



**Cross Canada Fiber Optic LED
Pocket Otoscope and Ophthalmoscope
Diagnostic Set**



Cross Instruments Inc.
4004 Aspen Drive East N.W.
Edmonton, AB T6J 2A8, Canada
Tel. (780) 669-1506
Fax. (780) 628-4156
Email: crossinstruments.com@gmail.com
URL: www.crossinstruments.com



Otoscope

INSTRUCTION MANUAL

An instruction of otoscope for practitioner. It is an internally powered device. Please read through this brochure before use, and keep it handy for future reference.

Symbols:

	Manufacturer
	Symbol for the marking of electrical and electronics devices according to Directive 2002/96/EC. The device, accessories and the packaging have to be disposed of waste correctly at the end of the usage. Please follow Local Ordinances or Regulations for disposal.
	Type B Applied Part
	Attention, consult accompanying documents

SAFETY INFORMATION

To assure the correct use of the product, basic safety measures should always be followed including the warnings and cautions listed in this instruction manual.

Warnings & Cautions:

- Do not use the device where it may be exposed to flammable gas.
- Protect this device from water, moisture, impact, dropping, direct sunlight, heat and fire.
- Do not touch the lens directly by hand or something hard.
- Please use the bulb type specified in this instruction brochure.
- Keep the device out of the reach of unsupervised infants and children.
- Do not disassemble or attempt to repair the device or components.

GENERAL

Description:

As classic medical devices in ENT (Ear, Nose and Throat), the series of otoscopes adopt a total reflection of optical fiber, and make light path and observation of light tend to a coaxial through the optimization design, which increase the visual field of view. It is used for viewing the tympanic membrane and external ear canal, helping doctors to diagnose outer and middle ear pathologies in clinic.

Technical Specifications:

- XHL Xenon Halogen Bulb and LED Bulb for option.
- 3X Magnification for the viewing window.
- 11-118 (LED Bulb)

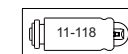

- Fiber optic illumination.
- An insufflation bulb for pneumatic testing.

HOW TO USE THIS DEVICE

- Turn on (or off) the device by pushing downwards (or upwards) as fig.1;
- Select a reasonable tip for patient's ear canal and push it onto the head and screw the tip clockwise, refer to fig.2. Generally, the tip size of 4mm is for adults and 2.4mm is for children;
- Put the otoscope with a tip into the ear canal of patient (fig.3), and examine through the viewing window which is with 3x magnification;

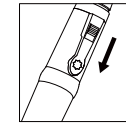

fig.1

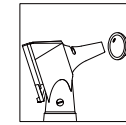

fig.2

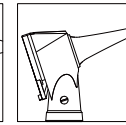

fig.3

Attention:

The otoscope should only be used to examine ear when a tip is fitted. It is an intermittent operated device, 1 minute ON, 5 minutes OFF.

MAINTENANCE

Changing Spare Parts:

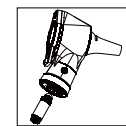

fig.4

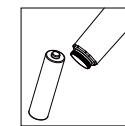

fig.5

1. Changing the bulb (fig.4)

- Turn off the power and unscrew the head from the handle of device;
- Pull the old bulb downwards, and replace with new one;
- Screw the head back on to the handle.

Attention:

- Please use the specialized bulb (Model: 11-118 LED Bulb)
- After the bulb burns out, the temperature will remain high for approximately 5 minutes. Please wait for a moment to avoid injury.

2. Changing the batteries (fig.5)

- Unscrew the bottom cover from the handle;
- Remove the old AA batteries, and replace with new ones. Ensure the anode of the batteries points to the head of the device;
- Screw on the bottom cover of the handle.

Attention:

- AA alkaline batteries are recommended.
- Replace all batteries simultaneously and do not use alkali manganese batteries with lithium as bulb life will be reduced.
- Do not leave worn batteries in the handle.
- Please take out batteries from the device if not in use for a prolonged period.
- Batteries should be disposed of in accordance with local regulations.

Cleaning and Disinfection:

- Clean the surface of device with 75% alcohol solution at least once a week, avoiding the magnifying glass (viewing window) in the head. And corrosive or polishing detergent is prohibited.
- Disinfect the tips of otoscope with saturated steam for 20 minutes at 134°C.

Attention:

Do not soak, autoclave or let water dip into the device!

PERIODIC SAFETY CHECKS

Preventive inspection and maintenance to be performed including the frequency of such maintenance. The following safety check should be performed at least every 12 months by a qualified person who has adequate training, knowledge, and practical experience to perform these tests.

- Inspect the equipment and accessories for mechanical and functional damage.
- Inspect the safety relevant labels for legibility.
- Verify that the device functions properly as described in the instructions for use.

SPECIFICATIONS

Illumination	Fiber Optic Illumination / Direct Illumination	
Luminance	18.5 Lumen	
Magnification	3X	
Tip sizes	2.4mm, 3mm, 4mm, 5mm	
Bulb	Specified Model: 11-118 LED Bulb	
Battery	2 AA alkaline batteries	
Operation	Temperature	10°C ~ 35°C
	Humidity	30% ~ 75%
	Air pressure	700 hPa ~ 1060 hPa
Storage & Transport	Temperature	-20°C ~ 70°C
	Humidity	10% ~ 90% (without condensation)
	Air pressure	500 hPa ~ 1060 hPa
Standards	MDD 93/42/EEC IEC 60601-1:2012, IEC 60601-1-2:2007	

ELECTRICAL CLASSIFICATION

Equipment Classification with respect to protection from electric shock: Internally powered equipment.
Degree of protection from electric shock: TYPE B.
Equipment not suitable for use in the presence of flammable mixture: Yes.
Mode of operation: intermittent operation.



Cross Instruments Inc.
4004 Aspen Drive East N.W.
Edmonton, AB T6J 2A8, Canada
Tel. (780) 669-1506
Fax. (780) 628-4156
Email: crossinstruments.com@gmail.com
URL: www.crossinstruments.com

The manufacturer reserves the right to make technical changes without notice in the interest of progress. Prior notices will not be given in case of any amendments within this manual.





**Cross Canada Fiber Optic LED
Pocket Oscope and Ophthalmoscope
Diagnostic Set**



Cross Instruments Inc.
4004 Aspen Drive East N.W.
Edmonton, AB T6J 2A8, Canada
Tel. (780) 669-1506
Fax. (780) 628-4156
Email: crossinstruments.com@gmail.com
URL: www.crossinstruments.com

Direct Ophthalmoscope

INSTRUCTION MANUAL

An instruction of ophthalmoscope for ophthalmologist. It is an internally powered device. Please read through this brochure before use, and keep it handy for future reference.

Symbols:

	Manufacturer
	Symbol for the marking of electrical and electronics devices according to Directive 2002/96/EC. The device, accessories and the packaging have to be disposed of waste correctly at the end of the usage. Please follow Local Ordinances or Regulations for disposal.
	Type B Applied Part
	Attention, consult accompanying documents

SAFETY INFORMATION

To assure the correct use of the product, basic safety measures should always be followed including the warnings and cautions listed in this instruction manual.

Warnings & Cautions:

- Do not use the device where it may be exposed to flammable gas.
- Protect this device from water, moisture, impact, dropping, direct sunlight, heat and fire.
- Do not touch the lens directly by hand or something hard.
- Please use the bulb type specified in this instruction brochure.
- Keep the device out of the reach of unsupervised infants and children.
- Do not disassemble or attempt to repair the device or components.

GENERAL

Description:

Direct ophthalmoscope, a classic medical device for ophthalmology, adopts a professional lens system. It makes doctors conveniently get a clear visual field and examine the interior structures of eyes, such as dioptric media etc..

Technical Specifications:

- XHL Xenon Halogen Bulb and LED Bulb for option.
- 11-118 LED Bulb

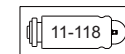

- 4 different apertures (Some Models Only)



- Range of lenses: -20 D to +20 D

HOW TO USE THIS DEVICE

- Turn on (or off) the device by pushing downwards (or upwards) as fig.1;
- Scroll the diopter wheel in two directions as fig.2 to select a suitable diopter, which helps to get a clearer observation vision for user ;
- Scroll the diaphragm wheel as fig.3 for getting a needed aperture;
- Diagnose by aiming the light to the patient's eye as fig.4.

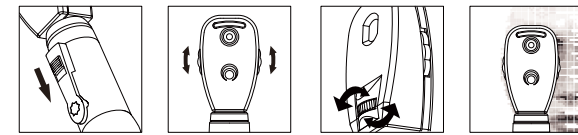

Attention:

It is an intermittent operated device, 1 minute ON, 5 minutes OFF.

MAINTENANCE

Changing Spare Parts:

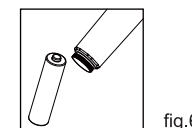

1.Changing the bulb

- Turn off the power and unscrew the head from the handle of device;
- Pull the old bulb downwards after opening screw and replace with new one;
- Screw the head back on to the handle.

Attention:

- Please use the specialized bulb (Model: 11-118 LED Bulb)
- After the bulb burns out, the temperature will remain high for approximately 5 minutes. Please wait for a moment to avoid injury.

2. Changing the batteries (fig.6)

- Unscrew the bottom cover from the handle;
- Remove the old AA batteries, and replace with new ones. Ensure the anode of the batteries points to the head of the device;
- Screw on the bottom cover of the handle.

Attention:

- AA alkaline batteries are recommended.
- Replace all batteries simultaneously and do not use alkali manganese batteries with lithium as bulb life will be reduced.
- Do not leave worn batteries in the handle.
- Please take out batteries from the device if not in use for a prolonged period.
- Batteries should be disposed of in accordance with local regulations.

Cleaning and Disinfection:

Clean the surface of device with 75% alcohol solution at least once a week, avoiding the lenses in the head. And corrosive or polishing detergent is prohibited.

Attention:

Do not soak, autoclave or let water dip into the device!

PERIODIC SAFETY CHECKS

Preventive inspection and maintenance to be performed including the frequency of such maintenance. The following safety check should be performed at least every 12 months by a qualified person who has adequate training, knowledge, and practical experience to perform these tests.

- Inspect the equipment and accessories for mechanical and functional damage.
- Inspect the safety relevant labels for legibility .
- Verify that the device functions properly as described in the instructions for use.

SPECIFICATIONS

Illumination	Direct Illumination	
Luminance	18.5 Lumen	
Bulb	Specified Model: 11-118 LED Bulb	
Battery	2 AA alkaline batteries	
Operation	Temperature	10°C ~ 35°C
	Humidity	30% ~ 75%
	Air pressure	700 hPa ~ 1060 hPa
Storage & Transport	Temperature	-20°C ~ 70°C
	Humidity	10% ~ 90% (without condensation)
	Air pressure	500 hPa ~ 1060 hPa
Standards	MDD 93/42/EEC	
	IEC 60601-1:2012, IEC 60601-1-2:2007	

ELECTRICAL CLASSIFICATION

Equipment Classification with respect to protection from electric shock: Internally powered equipment.
Degree of protection from electric shock: TYPE B.
Equipment not suitable for use in the presence of flammable mixture: Yes.
Mode of operation: intermittent operation.



Cross Instruments Inc.
4004 Aspen Drive East N.W.
Edmonton, AB T6J 2A8, Canada
Tel. (780) 669-1506
Fax. (780) 628-4156
Email: crossinstruments.com@gmail.com
URL: www.crossinstruments.com

The manufacturer reserves the right to make technical changes without notice in the interest of progress. Prior notices will not be given in case of any amendments within this manual.

