

# 7BBL

## Mash/lauter tank

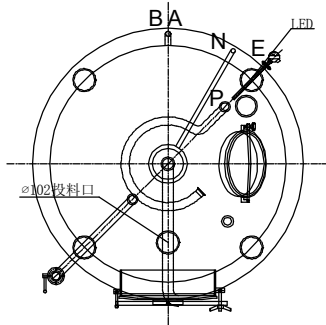
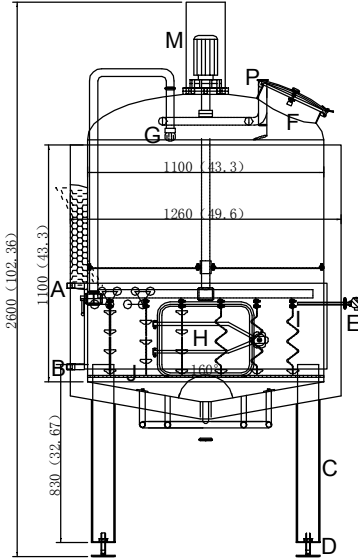

### Technique parameter

	Vessel	Jacket
Material	SUS304	SUS304
Storage liquid	Wort	Steam
Working pressure Mpa	Ordinary pressure	0.2
Heating mode	Steam heating	
Insulation material	Polyurethane	
Insulation thickness mm	80	
Effective volume BBL	7	
Total volume BBL	10.5	

### Welding process requirement

		standard
Welding wire material	308-SUS	GB/T983, YB/T5092, YB/T5091
welding requirements	Both sides welding	JB/T4709-2000

### Specification

Icon	Function	Connection mode	Remarks
P	Hot water port	Clamp	φ32mm
M	Motor		
K			
J	Sieve plate		
I	Rake knife		
H	Vinasse door	Quick-open	430*330mm
G	Cleaning ball	Clamp	φ32mm
F	Manhole door	Quick-open	φ400mm
E	Temperature probe	Clamp	φ10mm
D	Adjusting bolt	Thread	M20
C	Supporting leg	Welding	φ108mm
B	Steam outlet	Thread	φ32mm
A	Steam inlet	Thread	φ32mm

### Technical standards:

1. Material is SUS 304, inner tank is 3.0mm, out jacket is 2.0mm
2. The inner surface polished to  $Ra < 0.4\mu m$ .
3. Weld PaoSha light band, 40 mm width. 1. Shell weld shall ensure that the internal level, weld shall be ground flush, can not have uneven edge and scratches.
4. Inside of equipment treat with Acid cleaning passivation.

设计	签名	年月日	标准化	签名	年月日	阶段标记	重量	比例
审核								
工艺			批准			共张	第张	