

Quick Start Guide

1

Prior to use, put in order furniture including tables and chairs, as well as floor fans and other objects, and gather weighing scales, wires and other lower objects in order for maximum cleaning space. Do not use the mopping function on floor carpets.

Tidy the room

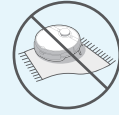
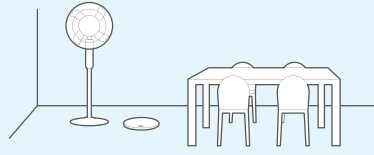

Dust collector station and robot preparation

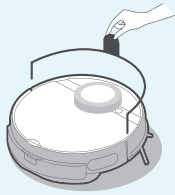

Remove the protection bar

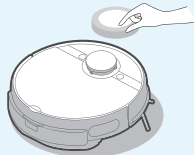

Remove the retainer

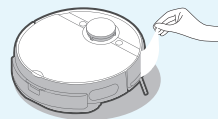

Peel off the bumper plate protection film

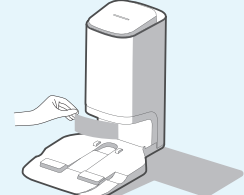

Peel off the protection film

2

Install side brushes

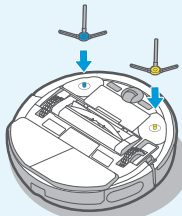

3

Place the dust collector station

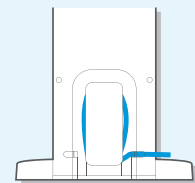
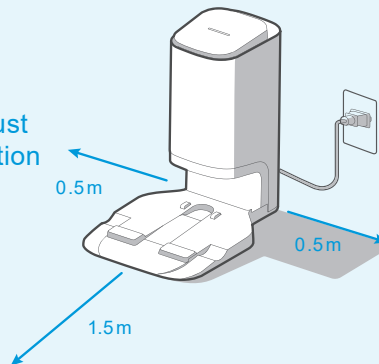

Put extra power cords in their storage slot

4

Connect Robot to Station

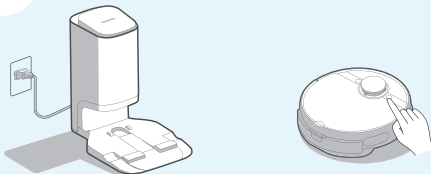

Option 1: Fast Connect
When robot is under powered-off status, long press "⏻" for 3 seconds. The connection will automatically complete after robot turned on. A sound of "Di-du" means connected successfully.



Option 2: Connect Manually
When robot is under powered-on status, long press "⏻" and "🔒" for 3 seconds at the same time. If connected successfully, a "Di-du" sound will be heard and station indicator light will flicker 3 times.

5

Network pairing

- Press the network pairing key for 3 seconds
- Press the "+" button on the main screen of the app and elect S8+ from the available list of products
- Enter the device addition wizard

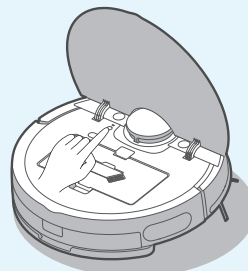

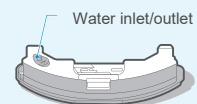

6

Start to clean

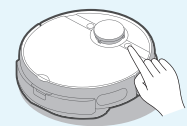

Fill the tank with water to the MAX line



 Briefly press it for 1 second to start/pause

Safety Instruction

1. This product is an indoor domestic product, not for use outdoor;
2. Do not use it in a humid environment (such as bathroom);
3. This product shall not bear an object (or person) exceeding 10 kg;
4. Do not touch power cords, sockets or power adapters with your wet hands;
5. Do not submerge the robotic cleaner in water, and avoid it from going close to heating apparatus or subject to direct sunlight to prevent fire hazards;
6. Do not fill the vibration tank with washing powder, laundry detergent, cleaning agents, disinfectants, hand sanitizers, unknown oily liquids, and alkaline substances to avoid unknown damages. Only use municipal water for the disinfection module;
7. To ensure better use effect of the machine, please let it go from its charging point to complete the mapping work when being used initially.