

BLENDER

USER MANUAL

MPB130ADKH

Warning notices: Before using this product, please read this manual carefully and keep it for future reference. The design and specifications are subject to change without prior notice for product improvement. Consult with your dealer or manufacturer for details. The diagram above is just for reference. Please take the appearance of the actual product as the standard.

THANK YOU LETTER

Thank you for choosing Midea! Before using your new Midea product, please read this manual thoroughly to ensure that you know how to operate the features and functions that your new appliance offers in a safe way.

CONTENTS







THANK YOU LETTER	01
SAFETY INSTRUCTIONS	02
SPECIFICATIONS	06
PRODUCT OVERVIEW	07
OPERATION INSTRUCTIONS	08
CLEANING AND MAINTENANCE	14
TROUBLESHOOTING	15
TRADEMARKS, COPYRIGHTS AND LEGAL STATEMENT	19
DISPOSAL AND RECYCLING	20
DATA PROTECTION NOTICE	21

SAFETY INSTRUCTIONS

Intended Use

The following safety guidelines are intended to prevent unforeseen risks or damage from unsafe or incorrect operation of the appliance. Please check the packaging and appliance on arrival to make sure everything is intact to ensure safe operation. If you find any damage, please contact the retailer or dealer. Please note modifications or alterations to the appliance are not allowed for your safety concern. Unintended use may cause hazards and loss of warranty claims.

Explanation of Symbols

	Danger This symbol indicates that there are dangers to the life and health of persons due to extremely flammable gas.
	Warning of electrical voltage This symbol indicates that there is a danger to life and health of persons due to voltage.
	Warning The signal word indicates a hazard with a medium level of risk which, if not avoided, may result in death or serious injury.
	Caution The signal word indicates a hazard with a low degree of risk which, if not avoided, may result in minor or moderate injury.
	Attention The signal word indicates important information (e.g. damage to property), but not danger.
	Observe instructions This symbol indicates that a service technician should only operate and maintain this appliance in accordance with the operating instructions.

Read these operating instructions carefully and attentively before using/commissioning the unit and keep them in the immediate vicinity of the installation site or unit for later use!

IMPORTANT SAFEGUARDS

- Read carefully and save all the instructions provided with this appliance.
- Always use your appliance from a power outlet of the voltage (A.C. only) marked on the appliance.
- This appliance is designed for domestic use only.
- Do not pull on the connection cord, but rather on the plug, to separate the appliance from the mains.
- Do not use outdoor.
- Do not leave the appliance unattended when it is switched on, as this may be a source of danger.
- Stand the appliance on a table or flat surface.
- If the supply cord is damaged, it must be replaced by the manufacturer, its service agent or similarly qualified persons in order to avoid a hazard.
- Avoid touching the moving parts.
- There is a potential injury from misuse. Please handle it with care.
- Ensure the control dial is in the off '0' position before plugging-in.
- Always disconnect the appliance from the supply if it is left unattended and before assembling, disassembling or cleaning.
- Do not use your appliance with an extension cord unless this cord has been checked and tested by a qualified technician or service person.

- Do not use an appliance for any purpose other than its intended use.
- Do not place an appliance on or near a hot gas flame, electric element or on a heated oven. Do not place on top of any other appliance.
- Do not let the power cord of an appliance hang over the edge of a table or bench top or touch any hot surface.
- Do not operate any electrical appliance with a damaged cord or after the appliance has been dropped or damaged in any manner.
- Do not immerse the appliance in water or any other liquid.
- Be careful when handling the sharp cutting blades, emptying the bowl and during cleaning.
- If the appliance is overfilled, boiling water may be ejected.
- This appliance shall not be used by children. Keep the appliance and its cord out of reach of children.
- This appliance can be used by persons with reduced physical, sensory or mental capabilities or lack of experience and knowledge if they have been given supervision or instruction concerning use of the appliance in a safe way and understand the hazards involved.
- Children shall not play with the appliance. Cleaning and user maintenance shall not be made by children without supervision.
- The appliance is only to be used with the stand provided.

- Children should be supervised to ensure that they do not play with the appliance.
- The heating element surface is subject to residual heat after use.
- Household use only.
- Switch off the appliance and disconnect from supply before changing accessories or approaching parts that move in use.
- Be careful if hot liquid is poured into the food processor or blender as it can be ejected out of the appliance due to a sudden steaming.
- Avoid spillage on the connector.

SAVE THESE INSTRUCTIONS

SPECIFICATIONS

Product Model	MPB130ADKH
Voltage	220-240V-
Frequency	50/60Hz
Heating Power	800W
Blender Rated Power	450W

PRODUCT OVERVIEW

General Description

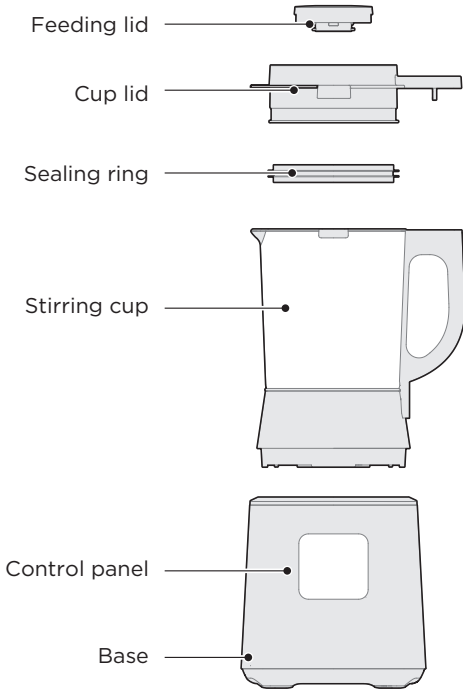

Accessories:



Measuring cup

NOTE

The above figure is the product diagram for reference purpose. Please refer to the actual product in the packaging.

OPERATION INSTRUCTIONS

Cautions Before Use

- This product is best worked below 2,000 meters above sea level, used at higher altitude may cause uncooked food, overflow and food burnt issues.
- Before turning on the power, make sure that the mixing cup, cup lid, and feeding lid are installed in place. If the soft rubber coaster on the main unit is warped, please flatten it before use.
- When the appliance is powered up, it is strictly forbidden to reach hands or sharp hard objects into the stirring cup to avoid injury or damage to the appliance.
- Please put food into the cup before starting. Never start working without food in it.
- When cleaning, please rinse the inside of the stirring cup with water and wipe dry; the blade is very sharp, please be careful when leaning to avoid injury.
- The outer case may be cleaned with a wringed cloth. To prevent leakage or damage to the equipment, do not immerse the machine into water or other liquids, do not wash directly under running water or other liquids.
- Do not use abrasive detergents or corrosive liquids (such as gasoline or acetone) to clean products.
- When using the non-warming functions, you may open the feeding lid to add the materials or ingredients during the operation (Strictly do not open the feeding lid when using warming functions to prevent from burning).
- The ingredients need to be pitted for making fruit and vegetable drinks.
- Before making food, wash the ingredients and cut them into pieces with a side length of no more than 5cm.
- It is forbidden to whip or grind dry goods and hard Chinese medicinal herbs (such as stone swallows, stone lotus seeds, stone magnets, etc.).
- Do not put ingredients and liquids above 80°C for whipping.
- The amount of ingredients in the recipe is prepared according to the standard water level, so users should also adjust the total amount of ingredients based on the amount of water and food types. The amount should not exceed 1,400mL when heating (the maximum capacity of soybean milk and rice cereal should not exceed 1,200mL), and that should be no more than 1,750mL for cold drinks, otherwise it will lead to overflow or burnt cooker.
- Do not use this appliance to directly heat milk, soy milk, cold rice paste and other viscous liquids; otherwise it will cause "burnt cooker" and other burning situations, resulting in odour.
- To make porridge, paste, soup, etc., you must select the corresponding buttons, otherwise they may taste bad or be undercooked, which will even cause overflow or burnt cooker in severe cases.
- In order to ensure food grinding effect and taste (dry corn, red bean, mung bean, barley and other dry led ingredients) when using porridge and paste function, please use hot water to soak for 4 hours before mixing.
- Do not add seasonings like granulated sugar and brown sugar to the cup during the preparation, in order to prevent the seasonings from sticking to the bottom of the stirring cup when heated.
- While making heated food, please do not put rags, sealing covers etc., on the lid of the cup to prevent overflow due to difficulties in steam exhaustion. Moreover, please be careful of the vapor and hot water splashed once the liquid in the mixing cup boils.

- When the food boils after heating for a while (the countdown starts), do not terminate the program. If the operation is terminated by mistake, do not select the heating function again so as to avoid overflow / burnt cooker due to repeated boiling of hot food. Please change the ingredients and select functions, or use the pot to cook and then use the custom mode to break the food.

Measuring Cup Instruction

When making rice cereal/porridge/soybean milk, use 1 cup of soybeans or 3/4-1 cup of rice with about 1,200mL water. The concentration can be adjusted by increasing or decreasing the amount of water according to personal taste.



Buttons Operation Instruction

Control panel

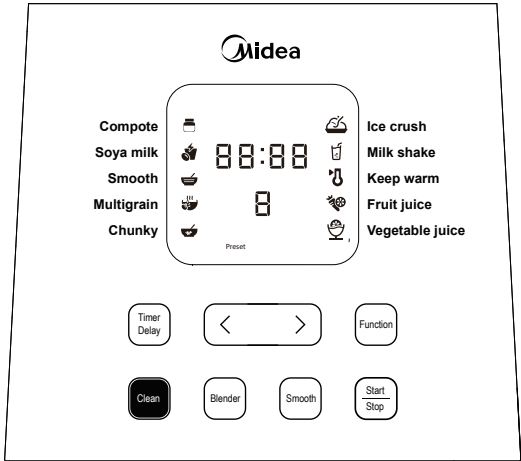

General functions:

Function Name	Operation method
Start/Stop	<ul style="list-style-type: none"> After setting the product work mode, touch the "Start/Stop" button, and the product enters the work state. Touch the "Start/Stop" button while working, the product stop working.
Function	<ul style="list-style-type: none"> Touch the "Function" button, and the "Soya milk" function light turns on. Touch the "Function" button again to turn on the next function light and stop after the required function.

Custom function:

Function Name	Operation method
Blender	<ul style="list-style-type: none">• After adding ingredients, touch the "Blender" key, and then touch "<" or ">" to adjust the gear. from L,1,...,8,H.L is the lowest speed, H is the highest speed Touch "Start / Stop" and the product will enter the working state. <p> Note: Time is not adjustable.</p>
Timer Delay	<ul style="list-style-type: none">• Tap the "Timer Delay" key, then tap "<" or ">" to adjust the time to complete the food, and tap the "Start / Stop" key to start. Note: reservation is applicable to heating function.

Heating function:

Function Name	Operation method
Compote	<ul style="list-style-type: none">• Add ingredients, select the function, and then touch the "Start/Stop" button to enter the working state. The food needs to be boiled first, then whipped and boiled for a long time. <p> Note:</p> <ol style="list-style-type: none">1. In the Soup mode, food will not be broken but it will lead to few food detritus by slight stirring.2. Dry corn, red beans, mung beans, barley and other hard and dry ingredients need to be soaked in hot water for 4 hours in advance.3. Program time and gear are fixed, not adjustable.
Soya milk	
Smooth	
Multigrain	
Chunky	
Keep warm	<ul style="list-style-type: none">• After adding an appropriate amount of water, select the "Keep warm" function. Touch the "Start/Stop" button, the cup starts working with slight agitation. And the water temperature in the mixing cup will be maintained at about 55°C for nearly 6 hours.
Clean	<ul style="list-style-type: none">• Used to help clean the hot cup. After adding 1,000mL water (the amount of water can be adjusted appropriately), select the "Clean" function. Touch the "Start/Stop" button to start work. And when the countdown ends the work is completed.

Non-heating function:

Function Name	Operation method
Ice crush	<ul style="list-style-type: none">• Add ingredients, select the function, and then touch the "Start/Stop" button to enter the working state. <p> Note:</p> <ol style="list-style-type: none">1. Program time and gear are fixed, not adjustable.
Milk shake	
Fruit juice	
Vegetable juice	

Usage

1. Cut the ingredients into blocks no more than 5 centimetres long. (Meat cut into strips and remove tendon.)

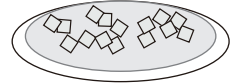

2. Use the measuring cup to get the right amount of ingredients according to the recipe, pour it into the mixing cup, and add the right amount of water.



Note:

- Adjust the amount of water according to recipes ratio.

3. Stagger the buckles on both sides of the cup lid to align the cup lugs, press the cup lid into the mixing cup, then turn the lid clockwise to buckle the mixing cup, and finally screw the feeding lid onto the cup lid.

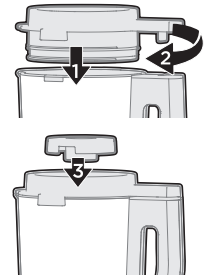

Note:

- The cup cover sealing ring shall not be omitted.
- The mixing cup has a cover opening protection device. If the cup cover is not rotated in place, the product will not work. The display flashes “88:88” .

4. Put the mixing cup properly on the base, plug in the power cord, and when the power is turned on, the product will beep and the display lights up.

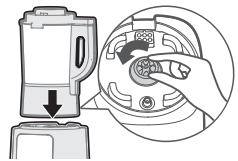

Note:

- If the mixing cup cannot be placed flat on the base, please slightly rotate the angle of the connector on the base, and then place the mixing cup on the base again.

5. Select functions according to your needs. Touch the “Start/Stop” button, the product starts to work.

Note:

- During the operation, the motor may have intermittent speed actions which is normal.
- There is a waiting time after the heating function is activated. When the water reaches a certain temperature, it will enter the countdown.

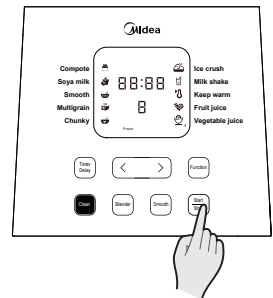

6. After the work is completed, you will hear the warning sound of "di di...". Unplug the power cord, remove the stirring cup and , open the cup lid.

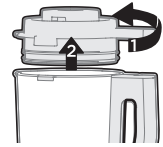

Note:

- To prevent burning, be aware of the hot steam when opening the cup lid.

7. Pour out the liquid and add seasoning according to personal preference.

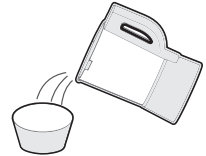

Note:

- Do not rush to pour out the liquid to prevent liquid spillage.

Recipes

Name	Ingredients & Cooking Methods
Oat & Barley Paste	<ul style="list-style-type: none"> • Ingredients: 24g barley, 24g oats, 24g soybeans, 24g red dates (with pits removed), 12g pine nuts, 12g flax seeds Cooking Method: Wash all the ingredients and put them in a hot jar, add 1,000ml hot water above 80 C (increase or decrease the temperature based on your taste). Then, select the "Multigrain" function, press the "Start/Stop" button, until it is completely prepared. • Cooking Method: Wash all the ingredients and put them in a hot jar, add 1,000 ml fresh water (increase or decrease the temperature based on your taste). Then, select the "Multigrain" function, press the "Start/Stop" button, until the paste is completely prepared.
Walnuts & Oatmeal Soymilk	<ul style="list-style-type: none"> • Ingredients: 50g dried soybeans, 20g raw oats, 15g walnut kernels (one) Cooking Method: Wash all the ingredients and put them in a hot jar, add 1,000ml hot water above 80 C (increase or decrease the temperature based on your taste). Then, select the "Soya milk" function, press the "Start/Stop" button, until it is completely prepared. • Cooking Method: Wash all the ingredients and put them in a hot jar, add 1,000 ml fresh water (increase or decrease the temperature based on your taste). Then, select the "Soya milk" function, press the "Start/Stop" button, until the paste is completely prepared.

Name	Ingredients & Cooking Methods
Pork Ribs Soup	<ul style="list-style-type: none"> • Ingredients: Half of a corn (about 200g), 200g ribs, 200g carrot, 5 slices of carrot, and appropriate amount of salt • Cooking Method: Wash all the ingredients, chop the ribs, cut corn into 6 sections, and dice carrots; then, put them into a hot jar, add about 700 ml fresh water (increase or decrease the temperature based on your taste), select the "Chunky" function, and press "Start" /"Stop" button, until it is completely prepared.
Banana Apple Juice	<ul style="list-style-type: none"> • Ingredients: 1 scoop of honey, 100g milk, 1 banana, 120g apple (about half of apple) (recommended to add 3 ice cubes to give better taste) • Cooking Method: Wash the apple, remove its core and cut it into pieces not greater than 1.5 cm, cut the banana into 6 sections. Then, put the ingredients in a hot jar, add 100g milk and 1 spoon of honey. Select the "Fruit juice" function, press the "Start/Stop" button, until it is completely prepared.
Carrot Juice	<ul style="list-style-type: none"> • Ingredients: 700g carrot • Cooking Method: Wash the carrot, cut it into pieces of about 1.5 cm, put it in a hot jar, and add 1,050g water. Select the "Blender" function mode and the highest gear (H gear), time is 3min, and then press the "Start/Stop" button, until it is completely prepared.
Milk shake	<ul style="list-style-type: none"> • Ingredients: Mango 400g, ice 200g, yogurt 250ml • Practice: remove the core and peel the mango, cut it into two pieces, ice and yogurt into a cup. Select the "milk shake" function, tap the "start / stop" key and wait for the production to be completed.
Ice crush	<ul style="list-style-type: none"> • Ingredients: Mango 300g, 6 ice cubes, fresh milk 60ml • Practice: remove the core and peel the mango, cut it into two pieces, ice and fresh milk into a cup. Select the "ice crush" function, tap the "start / stop" key and wait for the production to be completed.
vegetable soup	<ul style="list-style-type: none"> • Ingredients: carrot 224g, potato 224g, onion 210g, parsley 7g, water 735g • Method: cut carrots, potatoes and onions into 2cm pieces, Parsley Remove stalks and put it into the cup, and then pour 735g of water into the cup. Select the "compare or smooth" function, tap the "start / stop" key and wait for the production to be completed.

CLEANING AND MAINTENANCE

- After the juice is poured out of the mixing cup, add clean water immediately and use the "High Temperature Clean" function or press the "Long Press Blending" button several times to clean the cup.
- Disconnect the power supply. The outer case may be cleaned with a wringed cloth. To prevent leakage or damage to the equipment, do not immerse the machine into water or other liquids, do not wash directly under running water or other liquids.
- When cleaning, please rinse the inside of the stirring cup with water and wipe dry; the blade is very sharp, please be careful when leaning to avoid injury.
- After using, it's necessary to clean the cup lid, sealing ring, etc., as soon as possible to avoid staining after being placed for a long time. If some parts are stained with food, try adding a few drops of cooking oil to wipe before rinsing.
- Rinse the parts with water and then dry it thoroughly.
- Be careful of burning by overheating; please clean up the stirring cup after cooling.
- When the residue in the drum is dry and difficult to remove add the appropriate amount of water for soaking, wait for 0.5 to 1 hour for softening, and then clean it up and wipe dry.
- The electricity conducted components such as product base, stirring cup, power cord, etc cannot be immersed into water and other liquids.
- If the bottom of the stainless steel heating plate is not cleaned up for several times, light brown dirt will be accumulated on its bottom. At this time, soak the plate with water for a long time, and use a slightly harder cloth to dip white vinegar and wipe it along the bottom texture in rotation.
- Do not directly wash the base and the bottom of the stirring cup under running water.
- Do not place the appliance, power cord, and packaging accessories under the sun.

Maintenance

- For prolonged storage, keep it in a dry and ventilated place to prevent the motor from moisture and affecting normal usage.

TROUBLESHOOTING

Abnormality Handling

- If anomalies occur, such as: abnormal noise, smell, smoke, etc., cut off the power immediately and stop using it.
- If the blender cup does not work: Please check whether the power supply is well connected, whether the switch is turned on, and whether the mixing cup and the cup lid are in place.
- If the product still cannot work after checks mentioned above, please consult the designated repair centre for maintenance.

Troubleshooting And Analysis

Abnormal situation	Analysis of Possible Causes	Countermeasure
Spill over	• Too much or too little Ingredients	• Put the amount of ingredients according to the instruction manual
	• Too much or too little water	• Please add water to appropriate water level
	• Wrong selection of function	• Select the function according to the instruction manual
	• Appliance breakdown	• Send to local after-sales service centre for maintenance
	• The cup lid with spill-proof function is not fully covered in placed	• Please ensure that the cup lid is in placed and the signal is reliably connected
Burnt ingredients	• Too much Ingredients	• Put the amount of ingredients according to the instruction manual
	• Placed wrong ingredients	• Do not put in flour and ingredients that can seriously burned at the bottom
	• Too little water	• Please add water to appropriate water level
	• The bottom of the cup is not washed clean	• Please wash it clean before use
	• Wrong selection of function	• Select the function according to the instruction manual
	• Appliance breakdown	• Send to local after-sales service centre for maintenance

Abnormal situation	Analysis of Possible Causes	Countermeasure
Ingredients cannot be broken into pieces	• Too much or too little Ingredients	• Please follow recipes
	• Too much or too little water	• Please add water to appropriate water level
	• Wrong selection of function	• Select the function according to the instruction manual
	• Appliance breakdown	• Send to local after-sales service centre for maintenance
At the end of the work, the ingredients are not hot	<ul style="list-style-type: none"> • Wrong selection of function gear. • Under this function gear, food is only heated without whipping • Appliance breakdown 	<ul style="list-style-type: none"> • Select the function according to the instruction manual • Send to local after-sales service centre for maintenance
Work noise	• Motor stirring sound	• Normal phenomenon
	• Product break-in period	• Occasional noise is a normal phenomenon
	• Abnormal sound, motor anomaly	• Send to local after-sales service centre for maintenance
Display "8888"	• Cup cover not installed in place	• Refit the cup cover
	• Machine failure	• Send to local after-sales service
The screen is not display	• The power cord is not plugged in	• Send to local after-sales service centre for maintenance
	• Appliance breakdown	• Check the power cord and ensure it is plugged in
	• The cup is not in place	• Refill the cup
Button no response	• The machine cannot be operated while it is working	• Normal phenomenon
	• The panel has water, affecting the level of sensitivity	• Wipe dry the panel
	• Appliance breakdown	• Send to local after-sales service centre for maintenance

Abnormal situation	Analysis of Possible Causes	Countermeasure
The screen is on, but machine not working	<ul style="list-style-type: none"> Start/Stop button not pressed 	<ul style="list-style-type: none"> Reselect the function and press the Start/Stop button
	<ul style="list-style-type: none"> No water in the cup to protect overheating 	<ul style="list-style-type: none"> Please add water to the correct water level, restart after cooling it
	<ul style="list-style-type: none"> A tweet alarm occurred while working 	<ul style="list-style-type: none"> Unplug the power first, reconnect and follow the normal working steps be operated
	<ul style="list-style-type: none"> Appliance breakdown 	<ul style="list-style-type: none"> Send to local after-sales service centre for maintenance
Display “_____”	<ul style="list-style-type: none"> Select mode 	<ul style="list-style-type: none"> Normal operation. Select speed or preset.

Fault Code Displays

- Prompts
- If an alarm sound occurs during the production, and letters and figures will appear on the display simultaneously, and you're required to make troubleshooting as per the table below.

Error code	Possible cause	Solutions
d1	<ul style="list-style-type: none"> • Water enters the base • The food block is too large or put too much, leading to motor overload protection • Failure of circuit board 	<ul style="list-style-type: none"> • Make sure the water stain inside the appliance is dried naturally to avoid water entry • Food in the grinding jar should be cut into small pieces as much as possible with appropriate amount • Send to the after-sales center for repair if the fault cannot be recovered
E1 E2	<ul style="list-style-type: none"> • Water enters the base, which is mainly the connection between base and jar, and the circuit board • Water enters the base • Jar is put on the base improperly • Failure of circuit board and internal wiring of the appliance 	<p>Replace the grinding jar, and identify whether the jar or the base is faulty. If the base is confirmed to be faulty, take measures as follows:</p> <ul style="list-style-type: none"> • Make sure the water stain inside the appliance is dried naturally to avoid water entry • Send to the after-sales center for repair if the fault cannot be recovered for repair if the fault cannot be recovered
C3	<ul style="list-style-type: none"> • Failure of circuit board and internal wiring of the appliance • Jar is put on the base improperly • Water enters the base • Loosened or disconnected internal wiring of the base • Circuit board is failed • Thermostat is in high temperature protection mode 	<ul style="list-style-type: none"> • Excessive ingredients are cooked, resulting in overcook of food, and a high temperature alarm will be issued; you need to clean the ingredients in the cup, and cook again in accordance with the instructions • Make sure the water stain inside the appliance is dried naturally to avoid water entry • Send to the after-sales center for repair if the fault cannot be recovered
C3	<ul style="list-style-type: none"> • Failure of circuit board • Water enters into the appliance 	<ul style="list-style-type: none"> • Make sure the water stain inside the appliance is dried naturally to avoid water entry • Send to the after-sales center for repair if the fault cannot be recovered

TRADEMARKS, COPYRIGHTS AND LEGAL STATEMENT

 Midea logo, word marks, trade name, trade dress and all versions thereof are valuable assets of Midea Group and/or its affiliates (“Midea”), to which Midea owns trademarks, copyrights and other intellectual property rights, and all goodwill derived from using any part of an Midea trademark. Use of Midea trademark for commercial purposes without the prior written consent of Midea may constitute trademark infringement or unfair competition in violation of relevant laws.

This manual is created by Midea and Midea reserves all copyrights thereof. No entity or individual may use, duplicate, modify, distribute in whole or in part this manual, or bundle or sell with other products without the prior written consent of Midea.

All the described functions and instructions were up to date at the time of printing this manual. However, the actual product may vary due to improved functions and designs.

DISPOSAL AND RECYCLING

Important Instructions For Environment

Compliance with the WEEE Directive and Disposing of the Waster Product:
This product complies with EU WEEE Directive (2012/19/EU). This product bears a classification symbol for waster electrical and electronic equipment (WEEE).

This symbol indicates that this product shall not be disposed with other household wastes at the end of its service life. Used device must be returned to official collection point for recycling of electrical electronic devices. To find these collection systems please contact to your local authorities or retailer where the product was purchased. Each household performs important role in recovering and recycling of old appliance. Appropriate disposal of used appliance helps prevent potential negative consequences for the environment and human health.



Compliance With Rohs Directive

The product you have purchased complies with EU RoHS Directive (2011/65/EU). It does not contain harmful and prohibited materials specified in the Directive.

Package Information

Packaging materials of the product are manufactured from recyclable materials in accordance with our National Environment Regulations. Do not dispose of the packaging materials together with the domestic or other wastes. Take them to the packaging material collection points designated by the local authorities.

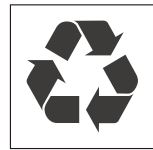

DATA PROTECTION NOTICE

For the provision of the services agreed with the customer, we agree to comply without restriction with all stipulations of applicable data protection law, in line with agreed countries within which services to the customer will be delivered, as well as, where applicable, the EU General Data Protection Regulation (GDPR).

Generally, our data processing is to fulfil our obligation under contract with you and for product safety reasons, to safeguard your rights in connection with warranty and product registration questions. In some cases, but only if appropriate data protection is ensured, personal data might be transferred to recipients located outside of the European Economic Area.

Further information are provided on request. You can contact our Data Protection Officer via **MideaDPO@midea.com**. To exercise your rights such as right to object your personal data being processed for direct marketing purposes, please contact us via **MideaDPO@midea.com**. To find further information, please follow the QR Code.



www.midea.com

© Midea 2022 all rights reserved