



FOOD WASTE DISPOSER

Safety Information

Connecting Electricity.....2, 3
Safety Precautions.....2

Installation Instructions

Attaching the Discharge
Elbow6
Components and Installation
of Sink Flange.....5
Connecting Disposer to
Sink Flange.....7
Dimensions/Typical
Installations.....8
Dishwasher Connection.....6

Operating Instructions

Care and Maintenance.....10
Continuous Feed Models.....9

Troubleshooting Tips

Before You Call for
Service.....11

Customer Service

Warranty.....12

Owner's Manual
& Installation

Model Line Series
MD1-C38-EU



**Write the model and serial numbers
for your Disposer here:**

Model # _____

Serial # _____

*You can find them on a label on
the bottom of the disposer.*

IMPORTANT SAFETY INSTRUCTIONS. READ ALL INSTRUCTIONS BEFORE USING.

INSTRUCTIONS PERTAINING TO A RISK OF FIRE, ELECTRIC SHOCK OR INJURY TO PERSONS

WARNING!

When using electrical appliances, basic safety precautions should be followed, including the following:



SAFETY PRECAUTIONS

- Use this appliance only for its intended purpose as described in the owner's manual.
- Read all the instructions before using the appliance.
- To reduce the risk of injury, close supervision is required when an appliance is used near children.
- Do not put fingers or hands into a waste disposer.
- Turn the electrical switch connected to the disposer to the off position before attempting to clear a jam or remove an object from the disposer.
- When attempting to loosen a jam in a waste disposer, use long wooden object such as a wooden spoon or the handle of a broom or mop.
- When attempting to remove objects from a waste disposer, use long-handled tongs or pliers. If the disposer is magnetically actuated, use only nonmagnetic tools.
- To reduce the risk of injury by materials that may be expelled by a waste disposer, do not put the following into a disposer:
 - a) Clam or oyster shells.
 - b) Caustic drain cleaners or similar products.
 - c) Glass, china or plastic.
 - d) Large whole bones.
 - e) Metal, such as bottle caps, tin cans, utensils or aluminum foil.
 - f) Hot grease or other hot liquids.
 - g) Whole corn husks.
- This appliance must be installed by the local authority or the national authority. Do not disassemble for any reason when the appliance is installed. There are no serviceable parts.
- When not operating a disposer, leave the drain stopper in place to reduce the risk of objects falling into the disposer.
- The appliance must be installed so that reset button is readily accessible.
- This appliance is not intended for use by persons (including children) with reduced physical, sensory or mental capabilities, or lack of experience and knowledge, unless they have been given supervision or instruction concerning the use of the appliance by a person responsible for their safety. Children should be supervised to ensure they do not play with the appliance.
- If the supply cord is damaged, it must be replaced by the manufacturer, its service agent or similarly qualified persons in order to avoid a hazard.
- Make sure that the installation of this appliance is allowed by the authorities.
- This marking indicates that this product should not be disposed with other household wastes throughout the EU. To prevent possible harm to the environment or human health from uncontrolled waste disposal, recycle it responsibly to promote the sustainable reuse of material resources. To return your used device, please use the return and collection systems or contact the retailer where the product was purchased. They can take this product for environmental safe recycling.



For proper grounding instructions see the ELECTRICAL CONNECTION portion of this manual.

- Never use this appliance in damp location (eg. bathroom or laundry room).
- Do not use this appliance to dispose of hard materials such as glass and metal.
- Switch off or unplug the appliance before attempting to free a jammed rotor with an implement.

WARNING!

HOW TO CONNECT ELECTRICITY



If you are not familiar with electrical power and procedures, call a qualified electrician.

DANGER: Improper connection of the equipment-grounding conductor can result in a risk of electric shock. Check with a qualified electrician or serviceman if you are in doubt as to whether the appliance is properly grounded. Do not modify the plug provided with the appliance if it will not fit the outlet; have a proper outlet installed by a qualified electrician.

These appliances are meant for household use only. Do not use for commercial application.

For Models Equipped with a Grounded Cord: GROUNDING INSTRUCTIONS: This appliance must be grounded. In the event of a malfunction or breakdown, grounding provides a path of least resistance for electric current to reduce the risk of electric shock. This appliance is equipped with a cord having an equipment-grounding conductor and a grounding plug. The plug must be plugged into an appropriate outlet that is properly installed and grounded in accordance with all local codes and ordinances.

IMPORTANT SAFETY INSTRUCTIONS.

READ ALL INSTRUCTIONS BEFORE USING.

⚠ WARNING!



HOW TO CONNECT ELECTRICITY (cont.)

If you are not familiar with electrical power and procedures, call a qualified electrician.

The power cord and/or connections must comply with the National Electrical Code, Section 422 and/or local codes and ordinances.

For Models Not Equipped with a Cord:

1. Chose a power cord not less than H05VV-F, 3G1.0mm² incorporate with a plug rated 250V 13A (fuse in plug: 250V, 10A) approved by BSI which matched ground wire for UK market (Standard: BS1363-1) or a plug rated 250V 16A approved by VDE with matched ground wire (Standard: DIN VDE 0620-1).

2. Chose a power cord not less than H05VV-F, 3G1.0mm² and fitted with a switch, the switch shall be directly connected to the supply terminals and shall have a contact separation in all poles, providing full disconnect under overvoltage category III conditions (the full disconnection not less than 3mm).

3. Make sure the switch shall be easily visible and accessible. The recommend distance between this appliance and electrical switch is within 2m.

To Attach a Power Cord:

GROUNDING INSTRUCTIONS: This appliance must be grounded. In the event of malfunction or breakdown, grounding provides a path of least resistance for electric current to reduce the risk of electric shock. The power cord (to be installed) must have an equipment-grounding conductor and a grounding plug. The plug must be plugged into an appropriate outlet that is properly installed and grounded in accordance with all local codes and ordinances.

DANGER: *Improper connection of the equipment-grounding conductor can result in a risk of electric shock. Check with a qualified electrician or serviceman if you are in doubt as to whether the appliance is properly grounded.*

NOTE:

Disconnect electric power to disposer circuit before installation. Turn the circuit breaker to the OFF position or remove the fuse.

A. Connect the disposer to 220-240 Volt, 50-60 Hz AC current only.

B. If a plug-in cord is used, use a three-prong plug. Ground wire should be attached to the ground screw in the bottom of the disposer (end bell).

Trace the lead connected to this blade marked □□ and attach that lead to blue wire on disposer.

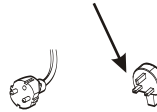

NOTE: When viewing face of electrical plug with grounding pin at top, the left blade is connected to the identified wire.

C. Use a cable clamp strain relief connector where power cord enters the disposer.

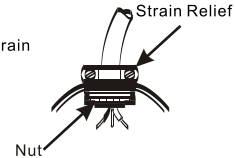

To Wire Your Disposer Directly into the House Current:

GROUNDING INSTRUCTIONS: This appliance must be connected to a grounded, metal, permanent wiring system; or an equipment-grounding conductor must be run with the circuit conductors and connected to the equipment-grounding terminal or lead on the appliance.

A. If you use BX cable:

1. These products are designed for household use.
2. Connect line wire to blue lead of disposer with a wire nut. Connect neutral wire to brown lead of disposer with a wire nut. Connect bare ground wire to the ground screw. The ground wire should be clamped and held by a strain relief.
3. Do not use a rigid conduit for the wiring connection.
4. A dedicated acceptable motor switch, with the off position marked, shall be provided for this disposer at the time of installation. The switch shall be mounted in sight of the disposer or the sink opening for the disposer.

If BX cable is not used, provide a separate ground wire to nearest reliable ground, using the screw in the end bell for the ground wire.

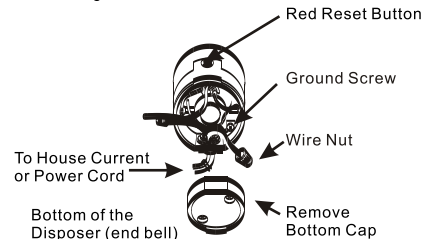

Safety Information

Installation Instructions

Operating Instructions

Troubleshooting Tips

Customer Service

**IMPORTANT SAFETY INSTRUCTIONS.
READ ALL INSTRUCTIONS BEFORE USING.**

Safety Information

⚠ WARNING!



HOW TO CONNECT ELECTRICITY (cont.)

If you are not familiar with electrical power and procedures, call a qualified electrician.

SOME TYPICAL ELECTRICITY CONNECT

If your kitchen had a wall outlet with a control switch yet, please plug the power cord of disposer into the outlet directly.

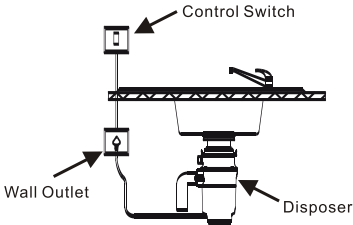

If your kitchen wall outlet didn't have a control switch, you can buy an external air switch from us or from market, the switch should have a CE certification if you buy from market. Please connect your disposer power cord to the air switch according to below method.

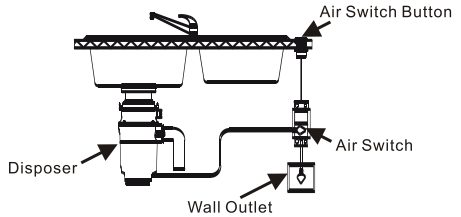

Installation Instructions

Operating Instructions



READ AND FOLLOW THIS SAFETY INFORMATION CAREFULLY

SAVE THESE INSTRUCTIONS

Troubleshooting Tips

Customer Service

Installation Instructions

Disposer

BEFORE YOU BEGIN

Read these instructions completely and carefully

? **IMPORTANT** - Save these instructions for local inspector's use.

? **IMPORTANT** - Observe all governing codes and ordinances.

? **Note to Installer** - Be sure to leave these instructions with the Consumer.

? **Note to Consumer** - Keep these instructions for future reference.

? **Skill Level** - Installation of this appliance requires basic mechanical skills.

? **Completion Time** - 1 hour.

? Proper installation is the responsibility of the installer.

PREPARATION

1. Disconnect electrical power supply to disposer.
2. Remove old disposer or sink flange assembly.
3. Inspect drain line. If it is heavily coated with hardened grease and accumulations, rout out with a plumber's snake.
4. Remove old sealing materials and gasketing from sink opening, both top and bottom.

NOTE: Top and bottom of sink surfaces must be free of any materials to prevent leaks.

WHAT YOU WILL NEED

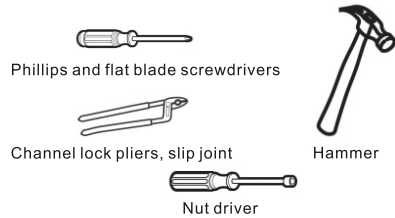

ADDITIONAL MATERIALS YOU MAY NEED

1. Steel punch or wooden dowel
2. Petroleum jelly or liquid soap
3. Hose clamp
4. Dishwasher drain connector
5. Adjustable pipe wrench
6. Plumber's putty (for cast sinks)
7. Stepped rubber drain adapter
8. Wire nuts
9. Cable connector
10. Flexible drain pipe
11. Power cord kit

Installation Instructions

1 COMPONENTS AND INSTALLATION

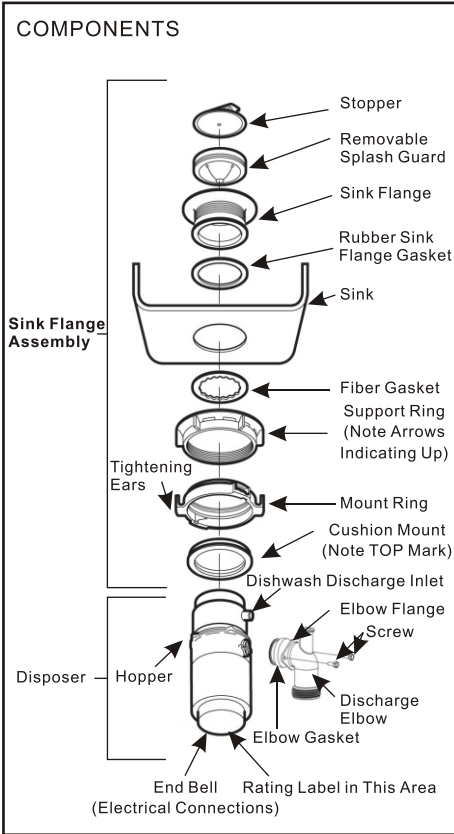

NOTE: Pay close attention to the order of the sink flange parts, as they have been correctly assembled by the factory.

A. Disassemble the sink flange assembly from the disposer by turning the mount ring to the left (clockwise) and removing it.

B. Raise the mount ring toward the top of the sink flange. Remove the cushion mount and the mount ring. You may want to practice installing the cushion mount at this point before you are under the sink.

C. Unscrew the support ring from the sink flange and remove the fiber gasket. You are now left with the sink flange and the rubber gasket.

D. The rubber gasket is used instead of plumbers putty with stainless steel sinks. Some cast sinks will require putty.

E. If no putty is used, insert the sink flange through the rubber gasket into the sink opening. Do not turn the flange once it is seated.

F. If you use putty instead of the gasket, form a ring around the underside of the sink flange. Insert the flange into the sink opening, press down hard to squeeze out excess putty. From under the sink, trim off excess putty flush with the bottom edge of the sink opening.

G. From underneath the sink, slip the fiber gasket onto the exposed sink flange. With arrows pointing up, screw the support ring onto the sink flange and hand tighten until the sink flange will not move. At this point you may want to insert the stopper in the sink and fill with water to check the sink flange seal and insure there are no leaks.



Hand-tighten sink flange

H. Place the mount ring over the sink flange and hold in place while installing the cushion mount (large side down). Make sure the groove on the inside of the cushion mount fits over the lip on the sink flange, similar to putting the on a plastic container. Run your fingers around the entire cushion mount with slight pressure. Do not press too hard. When the cushion mount is properly seated, the mount ring can be pulled downward over the cushion mount and will be free to turn.



Cushion Mount Detail

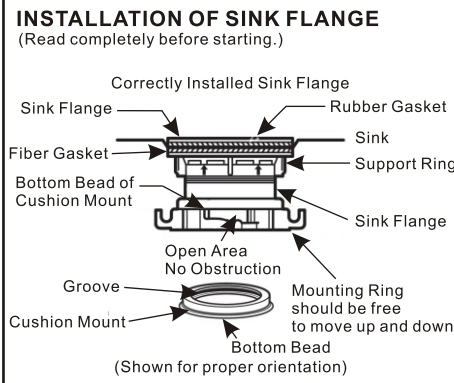
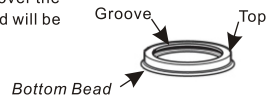

Installation Instructions

2 DISHWASHER CONNECTION (IF REQUIRED)

If you are connecting to a dishwasher, complete the following step. If a dishwasher is not to be connected go on to "Attaching the Discharge Elbow" section.

1 KNOCK OUT PLUG

Using a blunt instrument (steel punch or wooden dowel), knock out entire plug. Do not use a screwdriver or sharp instrument. When knockout plug falls into disposer, you may remove it or simply grind it up when the disposer is used. This will not damage the disposer in any way, but may take some time to grind, over the course of several uses.

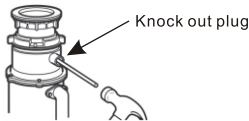

2 CONNECT HOSE

Connect the dishwasher hose using a hose clamp. If the hose size is different, you will need a stepped rubber adapter.



Hose Clamp Stepped Rubber Adapter

3 ATTACHING THE DISCHARGE ELBOW

CONNECT DISCHARGE ELBOW*

Connect the discharge elbow to the disposer.** Make sure all plumbing connections are tight.

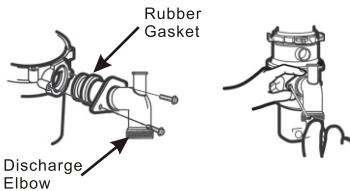

* Discharge elbow must be installed by a professional.

** Some installations (see page 8 for examples) may require the use of a flexible drain pipe.

NOTE: If the dishwasher connection is made without removing the plug, the dishwasher may overflow.

Installation Instructions

4 CONNECTING DISPOSER TO SINK FLANGE

1 ATTACH TO SINK FLANGE

Line up the disposer under the sink flange. Guide the hopper projections into the mount ring slots. Turn the mount ring about 1/4" to the right so that the disposer is temporarily supported.

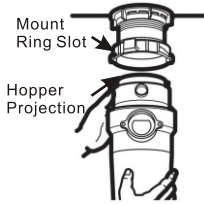

2 LINE UP WITH OUTLET PIPE

Turn the mount ring and the disposer until the disposer discharge elbow lines up with the outlet pipe (See page 9).

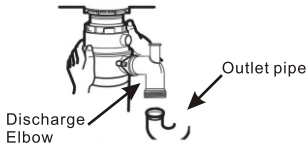

3 LOCK MOUNT RING

Turn the mount ring to the right until it locks up tight. Hopper projections must be to the extreme left of the mounting slots. If the mount ring is hard to turn, you may add a small amount of petroleum jelly or liquid soap to the hopper projection. Run water and check for leaks.



Locking Detail

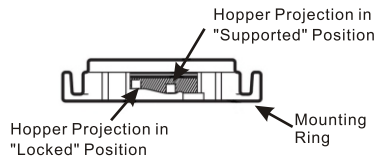

4 CHECK FOR LEAKS

Check the unit for leaks 24 hours after installation and first operation.

IMPORTANT: Don't put your head or body under disposer, unit could fall during installation.

Installation Instructions

DIMENSIONS

- A: Disposer height
- B: Disposer from bottom of sink bowl to centerline of discharge outlet
- C: Distance from centerline of the discharge outlet to end of discharge tube
- D: Disposer width
- E: Distance from disposer vertical centerline to centerline of discharge elbow

Dimension Model No	A	B	C	D	E
MD1-C38 -EU	365	176	70	197	137
MD1-C56 -EU	392	184	70	216	141
MD1-C75 -EU	432	184	70	216	141

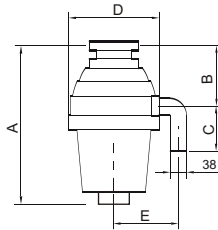

SOME TYPICAL INSTALLATIONS

SINGLE BOWL



DOUBLE BOWL CENTER OUTLET

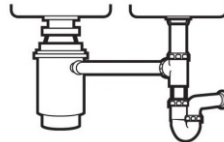

DOUBLE BOWL END OUTLET

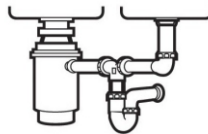

- NOTE:** 1. It is essential for the proper operation of the disposer that this dimension be 230-300mm, depending upon the models listed above, to avoid standing water in disposer motor housing.
2. Flexible drain pipe may be necessary for this application.

Operating Instructions

This disposer uses anti-jam swivel impellers that make a clicking sound as they swing into place. This indicates normal operation.

Operating Instructions

1. Remove the sink stopper and turn on a medium flow of cold water.
2. Turn on the wall switch.
3. Slowly insert food waste into disposer and position stopper to minimize possible ejection of material while grinding.
4. After grinding is complete, turn disposer off and run water for at least 15 seconds to flush drain line.

Helpful Hints

DO...

- A. Be sure the disposer is empty before using the dishwasher so it can drain properly.
- B. You may want to leave the stopper in the drain when not in use to prevent utensils and foreign objects from falling into the disposer.
- C. **TO SPEED UP FOOD WASTE DISPOSER...** Cut or break up large bones, melon rinds, grapefruit skins and corn cobs. Items such as large bones, fibrous husks like lima bean pods and corn husks require considerable cutting time. For this reason, you may prefer to place them in the trash can.
- D. Grind peelings from citrus fruits to freshen up drain smells.
- E. Use a disposer cleaner or deodorizer as necessary to relieve objectionable odors caused by grease build-up.
- F. Before turning the disposer off, let the water and the disposer run for at least 15 seconds after shredding stops. This assures that all waste is thoroughly flushed through the trap and drain.

DON'T...

- A. Don't be alarmed that the disposer slows down while grinding. The disposer is actually increasing torque (grinding power) and is operating under normal conditions.
- B. Don't pour grease or fat down your disposer or any drain. It can build up in pipes and cause drain blockages. Put grease in a jar or can and dispose in the trash.
- C. Don't use hot water when grinding food waste. It is OK to drain hot water into the disposer between grinding periods.
- D. Don't put tin cans, bottles and bottle caps, glass, china, leather, cloth, crockery, rubber, string, feathers, or clam or oyster shells into your disposer. These are waste materials and belong in the trash can.
- E. Don't fill disposer with a lot of vegetable peels all at once. Instead, turn the water and disposer on first and then feed the peels in gradually.
- F. Don't grind extremely fibrous materials like corn husks, artichokes, etc., To avoid possible drain blockage.
- G. Don't turn off disposer until grinding is completed and only sound of motor and water is heard.

Care and Maintenance

THE MOTOR IS PERMANENTLY LUBRICATED FOR LIFE. DON'T ATTEMPT TO LUBRICATE YOUR DISPOSER, The disposer is self cleaning and scours itself with each use.

- NEVER put lye or chemical cleaners into the disposer, as they cause serious corrosion of metal parts.
- Your disposer is equipped with a removable splash guard for ease of cleaning or replacement. Remove the splash guard by pulling it out from the top. To replace, insert into the sink flange and push down until it is properly seated.
- If an odor develops, run orange or lemon rinds through the disposer. A dozen ice cubes sprinkled with a little household scouring powder will also work.

Safety Information

Installation Instructions

Operating Instructions

Troubleshooting Tips

Customer Service

Troubleshooting tips

Before you call for service...



Troubleshooting Tips

Save time and money! Review the chart on this page first and you may not need to call for service.

SAFETY NOTE: Before investigating, you must disconnect the power supply.

⚠ WARNING!

Before resetting, disconnect the power supply-please see SAFETY NOTE above. The overload control prevents the motor from operating should overloading occur. This feature protects your house wiring and your disposer. When overloaded, the motor will stop automatically.

Problem	Possible Causes	What To Do
Loud noises (other than those during grinding of bones and fruit pits)	Silverware, bottle cap or other foreign object has fallen into the disposer.	Remove the splash guard and remove the object with long-handled tongs. Replace the splash guard.
Disposer does not start	Reset button has been tripped.	With the splash guard removed, check to see if the turntable will move freely using a broom handle. If the turntable moves freely, replace the splash guard and check the reset button to see if it has been tripped. The reset button is red and located opposite the discharge elbow, near the bottom of the disposer. Push the button in until it clicks and remains depressed. If the reset button has not been tripped, check for a shorted or broken wire connecting to the disposer. Check the electrical power switch, fuse box or circuit breaker. If wiring and electrical components are intact, the unit may have internal problems that require service or replacement.
	Turntable cannot rotate.	If the turntable does not turn freely, check for an object lodged between the turntable and the grind ring. Dislodge the object by moving the turntable with a broom handle. Then remove the object. If no foreign object is present, there may be internal problems.
Disposer leaks	<p>If the leak is at the top, it may be caused by:</p> <ol style="list-style-type: none"> 1. Improper seating of sink flange (gasket choice, putty or tightening). 2. Support ring not tightened properly. 3. Defective cushion mount. <p>If the leak is at the discharge elbow, leak may be caused by improper tightening of elbow flange screws.</p>	

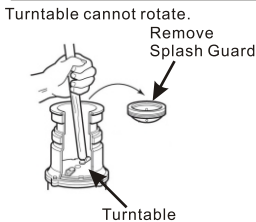
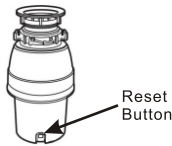

Safety Information

Installation Instructions

Operating Instructions

Troubleshooting Tips

Customer Service

Warranty & Service

Safety Information
Installation Instructions
Operating Instructions
Troubleshooting Tips
Customer Service

WARRANTY

Limited One Year Warranty-Parts and Labor(From the date of the original purchase)

The entire disposer if there is a defect in materials or workmanship relating to functional parts only (appearance parts are excluded). During this **limited one-year warranty**, **MIDEA** will also provide, **free of charge**, all labor charges related to replacing the original disposer along with the replacement disposer within the first year.

What is Not Covered By These Warranties

1. Service trips to your home to teach you how to use the product.
2. Improper installation or maintenance.
3. Failure of the product if it is abused, misused, or used for other than the intended purpose or used commercially.
4. Replacement of house fuses or resetting of circuit breakers.
5. Damage to the product caused by accident, fire, floods or acts of God.
6. Incidental or consequential damage caused by possible defects with this appliance.
7. Product not accessible to provide required service.
8. Warranties are void if the original serial numbers have been removed, altered or can't be readily determined.

EXCLUSION OF IMPLIED WARRANTIES Your sole and exclusive remedy is product repair as provided in the Limited Warranty. Any implied warranties, including the implied warranties of merchantability or fitness for a particular purpose, are limited to one year or the shortest period allowed by law.

The specific warranties expressed above are the **ONLY** warranties provided by the manufacturer. These warranties give you specific legal rights, and you also have the other rights by local government law.