

Cooker Hood

# USER MANUAL

90J05-ET23

Warning notices: Before using this product, please read this manual carefully and keep it for future reference. The design and specifications are subject to change without prior notice for product improvement. Consult with your dealer or manufacturer for details. The diagram above is just for reference. Please take the appearance of the actual product as the standard.

## THANK YOU LETTER

Thank you for choosing Midea! Before using your new Midea product, please read this manual thoroughly to ensure that you know how to operate the features and functions that your new appliance offers in a safe way.

# CONTENTS







THANK YOU LETTER .....	01
SAFETY INSTRUCTIONS .....	02
SPECIFICATIONS .....	04
PRODUCT OVERVIEW .....	05
PRODUCT INSTALLATION .....	06
OPERATION INSTRUCTIONS .....	09
CLEANING AND MAINTENANCE .....	10
TROUBLE SHOOTING .....	12
TRADEMARKS, COPYRIGHTS AND LEGAL STATEMENT	13
DISPOSAL AND RECYCLING .....	13
DATA PROTECTION NOTICE .....	14

# SAFETY INSTRUCTIONS

## Intended Use

The following safety guidelines are intended to prevent unforeseen risks or damage from unsafe or incorrect operation of the appliance. Please check the packaging and appliance on arrival to make sure everything is intact to ensure safe operation. If you find any damage, please contact the retailer or dealer. Please note modifications or alterations to the appliance are not allowed for your safety concern. Unintended use may cause hazards and loss of warranty claims.

## Explanation of Symbols

	<b>Danger</b> This symbol indicates that there are dangers to the life and health of persons due to extremely flammable gas.
	<b>Warning of electrical voltage</b> This symbol indicates that there is a danger to life and health of persons due to voltage.
	<b>Warning</b> The signal word indicates a hazard with a medium level of risk which, if not avoided, may result in death or serious injury.
	<b>Caution</b> The signal word indicates a hazard with a low degree of risk which, if not avoided, may result in minor or moderate injury.
	<b>Attention</b> The signal word indicates important information (e.g. damage to property), but not danger.
	<b>Observe instructions</b> This symbol indicates that a service technician should only operate and maintain this appliance in accordance with the operating instructions.

Read these operating instructions carefully and attentively before using/commissioning the unit and keep them in the immediate vicinity of the installation site or unit for later use!



## WARNING

- This appliance is not intended for use by persons (including children) with reduced physical, sensory or mental capabilities, or lack of experience and knowledge, unless they have been given supervision or instruction concerning use of the appliance by a person responsible for their safety. Children shall not play with the appliance.
- Cleaning and user maintenance shall not be made by children without supervision. If the supply cord is damaged, it must be replaced by the manufacturer, its service agent or similarly qualified persons in order to avoid a hazard. There shall be adequate ventilation of the room when the range hood is used at the same time as appliances burning gas or other fuels.
- Please do not use corrosive detergent for cleaning. The proper function of the unit is conditioned by the regularity of the maintenance.
- To protect the main body from corrosive of the long time accumulation of dirt, the cooker hood should be cleaned with hot water with non-corrosive detergent every two months.
- There is a fire risk if cleaning is not carried out in accordance with the instructions.
- Do not flame under the range hood.
- The air must not be discharged into a flue that is used for exhausting fumes from appliances burning gas or other fuels.
- The minimum distance between the supporting surface for the cooking vessels on the hob and the lowest part of the range hood. This distance shall be at least 65 cm. If the instructions for installation specify a smaller distance, this has to be taken into account. The distance of 65 cm can be reduced for: non-combustible parts of range hoods, except grease filters, and parts operating at safety extra low voltage, provided these parts do not give access to live parts if deformed.
- Regulations concerning the discharge of air have to be fulfilled.
- The appliance uses 6 hob elements at most.
- CAUTION :Accessible parts may become hot when used with cooking appliances.
- The first time connecting the supply power or re-up electricity , the hood have self-inspection function, the top glass plate will open and close one time, so minds your hand to be pinched, not to handle your hand near the panel!"
- Range hoods and other cooking fume extractors may adversely affect the safe operation of appliances burning gas or other fuels (including those in other rooms) due to back flow of combustion gases. These gases can potentially result in carbon monoxide poisoning. After installation of a range hood or other cooking fume extractor,the operation of open flued gas appliances should be tested by a competent person to ensure that back flow of combustion gases does not occur.

- The appliance is not intended for use by young children or infirm persons without supervisions.
- Young children should be supervised to ensure they do not play with the appliance.
- Plug the power cord to socket outlet with earthing continuity terminal.
- The cooker hood is for home use only, not suitable for barbecue, roast shop and other commercial purposes.
- The cooker hood and its filter should be cleaned regularly according to the instruction.
- Do not use open flame, or allow oil to go beneath the appliance.
- If there is any fault occurred with the appliance, please call after-sale service department.
- Please keep the kitchen room ventilated.
- Prior to any maintenance, cleaning operation, ensure the power is cut off.
- If the supply cord is damaged, it must be replaced by the manufacturer, service agent or similarly qualified person in order to avoid a hazard. The replaced power cord should be provided by manufacturer or seller.
- If the plug or cord is damaged, please call after-sale service center.
- There is a fire risk if cleaning is not carried out in accordance with the instruction.
- In case of damaged connecting wire, please refer to the manufacturer, after-sale service personnel or other qualified technicians.
- Use the unit according to the instructions to avoid any fire hazard.
- The exhaust air must not be introduced into a smoke flue or chimney that is used for exhausting fumes from appliances burning gas.
- Follow the local laws applicable for external air evacuation.
- As the upper panel is closing, don't put your hands between the upper panel and the body in case of clamp your hand.
- As steam generator is working, be careful of hot steam out of the body.

## SPECIFICATIONS

Product Model	90J05-ET23
Voltage	220V-240V-/50Hz
Rated Power	1600W
Lighting Power	4 W x 1
Motor Power	160 W
Diameter of air tube	Φ195mm/Φ190mm(inner diameter)
Noise	≤70 dB(A)

The air flow parameter is tested under conditions of 230V- /50Hz when the voltage is 220V-240V- /50Hz.

# PRODUCT OVERVIEW

## Components

Ref.	Qty.	Product Components
1	1	Range hood body
2	1	Exhaust pipe
3	1	Check valve
4	1	Check valve Sealing gasket
5	1	Installation plate
6	7	Expansion bolt
7	2	Screws (ST2.9x9.5)
8	4	Screws (ST4.2x16)
9	6	Screws (5x50)
10	1	Screws (M5x16)
11	1	Screws (ST5x45)
12	2	Screws (ST4.2x9.5)
13	2	Oil cup
14	1	Water cup
15	1	Water Pipe

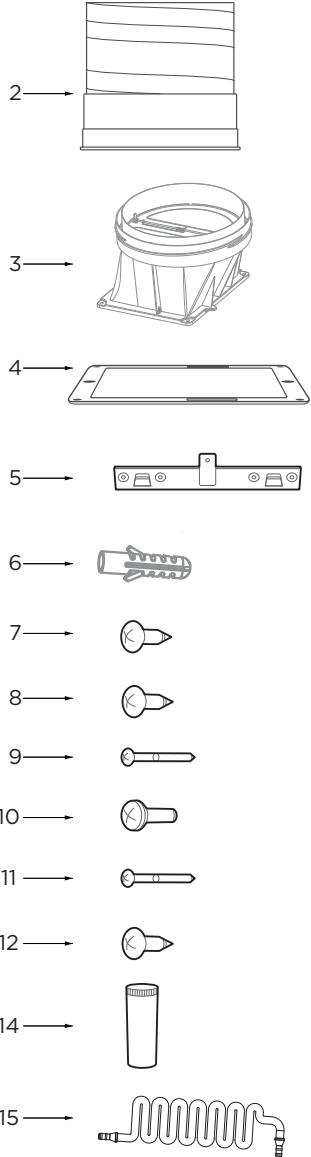
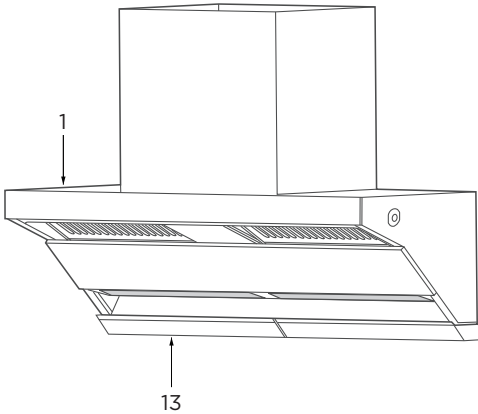

# PRODUCT INSTALLATION

## Determine location

- Range hood should be installed horizontally on the top of the stove, the installation diagram is as follows:

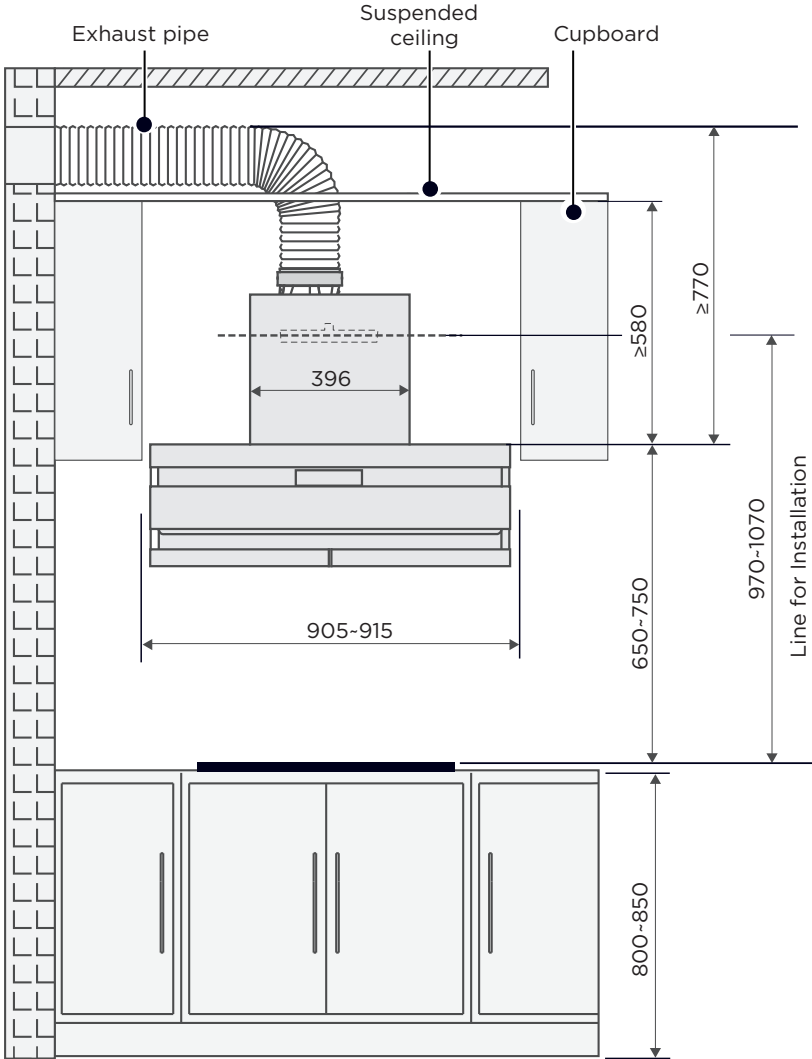

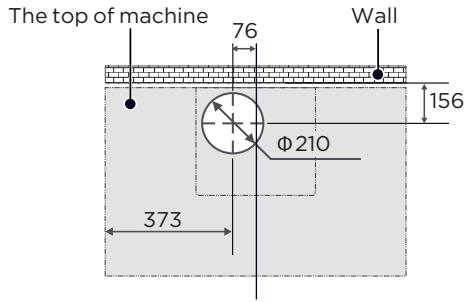
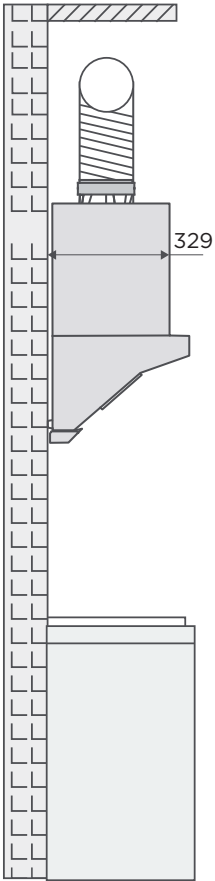

Schematic diagram of the hole size of the exhaust pipe at the ceiling

Note: This installation height is only applicable to electric stove, if installed above the gas stove, the installation height should be in accordance with the installation height requirements of gas stove.



## Installation plate

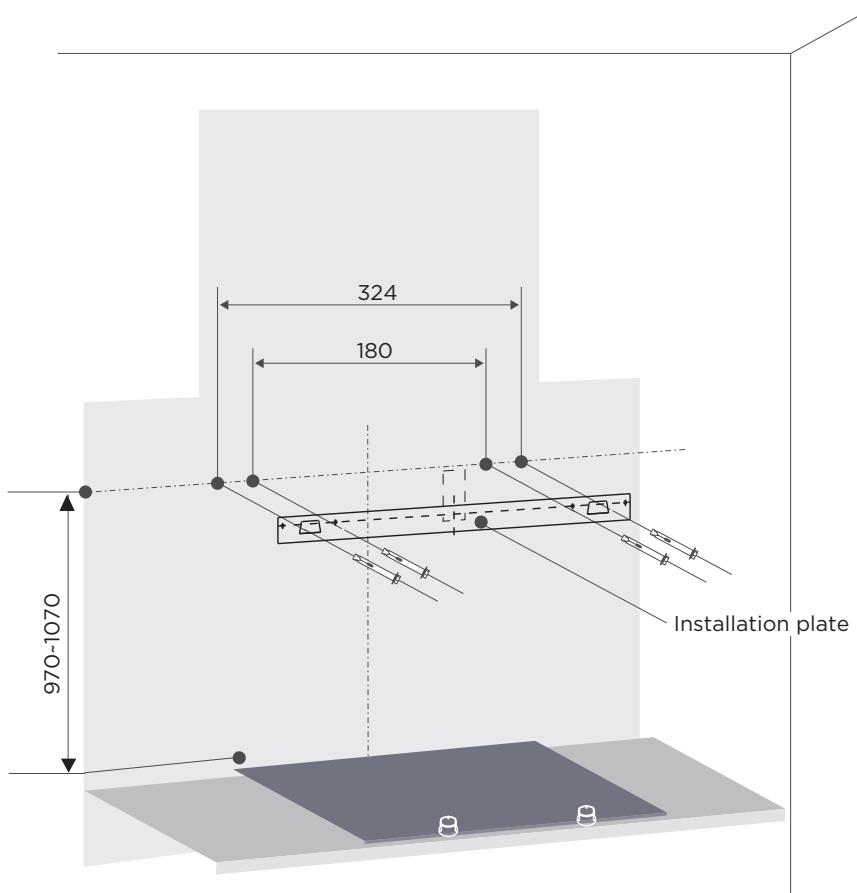

After hang the hood on the installation plate, fasten the screws M5X 16, avoid the hood slide off accidentally.

# OPERATION INSTRUCTIONS

## Range Hood Can Be Used After Power.



Gesture control left

Gesture control right

Short press: 0.5 second  
 Long press: 2-3 seconds

Button	Name	Function
	Light	Short press: Turn on the light; Long press: Adjust the light.
	Gesture	Short press: Open the gesture; Short press: Close the gesture.
	Steam washing	Long press: Start; Twice short press: Cancel the indicator
	Auto	Short press: the sensor can adjust suction level automatically depends on the fume heavily or slightly. The level is adjustable from 1-8 level.
	Speed	Short press: Adjust speed . (08 speed return to 03 speed after 2 min)
	Switch	1 <sup>st</sup> Short press: Startup (2 speed); 2 <sup>nd</sup> Short press: Delay 3 min; 3 <sup>rd</sup> Short press: OFF immediately.
		Palm from left to right or from right to left is to start the range hood.

# CLEANING AND MAINTENANCE

## Cleaning On The Surface

- The surface of the range hood and filter should be clean regularly, do not use clean balls, brushes, coarse cloth, so as not to scratch the surface of the machine.
- It's suggested that the oil cup should be cleaned every half a month to avoid any overwhelm oil drop from the full oil cup.
- Get the condensation plate clean every half a month - better to be cleaned no more than a month.

## Cleaning Mode (Cleaning the surface manually )

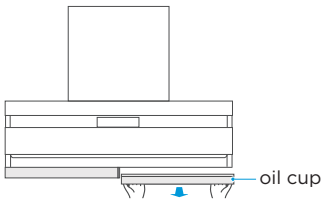

1. Draw out the oil cup with both hands horizontally and pour away the oil



2. Clean the oil cup and wipe it clean

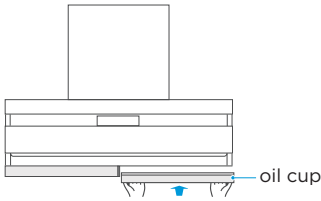

3. Return your hands horizontally to the oil cup

## Fiter Cleaning

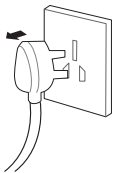

1. unplug the power

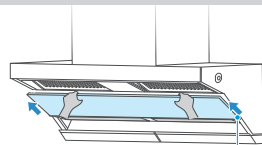

2. Open the condensation plate  
Pull out directly by holding it

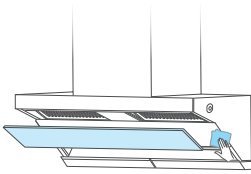

3. Clean the inside after the condensation plate is open



5. After cleaning, insert the power plug

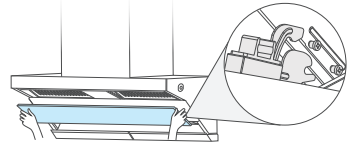

4. Close the condensation plate by holding the both sides and insert the clip to the screws Pull upward to fix

## LED Light Information

	Max Power	Voltage	Picture	Lamp Cap
Square/Diameter: 160x121mm	4W	DC 12V		--

## Steam Washing (Cleaning inner of the hood)

①



As the indicator light turns red and flashes, it is indicated that steam washing is required.

②

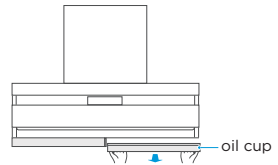

- Remove oil cup
- Dump accumulated oil
- Install oil cup

③



Cup filled with purified water or distilled water.

④

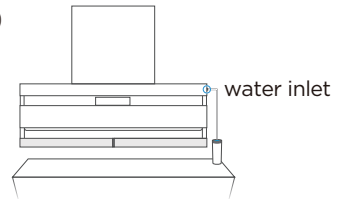

Plug the tube into the water inlet.

⑤



Press "Steam Washing" for 3 seconds to start the steam washing.

⑥



Steam washing: 12 min  
Drying: 3 min

⑦

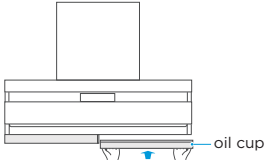

- Remove oil cup
- Dump accumulated oil
- Install oil cup

### Steam washing process

start → washing → drying → over

- Cancel the steam washing reminder (not washing): Long press 2 seconds + short press twice to fast forward to the end.
- Fast forward or end in advance (during washing) : Short press again to fast forward to the next step.



**During steam washing, do not touch the surface  
CAUTION of glass panels or deflector to avoid scalding.**

## TROUBLE SHOOTING

Fault	Solution
Both light and motor do not work	Unplug power plug and reconnect the power supply.
Oil leakage	Oil cup tilt, please reinstall.
	Oil cup full filled with oil, please dump the oil.
	Oil-way blockage caused by long time uncleaned internal oil-way, needs professionals to wash the hood.
Insufficient suction	Avoid opening window or door frequently.
	Adjust to max. speed.
Steam washing fault	Water cup lack of water, please fill with water.
	Filter cotton blockage, please change the filter cotton.

# TRADEMARKS, COPYRIGHTS AND LEGAL STATEMENT

 Midea logo, word marks, trade name, trade dress and all versions thereof are valuable assets of Midea Group and/or its affiliates (“Midea”), to which Midea owns trademarks, copyrights and other intellectual property rights, and all goodwill derived from using any part of an Midea trademark. Use of Midea trademark for commercial purposes without the prior written consent of Midea may constitute trademark infringement or unfair competition in violation of relevant laws.

This manual is created by Midea and Midea reserves all copyrights thereof. No entity or individual may use, duplicate, modify, distribute in whole or in part this manual, or bundle or sell with other products without the prior written consent of Midea.

All the described functions and instructions were up to date at the time of printing this manual. However, the actual product may vary due to improved functions and designs.

## DISPOSAL AND RECYCLING

### Important instructions for environment

Compliance with the WEEE Directive and Disposing of the Waster Product:  
This product complies with EU WEEE Directive (2012/19/EU). This product bears a classification symbol for waster electrical and electronic equipment (WEEE).

This symbol indicates that this product shall not be disposed with other household wastes at the end of its service life. Used device must be returned to official collection point for recycling of electrical electronic devices. To find these collection systems please contact to your local authorities or retailer where the product was purchased. Each household performs important role in recovering and recycling of old appliance. Appropriate disposal of used appliance helps prevent potential negative consequences for the environment and human health.

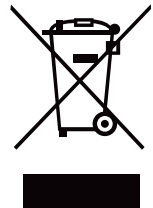

## Compliance with RoHS Directive

The product you have purchased complies with EU RoHS Directive (2011/65/EU). It does not contain harmful and prohibited materials specified in the Directive.

## Package information

Packaging materials of the product are manufactured from recyclable materials in accordance with our National Environment Regulations. Do not dispose of the packaging materials together with the domestic or other wastes. Take them to the packaging material collection points designated by the local authorities.



# DATA PROTECTION NOTICE

For the provision of the services agreed with the customer, we agree to comply without restriction with all stipulations of applicable data protection law, in line with agreed countries within which services to the customer will be delivered, as well as, where applicable, the EU General Data Protection Regulation (GDPR).

Generally, our data processing is to fulfil our obligation under contract with you and for product safety reasons, to safeguard your rights in connection with warranty and product registration questions. In some cases, but only if appropriate data protection is ensured, personal data might be transferred to recipients located outside of the European Economic Area.

Further information are provided on request. You can contact our Data Protection Officer via **MideaDPO@midea.com**. To exercise your rights such as right to object your personal data being processed for direct marketing purposes, please contact us via **MideaDPO@midea.com**. To find further information, please follow the QR Code.



*make yourself at home*



[www.midea.com](http://www.midea.com)

© Midea 2023 all rights reserved

16173000A22052

V1.0