

Sprockets

Taper | Throbbore | Plates | Weld Fit



SPROCKETS - Taper, Throbore, Plates, Weld Fit

ASA Plate Wheels	108
40-1 Plate Wheel	108
60-1 Plate Wheel	108
80-1 Plate Wheel	108
ASA Sprockets	109
25-1 Sprocket	109
35-1 Sprocket	110
40-1 Sprocket	111
60-1 Sprocket	112
80-1 Sprocket	113
100-1 Sprocket	114
120-1 Sprocket	114
BS Sprockets	115
05B Sprocket	115
06B-1-2 Sprocket	116
08B-1-2-3 Sprocket	117
10B-1-2-3 Sprocket	118
12B-1-2-3 Sprocket	119
16B-1-2-3 Sprocket	120
20B-1-2 Sprocket	121
24B-1-2 Sprocket	121
BS Taper Locks	122
06B-1-2 Taper Lock	122
08B-1-2 Taper Lock	123
10B-1-2 Taper Lock	124
12B-1-2-3 Taper Lock	125
16B-1-2-3 Taper Lock	126
20B-1 Taper Lock	127
24B-1 Taper Lock	127
Cast Iron Sprockets	128
Pilot Bore	128
Taper Lock	128
BS Plate Wheels	129
06A-1 Plate Wheel	129
08A-1 Plate Wheel	130
10A-1 Plate Wheel	131
12A-1 Plate Wheel	132
16A-1 Plate Wheel	133
24B-1 Plate Wheel	134
Weld Fit Welded Hubs & Sprockets	135
Welded Hubs	135
BS Plate Wheel Sprocket	136
ANSI Plate Wheel Sprocket	136

40-1 Plate Wheel

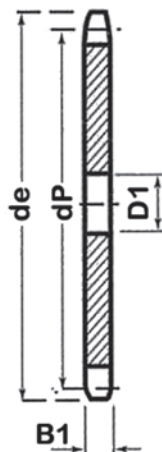
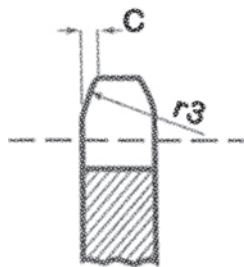

Pinions	mm
Tooth Radius r3	
Radius Width C	
Tooth Width B1	7.2
Chain	mm
Pitch	12.7
Inside	7.92
Roller ϕ	7.92

Teeth	de	dp	D1	App. Kg
15	67.2	61.09	10	0A
21	91.3	85.22	14	0A
42	176.6	169.95	16	1.13
48	200.8	194.18	20	1.46
50	208.9	202.26	20	1.70
55	229.1	222.46	20	2.08
60	249.3	242.66	20	2.13
65	269.5	262.86	20	2.25
70	289.7	283.07	25	3.28
72	297.8	291.16	25	3.51
76	313.9	307.33	25	3.70

60-1 Plate Wheel

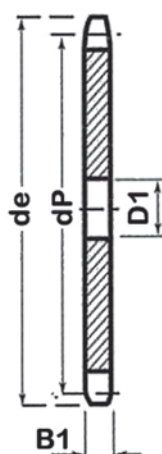
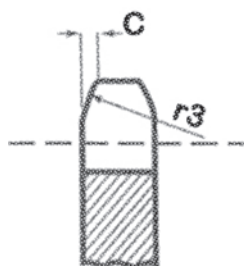

Pinions	mm
Tooth Radius r3	
Radius Width C	
Tooth Width B1	11.7
Chain	mm
Pitch	19.05
Inside	12.7
Roller ϕ	11.91

Teeth	de	dp	D1	App. Kg
42	265.2	254.93	25	4.53
48	301.5	291.27	25	5.75
50	313.6	303.39	25	6.45
55	343.9	333.70	25	7.82
60	374.2	363.99	25	9.19
65	404.5	394.29	30	10.65
70	434.9	424.60	30	12.45
72	447.0	436.74	30	13.22
76	471.2	460.99	30	14.78

80-1 Plate Wheel

Teeth	de	dp	D1	App. Kg
17	150	138.22	20	0A

"Why compete against your supplier when you can be our partner"

Finer Power Transmissions stocks a range of ASA high quality steel sprockets. Complete with induction hardened teeth, thus improving the sprockets resistance to wear and increasing the sprockets working life.

All Finer sprockets are engineered in accordance with the stringent ISO 9000 standards.

25-1 Sprocket		Teeth	de	dp	Simplex		
					dm	D1	A
		9	18.1	16.59	10	5	15
		10	22.3	20.55	11	5	15
		11	24.3	22.54	14	6	15
		12	26.4	24.33	16	6	15
		13	28.5	26.53	18	6	15
		14	30.5	28.53	20	6	15
		15	32.5	30.55	22	6	15
		16	34.5	32.55	24	8	15
		17	36.5	34.55	26	8	15
		18	38.5	36.56	28	8	15
		19	40.5	38.58	30	8	15
		20	42.5	40.58	32	8	15
		21	44.6	42.60	34	8	15
		22	46.6	44.62	36	8	15
		23	48.6	46.63	38	8	15
		24	50.6	48.64	40	8	15
		25	52.6	50.66	42	8	18
		26	54.6	52.67	44	10	18
		27	54.6	54.69	46	10	18
		28	58.7	56.71	48	10	18
		29	60.7	58.73	48	10	18
		30	62.7	60.75	48	12	18
		35	72.8	70.84	50	12	18
		38	78.8	76.89	50	12	18
		45	93.0	91.03	50	12	18
		50	104	102	50	12	20
		57	117.2	115.27	OA	OA	OA
		76	155.6	153.66	OA	OA	OA

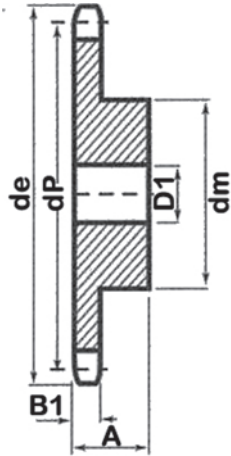
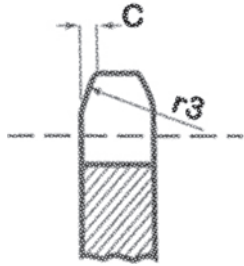

Pinions		mm
Tooth Radius r3		
Radius Width C		
Tooth Width B1	2.9	
Chain		mm
Pitch	6.35	
Inside	3.18	
Roller ø	3.3	

35-1 Sprocket

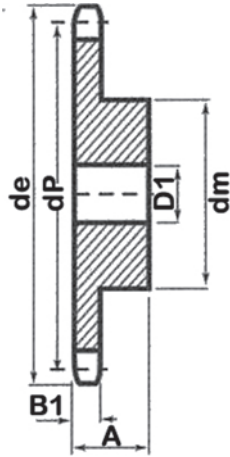
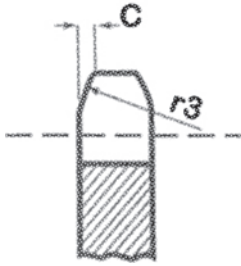

Pinions		mm
Tooth Radius r3		
Radius Width C		
Tooth Width B1	4.3	
Chain		mm
Pitch	9.525	
Inside	4.77	
Roller ϕ	5.08	

Teeth	de	dp	Simplex			
			dm	D1	A	App. Kg
9	28.6	24.89	15	8	20	0.04
10	31.5	27.85	18	8	20	0.06
11	34.5	20.82	20	8	20	0.09
12	40.5	36.8	25	8	25	0.10
13	43.5	39.80	28	8	25	0.11
14	46.5	42.80	31	8	25	0.12
15	49.5	45.81	34	8	25	0.14
16	52.5	48.82	37	10	28	0.18
17	55.5	51.83	40	10	28	0.20
18	58.6	54.85	43	10	28	0.23
19	61.6	57.87	45	10	28	0.25
20	64.6	60.89	46	10	28	0.31
21	67.6	63.91	48	12	28	0.36
22	70.6	66.93	50	12	28	0.37
23	73.7	69.95	52	12	28	0.39
24	76.7	72.97	54	12	28	0.40
25	79.7	76.00	57	12	28	0.41
26	82.7	79.02	60	12	28	0.42
27	85.7	82.04	60	12	28	0.44
28	88.8	85.07	60	12	28	0.45
29	91.8	88.09	60	12	28	0.47
30	94.8	91.12	60	12	28	0.48
38	119.0	115.34	70	16	30	0.77
40	125.1	121.40	70	16	30	0.81
57	177.5	172.91	OA	OA	OA	1.27
60	186.6	181.99	OA	OA	OA	1.34



"Why compete against your supplier when you can be our partner"

40-1 Sprocket		Teeth	de	dp	Simplex			
					dm	D1	A	App. Kg
		9	43.2	37.13	24	10	25	0.14
		10	47.2	41.10	26	10	25	0.15
		11	51.2	45.07	29	10	25	0.17
		12	55.2	49.07	33	10	28	0.24
		13	59.2	53.06	37	10	28	0.25
		14	63.2	57.07	41	10	28	0.31
		15	67.2	61.09	45	10	28	0.33
		16	71.2	65.10	50	12	28	0.37
		17	75.2	69.11	52	12	28	0.51
		18	79.2	73.14	56	12	28	0.54
		19	83.3	77.16	60	12	28	0.65
		20	87.3	81.19	64	12	28	0.76
		21	91.3	85.22	68	14	28	0.82
		22	95.4	89.24	70	14	28	0.88
		23	99.4	93.27	70	14	28	1.05
		24	103.4	97.29	70	14	28	1.07
		25	107.4	101.33	70	14	28	1.13
		26	111.5	105.36	70	16	30	1.15
		27	115.5	109.40	70	16	30	1.19
		28	119.5	113.42	70	16	30	1.30
		29	123.6	117.46	80	16	30	1.33
		30	127.6	121.50	80	16	30	1.36
		32	135.7	129.56	90	16	30	1.46
		35	147.8	141.68	90	16	30	1.61
		38	159.9	153.80	90	16	35	1.78
		40	168.0	161.87	90	16	35	1.88
		42	176.6	169.95	OA	OA	OA	1.97
		50	208.9	202.26	OA	OA	OA	3.00
		55	229.1	222.46	OA	OA	OA	3.14
		57	237.2	230.54	OA	OA	OA	3.28
		60	249.3	242.66	OA	OA	OA	3.45

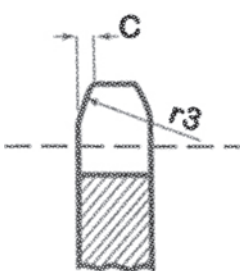

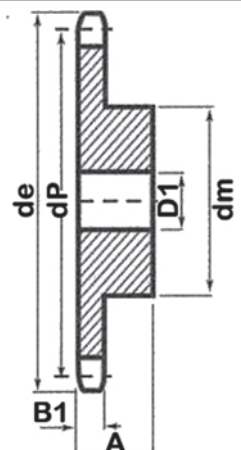

Pinions		mm
Tooth Radius r3		
Radius Width C		
Tooth Width B1	7.2	

Chain		mm
Pitch	12.7	
Inside	7.94	
Roller ø	7.94	

60-1 Sprocket

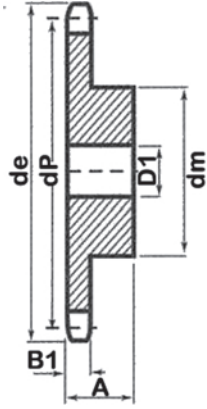
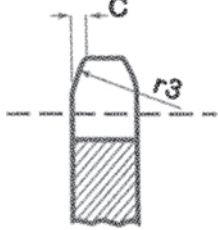

Pinions		mm
Tooth Radius r3		
Radius Width C		
Tooth Width B1		11.6
Chain		mm
Pitch		19.05
Inside		12.7
Roller ϕ		11.91

Teeth	de	dp	Simplex			App. Kg
			dm	D1	A	
9	64.0	55.70	37	12	30	0.35
10	70.0	61.64	42	12	30	0.41
11	76.0	67.61	46	16	35	0.53
12	81.9	73.6	52	16	35	0.67
13	87.9	79.59	58	16	35	0.75
14	94.0	85.61	64	16	35	0.91
15	100.0	91.63	70	16	35	1.14
16	106.0	97.65	75	16	35	1.27
17	112.0	103.67	80	16	35	1.46
18	118.0	109.71	80	16	35	1.69
19	124.1	115.75	80	16	35	1.78
20	130.1	121.78	80	16	35	2.10
21	136.2	127.82	90	20	40	2.27
22	142.2	133.86	90	20	40	2.38
23	148.2	139.90	90	20	40	2.49
24	154.3	145.94	90	20	40	2.62
25	160.3	152.00	90	20	40	2.78
26	166.4	158.04	95	20	40	2.89
27	172.4	164.09	95	20	40	3.05
28	178.5	170.13	95	20	40	3.12
29	184.5	176.19	95	20	40	3.30
30	190.6	182.25	95	20	40	3.44
32	202.7	194.35	95	20	40	3.75
34	214.8	206.46	95	OA	40	3.99
38	239.0	230.69	100	25	40	4.92
40	251.1	242.81	100	25	40	5.22

"Why compete against your supplier when you can be our partner"

80-1 Sprocket		Teeth	de	dp	Simplex			App. Kg
					dm	D1	A	
		8	77.0	66.37	42	16	35	0A
		9	85.8	72.47	50	16	35	0A
		10	93.8	82.19	55	16	35	0A
		11	101.7	90.14	61	16	40	1.45
		12	109.7	98.14	69	16	40	1.82
		13	117.7	106.12	78	16	40	1.92
		14	125.7	114.15	84	16	40	2.09
		15	133.7	122.17	92	16	40	2.59
		16	141.8	130.20	100	20	45	3.00
		17	149.8	138.22	100	20	45	3.18
		18	157.8	146.28	100	20	45	3.77
		19	165.9	154.33	100	20	45	3.86
		20	173.9	162.38	100	20	45	4.09
		21	182.0	170.43	110	20	50	4.54
		22	190.1	178.48	110	20	50	4.99
		23	198.1	186.53	110	20	50	5.08
		24	208	194.6	108	25	45	0A
		25	215	202.72	110	20	50	0A
		26	224	210.72	108	25	45	0A
		27	230	218.79	120	20	50	0A
		28	237	226.86	120	20	50	0A
		29	245	234	108	25	45	0A
		30	255	243	108	25	45	0A
		38	319.2	307.59	120	25	50	11.12

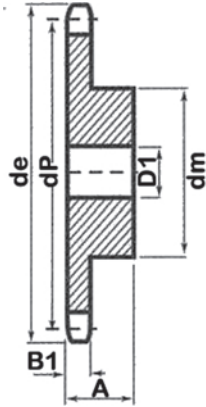
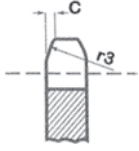

Pinions		mm
Tooth Radius r3		
Radius Width C		
Tooth Width B1	14.6	
Tooth Width b1		
Chain		mm
Pitch	25.4	
Inside	15.88	
Roller ø	15.88	



100-1 Sprocket		Teeth	de	dp	Simplex		
					dm	D1	A
9	108	92.84	63	20	40		
10	117.9	102.74	70	20	40		
11	127.8	112.68	77	20	45		
12	137.8	122.68	88	20	45		
13	147.8	132.65	98	20	45		
14	157.8	142.68	108	20	45		
15	167.9	152.72	118	20	45		
16	177.9	162.75	120	25	50		
17	187.9	172.78	120	25	50		
18	198	182.85	120	25	50		
19	208.1	192.91	120	25	50		
20	218.1	202.98	120	25	50		
21	228.2	213.04	140	25	55		
22	238.3	223.11	140	25	55		
23	248.3	233.17	140	25	55		
24	258.4	243.23	140	25	55		
25	268.5	253.33	140	25	55		
26	278.6	263.4	OA	OA	OA		
27	288.6	273.4	OA	OA	OA		
28	298.7	283.56	OA	OA	OA		
29	308.8	293.65	OA	OA	OA		
30	318.9	303.75	OA	OA	OA		
38	399.6	384.49	OA	OA	OA		

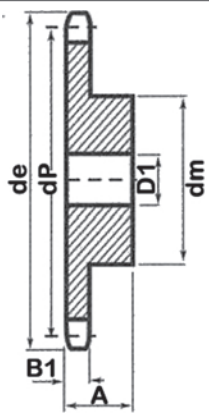
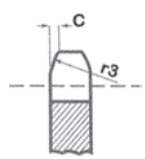

Pinions	mm
Tooth Radius r3	
Radius Width C	
Tooth Width B1	
Tooth Width b1	
Chain	mm
Pitch	
Inside	
Roller ø	

120-1 Sprocket		Teeth	de	dp	Simplex		
					dm	D1	A
9	130.88	111.4	70	20	45		
10	142.77	123.29	80	20	45		
11	154.71	135.21	90	25	50		
12	166.69	147.22	102	25	50		
13	178.68	159.18	114	25	50		
14	190.7	171.22	128	25	50		
15	202.73	183.26	140	25	50		
16	214.77	195.29	136	25	55		
17	226.83	207.35	140	25	55		
18	238.89	219.41	140	25	55		
19	245.5	231.49	140	25	55		
20	263.03	243.55	140	25	55		
21	270.5	255.65	OA	OA	OA		
22	287.2	267.77	OA	OA	OA		
23	294.5	279.8	OA	OA	OA		
24	307	291.88	OA	OA	OA		
25	323.47	303.99	150	30	60		
26	331	316.08	OA	OA	OA		
27	343	328.19	OA	OA	OA		
28	355	340.27	OA	OA	OA		
29	367.5	352.38	OA	OA	OA		
30	383.97	364.49	OA	OA	OA		
38	480.85	461.37	OA	OA	OA		

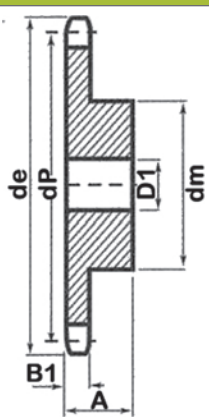
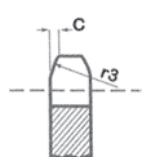

Pinions	mm
Tooth Radius r3	
Radius Width C	
Tooth Width B1	
Tooth Width b1	
Chain	mm
Pitch	
Inside	
Roller ø	

"Why compete against your supplier when you can be our partner"

Finer Power Transmissions stocks a range of British high quality steel sprockets. Complete with induction hardened teeth, thus improving the sprockets resistance to wear and increasing the sprockets working life.

All Finer sprockets are engineered in accordance with the stringent ISO 9000 standards.

05B Sprocket		Teeth	de	dp	Simplex		
					dm	D1	A
		9	25.09	23.99	15	6	12
		10	28.4	25.89	17	6	12
		11	31	28.39	18	7	13
		12	33.7	30.91	20	7	13
		13	36.7	33.42	23	7	13
		14	39.2	35.95	25	7	13
		15	41.7	48.48	28	7	13
		16	44.2	41.01	30	8	14
		17	46.7	43.53	30	8	14
		18	49.2	46.07	30	8	14
		19	51.7	48.61	30	8	14
		20	54.2	51.14	30	8	14
		21	57.2	53.67	35	8	14
		22	59.2	56.21	35	8	14
		23	62.2	58.75	35	8	14
		24	64.7	61.29	35	8	14
		25	67.2	63.83	35	8	14
		26	69.7	66.37	40	10	16
		27	72.3	68.91	40	10	16
		28	74.7	71.45	40	10	16
		29	77.3	73.99	40	10	16
		30	80.2	76.53	40	10	16
		32	85.2	81.61	40	12	16
		34	90.2	86.7	40	12	16
		36	95.2	91.79	40	12	16
		38	100.2	96.88	40	12	16
		40	105.2	102	40	12	16
		57	149.3	145.2	80	14	20

Pinions		mm
Tooth Radius r3		
Radius Width C		
Tooth Width B1	2.8	
Tooth Width b1		

Chain		mm
Pitch	8	
Inside	3	
Roller ϕ	5	



06B-1-2 Sprocket

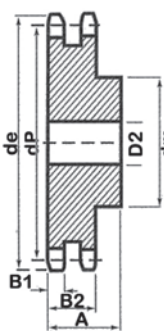
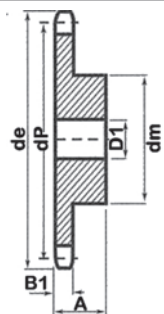
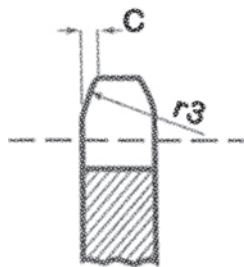

Pinions		mm
Tooth Radius r3		
Radius Width C		
Tooth Width B1		5.3
Tooth Width b1		
Tooth Width B2		15.4
Chain		mm
Pitch		9.53
Inside		5.72
Roller ϕ		6.35

Teeth	de	dp	Simplex				Duplex			
			dm	D1	A	App. Kg	dm	D2	A	App. Kg
8	28.6	24.89	15	8	20	0.03	-	-	-	-
9	31.5	27.85	18	8	20	0.04	18	8	25	0A
10	34.5	30.82	20	8	20	0.06	20	8	25	0.11
11	37.5	33.8	22	8	25	0.09	22	10	30	0.13
12	40.5	36.8	25	8	25	0.10	25	10	30	0.16
13	43.5	39.8	28	8	25	0.11	28	10	30	0.20
14	46.5	42.8	31	8	25	0.12	31	10	30	0.25
15	49.5	45.81	34	8	25	0.14	34	10	30	0.29
16	52.5	48.82	37	10	28	0.18	37	12	30	0.34
17	55.5	51.83	40	10	28	0.20	40	12	30	0.39
18	58.6	54.85	43	10	28	0.23	43	12	30	0.45
19	61.6	57.87	45	10	28	0.25	46	12	30	0.52
20	64.6	60.89	46	10	28	0.31	49	12	30	0.59
21	67.6	63.91	48	12	28	0.36	52	16	30	0.68
22	70.6	66.93	50	12	28	0.37	55	16	30	0.75
23	73.7	69.95	52	12	28	0.39	58	16	30	0.80
24	76.7	72.97	54	12	28	0.40	61	16	30	0.84
25	79.7	76	57	12	28	0.41	64	16	30	0.89
26	82.7	79.02	60	12	28	0.42	67	16	30	0.91
27	85.7	82.04	60	12	28	0.44	70	16	30	1.00
28	88.8	85.07	60	12	28	0.45	73	16	30	1.07
29	91.8	88.09	60	12	28	0.47	76	16	30	1.14
30	94.8	91.12	60	12	28	0.48	79	16	30	1.22
31	97.9	94.15	65	14	30	0.51	-	-	-	-
32	100.9	97.17	65	14	30	0.56	-	-	-	-
33	103.9	100.2	65	14	30	0.62	-	-	-	-
34	106.9	103.2	65	14	30	0.66	-	-	-	-
35	110	106.3	65	14	30	0.68	-	-	-	-
36	113	109.3	70	16	30	0.71	-	-	-	-
37	116	112.3	70	16	30	0.74	-	-	-	-
38	119	115.3	70	16	30	0.77	90	16	30	1.72
39	122.1	118.4	70	16	30	0.79	-	-	-	-
40	125.1	121.4	70	16	30	0.81	-	-	-	-
45	140.2	136.5	75	16	30	0.91	90	19	35	2.35
48	149.7	145.6	75	16	30		90	20	35	
57	176.6	172.9	75	19	30	1.27	90	20	35	3.47
76	234.2	230.5	75	19	30	1.91	90	20	38	5.67
95	291.8	288.1	75	19	30	2.61	95	25	38	8.64
114	349.4	345.7	75	19	30	3.63	95	25	38	11.12

"Why compete against your supplier when you can be our partner"

08B-1-2-3 Sprocket		Teeth	de	dp	Simplex				Duplex				Triplex				
					dm	D1	A	App. Kg	dm	D2	A	App. Kg	dm	D3	A	App. Kg	
		8	38	33.18	20	10	25	0.13	-	-	-	-	-	-	-	-	-
		9	42	37.13	24	10	25	0.14	24	10	32	0.18	-	-	-	-	-
		10	45.9	41.1	26	10	25	0.15	28	10	32	0.22	-	-	-	-	-
		11	49.9	45.07	29	10	25	0.17	32	12	35	0.24	-	-	-	-	-
		12	53.9	49.07	33	10	28	0.24	35	12	35	0.26	-	-	-	-	-
		13	57.9	53.06	37	10	28	0.25	38	12	35	0.28	38	16	50	0.59	-
		14	61.9	57.07	41	10	28	0.31	42	12	35	0.34	42	16	50	0.72	-
		15	65.9	61.09	45	10	28	0.33	46	12	35	0.36	46	16	50	0.81	-
		16	69.9	65.1	50	12	28	0.37	50	16	38	0.40	50	16	50	0.90	-
		17	74	69.11	52	12	28	0.51	54	16	38	0.44	54	16	50	1.04	-
		18	78	73.14	56	12	28	0.54	58	16	38	0.49	58	16	50	1.22	-
		19	82	77.16	60	12	28	0.65	62	16	38	0.57	62	16	50	1.41	-
		20	86	81.19	64	12	28	0.76	66	16	38	0.65	66	16	50	1.58	-
		21	90.1	85.22	68	14	28	0.82	70	16	40	0.72	70	16	55	1.81	-
		22	94.1	89.24	70	14	28	0.88	70	16	40	0.80	70	16	55	2.03	-
		23	98.1	93.27	70	14	28	1.05	70	16	40	0.83	70	16	55	2.27	-
		24	102.1	97.29	70	14	28	1.07	75	16	40	0.94	75	16	55	2.44	-
		25	106.2	101.3	70	14	28	1.13	80	16	40	0.98	80	16	55	2.54	-
		26	110.2	105.4	70	16	30	1.15	85	16	40	1.04	85	20	55	OA	-
		27	114.2	109.4	70	16	30	1.19	85	16	40	1.08	85	20	55	2.85	-
		28	118.3	113.4	70	16	30	1.30	90	16	40	1.10	90	20	55	3.16	-
		29	121	117.5	80	11	30	OA	95	20	40	OA	95	20	55	OA	-
		30	126.3	121.5	80	16	30	1.36	100	16	40	1.16	95	20	55	3.48	-
		31	130.4	125.5	90	16	30	1.41	100	120	40	OA	-	-	-	-	-
		32	134.4	129.6	90	16	30	1.46	100	20	40	1.24	-	-	-	-	-
		33	138.4	133.6	90	16	30	1.51	100	20	40	OA	-	-	-	-	-
		34	142.5	137.6	90	16	30	1.56	100	20	40	1.33	-	-	-	-	-
		35	146.5	141.7	90	16	30	1.61	100	20	40	OA	-	-	-	-	-
		36	150.6	145.7	90	16	35	1.69	100	20	40	2.05	-	-	-	-	-
		37	154.6	149.8	90	16	35	1.74	100	20	40	OA	-	-	-	-	-
		38	158.6	153.8	90	16	35	1.78	100	20	40	2.17	120	25	55	6.49	-
		39	162.7	157.8	90	16	35	1.83	100	20	40	OA	-	-	-	-	-
		40	166.7	161.9	90	16	35	1.88	100	20	40	2.28	-	-	-	-	-
		41	171	165.9	-	-	-	-	110	20	50	OA	-	-	-	-	-
		42	176.5	170	90	19	35	1.97	110	20	50	2.32	-	-	-	-	-
		43	179	174	-	-	-	-	110	20	50	OA	-	-	-	-	-
		44	185	178	-	-	-	-	110	20	50	OA	-	-	-	-	-
		45	188.6	182.1	90	19	35	2.11	110	20	50	2.49	-	-	-	-	-
		46	193	186.1	-	-	-	-	110	20	50	OA	-	-	-	-	-
		48	200.7	194.2	100	19	35	2.76	110	20	45	2.65	-	-	-	-	-
		50	208.8	202.3	88	20	42	2.90	-	-	-	-	-	-	-	-	-
		55	229	222.5	88	20	42	3.15	-	-	-	-	-	-	-	-	-
		57	233.1	230.5	100	19	35	3.28	110	25	45	3.88	120	25	60	12.62	-
		60	249.2	242.7	100	19	35	3.45	-	-	-	-	-	-	-	-	-
		76	313.9	307.3	100	19	35	5.73	120	30	45	6.60	130	30	65	22.23	-
		95	390.7	384.1	100	25	35	8.90	120	30	45	9.89	-	-	-	-	-
		114	467.4	460.9	100	25	35	11.17	120	30	45	12.88	-	-	-	-	-

Finer Power Transmissions P/L will not accept liability for any damage or loss caused as a result of the data in this catalogue.

10B-1-2-3 Sprocket

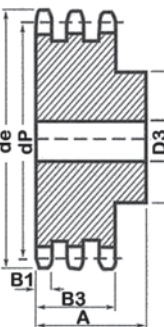
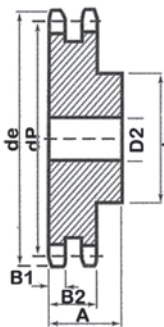
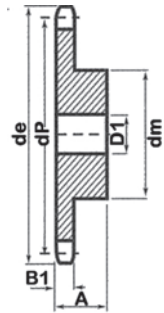
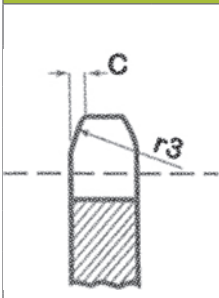

Pinions		mm
Tooth Radius r3		
Radius Width C		
Tooth Width B1	9.1	
Tooth Width b1		
Tooth Width B2	25.5	
Tooth Width B3		
Chain		mm
Pitch	5.88	
Inside	9.65	
Roller ø	10.2	

Teeth	de	dp	Simplex				Duplex				Triplex				
			dm	D1	A	App. Kg	dm	D2	A	App. Kg	dm	D3	A	App. Kg	
8	48.4	41.48	25	10	25	0.09	-	-	-	-	-	-	-	-	-
9	53.3	46.42	30	10	25	0.14	30	12	40	0.31	-	-	-	-	-
10	58.3	51.37	35	10	25	0.23	35	12	40	0.39	-	-	-	-	-
11	63.2	56.35	37	12	30	0.27	39	16	40	0.44	-	-	-	-	-
12	68.2	61.34	42	12	30	0.32	44	16	40	0.57	-	-	-	-	-
13	73.2	66.32	47	12	30	0.36	49	16	40	0.71	-	-	-	-	-
14	78.2	71.34	52	12	30	0.45	54	16	40	0.84	54	16	55	OA	
15	83.2	76.36	57	12	30	0.59	59	16	40	1.01	-	-	-	-	-
16	88.3	81.37	60	12	30	0.68	64	16	45	1.19	-	-	-	-	-
17	93.3	86.39	60	12	30	0.82	69	16	45	1.38	-	-	-	-	-
18	98.3	91.42	70	14	30	0.91	74	16	45	1.62	74	16	60	OA	
19	103.3	96.45	70	14	30	1.04	79	16	45	1.77	79	16	60	OA	
20	108.4	101.5	75	14	30	1.13	84	16	45	1.93	-	-	-	-	-
21	113.4	106.5	75	16	30	1.18	85	20	45	2.22	85	20	60	OA	
22	118.4	111.6	80	16	30	1.27	90	20	45	2.53	90	20	60	OA	
23	123.5	116.6	80	16	30	1.45	95	20	45	2.77	-	-	-	-	-
24	128.5	121.6	80	16	30	1.50	100	20	45	2.95	-	-	-	-	-
25	133.6	126.7	80	16	30	1.59	105	20	45	3.15	-	-	-	-	-
26	138.6	131.7	85	20	35	1.63	110	20	45	3.42	-	-	-	-	-
27	143.6	136.8	85	20	35	1.68	110	20	45	3.98	-	-	-	-	-
28	148.7	141.8	90	20	35	1.72	115	20	45	4.2	-	-	-	-	-
29	153.7	146.8	90	20	35	1.91	115	20	45	4.43	-	-	-	-	-
30	158.8	151.9	90	20	35	2.04	120	20	45	4.66	-	-	-	-	-
31	163.8	156.9	95	20	35	2.13	-	-	-	-	-	-	-	-	-
32	168.9	162	95	20	35	2.27	-	-	-	-	-	-	-	-	-
33	173.9	167	95	20	35	2.33	-	-	-	-	-	-	-	-	-
34	178.9	172.1	95	20	35	2.36	-	-	-	-	-	-	-	-	-
35	184	177.1	95	20	35	2.48	-	-	-	-	-	-	-	-	-
36	189	182.2	100	20	35	2.56	-	-	-	-	-	-	-	-	-
37	194.1	187.2	100	20	35	2.68	-	-	-	-	-	-	-	-	-
38	199.1	192.2	100	20	35	2.72	120	20	45	7.67	120	25	60	OA	
39	204.2	197.3	100	20	35	2.86	-	-	-	-	-	-	-	-	-
40	209.2	202.3	100	20	35	2.95	120	20	45	7.92	-	-	-	-	-
42	220.8	212.4	108	20	43	3.01	-	-	-	-	-	-	-	-	-
45	236	227.6	108	20	43	3.73	OA	OA	OA	9.21	-	-	-	-	-
48	251.1	242.7	108	20	43	4.18	-	-	-	-	-	-	-	-	-
50	261.2	252.8	108	20	43	4.40	-	-	-	-	-	-	-	-	-
55	286.5	278.1	108	20	43	4.96	-	-	-	-	-	-	-	-	-
57	296.6	288.2	108	20	43	5.27	100	30	56	15.07	-	-	-	-	-
60	311.7	303.3	108	20	43	5.9	-	-	-	-	-	-	-	-	-
76	392.5	384.2	90	24	50	11.03	100	30	63	26.31	-	-	-	-	-
95	488.5	480.1	100	24	56	14.57	110	30	63	32.69	-	-	-	-	-
114	584.5	576.1	100	25	56	20.61	125	30	70	49.3	-	-	-	-	-

"Why compete against your supplier when you can be our partner"

12B-1-2-3 Sprocket

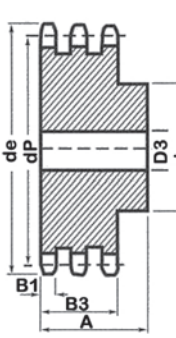
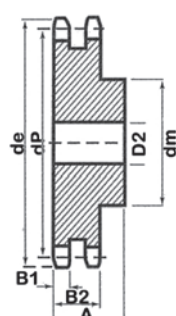
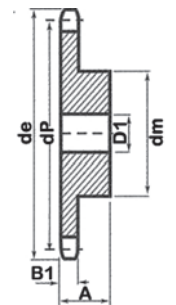
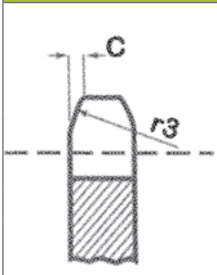

Pinions	mm
Tooth Radius r3	
Radius Width C	
Tooth Width B1	11.1
Tooth Width b1	
Tooth Width B2	30.3
Tooth Width B3	49.8
Chain	mm
Pitch	19.05
Inside	11.68
Roller ϕ	12.07

Teeth	de	dp	Simplex				Duplex				Triplex				
			dm	D1	A	App. Kg	dm	D2	A	App. Kg	dm	D3	A	App. Kg	
8	58	49.78	31	12	30	0A	-	-	-	-	-	-	-	-	-
9	63.9	55.7	37	12	30	0A	37	16	45	0.75	-	-	-	-	-
10	69.8	61.64	42	12	30	0A	42	16	45	0.90	-	-	-	-	-
11	75.8	67.61	46	16	35	0.53	47	16	50	1.00	47	20	70	0A	-
12	81.8	73.6	52	16	35	0.67	53	16	50	1.23	-	-	-	-	-
13	87.8	79.59	58	16	35	0.75	59	16	50	1.41	59	20	70	1.77	-
14	93.8	85.61	64	16	35	0.91	65	20	50	1.68	-	-	-	-	-
15	99.8	91.63	70	16	35	1.14	71	20	50	1.95	71	20	70	2.45	-
16	105.8	97.65	75	16	35	1.27	77	20	50	2.27	77	20	70	0A	-
17	111.9	103.7	80	16	35	1.46	83	20	50	2.63	83	20	70	3.49	-
18	117.9	109.7	80	16	35	1.69	89	20	50	3.18	89	20	70	0A	-
19	123.9	115.8	80	16	35	1.78	95	20	50	3.50	95	20	70	4.54	-
20	130	121.8	80	16	35	2.10	100	20	50	3.72	100	20	70	0A	-
21	136	127.8	90	20	40	2.27	100	20	50	4.31	100	25	70	5.67	-
22	142	133.9	90	20	40	2.38	100	20	50	4.77	100	20	70	0A	-
23	148.1	139.9	90	20	40	2.49	110	20	50	4.99	110	25	70	6.62	-
24	154.1	145.9	90	20	40	2.62	110	20	50	5.45	110	20	70	0A	-
25	160.2	152	90	20	40	2.78	120	20	50	5.67	120	25	70	7.71	-
26	166.2	158	95	20	40	2.89	120	20	50	6.13	-	-	-	-	-
27	172.3	164.1	95	20	40	3.05	120	20	50	6.49	120	25	70	8.99	-
28	178.3	170.1	95	20	40	3.12	120	20	50	6.81	-	-	-	-	-
29	184.4	176.2	95	20	40	3.30	120	20	50	7.13	-	-	-	-	-
30	190.4	182.3	95	20	40	3.44	120	20	50	7.49	120	25	70	10.53	-
31	196.5	188.3	95	20	40	3.50	-	-	-	-	-	-	-	-	-
32	202.5	194.4	95	20	40	3.75	-	-	-	-	-	-	-	-	-
33	208.6	200.4	95	20	40	3.82	-	-	-	-	-	-	-	-	-
34	214.6	206.5	95	20	40	3.99	-	-	-	-	-	-	-	-	-
35	220.7	212.5	95	20	40	4.10	120	20	50	10.18	-	-	-	-	-
36	226.8	218.6	100	25	40	4.35	120	25	50	12.31	-	-	-	-	-
37	232.8	224.6	100	25	40	4.64	-	-	-	-	-	-	-	-	-
38	238.9	230.1	100	25	40	4.92	120	25	50	12.99	130	25	70	20.57	-
39	244.9	236.8	100	25	40	5.15	-	-	-	-	-	-	-	-	-
40	251	242.8	100	25	40	5.22	-	-	-	-	-	-	-	-	-
41	258	248.86	100	25	40	0A	-	-	-	-	-	-	-	-	-
42	265	254.9	118	25	60	5.78	-	-	-	-	-	-	-	-	-
43	272	260.98	100	25	40	0A	-	-	-	-	-	-	-	-	-
44	276	267.03	100	25	40	0A	-	-	-	-	-	-	-	-	-
45	283.2	273.1	100	25	56	6.34	136	25	62	15.38	-	-	-	-	-
48	301.4	291.3	118	25	60	7.18	-	-	-	-	-	-	-	-	-
50	313.5	303.4	118	25	60	8.01	-	-	-	-	-	-	-	-	-
55	343.8	333.7	118	25	60	9.90	-	-	-	-	-	-	-	-	-
57	355.9	345.8	100	30	56	10.10	120	30	63	25.34	140	40	70	33.73	-
60	374.1	364	118	25	60	11.44	-	-	-	-	-	-	-	-	-
76	471.1	461	100	30	56	17.26	135	30	63	25.63	160	40	75	37.19	-
95	586.2	576.2	100	30	65	23.83	135	30	70	39.24	-	-	-	-	-
114	700.9	691.36	100	30	65	0A	135	30	70	-	-	-	-	-	-

16B-1-2-3 Sprocket

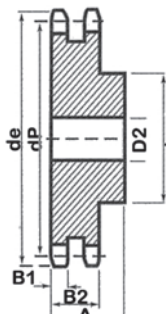
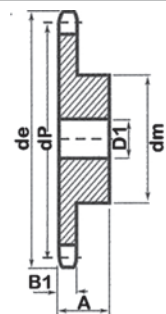
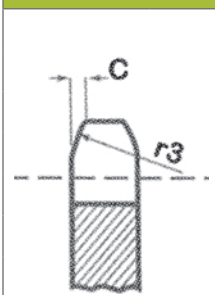

Pinions	mm
Tooth Radius r3	
Radius Width C	
Tooth Width B1	16.2
Tooth Width b1	
Tooth Width B2	47.7
Tooth Width B3	79.6
Chain	mm
Pitch	25.4
Inside	17
Roller ϕ	15.88

Teeth	de	dp	Simplex				Duplex				Triplex					
			dm	D1	A	App. Kg	dm	D2	A	App. Kg	dm	D3	A	App. Kg		
8	77.9	66.37	42	16	35	0.95	-	-	-	-	-	-	-	-	-	-
9	85.8	74.27	50	16	35	1.20	50	20	65	0A	-	-	-	-	-	-
10	93.8	82.19	55	16	35	1.35	56	20	65	0A	56	20	95	-	-	-
11	101.7	90.14	61	16	40	1.45	64	20	70	1.82	-	-	-	-	-	-
12	109.7	98.14	69	16	40	1.82	72	20	70	2.36	-	-	-	-	-	-
13	117.7	106.1	78	16	40	1.94	80	20	70	1.95	80	25	100	4.13	-	-
14	125.7	114.2	84	16	40	2.09	88	20	70	3.5	-	-	-	-	-	-
15	133.7	122.2	92	16	40	2.59	96	20	70	4.18	96	25	100	5.54	-	-
16	141.8	130.2	100	20	45	3.00	104	25	70	5.22	-	-	-	-	-	-
17	149.8	138.2	100	20	45	3.18	112	25	70	5.99	112	25	100	8.07	-	-
18	157.8	146.3	100	20	45	3.77	120	25	70	6.81	-	-	-	-	-	-
19	165.9	154.4	100	20	45	3.86	128	25	70	7.71	128	25	100	10.89	-	-
20	173.9	162.4	100	20	45	4.09	130	25	70	8.26	-	-	-	-	-	-
21	182	170.4	110	20	50	4.54	130	25	70	8.85	130	25	100	13.61	-	-
22	190.1	178.5	110	20	50	5.00	130	25	70	9.53	-	-	-	-	-	-
23	198.1	186.5	110	20	50	5.08	130	25	70	10.43	130	25	100	14.97	-	-
24	206.2	194.6	110	20	50	5.54	130	25	70	11.44	-	-	-	-	-	-
25	214.2	202.7	110	20	50	5.76	130	25	70	12.47	130	25	100	17.70	-	-
26	222.3	210.7	120	20	50	7.03	130	25	70	13.62	-	-	-	-	-	-
27	230.4	218.8	120	20	50	7.53	130	25	70	14.75	130	30	100	21.57	-	-
28	238.4	226.9	120	20	50	7.58	130	25	70	15.89	-	-	-	-	-	-
29	246.5	234.9	120	20	50	7.94	130	25	70	17.02	-	-	-	-	-	-
30	254.6	243	120	20	50	8.26	130	25	70	18.16	130	30	100	26.33	-	-
31	262.6	251.1	120	25	50	8.62	-	-	-	-	-	-	-	-	-	-
32	270.7	259.1	120	25	50	8.98	-	-	-	-	-	-	-	-	-	-
33	278.8	267.2	120	25	50	9.33	-	-	-	-	-	-	-	-	-	-
34	286.9	275.3	120	25	50	9.69	-	-	-	-	-	-	-	-	-	-
35	294.9	283.4	120	25	50	10.05	-	-	-	-	-	-	-	-	-	-
36	303	291.4	120	25	50	10.41	-	-	-	-	-	-	-	-	-	-
37	311.1	299.5	120	25	50	10.78	-	-	-	-	-	-	-	-	-	-
38	319.2	307.6	120	25	50	11.12	140	25	70	29.60	140	30	100	41.45	-	-
39	327.2	315.7	120	25	50	11.48	-	-	-	-	-	-	-	-	-	-
40	335.3	323.4	120	25	50	11.83	-	-	-	-	-	-	-	-	-	-
45	377.9	364.1	125	30	70	13.62	150	40	75	34.35	160	45	100	45.00	-	-
57	474.9	461.1	125	30	70	22.16	170	40	90	38.18	165	45	100	51.35	-	-
76	628.4	614.7	140	35	80	39.24	175	40	95	68.11	200	45	110	77.11	-	-
95	782	768.2	140	40	80	57.12	-	-	-	-	-	-	-	-	-	-
114	935.6	921.8	140	30	80	75.00	-	-	-	-	-	-	-	-	-	-

"Why compete against your supplier when you can be our partner"

20B-1-2 Sprocket		Teeth	de	dp	Simplex			Duplex				
					dm	D1	A	App. Kg	dm	D2	A	App. Kg
		9	106.5	92.84	63	20	40	1.45	-	-	-	-
		10	117	102.7	70	20	40	1.86	-	-	-	-
		11	127	112.7	77	20	45	2.40	80	25	80	3.67
		12	137	122.7	88	20	45	2.95	90	25	80	OA
		13	147.5	132.7	98	20	45	3.00	100	25	80	5.53
		14	157.6	142.7	108	20	45	3.40	110	25	80	6.62
		15	167.6	152.7	118	20	45	4.31	120	25	80	7.76
		16	177.7	162.8	120	25	50	4.63	120	30	80	OA
		17	187.8	172.8	120	25	50	4.99	120	30	80	10.44
		18	197.8	182.9	120	25	50	5.44	120	30	80	OA
		19	207.9	192.9	120	25	50	5.9	120	30	80	12.92
		20	217.9	203	120	25	50	6.35	120	30	80	OA
		21	228	213	140	30	55	7.03	140	30	80	16.55
		22	238.1	223.1	140	30	55	7.71	140	30	80	OA
		23	248.2	233.2	140	30	55	8.16	140	30	80	19.05
		24	258.3	243.2	140	30	55	8.62	140	30	80	OA
		25	268.4	253.3	140	30	55	9.07	140	30	80	21.77
		26	278.4	263.4	150	30	55	9.53	150	30	80	OA
		27	288.5	273.5	150	30	55	10.43	150	30	80	24.97
		28	299	283.6	150	30	55	11.34	150	30	80	OA
		29	308.8	293.6	150	30	55	OA	150	30	80	OA
		30	319	303.8	150	30	55	12.02	150	30	80	OA

24B-1-2 Sprocket		Teeth	de	dp	Simplex			Duplex				
					dm	D1	A	App. Kg	dm	D2	A	App. Kg
		9	125	111.4	70	25	95	2.02	-	-	-	-
		10	137	123.3	80	25	95	2.61	-	-	-	-
		11	149	135.2	90	25	100	3.77	90	25	100	6.50
		12	161	147.2	102	25	100	4.77	102	25	100	OA
		13	137	159.2	114	25	100	5.91	114	25	100	9.92
		14	185	171.2	128	25	100	6.68	128	25	100	11.98
		15	197	183.3	132	25	100	7.49	132	25	100	14.13
		16	209	195.3	136	30	100	9.08	136	30	100	16.35
		17	221	207.3	136	30	100	9.76	136	30	100	17.85
		18	233	219.4	160	30	100	10.49	160	30	100	20.35
		19	245.5	231.5	160	30	100	11.21	160	30	100	22.56
		20	257.5	243.6	160	30	100	12.26	160	30	100	24.78
		21	270.5	255.7	160	30	100	13.38	160	30	100	26.99
		22	282.5	267.7	160	30	100	13.67	160	30	100	29.74
		23	294.5	279.8	160	30	100	14.74	160	30	100	OA
		24	307	292	160	30	100	OA	160	30	100	OA
		25	319	304	160	30	100	16.38	160	30	100	OA
		26	331	317	160	30	100	OA	160	30	100	OA
		27	343	328	160	30	100	OA	160	30	100	OA
		28	355	340	160	30	100	OA	160	30	100	OA
		29	367	352	160	30	100	OA	160	30	100	OA
		30	379	365	160	30	100	OA	160	30	100	OA

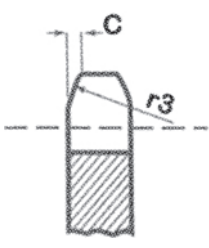
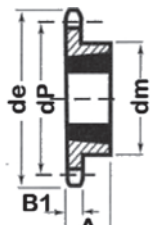
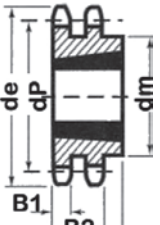
06B-1-2 Taper Lock		Teeth	de	dp	Simplex					Duplex				
					dm	A	Bush	Type	App. Kg	dm	A	Bush	Type	App. Kg
	 <p>Type 1</p>	17	55.5	51.83	45	22.23	1008	1	0.14	41	22	1008	2	0.5
		18	58.6	54.85	45	22.23	1008	1	0.18	43	22	1008	2	0A
		19	61.6	57.87	45	22.23	1008	1	0.23	46	22	1008	2	0.6
		20	64.6	60.89	45	22.23	1008	1	0.27	48	22	1008	2	0A
		21	67.6	63.91	45	22.23	1008	1	0.32	49	22	1008	2	1.4
		22	70.6	66.93	45	22.23	1108	1	0.36	52	22	1008	2	0A
		23	73.7	69.95	63	25.40	1210	1	0.41	59	25	1210	2	1.8
		24	76.7	72.97	63	25.40	1210	1	0.45	61	25	1210	2	0A
		25	79.7	76	63	25.40	1210	1	0.54	64	25	1210	2	1.9
		26	83.0	79.02	63	25.40	1210	1	0.53	64	25	1210	2	1.95
 <p>Type 2</p>	27	85.7	82.04	63	25.40	1210	1	0.52	70	25	1210	2	2.0	
	28	89	85.07	63	25.4	1210	1	0.53	70	25	1210	2	0A	
	29	92	88.09	63	25.4	1210	1	0.53	70	25	1210	2	0A	
	30	94.8	91.12	63	25.40	1210	1	0.54	75	25	1210	2	2.1	
	36	113.4	109.3	-	-	-	-	-	75	25	1210	2	0A	
	38	119	115.3	70	25.40	1210	1	0.68	80	25	1610	2	2.5	
	45	118.6	114.7	70	25.40	1210	1	0.95	-	-	-	-	-	
	57	149.3	145.2	83	25.40	1210	1	1.25	80	25	1610	2	4.1	
	76	197.9	193.6	83	25.40	1210	1	1.82	80	25	1615	2	6.8	
	95	246.3	242	83	25.40	1210	1	2.28	90	25	1615	2	6.9	
	114	294.8	290.3	83	38	1215	1	0A	-	-	-	-	-	
Pinions	mm													
Tooth Radius r3														
Radius Width C														
Tooth Width B1	5.3													
Chain	mm													
Pitch	9.53													
Inside	5.72													
Roller ø	6.35													



"Why compete against your supplier when you can be our partner"

08B-1-2 Taper Lock		Teeth	de	dp	Simplex				Duplex				
					dm	A	Bush	Type	App. Kg	dm	A	Bush	Type
14	61.9	57.07	45	22.23	1008	1	0.18	-	-	-	-	-	
15	65.9	61.09	45	22.23	1008	1	0.18	46	22.23	1008	2	0.18	
16	69.9	65.1	45	22.23	1008/1108	1	0.23	50	22	1008	2	0A	
17	74	69.11	60	25.40	1108/1210	1	0.23	56	25.40	1210	2	0.27	
18	78	73.14	62	25.40	1210	1	0.27	60	25	1210	2	0A	
19	82	77.16	63	25.40	1210	1	0.32	62	25.40	1210	2	0.36	
20	86	81.19	71	25.40	1210/1610	1	0.41	66	25	1610	2	0A	
21	90.1	85.22	71	25.40	1610	1	0.45	70	25.40	1610	2	0.46	
22	94.1	89.24	71	25.40	1610	1	0.50	76	25	1610	2	0A	
23	98.1	93.27	76	25.40	1610	1	0.59	79	25.40	1610	2	0.59	
24	102.1	97.29	76	25.40	1610	1	0.73	84	25	2012	2	0A	
25	106.2	101.3	76	25.40	1610	1	0.74	87	31.75	2012	2	0.77	
26	110.2	105.4	76	25.40	1610	1	0.76	87	32	2012	2	0A	
27	114.2	109.4	76	25.40	1610	1	0.78	87	31.75	2012	2	0.95	
28	118.3	113.4	76	25.40	2012	1	0.80	87	32	2012	2	0A	
29	112.3	117.5	76	25.40	2012	1	0.81	87	32	2012	2	0A	
30	126.3	121.5	90	31.75	2012	1	0.82	87	32	2012	2	1.59	
32	134.4	129.6	90	31.75	2012	1	0.87	-	-	-	-	-	
35	146.5	141.7	9.0	31.5	2012	1	0.95	-	-	-	-	-	
37	151.0	145.7	-	-	-	-	-	87	32	2012	2	2.85	
38	158.6	153.8	90	31.75	2012	1	1.23	100	32	2012	2	3.18	
45	188.6	182.1	100	31.75	2012	1	1.46	100	32	2012	2	3.95	
48	200.7	194.2	100	31.75	2012	1	1.55	-	-	-	-	-	
50	208.8	202.3	110	31.75	2012	1	0A	-	-	-	-	-	
57	233.1	230.5	110	31.75	2012	1	2.60	110	31.75	2012	2	7.56	
76	313.9	307.3	110	31.75	2012	1	4.27	110	31.75	2012	2	15.26	
95	390.7	384.1	110	31.75	2012	1	6.88	110	31.75	2012	2	19.08	
114	467.4	460.9	110	44.45	2012/2517	1	10.44	110	31.75	2517	2	22.90	

Pinions	mm
Tooth Radius r3	
Radius Width C	
Tooth Width B1	7.2
Chain	mm
Pitch	12.7
Inside	7.75
Roller ϕ	8.51

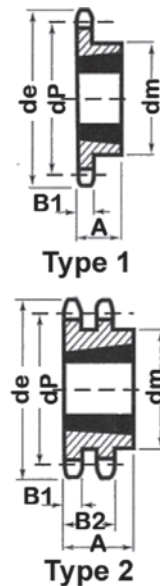

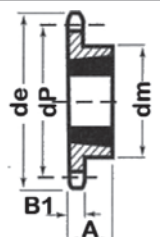
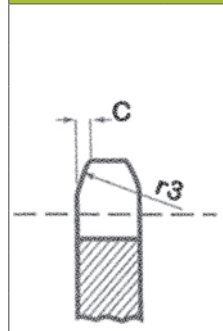

10B-1-2 Taper Lock		Teeth	de	dp	Simplex				Duplex					
					dm	A	Bush	Type	App. Kg	dm	A	Bush	Type	App. Kg
		12	68.2	61.34	47	22.23	1008	1	0.20	-	-	-	-	-
		13	73.2	66.32	47	22.23	1008	1	0.23	-	-	-	-	-
		14	78	71.34	52	22	1108	1		-	-	-	-	-
		15	83.2	76.36	60	25.40	1210	1	0.32	-	25.4	1210	3	0.48
		16	88.3	81.37	71	25.40	1210/1610	1	0.37	-	25.4	1610	3	0.48
		17	93.3	86.39	71	25.40	1610	1	0.41	-	25.4	1610	3	0.57
		18	98.3	91.42	75	25.40	1610	1	0.51	-	25.4	1610	3	0.57
		19	103.3	96.45	75	25.40	1610	1	0.64	-	25.4	1610	3	0.71
		20	108.4	101.5	75	25.40	1610	1	0.68	-	25.4	1610	3	0.71
		21	113.4	106.5	76	25.40	1610	1	0.73	-	25.4	1610	3	0.86
		22	118.4	111.6	76	25.40	1610	1	0.78	-	25.4	1610	3	0.86
		23	123.5	116.6	76	25.40	1610	1	0.82	-	25.4	1610	3	0.98
		24	128.5	121.6	90	25.40	1610/2012	1	0.91	90	31.75	2012	2	0.98
		25	133.6	126.7	90	31.75	2012	1	1.09	90	31.75	2012	2	3.40
		26	138.6	131.7	90	31.75	2012	1	1.14	90	31.75	2012	2	3.40
		27	143.6	136.8	90	31.75	2012	1	1.18	90	31.75	2012	2	3.50
		28	148.7	141.8	90	31.75	2012	1	1.29	90	31.75	2012	2	3.50
		29	153.8	146.8	90	31.75	2012	1		90	31.75	2012	2	
		30	158.8	151.9	90	31.75	2012	1	1.41	90	31.75	2012	2	3.92
		32	168.9	162	90	31.75	2012	1	1.63	-	-	-	-	-
		33	174.5	167	90	31.75	2012	1		-	-	-	-	-
		35	184.1	177.1	90	31.75	2012	1		-	-	-	-	-
		36	189.1	182.2	90	31.75	2012	1		-	-	-	-	-
		38	199.1	192.2	90	31.75	2012	1	2.22	90	31.75	2012	2	5.68
		40	209.3	202.3	90	31.75	2012	1		-	-	-	-	-
		45	236	227.6	90	31.75	2012	1	2.95	-	-	-	-	-
		48	251.1	242.7	90	31.75	2012	1	3.25	-	-	-	-	-
		57	296.6	288.2	90	31.75	2012	1	4.59	110	44	2517/3020	2	0.48
		76	392.5	384.2	110	31.75	2012	1	8.31	110	44	2517/3020	2	0.48
		95	488.5	480.1	110	44.45	2517	1	12.76	-	-	-	-	-
		114	584.5	576.1	110	44.75	2517	1		-	-	-	-	-

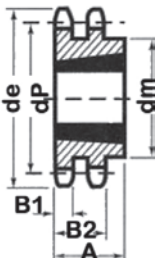

Type 1

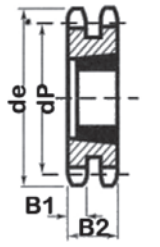

Type 2



Type 3

Pinions	mm
Tooth Radius r3	
Radius Width C	
Tooth Width B1	9.1
Chain	mm
Pitch	5.88
Inside	9.65
Roller ø	10.2

"Why compete against your supplier when you can be our partner"

12B-1-2-3 Taper Lock		Teeth	de	dp	dm	A	Bush	Type	App. Kg	dm	A	Bush	Type	App. Kg	dm	A	Bush	Type	App. Kg	
		12	81.5	73.6	60	24.4	1210	1	0A	-	-	-	-	-	-	-	-	-	-	-
		13	87.8	79.59	60	25.40	1210	1	0.41	0A	25.4	1210	0A	0A	-	-	-	-	-	-
		14	93.6	85.61	70	25.40	1610	1	0A	-	-	-	-	-	-	-	-	-	-	-
		15	99.8	91.63	70	25.40	1610	1	0.54	-	30.10	1610	3	0.90	-	49.8	1615	5	0A	-
		16	105.5	97.65	75	25.40	1610	1	0A	-	30.10	1610	3	0A	-	-	-	-	-	-
		17	111.9	103.7	76	25.40	1610	1	0.82	-	30.10	1610/1615	3	1.25	-	49.8	1615/2017	5	0A	-
		18	117.9	109.7	90	31.75	1610/2012	1	0.91	90	31.75	2012	2	0A	-	-	-	-	-	-
		19	123.9	115.8	90	31.75	2012	1	1.00	90	31.75	2012	2	1.81	-	49.8	2012	5	0A	-
		20	130	121.8	90	44.45	2012	1	1.00	108	44.45	2517	2	0A	-	-	-	-	-	
		21	136	127.8	102	44.45	2517	1	1.18	108	44.45	2517	2	2.50	-	49.8	2517	5	0A	-
		22	142	133.9	102	44.45	2517	1	1.27	108	44.45	2517	2	0A	-	-	-	-	-	
Pinions	mm	23	148.1	139.9	108	44.45	2517	1	1.37	108	44.45	2517	2	3.07	-	49.8	2517	5	0A	-
Tooth Radius r3		24	154.1	145.9	108	44.45	2517	1	1.50	108	44.45	2517	2	0A	-	-	-	-	-	
Radius Width C		25	160.2	152	108	44.45	2517	1	1.74	108	44.45	2517	2	3.63	-	49.8	2517	5	0A	-
Tooth Width B1	11.1	26	165.9	158	108	44.45	2517	1	0A	108	44.45	2517	2	0A	-	-	-	-	-	
		27	172.3	164.1	108	44.45	2517	1	1.80	108	44.45	2517	2	4.20	140	50.80	3020	4	0A	-
Chain	mm	28	178	170	108	44.45	2517	1	0A	108	44.45	2517	2	0A	-	-	-	-	-	
Pitch	19.05	29	184.1	176.2	108	44.45	2517	1	0A	108	44.45	2517	2	0A	-	-	-	-	-	
Inside	11.68	30	190.4	182.3	108	44.45	2517	1	2.32	140	50.80	2517	2	5.04	140	50.80	3020	4	0A	-
Roller ø	12.07	32	202.5	194.4	108	44.45	2517	1	2.48	0A	0A	2517	0A	0A	-	-	-	-	-	
		34	214.6	206.5	108	44.45	2517	1	0A	-	-	-	-	-	-	-	-	-	-	
		35	221	212.5	108	44.45	2517	1	0A	-	-	-	-	-	-	-	-	-	-	
		36	226.8	218.6	108	44.45	2517	1	0A	-	-	-	-	-	-	-	-	-	-	
		38	238.9	230.1	108	44.45	2517	1	3.36	140	50.80	3020	2	8.40	140	50.80	3020	4	0A	-
		45	283.2	273.1	108	44.45	2517	1	3.98	140	50.80	3020	2	-	-	-	-	-	-	
		57	355.9	345.8	108	44.45	2517	1	8.76	140	50.80	3020	2	19.48	160	50.80	3020	4	0A	-
		76	471.1	461	108	44.45	2517	1	11.68	140	50.80	3020	2	29.52	160	50.80	3020	4	0A	-
		95	586.2	576.2	108	44.45	2517	1	14.60	140	50.80	3020	2	34.40	-	-	-	-	-	
		114	701.4	691.4	140	50.80	3020	1	17.52	160	76.20	3030	2	39.28	-	-	-	-	-	

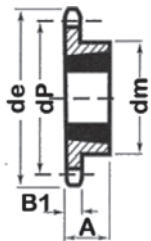

Type 1

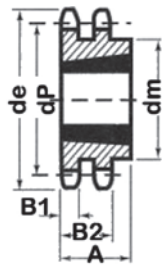

Type 2

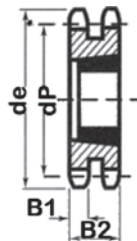

Type 3

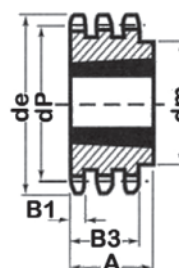

Type 4

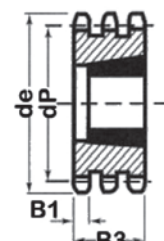

Type 5

British Standard Taper Locks



"Australia's Only Genuine Wholesaler"

Finer Power Transmissions P/L | www.finerpt.com

16B-1-2-3 Taper Lock		Teeth	de	dp	dm	A	Bush	Type	App. Kg	dm	A	Bush	Type	App. Kg	dm	A	Bush	Type
		12	109	98.14	73	25.4	1610	1	OA	-	-	-	-	-	-	-	-	-
		13	117.7	106.1	73	38.10	1610/1615	1	1.27	OA	47.7	2012	OA	OA	-	-	-	-
		14	125	114	76	38.10	1610	1	OA	-	-	-	-	-	-	-	-	-
		15	133.7	122.2	76	38.10	1610/1615	1	1.45	-	47.7	2012	3	2.04	-	47.7	2012	5
		16	141.8	130.2	76	38.10	1615/2012	1	1.55	-	47.7	2517	3	OA	-	-	-	-
		17	149.8	138.2	90	32	2012/2517	1	1.69	-	47.7	2517	3	2.50	-	79.6	2517	5
		18	157.8	146.3	108	44.45	2517	1	1.46	-	47.7	2517	3	OA	-	-	-	-
		19	165.9	154.4	108	44.45	2517	1	2.14	-	47.7	2517	3	3.18	-	79.6	3030	5
		20	173.9	162.4	108	44.45	2517	1	2.72	-	47.7	2517	3	OA	-	-	-	-
		21	182	170.4	110	44.45	2517	1	2.95	140	50.80	3020	2	2.95	-	79.6	3030/3535	5
Pinions	mm	22	190.1	178.5	110	44.45	2517	1	3.18	140	50.80	3020	2	OA	-	-	-	-
Tooth Radius r3		23	198.1	186.5	110	44.45	2517	1	3.40	140	50.80	3020	2	5.48	-	89	3525/3535	5
Radius Width C		24	206.2	194.6	110	44.45	2517	1	3.63	140	50.80	3020	2	OA	-	-	-	-
Tooth Width B1	16.2	25	214.2	202.7	110	44.45	2517	1	3.90	140	50.80	3020	2	7.72	-	89	3535	5
		26	221.6	210.7	110	44.45	2517	1	OA	140	50.80	3020	2	OA	-	-	-	-
Chain	mm	27	230.4	218.8	110	44.45	2517	1	4.31	140	50.80	3020	2	10.22	-	89	3535	5
Pitch	25.4	28	237.7	226.8	110	44.45	2517	1	OA	140	50.80	3020	2	OA	-	-	-	-
Inside	17.02	29	245.8	234.9	120	44.45	2517/3020	1	OA	140	50.80	3020	2	OA	-	-	-	-
Roller ø	15.88	30	254.6	243	120	44.45	2517/3020	1	5.44	140	50.80/76.20	3020/3030	2	11.35	175	89	3525/3535	4
		32	270.7	259.1	140	50.8	3020	1	OA	-	-	-	-	-	-	-	-	-
		33	278.5	267.2	140	50.8	3020	1	OA	-	-	-	-	-	-	-	-	-
		35	294.9	283.4	140	50.80	3020	1	7.12	-	-	-	-	-	-	-	-	
		38	319.2	307.6	140	50.80	3020	1	8.85	160	76.20	3020/3030	2	21.79	178	89	3535	4
		45	377.9	364.1	140	50.80	2517/3020	1	12.25	OA	76.2	3020	OA	OA	-	-	-	-
		57	474.9	461.1	140	50.80	3020	1	19.16	175	86.90	3525	2	27.24	216	102	4040	4
		76	628.4	614.7	140	50.80	3020	1	28.55	175	86.90	3535	2	37.68	216	102	4030/4040	4
		95	782	768.2	140	50.80	3020	1	41.58	-	-	-	-	-	-	-	-	
		114	935.6	921.8	140	50.80	3030	1	56.15	-	-	-	-	-	-	-	-	

<p>Type 1</p>	<p>Type 2</p>	<p>Type 3</p>	<p>Type 4</p>	<p>Type 5</p>
----------------------	----------------------	----------------------	----------------------	----------------------

Sprockets

"Why compete against your supplier when you can be our partner"

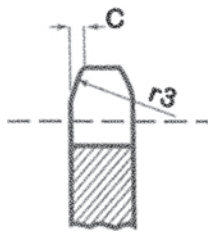
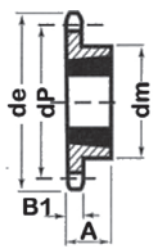
20B-1 Taper Lock		Teeth	de	dp	Simplex			
					dm	A	Bush	Type
		9	106.5	92.84	63	40	2012	1
		10	117	102.7	70	40	2012	1
		11	127	112.7	77	45	2517	1
		12	137	122.7	88	45	2517	1
		13	147.5	132.7	98	45	2517	1
		14	157.6	142.7	108	45	2517	1
		15	167.6	152.7	118	45	2517	1
		16	177.7	162.8	120	50	2517	1
		17	187.8	172.8	120	50	2517	1
		18	197.8	182.9	120	50	2517	1
		19	207.9	192.9	120	50	2517	1
		20	217.9	203	120	50	2517	1
		21	228	213	140	55	2517	1
		22	238.1	223.1	140	55	2517	1
		23	248.2	233.2	140	55	2517	1
		24	258.3	243.2	140	55	2517	1
		25	268.4	253.3	140	55	2517	1
		26	278.4	263.4	150	55	2517	1
		27	288.5	273.5	150	55	3020	1
		28	299	283.6	150	55	3020	1
29	308.8	293.6	150	55	3020	1		
30	319	303.8	150	55	3020	1		
38	399.6	384.5	160	55	3020	1		

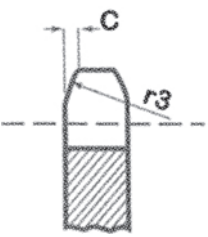
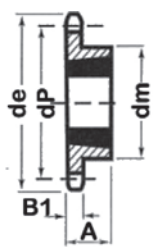
24B-1 Taper Lock		Teeth	de	dp	Simplex			
					dm	A	Bush	Type
		19	246.5	231.49	133.4	50.8	3020	1
		23	294.8	279.8	133.4	50.8	3020	1

Pilot Bore	Teeth	de	dp	Simplex			Duplex			Triplex		
				dm	D1	A	dm	D2	A	dm	D3	A
06B	114	350.3	345.68	80	18	32	-	-	-	-	-	-
08B	95	390.1	384.11	108	25	42	-	-	-	-	-	-
10B	95	488.5	480.14	-	-	-	145	30	58	-	-	-
10B	114	584.5	576.13	100	30	60	130	30	63	-	-	-
12B	57	355.9	345.8	-	-	-	-	-	-	140	30	75
12B	76	471.1	461	-	-	-	-	-	-	150	30	75
12B	114	701.4	691.36	-	-	-	140	30	63	-	-	-
16B	57	474.9	461.1	-	-	-	-	-	-	180	40	112
16B	76	628.4	614.7	-	-	-	-	-	-	180	40	112

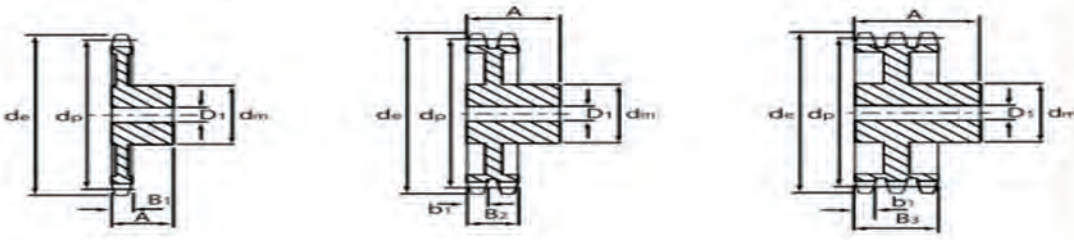

Taper Lock

Pitch	Teeth	de	dp	Simplex				Duplex				Triplex			
				dm	A	Bush	Type	dm	A	Bush	Type	dm	A	Bush	Type
06B	95	246.3	242	0A	0A	1210	1	0A	0A	0A	2	-	-	-	-
06B	114	294.8	242	0A	0A	1210	1	-	-	-	-	-	-	-	-
08B	76	313.9	307.3	-	-	-	-	100	32	2012	2	-	-	-	-
08B	95	390.7	384.1	-	-	-	-	100	32	2012	2	-	-	-	-
08B	114	467.4	460.9	100	32	2012	1	110	45	2517	2	-	-	-	-
10B	95	488.5	480.1	110	44	2517	1	-	-	-	-	-	-	-	-
10B	114	584.5	576.1	124	45	2517	1	-	-	-	-	-	-	-	-
12B	57	355.9	345.8	108	45	2517	1	140	51	3020	2	140	51	3020	4
12B	76	471.1	461	108	45	2517	1	140	51	3020	2	140	51	3020	4
12B	95	586.2	576.2	108	45	2517	1	-	-	-	-	-	-	-	-
12B	114	701.4	691.4	108	64	2525	1	124	64	2525	2	-	-	-	-
16B	57	474.9	461.1	140	51	3020	1	175	65	3525	2	216	79.6	4030	4
16B	76	628.4	614.7	140	51	3020	1	175	65	3525	2	216	79.6	4030	4
16B	95	781.1	614.65					215	100	4040	2				
16B	114	935.6	921.8	140	76	3030	1	-	-	-	-	-	-	-	-

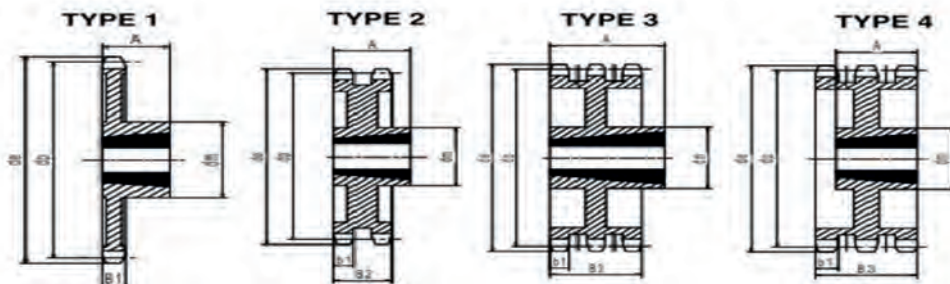

"Why compete against your supplier when you can be our partner"

06A-1 Plate Wheel

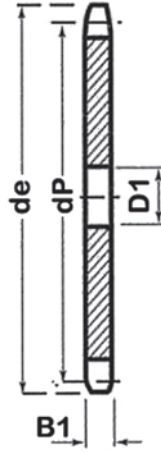
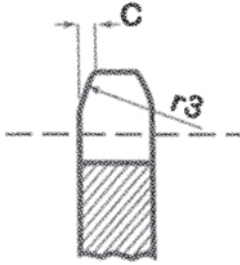

Pinions		mm
Tooth Radius r3		
Radius Width C		
Tooth Width B1		5.3
Chain		mm
Pitch		9.525
Inside		5.72
Roller ϕ		6.35

Teeth	de	dp	D1	App. Kg
11	37.5	33.8	8	0.05
12	40.5	36.8	8	0.05
13	43.5	39.8	8	0.05
14	46.5	42.8	8	0.06
15	49.5	45.81	8	0.07
16	52.5	48.82	10	0.08
17	55.5	51.83	10	0.10
18	58.6	54.85	10	0.11
19	61.6	57.87	10	0.12
20	64.6	60.89	10	0.13
21	67.6	63.91	12	0.14
22	70.6	66.93	12	0.15
23	73.7	69.95	12	0.17
24	76.7	72.97	12	0.19
25	79.7	76	12	0.20
26	82.7	79.02	12	0.21
27	85.7	82.04	12	0.22
28	88.8	85.07	12	0.23
29	91.8	88.09	12	0.25
30	94.8	91.12	12	0.27
31	97.9	94.15	14	0.22
32	100.9	97.17	14	0.24
33	103.9	100.2	14	0.25
34	106.9	103.2	14	0.26
35	110	106.3	14	0.27
36	113	109.3	16	0.28
37	116	112.3	16	0.35
38	119	115.3	16	0.43
39	122.5	118.3	16	0.44
40	125.1	121.4	16	0.45
45	140.7	136.5	16	0.51
56	173.8	169.9	20	0.83
57	176.9	172.9	20	0.86

08A-1 Plate Wheel

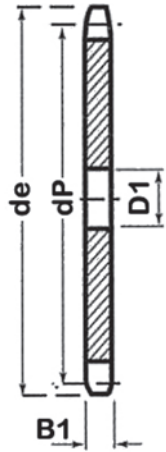
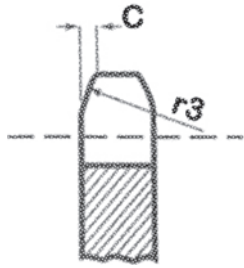

Pinions		mm
Tooth Radius r3		
Radius Width C		
Tooth Width B1		7.2
Chain		mm
Pitch		12.7
Inside		7.75
Roller ϕ		8.51

Teeth	de	dp	D1	App. Kg
10	43	41.1	8	0A
11	49.9	45.07	10	0.06
12	53.9	49.07	10	0.08
13	57.9	53.06	10	0.10
14	61.9	57.07	10	0.12
15	65.9	61.09	10	0.14
16	69.9	65.1	12	0.15
17	74	69.11	12	0.16
18	78	73.14	12	0.2
19	82	77.16	12	0.21
20	86	81.19	12	0.25
21	90.1	85.22	14	0.26
22	94.1	89.24	14	0.30
23	98.1	93.27	14	0.33
24	102.1	97.29	14	0.37
25	106.2	101.3	14	0.40
26	110.2	105.4	16	0.43
27	114.2	109.4	16	0.44
28	118.3	113.4	16	0.50
29	112.3	117.5	16	0.55
30	126.3	121.5	16	0.57
31	130.4	125.5	16	0.64
32	134.4	129.6	16	0.67
33	138.4	133.6	16	0.71
34	142.5	137.6	16	0.74
35	146.5	141.7	16	0.77
36	150.6	145.7	16	0.83
37	154.6	149.8	16	0.87
38	158.6	153.8	16	0.91
39	162.7	157.8	16	0.92
40	166.7	161.9	16	1.01
42	176.5	170	20	1.13
45	188.6	182.1	20	1.43
48	200.7	194.2	20	1.46
50	208.8	202.3	20	1.80
55	229	222.5	20	2.10
57	233.1	230.5	20	2.27
60	249.2	242.7	20	2.37
65	269.4	262.86	25	2.17
70	289.6	283.07	25	3.10
72	297.1	291.2	25	3.25
76	313.9	307.3	25	3.50

"Why compete against your supplier when you can be our partner"

10A-1 Plate Wheel		Teeth	de	dp	D1	App. Kg
		11	63.2	56.35	12	0.11
		12	68.2	61.34	12	0.15
		13	73.2	66.32	12	0.19
		14	78.2	71.34	12	0.23
		15	83.2	76.36	12	0.25
		16	88.3	81.37	12	0.31
		17	93.3	86.39	12	0.35
		18	98.3	91.42	14	0.39
		19	103.3	96.45	14	0.43
		20	108.4	101.5	14	0.48
		21	113.4	106.5	16	0.51
		22	118.4	111.6	16	0.59
		23	123.5	116.6	16	0.65
		24	128.5	121.6	16	0.68
		25	133.6	126.7	16	0.73
		26	138.6	131.7	20	0.78
		27	143.6	136.8	20	0.89
		28	148.7	141.8	20	0.93
		29	153.7	146.8	20	1.07
		30	158.8	151.9	20	1.15
		31	163.8	156.9	20	1.27
		32	168.9	162	20	1.32
		33	173.9	167	20	1.42
		34	178.9	172.1	20	1.45
		35	184	177.1	20	1.51
		36	189	182.2	20	1.73
		37	194.1	187.2	20	1.81
		38	199.1	192.2	20	1.88
		39	204.2	197.3	20	2.00
		40	209.2	202.3	20	2.02
		42	220.8	212.4	20	2.26
		45	236	227.6	20	2.69
		48	251.1	242.7	20	2.98
		50	261.2	252.8	20	3.22
		52	270.4	262.92	20	0A
		55	286.5	278.1	20	3.88
		57	296.6	288.2	25	4.25
		60	311.7	303.3	25	4.90
		65	337.0	328.58	25	5.50
		70	362.2	353.84	25	6.35
		72	372.3	363.95	25	6.91
		76	392.5	384.2	25	9.11

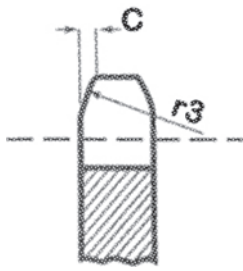

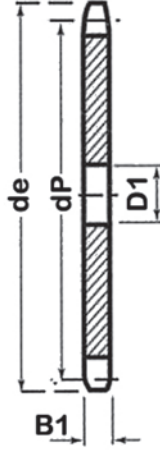

Pinions		mm
Tooth Radius r3		
Radius Width C		
Tooth Width B1	9.1	

Chain		mm
Pitch	5.88	
Inside	9.65	
Roller ø	10.2	

12A-1 Plate Wheel

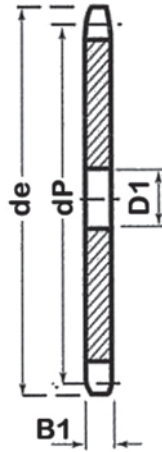
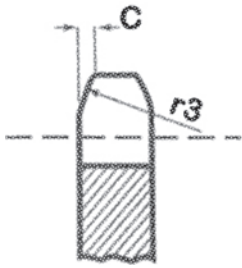

Pinions		mm
Tooth Radius r3		
Radius Width C		
Tooth Width B1		11.1
Chain		mm
Pitch		19.05
Inside		11.68
Roller ϕ		12.07

Teeth	de	dp	D1	App. Kg
11	75.8	67.61	16	0.36
12	81.8	73.6	16	0.42
13	87.8	79.59	16	0.48
14	93.8	85.61	16	0.54
15	99.8	91.63	16	0.60
16	105.8	97.65	16	0.68
17	111.9	103.7	16	0.77
18	117.9	109.7	16	0.85
19	123.9	115.8	16	0.95
20	130	121.8	16	1.08
21	136	127.8	20	1.15
22	142	133.9	20	1.24
23	148.1	139.9	20	1.33
24	154.1	145.9	20	1.47
25	160.2	152	20	1.63
26	166.2	158	20	1.72
27	172.3	164.1	20	1.91
28	178.3	170.1	20	1.99
29	184.4	176.2	20	2.28
30	190.4	182.3	20	2.44
31	196.5	188.3	20	2.49
32	202.5	194.4	20	2.62
33	208.6	200.4	20	2.77
34	214.6	206.5	20	2.91
35	220.7	212.5	20	3.19
36	226.8	218.6	25	3.21
37	232.8	224.6	25	3.52
38	238.9	230.1	25	3.67
39	244.9	236.8	25	3.87
40	251	242.8	25	4.00
42	265	254.9	25	4.53
45	283.2	273.1	25	5.14
46	287.9	279.16	25	5.35
48	301.4	291.3	25	5.75
50	313.5	303.4	25	6.45
55	343.8	333.7	25	7.43
57	355.9	345.8	25	8.11
60	374.1	364	25	9.19
65	404.4	394.29	25	10.65
70	434.7	424.60	30	12.45
72	446.8	436.74	30	13.22
76	471.1	461	30	14.78
114	584.5	576.1	OA	OA

"Why compete against your supplier when you can be our partner"

16A-1 Plate Wheel		Teeth	de	dp	D1	App. Kg
		11	101.7	90.14	16	0.82
		12	109.7	98.14	16	0.91
		13	117.7	106.1	16	1.04
		14	125.7	114.2	16	1.22
		15	133.7	122.2	16	1.36
		16	141.8	130.2	20	1.54
		17	149.8	138.2	20	1.81
		18	157.8	146.3	20	2.00
		19	165.9	154.4	20	2.13
		20	173.9	162.4	20	2.49
		21	182	170.4	20	2.63
		22	190.1	178.5	20	2.82
		23	198.1	186.5	20	3.04
		24	206.2	194.6	20	3.45
		25	214.2	202.7	20	3.63
		26	222.3	210.7	20	3.90
		27	230.4	218.8	20	4.31
		28	238.4	226.9	20	4.58
		29	246.5	234.9	20	4.81
		30	254.6	243	20	5.22
		31	262.6	251.1	25	5.56
		32	270.7	259.1	25	5.90
		33	278.8	267.2	25	6.24
		34	286.9	275.3	25	6.58
		35	294.9	283.4	25	6.92
		36	303	291.4	25	7.26
		37	311.1	299.5	25	7.60
		38	319.2	307.6	25	7.94
		39	327.2	315.7	25	8.48
		40	335.3	323.4	25	9.01
		42	353.0	339.9	25	10.1
		45	377.9	364.1	25	11.70
		57	474.9	461.1	30	18.14
		76	627.0	614.65	30	0A
		95	781.1	768.2	30	0A

Pinions		mm
Tooth Radius r3		
Radius Width C		
Tooth Width B1		16.2

Chain		mm
Pitch		25.4
Inside		17.02
Roller ϕ		15.88

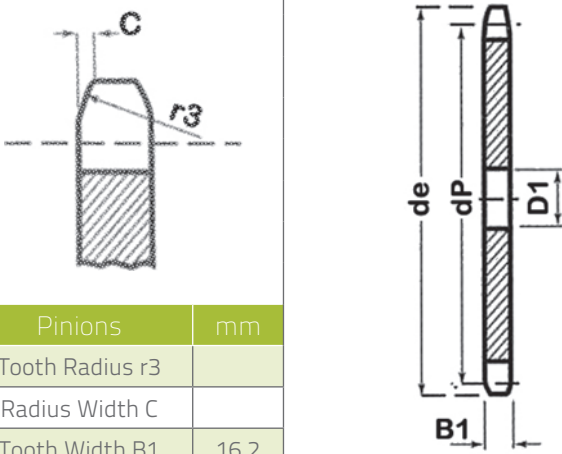

24B-1 Plate Wheel

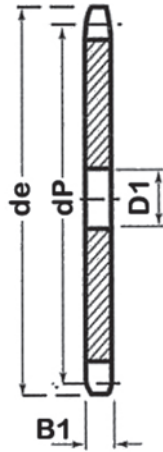
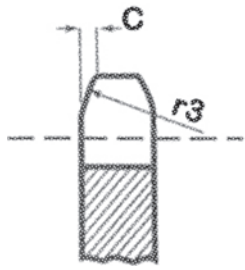

Teeth	de	dp	D1
38	476.2	461.4	30
50	621.7	606.78	30

Pinions		mm
Tooth Radius r3		
Radius Width C		
Tooth Width B1		11.7
Chain		mm
Pitch		19.05
Inside		12.7
Roller ϕ		11.91



"Why compete against your supplier when you can be our partner"

Welded Hubs For use with Welded Sprockets

	VT Series Hub		WT Series Hub		XT Series Hub	
	For VT sprockets		For WT sprockets		For XT sprockets	
A	34mm	(1-5/16)	45mm	(1-3/4)	62mm	(2-7/16)
B	30mm	(1-3/16)	41mm	(1-5/8)	57mm	(2-1/4)
C	12mm	(1/2)	12mm	(1/2)	12mm	(1/2)
D	30mm	(1-3/16)	37mm	(1-7/16)	37mm	(1-7/16)

BORE					
Inch	mm	Inch	mm	Inch	mm
1/2	12	1/2		1/2	
	14		14		14
5/8	15	5/8	15	5/8	15
			16		16
3/4		3/4	18	3/4	18
	19		19		19
7/8	20	7/8	20	7/8	20
		1	24	1	24
			25		25
		1-1/8	28	1-1/8	28
			30		30
		1-1/4	32	1-1/4	32
					35
				1-3/8	38
					40
				1-1/2	42
				1-5/8	45
				1-3/4	

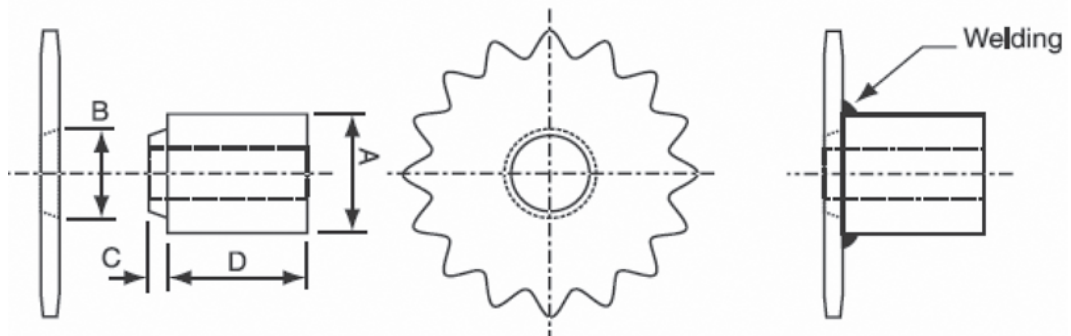
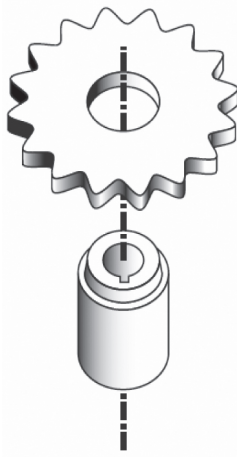

Notes

- 1) Welding with low hydrogen electrodes is recommended
- 2) Keyways conform to BS 46 (imperial) and BS 4235 (metric)

ANSI & BS Plate Wheel Sprockets with prepared Taper bore to receive welded hubs

No. of Teeth	08B1 1/2" Pitch	ANSI-40 1/2" Pitch	ANSI-50 BS 10B 5/8" Pitch	ANSI-60 BS 12B 3/4" Pitch	ANSI-80 BS 16B 1" Pitch
12	08V12HT	40VT12HT	50WT12HT	60WT12HT	80XT12HT
13	08V13HT	40VT13HT	50WT13HT	60WT13HT	80XT13HT
14	08V14HT	40VT14HT	50WT14HT	60WT14HT	80XT14HT
15	08V15HT	40VT15HT	50WT15HT	60XT15HT	80XT15HT
16	08WT16HT	40WT16HT	50WT16HT	60XT16HT	80XT16HT
17	08WT17HT	40WT17HT	50XT17HT	60XT17HT	80XT17HT
18	08WT18HT	40WT18HT	50XT18HT	60XT18HT	80XT18HT
19	08WT19HT	40WT19HT	50XT19HT	60XT19HT	80XT19HT
20	08XT20HT	40XT20HT	50XT20HT	60XT20HT	80XT20HT
21	08XT21HT	40XT21HT	50XT21HT	60XT21HT	80XT21HT
22	08XT22HT	40XT22HT	50XT22HT	60XT22HT	80XT22HT
23	08XT23HT	40XT23HT	50XT23HT	60XT23HT	80XT23HT
24	08XT24HT	40XT24HT	50XT24HT	60XT24HT	80XT24HT
25	08XT25HT	40XT25HT	50XT25HT	60XT25HT	80XT25HT
26	08XT26HT	40XT26HT	50XT26HT	60XT26HT	80XT26HT
27	08XT27HT	40XT27HT	50XT27HT	60XT27HT	80XT27HT
28	08XT28HT	40XT28HT	50XT28HT	60XT28HT	80XT28HT
29	08XT29HT	40XT29HT	50XT29HT	60XT29HT	80XT29HT
30	08XT30HT	40XT30HT	50XT30HT	60XT30HT	80XT30HT
32	08XT32HT	40XT32HT	50XT32HT	60XT32HT	80XT32HT
34	08XT34HT	40XT34HT	50XT34HT	60XT34HT	80XT34HT
36	08XT36HT	40XT36HT	50XT36HT	60XT36HT	80XT36HT
38	08XT38HT	40XT38HT	50XT38HT	60XT38HT	80XT38HT
40	08XT40HT	40XT40HT	50XT40HT	60XT40HT	80XT40HT
45	08XT45HT	40XT45HT	50XT45HT	60XT45HT	80XT45HT
57	08XT57HT	40XT57HT	50XT57HT	60XT57HT	80XT57HT
76	08XT76HT	40XT76HT	50XT76HT	60XT76HT	80XT76HT

