

PALETTE 2S from Mosaic Manufacturing

SIMPLE MULTI-MATERIAL 3D PRINTING



<p>EXPLORE MULTI-MATERIAL PRINTING: SOLUBLE, DURABLE, FLEXIBLE, COLORFUL</p>	<p>REDISCOVER YOUR PRINTER</p>
<p>Unlock your 3D printing potential with the most reliable multi-material printing experience.</p> <p>You can feed up to 4 filaments into your Palette 2S. It splices the filaments at various points, turning it into 1 filament which it feeds into your printer. Turn your printer into multi-color and multi-material without any modifications.</p> <ul style="list-style-type: none"> • Easy plug-n-play setup. • Color touchscreen includes built-in Gradient and Pattern modes. • Combine different types of materials together, like PLA or PETG with Breakaway support to make challenging overhangs a problem of the past. • Make heat- and water-resistant models in four colors of durable PETG. • Create functional, end-user products by combining TPU with TPU. 	<p>Palette 2S works with most filament-based printers. Find out if your printer is compatible with Palette 2S here.</p> <p>Join the global community of Palette owners in 40+ countries.</p> <p>See what Palette owners are creating: twitter.com/PalettePrinted.</p>

Multi-Material Combinations

Endless Possibilities with Multi-Color, Durable, Flexible, Soluble Prints

Several models printed in PLA, PETG, flexible TPU and more! Most of the model files (.STLs) are available at <http://mm3d.co/thingiverse>.

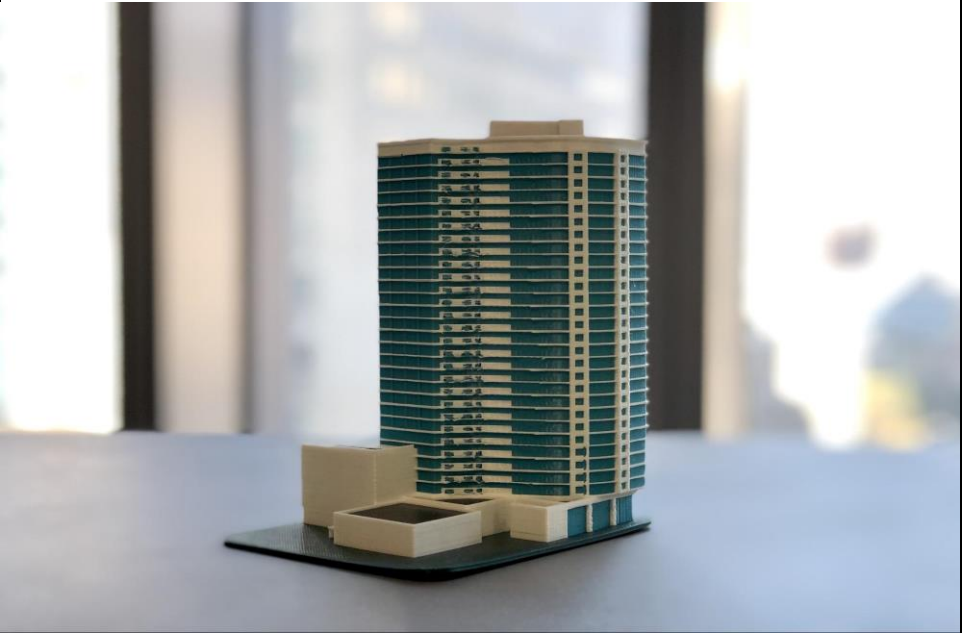

Other Features

Splice Core S

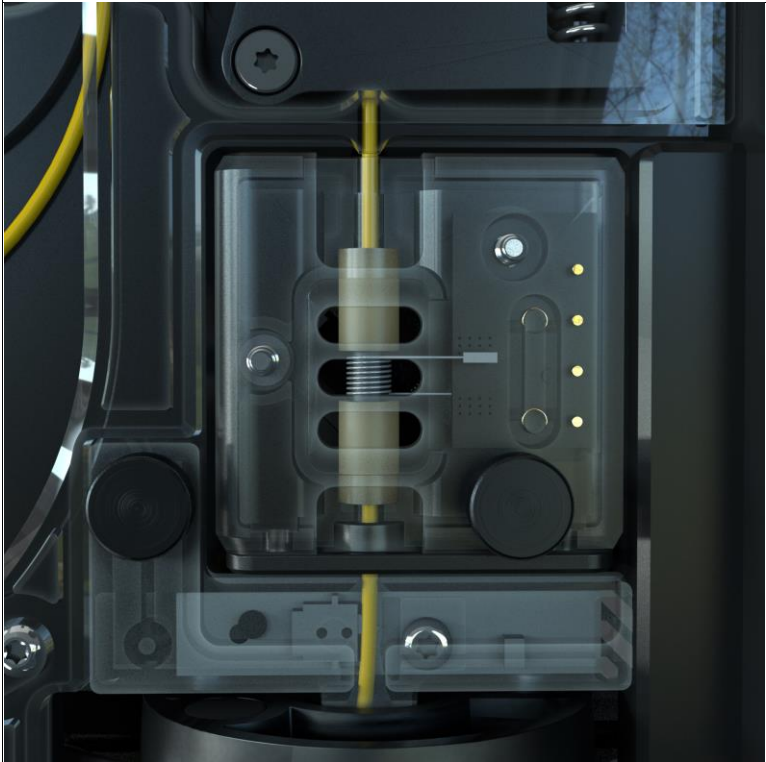

Palette 2S's improved splice mechanism is 10% faster than its predecessor, giving you more flexibility with your print settings.

CANVAS Hub S



Simplify and enhance the entire printing process by wirelessly connecting your printer, Palette 2S, and computer using CANVAS Hub S (sold separately).

Automated Filament Management



Palette 2S will detect when you've run-out of one spool of filament, and automatically splice to the next. A great way to get rid of your near-empty spools, and give you the most efficient material usage possible.

Plug and Play Setup



Your Palette 2S comes ready to print right out of the box. Simply create a file using CANVAS, or your chosen slicer, and you're ready to go!

PRINT WITH CANVAS AND PALETTE 2S

[CANVAS](#) is a simple and easy-to-use slicer software.

- Perfect for one material, built for multi-material.
- Save print time and material with features such as infill transition, and more.
- Apply color directly to your single file 3D models by digitally painting in CANVAS.
- Share, Save, organize, and track your print settings and models in the cloud.

FAQ

Q: Does Palette 2S work with 2.85mm or 3mm filament?

A: Palette 2S only works with 1.75mm filament however, adaptor kits are available for certain printers to convert them from 2.85mm to 1.75mm. These adaptors are available for Ultimaker and LulzBot printers.

Q: What materials does Palette 2S work with?

A: Palette 2S supports several combinations of materials. A full list can be found on the Palette 2S multi-material printing guide at <http://mm3d.co/multi-material>.

Q: How do Palette 2S and the printer know which color is which?

A: Each color/material is a separate model. If you're printing in 4 colors/materials, you will need 4 different model files. You can find models at <http://mm3d.co/stuff-to-print> or learn how to split 1 STL into multiple models at <http://mm3d.co/meshmixer>. The model is sliced as a multi-body G-code file. The G-code file is processed in [CANVAS](#) (our web-based slicer/customizer/modifier) to create a new files for the printer Palette 2S with instructions on when to switch between filaments. You can use CANVAS to Digitally Paint, Store and Slice your STLs, or you can pair it with Simplify3D, Cura, or Slic3r with our free desktop based tools in Chroma.

Q: Any software requirements?

A: Mosaic CANVAS software (free at <https://canvas3d.io>) or [Chroma](#) software (free software that accepts G-code and tells Palette 2S how much of each filament is required) works on **Windows** (7, 8, 10 or higher, 32-bit and 64-bit), **macOS** (Mountain Lion/10.8 or newer), and **Linux** (x64, tested on Ubuntu 16.04).