

Modell des ICE 3

**88714**

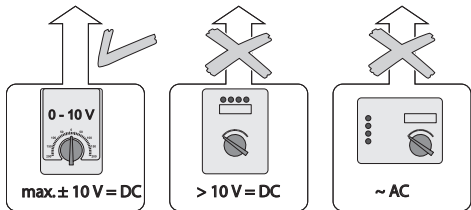

67011

67020 + 67030

67201

67271

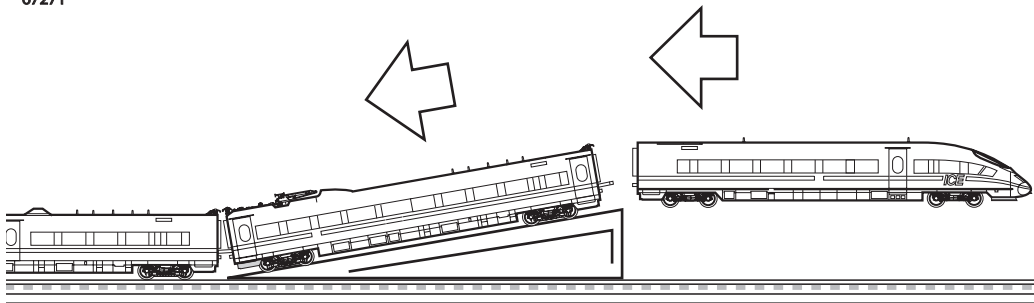

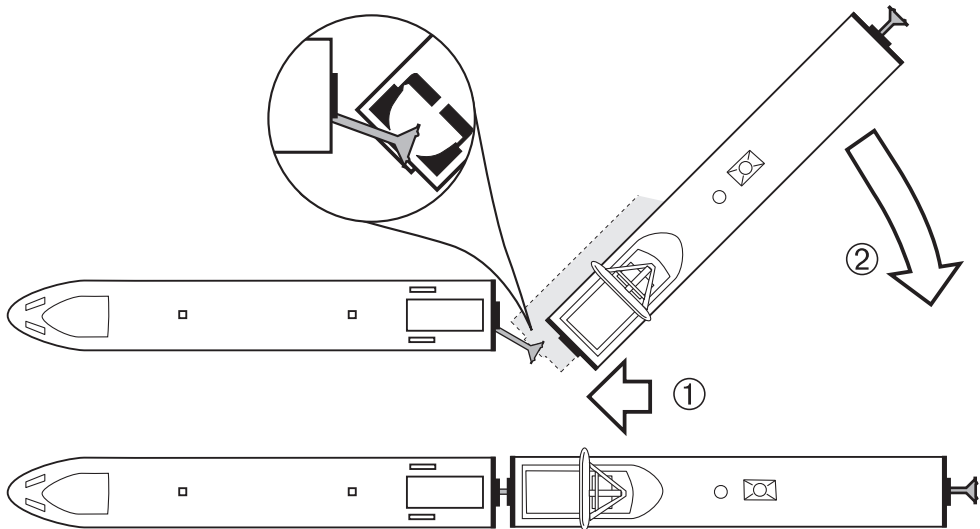
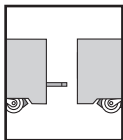
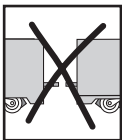

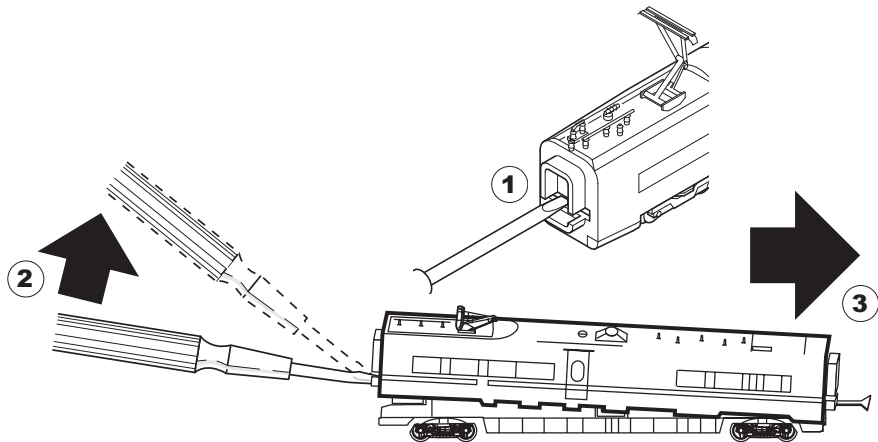

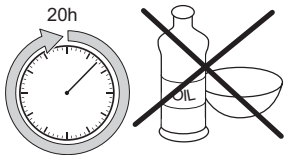

- Nur sparsam ölen (max. 1 Tropfen). Zuviel Öl führt häufig zum Verschmieren der Kollektoren und damit zur Beschädigung des Ankers.
- Oil sparingly (max. 1 drop). Too much oil frequently causes the commutator to become dirty and thereby leads to damage to the armature.
- Lubrifiez en très petite quantité (1 goutte max.). Trop d'huile entraîne souvent l'encrassement du collecteur et à des dommages à l'induit.
- Slechts spaarzaam oliën (max. 1 druppel). Te veel olie leidt vaak tot versmeren van de collector en daarmee tot beschadiging van het anker.

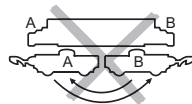
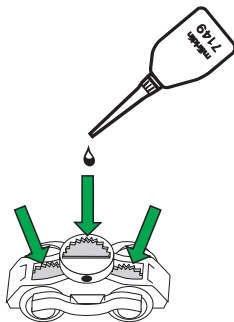
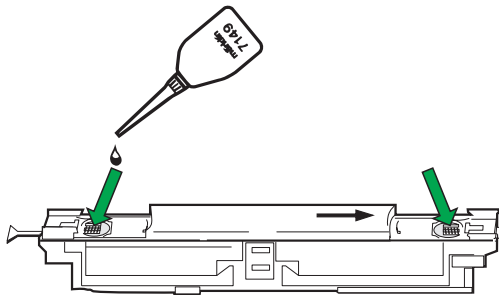

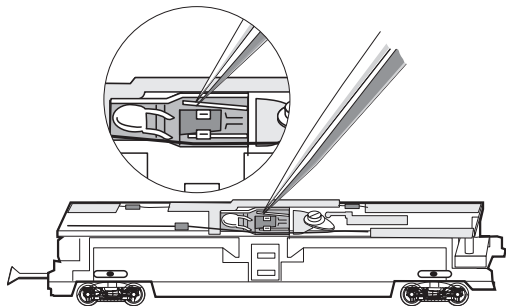
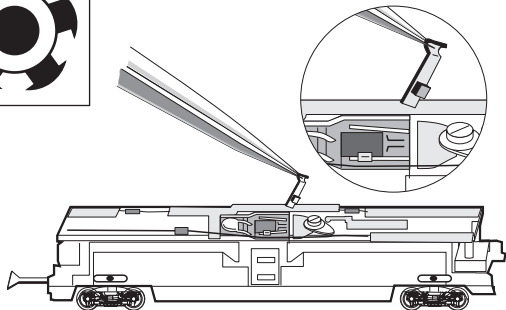
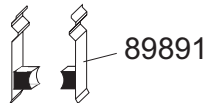

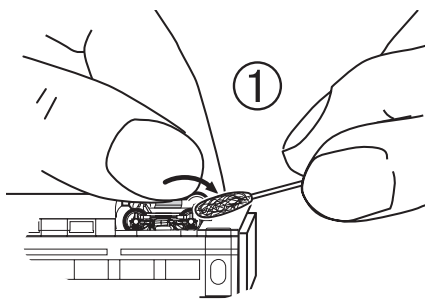
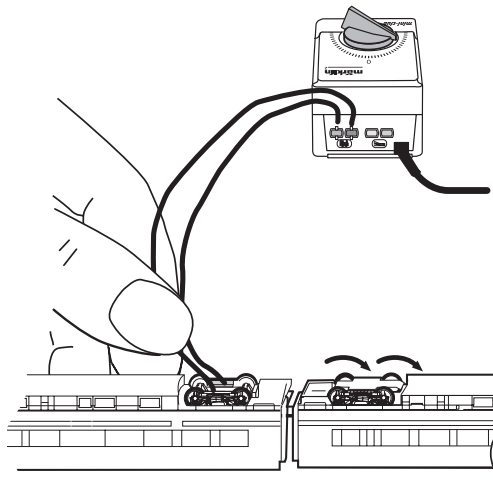

2

M

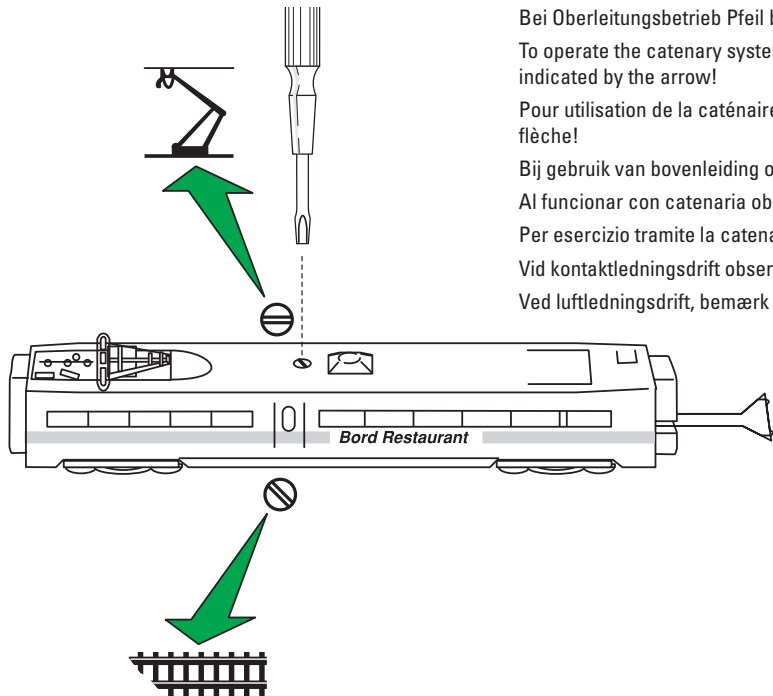

Bei Oberleitungsbetrieb Pfeil beachten!

To operate the catenary system follow the direction indicated by the arrow!

Pour utilisation de la caténaire tenir compte de la flèche!

Bij gebruik van bovenleiding op pijl letten!

Al funcionar con catenaria obsérvese la flecha!

Per esercizio tramite la catenaria osservare la freccia!

Vid kontaktledningsdrift observera pilen!

Ved luftledningsdrift, bemærk pil!



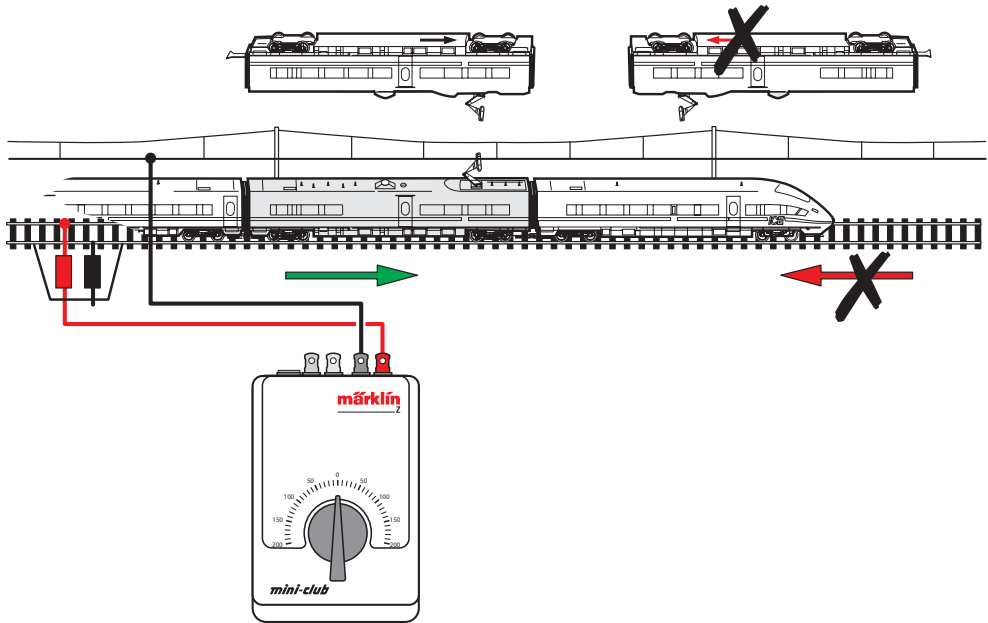

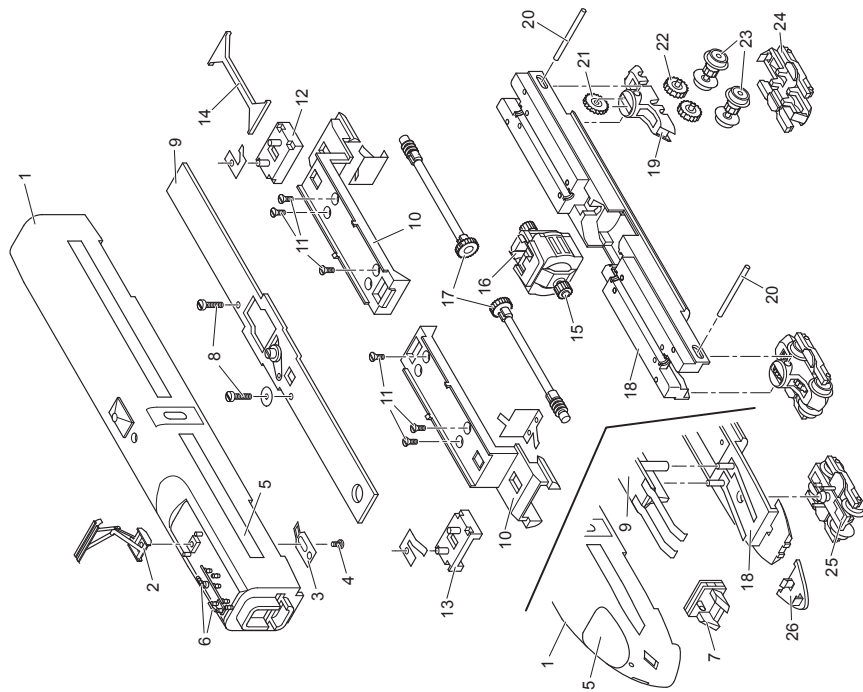

|                         | Steuer-<br>wagen 1 | Steuer-<br>wagen 2 | Mittel-<br>wagen | Motor-<br>wagen |
|-------------------------|--------------------|--------------------|------------------|-----------------|
| 1 Aufbau                | 134 553            | 134 556            | 134 550          | 134 546         |
| 2 Dachstromabnehmer     | —                  | —                  | 209 286          | 209 286         |
| 3 Kontaktfeder          | —                  | —                  | —                | 211 369         |
| 4 Zylinderschraube      | —                  | —                  | 785 460          | 785 460         |
| 5 Fenster               | 140 366            | 140 367            | 140 368          | 140 369         |
| 6 Dachausrüstung        | —                  | —                  | 140 371          | 140 372         |
| 7 Stirnbeleuchtung      | 209 313            | 209 313            | —                | —               |
| 8 Zylinderschraube      | —                  | —                  | —                | 785 190         |
| 9 Leiterplatte          | 603 849            | 212 747            | 211 288          | 209 277         |
| 10 Isolierung           | —                  | —                  | —                | 209 271         |
| 11 Senkschraube         | —                  | —                  | —                | 785 550         |
| 12 Kulisse rot          | 209 275            | —                  | 209 275          | 209 275         |
| 13 Kulisse schwarz      | —                  | 209 276            | 209 276          | 209 276         |
| 14 Kuppelstange         | 209 287            | —                  | 209 287          | 209 287         |
| 15 Motor                | —                  | —                  | —                | 211 903         |
| 16 Motorbürsten         | —                  | —                  | —                | 89 891          |
| 17 Antriebswelle        | —                  | —                  | —                | 209 284         |
| 18 Boden komplett       | 211 332            | 211 336            | 211 338          | —               |
| 19 Getriebegehäuse      | —                  | —                  | —                | 209 278         |
| 20 Achse                | —                  | —                  | —                | 260 720         |
| 21 Zahnrad              | —                  | —                  | —                | 262 960         |
| 22 Zwischenradsatz      | —                  | —                  | —                | 260 920         |
| 23 Treibradsatz         | —                  | —                  | —                | 117 436         |
| 24 Drehgestellblende    | —                  | —                  | —                | 209 279         |
| 25 Drehgestell komplett | 216 368            | 216 368            | 216 367          | —               |
| 26 Schienenräumer       | 209 947            | 209 947            | —                | —               |

Gebr. Märklin & Cie. GmbH  
Postfach 860  
D-73008 Göppingen  
[www.maerklin.com](http://www.maerklin.com)

134560/0808/SmSk  
Änderungen vorbehalten  
© by Gebr. Märklin & Cie. GmbH

**[www.ajckids.com](http://www.ajckids.com)**