

Modell der

BR 182 / Reihe 1016

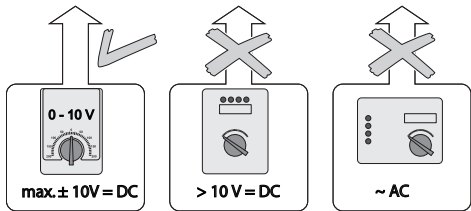

max. $\pm 10V = DC$

$> 10V = DC$

$\sim AC$

67011

67020 + 67030

67201

67271

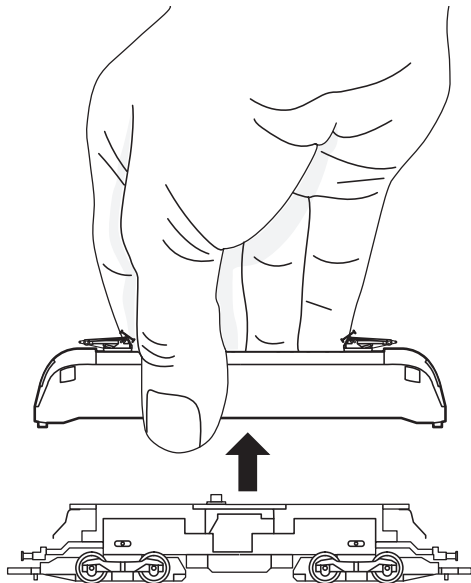
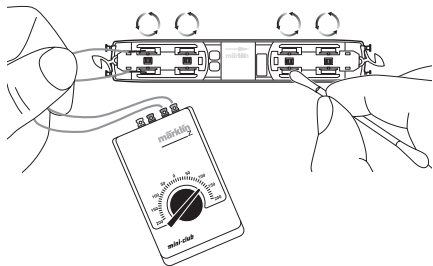

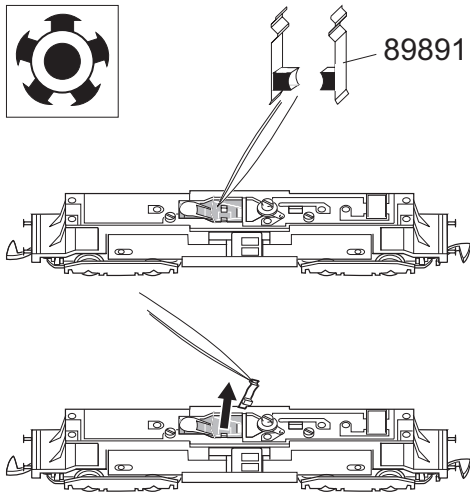
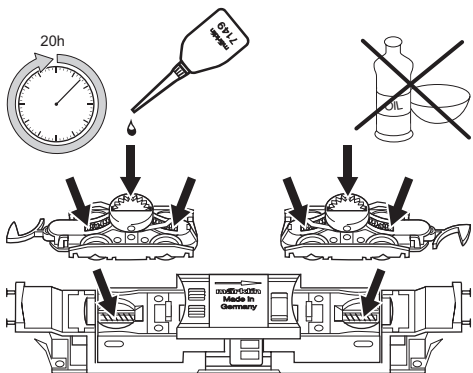
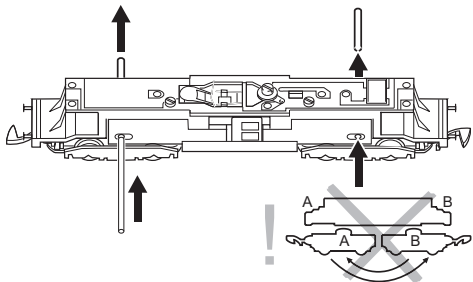

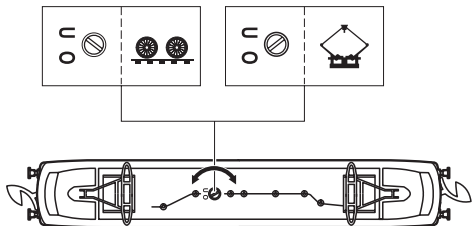

Bei Oberleitungsbetrieb Pfeil beachten!

To operate the catenary system follow the direction indicated by the arrow.

Pour utilisation de la caténaire tenir compte de la flèche.

Bij gebruik van bovenleiding op pijl letten!

Al funcionar con catenaria obsérvese la flecha.

Per esercizio tramite la catenaria osservare la freccia.

Vid kontaktledningsdrift observera pilen.

Ved luftledningsdrift, bemærk pil.

Gebr. Märklin & Cie. GmbH
Postfach 860
D-73008 Göppingen
www.maerklin.com

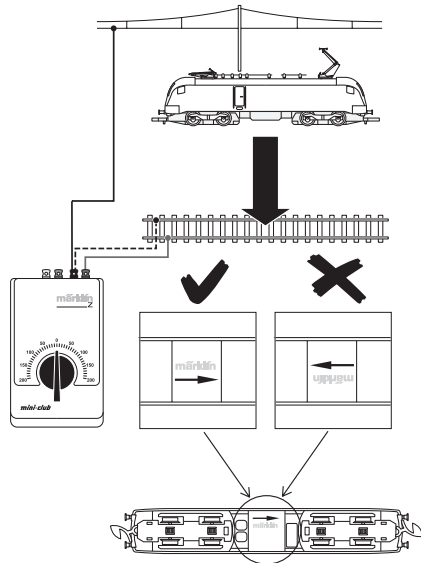

609419/0605/SmEf
Änderungen vorbehalten
© Gebr. Märklin & Cie. GmbH