

Modell der

**BR 042**

---

**88272**

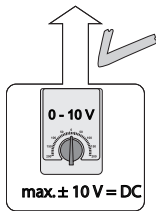

max.  $\pm 10\text{ V} = \text{DC}$

67011

67020 + 67030

67201

67271

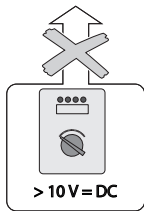

$> 10\text{ V} = \text{DC}$

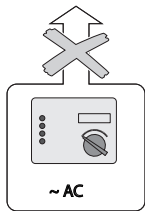

$\sim \text{AC}$

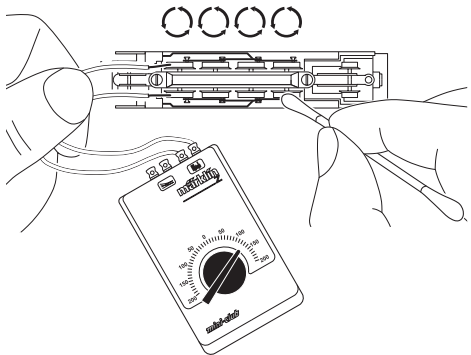
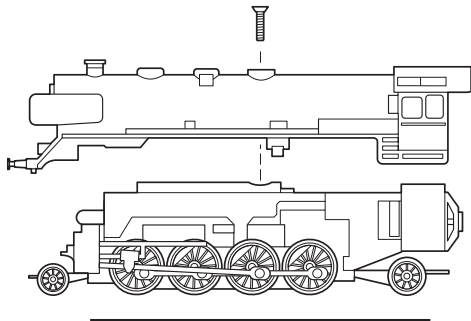

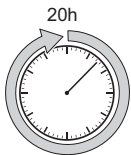

- Nur sparsam ölen (max. 1 Tropfen). Zuviel Öl führt häufig zum Verschmieren der Kollektoren und damit zur Beschädigung des Ankers.
- Oil sparingly (max. 1 drop). Too much oil frequently causes the commutator to become dirty and thereby leads to damage to the armature.
- Lubrifiez en très petite quantité (1 goutte max.). Trop d'huile entraîne souvent l'encrassement du collecteur et à des dommages à l'induit.
- Slechts spaarzaam oliën (max. 1 druppel). Te veel olie leidt vaak tot versmeren van de collector en daarmee tot beschadiging van het anker.

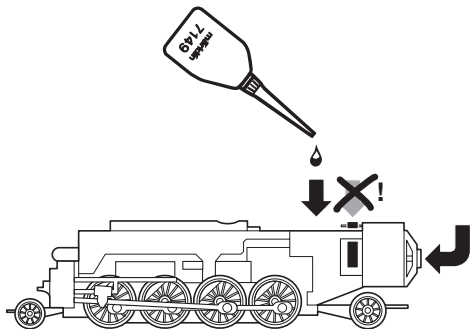
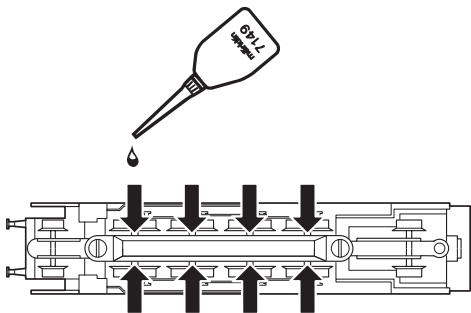

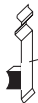
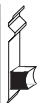
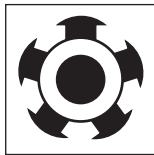

89891

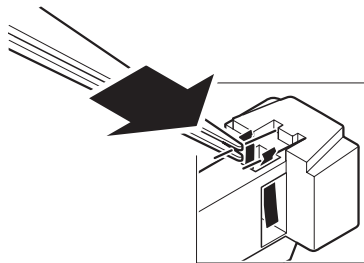

1

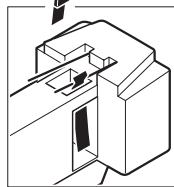

2

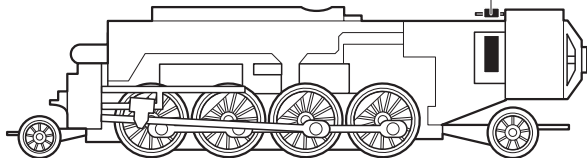

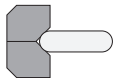

8953

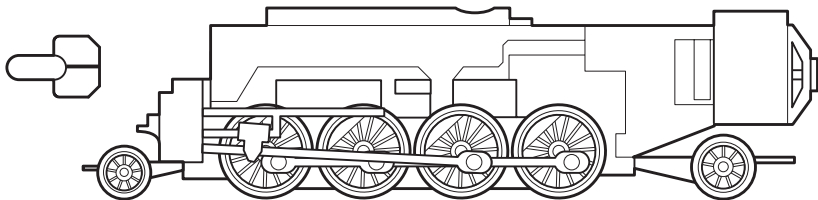

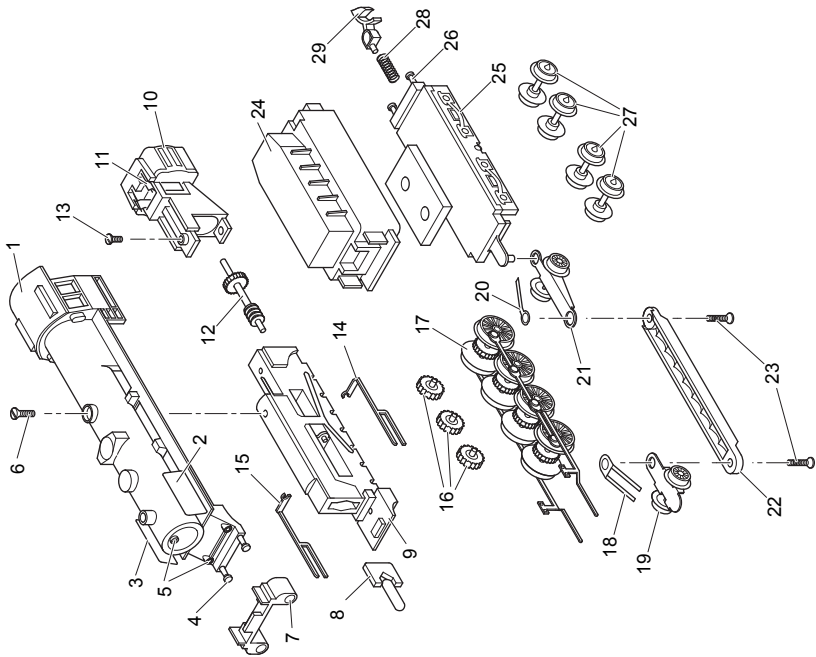

1 Lok-Aufbau (komplett) mit	108 812	24 Tendaraufbau	108 815
2 Windleitblech links	222 664	25 Boden	108 821
3 Windleitblech rechts	222 665	26 Puffer	761 450
4 Puffer	761 450	27 Radsatz	215 721
5 Lichtkörper	261 380	28 Druckfeder	765 680
		29 Kupplungshaken	704 200
6 Schraube	756 100		
7 Zylinderblock	260 040		
8 Beleuchtungseinsatz	8 953		
9 Traggestell komplett	262 680		
10 Motor	211 911		
11 Motorbürsten	89 891		
12 Antriebswelle	261 460		
13 Schraube	785 550		
14 Kreuzkopfführung links	224 901		
15 Kreuzkopfführung rechts	224 903		
16 Zwischenradsatz	260 640		
17 Treibradsatz komplett	226 744		
18 Blattfeder vorne	270 220		
19 Laufgestell vorne	261 740		
20 Blattfeder hinten	270 230		
21 Laufgestell hinten	223 558		
22 Abdeckung	262 600		
23 Senkschraube	785 570		

Gebr. Märklin & Cie. GmbH  
Postfach 860  
D-73008 Göppingen  
[www.maerklin.com](http://www.maerklin.com)

110709/0506/SmEf  
Änderungen vorbehalten  
© Gebr. Märklin & Cie. GmbH

**[www.ajckids.com](http://www.ajckids.com)**