

KOLLAGE FLOWERPOT

by Michael Rem

Instruction

①

Mark on the wall where you want to place your flowerpot. Drill a 10 mm hole and put in a wall plug.

Marker hvor på væggen du ønsker at placere din Kollage Flowerpot. Bor et 10 mm hul og indsæt en rawlplug.

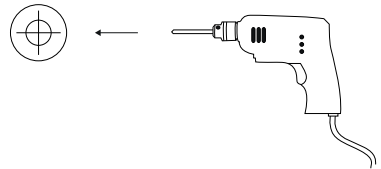

②

Place the allen key in a hole in the bushing and tighten firmly. Make sure that one of the holes, is pointing upwards.

Placer skruen med bøsningen med spidsen mod hullet. Sæt unbrakonøglen i et hul i bøsningen og spænd til den sidder stramt mod væggen. Et af hullerne skal vende opad.

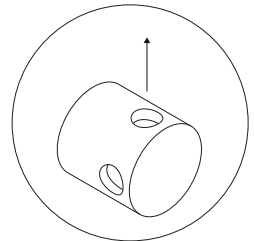
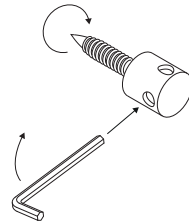

GEJST

- ③ Place the hook on the bushing.
Placer krogen på bøsningen.

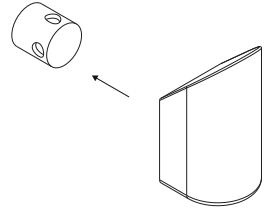

- ④ Place the flowerpot on top of the hook and secure by fastening the screw from the bottom.

Spænd Kollage Flowerpot fast ved at spænde skruen, fra bunden.

