

**ALCOVE SHOWER ENCLOSURE  
INSTALLATION**

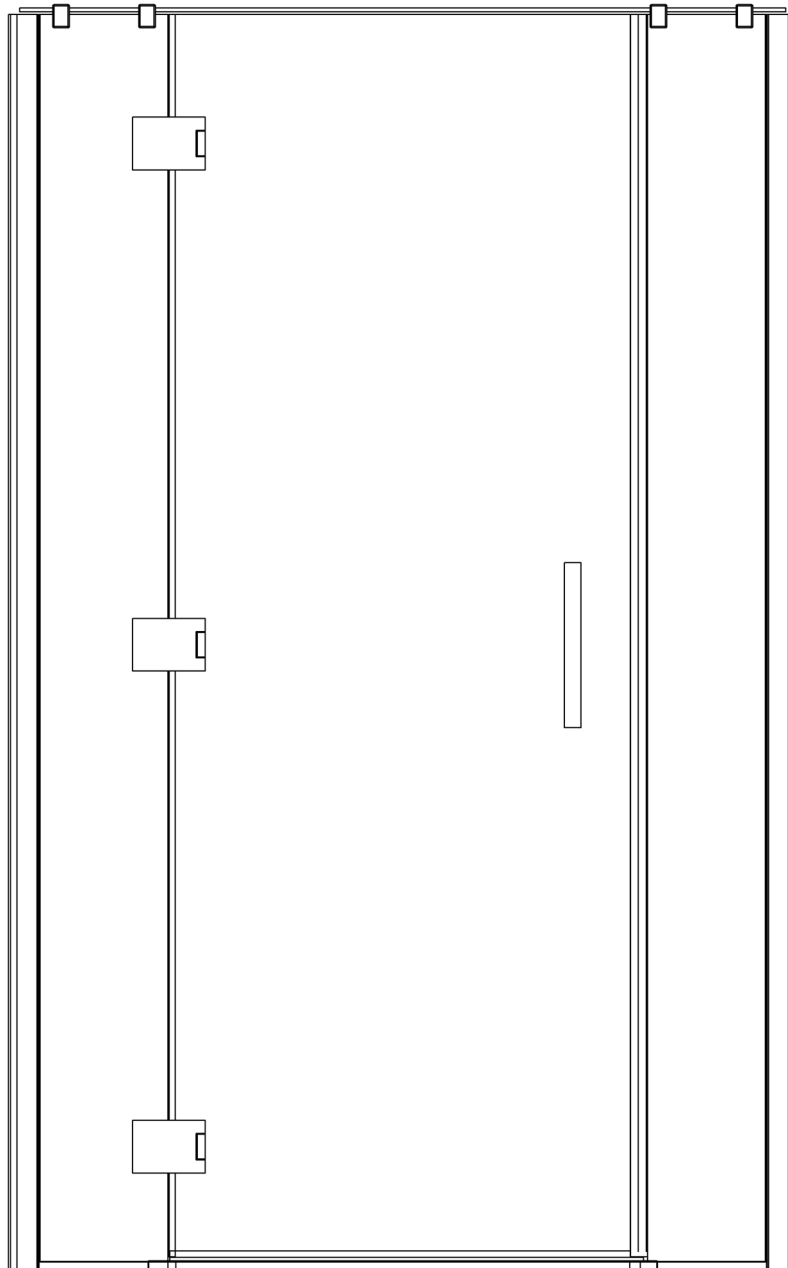

**PLEASE READ THESE INSTRUCTIONS CAREFULLY.**

**IT IS RECOMMENDED TO USE A TRAINED SHOWER INSTALLER FOR THIS SHOWER TO OBTAIN THE BEST INSTALLATION.**

# ALCOVE SHOWER ENCLOSURE

All Alcove shower enclosures can be installed to open Left Hand or Right Hand by rotating the Door 180 degrees (top to bottom). The SAFETY stamp should be on the OUTSIDE face of the Door.

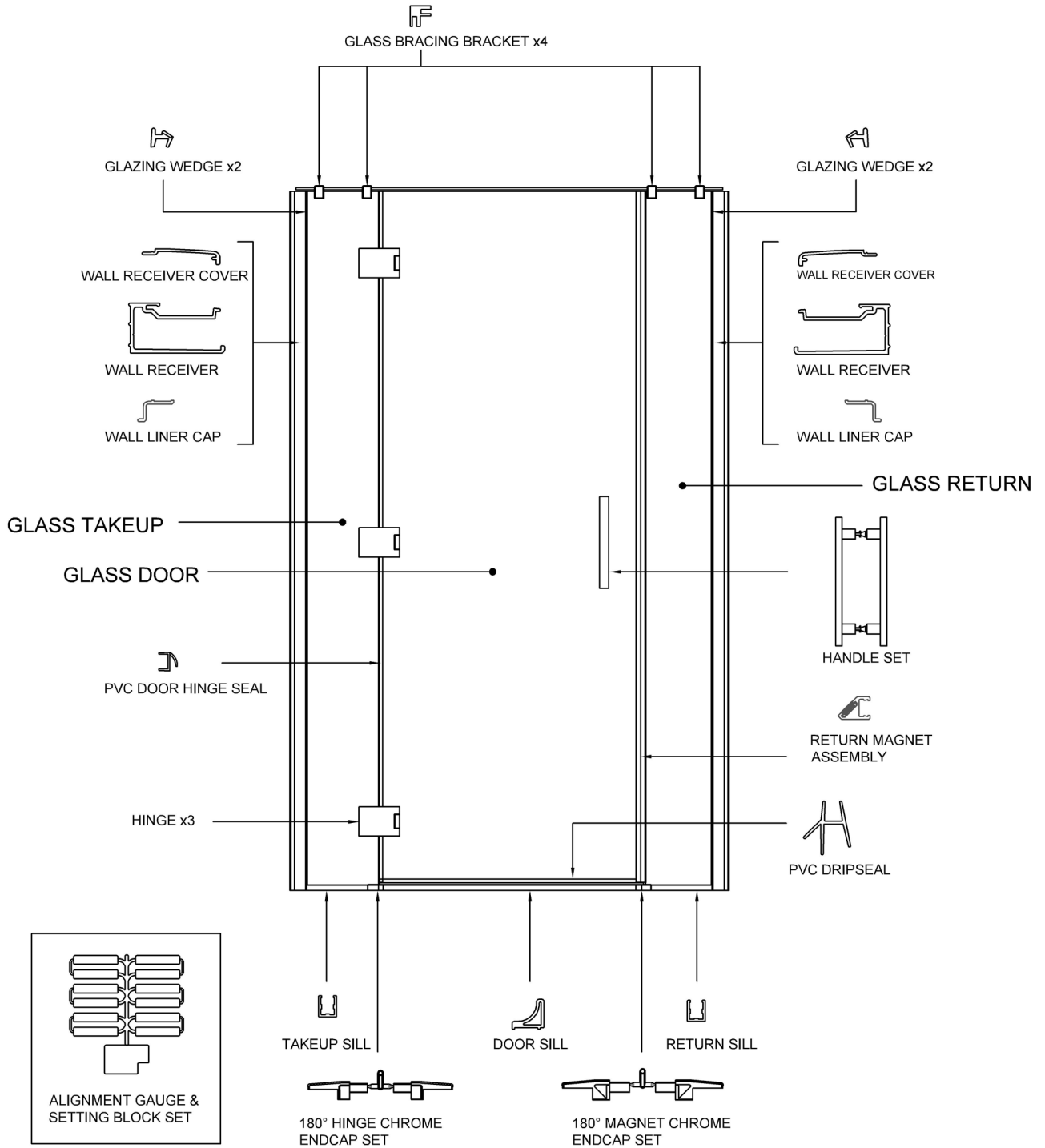

# WATERPROOF MEMBRANE & TILES

The Cardo Shower enclosure can be fitted to showers with Acrylic wall liners or walls which are to be tiled.

## **IMPORTANT**

When being installed on an Acrylic Tray with tiled walls the Wall Receivers must be fixed and sealed to the waterproofing membrane and Acrylic tray before tiling –refer to pg 5. This will ensure the Door set will fit the tray correctly.

The wall tiles and adhesive can be up to a maximum of 13mm thick.

When walls are to be tiled ensure that the chosen waterproof membrane is compatible with any sealants or adhesives used. **If in doubt consult the manufacturer.**

The shower tray must be installed so that it becomes an integral part of the waterproofing system at the tray to wall junction and if the floor is to be tiled at the tray to floor junction.

Ensure all Local Body Authority regulations are complied with where required.

## TOOLS REQUIRED

- Cordless Drill
- No.2 Square Drive screwdriver or screwdriver bit
- Spirit Level- (minimum 1200mm long)
- Carpenters Square
- Pencil
- Masking tape
- Ø 3.3mm twist drill
- Tape measure
- Caulking gun
- Sharp knife
- Hacksaw with fine tooth blade (18 TPI)
- White spirits

## COMPONENT LIST

### INSTALLATION PACK

- 3 Chrome hinges
- 1 Chrome handle set
- 4 Chrome glass bracing brackets
- Chrome endcap Hinge 180° set
- Chrome endcap Magnet 180° set
- 2 Wall Receivers
- 2 Wall Receiver covers
- Door Hinge Seal
- Return panel magnet assembly
- Dripseal
- Clear NG silicone
- Clear RTV silicone
- 4 - 2.1m glazing wedge
- 6 - 8 gauge x 50mm stainless steel pan head square drive screws
- 6 - 8 gauge x 12mm stainless steel pan head square drive screws
- Adhesive tape pad
- Allen key 3mm & 4mm
- Alignment gauge/set
- 2 - Alcohol wipes/ Lens Cleaner
- Wood block

### RETURN PACK

- Return glass
- Return Sill

### TAKEUP PACK

- Take-up glass
- Take up Sill

### DOOR PACK

- Door glass
- Door sill

### BRACE PACK

- Glass brace

# SHOWER SPECIFICATIONS

	A - Take up Panel position (mm)	B - WPM/Liner face to WPM/Liner (mm)	C- Return Panel position (mm)
900 Centre Door	162 +/- 7	874 +/-14	162 +/- 7
1000 Centre Door	162 +/- 7	974 +/-14	162 +/- 7
1200 Centre Door	222 +/- 7	1174 +/-14	222 +/- 7
1200 Short Take up	162 +/- 7	1174 +/-14	422 +/- 7
1200 Long Take up	422 +/- 7	1174 +/-14	162 +/- 7
1400 Centre Door	322 +/- 7	1374 +/-14	322 +/- 7
1400 Short Take up	222 +/- 7	1374 +/-14	422 +/- 7
1400 Long Take up	422 +/- 7	1374 +/-14	222 +/- 7
1600 Centre Door	422 +/- 7	1574 +/-14	422 +/- 7
1600 Short Take up	322 +/- 7	1574 +/-14	522 +/- 7
1600 Long Take up	522 +/- 7	1574 +/-14	322 +/- 7
1800 Centre Door	522 +/- 7	1774 +/-14	522 +/- 7
1800 Short Take up	422 +/- 7	1774 +/-14	622 +/- 7
1800 Long Take up	622 +/- 7	1774 +/-14	422 +/- 7

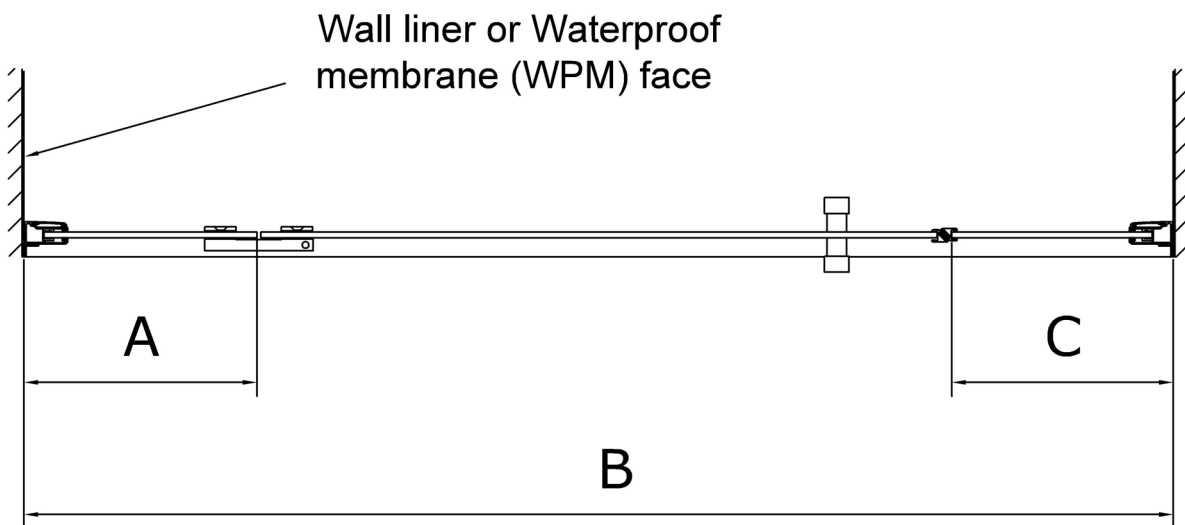

## IMPORTANT: SITE PREPARATION

To achieve optimum results when installing the Cardo shower it is important that the tray and walls of the shower are level and plumb respectively. The maximum deviation the wall may be from plumb is  $\pm 5$  mm over the 2000mm height. **The tray must be installed level.**

For every millimetre the tray is out of level, adjustment of the enclosure will be reduced by 2mm. e.g. if the tray is 4mm out of level there may be no adjustment left to accommodate out of plumb walls.

## TILED WALL INSTALLATION

When being installed on an Acrylic Tray with tiled walls the Wall Receivers need to be fixed and sealed to the water proofing membrane and Acrylic tray before tiling

## INSTALLATION OF THE GLASS WALL RECEIVERS

Please note: Throughout the instructions the Diagram numbering corresponds to the Instruction (Text) number sequence.

It is highly recommended that the Wall Receivers are fixed to solid studs/nogs.

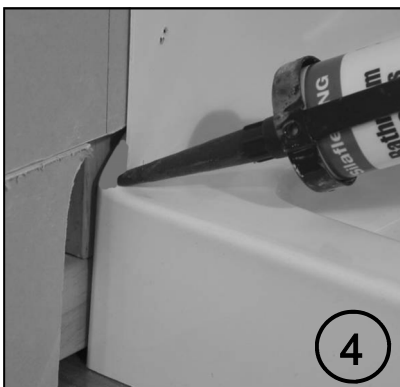
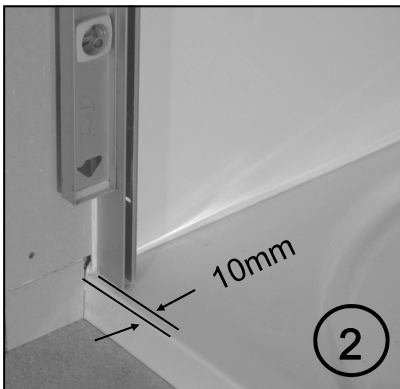

1. Before commencing installation, peel back the protective masking from the front edge of the tray. Leave masking on the centre of the tray as this will provide protection during the installation process. .
2. Place the Wall Receiver 10mm in from the front edge of the tray with the slotted holes facing inside the shower. You can use the Alignment Gauge to measure accurately. Vertically plumb the Wall Receiver using a spirit level.
3. Drill pilot holes into the wall. If there are no studs available for fixing the Wall Receiver into use a suitable wall anchor system. (not provided)
4. Apply silicone sealant where the tray and liner/WPM meet, continuing 15mm in from the edge of the lining. Apply a continuous full length bead of silicone sealant along the rear of the Wall Receiver and around the fixing holes.
5. Fix the Wall Receiver in place using the No.8 x 50mm Pan-head screws. Re-check Wall Receiver is plumb.
6. Repeat with the remaining Wall Receiver. It is critical that both Wall Receivers are aligned or the door magnets may not meet correctly.
7. If the walls are to be tiled apply silicone to the outside of the Wall Receivers where they meet the **WPM and the showertray** as shown. It is preferable to complete the tiling at this stage.

# INSTALLATION OF THE BOTTOM SILLS

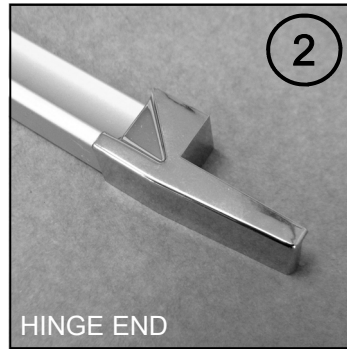
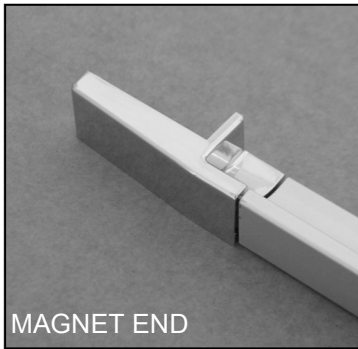

## LAYOUT FOR LH HINGED DOOR

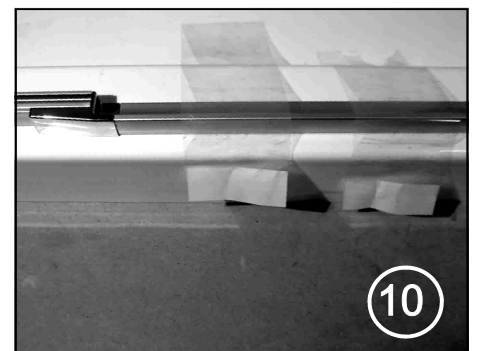
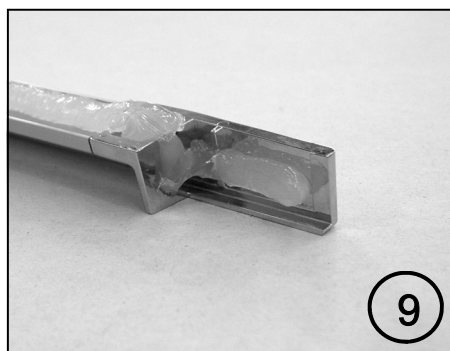
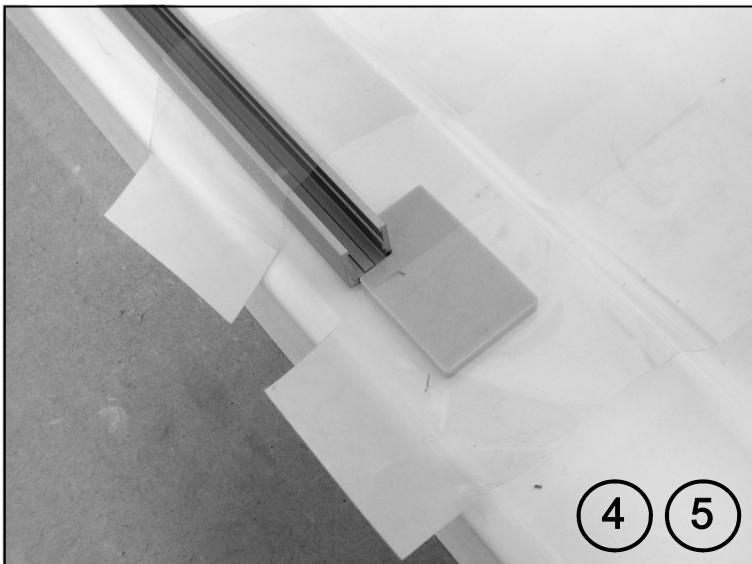
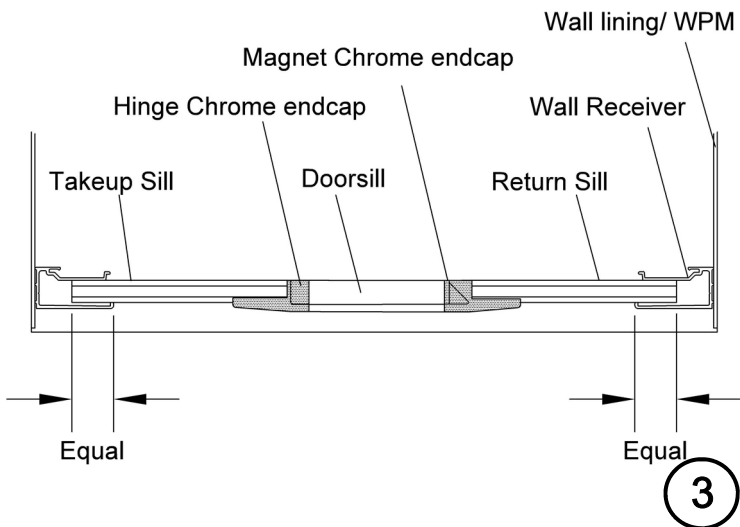

1. In the following instructions Take-up refers to the Hinged side and Return is the side with the magnets.
2. Assemble the appropriate Chrome Endcaps to each end of the Door Sill. Both a LH and RH set are included. Diagram 3 shows a LH hinge layout.
3. Clean the tray where the sills will be positioned with an alcohol wipe. Lay out the Take-up Sill, Door Sill with endcaps fitted and Return Sill onto the tray, ensuring they are all closely butted together. Adjust the sills so they are parallel to the front and side edges of the tray and that there is an equal amount of Take-up sill & Return sill protruding into the Wall Receivers.
4. Tape the Take up & Return sills into position on the tray using the clear adhesive tape supplied. Remove the Door sill with the Chrome endcaps.
5. Tape the alignment gauge to the tray at the end of the Take-up sill as shown.
6. Remove the Take-up sill and peel the adhesive tape cover from the bottom face. Using the alignment gauge and Wall Receiver as a guide press sill firmly back into position on the tray.
7. Repeat Steps 5 & 6 with the Return sill.
8. Pull the Chrome endcaps approximately 10mm out of the Door sill and apply a smear of silicone to the front and bottom faces of the spigots. Push the Endcaps back into position and clean any excess silicone.
9. Apply a continuous bead of silicone along the bottom of the Door sill and in the Chrome Endcap recesses as shown.
10. Position the Door sill back onto the tray and tape securely into place. Remove any excess silicone.

## INSTALLATION OF THE TAKE-UP AND RETURN GLASS

**NOTE: The Take-up and Return glass are labelled indicating the top of the shower.**

### SETTING BLOCK POSITIONS

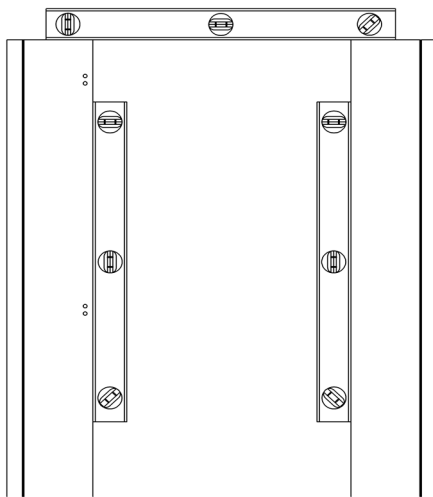
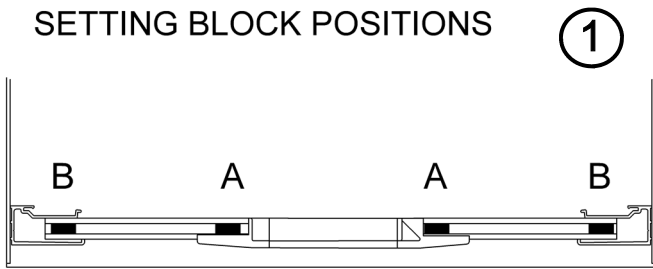

1. Position four 4mm setting blocks inside the sills at positions A & B.
2. Dry fit both the Take-up and Return panels with the Aluminium capped edge fitted into the Wall Receivers. Ensure they are the correct way with the TOP label pointing up. Check that they sit plumb and are aligned and level across the top glass edges. Adjust the setting blocks at positions B by using a combination of setting blocks to achieve this.
3. Remove the glass panels and apply a bead of silicone along the inside of the Take-up sill to seal to bed the glass panel into.
4. Re-position the glass panel into the Take-up sill. Ensure the glass edge is butted against the Chrome endcap at the bottom.
5. Drill through the 3 slotted holes in the Wall Receiver, with a  $\text{Ø}3.3\text{mm}$  drill, using the V groove in the aluminium edgcap as a guide. **Do not drill in any other position as this could damage the glass.**
6. Fix with the No.8 gauge x 12mm Pan head screws. **Hand tighten only.** Check the panel is plumb and clean up any excess silicone.
7. Repeat Steps 3-6 with the Return panel.

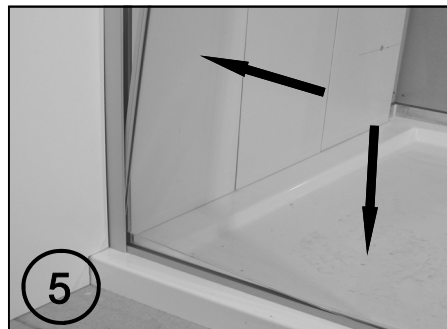

## INSTALLATION OF THE GLASS BRACE

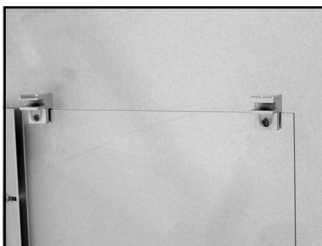

1. Position two Glass Brace brackets on top of the Take-up panel approximately 15mm in from the glass edge and the Wall Receiver, with the grub screws facing inside the shower. Ensure the gaskets are in place, then tighten the inside grub screws.
2. Position the remaining Glass Brace bracket on top of the Return panel approximately 15mm in from the glass edge with the grub screw facing inside the shower
3. Slide the Glass brace into the brackets. Ensure the gaskets are in place, then tighten the grub screws.
4. Check the distance between the top of the Take-up and Return panels is the same as the bottom measurement.

## INSTALLATION OF THE HINGES, DOOR HANDLE AND RETURN MAGNET

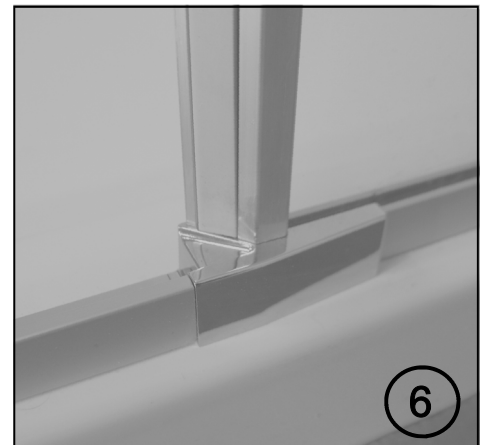
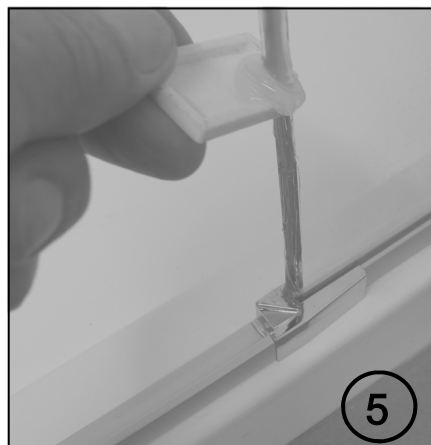
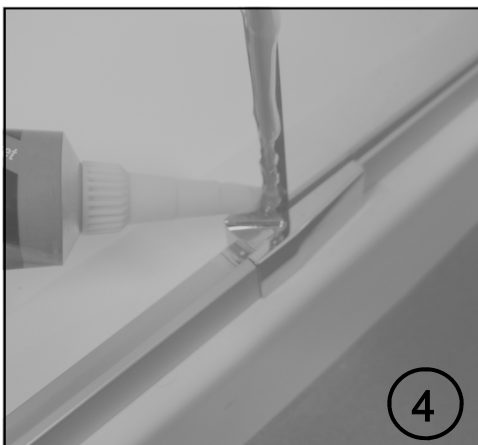
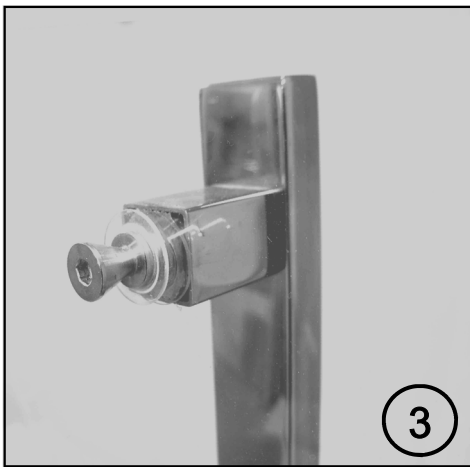
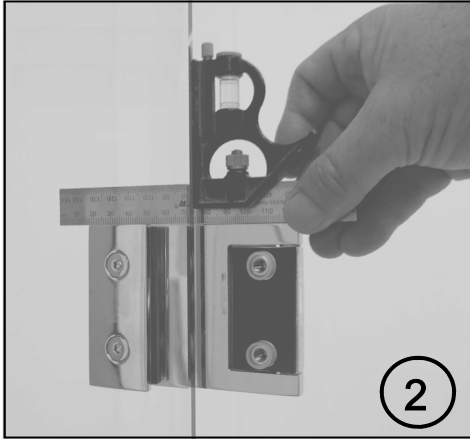

1. Attach the hinges loosely to the Take-up panel ensuring the plastic gaskets and sleeves are fitted in place. The hinges are fastened from the inside of the shower.
2. Position the hinges square to the glass edge and centralised to the holes in the Take-up glass and tighten.
3. Fit the door handle. Loosen the 2 small grub screws, separate the handle, remove the larger taper head screws and gaskets and reassemble to the Door. Do not overtighten the taper head screws. Check the ATHENA logo is facing the correct way up.
4. Fit the Return panel magnet. Clean the glass edge and the Magnet Assembly groove with an alcohol Lens Cleaner wipe. Apply a small bead of RTV silicone to the glass edge and onto the Chrome Endcap.
5. Using the notch in the Alignment gauge at a 45 degree angle screed the excess silicone off to leave a small triangular shaped bead on the glass edge.
6. Position the Magnet assembly onto the glass edge as shown and tape in place. Clean up any silicone.



## INSTALLATION OF THE DOOR

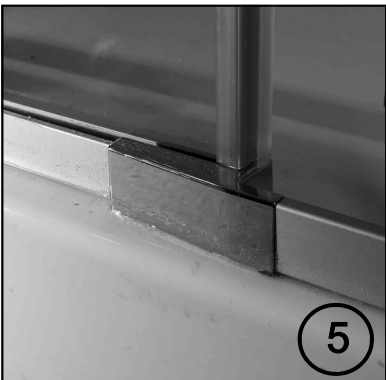
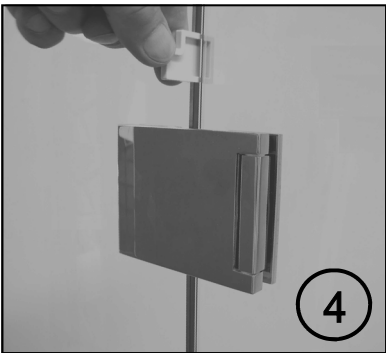
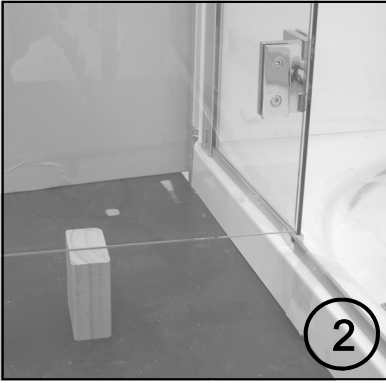

Note: The Door SAFETY stamp should be facing outside the shower.

1. Open the hinges to 90°.
2. Position the wooden block on the floor to support the door glass then secure the door to the hinges ensuring the plastic gaskets and sleeves are fitted. The top of the Door glass should be at the same height as the Take up glass. If not adjust the wooden block to suit.
3. Carefully move the door to its closed position making sure the glass Door edge **DOES NOT** contact the Take-up glass.
4. From inside the shower adjust the gap between the Door and Take-up glass by loosening each hinge on the door side one at a time and insert the alignment gauge as a guide. Retighten each hinge before adjusting the next hinge. Ensure the Hinge fastening screws are tightened evenly or the Hinge gaskets can be distorted.
5. Fit the Door hinge seal to the Take-up panel ensuring it is butted to the Chrome endcap at the bottom. The flexible leg should face to the outside of the shower.
6. If the door height needs to be adjusted, open door and reposition the wood block under the door glass. Carefully loosen both hinges and reset the door glass to the correct height. Then repeat step 4.
7. Check the Door and Return magnets touch over the full length. Adjustment of the Glass brace and the Take-up and Return panels positions may be necessary to align the magnets correctly.
8. Re-check all screws are securely tightened.

## INSTALLATION OF THE DOOR DRIPSEAL

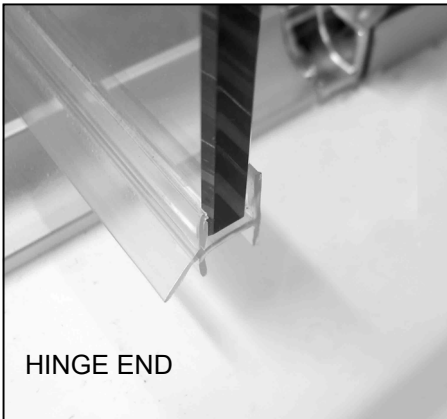
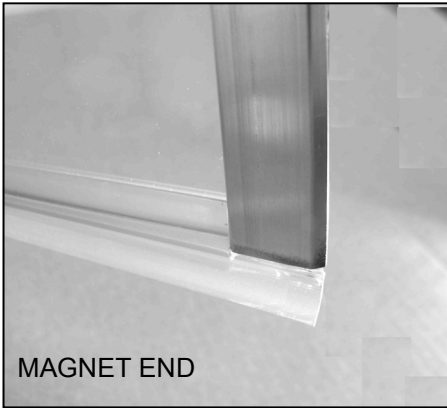

1. Fit the Dripseal starting at the Magnet end as shown.
2. Trim the Hinge end flush with the Glass Door edge using a sharp knife and fine tooth hacksaw blade. The lower flexible edge of the Dripseal should be just clear of the Door-sill to ensure the best water seal.

## INSTALLATION OF THE WALL RECEIVER COVERS AND GLAZING GASKETS

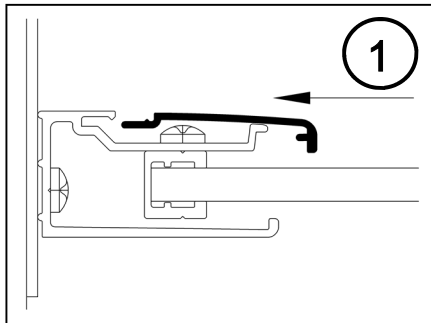

1. Fit the Wall Receiver Covers inside the shower by sliding into the Wall Receivers. They may need to be lightly tapped home using the wooden block.
2. Insert the outside glazing gasket between the glass and Wall Receivers. Start at the bottom and trim the excess at the top. **Note the correct orientation of the gasket.** The rigid black stripe faces the Aluminium extrusion.
3. Repeat with the inside glazing gaskets.

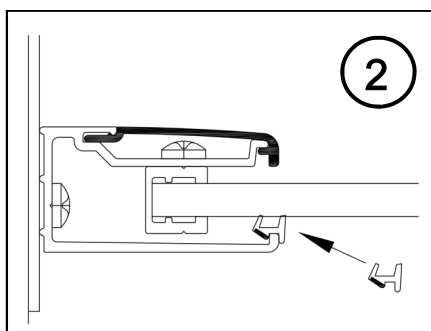

To remove the Wall Receiver Cover peel out the glazing gasket, slide the cover upwards then carefully pull or lever out using a flat bladed screwdriver. It may be necessary to remove the Glass Brace first.

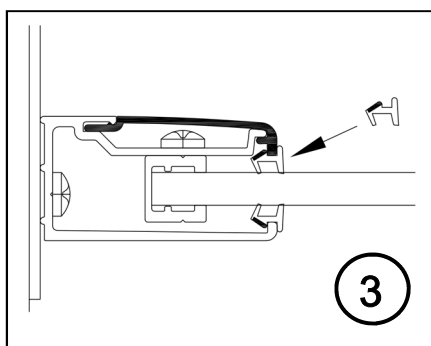

## SEALING THE ENCLOSURE

Silicone sealant should NOT be applied to the inside of the shower.

When applying silicone in long runs, mask either side of the area with masking tape to ensure a tidy finish. Remove the masking as soon as the silicone has been tooled smooth. Clean up and remove any uncured silicone with white spirits.

Allow 24 hours for the Silicone to properly set. Longer setting times may be required if ambient temperatures are low.



1. Degrease and clean the Acrylic surface to improve adhesion when using NG silicone.
2. Run a continuous bead of the NG Translucent silicone supplied along the joint where the shower enclosure touches the shower tray.
3. Seal the vertical joint between the Wall Receiver and bottom sill up to the glass Glazing gasket.
4. Seal between the Wall Receiver and wall extending up at least 150mm vertically from the tray.

## WALL LINER FINISHING CAP - NOT REQUIRED FOR TILED INSTALLATIONS

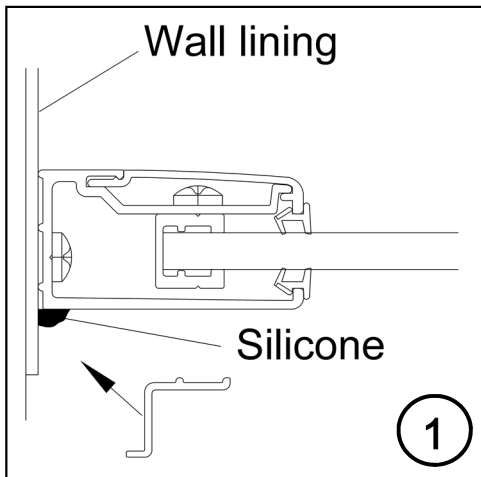

1. Run a generous bead of silicone up the full length of the joint where the Wall Receiver touches the wall liner.
2. Position the finishing cap so it fits firmly against the Wall Receiver. Tape into place if necessary until silicone cures.

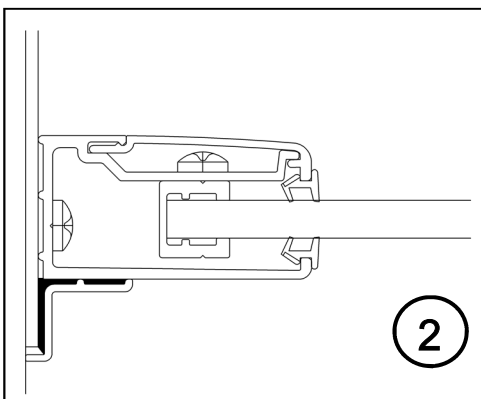

## CONTACT DETAILS

Free Phone: 0800 4 ATHENA  
Email: [information@athena.co.nz](mailto:information@athena.co.nz)  
Web Site: [www.athena.co.nz](http://www.athena.co.nz)