

## PRODUCT INFORMATION

### DIMENSIONS

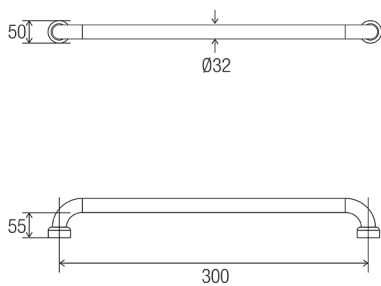

### INDICATIVE IMAGE

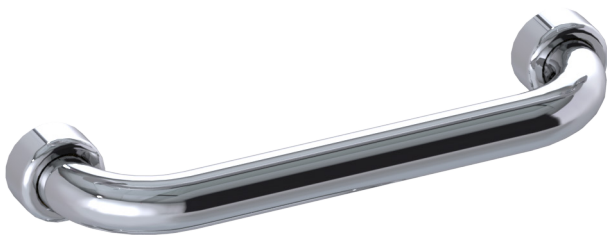

## HYGIENIC SEAL® - STRAIGHT GRAB RAILS

### Product Code - Finish

- HS 300 PS - Polish Supreme™

### Features

- 300 mm Ø to Ø
- Premium 32 mm grab rail
- Fabricated from 304 stainless steel
- Assembled with 50 mm brass screw on flange covers and TPE (Thermoplastic Elastomer) fitted seals with Biomaster antimicrobial additive
- Inside of grab rail has been cleaned and free of unsanitary oil and dirt produced through fabrication processes
- Stainless steel fixing screws supplied

### Compliance

- Complies with Section 14 of AS 1428.1:2021 for design and construction of grab rails

### Warranty

See Con-Serv warranty policy for full details.

CON-SERV CORPORATION AUSTRALIA PTY. LTD.

17 Glentanna Street, Kedron · Qld. 4031 Australia

Phone: +61 (0)7 3630 5744 · Fax: +61 (0)7 3630 5755 · Email: mail@con-serv.com.au · www.con-serv.com.au