

Installation Instructions

Polyurethane Niche

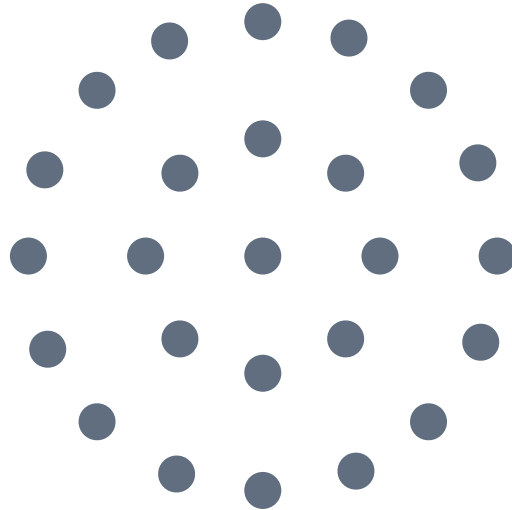

UNIVERSAL SHOWER BASE

54 - 56 Elliott Road
Dandenong South, VIC 3175

Telephone 03 9791 8925

Facsimile 03 9793 2403

info@universalshowerbase.com.au

universalshowerbase.com.au

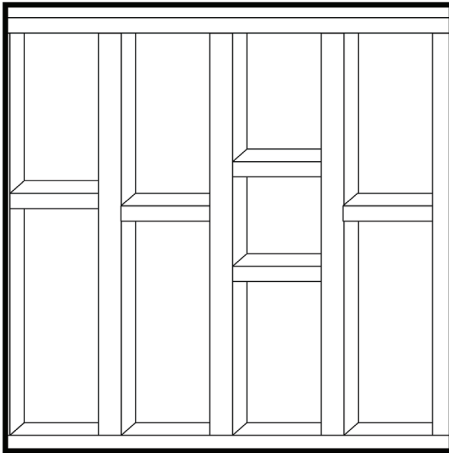

Step 1

Add extra framing in desired position to wall frame to support and match dimensions of the Niche. Ensure all framing is level and all four sides are supported

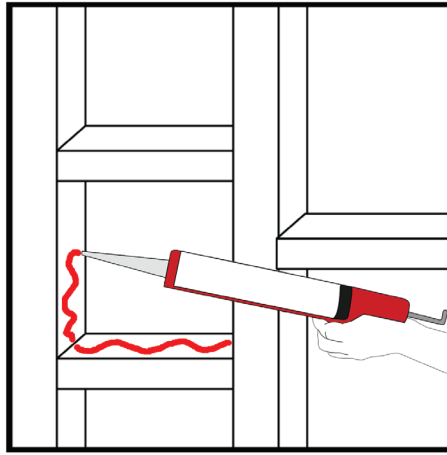

Step 2

Apply polyurethane sealant adhesive (fast cure) to all noggins/studs in a continuous snake like bead.

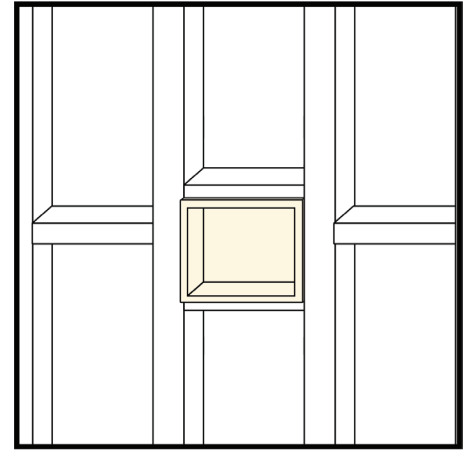

Step 3

Insert Niche so all edges will be flush with the face of the wall sheeting and edge with fall is facing to the bottom.

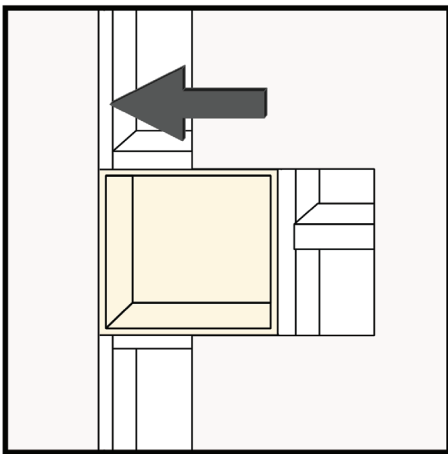

Step 4

Install wallboard to finish flush with the edges of the niche. Please note: once installed you can trim the Niche using a stanley knife.

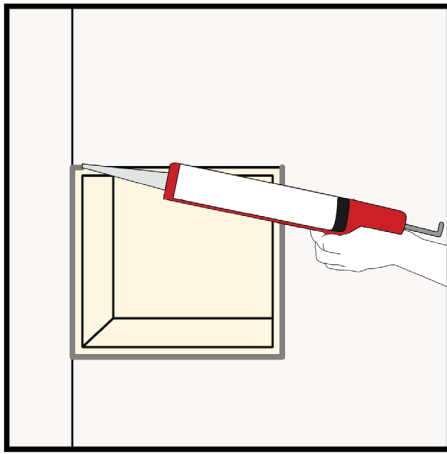

Step 5

Seal any gaps between wallboard and niche by applying polyurethane sealant adhesive (fast cure) around the niche.

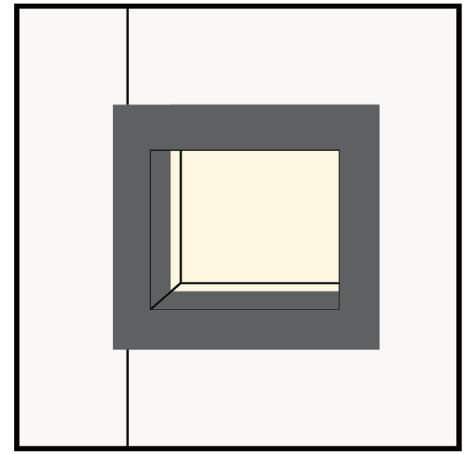

Step 6

Apply waterproof membrane, bandage to overlay the inside and outside surfaces of the Niche and Wallboard by minimum of 40mm.

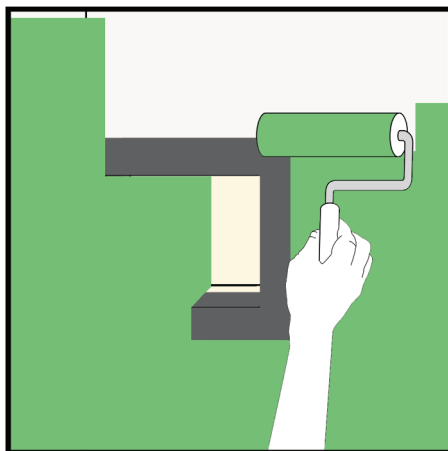

Step 7

Apply a waterproof membrane over the Niche and walls in accordance with manufacturer's instructions. Please note: It is recommended that a test patch is conducted first to ensure adequate adhesion.

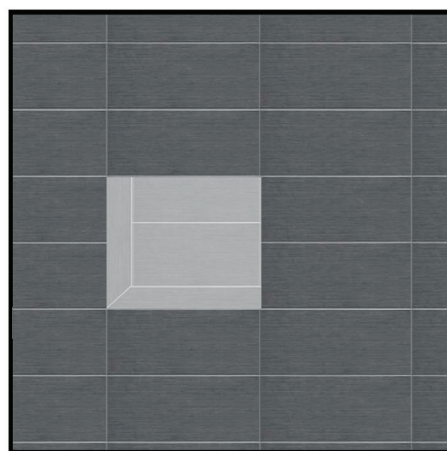

Step 8

The Niche is now ready to tile. To ensure proper adhesion it is recommended that the same brand of tile adhesive and waterproofing membrane are used as per manufacturer's instructions.