

CABINET SPECIFICATIONS



EDGE Scandi Oak Wall-Hung Cabinet

- Scandi Oak textured print on interior & exterior
- Bevelled edge pull-channel
- Soft-close doors & drawers
- Full extension drawer runners
- 16mm thick backing boards & drawer bases
- 650mm tall (without top)

600 width

60S

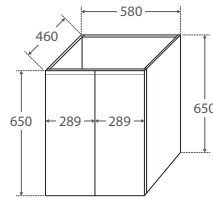

TOP VIEW: SHELF AREA

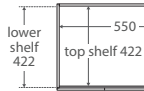

SIDE VIEW: SHELF STORAGE



Bevelled edge pull-channel



750 width

LEFT drawers: 75SL
RIGHT drawers: 75SR

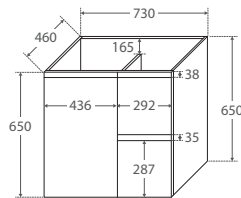

TOP VIEW: SHELF AREA & DRAWER AREA

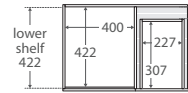

SIDE VIEW: SHELF STORAGE

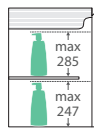

SIDE VIEW: RECESS & DRAWER STORAGE

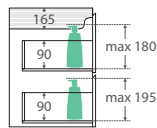

1200 width

120S

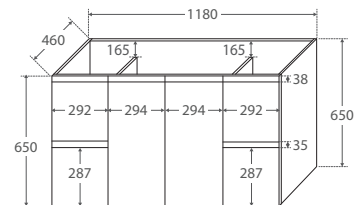

TOP VIEW: SHELF AREA & DRAWER AREA

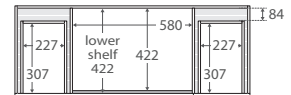

SIDE VIEW: SHELF STORAGE

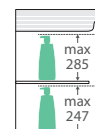

SIDE VIEW: RECESS & DRAWER STORAGE

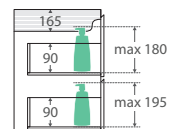

900 width

LEFT drawers: 90SL
RIGHT drawers: 90SR

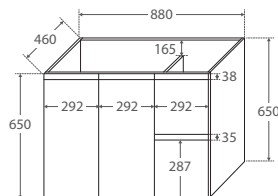

TOP VIEW: SHELF AREA & DRAWER AREA

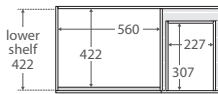

SIDE VIEW: SHELF STORAGE

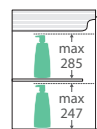

SIDE VIEW: RECESS & DRAWER STORAGE

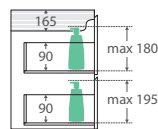

1500 width

150S

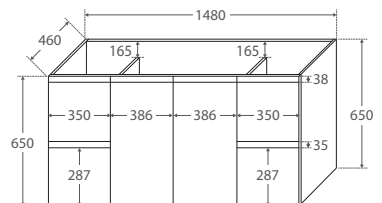

TOP VIEW: SHELF AREA & DRAWER AREA

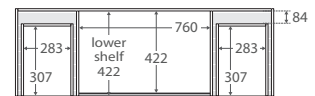

SIDE VIEW: SHELF STORAGE

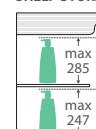

SIDE VIEW: RECESS & DRAWER STORAGE

