

Trespa Pura NFC® Flush Cladding System, Horizontal Installation

Make a facade drawing.

- We recommend you read the below instructions first to ensure correct placement of cladding and accessories.

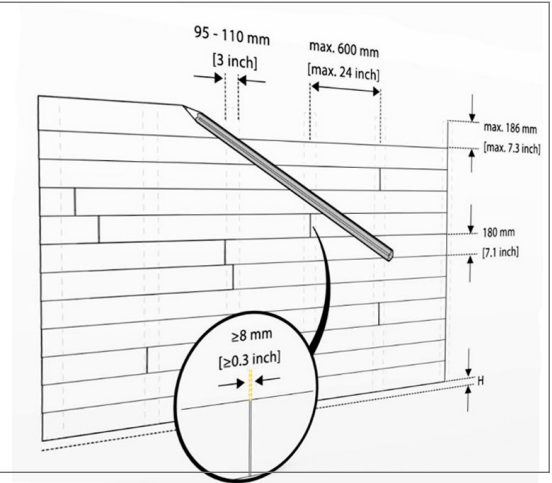

- Mount Vertical battens of 95-110mm width, minimum 34mm deep.
- The maximum distance between the vertical battens is 600mm on centre.
- Fix battens with flat head screws.
- It is essential that all battens are mounted in such a way that they provide a perfectly flat surface for the Pura cladding.



- Attach strips of EPDM rubber at least as wide as the vertical batten.
- Install a **Ventilation Profile** at the bottom, if applicable.



- Fit **Flush Siding Finish Profiles** and **Flush Siding Outer-Corner Profiles** as appropriate. These profiles are designed to provide aesthetically pleasing finishing options for your installation.
- Fix with **SFS Intec Profile Screws** along the length of the profile.
Note: Profiles must be pre-drilled prior to fixing profile screws.



- Place an installation bar (any straight edge bar) at a distance of 35mm from the starting height.
- The installation bar is used as attachment points for the first row of Universal Clips. It is essential all clips are set at the same height.
- **Note:** Allow for any undulations in the floor before setting the installation bar.



- Place the first row of **Universal Clips**, with the protruding head of the clip pointing down.
- Secure the Universal Clip with a screw in the top hole.



- Any intermediate joints for cladding require two Universal Clips to be placed, allowing a minimum 8mm gap between planks. This is to allow for any panel expansion.
- Do not place the clip on a finishing profile.

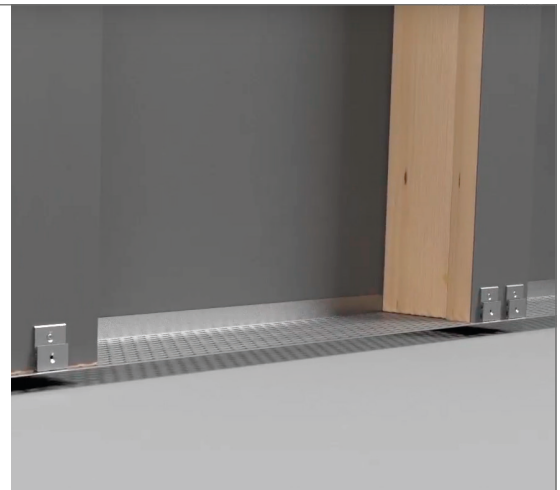

- When cutting the planks ensure that the blade cuts into the decorative surface and not out. (Generally a circular saw cuts on the up and a stationary blade cuts on the down. Please check the direction of the cut before commencing work.)

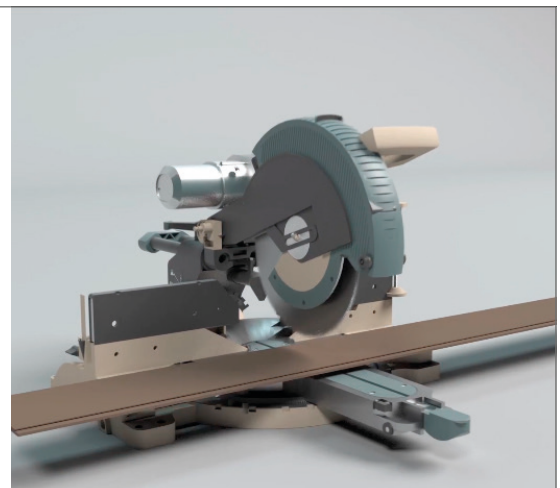

- Remove the installation bar.
- Place the flush cladding by sliding them from the top of the Universal Clips.
- The distance between Flush cladding and Flush finishing profiles must be 5mm.



- Place the second row of Universal Clips with the protruding head pointing up.
- Use the positioning tool provided to allow a 1mm vertical expansion between the cladding plank and the second row of Universal Clips.
- Secure the universal clip with a screw placed into the top hole.

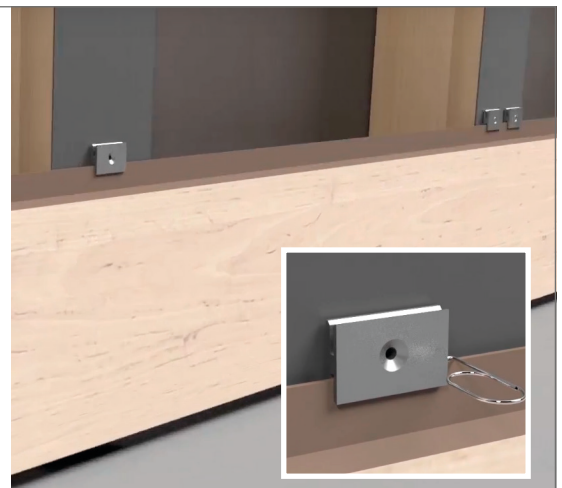

- Ensure that any intermediate joints allow an 8mm gap between planks.



- Drill one hole of 2mm in the thin part of each flush cladding.
- Fix each length piece of flush cladding with an oval head nail to prevent sliding. Use a nail punch to ensure the head is flat to the surface, if needed.

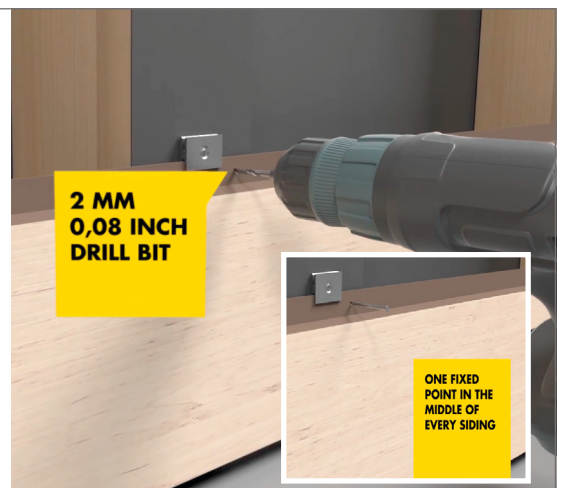

Place the second row of cladding, then the remainder, ensuring:

- Intermediate joints are supported on both sides by their own universal clip.
- That the intermediate joint is at least 8mm wide.
- Each flush cladding plank is secured with an oval head nail.



- Place the last row of flush cladding.
- Finish with Universal Clips if there is enough space.

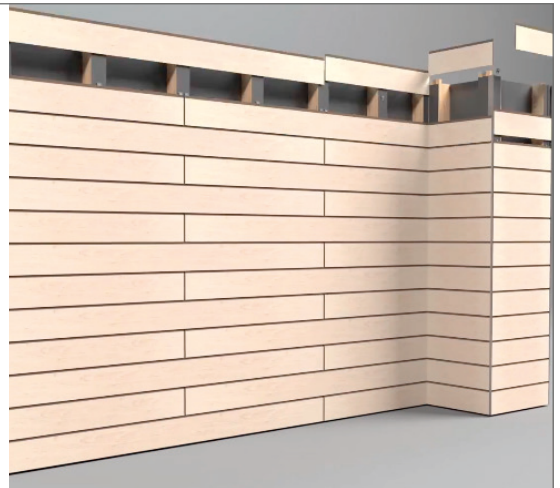

If there isn't enough space:

- Saw the top row of flush cladding to size.

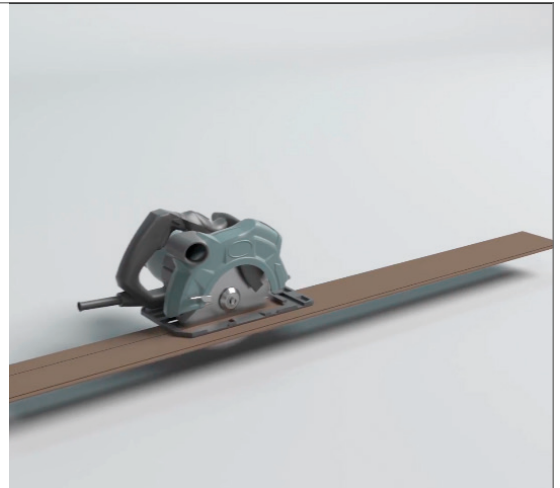

- Allow 5mm gap at the top for ventilation.



- Drill 8mm holes in the cladding, 20mm from the top.
- At least 20mm from the end of the flush cladding.
- Ensure that the most central point of the plank is pre-drilled with a 5mm hole to act as a fixed point.



- Secure the cladding with **SFS Intec HPL Fast Fixing Screws**, placing a 3mm installation ring or horseshoe spacer between the flush cladding and vertical batten.
- Fix each cladding plank with an oval head nail.



- Finish with a roof trim, for example, to cover the top row of Universal Clips or HPL Fast Fixing Screws.
- Remember to maintain the ventilation space of 5mm to allow for a clear, continuous air-gap.



This document is intended to provide guidelines for informational purposes only.

We strongly advise that the customer, project owner and architect seek independent advice from a certified construction professional and/or engineer regarding application and installation as well as compliance with design requirements, applicable codes, laws and regulations, and test standards. Please check your local codes and applicable design requirements for proper use.

For current product/technical information see www.trespa.info

Questions?

Please contact Performance Panels Limited on:
01422 310 319

Alternatively email us on:
info@performance-panels.co.uk



performance panels

www.performance-panels.co.uk