



# Siemens MAGNETOM Avanto Fit 1.5T

RELOCATABLE MRI BUILDING  
PLANNING GUIDE  
MR 11



# Table of Content

---

<b>Rental Solutions from Scandinavian Medical Solutions</b> .....	2
<b>System Specifications</b> .....	2
<b>Inventory</b> .....	9
<b>Equipment List</b> .....	11
<b>Dimensions &amp; Weight</b> .....	11
<b>Access to The Building</b> .....	13
<b>Environmental requirements</b> .....	16
<b>Minimum required Area</b> .....	16
<b>Minimum Container Sitting Conditions</b> .....	18
<b>Conditions of Container Lifting Guidelines</b> .....	19
<b>MRI Building Connection</b> .....	20
<b>Main Power Connection</b> .....	21

## Rental Solutions from Scandinavian Medical Solutions

At Scandinavian Medical offer solutions that differ from other rental solutions on the market, providing a flexible, cost-effective solution tailored to your requirements, timeline, and budget.

Our team has developed a unique and flexible rental concept, which provides you with a wide selection of customized alternatives to high-cost OEM equipment at a fixed monthly rate. There are no heavy investments, no risks, and no residual value.

We offer short – and long-term rental solutions - from fixed-site to trailers and modular rental solutions. Regardless of the challenges you face - be it replacement of equipment, breakdowns, bridging periods, or back-locks - we offer excellent solutions that ensure you can avoid downtime and optimize your scan capacity.

## System Specifications

---

- **Brand:** Siemens
- **Model:** Avanto Fit1.5T
- **YOM:** 2008
- **Upgrade YOM:** 2015
- **Channels:** 48 Channels
- **Gradients:** SQ Gradients
- **Magnet Type:** OR105
- **Coils:** Head/Neck 20, Peripheral Angio 36, Shoulder 16, Body 18, Breast 18, Foot/Ankle 16, Hand/Wrist 16, Flex Large, Flex Small
- **External workstation:** HP Z440
- **Software Version:** VE11E-SP01













RFI  
Asunto  
SL-25814  
PCL-00038  
Reserva de espacio para el control  
Reserva de espacio para el control



## Inventory

---

- Steel construction protected with fire-retardant paint R30.
- Housing – sandwich panels with PIR, color white,
- Window and door in operator room with interior blinds.
- Door to technical room and technical bridge – aluminium with panel.
- Magnetic shielding - fringe field not exceeding 0,5 mT out of building.
- RF room in accordance with the system requirements
- Chiller incl. cooling water installation.
- Air-conditioning with temperature control via a touch-panel.
- Electrical installations.

## Equipment List

---

- 1 planning guide
- 4 lifting eyes
- 1 aluminum Fire Extinguisher (in technical room)
- 1 ladder (in technical room)
- 1 Allen key

## Dimensions & Weight

---

MRI building with its dimensions you can see in Figure 1.

The height of container is **3,20m**. The length is **13m** and the width is **4m**.

The total weight of a building including the MRI Siemens Avanto Fit 1.5T system is about **35 tons**

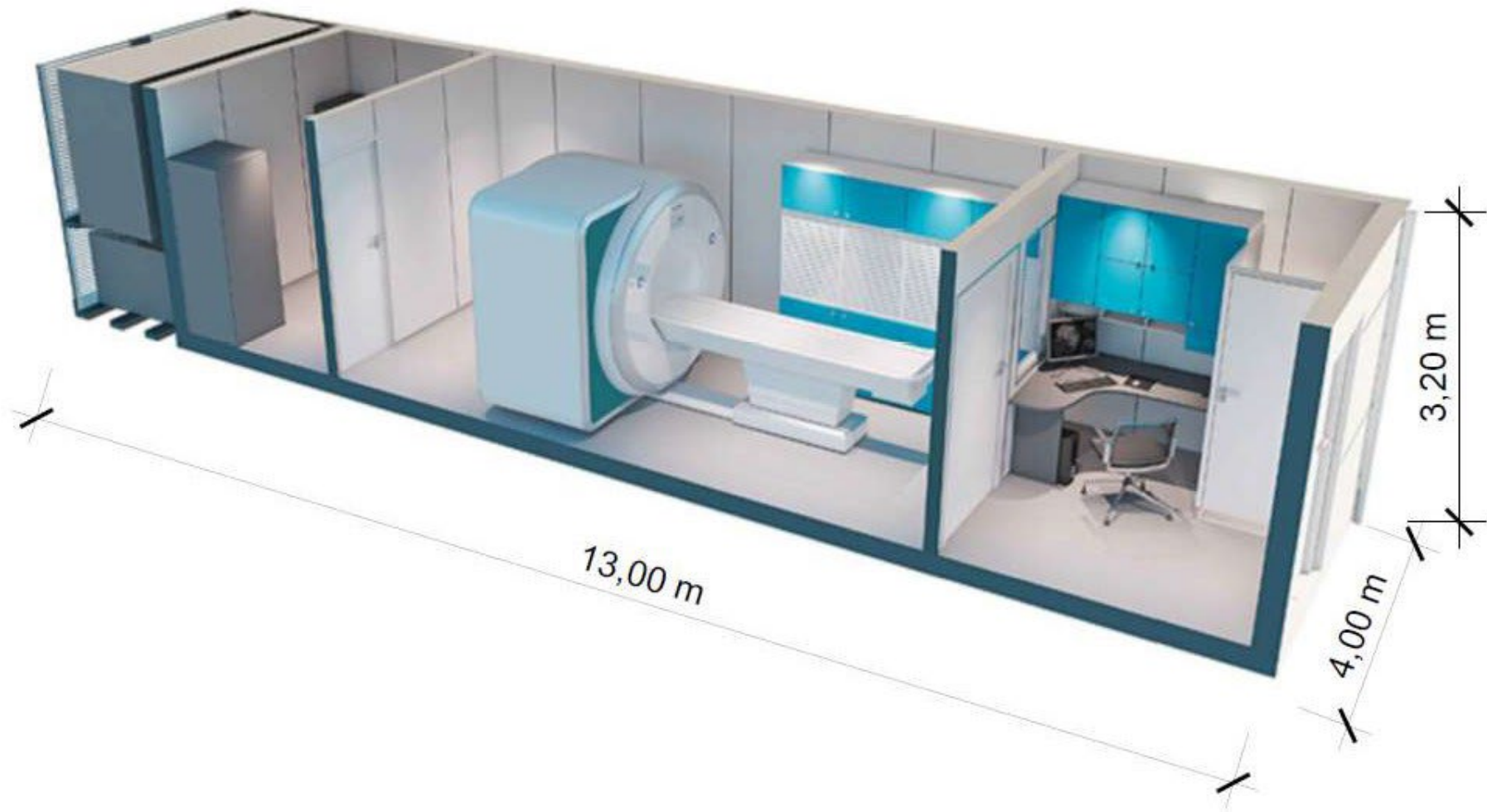

Figure 1 MRI building (can differ in furnishing and positioning of doors)

## Access to The Building

---

The relocatable MRI building can be accessed via three doors:

- Two doors leading to the operator room (patient and staff access)
- One door leading to the technical room (service access).

On the rear wall there are service doors to the technical bridge. On the left wall you can find handle for ladder, that gives access to the roof. Service access can be found in Figure 3. Mentioned doors you can find in Figure 2. Connection points you can find in Figure 3 and 4. Drainage you can find in Figure 5.

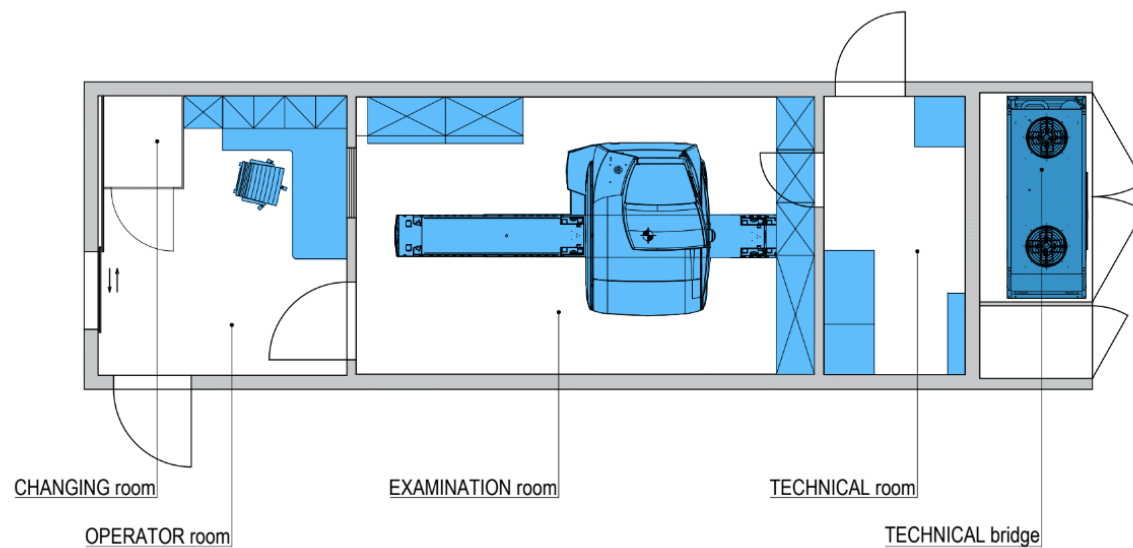

Figure 2

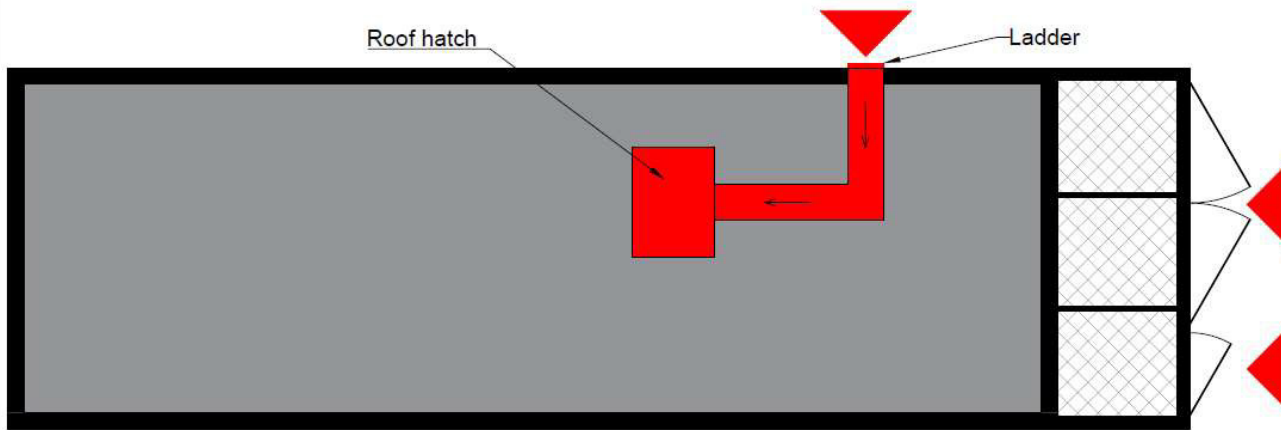
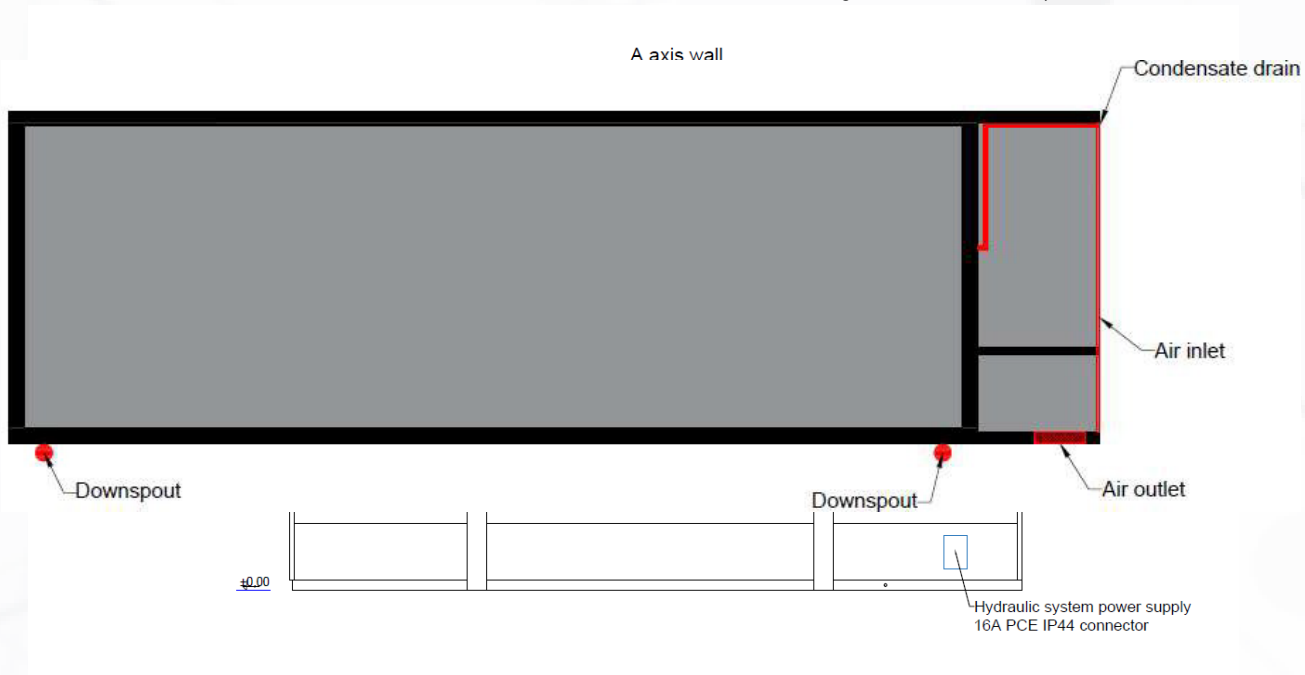

Figure 3 Service Access and connections

Figure 4 Connection points

Figure 4 Connection points







## **Environmental requirements**

---

All necessary administrative consents needed for the unit installation in the indicated area and for entry and unloading should be provided. Also, permission to enter and work the crane from 6am to 6pm must be provided.

It is necessary to prepare and secure the access road to the entry of heavy equipment and the foundation of the unit. Moreover, maximum 1 % terrain deferral. If more, site preparation with ground leveling is to be handled prior to installation.

## **Minimum required Area**

---

To enable access to all parts of the MRI building you need to provide suitable area. Required area for the unit is: 16,60 m x 6,20 m and is shown in the Figure 7.

Contact our technical department for the detailed minimum required area.

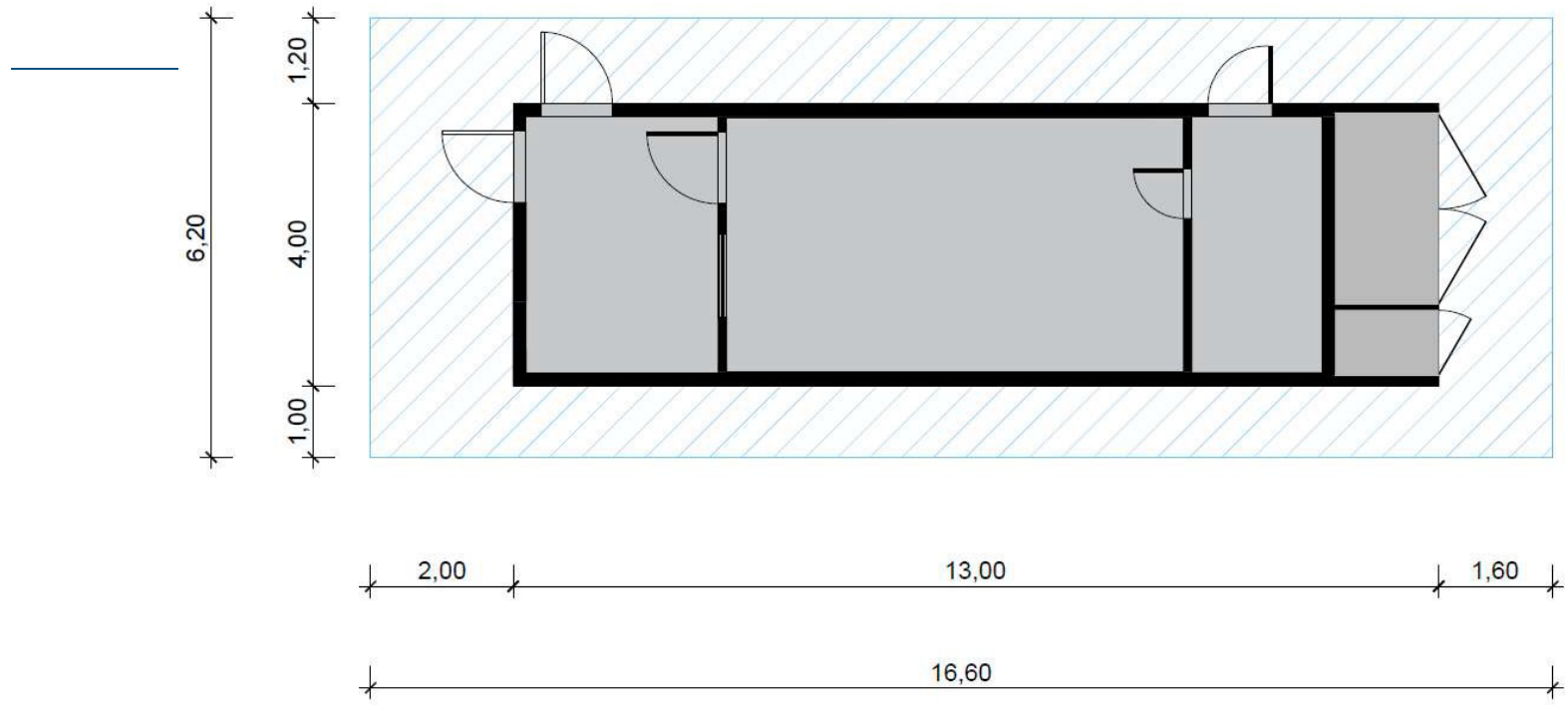

Figure 5 Required Area

## Minimum Container Sitting Conditions

A level ground should be prepared for unit installation with an accuracy of 10mm. Typical foundation is shown in Figure 6. Detailed information about preparing the ground can be found in the technical documentation.

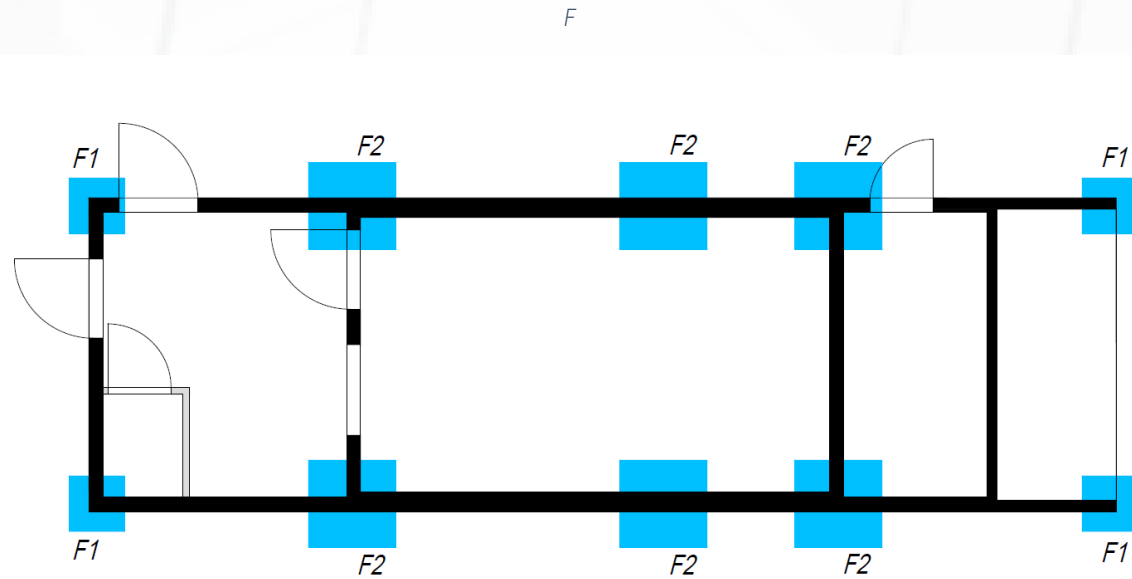

Figure 6 Sitting Conditions



# Conditions of Container Lifting Guidelines

The unit should be lifted by 4 lifting brackets mounted on the upper frame. The lifting scheme you can see in the Figure 7. The crane selection is considered individually for each project.

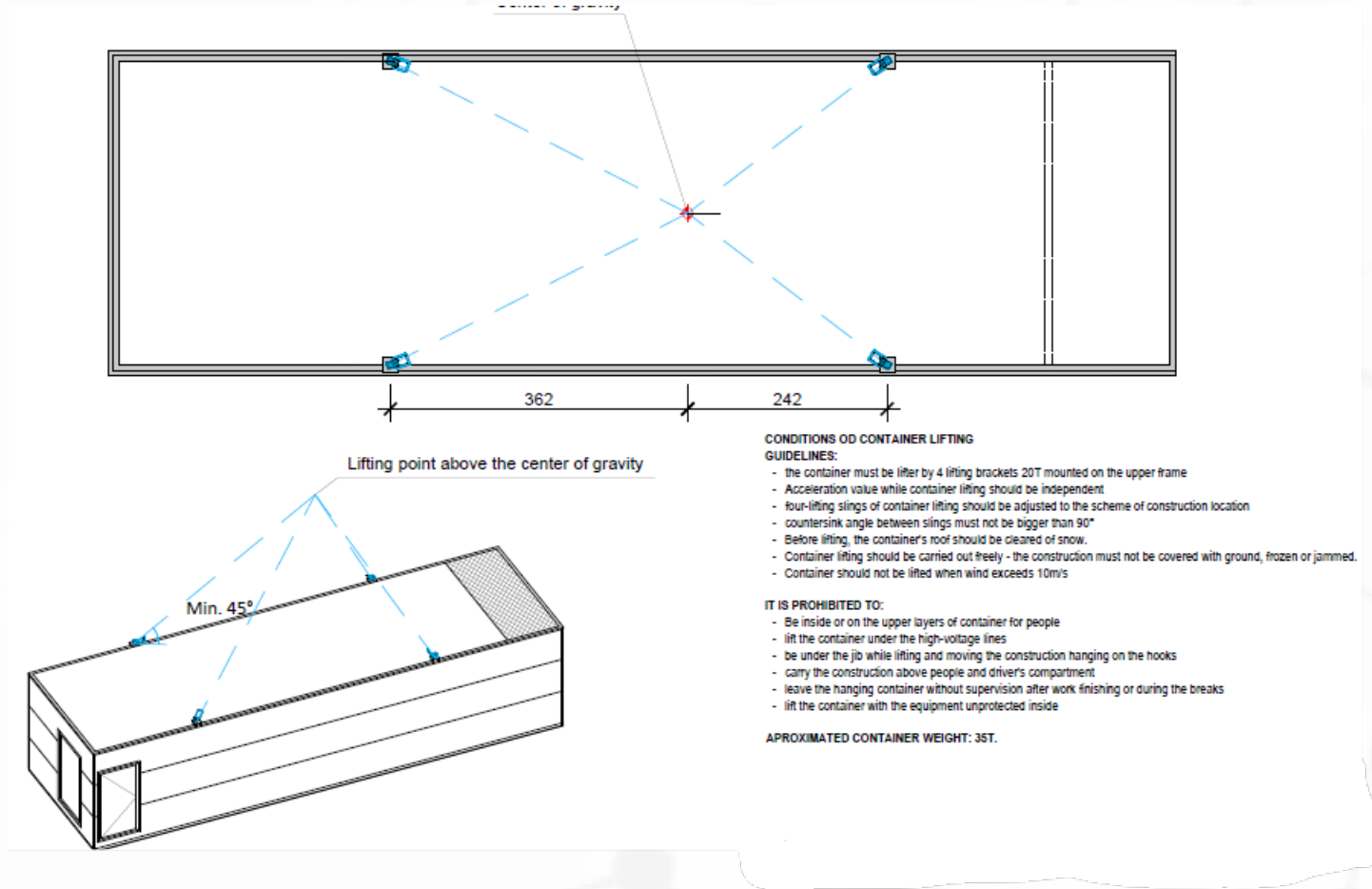

Figure 7 Lifting Points

## MRI Building Connection

It is necessary to ensure power supply and connection of the building by a person with appropriate qualifications. The unit should be connected within no more than 2 hours from the setting it up. The connection boxes with dimensions can be found in Figure 8.

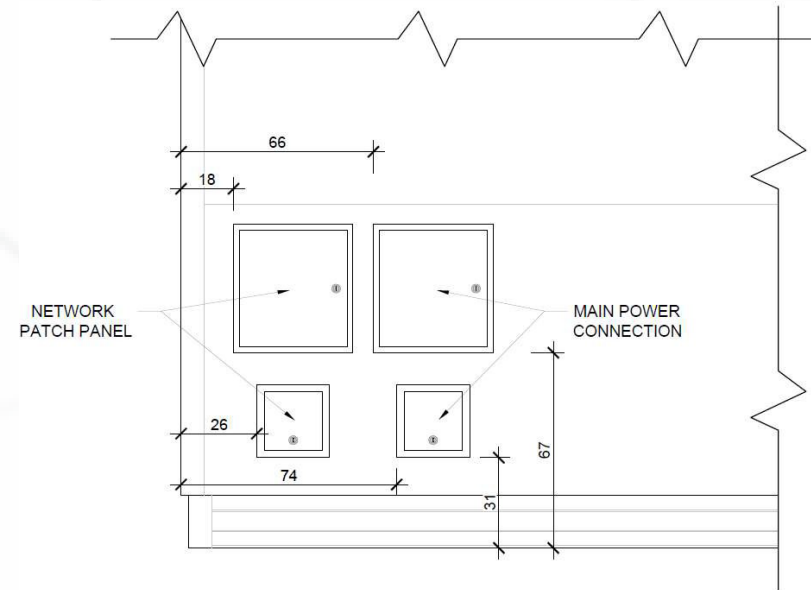

Figure 8 Connections

## Main Power Connection

Applying power to the main power connection, connecting the building to electricity, and performing protective measurements after connecting the power supply are the responsibility of the user. These activities must be performed by a person with appropriate qualifications. Connecting the building should take place within 2 hours from setting up the building.

Power connection details:

**Building incl. chiller: 63A (43kVA)**

**With minimum protection: 80A – gG**

**MRI system: 160A**

**(110kVA)**

**With minimum protection: 100A – gG**

**Voltage: 400 V**

**Frequency: 50/60 HZ**



## Contact

 +45 53 70 11 38 or +45 25 31 80 80

 Gasvaerksvej 48, 1st Floor Right, 9000 Aalborg, Denmark

 [scandinavian-medical.com](http://scandinavian-medical.com)

 [rental@scandinavian-medical.com](mailto:rental@scandinavian-medical.com)