



**Product:** 24 Inch Indoor Outdoor Refrigerator Drawers

**Model Number:** TRF24U

**FEATURES & BENEFITS**

- + **Easy Installation** - Unit available as built-in or freestanding for easy installation in any space
- + **Convection Cooling System** - Convection cooling system provides a quick cool down and consistent temperature
- + **Indoor and Outdoor Rated** - Rated for both indoor and outdoor use so add it to your man cave or keep it out by the grill
- + **Large Storage Space** - 5.4 cubic feet of capacity easily stores all the beers, and then some
- + **Digital Controls** - Digital touch pad with LED display makes it easy to adjust temperature settings
- + **Soft Close Drawers** - Two soft close drawers equipped with a bright white and blue LED lights to easily find your beverage of choice
- + **Anti-finger Print Surface** - Stainless steel design offers modern, smudge-free design aesthetic
- + **Adjustable Leveling Legs** - Four adjustable leveling legs keep the unit balanced regardless of its location
- + **Quiet Operation** - 44 db sound level for supremely quiet operation.

**TECHNICAL DETAILS**

Appliance Type	Refrigerator
Color/Finish	Stainless Steel
Refrigerator Capacity	152 L (5.4 cu. ft.)
Gross Weight (lb.)	126 lb.
Net Weight (lb.)	114 lb.
Number of Drawers	2
Number of Shelves	1 Shelf
Number of Baskets/Bins	1 Basket/Bin

**PRODUCT DIMENSIONS**

Depth (Excluding Handles)	23 5/16"
Depth (Less Door)	21 3/8"
Height to Top of Door Hinge (in.)	34 3/16"
Product Depth (in.)	23 3/8"
Product Width (in.)	23 1/2"
Depth (Including Handles)	25 5/7"
Height to Top of Refrigerator (in.)	34 3/16"
Product Height (in.)	34 3/16"
Refrigerator Width (In.)	23 1/2"



**WARRANTY: 2 YEARS ON PARTS AND LABOR**



**TOP DRAWER**

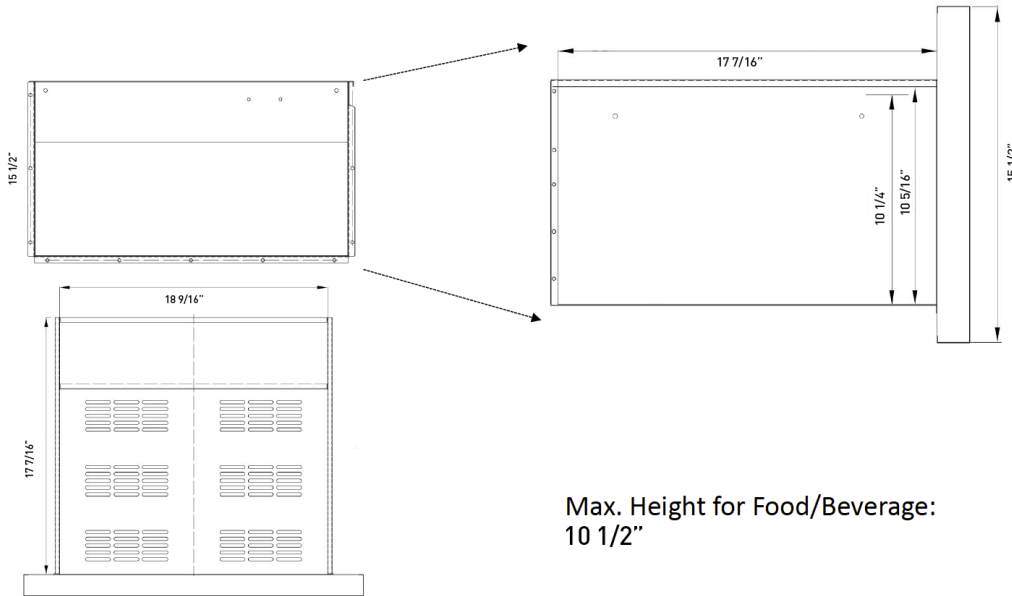

Max. Height for Food/Beverage:  
10 1/2"

**BOTTOM DRAWER**

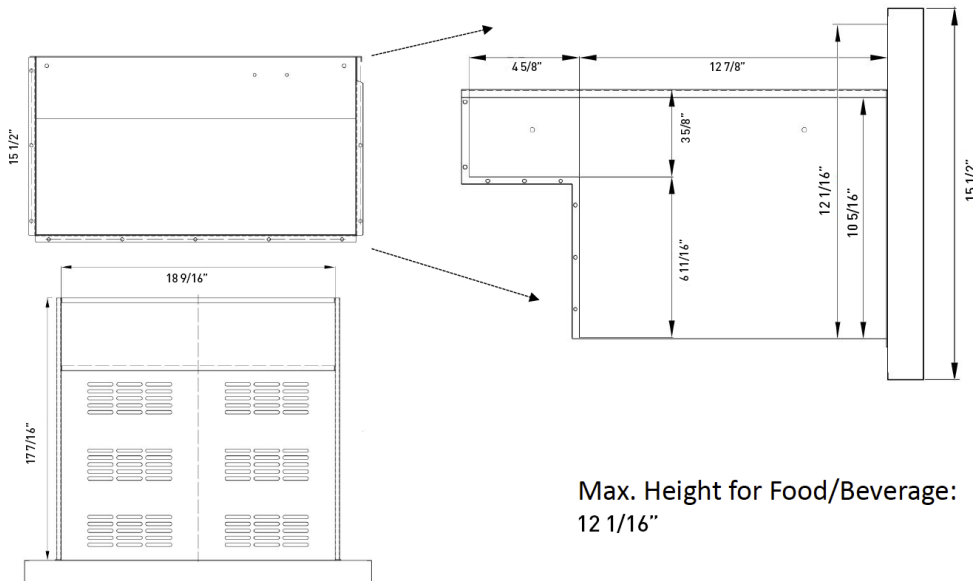

Max. Height for Food/Beverage:  
12 1/16"