

ULTRAVIOLET

DISINFECTION SYSTEM

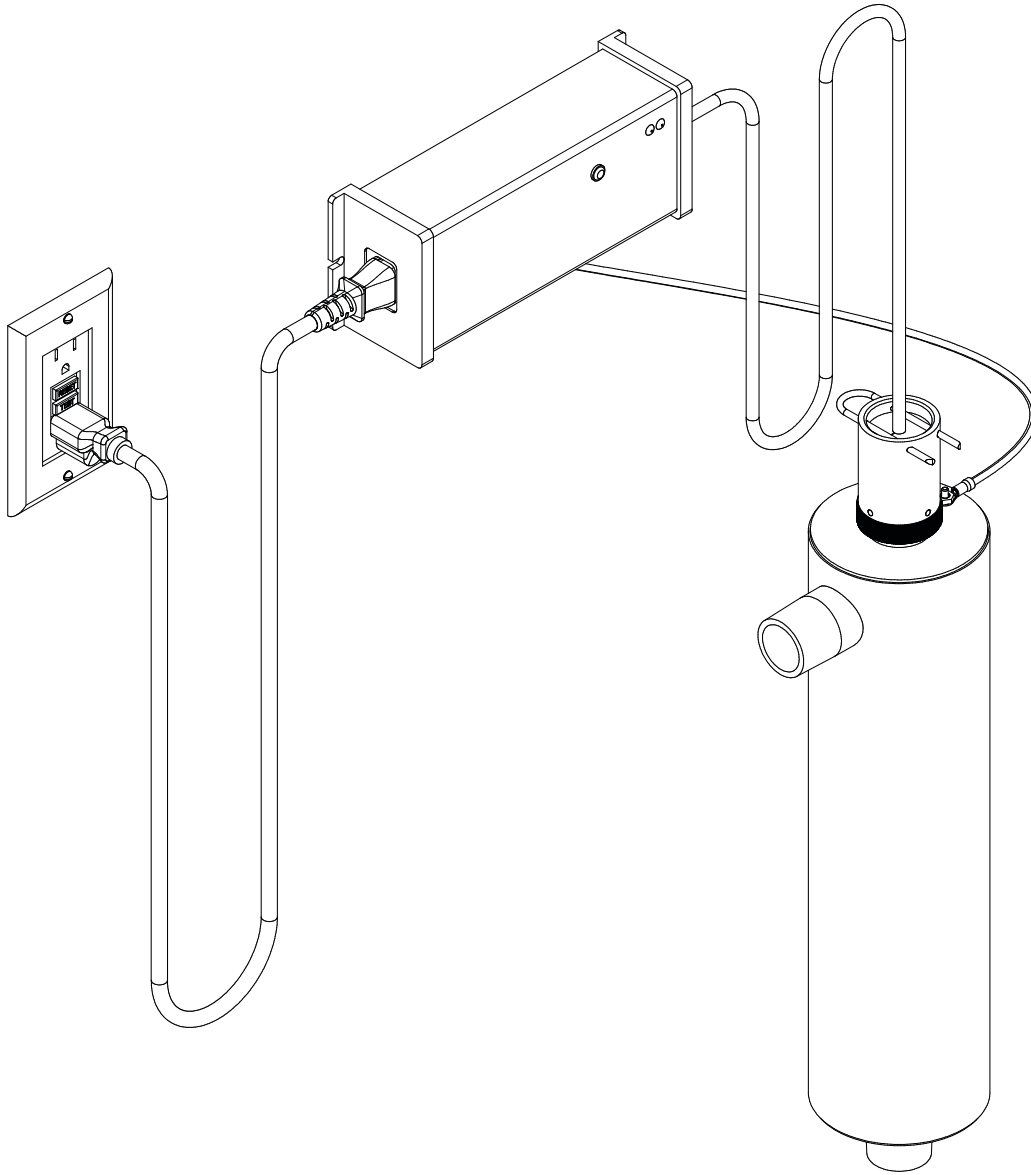

PROFESSIONAL INSTALLATION, OPERATING AND SERVICE MANUAL

PPUV009

PPUV016

PPUV030

PLEASE CAREFULLY READ INSTRUCTIONS BEFORE INSTALLING SYSTEM
FOLLOW ALL STATE AND LOCAL CODES AND REGULATIONS FOR PLUMBING AND ELECTRICAL.
INSTALLATION BY A CERTIFIED PLUMBER IS RECOMMENDED.

PROTECT PLUS
WATER FILTRATION
PROTM

JOB SPECIFICATIONS

MODEL NO. _____
 INSTALLATION DATE _____
 SERIAL NUMBER _____
 INSTALLER NAME _____ PHONE _____
 ADDRESS _____

WATER TEST AT TIME OF INSTALLATION

_____ Hardness CaCo ₃ (gpg)	Other: _____
_____ pH	_____
_____ Chlorine (ppm)	_____

SIZING INFORMATION

All Water is Treated Except:

_____ Rear Hose Bib _____ Front Hose Bib _____ Kitchen Cold _____ Toilets _____ All Cold
 _____ Other _____

The average family uses 50 gallons per person daily for all water uses in the home.

_____ Daily Water Usage (Gallons/Person)
 x _____ Family Size (Number of people in family)
 = _____ Total Gallons Per Day
 x _____ Grains Per Gallon of hardness
 = _____ Total Grains per Day

TABLE OF CONTENTS

Safety Instructions	4
Product Overview	5
Dimensions	6
Specifications	7
Water Chemistry	8
Installing your UV Disinfection System	8-9
Disinfection Procedure	10
Operating & Maintenance Instructions	11
Electronic Ballast Operation	12
Exploded Diagram	13
Troubleshooting	14
Warranty	15-16

PLEASE CAREFULLY READ INSTRUCTIONS BEFORE INSTALLING SYSTEM

FOLLOW ALL STATE AND LOCAL CODES
AND REGULATIONS FOR PLUMBING AND ELECTRICAL.
INSTALLATION BY A CERTIFIED PLUMBER IS RECOMMENDED.

Safety Instructions:

WARNING - to guard against injury, basic safety precautions should be observed, including the following:

- 1. READ AND FOLLOW ALL SAFETY INSTRUCTIONS.**
- 2. CAUTION** - Always disconnect power before servicing.
- 3. DANGER - *Warning: the UV light given off by this unit can cause serious burns to unprotected eyes and skin. Never look directly at an illuminated UV lamp. When performing any work on the UV disinfection system always unplug the unit first. Never operate the UV system while the UV lamp is outside of the UV chamber.***
- 4. DANGER** - To avoid possible electric shock, special care should be taken since water is present near electrical equipment. Unless a situation is encountered that is explicitly addressed by the provided maintenance and troubleshooting sections, do not attempt repairs yourself, refer to a certified plumber/technician.
- Carefully examine the disinfection system after installation. It should not be plugged in if there is water on parts not intended to be wet such as the ballast or lamp connector.
- Do not operate the disinfection system if it has a damaged cord or plug, if it is malfunctioning or if it has been dropped or damaged in any manner.
- Always disconnect water flow and unplug the disinfection system before performing any cleaning or maintenance activities. Never yank the cord to remove from an outlet; grasp the wall plug and pull to disconnect.
- Do not use this disinfection system for other than intended use (potable water application). The use of attachments not recommended or sold by the manufacturer/distributor may cause an unsafe condition.
- Intended for indoor use only. Do not install this disinfection system where it will be exposed to the weather or to temperatures below freezing. Do not store this disinfection system where it will be exposed to temperatures below freezing unless all water has been drained from it and the water supply has been disconnected.
- Read and observe all the important notices and warnings on the water disinfection system.
- If an extension cord is necessary, a cord with a proper rating should be used. A cord rated for less Amperes or Watts than the disinfection system rating may overheat. Care should be taken to arrange the cord so that it will not be tripped over or pulled.
- A dedicated circuit breaker must not exceed the electronic ballast power cord current rating (10A for 125V, 18AWG x 3C, SVT or SJT cord type).
- To avoid creating an electric shock hazard, never attempt to operate the disinfection system unless it has first been properly grounded.
- To prevent an electric shock, do not plug the disinfection system into any socket that has not been equipped with a Ground Fault Circuit Interrupter (GFCI).
- 15. SAVE THESE INSTRUCTIONS.**

Note: The UV lamp inside the disinfection system is rated at an effective life of approximately 9000 hours. To ensure continuous protection, replace the UV lamp annually.

PRODUCT OVERVIEW:

Please read this manual thoroughly for a detailed explanation of the system.

The following is a description of the components that make up the system.

Ensure that the following components accompany the system.

To ensure system performance, all replacement components should be purchased from an authorised dealer.

The use of components purchased from other sources will void the warranty and could cause the system to operate at a lower performance than intended.

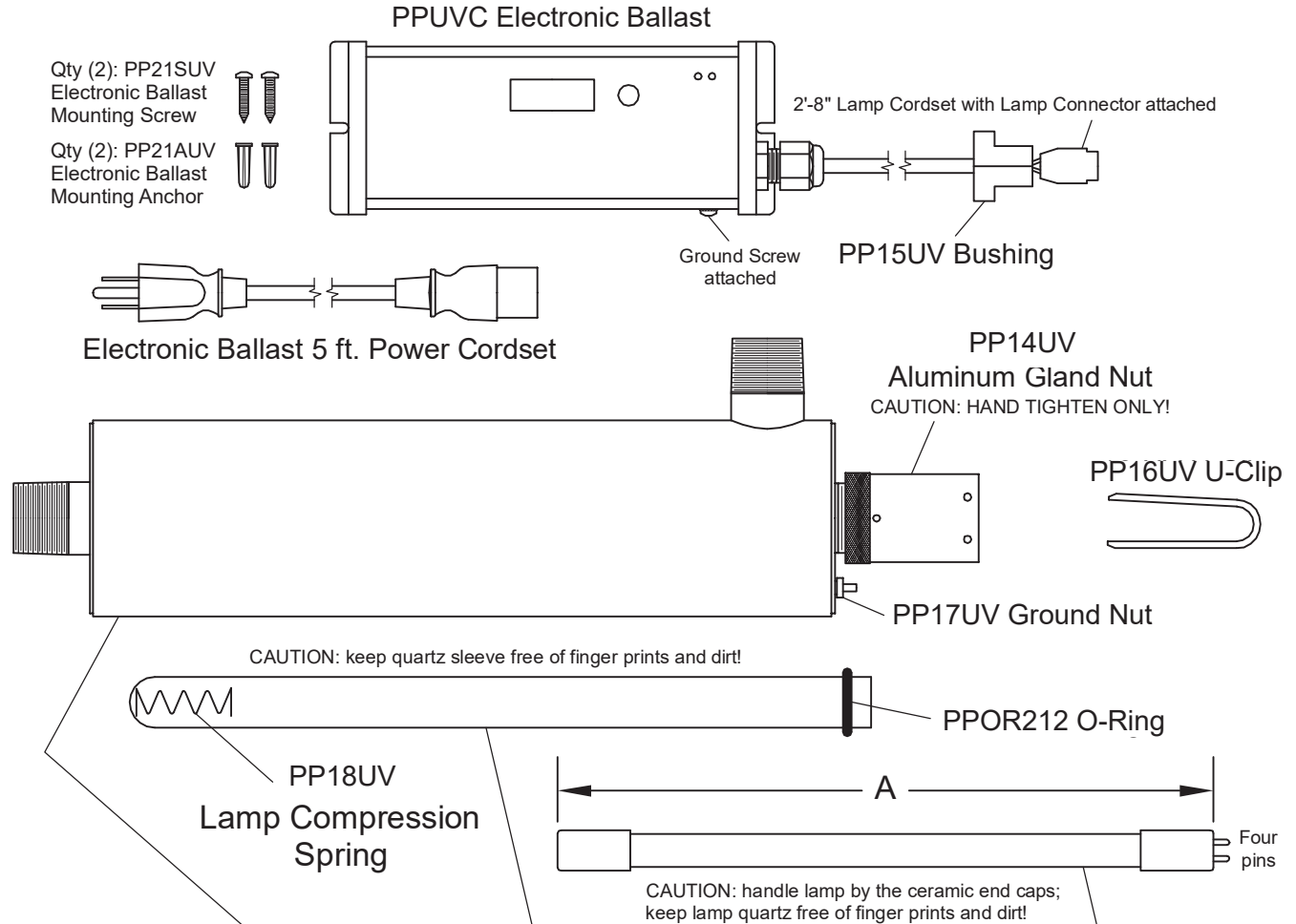

Model	SS UV Chamber	Domed Quartz Sleeve (length)	UV Lamp (A)
PPUV009	PP100UV	PPQ6 (13-1/8")	PPL6 (11-13/16")
PPUV016	PP200UV	PPQ10 (21-3/8")	PPL10 (20-1/16")
PPUV030	PP300UV	PPQ20 (34-3/4")	PPQ20 (33-3/16")

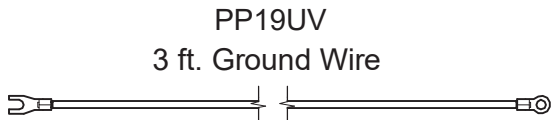

PPOR212 O-Ring (spare)



Qty (2): PP20UV
UV Chamber
Mounting Bracket

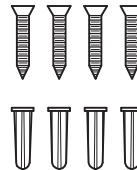
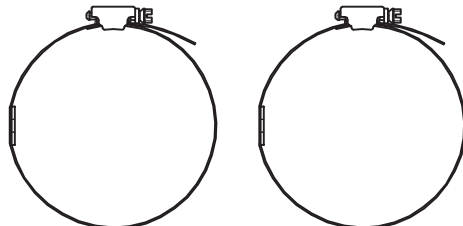

Qty (4): PP20SUV
Mounting Bracket Screw

Qty (4): PP20AUV
Mounting Bracket Anchor

DIMENSIONS:

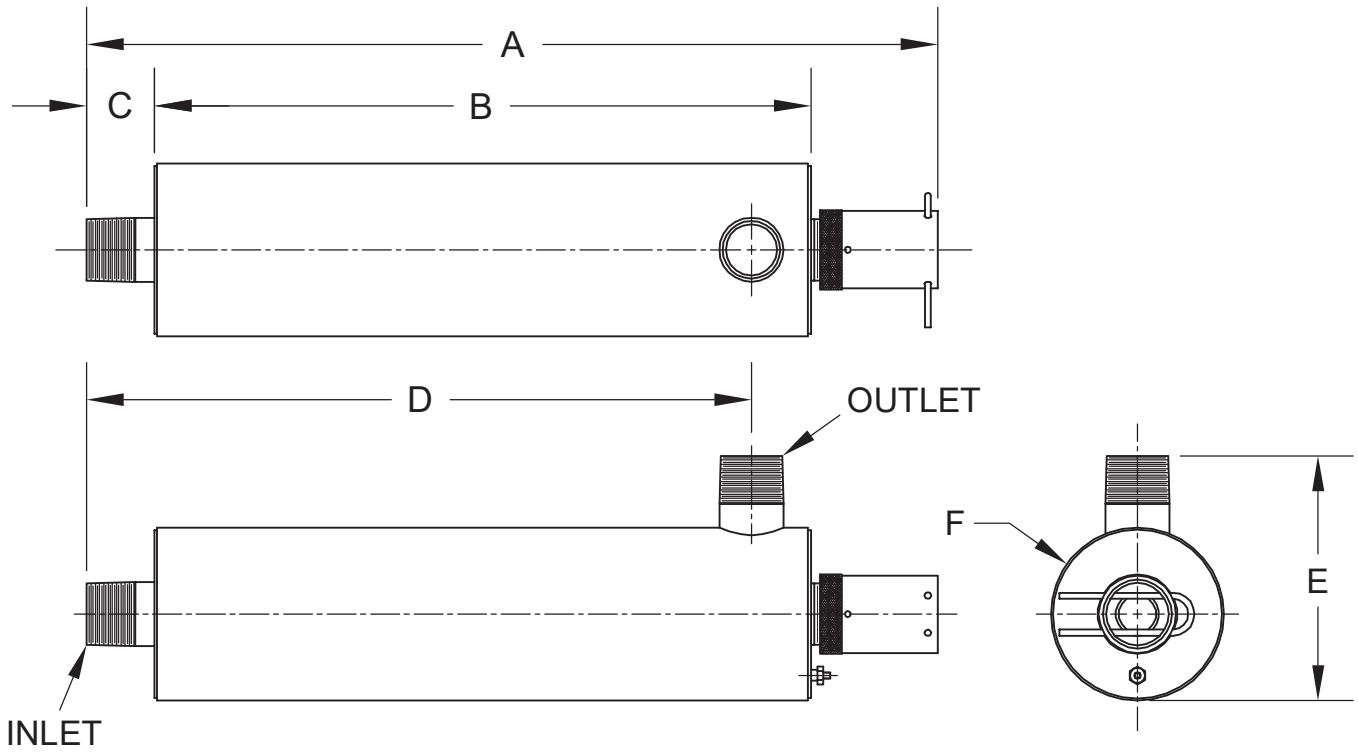

MODEL	A	B	C	D	E	F (DIA.)	INLET/OUTLET
PPUV009	17-3/8	13-3/8	1-3/8	13-9/16	5	3-1/2	1.0 MNPT
PPUV016	25-5/8	21-11/16	1-3/8	21-13/16	5	3-1/2	1.0 MNPT
PPUV030	39-3/4	35-1/16	2-1/8	35-9/16	5-1/4	3-1/2	1.5 MNPT

GENERAL NOTES FOR ESTIMATING ONLY.
ALL DIMENSIONS ARE IN INCHES.

PART NUMBER PPUVC ELECTRONIC BALLAST/CONTROLLER

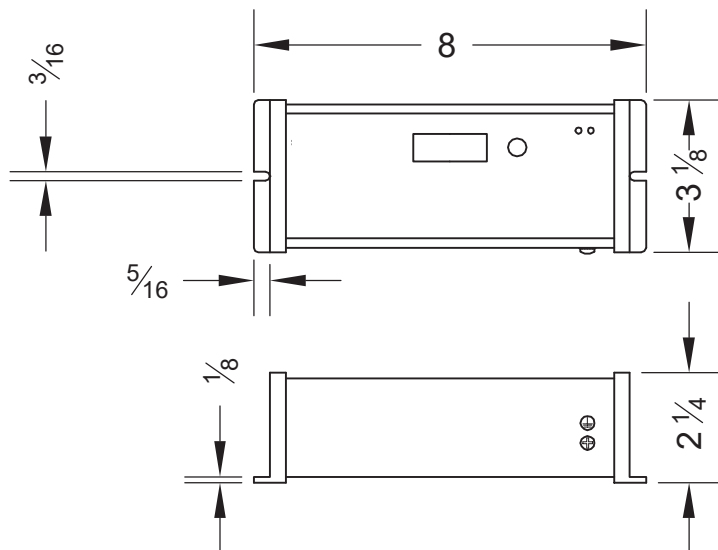

SPECIFICATIONS:

	FLUENCE (UV DOSE)	MODEL PPUV009	MODEL PPUV016	MODEL PPUV030
FLOW RATE ⁽¹⁾	US PUBLIC HEALTH 16mJ/cm ²	17 GPM	35 GPM	55 GPM
	INDUSTRY STANDARD 30mJ/cm ²	9 GPM	16 GPM	30 GPM
	NSF/EPA 40mJ/cm ²	7 GPM	14 GPM	22 GPM
ELECTRICAL	VOLTAGE ⁽²⁾	110V to 240V AC 50/60Hz		
	POWER CONSUMPTION	34 W	50 W	90 W
	LAMP WATTS	29 W	45 W	80 W
INLET/OUTLET PORT SIZE	1.0" MNPT	1.0" MNPT	1.5" MNPT	
MAXIMUM OPERATING PRESSURE	125 PSI			
PRESSURE DROP at 30mJ/cm ² RATED FLOW	LESS THAN 1 PSI			
AMBIENT AIR & WATER TEMPERATURE	36 to 104°F			
LAMP TYPE	LOW PRESSURE HIGH OUTPUT (LPHO)			
CHAMBER MATERIAL	304 SS			
LAMP-ON INDICATOR	STEADY "WORK" GREEN LED			
LAMP LIFE REMAINING (DAYS)	VISUAL COUNT DOWN DISPLAY (365 - 0); MANUAL RESET FUNCTION			
LAMP REPLACEMENT REMINDER	VISUAL DISPLAY (A3), "FAULT" RED LED FLASHES and AUDIBLE ALARM SOUNDS INTERMITTENTLY (1 SEC. BEEP EVERY 5 SEC.)			
LAMP REPLACEMENT REMINDER DELAY	SILENCES AUDIBLE ALARM FOR 7 DAYS, REPEATABLE UP TO 4 TIMES (28 DAYS MAXIMUM)			
LAMP FAILURE INDICATOR	LAMP LIFE REMAINING (DAYS) CONTINUES TO BE DISPLAYED BUT STOPS COUNTING DOWN, "FAULT" RED LED FLASHES and AUDIBLE ALARM SOUNDS INTERMITTENTLY (1 SEC. BEEP EVERY 1 SEC.)			
BALLAST TOTAL RUNNING DAYS	VISUAL INCREMENTAL DISPLAY (0 - 9999); CANNOT BE RESET			
BALLAST FAILURE INDICATOR	BLANK DISPLAY			

⁽¹⁾ At flow rates stated, the corresponding fluence (UV dose) levels are theoretically met or exceeded at 95% UVT and EOL (end of lamp life; 1 year). *UVCalc*[®], developed by Bolton Photosciences Inc., is based on calculations of fluence rates (irradiances) using the multiple point source summation approximation with full accommodation of reflection and refraction occurring at the air/quartz/water interface and is the only mathematical fluence rate model that has been experimentally verified.

⁽²⁾ Models are supplied with a 5 FT. power cordset for 120V AC 60 Hz (NEMA 5-15P plug to IEC 60320/C13 connector).

Water Chemistry:

Water quality is extremely important for the optimum performance of your UV system. The following levels are recommended for installation:

- Iron: < 0.3 ppm (0.3 mg/L)
- Hardness*: < 7 gpg (120 mg/L)
- Turbidity: < 1 NTU
- Manganese: < 0.05 ppm (0.05 mg/L)
- Tannins: < 0.1 ppm (0.1 mg/L)
- UV Transmittance: > 75% (call factory for recommendations on applications where UVT < 75%)

*Where total hardness is less than 7 gpg, the UV unit should operate efficiently provided the quartz sleeve is cleaned periodically. If total hardness exceeds 7 gpg, the water should be softened. If your water chemistry contains levels in excess of those mentioned above, proper pre-treatment is recommended to correct these water problems prior to the installation of your UV disinfection system. These water quality parameters can be tested by your local dealer, or by most private analytical laboratories. **Proper pre-treatment is essential for the UV disinfection system to operate as intended.**

Installing your UV Disinfection System:

- **CAUTION**, electronic ballast must be connected to a grounded receptacle. A ground fault protected circuit (GFCI) is recommended.
- The disinfection system is designed to be mounted either horizontally or vertically at the point-of-use or point-of-entry depending on the specific flow rate of the unit. **NOTE:** The ideal installation is vertical with the lamp connector on top. This is to prevent water damage from occurring on the lamp connector and lamp pins. Leave space at least equal to the overall length of the disinfection system to allow clearance for the removal and replacement of the lamp and/or quartz sleeve.
- The electronic ballast should be mounted either above or beside the stainless steel UV reactor chamber. Never mount ballast vertically with AC connector at top of ballast to prevent moisture from running down cordage and causing a potential fire hazard. Drip loops in all cordage connected to ballast is highly recommended.
- The complete water system, including any pressure or hot water tanks, must be sterilized before start up by flushing with chlorine (household bleach) to destroy any residual contamination (see page 8).
- The disinfection system is intended for indoor use only. Do not install disinfection system where it may be exposed to the weather. Protect system from freezing temperature.
- Refer to specifications page for ambient conditions and maximum operating pressure.
- Install the disinfection system on cold water line only.
- If treating the entire house, install the disinfection system before any branch lines.
- A 5 micron sediment filter must precede the disinfection system. Ideally, the disinfection system should be the last treatment the water receives before it reaches the faucet.

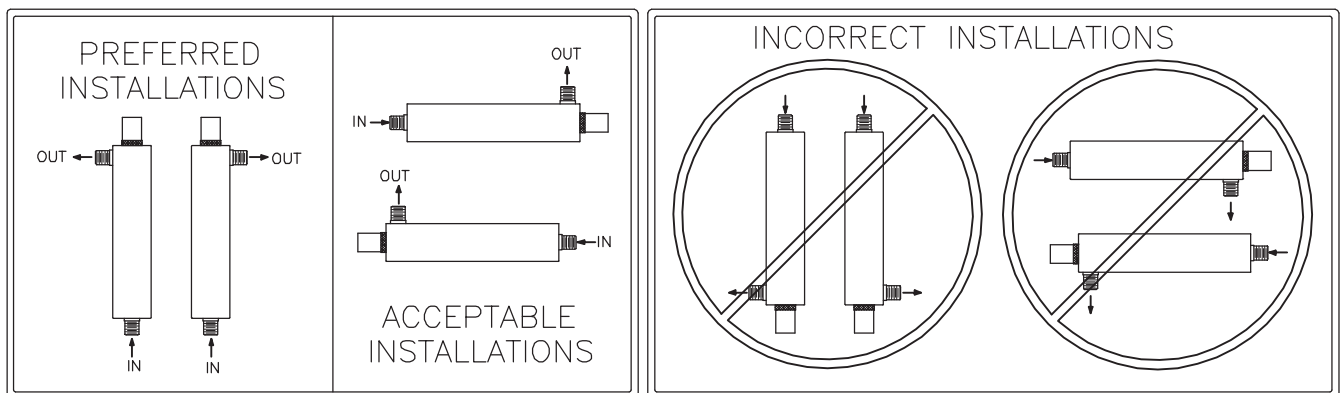

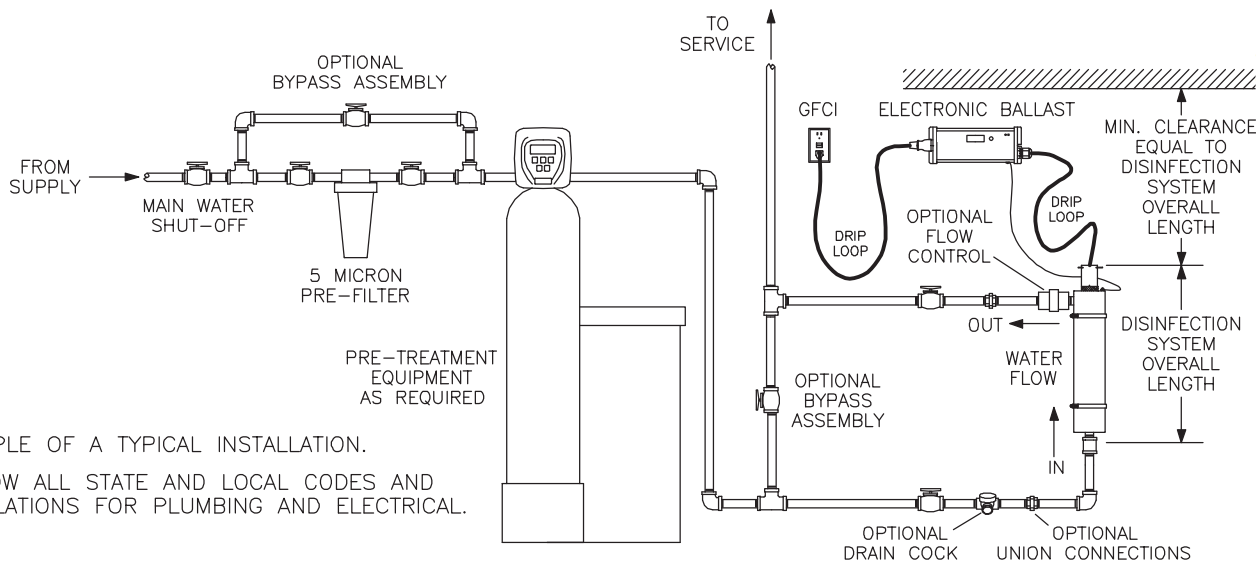

EXAMPLE OF A TYPICAL INSTALLATION.

FOLLOW ALL STATE AND LOCAL CODES AND REGULATIONS FOR PLUMBING AND ELECTRICAL.

1. The above picture shows the installation of a typical disinfection system and the related components that may be used for the installation. The use of a by-pass assembly is recommended in case the system requires “off-line” maintenance. If this is the case, it must be noted that the system will require supplementary disinfection of the distribution system if any water is used during this by-pass condition. In addition, during by-pass, the water will NOT be disinfected. Please refer to the complete disinfection procedure as outlined on page 10 of this document. If the water is to be consumed while the system is off-line, the water must be boiled for twenty minutes prior to consumption.
2. Select a suitable location for the disinfection system and its related components. As it is recommended to install a ground fault protected circuit (GFCI), make sure that this is taken into consideration prior to any installation. The system can either be installed vertically(inlet port at the bottom), or horizontally, however the vertical installation is the most preferred method. When selecting a mounting location, you must also leave enough space to allow for the removal of the UV lamp and/or quartz sleeve (minimum clearance equal to disinfection system overall length; refer to dimensions page).
3. Install the quartz sleeve as outlined on page 11.
4. Mount the system to the wall using the supplied clamps. Various connection methods can be used to connect the water source to the system, however union type connectors are recommended. The use of a flow restrictor device is strongly recommended when installing your system in order to maintain the manufacturer’s rated flow rate. The flow restrictor should be installed on the outlet port and is designed to be installed in one direction only. Ensure that the flow of the water matches the flow direction as indicated on the flow restrictor. **DO NOT SOLDER CONNECTIONS WHILE ATTACHED TO THE SYSTEM AS THIS COULD DAMAGE THE O-RING SEALS.**
5. Mount the electronic ballast controller horizontally to the wall, near the UV reactor chamber. Ideally place the controller above the reactor and away from any water connection point, to prevent any water from potentially leaking onto the controller by means of a leak at a connection point or a “sweating” system. Make sure you allow for a “drip-loop” on the lamp power cord, again to prevent any water from potentially entering the controller. A ground stud and nut are provided on the UV reactor chamber. Attach the supplied 3 foot long, #14 AWG green ground wire to this ground stud using the ring terminal end. Attach the fork terminal end of the ground wire to the electronic ballast controller ground screw.
6. Install the UV lamp as outlined on page 11.
7. When all plumbing connections are made, slowly turn on the water supply and check for leaks. The most likely cause for leaks is from the o-ring seal. In case of leak, shut water off, drain chamber, remove the gland nut assembly, wipe the o-ring and threads clean and re-install. Refer to exploded view diagram page.
8. Once it is determined that there are no leaks, plug the system into the GFCI, and check electronic ballast controller to ensure the system is operating properly. The controller is designed to detect both power to the system and lamp illumination. It is important to **NEVER LOOK DIRECTLY AT THE GLOWING UV LAMP.**
9. Allow the water to run for a few minutes to clear any air or dust that may be in the UV chamber.

PLEASE NOTE: When there is no flow, the water in the chamber will become warm, as the UV lamp is always on. To remedy this, run a cold water tap anywhere in the house for a minute to flush out the warm water.

Disinfection Procedure:

UV disinfection is a physical disinfection process and does not add any potentially harmful chemicals to the water. As UV does not provide a disinfection residual, it is imperative that the entire distribution system located after the UV be chemically disinfected to ensure that the water is free from any bacteriological contaminants. The disinfection process must be performed immediately after the UV unit is installed and repeated thereafter whenever the UV is shut down for service, without power, or inoperative for any reason. The procedure for sanitizing the plumbing system is readily accomplished as follows:

1. Shut off the upstream water supply that feeds water into the reactor chamber and depressurize water system. Remove the pre-filter cartridge and fill the sump with 1-2 cups of household (5.25%) bleach (chlorine) - Do NOT use hydrogen peroxide. At all times during this process, make sure the UV unit (and lamp) is turned on and operational!
2. Repressurize water system, open each faucet and allow cold water to run until you smell chlorine, shut the faucet off and then repeat the process for each faucet, including hot water. You must ensure that all taps, including outside faucets, dishwasher, shower heads, washing machines, connection to refrigerators, toilets, etc., pass chlorinated water.
3. Once all the locations have passed the chlorine disinfection solution, you will need to leave the solution sit for a period of 20-30 minutes. Reinstall the pre-filter cartridge into the filter, and then flush the chlorine solution from the system until no chlorine smell is detectable. Make sure that each fixture that was disinfected in step two is completely flushed of the chlorine solution as the consumption of the water is not advised due to the extremely high concentrations of chlorine. It is important to remember that in the event that a UV is briefly shut down for a routine cleaning or during power interruptions where water could have passed through the system, the aforementioned procedure must also be followed.

Note A: The addition of chlorine (bleach) to a hot water tank that has in the past been fed with untreated raw water with high levels of other contaminants (iron, manganese, hydrogen sulphide, organics, etc.) will result in oxidation of these contaminants and may require repeated flushing of the hot water tank. This contingency must be dealt with independently under the start-up procedure for any other conditioners that may form a part of the pre-treatment for the UV unit.

Note B: The above procedure (Steps 1 to 3) will result in a massive chlorine residual far in excess of the 0.5 to 1.0 mg/L typically present in municipally chlorinated water and of a magnitude consistent with the minimum 50mg/L chlorine solution recommended for the disinfection of distribution systems known to be contaminated. Do not consume water until complete system has been flushed.

- Always disconnect power before performing any work on the disinfection system.
- Regularly inspect your disinfection system to ensure that the power indicators are on and no alarms are present.
- Replace the UV lamp annually (or biennially if seasonal home use) to ensure maximum disinfection.
- Always drain the UV chamber when closing a seasonal home or leaving the unit in an area subject to freezing temperatures.

Operating & Maintenance Instructions:

Caution: Prior to performing any work on the disinfection system, always disconnect the power supply first.

UV LAMP REPLACEMENT:

1. To replace the lamp, there is NO need to disconnect the system from the water supply, nor to drain the water from the UV chamber. **DO NOT USE WATER DURING THIS PROCEDURE.** Lamp replacement is a quick and simple procedure requiring no special tools. The UV lamp must be replaced after 9,000 hours of continuous operation (approximately one year) in order to ensure adequate disinfection.
2. Unplug the electronic ballast from the electrical outlet and allow the lamp to cool for at least 5 minutes before removing. Pull out the U clip from the gland nut. Remove bushing, connector and lamp from the UV chamber. Separate the lamp from the connector. Do not twist the lamp from the connector, simply slide the two apart. Avoid touching the lamp's quartz surface. Handling the lamp at the ceramic ends is acceptable, however if you must touch the lamp quartz, please use gloves or a soft cloth. Fully remove the lamp from the reactor chamber being careful not to angle the lamp as it is removed from the chamber. If the lamp is removed on an angle, pressure will be applied on the inside of the quartz sleeve, causing the sleeve to fracture.
3. To install a new lamp, first remove the lamp from its protective packaging, again being careful not to touch the lamp's quartz surface. Oil deposits from your fingers can create hot spots on the surface which may lead to premature lamp failure. Handle the lamp by the ceramic ends only. If the quartz surface becomes dirty, use a lint-free cloth and isopropyl alcohol to remove dirt. Carefully insert the lamp into the UV vessel (actually inside the quartz sleeve). Insert the lamp fully into the chamber leaving about two inches of the lamp protruding from the chamber. Next, attach the connector to the UV lamp. Ensure the connector is fully seated onto the UV lamp.
4. Once the lamp is fully seated on the connector, slide the connector and bushing into the aluminum gland nut. Gently press down on the bushing and squeeze/slide the U clip through the gland nut's four upper holes (2 pair, 180° apart).
5. Plug in ballast to the electrical outlet.

NOTE: RESET LAMP LIFE TIMER AFTER LAMP REPLACEMENT (PG 11) - refer to www.lamprecycle.org for lamp disposal

QUARTZ SLEEVE REPLACEMENT / CLEANING:

Mineral deposits and sediment may accumulate on the quartz sleeve decreasing the UV light transmittance and system performance. Good maintenance of filtration equipment will reduce the accumulation of residues. If necessary, remove the quartz sleeve and clean with a commercially available scale remover (CLR, Lime-Away, etc.) and a lint free cloth. Repeat the process as often as necessary to keep the quartz sleeve clean. Be sure to remove all traces of cleaning fluid from the sleeve before it is reinstalled in the UV chamber (be sure not to allow liquid inside the sleeve).

1. First remove the UV lamp by following steps 1 & 2 as outlined in the "Lamp Replacement" section above.
2. Shut off the upstream water supply that feeds water into the UV chamber.
3. Shut off the downstream water supply. If your system does not have a separate downstream valve, simply open a downstream faucet to release any pressure that may be built-up in the system.
4. Remove the aluminum gland nut by turning counter clockwise. Place a small pail under the UV chamber to catch any water that may leak from the system. Grasp the quartz sleeve and fully remove from the UV chamber. Make sure the sealing o-ring is removed with the quartz sleeve. As with the lamp, make sure the sleeve is removed from the UV chamber being careful not to angle the sleeve as it is removed from the chamber to avoid breakage.
5. Clean the sleeve as described above, or replace with a new sleeve. Reinstall the quartz sleeve in the reverse order. To install the sleeve, carefully insert the sleeve into the UV chamber (do not drop) until the sleeve domed end seats in the center of the hourglass retainer spring located in the end of the chamber. Install o-ring onto the sleeve until it is positioned against the chamfered seat. Make sure the small lamp compression spring is inside the sleeve.
6. Reinstall the aluminum gland nut on the UV chamber and tighten by turning clockwise. The gland nut should be **hand-tightened only**, the use of a wrench is not required, nor recommended. Reinstall the UV lamp and connector as outlined in steps three and four of the "Lamp Replacement" section.
7. Slowly turn on water and pressurize the chamber to verify that there are no leaks.
8. Reconnect to power source and ensure that the UV lamp is operating by verifying ballast green LED indicator is on and display is operational.

ELECTRONIC BALLAST OPERATION:

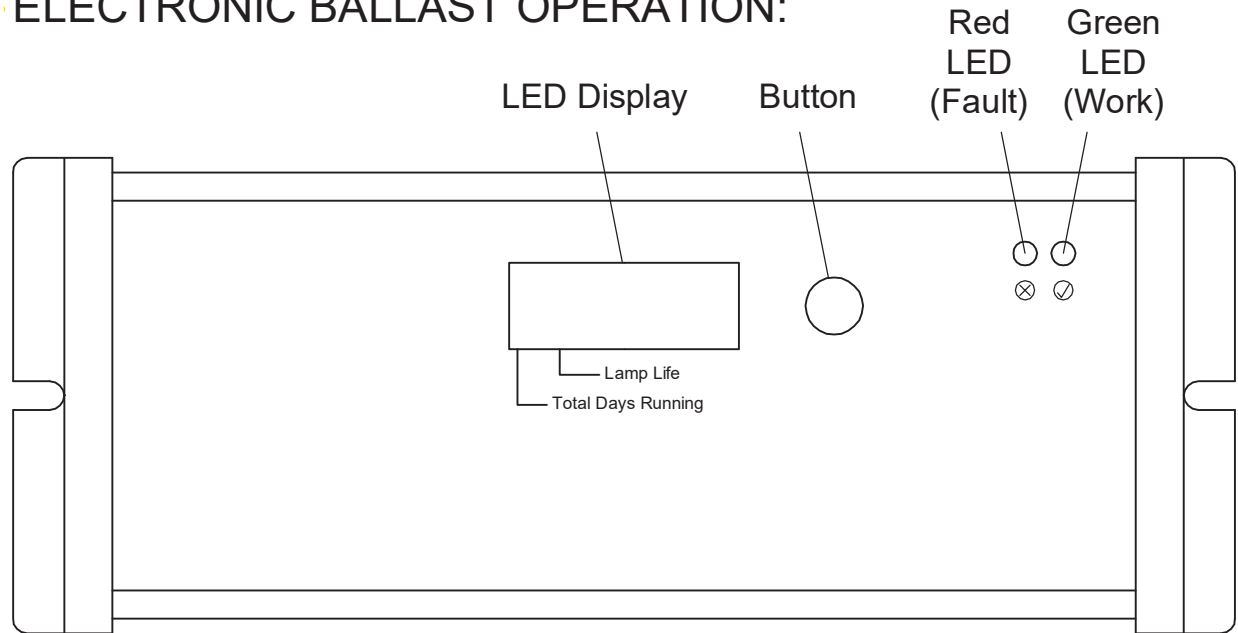

The PPUVC Electronic Ballast (a.k.a. EPS-Electronic Power Supply or simply "controller") is equipped with visible and audible operation indicators:

LAMP-ON INDICATOR - Steady "work" green LED.

LAMP LIFE REMAINING (DAYS) - Default count down display (365 - 0); manually reset see * below.

BALLAST TOTAL RUNNING DAYS - Incremental display (0-9999); cannot be reset. To view, press and hold button for 2 seconds, release button and LED display will show ballast total days running. After 10 seconds, the LED display will automatically return to default display (lamp life) or shortly press and hold button again (2 seconds) before 10 seconds elapse to return to the default (lamp life) display.

LAMP REPLACEMENT REMINDER - The 365 day countdown timer displays the number of days remaining until lamp replacement is required. When the countdown timer reaches 0 days an audible alarm sounds (1 second BEEP every 5 seconds), the red LED flashes and the display will indicate alarm A3.

LAMP REPLACEMENT REMINDER DELAY - To allow time for obtaining a replacement lamp, the audible alarm can be silenced for 7 days by pressing and holding the button for 2-5 seconds. The display will continue to show A3 and the red LED will continue to flash. After 7 days, the audible alarm will sound again if the lamp has not been replaced. The alarm can be silenced up to 4 times (28 days). After 4 times, the alarm can no longer be silenced until a replacement lamp is installed and the lamp life timer is reset.

Please note that the lamp has an approximate life of one year. Although the lamp will continue to operate long past one year, the UV output continually decreases after one year and may no longer provide adequate disinfection. Use only Protect Plus Pro lamps to ensure proper operation and performance.

* **RESET LAMP LIFE TIMER AFTER LAMP REPLACEMENT** - After replacing the lamp by following instructions on the previous page, reset the lamp life timer to 365 days by pressing and holding the button for 10 seconds... LED displays "rSEt"... keep holding button until LED displays 365 and alarm sounds (1 BEEP). Release button.

LAMP FAILURE INDICATOR - In the event of a failure of the lamp (no current running through the lamp), an audible alarm sounds (1 second BEEP every 1 second), the red LED flashes and the display continues to show lamp life remaining days but stops counting down (ballast total running days continues counting). The audible alarm cannot be silenced.

Please note that if this condition occurs and you are on a non-municipal water source, you should immediately stop using the water for potable applications until the lamp is replaced and distribution lines are disinfected.

BALLAST FAILURE INDICATOR - Blank display.

ELECTRONIC BALLAST
(INCLUDES POWER CORDSET AND LAMP CORDSET)

EXPLODED VIEW:

GFCI
PROTECTED
CIRCUIT
120 V

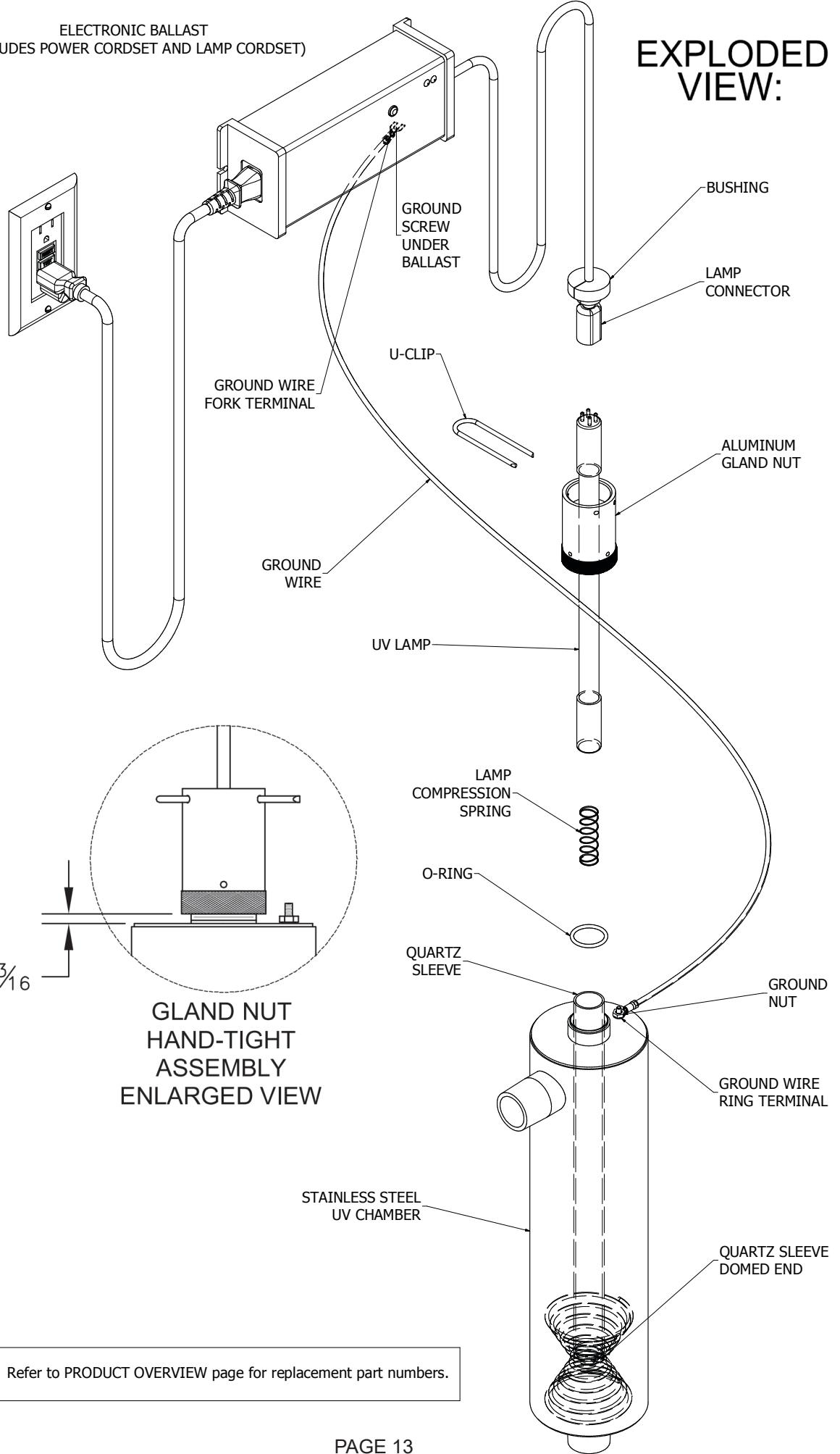

GLAND NUT
HAND-TIGHT
ASSEMBLY
ENLARGED VIEW

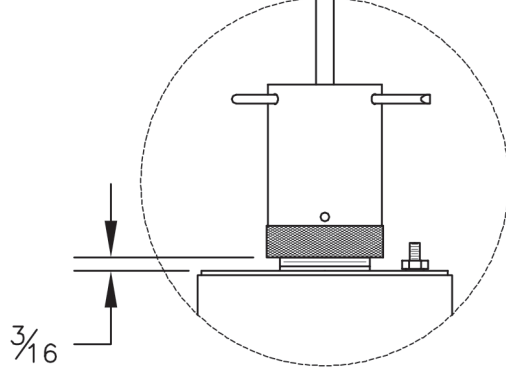

Refer to PRODUCT OVERVIEW page for replacement part numbers.



Whole House Water Treatment System Limited Warranty

Protect Plus Pro, LLC warrants any Protect Plus Pro, LLC brand whole house water treatment system that is installed by an authorized Protect Plus Pro, LLC dealer, to be free from defects in materials and workmanship to the original first purchaser from the date of purchase. All aspects of this warranty are subject to the following limitations, terms and conditions.

If Protect Plus Pro equipment consisting of the Mineral Tank and Brine Tank, Control Valve, Resin and Treatment Media is determined by our warranty department to have failed as a result of a manufacturing defect, Protect Plus Pro, LLC will, at its sole discretion, repair or replace the defective part at NO CHARGE to the Consumer (excluding labor, and applicable shipping and handling cost) for the length and terms of the product warranties specifically set forth below.

Control Valve	Limited Control Valve Warranty	Limited Pressure Tank Warranty	Limited Brine Tank Warranty
Diamond System	7	Lifetime	Lifetime

This warranty extends to the Consumer for damage resulting from defects in materials and workmanship and does not include renewable components. It does not extend to damage caused by the Consumer's misuse, misapplication, neglect, alteration, accident, force of nature, installation or operation contrary to instructions, contained within the owner's manual or extraordinary circumstances beyond the control of Company.

LIMITED SEVEN YEAR WARRANTY FOR CONTROL VALVE AND LIMITED LIFETIME WARRANTY FOR MINERAL TANKS AND BRINE TANKS (DIAMOND SYSTEMS):

Seven Year Limited Control Valve Warranty

Protect Plus Pro, LLC will replace the control valve of any new water conditioner assembled unit which fails within 84 months from date of purchase or installation by an authorized Protect Plus Pro, LLC dealer. This warranty does not cover control valves purchased or installed separate and not part of a new, assembled unit.

Limited Lifetime Warranty on Mineral Tanks and Brine Tanks

Protect Plus Pro, LLC will provide a replacement mineral tank or brine tank to any Consumer that purchased the new water conditioner assembled unit from an authorized Protect Plus Pro, LLC dealer and is in possession of a tank that fails, provided that the water conditioner is at all times operated in accordance with specifications, contained within the owner's manual, installed correctly, and not subject to freezing or negative pressure vacuum.

Limitations to Limited Warranty

Damage to any part of this water conditioner as a result of misuse, misapplication, neglect, alteration, accident, installation or operation contrary to our printed instructions, contained within the owner's manual, damage to ion exchange resin and seals caused by chlorine / chloramines in the water supply, or damage caused by any force of nature is not covered in this warranty. **DAMAGE TO PISTONS, SEALS, AND OR SPACERS WITHIN THE CONTROL VALVE ARE NOT COVERED UNDER THIS WARRANTY, IF THESE PARTS ARE EXPOSED TO HARSH ENVIRONMENTAL CONDITIONS, SUCH AS HIGH LEVELS OF IRON, MANGANESE, SULPHUR, AND SEDIMENT.** We will repair or replace defective parts if our warranty department determines it to be defective under the terms of this warranty. Protect Plus Pro, LLC assumes no responsibility for consequential damage, labor or expense incurred as a result of a defect or failure. Media and Resin coverage is limited to the warranty provided by the original manufacturer.

LIMITED WARRANTY ON COMPONENT PARTS NOT PURCHASED AS PART OF A NEW WATER CONDITIONER ASSEMBLED UNIT:

For Component parts not sold as a part of a new water conditioner assembled unit system are warranted to do the work for which they are intended where properly installed and operated. The new water conditioner assembled unit consists of a control valve, pressure tank, and brine tank sold as a complete, assembled unit. For component parts not sold as a new water conditioner assembled unit, Protect Plus Pro, LLC provides the following limited warranty on the component parts:

FIBERGLASS TANKS

Protect Plus Pro, LLC will provide a replacement fiberglass tank to a Consumer in possession of a fiberglass tank that fails within 120 months, provided that the water conditioner is at all times operated in accordance with specifications, contained within the owner's manual, and not subject to freezing or negative pressure vacuum.

CONTROL VALVE AND ASSOCIATED ELECTRONICS

Protect Plus Pro, LLC will replace the control valve of any new water conditioner assembled unit which fails within 60 months from date of purchase by the Consumer and installed by an authorized Protect Plus Pro, LLC dealer.

BRINE TANKS AND RELATED ASSEMBLIES

Protect Plus Pro, LLC will provide a replacement brine tank purchased by the Consumer and in possession of a brine tank that fails within 60 months, provided that the water conditioner is at all times operated in accordance with specifications, contained within the owner's manual, and not subject to freezing or negative pressure vacuum.

MEDIA AND RESIN

Media and Resin coverage is limited to the warranty provided by the original manufacturer. For a copy of this warranty, please contact Protect Plus Pro, LLC.

DAMAGE TO PISTONS, SEALS, AND OR SPACERS WITHIN THE CONTROL VALVE ARE NOT COVERED UNDER THIS WARRANTY, IF THESE PARTS ARE EXPOSED TO HARSH ENVIRONMENTAL CONDITIONS, SUCH AS HIGH LEVELS OF IRON, MANGANESE, SULPHUR, AND SEDIMENT.

Protect Plus Pro, LLC only provides a limited warranty for this product to its authorized Protect Plus Pro, LLC dealer dealers.

LIMITED WARRANTY