



To order or for more information please contact:

**docStock**  
MEDICAL EQUIPMENT SPECIALISTS™

DocStock Pty Ltd  
4881-48 103 248 523  
P: (02) 8850 7177  
E: info@docstock.com.au  
www.DocStock.com.au

Ships in 3 boxes





(2) wheels without brakes



(2) wheels with brakes



(2) wheels without brakes



(2) wheels with brakes go through the ring cable

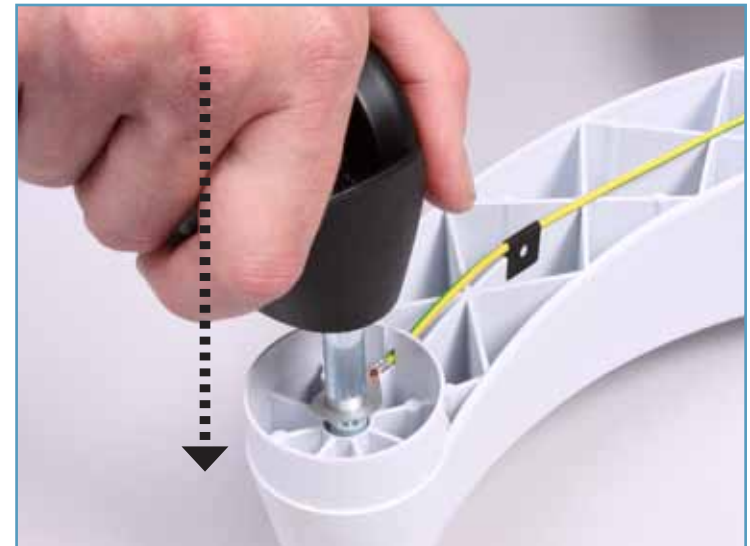

Place wheels with brakes through ring cable and insert completely



Insert two wheels without brakes completely









Tools not included

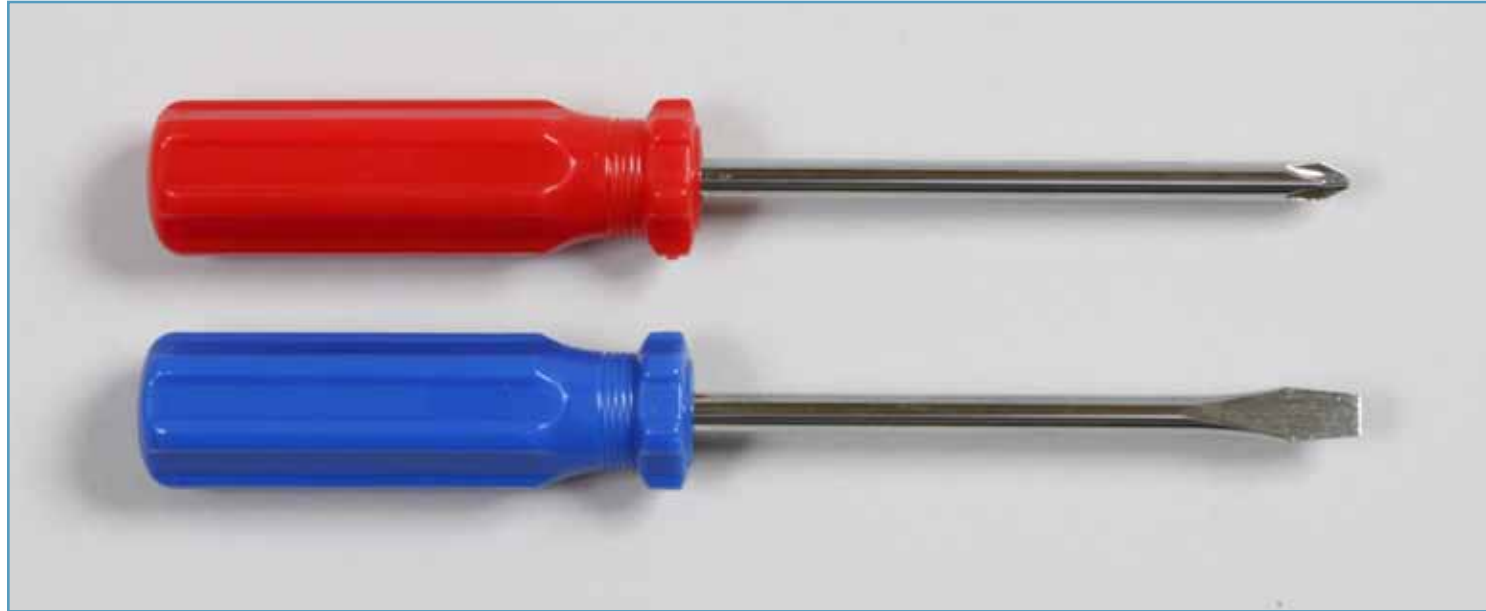

Insert two screws into pole



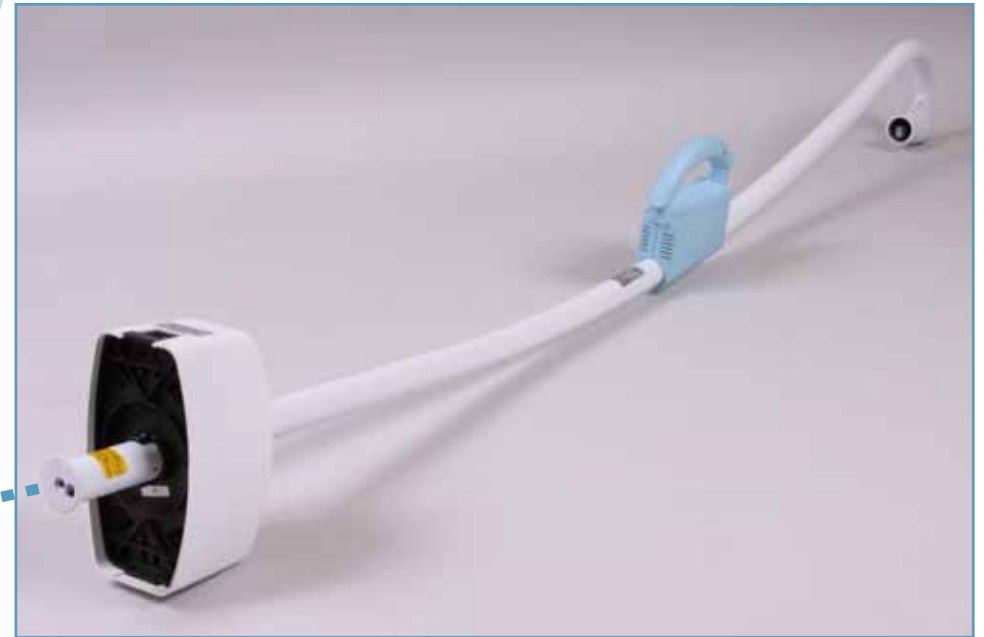

Insert the tripod tube so that the recess in the tube is seated in the nose of the tripod base and cannot be rotated any more





Assemble the winged screw with the spring washer and tighten



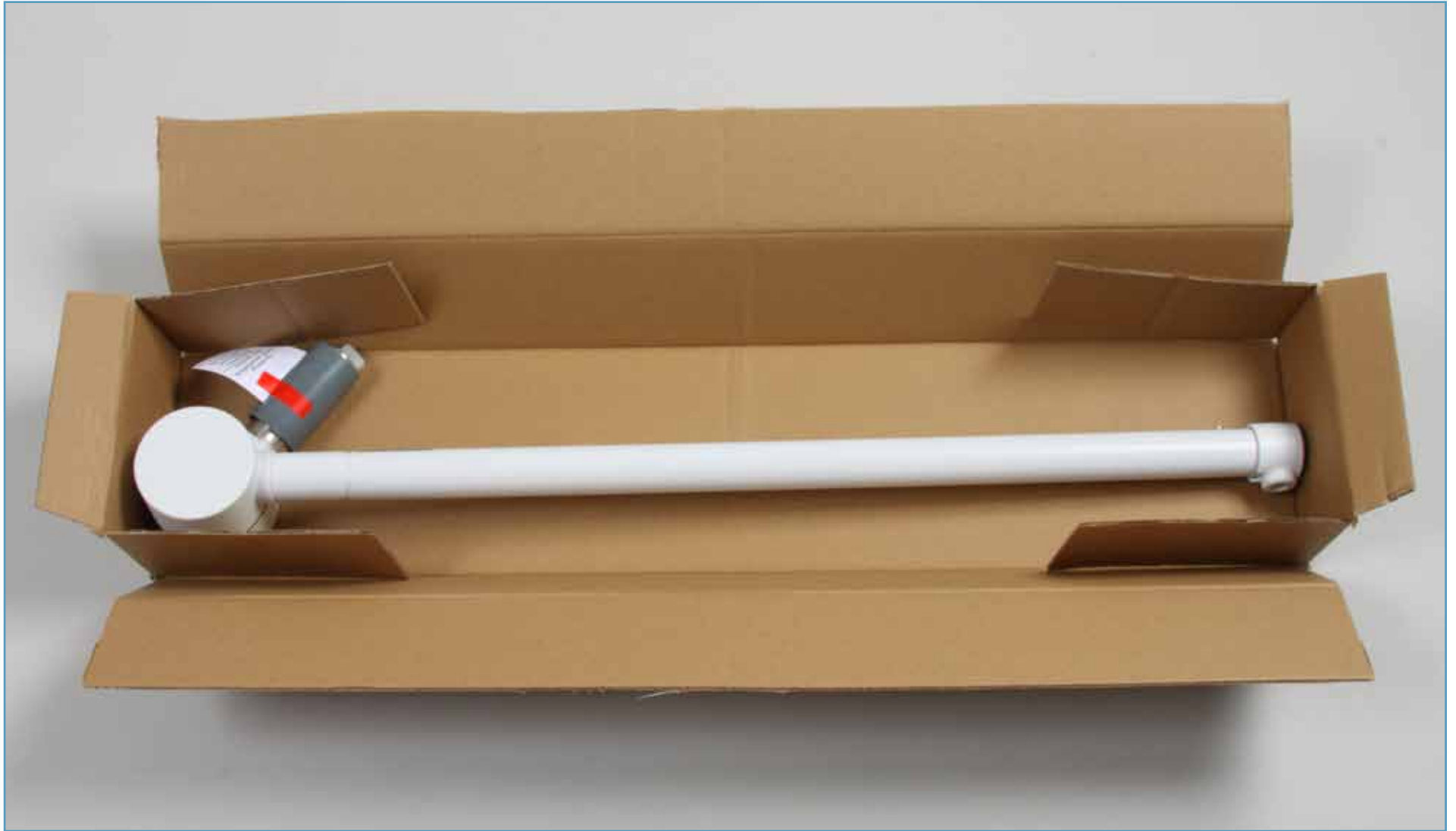



Remove and discard grey protective cover

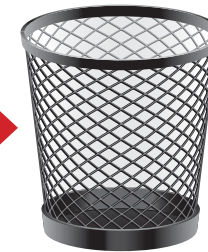

Unscrew the Phillips/plus-slotted screw, pull the cover off, pull cord through the top opening and insert the spring arm





Place the disk over spring arm



Place retaining ring over spring arm and secure into the pin groove

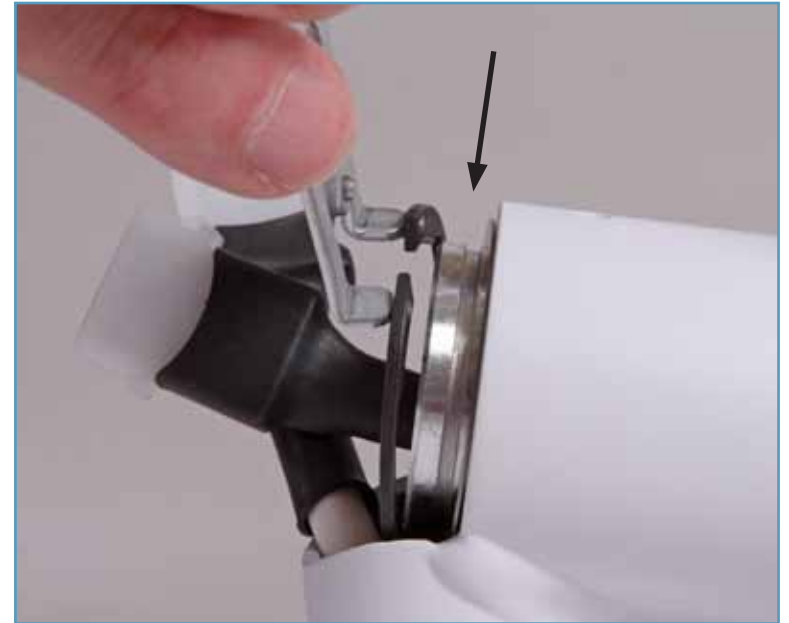

Make the electrical connection, tuck wires back inside, replace cover and tighten Phillips/plus screw





Remove and discard  
grey protective cover



Loosen the slotted/minus screw

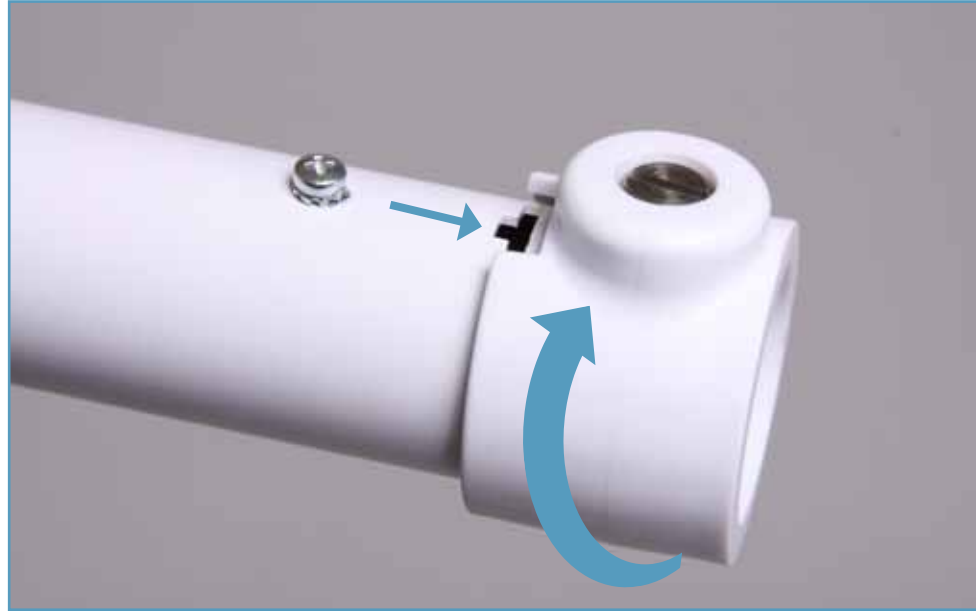

Loosen the Phillips/plus-slotted screw





*Luminaire*



Insert luminaire into the spring arm





Place securing segment completely into slot





Tighten the Phillips/plus-slotted screw, turn plastic sleeve 180° and tighten the slotted/minus screw



Plug in electrical connection to the unit and the wall

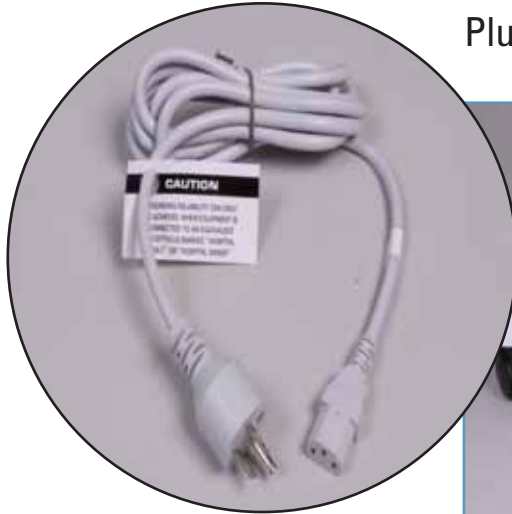

Turn on light

