

| |
|----------------|
| Thread Size |
| Appliance Pull |
| M6 |

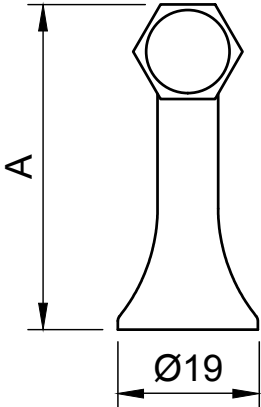
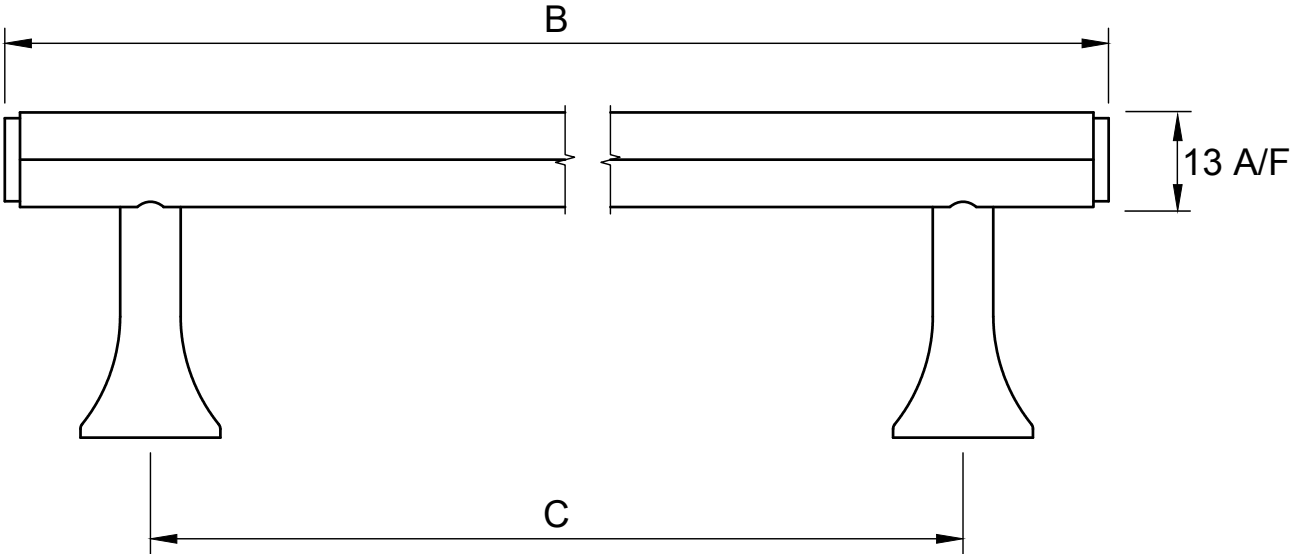

| A | B | C |
|------|-------|-------|
| 43mm | 439mm | 400mm |
| 43mm | 639mm | 600mm |

| | |
|---|--------------------------|
| DANIEL OXFORD CABINETRY COLLECTION | Design Name |
| | Battersea Appliance Pull |
| Version Number | |
| IMPORTANT: This technical drawing is the private and confidential property of DANIEL OXFORD and must not be disclosed to third parties without DANIEL OXFORD written permission | |