

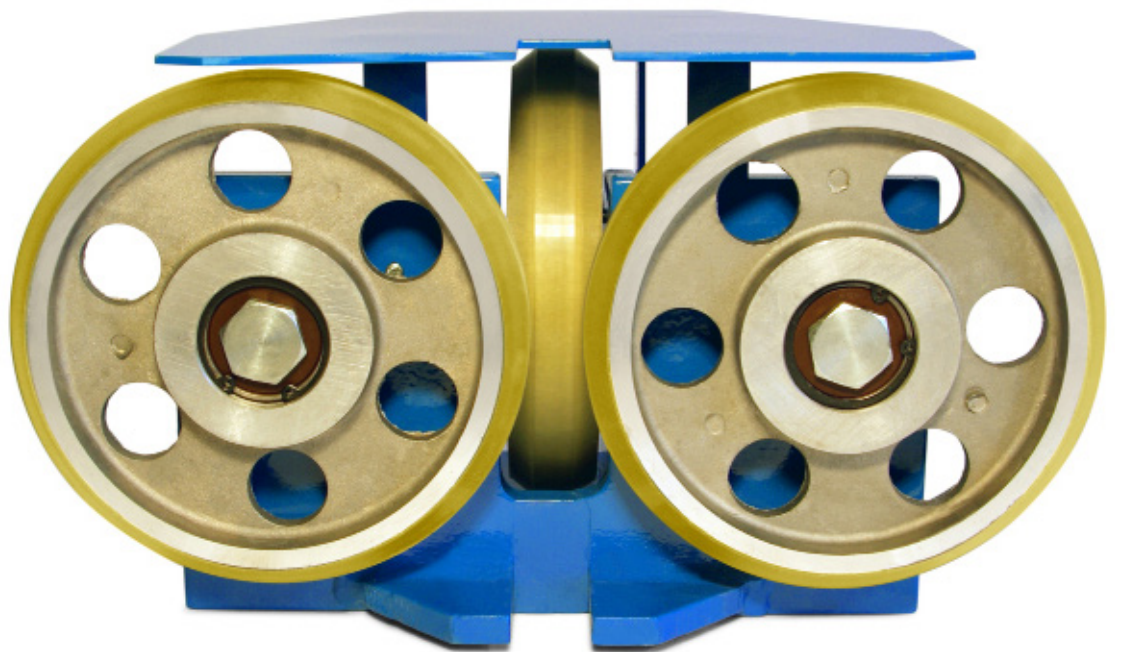

# 6" SPRING FREE ROLLER GUIDE ASSEMBLY



[www.delcoelevators.com](http://www.delcoelevators.com)  
[info@delcoelevators.com](mailto:info@delcoelevators.com) | 1-866-900-3727

## 6" SPRING FREE

With Dust Cover

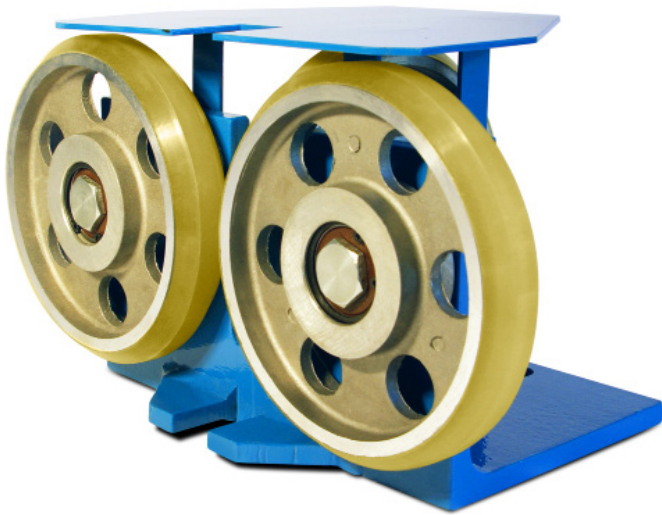

### Easy Installation

The Delco 6" Spring Free model is normally used in counterweight applications. Its best suited for passenger and hospital elevators that require speeds up to 800 fpm (4 m/s) and high capacities, from 4,000 to 7,000 Lbs (1800 – 3200 Kg).

These roller guide assemblies most often work in conjunction with Delco 7-7/8" Standard, C-08-0808, on the car side.

### Features

One key advantage of the spring free model is the extra simple installation as no spring adjustments are required.

This model comes with a dustcover and slotted holes in the base for field misalignment.

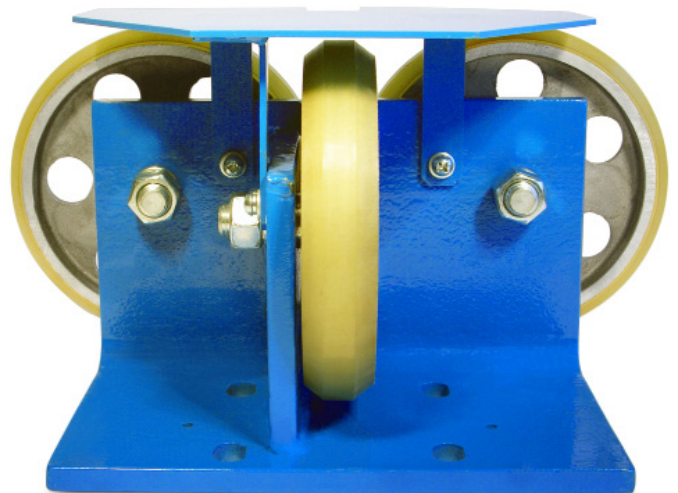
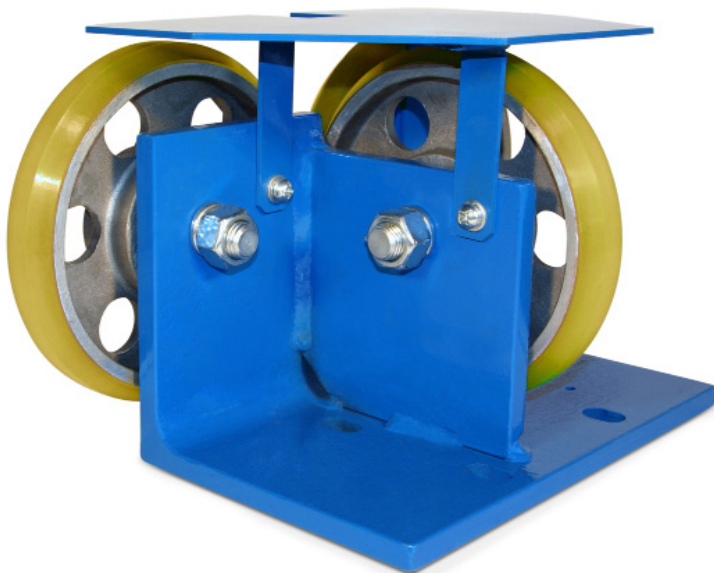

## 6" SPRING FREE

### Specifications

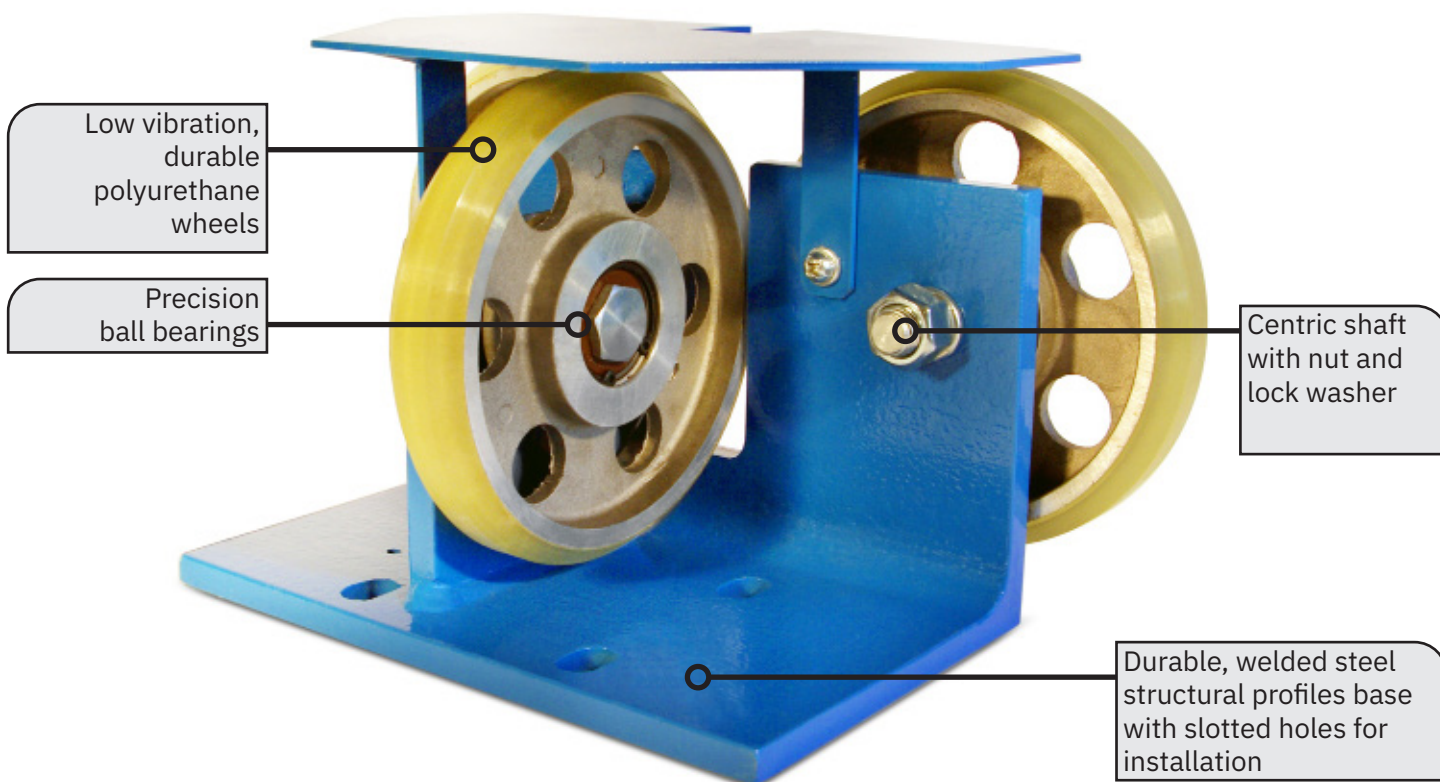

# C-08-0806

<b>Capacity</b>	up to 6615lbs (3000kg)
<b>Speed</b>	up to 787fpm (4m/s)
<b>Guide Rail Width</b>	10mm, 16mm (5/8")
<b>Roller Diameter</b>	6" (152mm)
<b>Roller Material</b>	Polyurethane
<b>Roller Hardness</b>	80±5 (Durometer Shore A)
<b>Structural Frame</b>	Structural welded profiles
<b>Ball Bearings</b>	NSK 6203DU
<b>Weight</b>	28 Lbs (13 Kg)

## 6" SPRING FREE

Diagram Front View

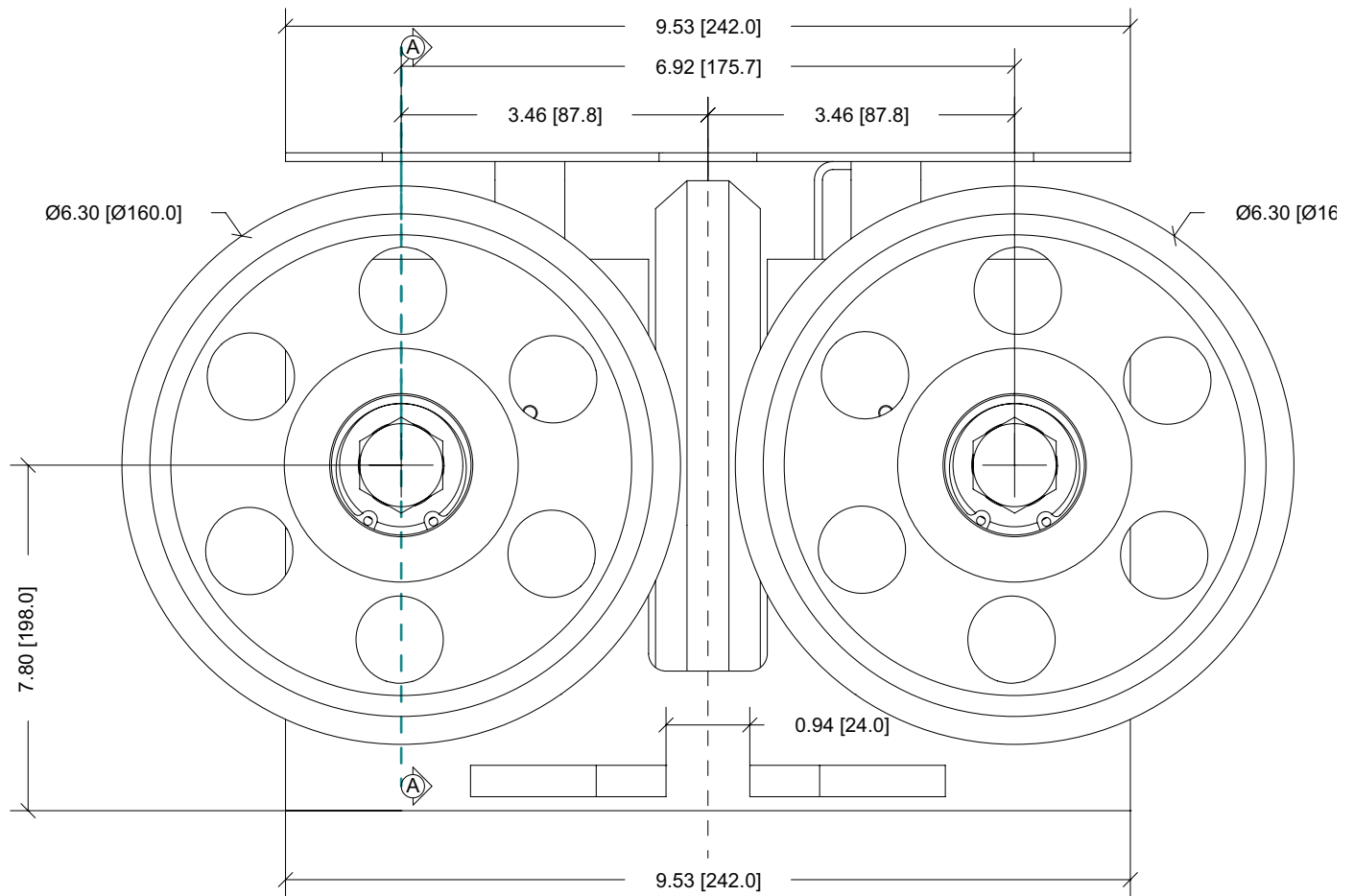

## 6" SPRING FREE

Diagram Side View

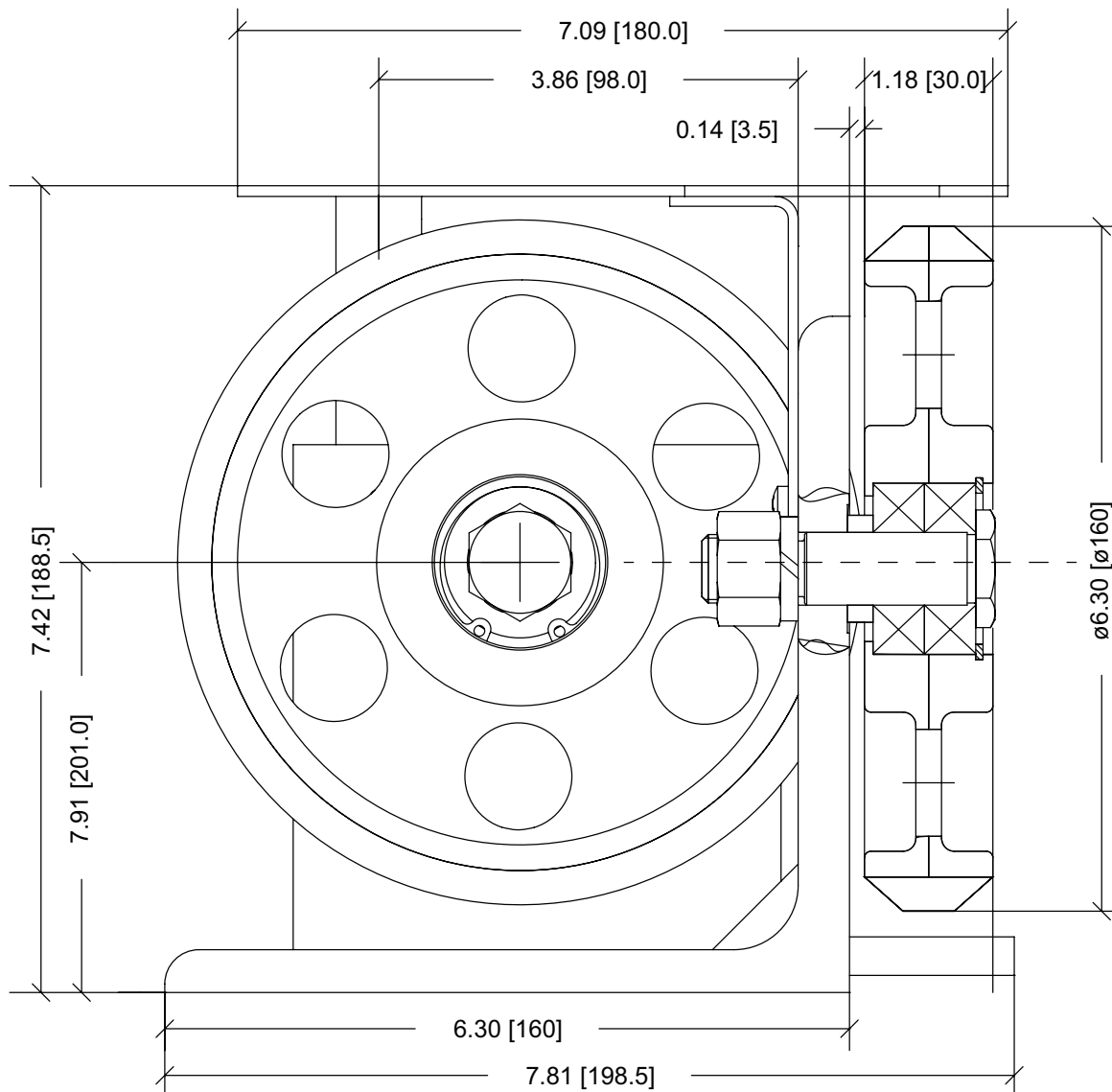



## 6" SPRING FREE

Diagram Top View

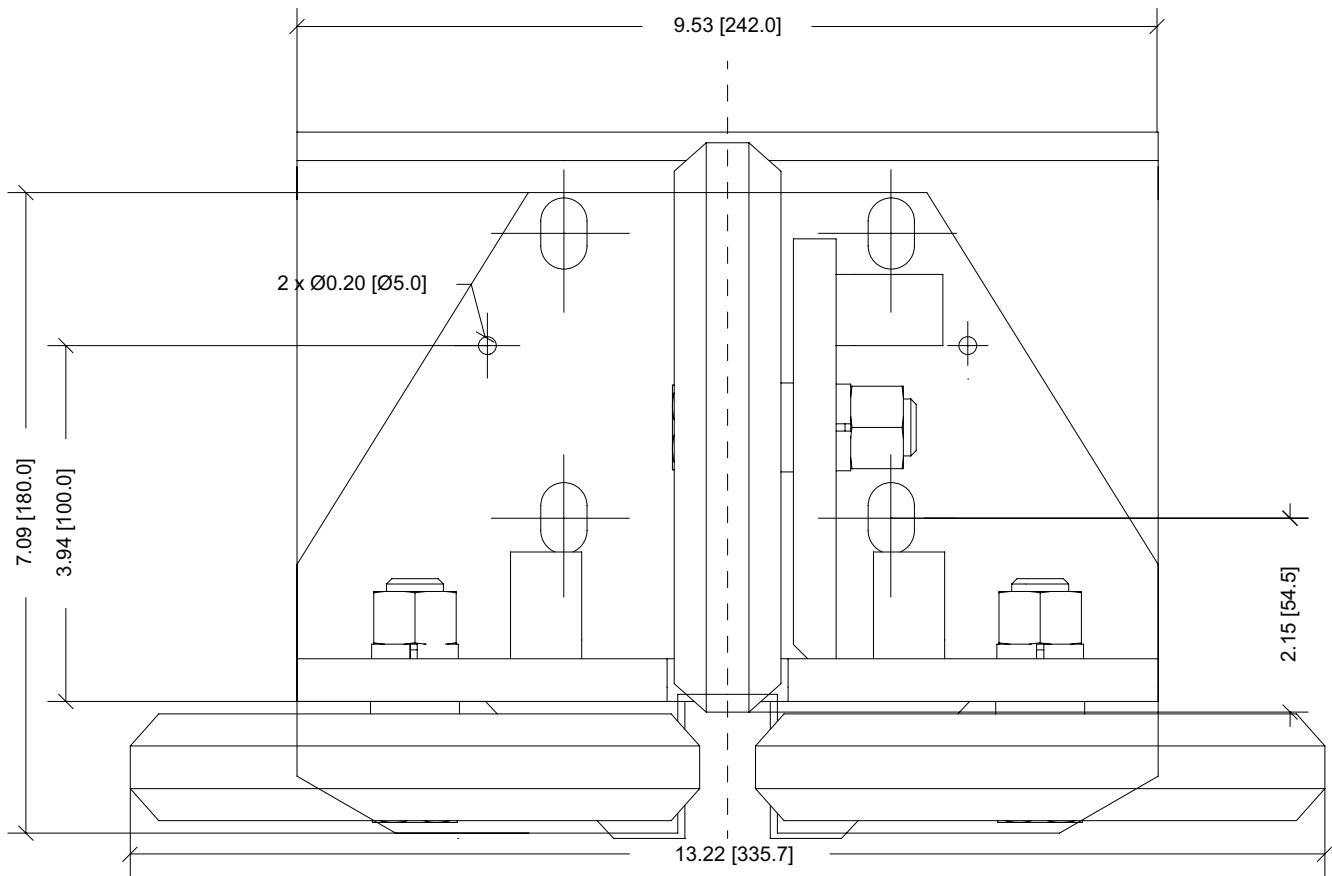

## 6" SPRING FREE

Diagram Baseplate View

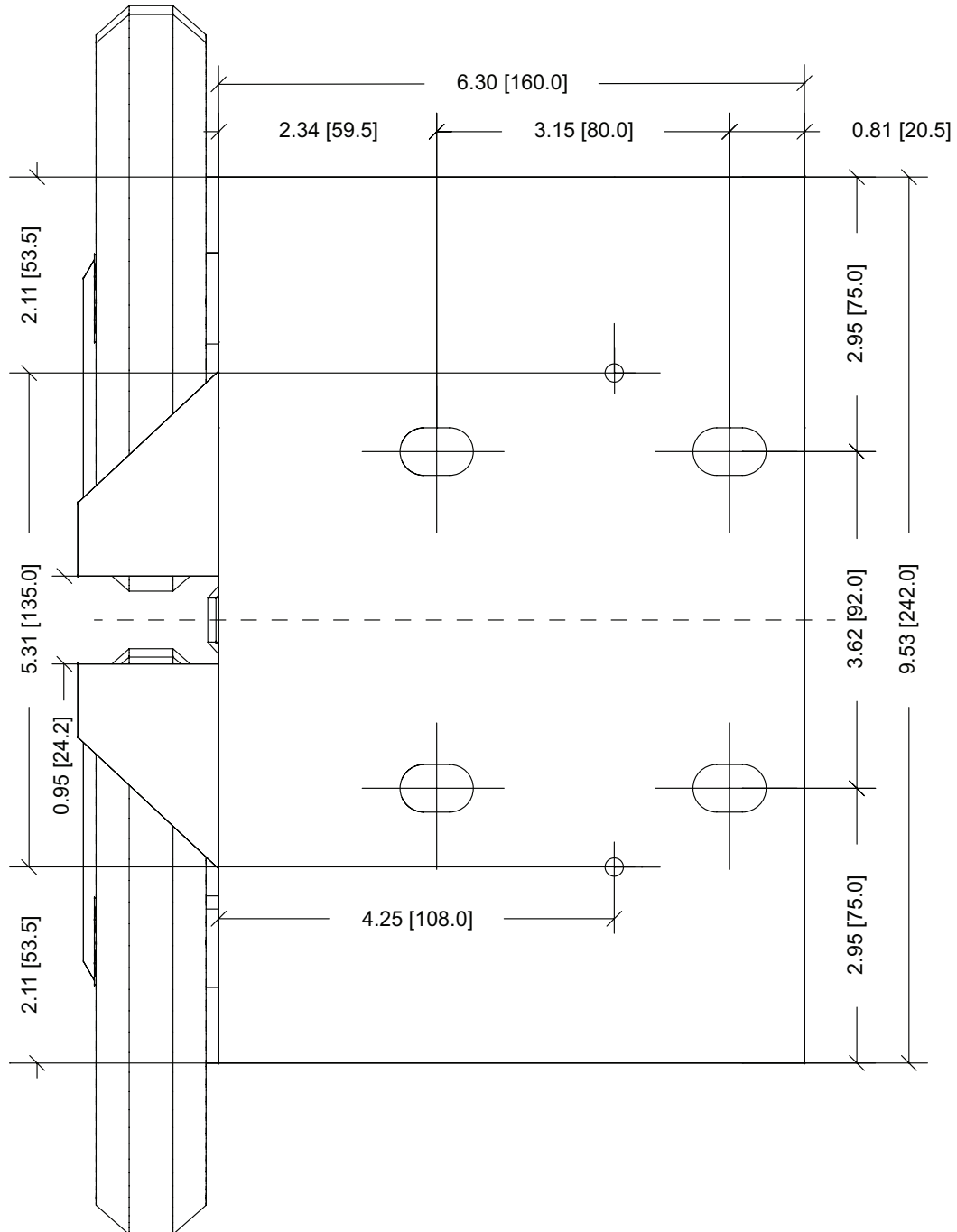

# ROLLER GUIDES

8 Models | up to 3000 KG | up to 1200 fpm

## Proven

With over 12,000 Delco Roller Guide Assemblies installed and running every day, our products are being relied on by hundreds of elevator contractors.

**CAPACITY: 0 – 6615 LBS (3000 KG)**  
**SPEED: 0 – 1200 FPM (6.0M/S)**

Meeting the requirements for over 90% of elevator installations, Delco offers 7 different RGA models. Low-rise, mid-rise and high-rise buildings throughout North America use Delco Roller Guides.

Easy to install and easy to maintain, Delco Roller Guides are manufactured with high precision, using the best materials, to provide many years of worry-free operation in many different elevator installation situations.

## Smooth, Tough and Reliable

Delco's roller guides are made with the best materials.

### Rollers

High quality polyurethane roller tires, with a hardness of  $80\pm 5$  (Durometer Shore A) provide a comfortable, smooth ride. Polyurethane has a high compression strength and doesn't create flat spots, ensuring reliable operation for many years.

### Frame materials

The cast iron frames and heavy duty hardware ensures a long life in all elevator hoistway environments.

### Precision Ball Bearings

Delco Roller Guides are made with NSK ball bearings manufactured in Japan, recognized world-wide as the most reliable, high performance bearings.

## Product Line

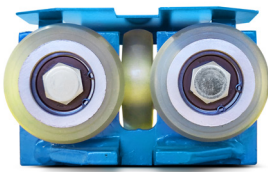

3" SPRING FREE  
C-08-0815 (16 mm)  
C-08-0817 (10 mm)

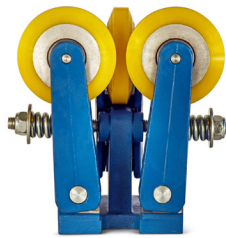

3¼" STANDARD  
C-08-0810

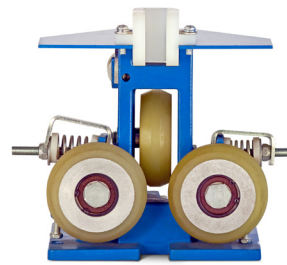

3¼" HIGH SPEED  
C-08-0807

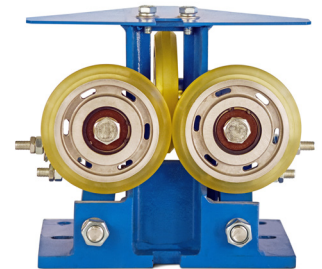

5" STANDARD  
C-08-0805

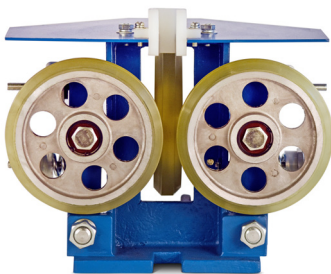

6" STANDARD  
C-08-0804



6" SPRING FREE  
C-08-0806



7⅞" STANDARD  
C-08-0808

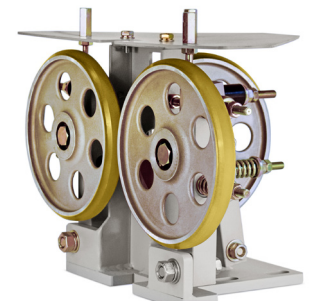

10" HIGH SPEED  
C-08-0803



## SELECTION GUIDE

Passenger Elevator	0-500fpm (0-2.5m/s)		600-800fpm (3.0-4.0m/s)		1000-1200fpm (5.0-6.0m/s)	
	Delco Car	Delco CWT	Delco Car	Delco CWT	Delco Car	Delco CWT
<3000lbs (<1350kg)	C-08-0805 C-08-0804	C-08-0810 C-08-0807 C-08-0815	C-08-0804	C-08-0807	C-08-0803	N/A
3500lbs (1600kg)	C-08-0805 C-08-0804	C-08-0810 C-08-0807 C-08-0815	C-08-0804	C-08-0807	C-08-0803	N/A
4000lbs (1800kg)	C-08-0804	C-08-0810 C-08-0807 C-08-0806	C-08-0804	C-08-0807	C-08-0803	N/A
4500lbs (2050kg)	C-08-0808	C-08-0806	C-08-0808	C-08-0806	C-08-0803	N/A
5000lbs (2300kg)	C-08-0808	C-08-0806	C-08-0808	C-08-0806	C-08-0803	N/A
6000lbs (2700kg)	C-08-0808	C-08-0806	C-08-0808	C-08-0806	C-08-0803	N/A
7000lbs (3200kg)	C-08-0803	C-08-0806	C-08-0803	C-08-0806	N/A	N/A

Hospital Elevator	0-250fpm (0-1.25m/s)		300-500fpm (1.5-2.5m/s)		600-800fpm (3.0-4.0m/s)		1000-1200fpm (5.0-6.0m/s)	
	Car	CWT	Car	CWT	Car	CWT	Car	CWT
<3000lbs (<1350kg)	C-08-0805 C-08-0804	C-08-0810 C-08-0807 C-08-0815	C-08-0805 C-08-0804	C-08-0810 C-08-0807 C-08-0815	C-08-0804	C-08-0807 C-08-0815	C-08-0803	N/A
3500lbs (1600kg)	C-08-0805 C-08-0804	C-08-0810 C-08-0807 C-08-0815	C-08-0805 C-08-0804	C-08-0810 C-08-0807 C-08-0815	C-08-0804	C-08-0807	C-08-0803	N/A
4000lbs (1800kg)	C-08-0804	C-08-0806	C-08-0804	C-08-0806	C-08-0804	C-08-0807	C-08-0803	N/A
4500lbs (2050kg)	C-08-0808	C-08-0806	C-08-0808	C-08-0806	C-08-0808	C-08-0806	N/A	N/A
5000lbs (2300kg)	C-08-0808	C-08-0806	C-08-0808	C-08-0806	C-08-0808	C-08-0806	N/A	N/A
6000lbs (2700kg)	C-08-0808	C-08-0806	C-08-0808	C-08-0806	C-08-0808	C-08-0806	N/A	N/A
7000lbs (3200kg)	C-08-0803	C-08-0806	C-08-0803	C-08-0806	C-08-0803	C-08-0806	N/A	N/A

### Freight Elevator

For freight elevator applications the Roller Guide Assembly selection will be based on the number of guide rails. For applications with 2 guide rails, refer to the Passenger Elevator chart above. For applications with 4 or more guide rails, please contact us.

### Important!

Please note that this table is only to be used as a guideline. Roller Guide Assembly selection must take many other criteria into consideration that can't be accounted for in this chart. Please contact us for selection assistance.

# ROLLER GUIDE ASSEMBLY

