

Delco
ELEVATOR PRODUCTS

3¹/₄" STANDARD ROLLER GUIDE ASSEMBLY

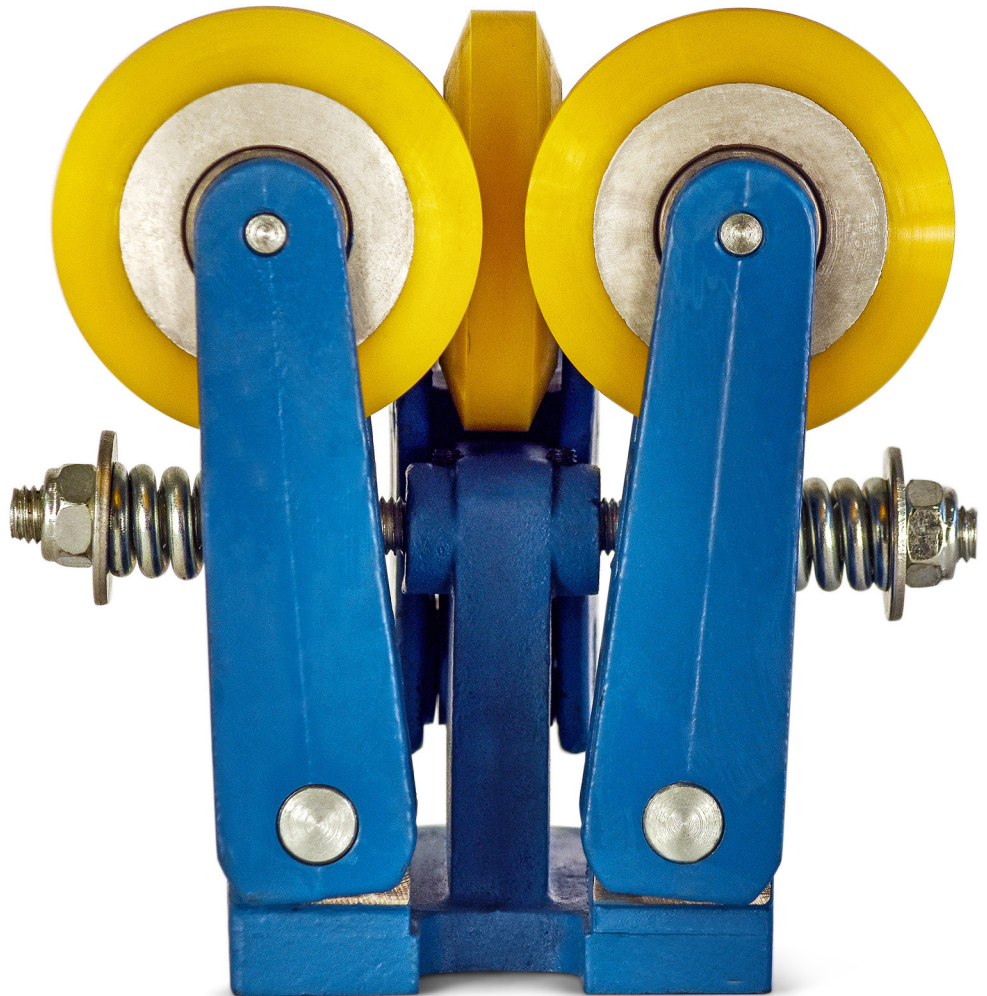

www.delcoelevator.com
info@delcoelevator.com | 1-866-900-3727

3¹/₄" STANDARD

Spring Loaded



Car and Counterweight

One of our most popular models, the 3-1/4" Standard spring-loaded roller guide can be used in both car side and counterweight side applications. Most commonly these roller guide assemblies are used in counterweight applications and low capacity car applications.

Features

This model is particularly popular because of its fully adjustable stabilizing springs, high precision bearings and cast-iron frame.

Reliable, durable and guaranteed to provide a smooth, quality engineered ride, the Delco 3-1/4" Standard also has slotted holes for increased flexibility for field misalignment.

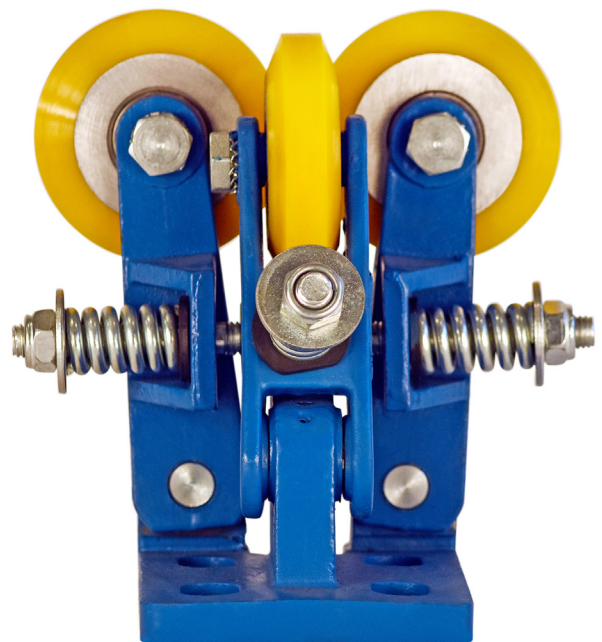
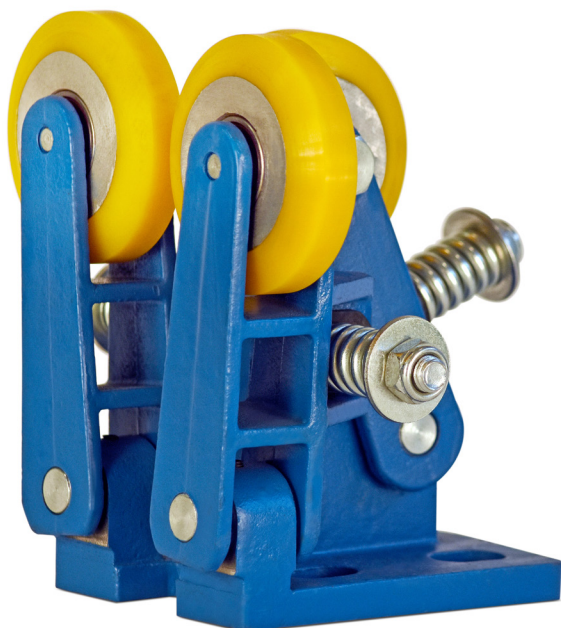

ROLLER GUIDE ASSEMBLY



3 1/4" STANDARD Specifications

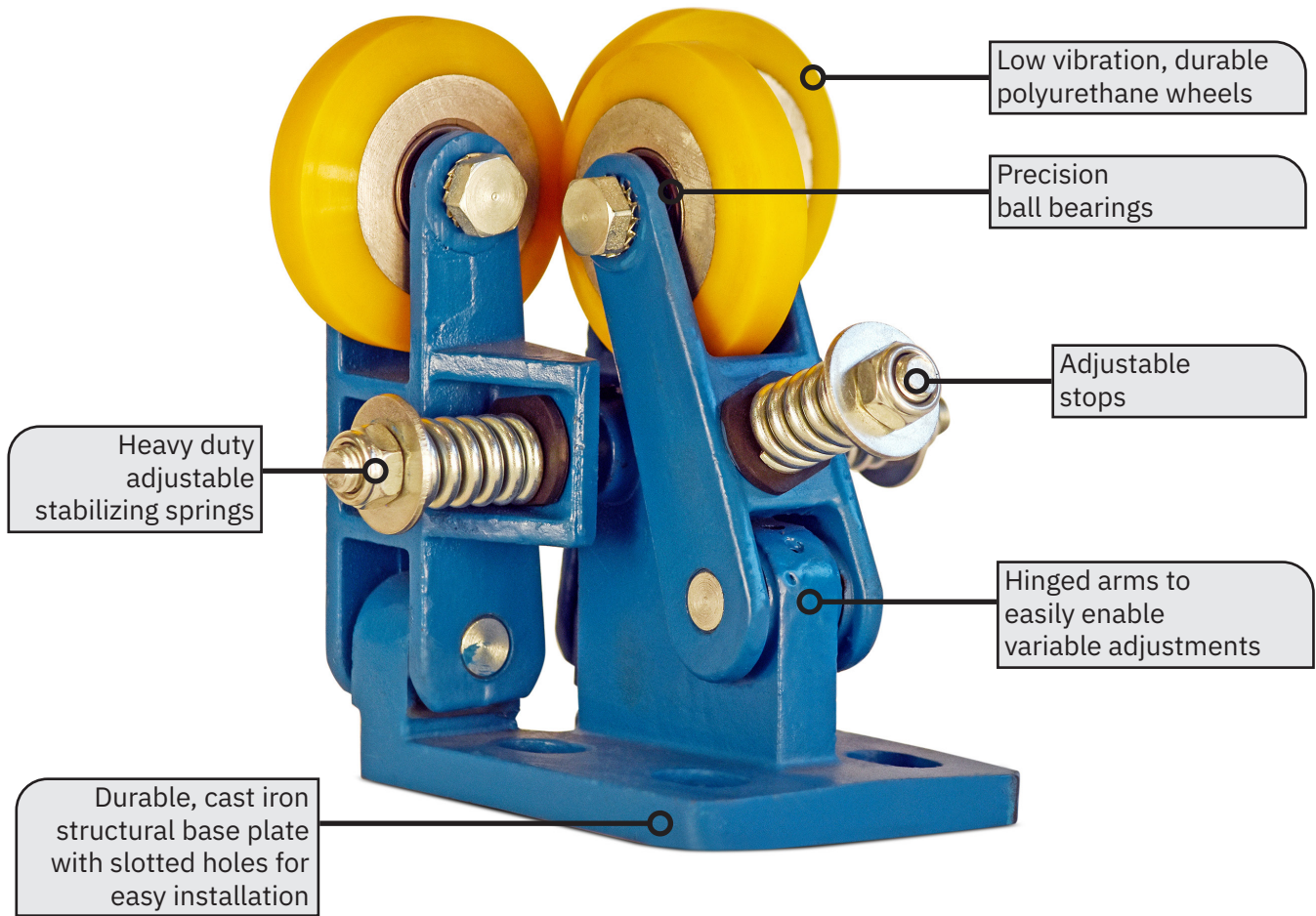

Capacity	Car Side: up to 1388 Lbs (630 Kg) CWT Side: up to 2975 Lbs (1350 Kg)
Speed	Car Side: up to 295fpm (1.5m/s) CWT Side: up to 393fpm (2.0m/s)
Guide Rail Width	10mm (27/64"), 16mm (5/8 ")
Roller Diameter	3 1/4" (82.55mm)
Roller Material	Polyurethane
Roller Hardness	80±5 (Durometer Shore A)
Structural Frame	Cast Iron
Ball Bearings	NSK 6201DU
Weight	13 Lbs (5.8 Kg)

C-08-0810

ROLLER GUIDE ASSEMBLY

3 1/4" STANDARD

Diagram Front View

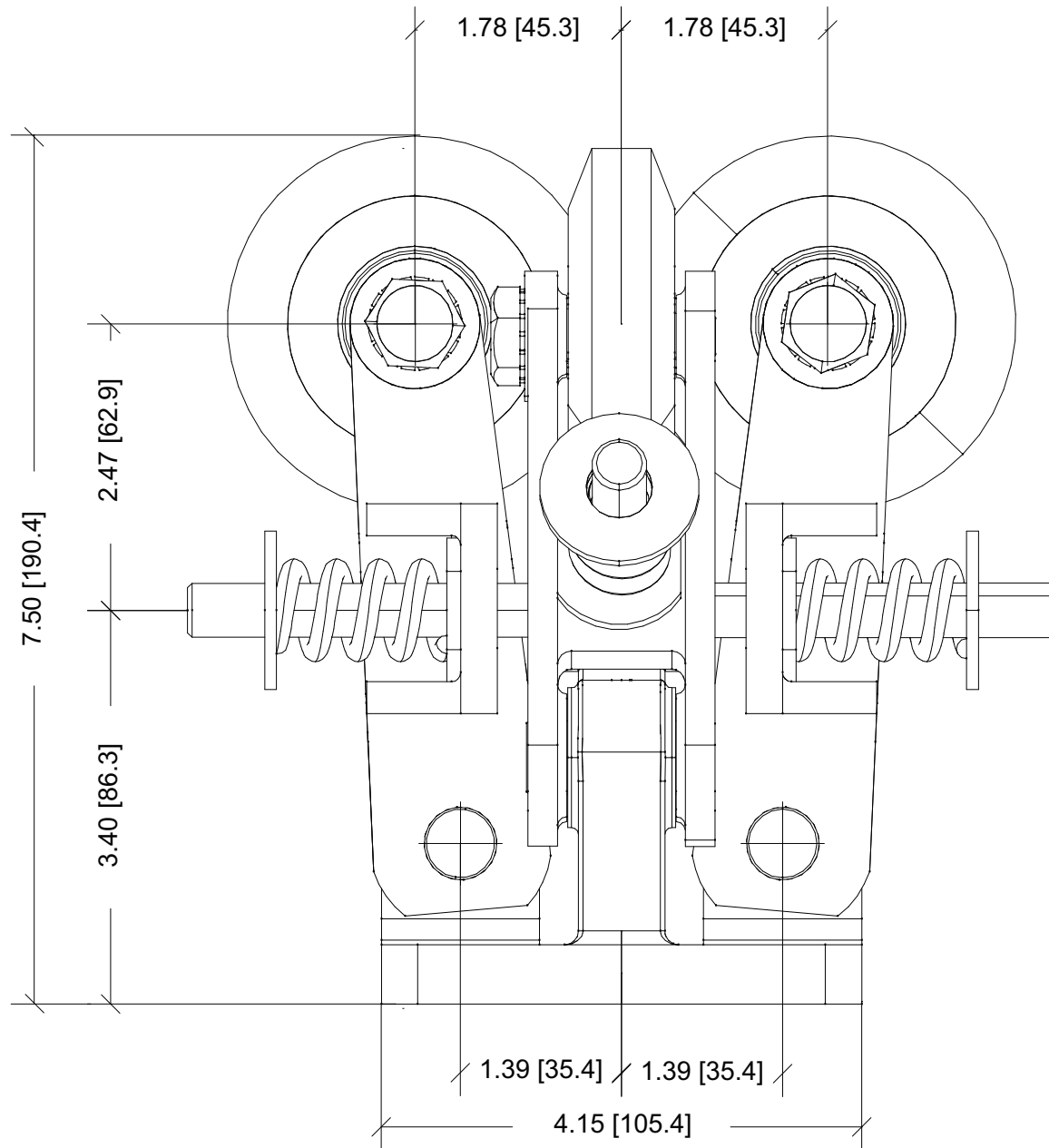

3 1/4" STANDARD

Diagram Side View

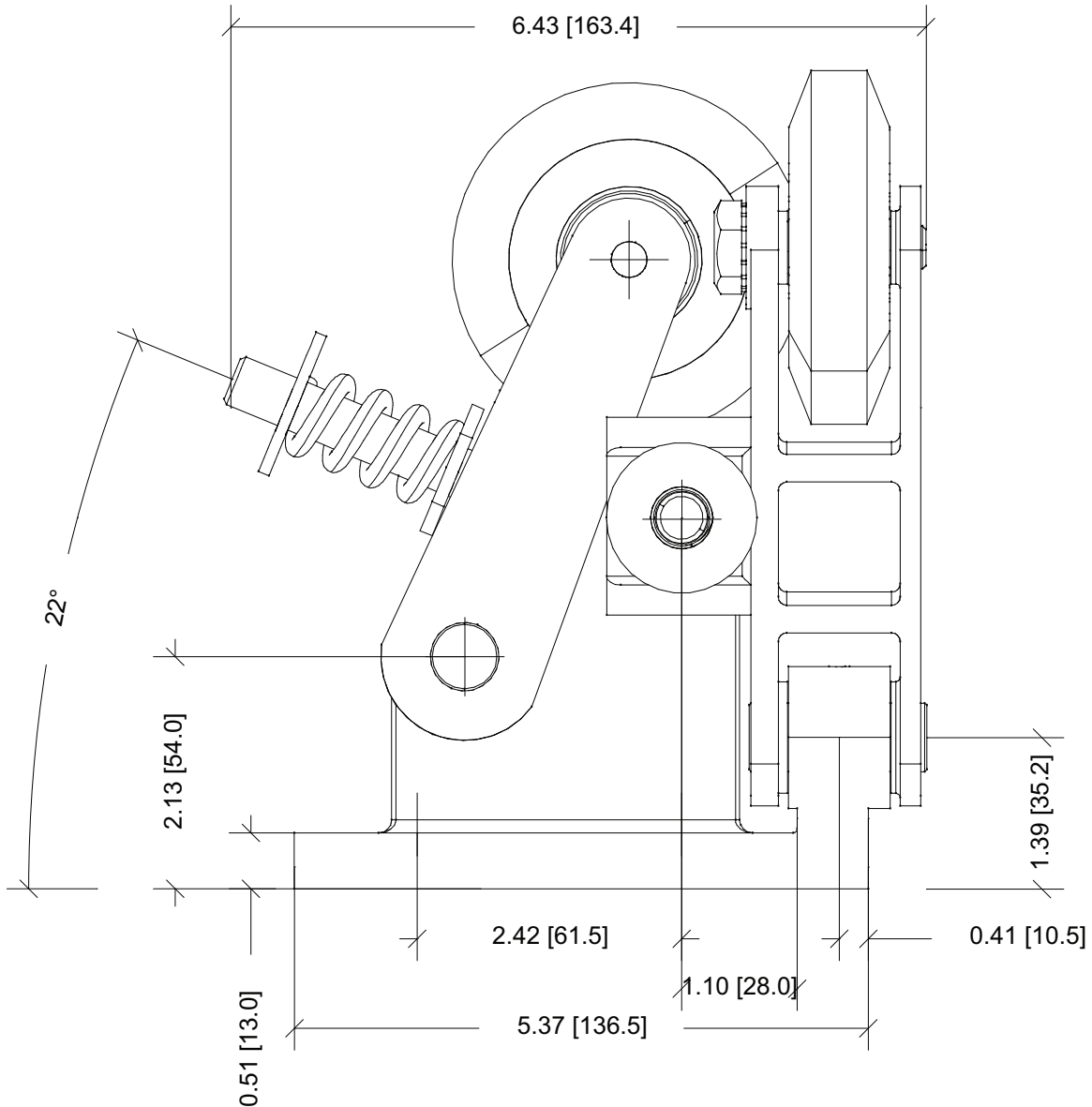

ROLLER GUIDE ASSEMBLY

3 1/4" STANDARD

Diagram Top View

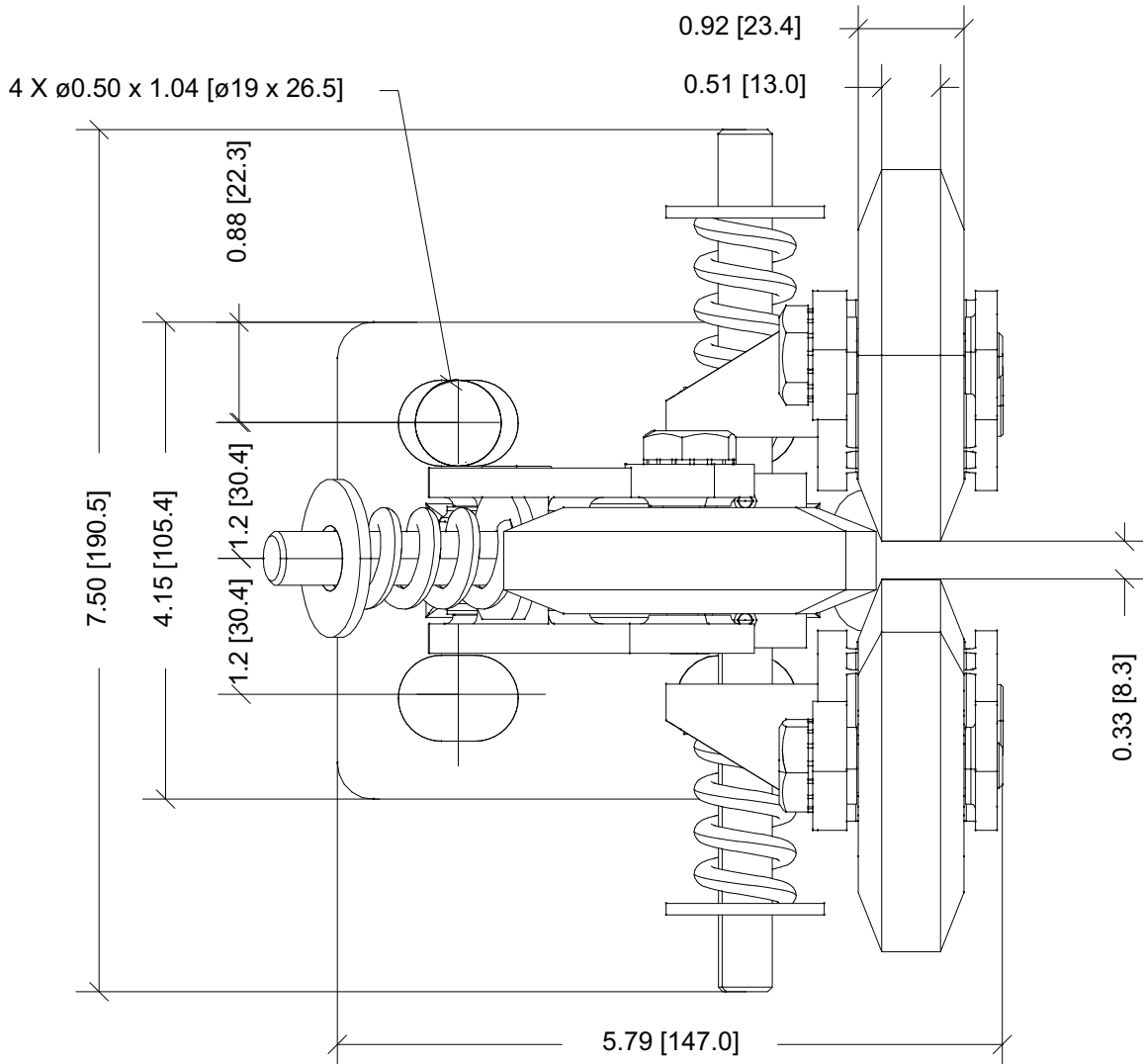

3 1/4" STANDARD

Diagram Baseplate View

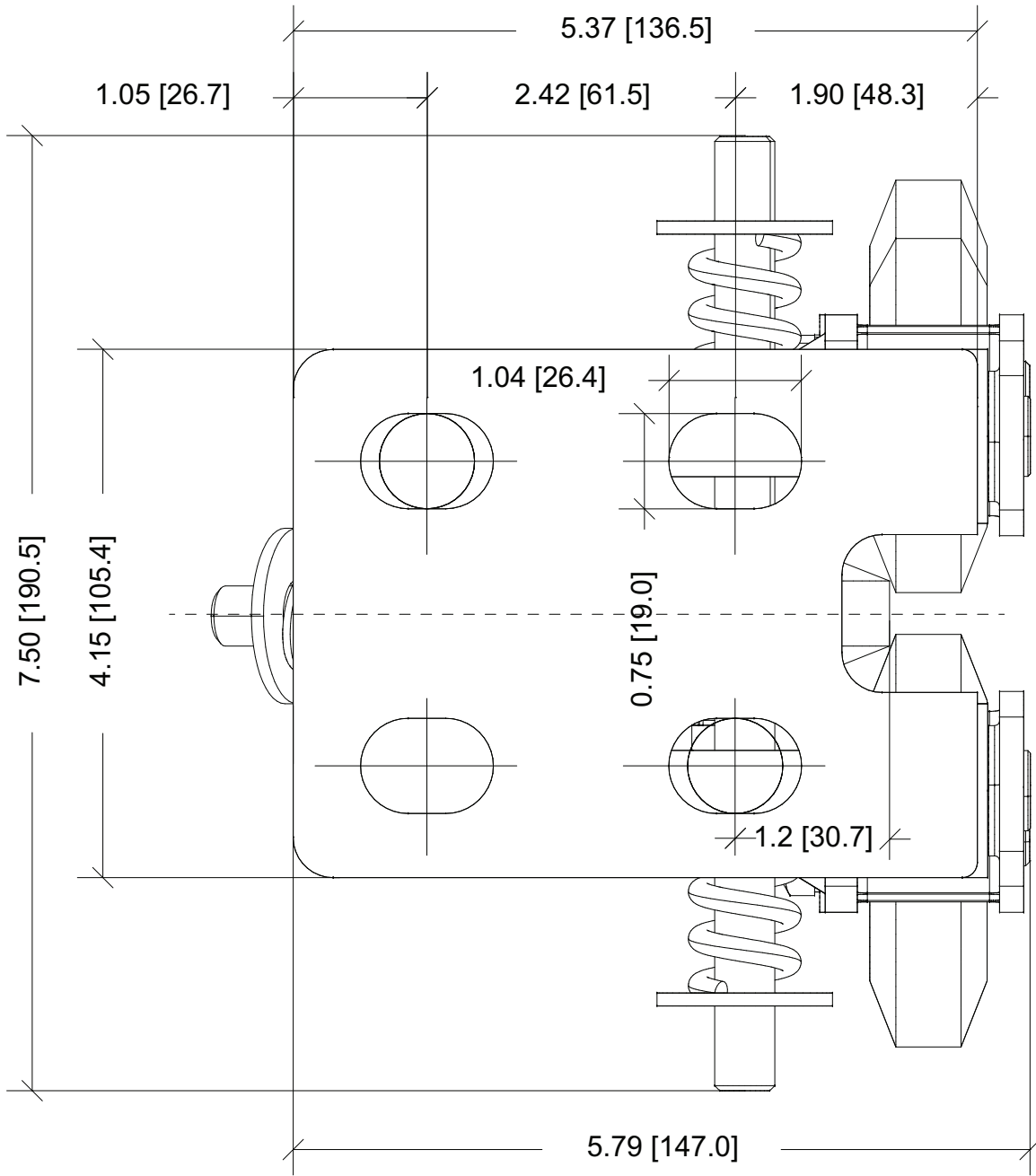

ROLLER GUIDE ASSEMBLY

3 1/4" STANDARD

Exploded View

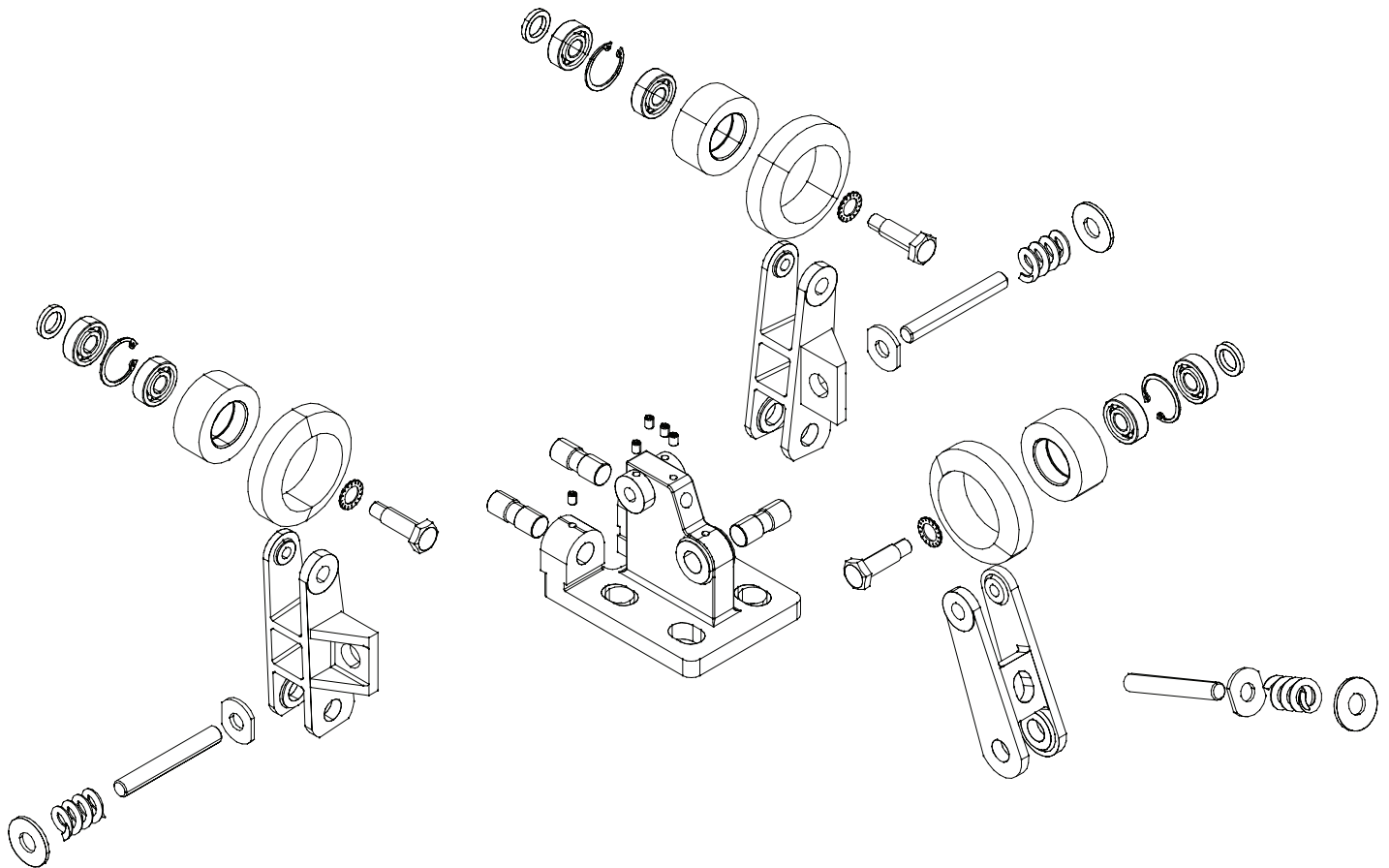

3 1/4" STANDARD

Installation Guide

Note: The following instructions are a guideline only. The installation process may need to be adjusted depending on the specific project and variable pre-existing conditions. Installations must be performed by a certified mechanic.

1. Hole Pattern Alignment

- On new installations use a roller guide mounting hole template to determine the position of the mounting holes in the car/counterweight frame before drilling. Mark and drill holes in the frames, ensuring that the hole size is appropriate for the hardware recommended for the installation.
- For modernization applications check if existing hole pattern or studs match the mounting hole pattern on the guide rail. If the holes locations don't line up a custom made adaptor plate or bracket is required.

2. Release Pressure from Wheels

- Back up the spring locking nut until spring is not loaded and arm can swing easily. Repeat for all wheels (See Diagram 1).

3. Position Guide on Rails

- Position guide over the mounting holes or studs. Make sure guide rail is centered on the rail.
- Ensure that guides are aligned properly on the rail (See Diagram 1).

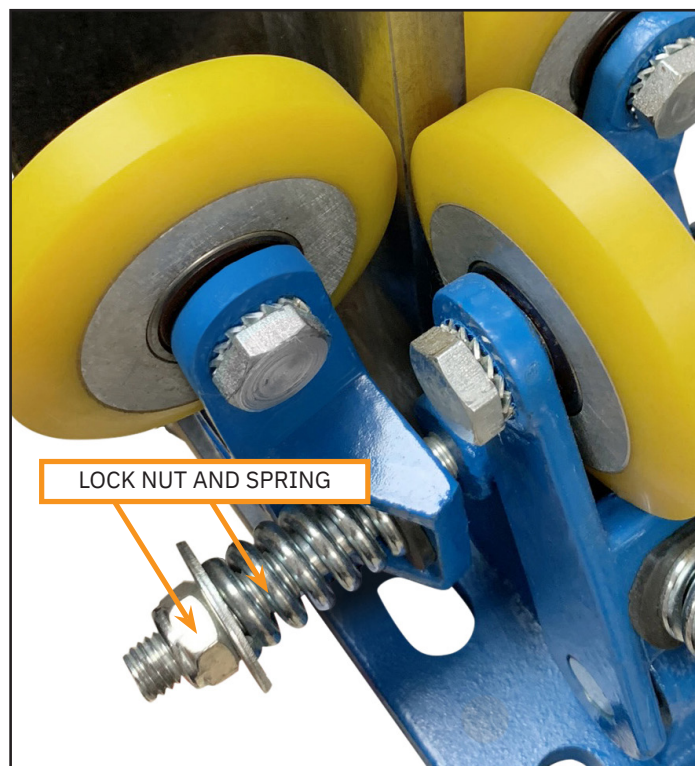
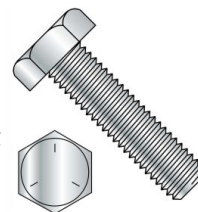

Diagram 1

4. Recommended Hardware

- Use M16 Class 8.8 or 5/8-11 Grade 5 Hex Head bolts and/or nut together with matching grade split lock washers and flat washers.
- Ensure the length of the bolt used will provide a minimum of 1.5 x diameter thread engagement.



5. Tighten Connection

- Securely tighten the mounting bolts and/or nuts until split washer is fully compressed.

3 1/4" STANDARD

Installation Guide

6. Pressure Adjustment for Side Arm Wheels

- Make sure the face of the side arm wheels is tracking in the center of the rail.
- Push the wheel against the rail to make contact. Tighten the lock nut until the spring is in contact with the arm and the washer - but spring is not yet compressed. Repeat this operation on the other side. Measure the height of the spring (see Diagram 2).
- Using a wrench turn the lock nut to compress the spring until the spring is compressed **3-5mm** from free length. The pressure of the two stabilizing springs should be the same. Repeat the operation on the other side.
- To ensure the correct pressure is achieved on the wheel, check that wheels can be skidded by hand on the rail with moderate effort.

7. Pressure Adjustment for Front Arm Wheel

- Make sure the face arm wheels are tracking in the center of the rail.
- Push the wheel against the rail to make contact. Tighten the lock nut until the spring is in contact with the arm and the washer - but spring is not yet compressed.
- Measure the height of the spring.
- Using a wrench turn the lock nut to compress the spring until the spring is compressed **2-4mm**.
- To ensure the correct pressure is achieved on the wheel, check that wheels can be skidded by hand on the rail with moderate effort.

8. Complete Installation

- Install the remaining roller guides on top and/or underneath the elevator/counterweight.
- Repeat the same steps for the lower roller guide assembly (when applicable).

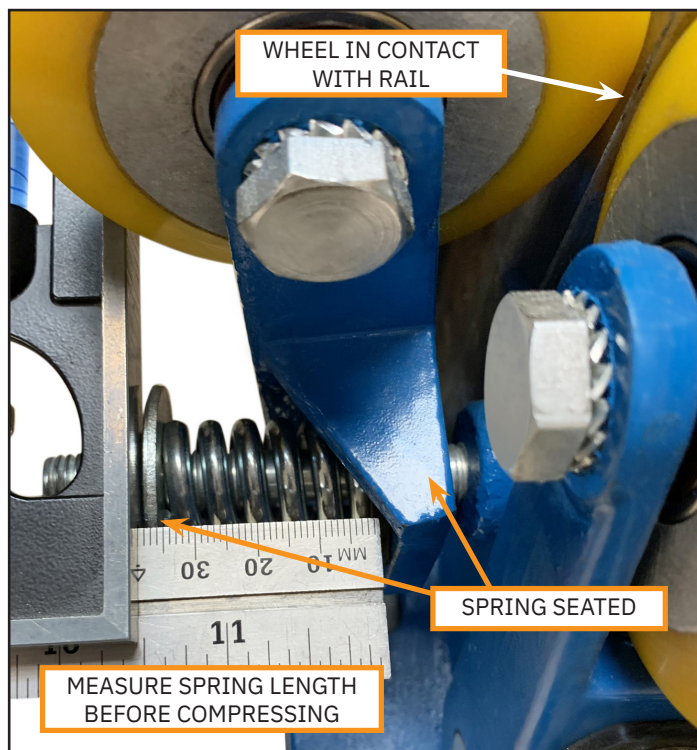

Diagram 2

Important!

- Do not oil the guide rail. Oiling will cause slippage.
- Check the roller guide assembly regularly after correct installation to ensure that it is running evenly and smoothly.
- Be sure to replace the guide wheels as soon as any uneven abrasion on the roller surface or cracks are observed on the springs.

ROLLER GUIDES

8 Models | up to 3000 KG | up to 1200 fpm

With over 12,000 Delco Roller Guide Assemblies installed and running every day, our products are being relied on by hundreds of elevator contractors.

CAPACITY: 0 – 6615 LBS (3000 KG)
SPEED: 0 – 1200 FPM (6.0M/S)

Meeting the requirements for over 90% of elevator installations, Delco offers 8 different RGA models. Low-rise, mid-rise and high-rise buildings throughout North America use Delco Roller Guides.

Easy to install and easy to maintain, Delco Roller Guides are manufactured with high precision, using the best materials, to provide many years of worry-free operation in many different elevator installation situations.

Delco's roller guides are made with the best materials.

Rollers

High quality polyurethane roller tires, with a hardness of 80 ± 5 (Durometer Shore A) provide a comfortable, smooth ride. Polyurethane has a high compression strength and doesn't create flat spots, ensuring reliable operation for many years.

Frame materials

The cast iron frames and heavy duty hardware ensures a long life in all elevator hoistway environments.

Precision Ball Bearings

Delco Roller Guides are made with NSK ball bearings manufactured in Japan, recognized world-wide as the most reliable, high performance bearings.

Product Line

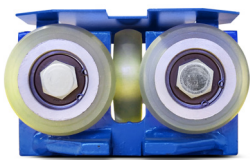

3" SPRING FREE
C-08-0815 (16 mm)
C-08-0817 (10 mm)

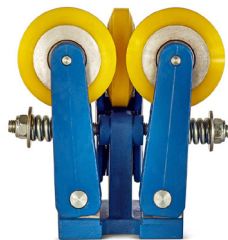

3¼" STANDARD
C-08-0810

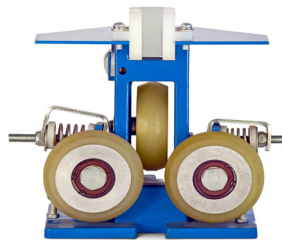

3¼" HIGH SPEED
C-08-0807

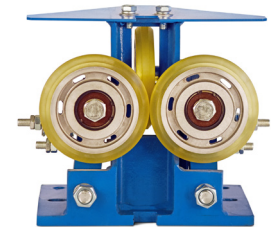

5" STANDARD
C-08-0805

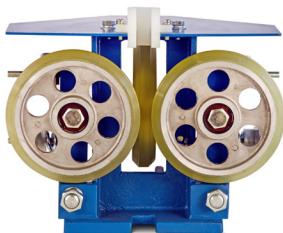

6" STANDARD
C-08-0804



6" SPRING FREE
C-08-0806



7⅞" STANDARD
C-08-0808

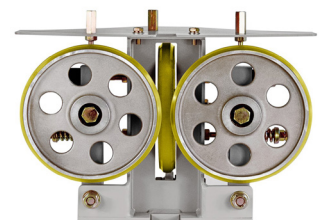

10" HIGH SPEED
C-08-0803

SELECTION GUIDE

Passenger Elevator	0-500fpm (0-2.5m/s)		600-800fpm (3.0-4.0m/s)		1000-1200fpm (5.0-6.0m/s)	
	Delco Car	Delco CWT	Delco Car	Delco CWT	Delco Car	Delco CWT
<3000lbs (<1350kg)	C-08-0805 C-08-0804	C-08-0810 C-08-0807 C-08-0815	C-08-0804	C-08-0807	C-08-0803	N/A
3500lbs (1600kg)	C-08-0805 C-08-0804	C-08-0810 C-08-0807 C-08-0815	C-08-0804	C-08-0807	C-08-0803	N/A
4000lbs (1800kg)	C-08-0804	C-08-0810 C-08-0807 C-08-0806	C-08-0804	C-08-0807	C-08-0803	N/A
4500lbs (2050kg)	C-08-0808	C-08-0806	C-08-0808	C-08-0806	C-08-0803	N/A
5000lbs (2300kg)	C-08-0808	C-08-0806	C-08-0808	C-08-0806	C-08-0803	N/A
6000lbs (2700kg)	C-08-0808	C-08-0806	C-08-0808	C-08-0806	C-08-0803	N/A
7000lbs (3200kg)	C-08-0803	C-08-0806	C-08-0803	C-08-0806	N/A	N/A

Hospital Elevator	0-250fpm (0-1.25m/s)		300-500fpm (1.5-2.5m/s)		600-800fpm (3.0-4.0m/s)		1000-1200fpm (5.0-6.0m/s)	
	Car	CWT	Car	CWT	Car	CWT	Car	CWT
<3000lbs (<1350kg)	C-08-0805 C-08-0804	C-08-0810 C-08-0807 C-08-0815	C-08-0805 C-08-0804	C-08-0810 C-08-0807 C-08-0815	C-08-0804	C-08-0807 C-08-0815	C-08-0803	N/A
3500lbs (1600kg)	C-08-0805 C-08-0804	C-08-0810 C-08-0807 C-08-0815	C-08-0805 C-08-0804	C-08-0810 C-08-0807 C-08-0815	C-08-0804	C-08-0807	C-08-0803	N/A
4000lbs (1800kg)	C-08-0804	C-08-0806	C-08-0804	C-08-0806	C-08-0804	C-08-0807	C-08-0803	N/A
4500lbs (2050kg)	C-08-0808	C-08-0806	C-08-0808	C-08-0806	C-08-0808	C-08-0806	N/A	N/A
5000lbs (2300kg)	C-08-0808	C-08-0806	C-08-0808	C-08-0806	C-08-0808	C-08-0806	N/A	N/A
6000lbs (2700kg)	C-08-0808	C-08-0806	C-08-0808	C-08-0806	C-08-0808	C-08-0806	N/A	N/A
7000lbs (3200kg)	C-08-0803	C-08-0806	C-08-0803	C-08-0806	C-08-0803	C-08-0806	N/A	N/A

Freight Elevator

For freight elevator applications the Roller Guide Assembly selection will be based on the number of guide rails. For applications with 2 guide rails, refer to the Passenger Elevator chart above. For applications with 4 or more guide rails, please contact us.

Important!

Please note that this table is only to be used as a guideline. Roller Guide Assembly selection must take many other criteria into consideration that can't be accounted for in this chart. Please contact us for selection assistance.

ROLLER GUIDE ASSEMBLY

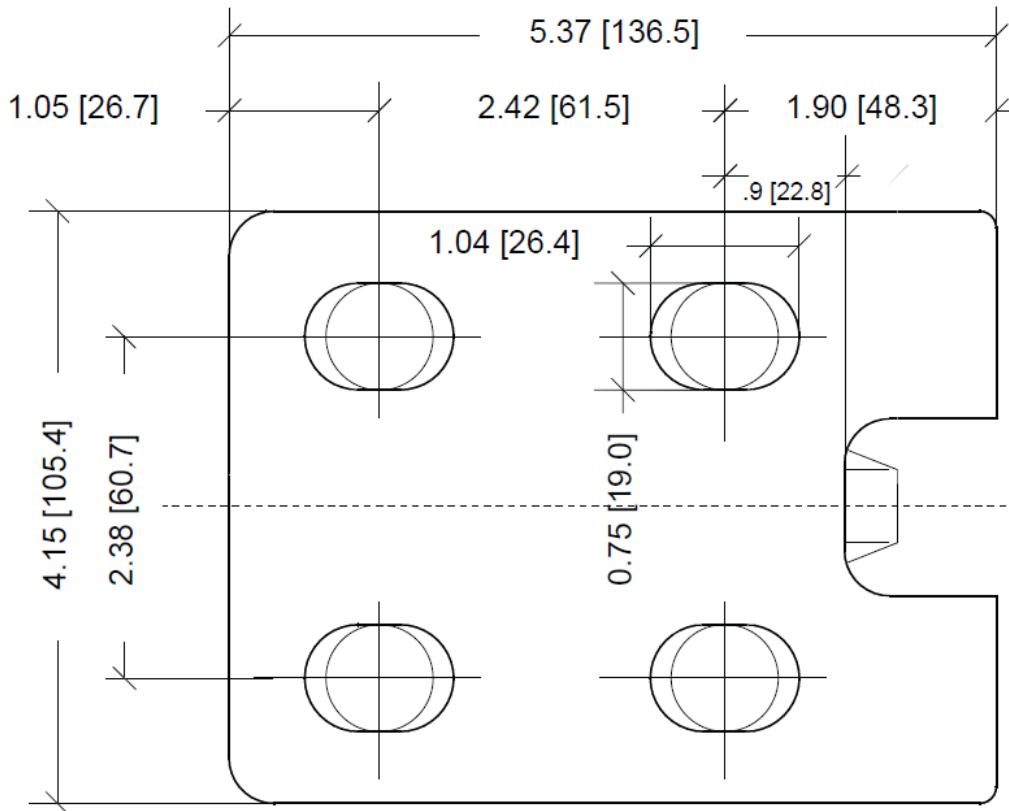

Delco
3 $\frac{1}{4}$ " Standard
Roller
Guide
Assembly
Template