

Assembly instructions

Thatsit™

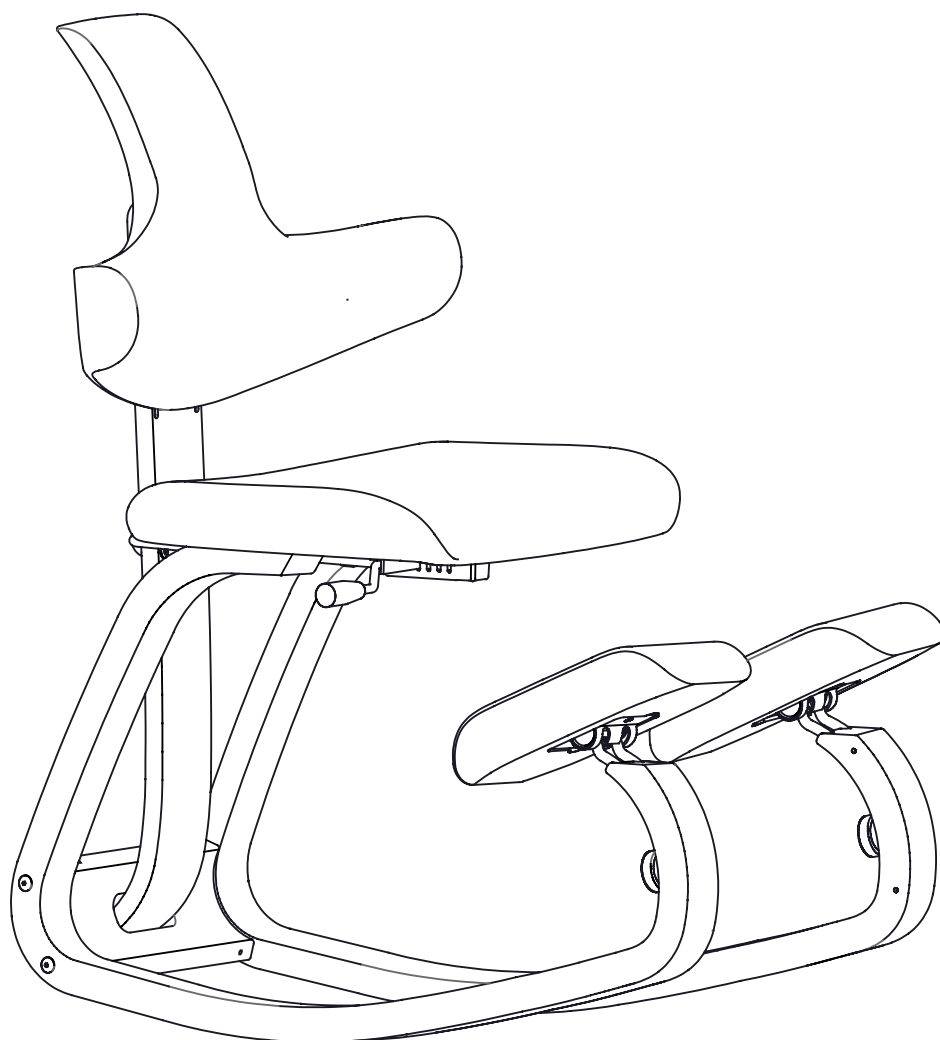

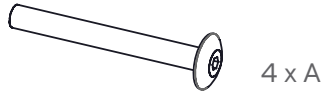

4 x A



2 x B



7 x C



1 x D



4 x E



3 x F

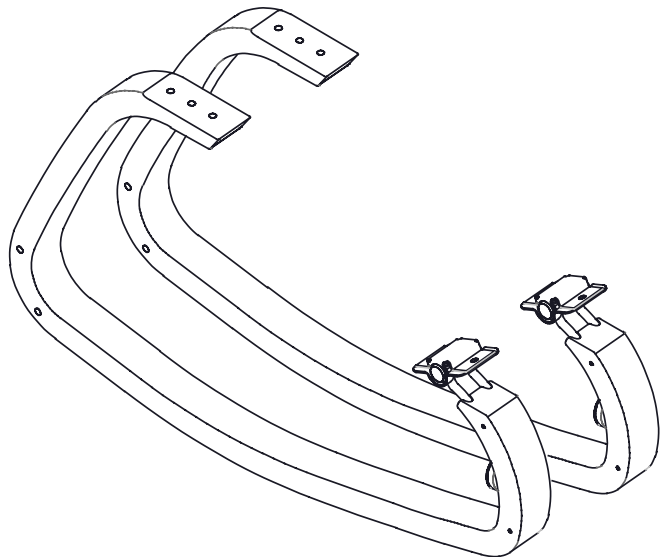
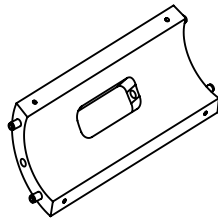
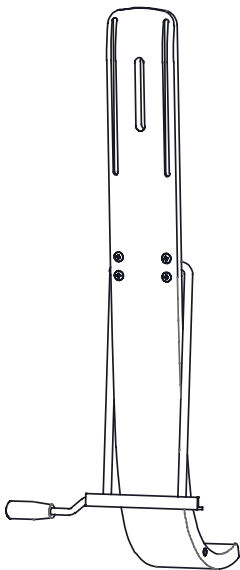
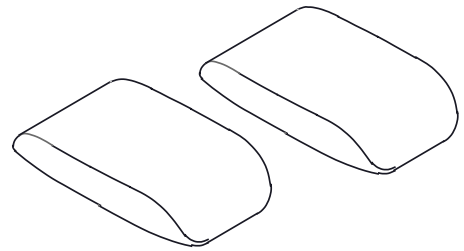
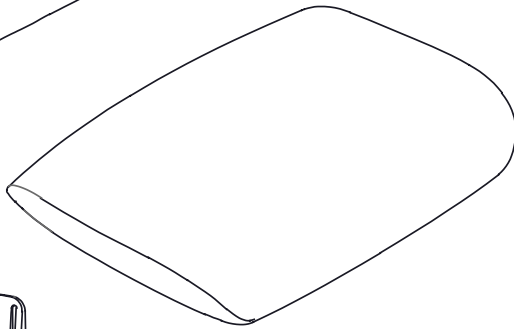
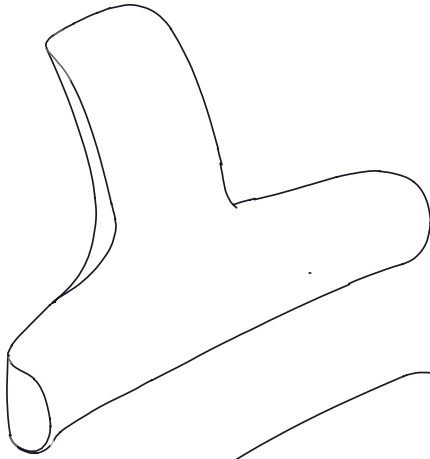
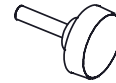
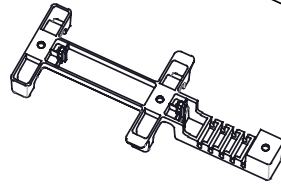
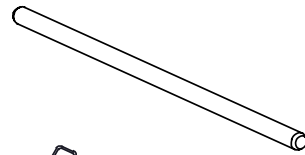

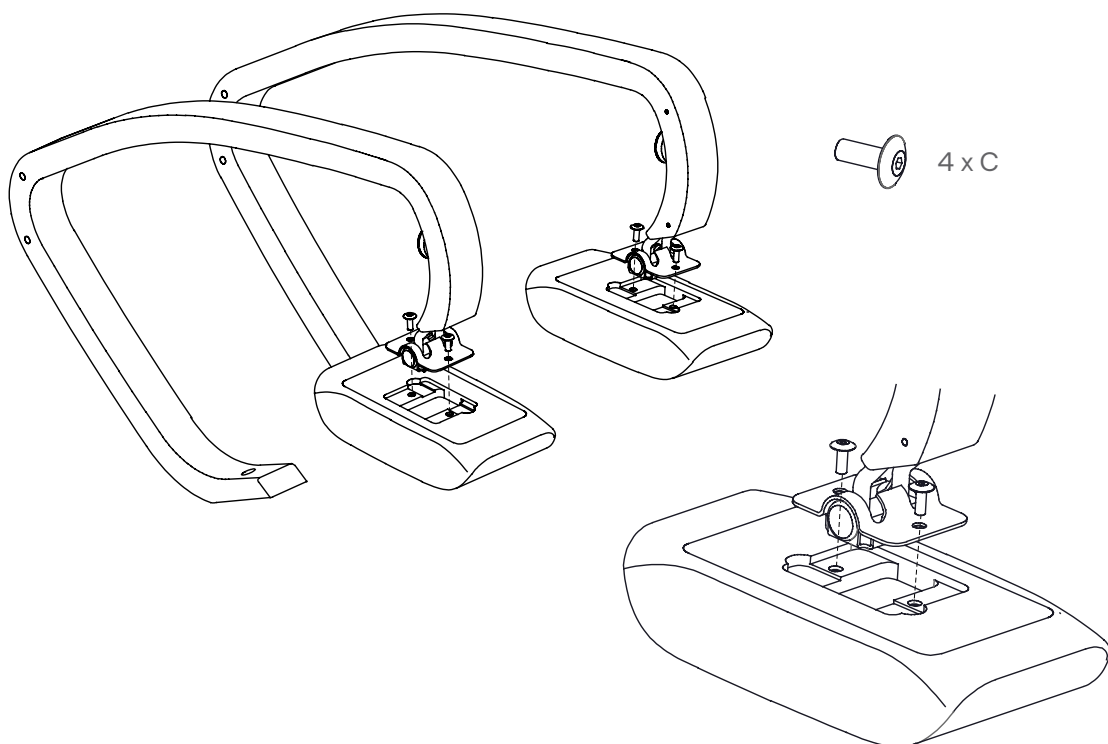

4 x C

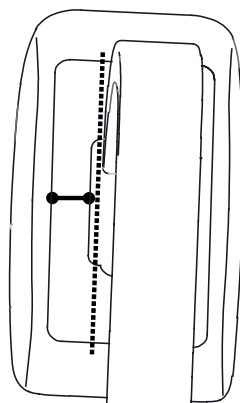
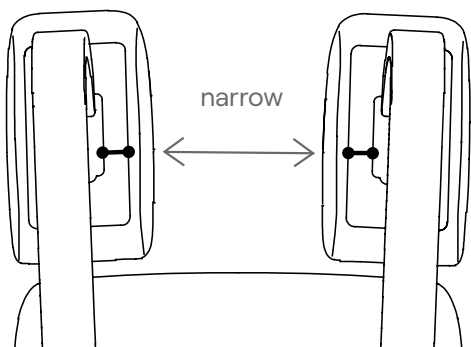

EN

Choose the distance you wish between the knee pads. For a narrow setting, mount the knee pads with the zipper facing inwards. For a wider setting, mount the knee pads with the zippers facing outwards.

DE

Wählen Sie den gewünschten Abstand zwischen den Kniepolstern. Montieren Sie die Polster für einen geringeren Abstand mit dem Reißverschluss nach innen, oder für einen breiteren Abstand mit dem Reißverschluss nach außen.

IT

Scegli tra due impostazioni di larghezza tra le ginocchiere. Per un'impostazione stretta, montare le ginocchiere con la cerniera rivolta verso l'interno. Per una regolazione più ampia, montare le ginocchiere con le cerniere rivolte verso l'esterno.

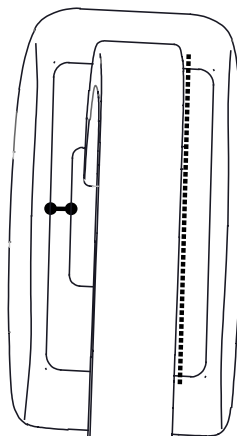
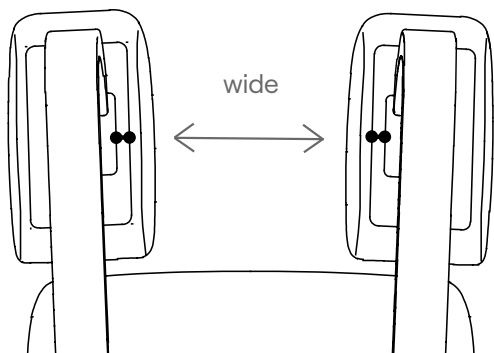

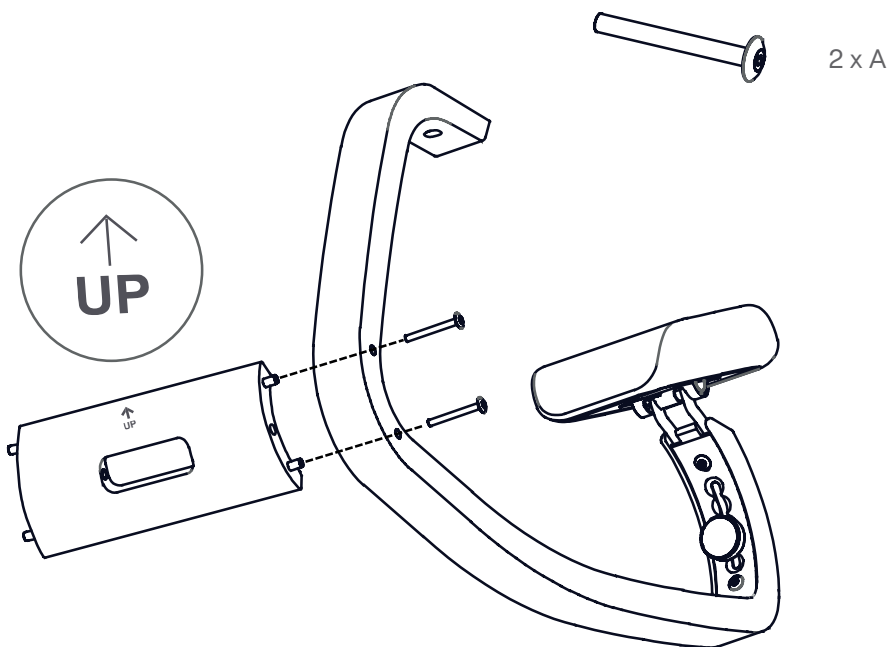

EN

Mount the floor brace with the short side up and the long side down.

DE

Montieren Sie die Quersarge mit der kurzen Seite nach oben und der langen Seite nach unten.

IT

Assemblare il traverso con il lato corto in alto e il lato lungo in basso.

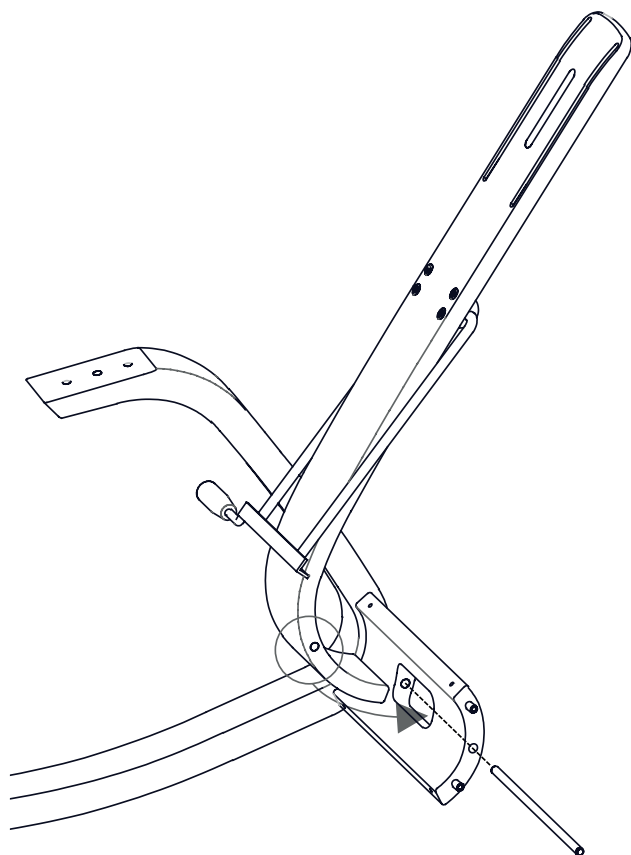

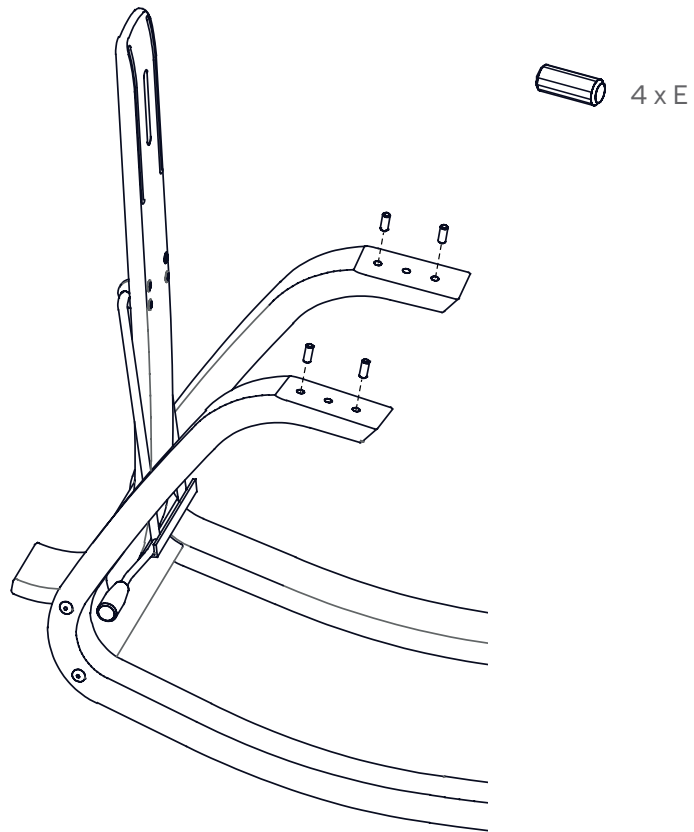
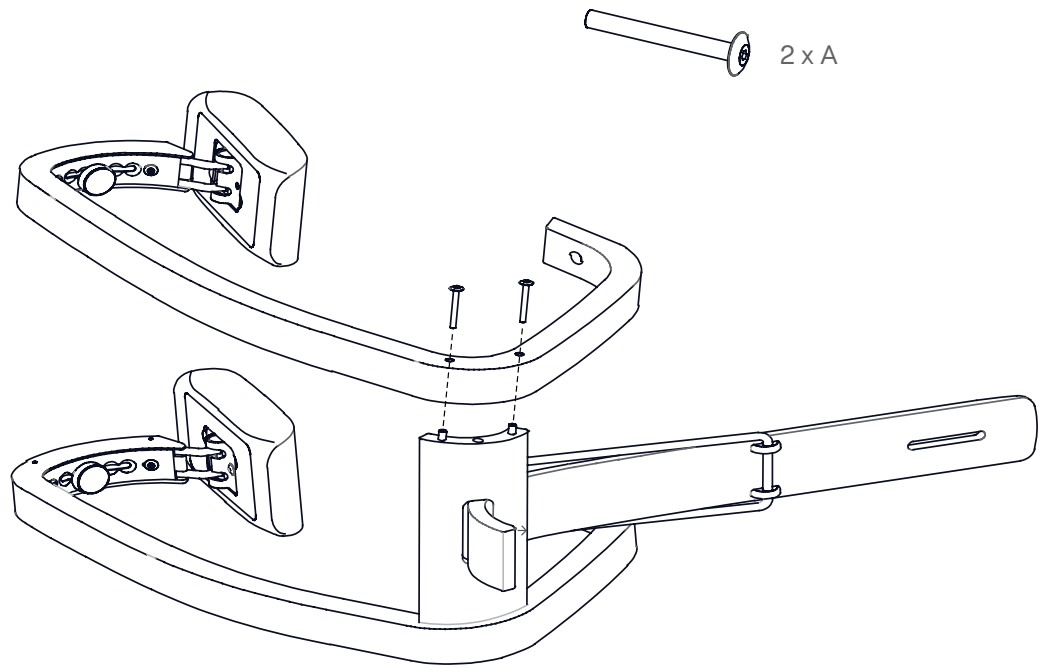

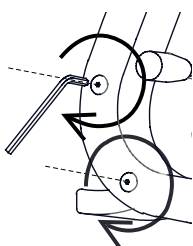
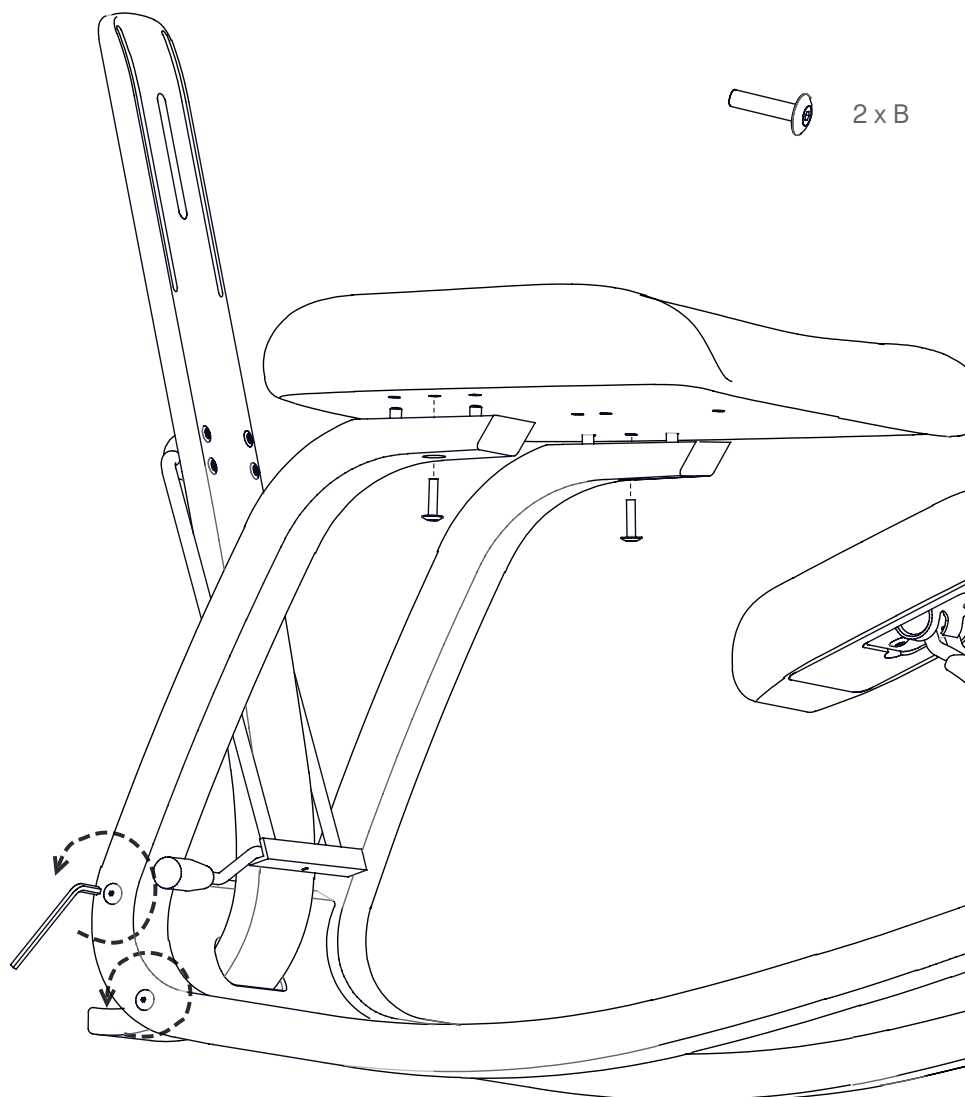

EN

Tighten the screws one round before attaching the seat to the runners. Tighten the screws properly once all parts have been put together.

DE

Ziehen Sie die Schrauben leicht an, bevor Sie den Sitz auf dem Holzgestell montieren. Nachdem alle Teile befestigt wurden, ziehen Sie die Schrauben fest an.

IT

Stringere le viti di un giro prima di fissare il sedile alle guide. Stringere le viti correttamente una volta che tutte le parti sono state assemblate.

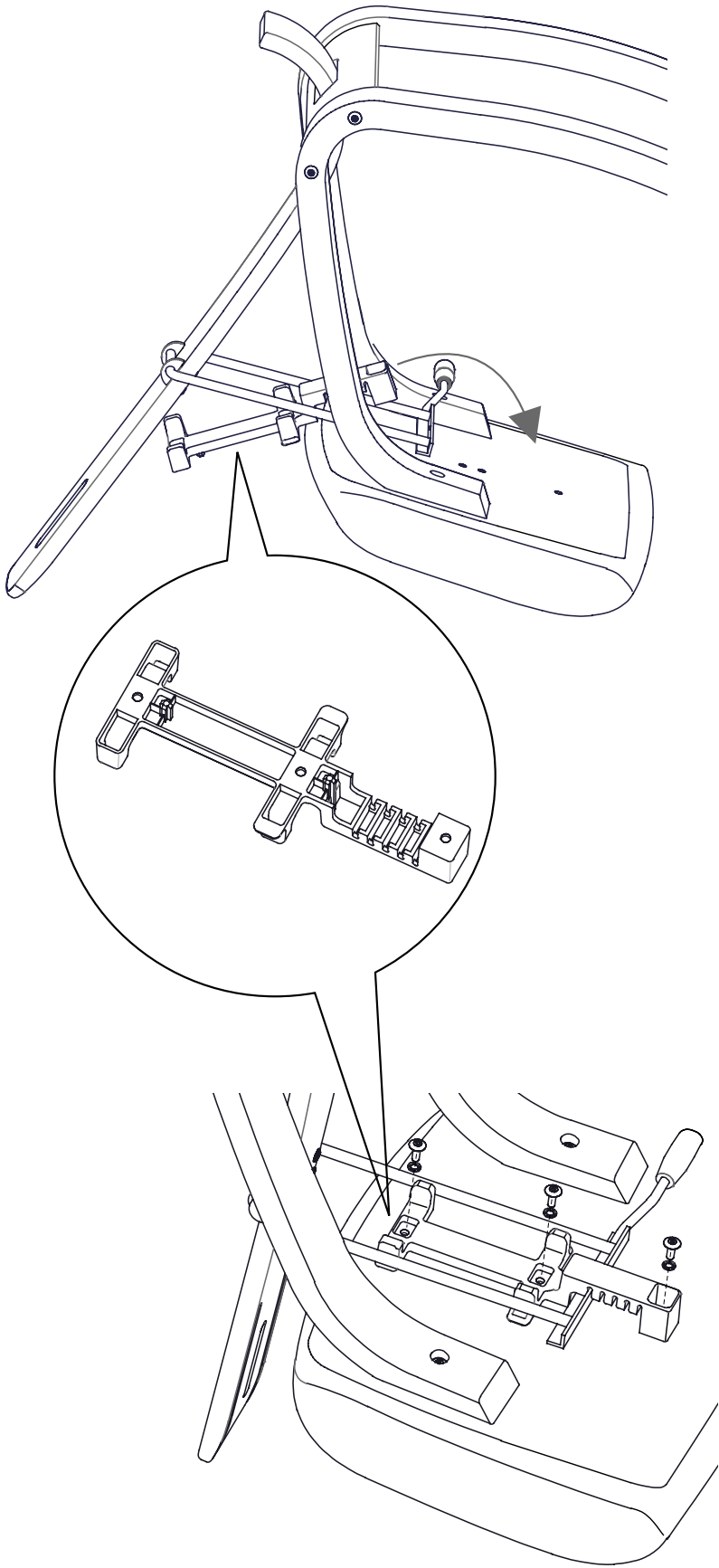

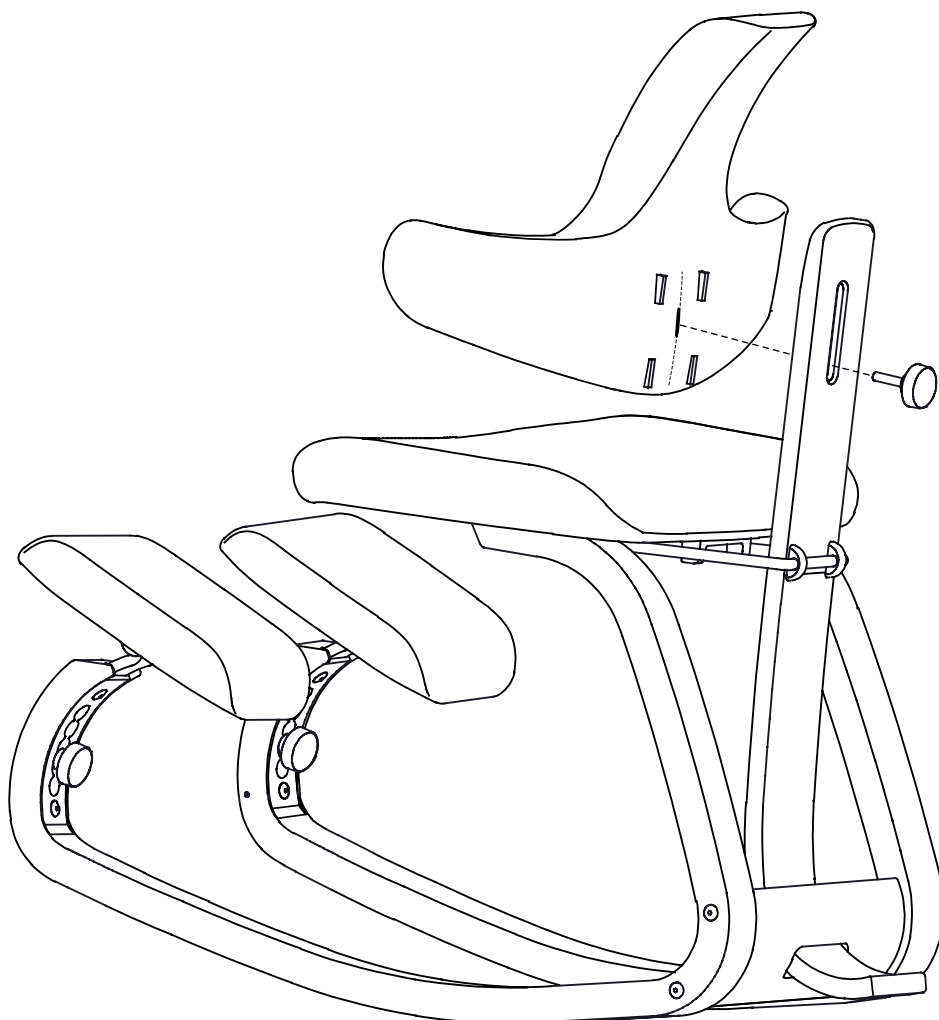

EN

Place the back lever to fasten the backrest. Adjust to achieve the desired height.

DE

Montieren Sie den Knauf, um die Rückenlehne zu befestigen. Stellen Sie danach die gewünschte Höhe ein.

IT

Posizionare il pomolo dello schienale per fissare lo schienale. Regolare per ottenere l'altezza desiderata.