

# Stephanie design

LIGHTING | FURNITURE | HOMEWARE | ART

---

*A Journey through Lighting Design*



**Commercial**

**Public Areas**

Lift Lobby  
Games Room  
Kitchen  
Entrance Foyer



# PAVILION THE PARK, BUKIT JALIL

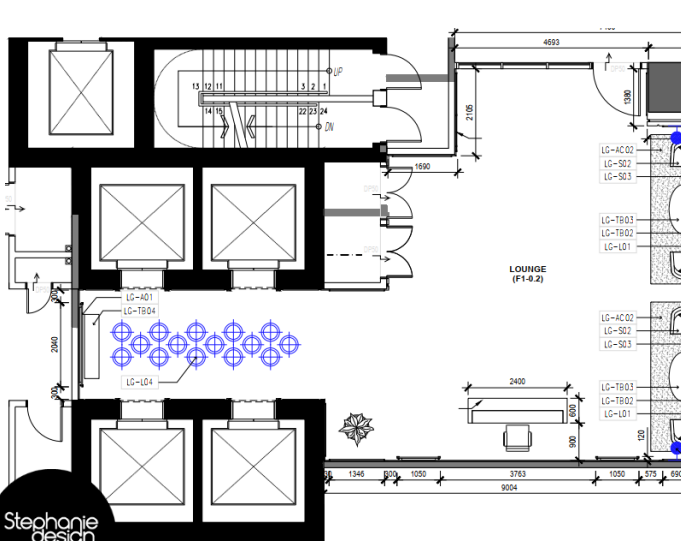
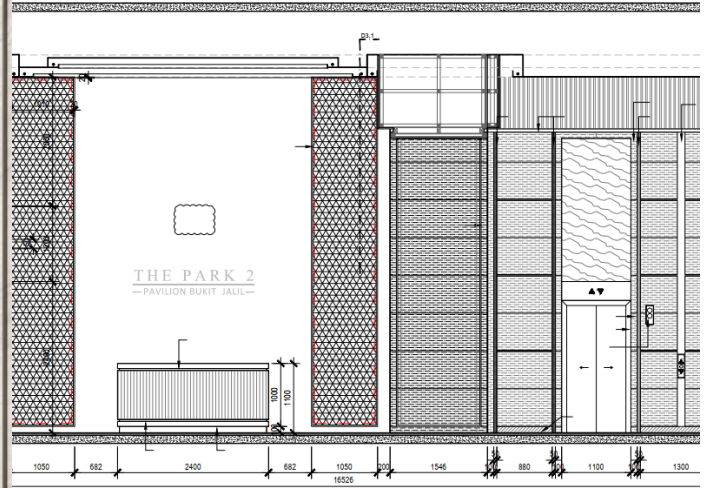
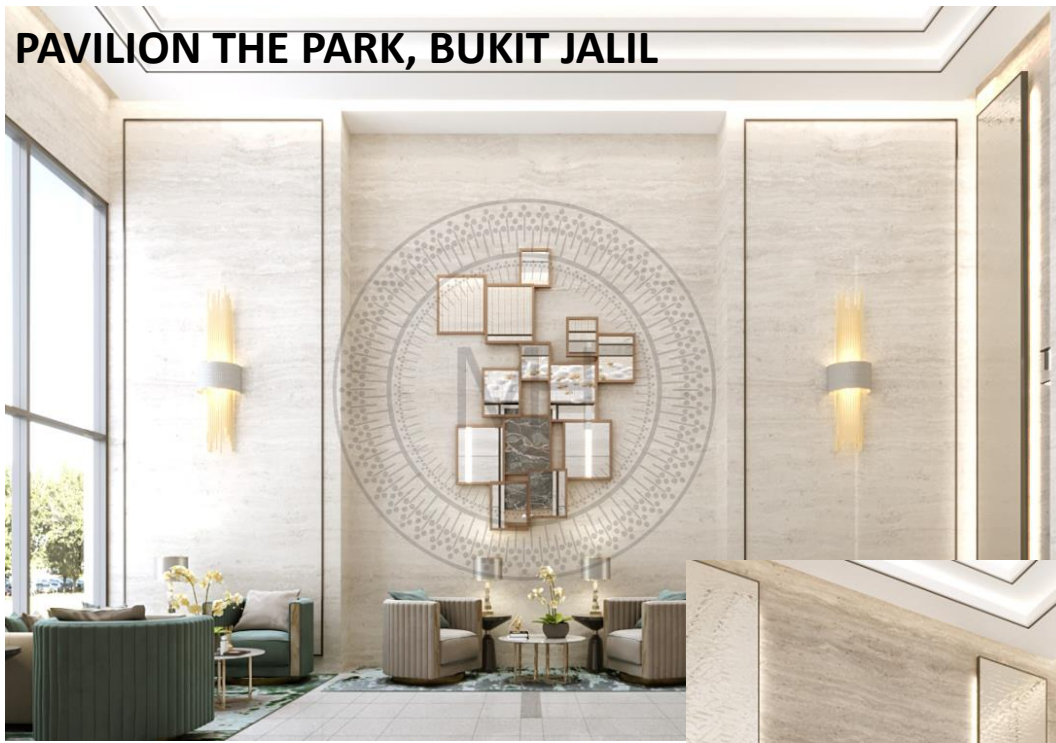





PAVILION THE PARK BUKIT JALIL

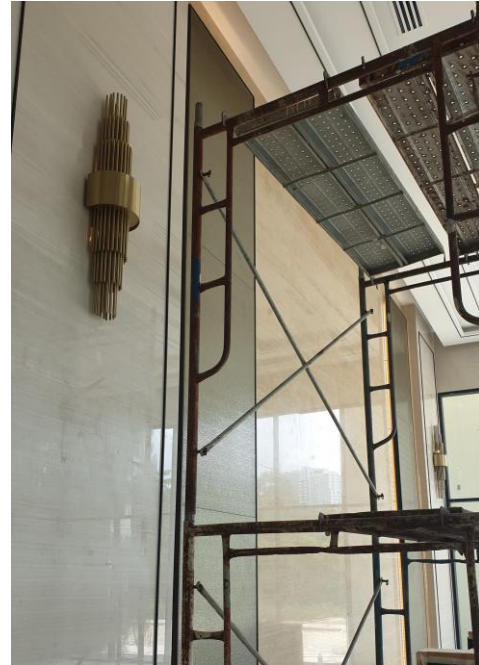



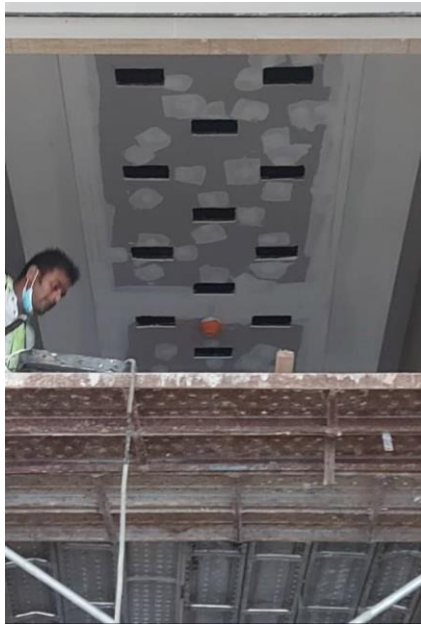

**PAVILION THE PARK, BUKIT JALIL**





PAVILION THE PARK, BUKIT JALIL





**Residential**

**All Rooms**  
Living  
Dining  
Kitchen  
Master Bedroom  
KTV Room





# SETIA BAKTI, DAMANSARA HEIGHTS

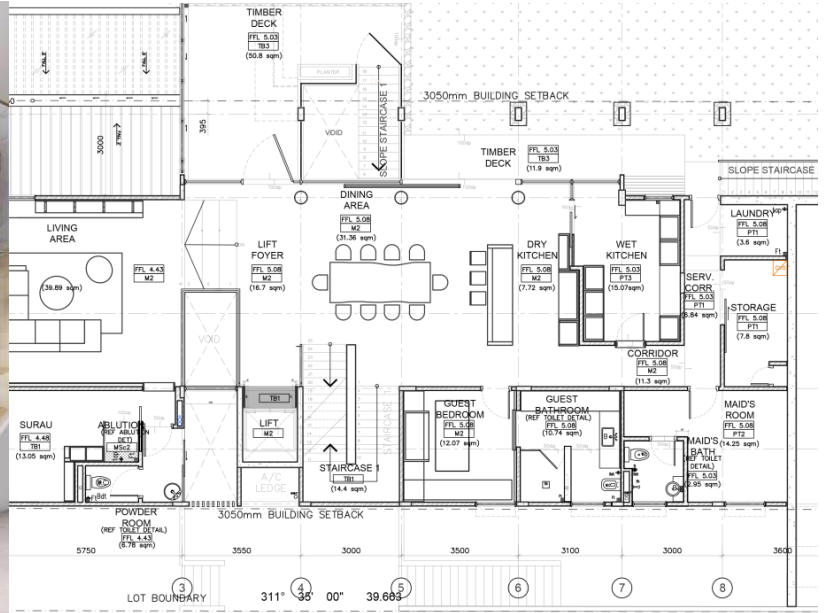

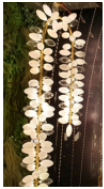

Reference Image

Total Glass - 93pcs

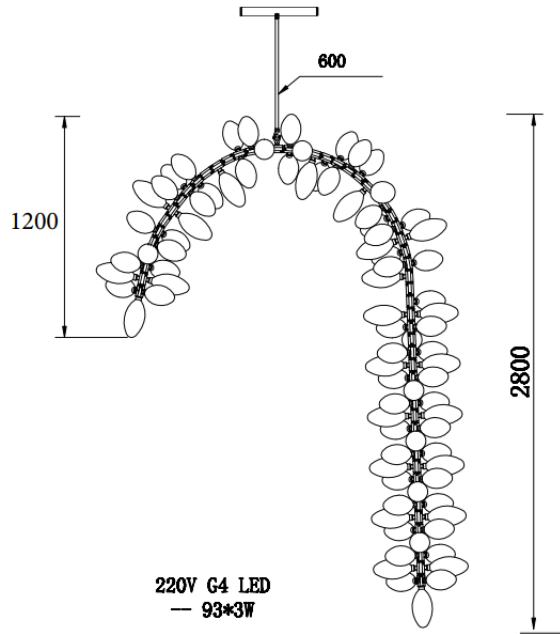

220V G4 LED  
— 93\*3W



Reference Image

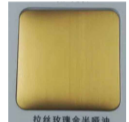

Brush Rose Gold JN-9015

Remark: There is a slight color difference between the swatch and the actual product, all finishes are subject to the actual product.



Reference Image

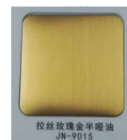

Brush Rose Gold JN-9015

Remark: There is a slight color difference between the swatch and the actual product, all finishes are subject to the actual product.

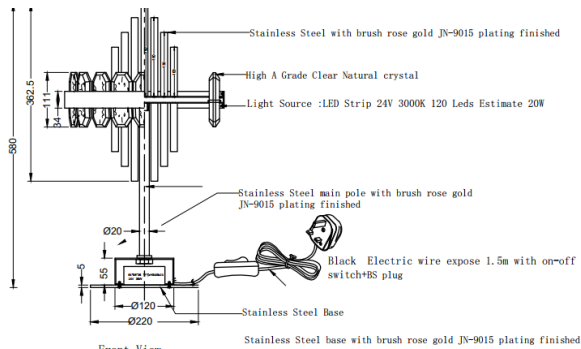

Front View

Stainless Steel base with brush rose gold JN-9015 plating finished

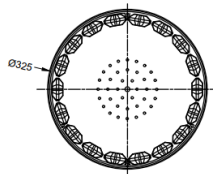

Vertical View

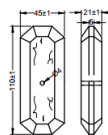

clear natural crystal details

PS: Offer 1m chain to client

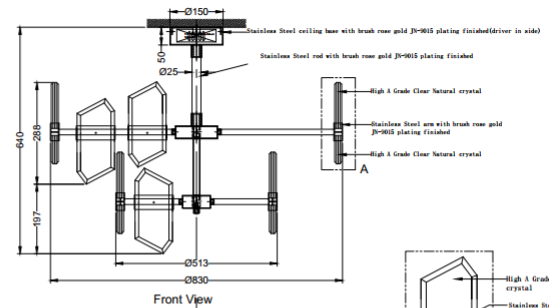

Front View

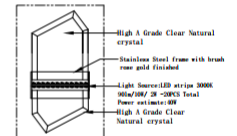

Part A Details

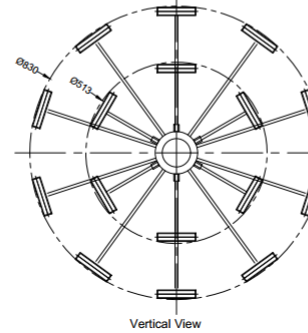

Vertical View

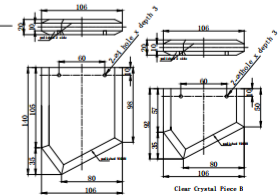

Clear Crystal Piece A

Clear Crystal Piece B

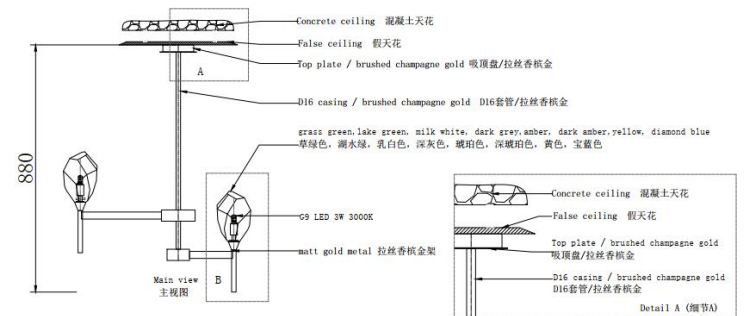

Main view

主视图

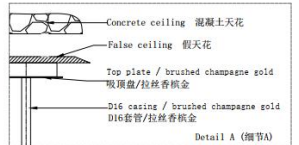

Detail A (细节A)

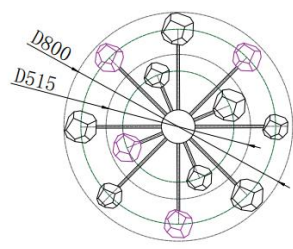

Overlook map

俯视图

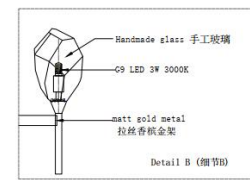

Detail B (细节B)



Detail of A





**SETIA BAKTI , DAMANSARA HEIGHTS**



**SETIA BAKTI , DAMANSARA HEIGHTS**









**Fit - Out**

**All Rooms**  
Living  
Dining  
Master Bedroom  
Bedroom 1/2





# PAVILION CEYLON

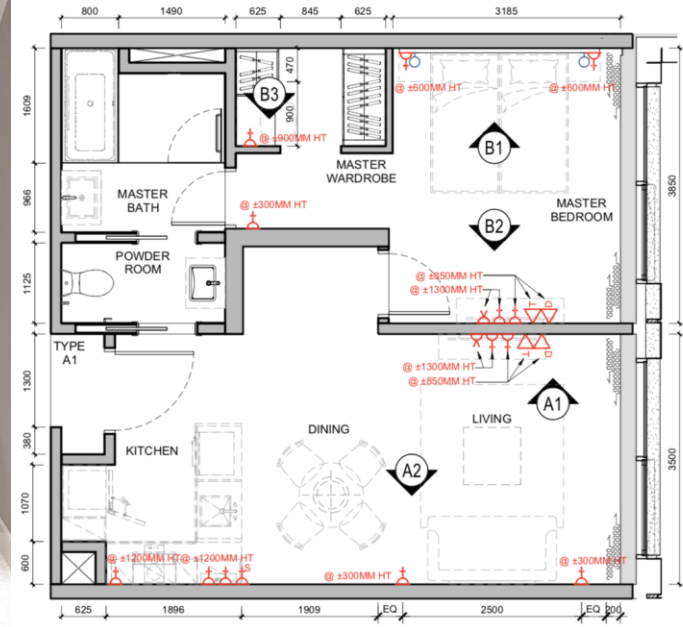

# FIT OUT - PAVILION CEYLON

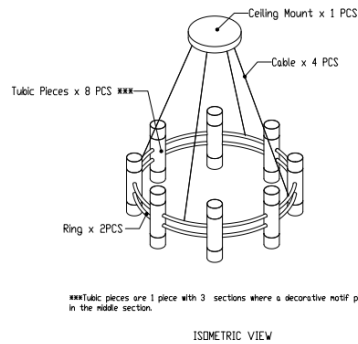
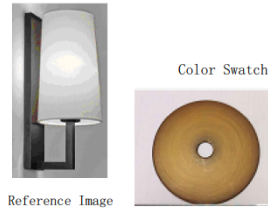
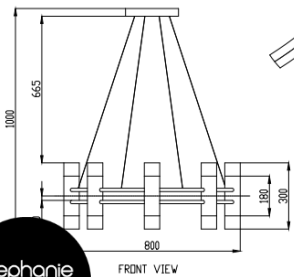
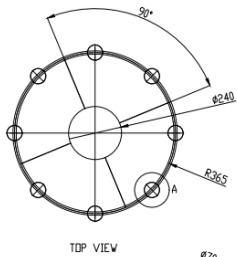
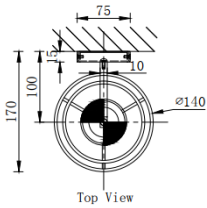
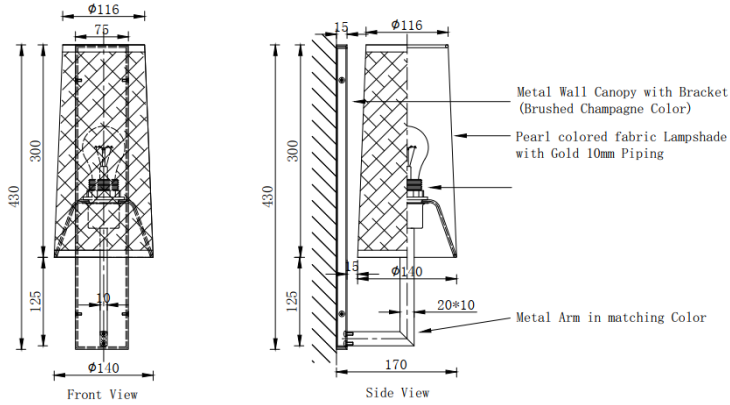

DETAIL A  
SCALE 1:2  
0.8 MM THICKNESS

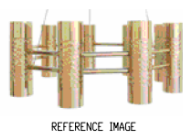

## Lighting Specification Sheet

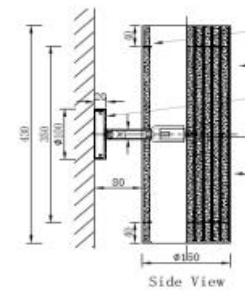
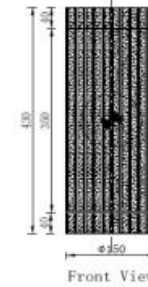

<b>Project Reference</b>	PM 342
<b>Product Type</b>	Wall Lamp
<b>Code</b>	LO 4
<b>Finished</b>	Brushed B16 antique brass finished
<b>Size</b>	D150mm x H430mm
<b>Color</b>	Antique Brass - B16
<b>Material</b>	Metal + Glass Rod
<b>Lamp Source</b>	E14 x 5 W LED x 1
<b>Bulb</b>	LED
<b>Light Source</b>	2700k/ Warm White
<b>Dimmable</b>	No
<b>Lead Time</b>	45 Day
<b>Weight</b>	Estimate 1.5Kg /pc



PAVILION CEYLON

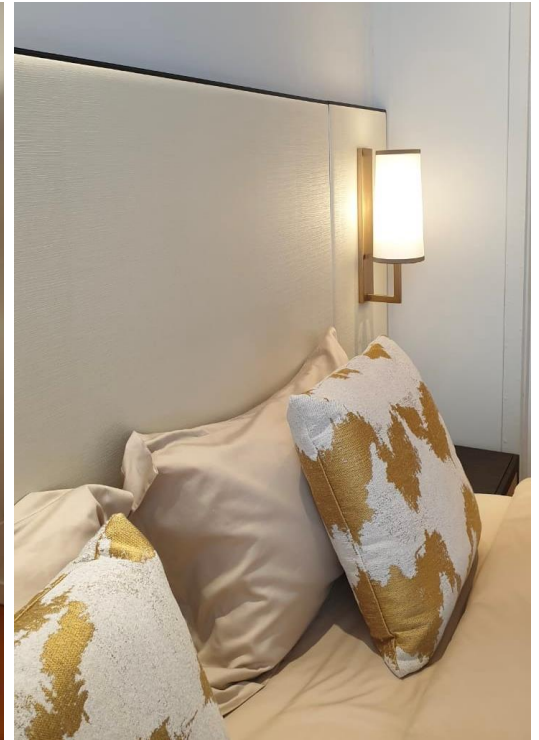



# Total Fit - Out

## Common Area

Lift Lobby  
Games Room  
Lifestyle Kitchen  
Multi Purpose Hall  
Gym & Yoga

## All Rooms

Living  
Dining  
Master Bedroom  
Bedroom 1/2





# PAVILION EMBASSY – COMMON AREA (IN PROGRESS)

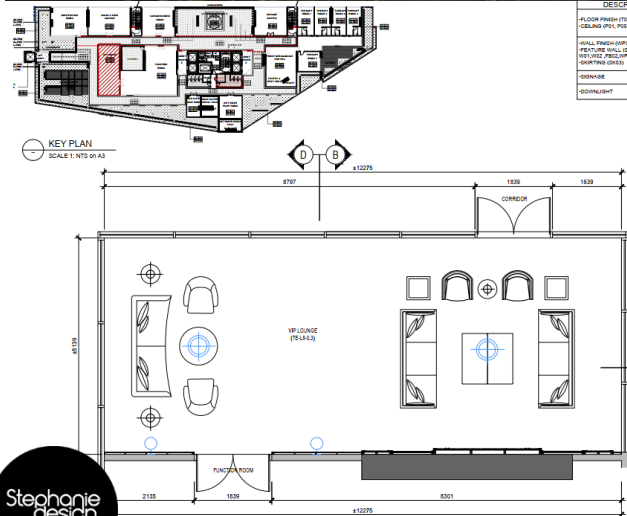
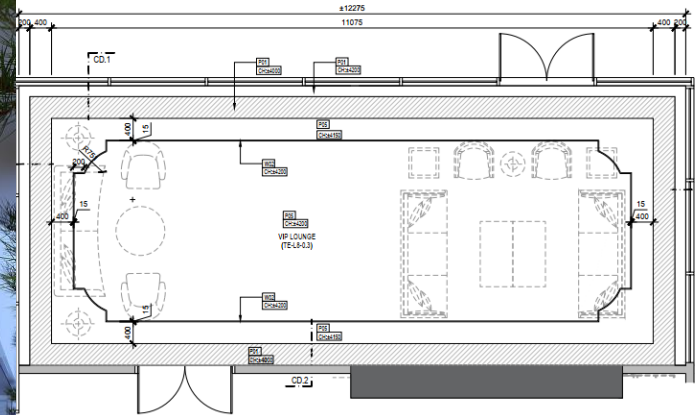



PAVILION EMBASSY – ALL UNITS



# PAVILION EMBASSY – ALL UNITS

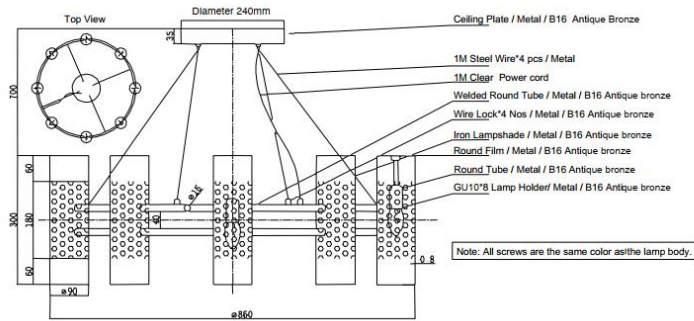

B16 Antique Bronze  
Color Swatch



1. Material - Iron
2. The accessories and screws are the same color, use of B16 Antique bronze color swatch
3. Assemble all together.
4. Lampsouce GU10, 5W, 3000K, Include Bulb.
5. Transparent power cord.
6. Everything used the B16 color plate
7. Round tube lamp body, bottom part uses acrylic cover.
- 8.SUS thickness 0.8mm

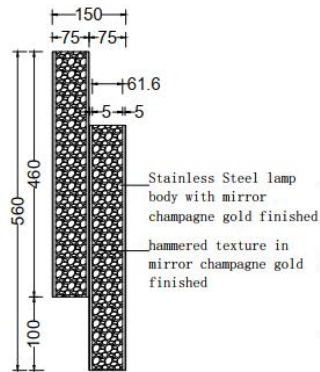

Reference Picture

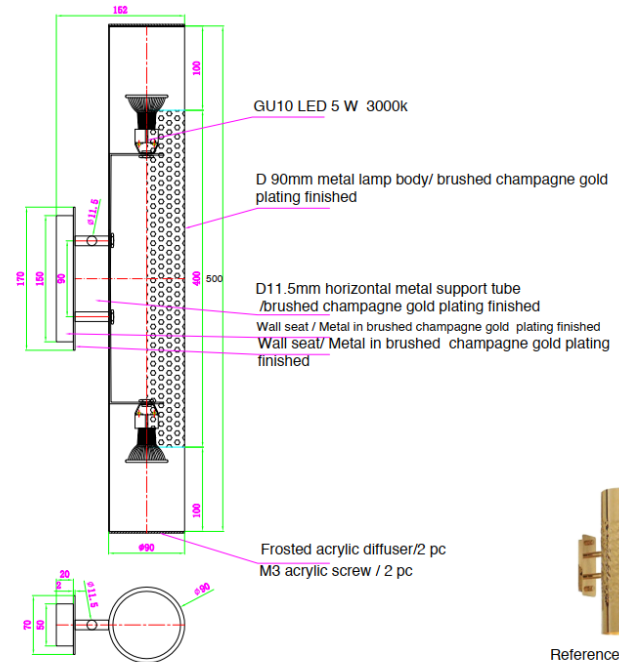

Reference Picture - Color  
Brushed Champagne Gold  
finished

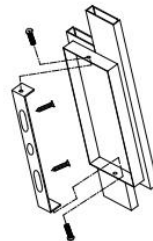
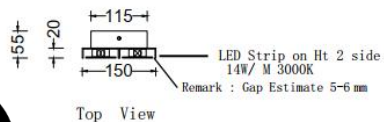

Lamp installation view

PAVILION EMBASSY – ALL UNITS

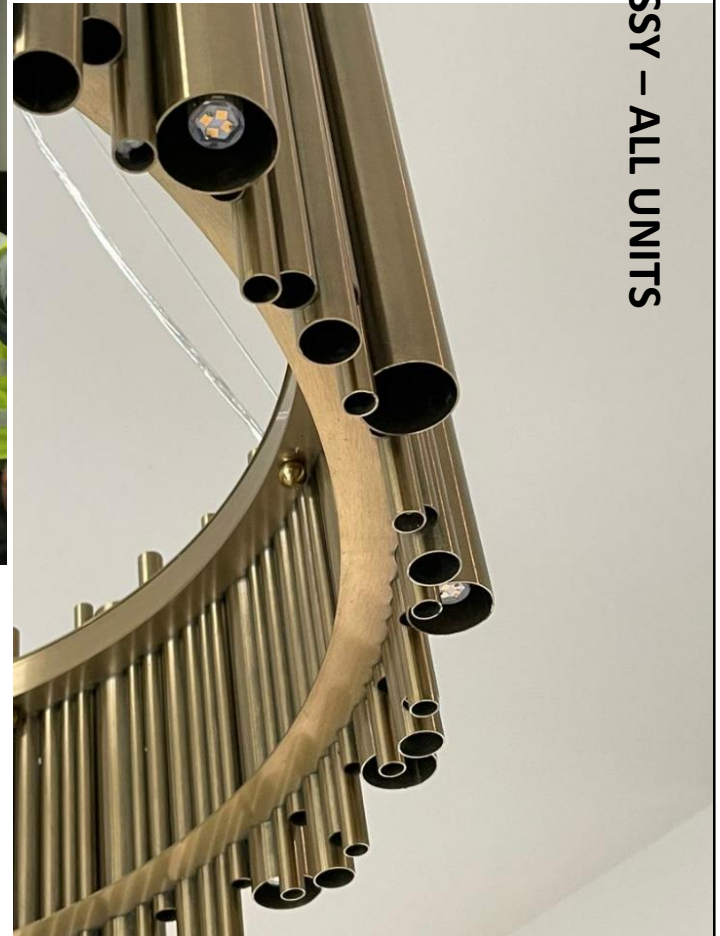



PAVILION EMBASSY – ALL UNITS

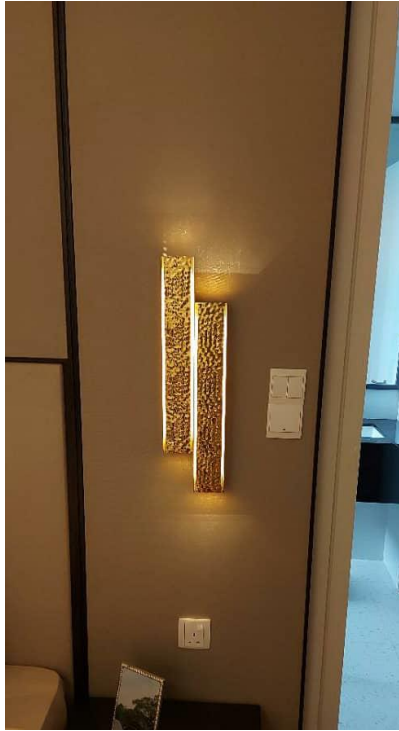

[www.stephaniengdesign.com](http://www.stephaniengdesign.com)

Stephanie Ng Design (002298802-V)  
83, Jalan Telawi, Bangsar Baru, 59100 Kuala Lumpur, Malaysia.  
Telephone : +603 2202 2028  
Email : [hello@stephaniengdesign.com](mailto:hello@stephaniengdesign.com)