



Installation Instructions Manual

Applicable models: CFT4.0D



一、 The installation of the handle

- 1 Unscrew the left and right side of the machine with a "hand screw" and remove the "handle"..

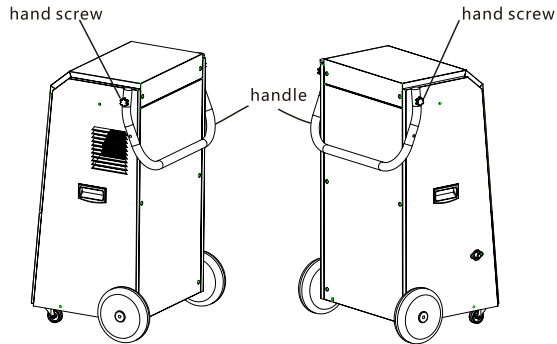

- 2 2 holes (ABCD) on the left and right sides of the "handle" are aligned with each of the 2 holes (ABCD) on both sides of the machine

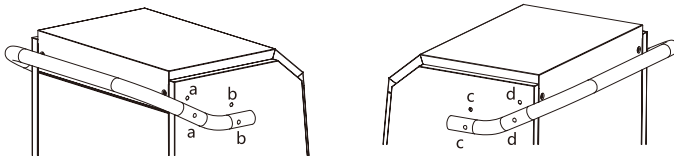

- 3 Tighten the "hand screw" on the ABCD hole and install the "handle" to complete.

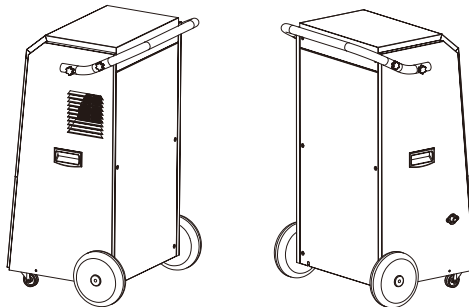

二、Filter screen disassembly and cleaning

- 1** Put your hands on the left and right sides of the "inlet plate" and remove the "inlet plate" in the direction of the arrow as shown.

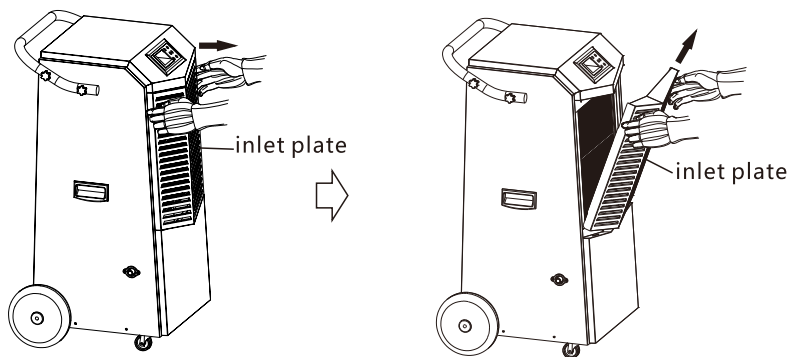

- 2** As shown in the figure, pull the filter handle with your hand up to about 30mm, then pull down the filter by diagonal.

