

**KYOWA SERVICE CENTER (MAIN)**

RM. 1203, STATE CENTER BLDG, #333 JUAN LUNA ST, BINONDO MANILA  
TEL: 242-1731 - 35

**METRO MANILA**

**TRONIX QUEZON CITY (MAIN)** #777 N.S. AMORANTO ST, COR. STO. DOMINGO AVE, Q.C.  
TEL: 743-9094 / 749-8477 MOBILE: 0922-8534797/0917-5231489 CONTACT PERSON: MS. JENIELYN MANZANO

**TRONIX MANILA** #1793 CONCEPCION AGUILA ST, NEAR J.P. LAUREL ST, SAN MIGUEL, MANILA (NEAR MALACAÑANG)  
TEL: 743-4088 MOBILE: 0922-7909555 CONTACT PERSON: MS. ANALEN FIADACAN

**TRONIX STA. CRUZ** #910 LUZON ST. (BET. MASANGKAY & BENAVIDEZ ST.) STA. CRUZ, MANILA  
TEL: 542-8345 / 310-3553 MOBILE: 0922-2389971 CONTACT PERSON: MS. SHEILA PIRANTE

**TRONIX SAN JUAN** #135 N.DOMINGO ST, CORNER PINAGLABANAN, BRGY. BALONG BATO, SAN JUAN CITY  
TEL: 949-3608 / 984-6395 MOBILE: 0922-9218653 CONTACT PERSON: MS. MICHELLE CASAÑA

**TRONIX ALABANG TOWN CENTER** LA-7 SERVICE TOWN, ALABANG TOWN CENTER, MUNTINLUPA CITY  
TEL: 807-3546 / 624-6880 MOBILE: 0922-7584917 / 0917-5899059 CONTACT PERSON: MR. FRANCIS ACOSTA

**TRONIX PARAÑAQUE** #103 CMSR BLDG, PHASE 1, 88 PRESIDENT AVENUE, BF HOME, PARAÑAQUE  
TEL: 622-4540 / 861-0092 / 828-2915 MOBILE: 0917-5978342 / 0932-4060806 CONTACT PERSON: MS. ELIZABETH PALIMA

**TRONIX MAKATI** #103 MJM BLDG, 650 JP RIZAL ST, BRGY. VALENZUELA MAKATI CITY  
TEL: 710-1980 / 949-3684 MOBILE: 0932-1999085

**TRONIX MARIKINA** #572 J.P. RIZAL AVE, CONCEPCION 1, MARIKINA (IN FRONT OF KSERVICO)  
TEL: 696-6411 MOBILE: 0942-0940088

**TRONIX PASIG** LOWER GROUND SERVICE LANE, SM CENTER, PASIG  
TEL: 703-5599 / 234-9020 MOBILE: 0932-1999372 CONTACT PERSON: MS. NORA CRESENCIO

**TRONIX SHAW - MANDALUYONG** #412 SHAW BLVD, COR. TORRES & CALDERON ST, MANDALUYONG CITY  
TEL: 542-8360 / 725-7290 MOBILE: 0923-1646350 CONTACT PERSON: MS. SHERLY DELA CRUZ

**TRONIX COMMONWEALTH** LAGMANLAG COMMONWEALTH AVE, HOLY SPIRIT, DILIMAN, Q.C. (BESIDE SHELL)  
TEL: 623-7266 MOBILE: 0933-6584465 / 09175810546 CONTACT PERSON: MR. MANNY SAGAYAP

**CAVITE**

**TRONIX CAVITE** KM 16, AGUINALDO HI-WAY, NIOG 1-A, PANAPAAN 1, BACOR, CAVITE  
TEL: (046) 519-0755 / (046) 475-6362 MOBILE: 0932-1991811 CONTACT PERSON: MS. MEANN DIONISIO

**CEBU**

**MARKWELL ENTERPRISES** #85 SIKATUNA ST, CEBU CITY  
TEL: (032) 253-0752 MOBILE: 0917-6256934 CONTACT PERSON: MR. BOY SOUICO

**BIO PLUS ELEC. REPAIR CENTER** C. PADILLA ST, SAN ROQUE, MAMBALING, CEBU CITY  
TEL: (032) 262-1339 MOBILE: 0922-4744991 CONTACT PERSON: MS. ZYSELDA MABUTE

**DAVAO**

**KOOL EXPRESS** DOOR 5, LUA BLDG, QUIRINO AVE, DAVAO CITY  
TEL: (082) 227-6369 MOBILE: 0908-420-6303 CONTACT PERSON: MS. DORIS ASIRIT

**ILOILO**

**NACES APPLIANCE CORPORATION** NACES BLDG, #10 DELGADO ST, ILOILO  
TEL: (033) 337-7696 MOBILE: (033) 508-2205 CONTACT PERSON: MS. LORELIE LIM

**TARLAC**

**TARLAC MAC ENTERPRISES INC.** BLK. 9, MCARTHUR HIGHWAY, SAN NICOLAS, TARLAC  
TEL: (045) 982-3178 MOBILE: 0922-8597136



# ORBIT FAN

**MODEL NO.: KW-6800**

Voltage: 230Va.c. 60Hz Power: 55 WATTS



# INSTRUCTION MANUAL

## CONGRATULATIONS

You are now a proud new owner of a KYOWA Orbit Fan model no. KW-6800.

Before using for the first time, kindly take time to carefully read your instruction manual. Please observe all safety precautions and follow operating procedures. After reading, kindly store your instruction manual in a safe place for your future reference. Should you pass on this Orbit Fan to a third party, please hand over this instruction manual as well.

## PARTS DESCRIPTION

1. MOUNTING BRACKET
2. LEAD WIRES
3. MOTOR ASSEMBLY
4. REAR GUARD
5. FAN BLADE
6. GUARD LOCK
7. FRONT GUARD
8. SIDE SCREW
9. LOCK NUT
10. SAFETY SCREW
11. EXTENDED METAL TAB

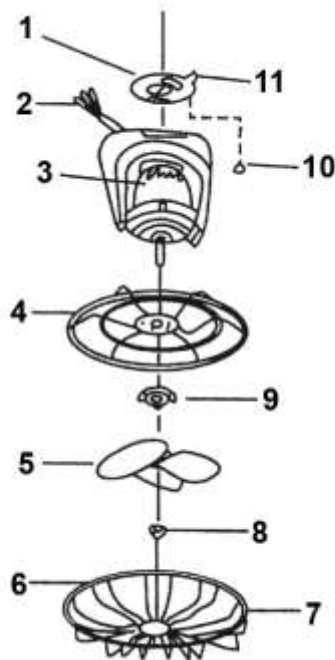

## IMPORTANT SAFEGUARDS

When using Kyowa Orbit Fan, basic safety precautions should always be followed:

- Always operate your KYOWA Orbit Fan from a power source of the same voltage and frequency rating as indicated on the rating label.
- Do not operate or place any part of your Orbit Fan on or near any hot surface such as a gas or electric burner, hotplate or heated oven.
- Do not operate or place fan in damp places or where humidity is high.
- Do not operate the Orbit Fan if any part of it including the supply cord has been damaged. Return the appliance to the nearest authorized dealer or service facility for repair.
- Do not use or replace accessories of the Orbit Fan, other than the ones originally provided.
- Switch OFF Orbit Fan when not in use or before cleaning.
- To reduce the risk of electric shock, do not immerse or expose the Orbit Fan to rain, moisture or any liquid.
- Keep out of reach from children or from persons with mental or physical disabilities.
- This appliance is not intended for use by persons (including children) with reduced physical, sensory or mental capabilities, lack of experience and knowledge, unless they have been given supervision or instruction concerning use of the appliance by a person responsible for their safety.
- Children should be supervised to ensure that they do not play with the appliance.
- This KYOWA Orbit Fan is intended for normal domestic/household use only. This model is not suitable for commercial use.

## HOW TO USE

### HOW TO ASSEMBLE

- Loosen the safety screw (10) from the motor assembly and turn the mounting bracket (1) clockwise to detach.
- Install mounting bracket into the ceiling. ( bulge portion facing up )
- Install electrical wiring in motor assembly for preparation of electrical connection between the motor and speed selector. (No wire provided upon purchase of this item. Recommended to use 0.75mm<sup>2</sup> sheathed type of cord)
- Fix motor assembly (3) by turning clockwise into the mounting bracket slot.
- Place screw on the extended metal tab (11) on the bracket and motor assembly to lock in place.
- Mount rear guard (4) into the motor by aligning rear guard holes into the round pins on the motor, then place the rear guard lock nut (9) into the shaft guard and turn it clockwise to lock in.
- Push fan blade (5) into the shaft then tighten the side screw (8) to lock in.
- Place the front guard (7) into the rear guard then lock it by the guard lock (6).
- Remove the speed selector cover by loosening the screw on the front cover
- Mount the speed selector to the wall
- Connect wire from motor assembly to speed selector
- Place back the speed selector cover
- Connect electrical wiring from speed selector to power source ( make sure that the speed selector is at off position)

#### Note:

- All electrical wiring and installation should be done by qualified electrician.
- Fans intended to be mounted at high level has to be installed so that the blades are more than 2.3 meters above the floor or windows.
- Provide the means for disconnection with contact separation at least 3 mm.

## CLEAN AND CARE

- Carefully wash movable parts of the Industrial Ground Fan with water and mild detergent.
- Avoid any kind of liquid to seep into the motor of the unit.
- Avoid using harsh or abrasive cleaning materials when cleaning.
- Wipe dry Industrial Ground Fan with a soft and dry cloth.
- Put back parts and accessories of the Industrial Ground Fan to their proper position before operating again.

## SERVICE

- Do not operate your KYOWA Orbit Fan if the unit malfunctions or appears damaged in any manner. Bring the complete product to the place of purchase or to any authorized KYOWA dealers for inspection, repair or replacement.
- Do not disassemble your KYOWA Orbit Fan by yourself. No user serviceable parts inside. Refer all needed repair to an authorized KYOWA service facility ONLY.