

KYOWA SERVICE CENTER (MAIN)

RM. 1203, STATE CENTER BLDG, #333 JUAN LUNA ST, BINONDO MANILA
TEL: 242-1731 - 35

METRO MANILA

TRONIX QUEZON CITY (MAIN) #777 N.S. AMORANTO ST, COR. STO. DOMINGO AVE, Q.C.
TEL: 743-9094 / 749-8477 MOBILE: 0922-8534797/0917-5231489 CONTACT PERSON: MS. JENIELYN MANZANO

TRONIX MANILA #1793 CONCEPCION AGUILA ST, NEAR J.P. LAUREL ST, SAN MIGUEL, MANILA (NEAR MALACAÑANG)
TEL: 743-4088 MOBILE: 0922-7909555 CONTACT PERSON: MS. ANALEN FIADACAN

TRONIX STA. CRUZ #910 LUZON ST. (BET. MASANGKAY & BENAVIDEZ ST.) STA. CRUZ, MANILA
TEL: 542-8345 / 310-3553 MOBILE: 0922-2389971 CONTACT PERSON: MS. SHEILA PIRANTE

TRONIX SAN JUAN #135 N.DOMINGO ST, CORNER PINAGLABANAN, BRGY. BALONG BATO, SAN JUAN CITY
TEL: 949-3608 / 984-6395 MOBILE: 0922-9218653 CONTACT PERSON: MS. MICHELLE CASAÑA

TRONIX ALABANG TOWN CENTER LA-7 SERVICE TOWN, ALABANG TOWN CENTER, MUNTINLUPA CITY
TEL: 807-3546 / 624-6880 MOBILE: 0922-7584917 / 0917-5899059 CONTACT PERSON: MR. FRANCIS ACOSTA

TRONIX PARAÑAQUE #103 CMSR BLDG, PHASE 1, 88 PRESIDENT AVENUE, BF HOME, PARAÑAQUE
TEL: 622-4540 / 861-0092 / 828-2915 MOBILE: 0917-5978342 / 0932-4060806 CONTACT PERSON: MS. ELIZABETH PALIMA

TRONIX MAKATI #103 MJM BLDG, 650 JP RIZAL ST, BRGY. VALENZUELA MAKATI CITY
TEL: 710-1980 / 949-3684 MOBILE: 0932-1999085

TRONIX MARIKINA #572 J.P. RIZAL AVE, CONCEPCION 1, MARIKINA (IN FRONT OF KSERVICO)
TEL: 696-6411 MOBILE: 0942-0940088

TRONIX PASIG LOWER GROUND SERVICE LANE, SM CENTER, PASIG
TEL: 703-5599 / 234-9020 MOBILE: 0932-1999372 CONTACT PERSON: MS. NORA CRESENCIO

TRONIX SHAW - MANDALUYONG #412 SHAW BLVD, COR. TORRES & CALDERON ST, MANDALUYONG CITY
TEL: 542-8360 / 725-7290 MOBILE: 0923-1646350 CONTACT PERSON: MS. SHERLY DELA CRUZ

TRONIX COMMONWEALTH LAGMANLAG COMMONWEALTH AVE, HOLY SPIRIT, DILIMAN, Q.C. (BESIDE SHELL)
TEL: 623-7266 MOBILE: 0933-6584465 / 09175810546 CONTACT PERSON: MR. MANNY SAGAYAP

CAVITE

TRONIX CAVITE KM 16, AGUINALDO HI-WAY, NIOG 1-A, PANAPAAN 1, BACOR, CAVITE
TEL: (046) 519-0755 / (046) 475-6362 MOBILE: 0932-1991811 CONTACT PERSON: MS. MEANN DIONISIO

CEBU

MARKWELL ENTERPRISES #85 SIKATUNA ST, CEBU CITY
TEL: (032) 253-0752 MOBILE: 0917-6256934 CONTACT PERSON: MR. BOY SOUICO

BIO PLUS ELEC. REPAIR CENTER C. PADILLA ST, SAN ROQUE, MAMBALING, CEBU CITY
TEL: (032) 262-1339 MOBILE: 0922-4744991 CONTACT PERSON: MS. ZYSELDA MABUTE

DAVAO

KOOL EXPRESS DOOR 5, LUA BLDG, QUIRINO AVE, DAVAO CITY
TEL: (082) 227-6369 MOBILE: 0908-420-6303 CONTACT PERSON: MS. DORIS ASIRIT

ILOILO

NACES APPLIANCE CORPORATION NACES BLDG, #10 DELGADO ST, ILOILO
TEL: (033) 337-7696 MOBILE: (033) 508-2205 CONTACT PERSON: MS. LORELIE LIM

TARLAC

TARLAC MAC ENTERPRISES INC. BLK. 9, MCARTHUR HIGHWAY, SAN NICOLAS, TARLAC
TEL: (045) 982-3178 MOBILE: 0922-8597136



BLENDER

MODEL NO.: KW-4726

Voltage: 230Va.c. 60Hz Power: 350 WATTS



INSTRUCTION MANUAL

CONGRATULATIONS

You are now a proud new owner of a KYOWA Blender model no. KW-4726.

Before using for the first time, kindly take time to carefully read your instruction manual. Please observe all safety precautions and follow operating procedures. After reading, kindly store your instruction manual in a safe place for your future reference. Should you pass on this Blender to a third party, please hand over this instruction manual as well.

PARTS DESCRIPTION

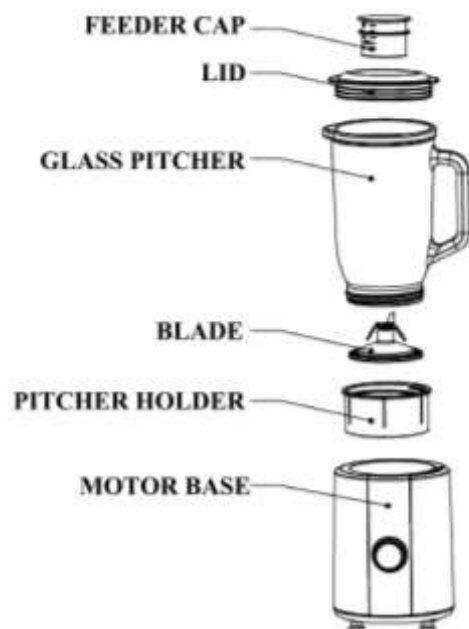

IMPORTANT SAFEGUARDS

When using your Blender, basic safety precautions should always be followed:

- Always operate your KYOWA Blender from a power source of the same voltage and frequency rating as indicated on the rating label.
- Do not place the unit on uneven surfaces. Place Blender upon a flat area surface and far from the edge of counter top.
- Do not use Blender in damp or wet area. Keep dry the exterior and the base of the Blender.
- Do not operate the Blender if any part of it including its power supply cord has been damaged. Return the appliance to the nearest authorized dealer or service facility for repair.
- Do not operate or place any part of your KYOWA Blender on or near any hot surface such as a gas or electric burner, hotplate or heated oven.
- Do not use or replace accessories other than the ones originally provided.
- Always ensure that the Blender pitcher is firmly attached to the motor base before operating.
- Always put in Blender pitcher cover before turning ON the unit.
- Foods to be processed in the Blender should not be larger than 1 inch.
- Always ensure that the cover is tightly closed while the Blender is in operation.
- While operating, hold to support Blender pitcher cover to avoid any untoward incidents.
- Always choose the lowest setting first when using the Blender. Set higher speed level if you notice that Blender is taking much time processing food.
- Remove feeder cap from the Blender pitcher cover when processing hot liquids.
- Use a rubber spatula to push or mix foods to be processed inside the Blender. Make sure that the unit is turned OFF when mixing foods inside the pitcher.
- Do not overload Blender by putting too much food on the pitcher exceeding the highest line indicated on the Blender pitcher.
- Never leave the Blender unattended when in use.
- Wait until the Blender has completely stopped processing before removing pitcher from the base.
- Switch OFF and unplug the Blender outlet before emptying, when not in use or before cleaning.
- Hold plug when unplugging from socket. Do not unplug by pulling the supply cord.
- To reduce the risk of electric shock, do not immerse or expose the Blender to rain, moisture or any liquid.
- This appliance is not intended for use by persons (including children) with reduced physical, sensory or mental capabilities, lack of experience and knowledge, unless they have been given supervision or instruction concerning use of the appliance by a person responsible for their safety.
- Children should be supervised to ensure that they do not play with the appliance.
- This KYOWA Blender is intended for normal domestic/household use only. This unit is not suitable for commercial use.

HOW TO USE

- Remove all packaging materials from the Blender. Completely untangle or unwind the power cable of the unit.
- Please make sure that the rubber sealing ring of the glass jar and lid gasket of the jar cover are both properly installed to prevent any leakage during operation.
- Wash food to be processed in the blender then cut into small pieces not larger than 1 inch.
- Put sliced fruits or vegetables inside the Glass Pitcher then secure with the Lid.
- Place Glass Pitcher on the Motor Base, make sure that the interlocking switch on the pitcher holder is well aligned on the motor base.
- Place Feeder cap on top of the Lid.
- Rest hand on the pitcher lid to support the unit while in operation.
- Select the required speed for the food that you are processing by rotating Rotary Switch clockwise from I to II. Rotate knob counter clockwise and hold to Pulse switch for controlled cycle operation.
- Allow blender to run for about 1 minute then turn OFF. Allow unit to rest for about 1 minute then repeat process until the food that you are processing is already well blended.
- To add ingredients while blending, remove refilling cup and gradually add ingredients into the small opening on the lid.
- Rotate knob to 0 or release Pulse switch when you are done using the blender to turn the unit OFF.

CLEAN AND CARE

- After every use, wash movable parts of the blender with warm, soapy water. You may also use the dishwasher to clean the pitcher, lid and refill cup of the Blender unit.
- The blender pitcher may be washed by putting water and a few drops of liquid detergent on it. Place blender pitcher in the motor base then allow to operate for about 10 seconds. Discard liquid then rinse blender pitcher thoroughly.
- Never immerse blender motor in water. Clean motor housing by wiping with a soft and damp cloth.
- Never use abrasive cleaning agents or any metallic and sharp objects (e.g. scrubbing brush or knife) for cleaning.
- Wipe dry all parts of the blender using a soft and dry cloth.
- Store blender in a cool and dry place.
- Put back parts and accessories of the blender to their proper places before operating again.

SERVICE

- Do not operate your KYOWA Blender if the unit malfunctions or appears damaged in any manner. Bring the complete product to the place of purchase or to any authorized KYOWA dealers for inspection, repair or replacement.
- Do not disassemble your KYOWA Blender by yourself. No user serviceable parts inside. Refer all needed repair to an authorized KYOWA service facility ONLY.