

## **KYOWA SERVICE CENTER**

Rm. 1203 State Center Building  
#333 Juan Luna St., Binondo  
Manila, Philippines



## **BLENDER**

**MODEL NO.: KW-4714**

Voltage: 230V a.c. 60Hz Power: 350 WATTS



**INSTRUCTION MANUAL**

## CONGRATULATIONS

You are now a proud new owner of a KYOWA Blender model no. KW-4714.

Before using for the first time, kindly take time to carefully read your instruction manual. Please observe all safety precautions and follow operating procedures. After reading, kindly store your instruction manual in a safe place for your future reference. Should you pass on this Blender to a third party, please hand over this instruction manual as well.

## PARTS DESCRIPTION

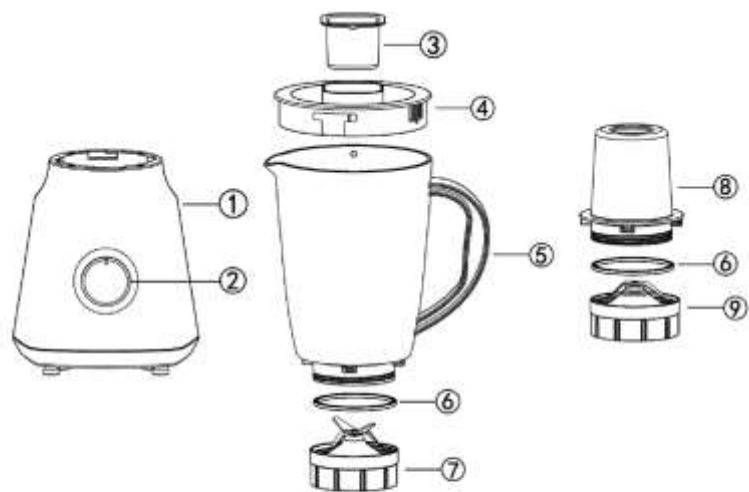

- |                         |                            |
|-------------------------|----------------------------|
| 1. MOTOR BASE           | 6. RUBBER SEALING RING     |
| 2. ROTARY SPEED CONTROL | 7. BLENDER BLADE ASSEMBLY  |
| 3. REFILL CAP           | 8. DRY MILL CUP            |
| 4. PITCHER COVER        | 9. DRY MILL BLADE ASSEMBLY |
| 5. PITCHER              |                            |

## IMPORTANT SAFEGUARDS

When using the Blender, basic safety precautions should always be followed:

- Always operate your KYOWA Blender from a power source of the same voltage and frequency rating as indicated on the rating label.
- Do not place the unit on uneven surfaces. Place upon a flat area surface and far from the edge of counter top.
- Do not use Blender in damp or wet area. Keep dry the exterior and the base of the Blender.
- Do not operate the Blender if any part of it has been damaged. Return the appliance to the nearest authorized dealer or service facility for repair.
- Do not operate or place any part of your KYOWA Blender on or near any hot surface such as a gas or electric burner, hotplate or heated oven.
- Do not use or replace accessories other than the ones originally provided.
- Always ensure that the Blender container is firmly attached to the base before operating.
- Always put in Blender container cover before turning ON the unit.
- Foods to be processed in the Blender should not be larger than 1 inch.
- Always ensure that the cover is tightly closed while the Blender is in operation.
- While operating, hold to support Blender container cover to avoid any untoward incidents.
- Always choose the lowest setting first when using the Blender. Higher speed level if you notice that Blender is taking much time processing food.
- Use a rubber spatula to push or mix foods to be processed inside the Blender. Make sure that the unit is turned OFF when mixing foods inside the container.
- Do not overload Blender by putting too much food on the container exceeding the MAX line indicated on the Blender container.
- Never leave the Blender unattended when in use.
- Wait until the Blender has completely stopped processing before removing pitcher / dry mill from the base.
- Switch OFF and unplug the Blender outlet before emptying, when not in use or before cleaning.
- Hold plug when unplugging from socket. Do not unplug by pulling the supply cord.
- To reduce the risk of electric shock, do not immerse or expose the Blender to rain, moisture or any liquid.

- Keep out of reach from children or from persons with mental or physical disabilities.
- This KYOWA Blender is intended for normal domestic/household use only. This unit is not suitable for commercial use.

## HOW TO USE

### BLENDER

- Place Blender Pitcher on the Blender Motor Base.
- Turn Blender Pitcher clockwise on the Motor Base until it is locked in place.
- Wash food to be processed in the Blender then cut into small pieces not larger than 1 inch.
- For making shakes and juices, put sliced fruits and vegetables into the Blender Container then add cold water. Add in crushed ice if desired.
- When making sauces and salsas, cut ingredients in small pieces then put inside the glass container.
- Secure Blender Pitcher with the Lid.
- Rest one hand on the container cover to support the unit while in operation.
- Turn rotary speed control to speed 1 or 2 required speed for the food that you are processing or turn to pulse for controlled cycle operation.
- Allow Blender to run for about 30 seconds then turn OFF. Repeat process until the food that you are processing is already well blended.
- Switch unit to 0 or release Pulse switch when you are done using the Blender.

### DRY MILL

- Put ingredients to be processed in the dry mill cup.
- Attach dry mill blade assembly into the cup then turn clockwise until it is locked in place.
- Place dry mill assembly on the motor base.
- Select required speed for the food you are going to process.
- Allow dry mill to process for about 10 seconds then turn OFF. Allow to rest for a couple of seconds then turn ON again.
- Repeat process until food is well milled.

## CLEAN AND CARE

- After every use, wash movable parts of the Blender and Dry Mill with warm, soapy water.
- The Blender container may be washed by putting water and a few drops of liquid detergent in it. Place Blender Pitcher in the motor base then allow to operate for about 10 seconds. Discard liquid then rinse Blender container thoroughly.
- Never immerse Blender motor in water. Clean the motor housing by wiping with a soft and damp cloth.
- Never use abrasive cleaning agents or any metallic and sharp objects (e.g. scrubbing brush or knife) for cleaning.
- Wipe dry all parts of the Blender using a soft and dry cloth.
- Put back parts and accessories of the Blender to their proper places before operating again.
- Store Blender in a cool, dry place after cleaning.

## SERVICE

- Do not operate your KYOWA Blender if the unit malfunctions or appears damaged in any manner. Bring the complete product to the place of purchase or to any authorized KYOWA dealers for inspection, repair or replacement.
- Do not disassemble your KYOWA Blender by yourself. No user serviceable parts inside. Refer all needed repair to an authorized KYOWA service facility ONLY.