

### **KYOWA SERVICE CENTER (MAIN)**

RM. 1203, STATE CENTER BLDG, #333 JUAN LUNA ST, BINONDO MANILA  
TEL: 242-1731 - 35

#### **METRO MANILA**

**TRONIX QUEZON CITY (MAIN)** #777 N.S. AMORANTO ST, COR. STO. DOMINGO AVE, Q.C.  
TEL: 743-9094 / 749-8477 MOBILE: 0922-8534797/0917-5231489 CONTACT PERSON: MS. JENIELYN MANZANO

**TRONIX MANILA** #1793 CONCEPCION AGUILA ST, NEAR J.P. LAUREL ST, SAN MIGUEL, MANILA (NEAR MALACANANG)  
TEL: 743-4088 MOBILE: 0922-7909555 CONTACT PERSON: MS. ANALEN FIADACAN

**TRONIX STA. CRUZ** #910 LUZON ST. (BET. MASANGKAY & BENAVIDEZ ST.) STA. CRUZ, MANILA  
TEL: 542-8345 / 310-3553 MOBILE: 0922-2389971 CONTACT PERSON: MS. SHEILA PIRANTE

**TRONIX SAN JUAN** #135 N.DOMINGO ST, CORNER PINAGLABANAN, BRGY. BALONG BATO, SAN JUAN CITY  
TEL: 949-3608 / 984-6395 MOBILE: 0922-9218653 CONTACT PERSON: MS. MICHELLE CASAÑA

**TRONIX ALABANG TOWN CENTER** LA-7 SERVICE TOWN, ALABANG TOWN CENTER, MUNTINLUPA CITY  
TEL: 807-3546 / 624-6880 MOBILE: 0922-7584917 / 0917-5899059 CONTACT PERSON: MR. FRANCIS ACOSTA

**TRONIX PARAÑAQUE** #103 CMSR BLDG, PHASE 1, 88 PRESIDENT AVENUE, BF HOME, PARAÑAQUE  
TEL: 622-4540 / 861-0092 / 828-2915 MOBILE: 0917-5978342 / 0932-4060806 CONTACT PERSON: MS. ELIZABETH PALIMA

**TRONIX MAKATI** #103 MJM BLDG, 650 JP RIZAL ST, BRGY. VALENZUELA MAKATI CITY  
TEL: 710-1980 / 949-3684 MOBILE: 0932-1999085

**TRONIX MARIKINA** #572 J.P. RIZAL AVE, CONCEPCION 1, MARIKINA (IN FRONT OF KSERVICO)  
TEL: 696-6411 MOBILE: 0942-0940088

**TRONIX PASIG** LOWER GROUND SERVICE LANE, SM CENTER, PASIG  
TEL: 703-5599 / 234-9020 MOBILE: 0932-1999372 CONTACT PERSON: MS. NORA CRESENCIO

**TRONIX SHAW - MANDALUYONG** #412 SHAW BLVD, COR. TORRES & CALDERON ST, MANDALUYONG CITY  
TEL: 542-8360 / 725-7290 MOBILE: 0923-1646350 CONTACT PERSON: MS. SHERLY DELA CRUZ

**TRONIX COMMONWEALTH** LAGMANLAG COMMONWEALTH AVE, HOLY SPIRIT, DILIMAN, Q.C. (BESIDE SHELL)  
TEL: 623-7266 MOBILE: 0933-6584465 / 09175810546 CONTACT PERSON: MR. MANNY SAGAYAP

#### **CAVITE**

**TRONIX CAVITE** KM 16, AGUINALDO HI-WAY, NIOG 1-A, PANAPAAN 1, BACOR, CAVITE  
TEL: (046) 519-0755 / (046) 475-6362 MOBILE: 0932-1991811 CONTACT PERSON: MS. MEANN DIONISIO

#### **CEBU**

**MARKWELL ENTERPRISES** #85 SIKATUNA ST, CEBU CITY  
TEL: (032) 253-0752 MOBILE: 0917-6256934 CONTACT PERSON: MR. BOY SOUICO

**BIO PLUS ELEC. REPAIR CENTER** C. PADILLA ST, SAN ROQUE, MAMBALING, CEBU CITY  
TEL: (032) 262-1339 MOBILE: 0922-4744991 CONTACT PERSON: MS. ZYSELDA MABUTE

#### **DAVAO**

**KOOL EXPRESS** DOOR 5, LUA BLDG, QUIRINO AVE, DAVAO CITY  
TEL: (082) 227-6369 MOBILE: 0908-420-6303 CONTACT PERSON: MS. DORIS ASIRIT

#### **ILOILO**

**NACES APPLIANCE CORPORATION** NACES BLDG, #10 DELGADO ST, ILOILO  
TEL: (033) 337-7696 MOBILE: (033) 508-2205 CONTACT PERSON: MS. LORELIE LIM

#### **TARLAC**

**TARLAC MAC ENTERPRISES INC.** BLK. 9, MCARTHUR HIGHWAY, SAN NICOLAS, TARLAC  
TEL: (045) 982-3178 MOBILE: 0922-8597136



## **JUICER BLENDER**

**MODEL NO.: KW-4220**

Voltage: 230V a.c. 60Hz Power: 700 WATTS



## **INSTRUCTION MANUAL**

# CONGRATULATIONS

You are now a proud new owner of a KYOWA Juicer Blender model no. KW-4220.

Before using for the first time, kindly take time to carefully read your instruction manual. Please observe all safety precautions and follow operating procedures. After reading, kindly store your instruction manual in a safe place for your future reference. Should you pass on this Juicer Blender to a third party, please hand over this instruction manual as well.

## PARTS DESCRIPTION

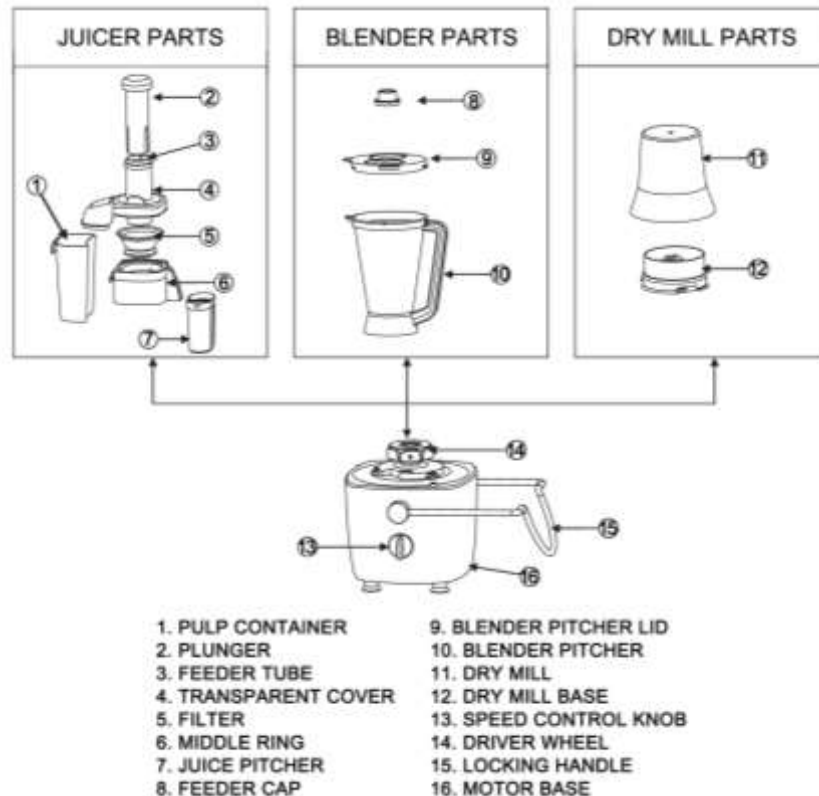

## IMPORTANT SAFEGUARDS

When using the Juicer Blender, basic safety precautions should always be followed:

- Always operate your KYOWA Juicer Blender from a power source of the same voltage and frequency rating as indicated on the rating label.
- Do not place unit on uneven surfaces. Place upon a flat area surface and far from the edge of the counter top.
- Do not operate the Juicer Blender if any part has been damaged. Return the unit to the nearest authorized dealer or service facility for repair.
- Do not operate or place any part of your KYOWA Juicer Blender on or near any hot surface such as gas / electric burner or heated oven.
- When using the juicer, always make sure that the juicer locking handle is clamped securely in place before the motor is turned ON. Do not fasten or unfasten locking handle while the juicer is in operation.
- Place fruit and vegetable into the juicer feeder tube one at a time. Do not overload tube or use excessive force to press food.
- Never use your finger or any other objects to push the fruit or vegetable into the juicer feeder tube. Use plunger or another piece of fruit or vegetable to push it down.
- If the fruit got stuck in the transparent cover of the juicer while the motor is operating, turn OFF juicer and unplug from the outlet. Disassemble juicer to remove fruit.
- When using the blender or the dry mill, always ensure that the blender pitcher or the dry mill is firmly attached to the motor base before operating.
- Always ensure that the blender pitcher lid or the dry mill is tightly closed while the unit is in operation.
- Always choose the lowest setting first when using the blender or the dry mill. Set higher speed level if you notice that motor is taking much time processing food.
- Use a rubber spatula to push or mix foods to be processed inside the blender. Make sure that the unit is turned OFF when mixing foods inside the container.
- Do not overload blender by putting too much food on the container exceeding the MAX line indicated on the Blender container.
- Do not use accessories or any other objects in the Juicer Blender other the ones originally provided.
- Never leave the Juicer Blender unattended when in use.
- Switch OFF and unplug the Juicer Blender from outlet when not in use or before cleaning.
- Hold plug when unplugging from socket. Do not unplug by pulling the supply cord.

- To reduce the risk of electric shock, do not immerse or expose the Juicer Blender to rain, moisture or any liquid.
- Keep out of reach from children or from persons with mental or physical disabilities.
- This KYOWA Juicer Blender is intended for normal domestic/household use only. This unit is not suitable for commercial use.

## HOW TO USE

### JUICER ASSEMBLAGE & USAGE INSTRUCTIONS

1. Place middle ring on the motor base. (FIG. 1)
2. Place filter over the driver wheel until it locks in place. (FIG. 2)
3. Place transparent cover over the middle ring aligning the pole on the middle ring into the hole on the cover. (FIG. 3)



FIGURE 1



FIGURE 2



FIGURE 3

4. Lock juicer by pulling locking handle counter-clockwise from 3 o'clock position to 12 o'clock position. Make sure locking handle is locked in place; otherwise, the unit will not operate. (FIG. 4)
5. Place pulp container under the pulp spout. (FIG. 5)
6. Place juice pitcher under the juice spout. (FIG. 6)



FIGURE 4



FIGURE 5

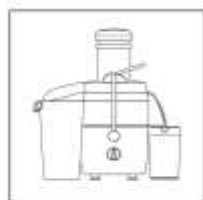

FIGURE 6

7. Wash fruits or vegetables to be processed in the Juicer Blender; chop into pieces fitting into feeder tube.
8. Plug in Juicer Blender into the power supply.
9. Insert fruits and vegetables into the feeding tube, gently push using the plunger.

10. Turn speed control knob clockwise to I or II depending on the hardness of the fruit or vegetable you are processing. Rotate speed control knob counter-clockwise for pulse or controlled-cycle operation.
11. Vitamins disappear quickly from fruits and vegetables when processed so it is recommended to consume the juice as soon as possible.
12. When extracting juice from apples, add a few drops of lemon into the processed juice to keep it from turning brown too quickly.
13. Vegetable and fruit pulps after juice extraction can still be used as a base for soups, sauces, jams and desserts.
14. Rotate speed control knob to 0 or release pulse switch to turn the unit to OFF.

### BLENDER ASSEMBLAGE & USAGE INSTRUCTIONS

1. Wash food to be processed into the blender.
2. Cut food into pieces not larger than 1 inch.
3. Put prepared food into the blender pitcher then cover with the blender pitcher lid. Make sure the food to be processed inside the blender must not exceed the MAX marking on the pitcher (FIG. 1)
4. Put blender pitcher into the motor base then rotate clockwise until the pitcher locks in place. (FIG. 2)



FIGURE 1



FIGURE 2

5. Turn speed control knob clockwise to I or II depending on the hardness of the fruit or vegetable you are processing. Rotate speed control knob counter-clockwise for pulse or controlled-cycle operation. (FIG. 3)
6. Rotate speed control knob to 0 or release pulse switch to turn the unit to OFF. (FIG. 4)



FIGURE 3



FIGURE 4

## DRY MILL ASSEMBLAGE & USAGE INSTRUCTIONS

1. Turn dry mill upside down. Rotate dry mill base counter-clockwise to open. (FIG. 1)
2. Put dry ingredients into the mill cup not exceeding the MAX marking on the cup. (FIG. 2)



FIGURE 1



FIGURE 2

3. Put base on the dry mill cup, rotate clockwise to close dry mill. (FIG. 3)
4. Place dry mill on the motor unit; rotate dry mill until it locks in place. (FIG. 4)
5. Turn speed control knob clockwise to I or II depending on the hardness of the fruit or vegetable you are processing. Rotate speed control knob counter-clockwise for pulse or controlled-cycle operation. (FIG. 3)
6. Rotate speed control knob to 0 or release pulse switch to turn the unit to OFF. (FIG. 4)



FIGURE 3



FIGURE 4



FIGURE 5

## CLEAN AND CARE

### JUICER

1. Wash movable parts of the Juicer Blender including the middle ring, filter, transparent cover, plunger, pulp container, and juice pitcher. (FIG. 1)
2. Clean motor unit with a soft and damp cloth. Never allow any kind of liquid to seep into the motor. (FIG. 2)



FIGURE 1



FIGURE 2

### BLENDER

1. After every use, wash movable parts of the blender including the pitcher, lid, and feeder cap with warm and mild dishwashing liquid.
2. For easier cleaning of the blender pitcher especially for the foods stuck on the blender blade, half fill pitcher with warm water with a few drops of liquid detergent. Turn unit to speed level II for about 5 seconds. Repeat cycle 3 times. (FIG. 1)
3. Remove blender pitcher from the motor base. Discard water then rinse blender pitcher thoroughly. (FIG. 2)



FIGURE 1



FIGURE 2

### DRY MILL

1. Wipe dry mill cup and base with a soft and damp cloth.



FIGURE 1

## SERVICE

- Do not operate your KYOWA Juicer Blender if the unit malfunctions or appears damaged in any manner. Bring the complete product to the place of purchase or to any authorized KYOWA dealers for inspection, repair or replacement.
- Do not disassemble your KYOWA Juicer Blender by yourself. No user serviceable parts inside. Refer all needed repair to an authorized KYOWA service facility ONLY.