

KYOWA SERVICE CENTER (MAIN)

RM. 1203, STATE CENTER BLDG, #333 JUAN LUNA ST, BINONDO MANILA
TEL: 242-1731 - 35

METRO MANILA

TRONIX QUEZON CITY (MAIN) #777 N.S. AMORANTO ST, COR. STO. DOMINGO AVE, Q.C.
TEL: 743-9094 / 749-8477 MOBILE: 0922-8534797/0917-5231489 CONTACT PERSON: MS. JENIELYN MANZANO

TRONIX MANILA #1793 CONCEPCION AGUILA ST, NEAR J.P. LAUREL ST, SAN MIGUEL, MANILA (NEAR MALACANANG)
TEL: 743-4088 MOBILE: 0922-7909555 CONTACT PERSON: MS. ANALEN FIADACAN

TRONIX STA. CRUZ #910 LUZON ST. (BET. MASANGKAY & BENAVIDEZ ST.) STA. CRUZ, MANILA
TEL: 542-8345 / 310-3553 MOBILE: 0922-2389971 CONTACT PERSON: MS. SHEILA PIRANTE

TRONIX SAN JUAN #135 N.DOMINGO ST, CORNER PINAGLABANAN, BRGY. BALONG BATO, SAN JUAN CITY
TEL: 949-3608 / 984-6395 MOBILE: 0922-9218653 CONTACT PERSON: MS. MICHELLE CASAÑA

TRONIX ALABANG TOWN CENTER LA-7 SERVICE TOWN, ALABANG TOWN CENTER, MUNTINLUPA CITY
TEL: 807-3546 / 624-6880 MOBILE: 0922-7584917 / 0917-5899059 CONTACT PERSON: MR. FRANCIS ACOSTA

TRONIX PARAÑAQUE #103 CMSR BLDG, PHASE 1, 88 PRESIDENT AVENUE, BF HOME, PARAÑAQUE
TEL: 622-4540 / 861-0092 / 828-2915 MOBILE: 0917-5978342 / 0932-4060806 CONTACT PERSON: MS. ELIZABETH PALIMA

TRONIX MAKATI #103 MJM BLDG, 650 JP RIZAL ST, BRGY. VALENZUELA MAKATI CITY
TEL: 710-1980 / 949-3684 MOBILE: 0932-1999085

TRONIX MARIKINA #572 J.P. RIZAL AVE, CONCEPCION 1, MARIKINA (IN FRONT OF KSERVICO)
TEL: 696-6411 MOBILE: 0942-0940088

TRONIX PASIG LOWER GROUND SERVICE LANE, SM CENTER, PASIG
TEL: 703-5599 / 234-9020 MOBILE: 0932-1999372 CONTACT PERSON: MS. NORA CRESENCIO

TRONIX SHAW - MANDALUYONG #412 SHAW BLVD, COR. TORRES & CALDERON ST, MANDALUYONG CITY
TEL: 542-8360 / 725-7290 MOBILE: 0923-1646350 CONTACT PERSON: MS. SHERLY DELA CRUZ

TRONIX COMMONWEALTH LAGMANLAG COMMONWEALTH AVE, HOLY SPIRIT, DILIMAN, Q.C. (BESIDE SHELL)
TEL: 623-7266 MOBILE: 0933-6584465 / 09175810546 CONTACT PERSON: MR. MANNY SAGAYAP

CAVITE

TRONIX CAVITE KM 16, AGUINALDO HI-WAY, NIOG 1-A, PANAPAAN 1, BACOR, CAVITE
TEL: (046) 519-0755 / (046) 475-6362 MOBILE: 0932-1991811 CONTACT PERSON: MS. MEANN DIONISIO

CEBU

MARKWELL ENTERPRISES #85 SIKATUNA ST, CEBU CITY
TEL: (032) 253-0752 MOBILE: 0917-6256934 CONTACT PERSON: MR. BOY SOUICO

BIO PLUS ELEC. REPAIR CENTER C. PADILLA ST, SAN ROQUE, MAMBALING, CEBU CITY
TEL: (032) 262-1339 MOBILE: 0922-4744991 CONTACT PERSON: MS. ZYSELDA MABUTE

DAVAO

KOOL EXPRESS DOOR 5, LUA BLDG, QUIRINO AVE, DAVAO CITY
TEL: (082) 227-6369 MOBILE: 0908-420-6303 CONTACT PERSON: MS. DORIS ASIRIT

ILOILO

NACES APPLIANCE CORPORATION NACES BLDG, #10 DELGADO ST, ILOILO
TEL: (033) 337-7696 MOBILE: (033) 508-2205 CONTACT PERSON: MS. LORELIE LIM

TARLAC

TARLAC MAC ENTERPRISES INC. BLK. 9, MCARTHUR HIGHWAY, SAN NICOLAS, TARLAC
TEL: (045) 982-3178 MOBILE: 0922-8597136



COFFEE MAKER

MODEL # KW-1205

Voltage: 230Va.c. 60Hz Power: 800 WATTS



INSTRUCTION MANUAL

CONGRATULATIONS

You are now a proud new owner of a KYOWA Coffee Maker model no. KW-1205.

Before using for the first time, kindly take time to carefully read your instruction manual. Please observe all safety precautions and follow operating procedures. After reading, kindly store your instruction manual in a safe place for your future reference. If you pass this Coffee Maker to a third party, this instruction manual must also be handed over.

PARTS DESCRIPTION

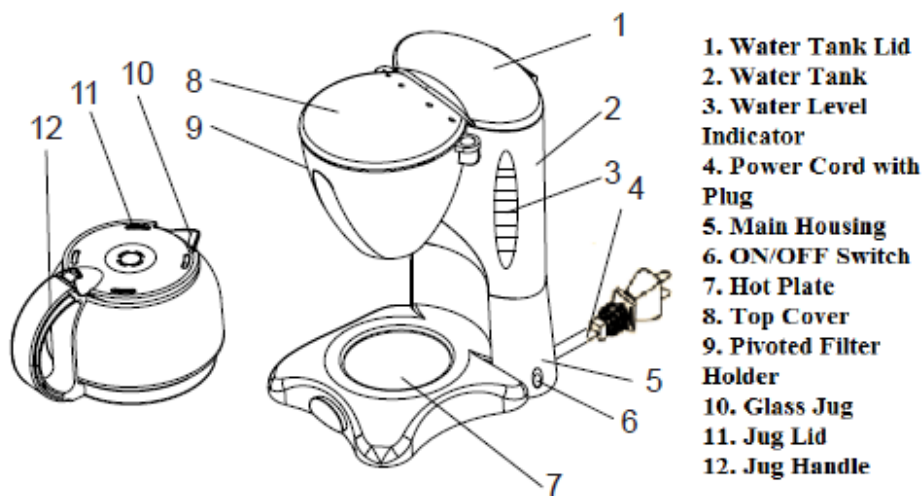

IMPORTANT SAFEGUARDS

- Always operate your KYOWA Coffee Maker from a power source of the same voltage and frequency rating as indicated on the rating label.
- Place the Coffee Maker on a flat surface and far from the edge of counter top.
- Do not operate the Coffee Maker if any part of it has been damaged. Return the appliance to the nearest authorized dealer or service facility for repair.
- Do not use or replace accessories such as the Filter and Carafe, other than the ones originally provided.
- Never leave the Coffee Maker unattended when in use.
- Avoid touching hot surfaces of the Coffee Maker during use. Use the cover or handle only.
- Never use your Coffee Maker without filling in water first.
- Be careful to avoid steam coming out from the Coffee Maker.
- Do not operate or place any part of your Coffee Maker on or near any hot surface such as gas or electric burner, hotplate or heated oven.
- Keep out of reach from children or from persons with mental or physical disabilities when operating the unit.
- Switch OFF and unplug the Coffee Maker from outlet before filling, emptying, when not in use or before cleaning.
- Allow Coffee Maker to cool down first before cleaning or replacing new ground coffee.
- To reduce the risk of electric shock, do not immerse or expose the Coffee Maker to rain, moisture or any liquid.
- Hold plug when unplugging from socket. Do not unplug by pulling the supply cord.
- After use, store your KYOWA Coffee Maker in a cool and dry place.
- This appliance is not intended for use by persons (including children) with reduced physical, sensory or mental capabilities, lack of experience and knowledge, unless they have been given supervision or instruction concerning use of the appliance by a person responsible for their safety.
- Children should be supervised to ensure that they do not play with the appliance.
- This KYOWA Coffee Maker is intended for normal domestic/household use only. This unit is not suitable for commercial use.

HOW TO USE

USING THE COFFEE MAKER FOR THE FIRST TIME

- Remove all packaging materials from the Coffee Maker. Completely unwind the power cable of the Coffee Maker.
- For initial use, operate the Coffee Maker with water only.
- Tip up the lid of the Water Tank. Fill the Carafe with cold water, pour water from the carafe into the Water Tank, and then tip down the lid to close.
- Place the Carafe in proper position under Swivel Filter Holder.
- Insert the plug into the socket.
- Start the brewing process by pressing the ON/OFF switch.
- Discard water.

HOW TO MAKE COFFEE

- Tip up the lid of the Water Tank. Fill Water Tank with at least 2 cups of cold water. The water level must not exceed the MAX level mark inside the Water Tank.
- Close lid of the Water Tank.
- Swivel open the Pivoted Filter Holder. Put desired amount of ground coffee into the Permanent Filter or Paper Filter.
- Swivel back to close the Pivoted Filter Holder.
- Place the Carafe with its lid on the Hotplate. Connect the Coffee Maker to the power outlet and press the switch. The Pilot Light will indicate that the Coffee Maker is ON.
- After the brewing process, take out Carafe and pour out coffee into cups.
- Turn OFF Coffee Maker if Carafe is empty or if there is no need to warm the coffee anymore.

TIPS

(For Great Tasting Coffee)

- Take time to select the right coffee beans and choose the blend that suits your taste. Great coffee begins with good quality coffee beans.
- Keep your coffee beans in a vacuum sealed container and store in a cool dry place to prolong freshness.
- Use filtered cold water for brewing coffee.
- Do not let your coffee sit for more than 30 minutes before consuming as it may become stale and lose its aroma. The best time to drink your coffee is immediately after brewing.

CLEAN AND CARE

- Wash movable parts of the Coffee maker with soapy water. Clean the outside surface with a soft, damp cloth.
- Never use abrasive cleaning agents or any metallic and sharp objects (e.g. scrubbing brush or knife) for cleaning.
- Remove lime scaling when you observe an excess of steam or if the coffee preparation time takes too long. If the water in your area is alkaline rich, it is highly recommended to remove lime scaling every two months. To do so:
 - Place the empty Carafe on the Hotplate. Dilute two cups of vinegar in six cups of water and fill the reservoir with the mixture.
 - Switch ON the Coffee Maker for a minute. Then switch OFF and leave for half an hour.
 - Discard the water and vinegar mixture, and then clean the Carafe. To eliminate vinegar residues, operate the Coffee Maker with water for two cycles.

SERVICE

- Do not operate your KYOWA Coffee Maker if the unit malfunctions or appears damaged in any manner. Bring the complete product to the place of purchase or to any authorized KYOWA dealers for inspection, repair or replacement.
- Do not disassemble your KYOWA Coffee Maker by yourself. No user serviceable parts inside. Refer all needed repair to an authorized KYOWA service facility ONLY.