





Gas Heater (TEGH) Conversion Procedure

Page 1 of 2

Doc. No.	SB-02A
Rev. (Rev. Date)	Apr. 8, 2011
Written by:	
Eng. Approval:	
Mfg. Approval:	

CONVERSION KIT PARTS INCLUDED

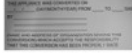
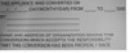
P/N CKNG-TEGH, NG Conversion Kit (LP to NG)				OR	P/N CKLP-TEGH, LP Conversion Kit (NG to LP)			
Part No.	Part Description	Qty.	Part Picture		Part No.	Part Description	Qty.	Part Picture
15108-36	Orifice #36 DMS, Main burner, NG	1		15108-50	Orifice #50 DMS, Main burner, LP	1		
15115	Orifice, rate screw, blank stud	1		15114	Orifice, rate screw 1.7mm # 51	1		
13349	Orifice (0.018), Pilot burner, NG	1		13348	Orifice (0.012), Pilot burner, LP	1		
18351	Conversion Label	1		18351	Conversion Label	1		

TOOLS REQUIRED

- 1/2" and 7/16" Wrench
- Long nose pliers
- Flat screwdriver

PROCEDURE

- 1) Shut-OFF the gas supply and then open the component access door.

Access Door

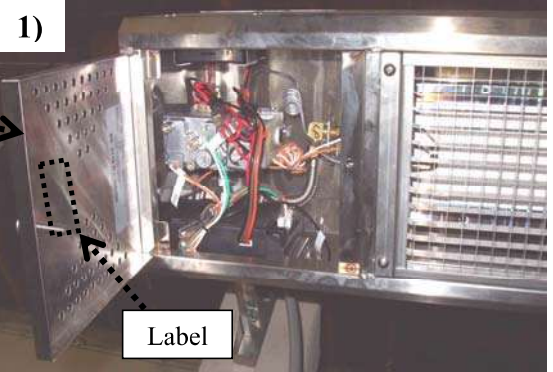

- 2) Remove the main burner orifice from the brass elbow using a 1/2" wrench. Replace the main burner orifice accordingly (#36 DMS for NG or #50 DMS for LP).



- 3) Remove the tubing from the pilot burner with a 7/16" open wrench. Remove the pilot burner orifice and insert the appropriate orifice in the same direction as shown on picture 3, (0.018 for NG or 0.012 for LP). Screw the tubing back into the pilot burner.

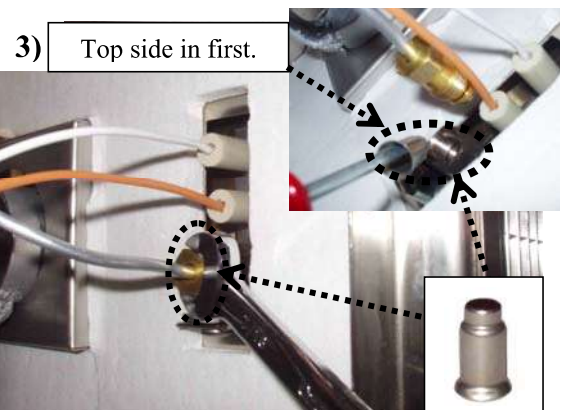

- 4) Remove the rate screw orifice with a flat screwdriver; you may need to use pliers to pull the rate screw of the cavity. Replace the rate screw orifice accordingly (Blank stud for NG or 1.7mm. # 51 for LP).

NOTE: On LP conversion, the rate screw orifice may need to be turned back out by 1 to 2 turns for the burner to have a stable flame on the low setting.

- 5) Remove the black rubber cover from the valve. Push and turn the stem converter 90° until the indicator slot is pointing towards the gas type being converted to. Place the black rubber cover back on.

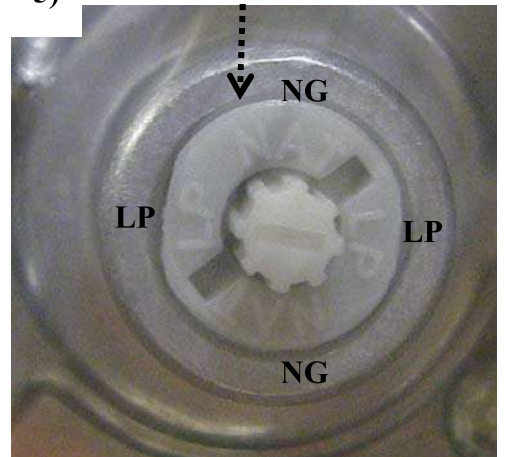
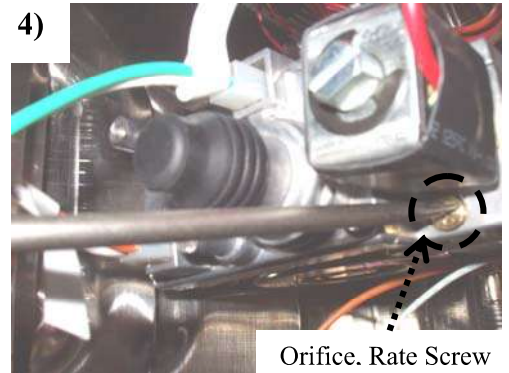

- 6) Open the gas supply to the unit and conduct an applicable leak test. Consider the unit operational only if no gas leak is found.
- 7) With a permanent marker, write the following information on the conversion label, such as: Model number indicate on the serial plate, gas converted to, date of the gas conversion, service agency name, address and contact phone number. Without covering the holes on the access door paste the label on the access door as shown on picture 1.
- 8) Gas conversion is complete