

# TOMAHAWK

**TOS38  
38" PUSH SWEEPER**

**Operation Manual**



# Table of Contents

<b>About these Instructions</b>	3
<b>Safety Instructions</b>	3
<b>Instructions for Use</b>	5
<b>Assembly</b>	6
<b>Operation</b>	7
<b>Maintenance and Troubleshooting</b>	9
<b>Specifications</b>	11
<b>Warranty</b>	11



# **I. About These Instructions**

## **1.1 Technical further development**

We are continuously working on further development of all our products. We therefore reserve the right to make changes in the scope of delivery with respect to form, technology, and equipment.

No claims can therefore be derived from information and illustrations contained in these instructions.

## **1.2 Target group**

These instructions are intended for the person using this sweeper.

### **Prerequisites**

- Persons who operate the sweeper must be informed about the dangers related to use of the machine.
- Persons who operate the sweeper must be rested, healthy and in good physical condition.
- Only pass on or loan the sweeper to persons who are familiar with this model and its handling – always provide the instructions with the machine.
- Persons who are using the sweeper for the first time must have safe operation of the machine explained to them by the salesperson or another qualified person before they operate the sweeper.
- Children should be supervised to ensure that they do not play with the sweeper.
- Minors must not operate the sweeper – except for juveniles over the age of 16 who are trained under supervision.
- This sweeper is not intended for use by persons (including children) with restricted physical, sensor or mental capacity or persons who lack experience and/or knowledge, unless they are supervised by a person responsible for their safety or received instructions from this person on how to use the machine.
- Persons who are prohibited from strenuous physical activity for health reasons should ask a doctor for advice on whether working with the sweeper is possible.
- The sweeper must not be operated after consumption of alcohol, medicines that impair reaction times or drugs.

# **II. Safety Instructions**

Safety instructions prevent danger to life and limb and avoid damage to property or the environment due to improper use of the sweeper.

For this reason, you must read these instructions carefully and follow the safety instructions contained in them before using and working on the sweeper.

The user of the sweeper is responsible for injuries and damage that are caused due to non-compliance with these instructions.

## **2.1 Intended use**

This sweeper is designed in accordance with the state of the art and recognized safety regulations.

Nevertheless, use of the sweeper can lead to dangers for the user or third parties or damage to the sweeper and other material assets.

The sweeper is intended for commercial use, e.g. in hotels, schools, hospitals, factories, shops, offices, and the equipment hire trade. The sweeper is intended exclusively for removal of road dirt, leaves, grass, paper, and similar debris.

Sweeping snow with the sweeper is not permitted.

Any other use will be deemed as improper use. The manufacturer will not be liable for damage caused as a result of this. The user is solely liable for the associated risks.

Claims of any kind due to damage caused by improper use are excluded.

The following information must also be observed when operating the sweeper:

- the safety instructions in these operating instructions.
- compliance with the operating, maintenance, and storage conditions prescribed by the manufacturer.
- compliance with accident prevention regulations as well as country-specific safety regulations, e.g. as issued by employers' professional liability associations, social security authorities, occupational health and safety bodies and others.
- national and local regulations on time restrictions for operation of noise-emitting equipment.

The sweeper must not be used, for example, for sweeping substances that are hazardous to health, flammable or glowing (e.g. cigarettes, matches), liquids, explosive or hazardous dusts (Ex), acids or solvents. The sweeper must not be used in explosion-hazard areas or as a means of transport.

## **2.2 Safety instructions for operation/Maintaining operating safety**

The user must not wear open long hair, tie, loose clothing, or jewelry, including rings. There is a risk of injury, e.g. getting caught up or pulled into the machine. Use personal protective equipment if necessary or required by regulations!

- Wear sturdy shoes with a high-grip, anti-slip sole.
- Always wear a dust protection mask in dusty conditions.
- Wear sturdy gloves.

Use the machine only in technically perfect condition for its intended purpose and paying attention to safety and the environment.

Have any faults that affect safety rectified immediately by a specialist dealer.

Observe all safety and danger instructions on the sweeper.

The user must ensure the presence and legibility of all warning and information notices throughout the entire service life of the sweeper.

Use only genuine spare parts and accessories that have been approved by the manufacturer. These guarantee that the machine can be operated safely and without faults.

Do not carry out any modifications, attachments or conversions on the sweeper that could impair safety without the approval of the manufacturer! The manufacturer excludes all liability for injuries or material damage caused by use of attachments that have not been approved.

The maintenance work described in these instructions must be carried out completely and at the specified intervals either by the user or at a specialist dealer.

### **III. Instructions for Use**

1. Before Using, Inspect the package check to make sure all parts are present and that during transit the package and equipment is not broken. If there is damage or broken parts, please contact the seller. (866) 577-4476
2. Before Using, please read this operation manual carefully and check whether the sweeper is working properly.
3. Note: this machine is not intended for cleaning harmful or toxic substances.
4. Do Not operate the machine on 1 single-wheel (tilted). This will effect the longevity of the sweeper.
5. Note: When sweeping and moving glass, metal or other parts into a trash can use gloves and safety glasses.
6. Visit us at [Tomahawk-Power.com](http://Tomahawk-Power.com) and visit Tomahawk Power YouTube Channel for assembly instructions
7. Never attempt to modify your machine in any way since this may increase the risk of personal injury. Tomahawk Power excludes all liability for personal injury and damage to property caused while using unauthorized attachments.
8. Transporting the Machine: Do not carry the power tool by the handle on the hopper.
9. Do Not sweep up burning objects such as lit cigarettes as there is a risk of fire.
10. Do Not bump into object and shelves as risk of items falling and hurting the operator.

# TOMAHAWK

www.tomahawk-power.com

TOS38: Assembly Guide

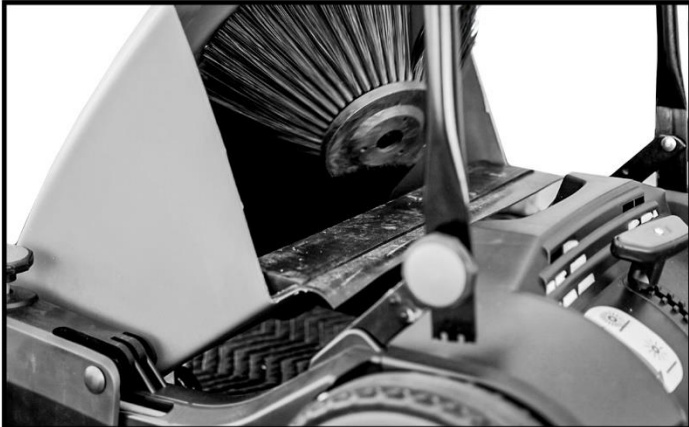

**1** Raise the handles and open the hopper bin to find the sweeper's two front brooms.



**2** Lift the broom arms and begin unscrewing the 3 screws attached underneath.



**3** Align the first broom to the holes in the arm and begin to fasten in place with the screws.



**4** Loosen the handle knobs then pull the handlebar up to align it with the slots.

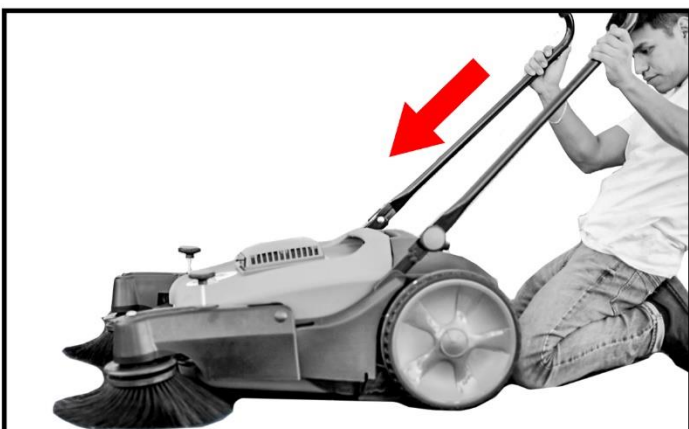

**5** Push the handlebar down into the slots and tighten the knobs to lock it in place.



**6** Adjust the height of the brushes using the back lever and side knobs for deeper cleaning.

## V. Operation

1. The operator should use the sweeper under normal operation and consider the surrounding environment when operating; be cautious of people around the sweeper and objects that may unintentionally sweep in an outward direction.

2. Depending upon the service the operator intends to sweep you can adjust the best height of the front and back brushes. The higher the brushes the less pressure on the surface. A higher brush may be less effective but will increase the longevity of the brush. The lower settings of the brush will be more effective at sweeping but harder to push and decrease the longevity of the brush.

3. If Debris is not going into the sweeper. Try sweeping quickly with some force over the debris pile to push the trash into the sweeper trash bin. **Note: Do not backup the sweeper it will not properly collect trash in the reverse direction**

### Assembly

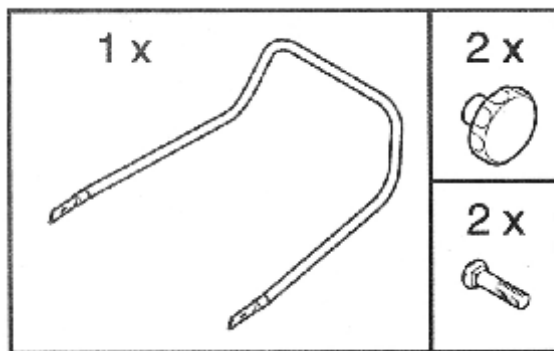

Handle and adjusting bolt assembly

Note:

Do not over-twist to prevent bolt damage.

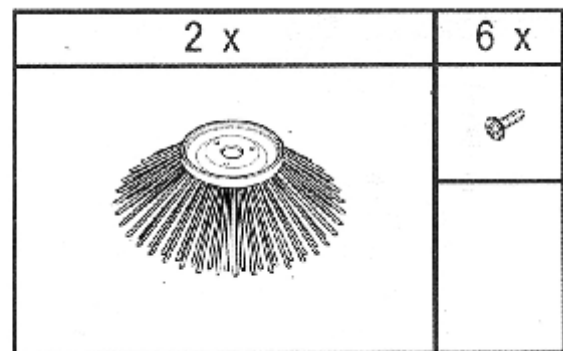

Front brush and fixed bolt

### Adjusting Height of Brush



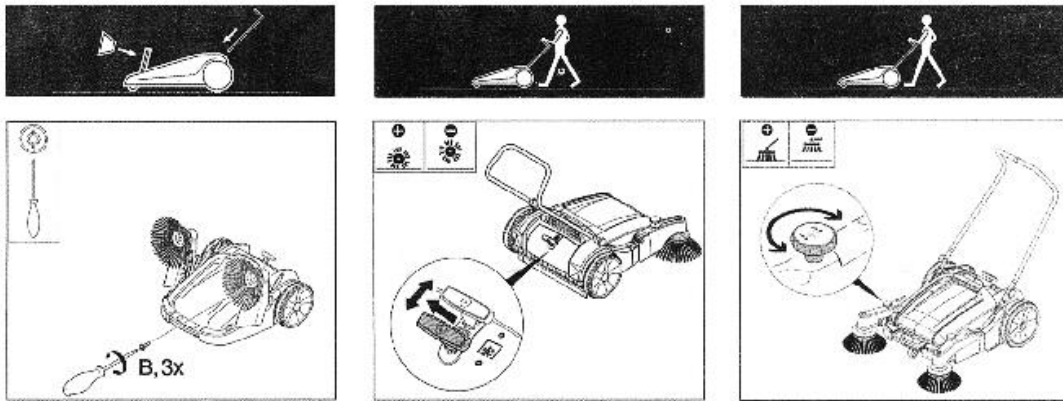

1. The front brush is fastened with three screws

2. Main Brush Adjusting Handle

"+" main brush down

" - " main brush up

3. Front Brush Adjusting Handle

"+" main brush down

" - " main brush up

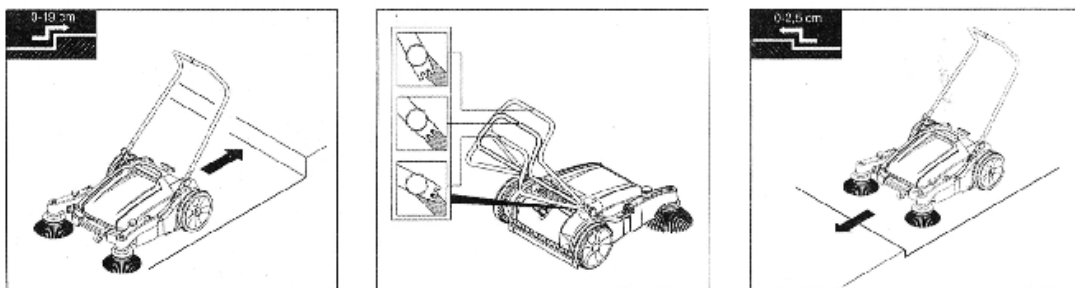

1. No more than 19 cm across the steps when machine back up

2. Three angle adjustments for handle

3. The height difference of cleaning ground not exceeding 2.5 cm

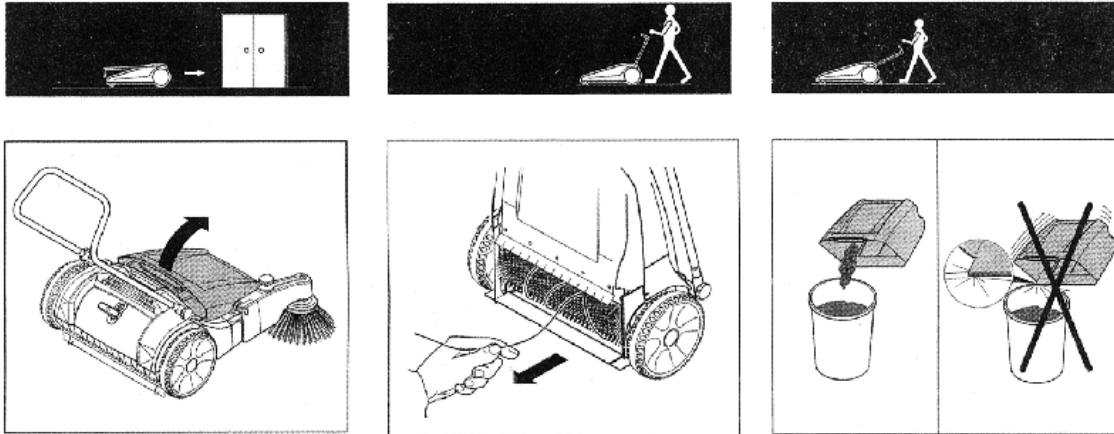

1. Hold your handle and lift it up to remove the garbage can
2. When the main brush is entangled with garbage, it should be reversed and removed in time.
3. Dump the garbage along the side of the garbage can. No knocking on the garbage can is allowed.

## VI. Maintenance and Troubleshooting

### Cleaning the machine

- Always clean, dust off and clear debris from the sweeper
- Do not use any grease solvents, pressure washer for cleaning the sweeper.
- Wear safety gear when cleaning to reduce the risk of injury.
- Store the machine in a safe and dry area.

### Maintenance

*Problem: If there is a Clog.*

Solution: If one of the side brooms or the roller brush becomes blocked, stop work, and remove the blockage. Wear work gloves to reduce the risk of cuts or injuries from sharp objects.

*Problem: If debris comes from the sides*

Solution: Continue pushing the sweeper for a brief period, lift the sweeper up at the front (front wheels up doing a wheelie) so that dirt falls to the back of the trash bin hopper. This helps make better use of the hopper's full capacity. When sweeping heavy material, ex: gravel, loose chippings, nails the sweeper's center of gravity shifts to the rear. This tends to lift the side brooms away from the surface and reduce cleaning efficiency. Adjust the side brooms downward accordingly.

*Problem: Side Brush not moving*

Solution: Replace Brush and or band that rotates brush.

*Problem: Debris Not sweeping up into hopper.*

Solution: Replace roller Brush

*Problem: Brush Bristles Damaged*

Solution: Use a heat gun or blower dry to straighten bristles

*Problem: The machine is difficult to push*

Solution: The Roller brush may have a blockage. Unclog the brush. Also, the side brushes may be a setting that is too low; increase the height of the brushes.

*Problem: Gear components Stiff.*

Solution: Lubricate gears with a silicone-based oil.

## **VII. Specifications**

Sweeping performance:

Trash Bin Hopper Capacity: 14.5 Gallon

Sweeping Distance: 31-38"

Brush Assembly Types: 2 side brushes 1 roller brush

Weight: 60lbs

Dimensions: 47" x 31" x 37"

Uses: indoor and outdoor

Fine dust filter: included

Adjustable roller brush: yes

Foldable side brush: yes

## **VIII. Warranty**

- The relevant national regulations apply in each country. Excepted from this are wearing parts such as sweeping lip, angled wheels and running wheels.
- Please enclose a copy of the invoice in the event of a warranty claim.
- Only genuine Tomahawk Power spare parts must be used.
- No technical modifications must be carried out on the sweeper.
- All claims under guarantee and warranty will be rendered void if the machine is not operated properly.

**NOTE: This product is covered under warranty for 1 year from the date of purchase.**



# TOMAHAWK

## COMPACTION



HONDA  
ENGINES

**3,550 lbs/ft Vibratory Rammer**  
Part#: TR68H

3.6 HP Honda GXR120 Engine  
Easily achieve a 100% compaction rating  
3-in-One Fuel System with carburetor protection  
13" x 11" plate for narrow trenches and corners  
3 Year Engine Warranty & 1 Year Product Warranty



HONDA  
ENGINES

**3,400 lbs/ft Plate Compactor**  
Part#: TPC90H

5.5 HP Honda GX160 Engine  
Easily achieve a 100% compaction rating  
22" x 20" cold, rolled steel beveled base plate  
Includes 3.5 gallon water tank for asphalt compaction  
3 Year Engine Warranty & 1 Year Product Warranty



HONDA  
ENGINES

KOHLER  
ENGINES

**3,000 lbs/ft Plate Compactor**  
Part#: TPC80 & TPC80H

6 HP Kohler CH260 & 5.5 HP Honda GX160 Engines  
Easily achieve a 100% compaction rating  
16.5" x 21.5" plate for narrow trenches and corners  
Optional Honda Engine model: TPC80H  
3 Year Engine Warranty & 1 Year Product Warranty

## FINISHING



**6.5 Gal Backpack Concrete Sprayer**  
Part#: TCS6.5

Maintain constant, adjustable pressure up to 450 PSI  
Achieve superior concrete finishes with even spraying  
Spray 15,000 sq ft in less than 10 minutes  
Compatible with major manufacturer wands  
1 Year Product Warranty



HONDA  
ENGINES

**1.6 HP Vibratory Concrete Screed**  
Part#: TVSA-H

1.6 HP Honda GX35 Engine  
Aluminum Magnesium blades available from 8ft - 14ft  
Finish concrete 4X faster than other screed methods  
360° adjustable handle placement  
3 Year Engine Warranty & 1 Year Product Warranty



HONDA  
ENGINES

**6" Early Entry Green Concrete Saw**  
Part#: TFS6H

5.5 HP Honda GX160 Engine  
Maximum cutting depth of 1 3/16 inches  
OSHA compliant vacuum port for dust collection  
Includes 6" early entry concrete blade  
3 Year Engine Warranty & 1 Year Product Warranty

## GENERATORS



INVERTER SERIES

**2000 Watt Inverter Generator**  
Part#: TG2000i

2000 Max Watts, 1600 Rated Watts  
Run Time of 8 hours on 1 gallon of gas  
OSHA and GFCI Compliant  
Parallel technology capable for double the power  
2 Year Product Warranty



INVERTER SERIES

**3500 Watt Inverter Generator**  
Part#: TG3500i

3500 Max Watts, 3000 Rated Watts  
Run Time of 20 hours on 3.5 gallon of gas  
OSHA and GFCI Compliant with Electric Start  
Parallel technology capable for double the power  
2 Year Product Warranty



**4000 & 7000 Watt Generators**  
Part#: TG4000 & TG7000

4000 / 7000 Max Watts, 2500 / 5500 Rated Watts  
Voltage Selector gives Full Wattage for 120V or 240V  
Run Time of 8 hours at 50% Load  
OSHA and GFCI Compliant  
2 Year Product Warranty

HAVE QUESTIONS?

Contact us. *We're here to help!*

Email us at [sales@tomahawk-power.com](mailto:sales@tomahawk-power.com)



**WELDING / POWER**

INVERTER SERIES



**120 Amp Portable Welder Generator**  
Part#: TWG120A

Steady 120 Amp DC welding output  
60% Duty Cycle for extended use  
Suitable for welding rods from 6010 to 6013  
Includes wheel kit for job site portability  
2 Year Product Warranty

INVERTER SERIES



**210 Amp Portable Welder Generator**  
Part#: TWG210A

Steady 50 - 210 Amp DC welding output  
60% Duty Cycle for extended use  
Suitable for welding rods from 6010 to 7024  
Electric Key Start with battery included  
2 Year Product Warranty



**9000 Watt Generators**  
Part#: TG9000

9000 Max Watts, 8500 Rated Watts  
Run Time of 10 hours at 50% Load  
7 gallon fuel tank for extended use  
Electric Key Start with battery included  
2 Year Product Warranty

**PEST CONTROL**



**3.7 Gallon 3HP Backpack Fogger**  
Part#: TMD14

Turbo Boosted Pump with 40ft + Horizontal Reach  
Sprays 1 acre in 30 minutes  
10X Faster than Manual Pump Sprayers  
Converts to Leaf Blower with 200 MPH Air Velocity  
1 Year Engine Warranty & 1 Year Product Warranty



**5 Gallon 1.8HP Backpack Sprayer**  
Part#: TPS25

Reach Up to 30ft Horizontal Reach  
Sprays 1 acre in 15 minutes  
10X Faster than Manual Pump Sprayers  
450 PSI Commercial Grade Pump  
1 Year Engine Warranty & 1 Year Product Warranty



**4 Gallon 3HP Backpack Spreader**  
Part#: TGS30

Reach Up to 30ft Horizontal Reach  
Covers 1 acre in less than 30 minutes  
20X Faster than Manual Broadcast Spreaders  
Converts to Fogger with Liquid Tank Accessory  
1 Year Engine Warranty & 1 Year Product Warranty

**AND MORE**



HONDA ENGINES

**8" Gas Powered Concrete Scarifier**  
Part#: TSCAR8H

5.5 HP Honda GX160 Engine  
Remove traffic lines at 800 - 1,000 linear ft/hr  
Tungsten Carbide Blade Kit Available  
OSHA approved dust port for silica vacuum removal  
3 Year Engine Warranty & 1 Year Product Warranty



KOHLER ENGINES

**36" & 46" Concrete Power Trowel**  
Part#: TPT36K & TPT46K

6 HP Kohler CH260 & 14 HP Kohler CH440 Engines  
Adjust trowel blade pitch from 0-28°  
60-115 RPM rotor speed for superior concrete finishes  
Includes float pan and trowel blades  
3 Year Engine Warranty & 1 Year Product Warranty



**2" and 3" Trash Water Pumps**  
Part#: TW2 & TW3

Moves liquids at a rate up to 9,240 gallons/hour  
Handle solids up to 0.6"  
Cast iron impeller for smooth performance  
6.5 HP engine protected by rugged all purpose frame  
1 Year Product Warranty

ASSEMBLED IN THE  
**USA**  
PARTS SOURCED GLOBALLY

(866) 577-4476

[www.tomahawk-power.com](http://www.tomahawk-power.com)



## Power Your World

Tomahawk understands to keep a job-site running smoothly the proper equipment and spare parts are needed at the drop of a hat. With same day shipping and faster delivery times, count on Tomahawk to keep you powered throughout the day! With long lasting parts and engines, Tomahawk equipment will be the star of your fleet for years to come. Visit [www.tomahawk-power.com](http://www.tomahawk-power.com) to get started today!

# TOMAHAWK

Tomahawk Power, LLC  
San Diego, CA

**Sales Support**  
(866) 577-4476  
[sales@tomahawk-power.com](mailto:sales@tomahawk-power.com)

**Equipment Support**  
(866) 577-4476  
[support@tomahawk-power.com](mailto:support@tomahawk-power.com)

[www.tomahawk-power.com](http://www.tomahawk-power.com)



**FACEBOOK**  
[facebook.com/TomahawkPowerUSA](https://facebook.com/TomahawkPowerUSA)

**YOUTUBE**  
[youtube.com/TomahawkPower](https://youtube.com/TomahawkPower)

**INSTAGRAM**  
[@tomahawkpower](https://instagram.com/tomahawkpower)