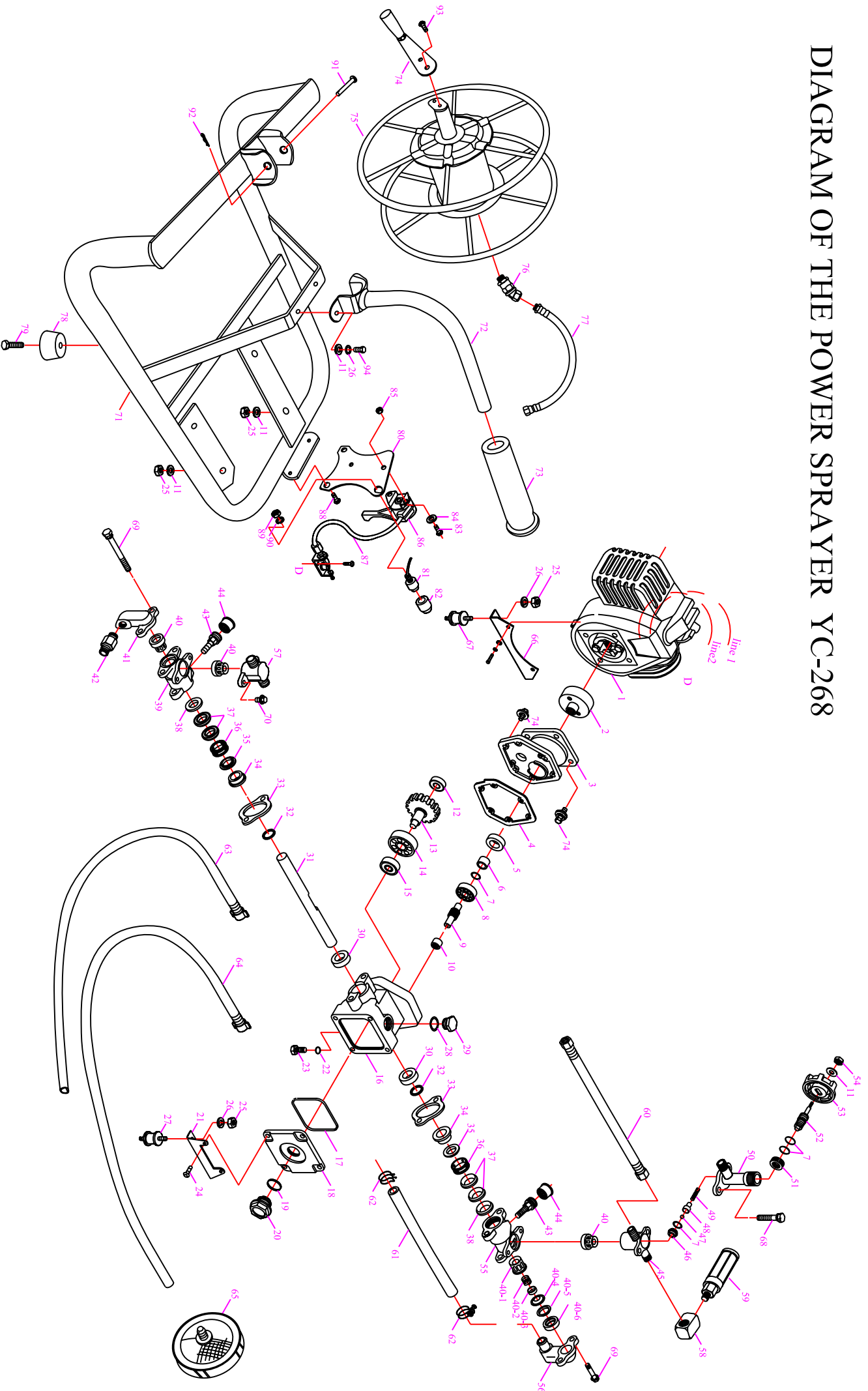

DIAGRAM OF THE POWER SPRAYER YC-268



YC-268 PORTABLE POWER SPRAYER PART LISTS

No.	Part name	MOLD	PER. SET	PRICE
1	Engine		1	
2	Drum clutch		1	
3	Drum case		1	
4	Gasket		1	
5	Oil seal	17.28.7	1	
6	Steel pipe		1	
7	O-ring	9x13	4	
8	Bearing 6201		1	
9	Shaft		1	
10	Bearing HK1010		1	
11	Steel pin		2	
12	Bearing 608		1	
13	Gear shaft		1	
14	Bearing 6203		1	
15	Bearing 6200		1	
16	Crank case	16mm	1	
17	O-ring	G60	1	
18	Crank case cover		1	
19	O-ring	G25	1	
20	Oil glass		1	
21	Pump stand		1	
22	O-ring	6x10	1	
23	Drain plug		1	
24	Screw	M6x12	6	
25	Nnt	M6	4	
26	Spring washer	M6	8	
27	Joint		2	
28	O-ring	12x2	1	
29	Oil inlet cup		1	
30	Oil seal	16.28.7	2	
31	Plunger	16mm	1	
32	O-ring	16x2.5	2	
33	Fixed plate	2mm	2	
34	Adjusting ring		2	
35	Grease ring		2	

YC-268 PORTABLE POWER SPRAYER PART LISTS

No.	Part name	MOLD	PER. SET	PRICE
36	V-packing upper seal		2	
37	V-packing		4	
38	Packing seat		2	
39	Cylinder		1	
40	Valve A'ssy		4	
40-1	Valve nut			
40-2	Valve spring			
40-3	Valve plug			
40-4	Valve seat			
40-5	Valve ring			
40-6	Valve packing			
41	Suction chamber		1	
42	Connector		1	
43+44	Grease cup		2	
45	Outlet chamber		1	
46	Valve seat		1	
47	Pressure valve		1	
48	Pressure valve rod		1	
49	Spring		1	
50	Relief valve A'ssy		1	
51	Nut		1	
52	Pressure valve screw		1	
53	Pressure adjusting		1	
54	Nylon nut	M6	7	
55	Cylinder		1	
56	Suction chamber		1	
57	Outlet chamber		1	
58	connector		1	
59	Pressure gauge		1	
60	High pressure hose		1	
61	Suction hose		1	
62	Clip		2	
63	Overflow hose		1	
64	Suction hose		1	
65	filter		1	

YC-268 PORTABLE POWER SPRAYER PART LISTS

No.	Part name	MOLD	PER. SET	PRICE
66	Engine stand		1	
67	Joint		2	
68	screw	M6x45	2	
69	Screw	M6x75	2	
70	Screw	M6x12	2	
71	Frame		1	
72	Handle		1	
73	Handle rubber		1	
74	Screw	M6x16	10	
75	Roller for PVC hose		1	
76	ROLLER		1	
77	PVC		1	
78	Joint		4	
79	screw	M8*25	4	
80	Fixed plate		1	
81	Stop switch		1	
82	Rubber sheath		1	
83	Screw	3/16"x3/8"L	2	
84	Washer	3/16"	2	
85	Nut	3/16"	2	
86	Throttle		1	
87	Cable comp		1	
88	Screw		2	
89	Washer		2	
90	Nut		2	
91	PIPE		1	
92	Bolt		1	
93	Screw		2	
94	Screw		2	