

# AG Glass Tube Fuse

- Fast Acting Glass Tube Fuses
- 5ø x 20 mm (0.197 x 0.787 Inch)
- Caps: Brass With Nickel Plating
- Body: Glass Tube
- Standards: UL & CSA 248-14
- Element: Silver Alloy
- Ampere Rating: 0.5 – 25 A
- Voltage Rating: 250V and Less

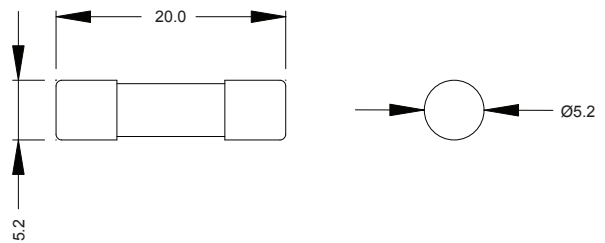

Scale: mm

## Specifications

### Opening Time / Pre-arcing Time:

In	1.0 In	1.35 In	2.0 In
0.5 - 25A	> 4 Hours	Max.	Max.
		1 Hour	10 s

### Ordering Information:

Part No.	Ampere (A)	Voltage (V)	Cold Resistance $\Omega$	Voltage Drop Max. (mV)	Breaking Capacity AC	$I^2t$ Min. (A <sup>2</sup> S)
AG-.5	500 mA	250 V	0.46	250	35A 250V	0.07
AG-1	1 A	250 V	0.15	180	35A 250V	0.48
AG-1.25	1.25 A	250 V	0.11	170	100A 250V	1.13
AG-2	2 A	250 V	0.06	130	100A 250V	2.70
AG-2.5	2.5 A	250 V	0.044	120	100A 250V	5.60
AG-3	3 A	250 V	0.040	117	100A 250V	7.50
AG-4	4 A	250 V	0.025	105	200A 250V	17.5
AG-5	5 A	250 V	0.019	100	200A 250V	28.50
AG-6	6 A	250 V	0.017	97	200A 250V	40.30
AG-8	8 A	250 V	0.011	90	200A 250V	96.00
AG-10	10 A	250 V	0.0085	85	200A 250V	110.00
AG-12	12 A	250 V	0.0075	90	200A 250V	210.00
AG-15	15 A	250 V	0.005	75	200A 250V	450.00
AG-20	20 A	250 V	0.0035	70	200A 250V	800.00
AG-25	25 A	250 V	0.002	60	200A 250V	1250.00

<http://www.tiewraps.com>

Telephone - 1•800•942•2292