

# D4+ 4.0

USER MANUAL



**ROADRUNNER**  
SCOOTERS



[RoadRunnerScooters.com](http://RoadRunnerScooters.com)

# RoadRunner D4+ 4.0 Electric Scooter



For instructional videos on how to: get your scooter ready to ride, maintain your scooter, and repair your scooter, scan this QR code with your camera phone and browse dozens of videos.



## Table of Contents

---

<b>Scooter and Accessories</b>	<b>3</b>
<b>D4+ 4.0 Electric Scooter</b>	<b>3</b>
<b>Accessories</b>	<b>3</b>
<b>Scooter Specs</b>	<b>4</b>
<b>Charging the Scooter</b>	<b>5</b>
<b>Battery and Charger Information</b>	<b>6</b>
<b>Handlebar Controls and Instruments</b>	<b>7</b>
<b>Parameter Settings (P-Settings)</b>	<b>9</b>
<b>Operating instructions</b>	<b>10</b>
<b>Safety Instructions</b>	<b>11</b>
<b>Maintenance</b>	<b>12</b>
<b>Adjusting the Stem Height</b>	<b>12</b>
<b>Troubleshooting common errors</b>	<b>13</b>
<b>Folding the Scooter</b>	<b>14</b>
<b>Unfolding the Scooter</b>	<b>15</b>
<b>Installing Steering Damper</b>	<b>16</b>
<b>How to Carry Your Scooter</b>	<b>22</b>
<b>Warranty Policy</b>	<b>22</b>

# Scooter and Accessories

## D4+ 4.0 Electric Scooter



### Accessories Included:

1. Owner's Manual
2. Steering Damper
3. Charger
4. Multi-tool

# Scooter Specs

Product name	RoadRunner D4+ 4.0 Electric Scooter
Product model	D4+ 4.0
Folded Dimensions	49" (l) x 9" (w) x 21" (h)
Unfolded Dimensions	49" (l) x 9" (w) x 50" (h)
Net weight	70 lbs
Max load	330 lbs
Max speed	40 MPH (depending on environment, incline, weight and driving habits)
Range:	40 miles (depending on environment, incline, weight and driving habits)
Max climb	28° incline
Suspension	C-Type with Front & Rear Spring Shock Absorbers
Tire	10" Pneumatic Hybrid Air Tires
IP Rating	IP53
Brake system	Front and Rear EBS Hydraulic Disc Brake System
Light system	LED Headlight; LED Taillight and LED Brake light
Lithium battery	52V 23.4Ah Lithium-Ion
Charging time	2A battery charger 9-10 hours, (2) 2A chargers 4-5 hours

## Charging the Scooter

1. Plug the charger into a power supply (wall outlet, power strip, etc.)
2. Open the waterproof cover on the charging port, then plug the charger into the charging port.
3. A red light means the scooter is charging; green means it is fully charged.
4. Cover the charging port once the charger is removed.

Note: If the scooter is known to not be fully charged when plugging charger in, and the light turns green, the charger is likely faulty.

Please contact service at [support@roadrunnerscooters.com](mailto:support@roadrunnerscooters.com)

# Battery and Charger Information

Every RoadRunner D4+ 4.0 Scooter is equipped with a dedicated lithium-ion battery and a dedicated smart charger. Please do not use any other charger or battery with your scooter, and do not use your dedicated charger with any other product. We are not responsible for any damage incurred due to misuse of your charger.

1. **Battery:** The lithium-ion battery provided by RoadRunner Scooters can be charged up to 600 times with no change in capacity.
  - Over 600 uses, the battery's capacity will drop to 80%.
  - Over 1000 uses, the battery may need replacing if it doesn't hold a full charge.

**Maximum Voltage for full battery charge:** 58.8 V

**Minimum Voltage before battery dies:** 42.0 V

**WARNING: NEVER LEAVE THE SCOOTER UNATTENDED WHILE BATTERY IS CHARGING!**

2. **Charger:** The smart charger included with your D4+ 4.0 scooter automatically stops charging and the light turns green when your scooter reaches 100%, which means it is fully charged. The battery should be fully charged in 9-10 hours with a single charger (4-5 hours with 2 chargers). If your battery will not charge, please contact RoadRunner Scooters for help. If your battery is damaged due to water, storing in extreme temperatures, or human mishandling, it is not covered under the new scooter or extended warranty.

# Handlebar Controls and Instruments

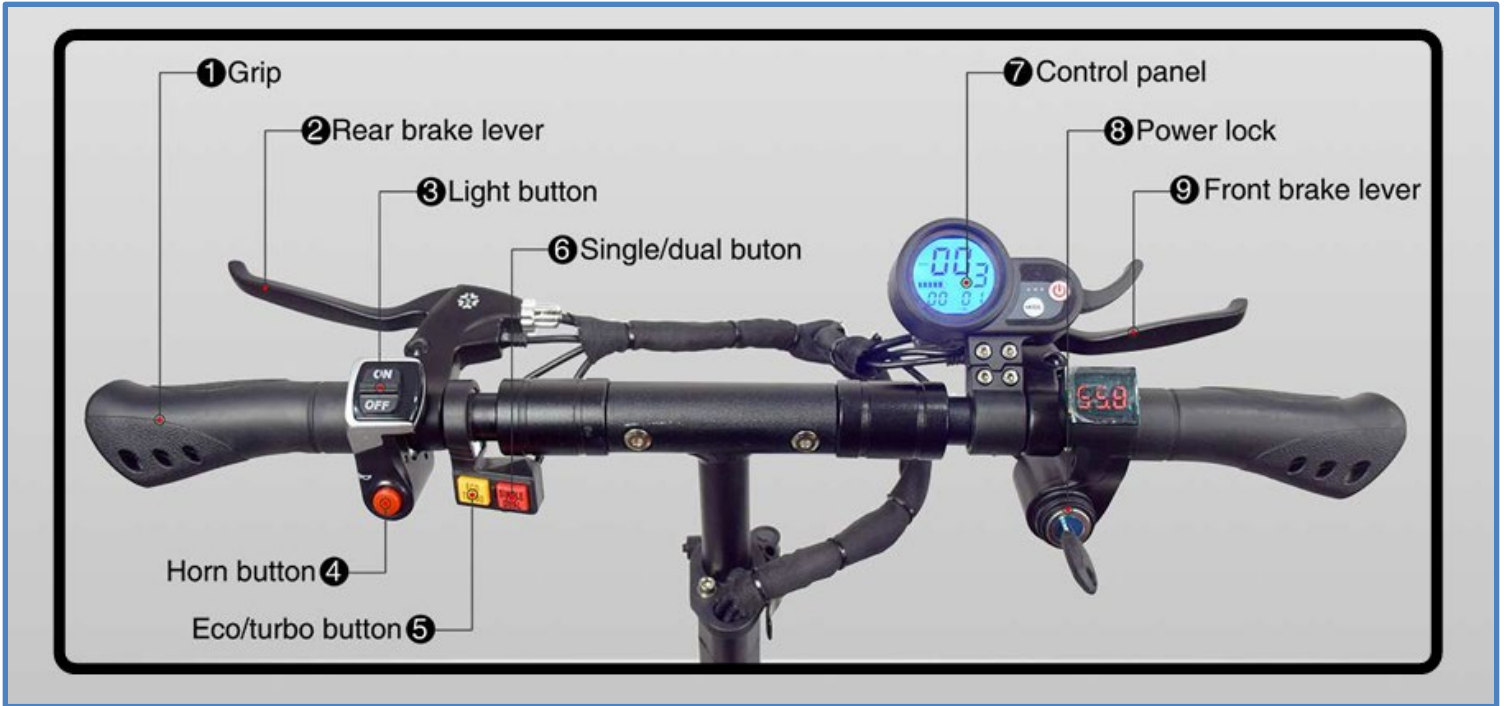



# LCD Display



**Power:** power button (hold down for 3 seconds)

**Gear:** current gear speed: Gear 1 (low), Gear 2 (medium), Gear 3 (fastest)

To switch to different modes, hit the mode button to get to Gear 2, hit the mode button again to get to Gear 3, and once more to return to Gear 1.

**Speed:** Current Speed

**Battery Voltage:** Current Battery level

**Riding Time:** Remaining Riding time left on battery.

**Mode:** Switches to each Parameter Setting (P-setting).

**Accelerator:** Powers the scooter acceleration.

## Parameter Settings (P-Settings)

To make changes to any P-settings, press the power and mode buttons simultaneously until the P-settings appear. Once the selected settings appear, quickly press the power button once to proceed to the next P-setting. Press the power button to exit the current P-settings or to advance to the next P-setting. P-settings will automatically exit if there is no activity for 8 seconds.

Example: to modify KM vs. miles, press the power and mode buttons simultaneously until the P-settings appear to enter P1. Once the selection flashes, press the power button once to select 0 (KM) and once more to select 1 (miles). Once you've made your selection, press the power button to proceed to the P2 setting.

P01	Headlight Brightness 1-3 3= brightest <b>default is 3</b>
P02	Range units: 0= Km, 1 = mile <b>Default is Km</b>
P03	Voltage: 24V,36V, 48V, 52V <b>Default is 52V</b>
P04	Automatic Display Shutoff <b>Default is 5 minutes</b>
P06	Wheel Diameter: 10.0 inches <b>Do not change</b>
P07	Magnetic Poles in hum motor: 30. <b>Do not change</b>
P08	Max output (max speed): 1 – 100% (example: 80 = 80% top speed).
P09	0 = non-kickstart; 1 = kickstart. With kickstart setting on, the scooter must be moving at 2mph for it to accelerate
P11	EBS Brake Settings: 0= EBS off 1= weakest EBS 5 = strongest EBS (most sensitive). <b>Default: 3</b>
P12	Start Settings: 1 – 5; 1 = slow start 5 = fastest start
P15	Voltage cut off. When voltage drops below 42V, the scooter will power off automatically to protect the lithium-ion battery. <b>Do not change</b>
P17	Cruise control: 0= Non-Cruise 1 = Cruise
P20	Default = 4 <b>Do not change</b>

# Operating instructions

## **Power on/off:** Power on/off

- a. Turn your key to the right to turn on, turn your key to the left to turn off.
- b. Long press the power button to turn the LCD display on/off.
- c. Press power button once quickly to switch gears (default is gear 1).

**Gear setting:** Press the button located on the throttle to switch gears.

<i>First gear</i>	Second gear	Third gear
Slow Speed (1)	Medium Speed (2)	Fast Speed (3)

**Kick Start Mode:** The throttle system will work once the scooter reaches 2 MPH. Press the throttle smoothly to accelerate. Refer to P-settings on how to change.

**Brake control:** Left-hand brake = rear brake and right-hand brake = front brake. Use both brakes simultaneously to stop quickly.

**Headlights:** When the scooter is powered on, push the headlight button downward to turn on all lights. Push the light button upward to turn all lights off.

**Cruise control:** When cruise control is turned on, it will automatically be activated when you reach a consistent speed. Release the thumb accelerator and the scooter will automatically move to the set speed. To cancel the cruise control, pull either brake lever, and cruise control will turn off.

# Safety Instructions

Please read the following carefully before use.

- This scooter is for use by one adult rider at a time.
- When riding, please wear safety gear including a helmet.
- Always keep both hands and both feet on your scooter while riding.
- Do not ride your scooter anywhere unsafe or illegal.
- Practice riding in an open space first, and only ride on the road once you're comfortable.
- If you ride at night, turn on your lights.
- Do not ride on a slippery surface (i.e., ice, rain, and oil)
- Do not exceed the weight limit of 330 lbs.
- Avoid using your scooter in extremely high or low temperatures.
- Do not store the scooter near flammable items.
- Do not immerse your scooter in water higher than 1/2" to avoid electrical damage.
- Avoid riding in extreme weather conditions such as rain, snow, and high winds.
- Avoid potholes.
- Always ride in accordance with local traffic laws and regulations.
- Recommended age is 16 years or older to ride.

# Maintenance

Always check your scooter regularly to ensure all screws are tight. Screws can become loose over time with vibration and movement. Tighten them as needed.

1. Battery
  - a. Be sure to fully charge your scooter's battery before your first ride.
  - b. When storing scooter during cold months, store a climate controlled environment to avoid battery damage.
2. Storage and daily care
  - a. Do not store your scooter in direct sun or in a damp area.
  - b. Keep your scooter clean of dirt and debris build-up, especially in brake and motor areas.

## Adjusting the Stem Height

**It is extremely important to make sure the fastening clasp is extremely tight before riding the D4+ 4.0 Electric Scooter.**



To adjust the stem height:

1. Pull the fastening clasp outwards so the clasp is open.
2. Loosen the fastening clasp counterclockwise.
3. Gently press the silver button to adjust the stem up or down as desired. (There are 3 heights to choose from).
4. Once adjusted to desired height, tighten the fastening clasp clockwise and push back into the stem so it is snug and tight.

# Troubleshooting common errors

## **1. Display appears black.**

- a. The display may overheat from direct sunlight.
- b. Place the scooter in the dark for a while and try again in 30 minutes.

## **2. Display does not show an accurate reading.**

- a. Parameters may be set incorrectly.
- b. Try resetting options.

## **3. Display appears opaque or shows discontinuous values.**

- a. Maybe due to a poor contact connection or low battery.
- b. Restart your scooter or contact RoadRunner Support.

Please contact RoadRunner Support at [support@roadrunnerscooters.com](mailto:support@roadrunnerscooters.com) if you need further assistance.

# Folding the Scooter



Pull the blue safety lever down to the deck. Press the silver snap back so that the stem completely folds down as shown in picture.



Lower the stem towards the scooter deck.



When you hear a click, the stem is locked, and folding is complete.

# Unfolding the Scooter



Press the silver snap back towards deck of scooter to completely remove the black post from the upper slot.



Keep pressing the silver snap and push the stem vertical to ground.



After the stem is locked in an upright position, push the stem forward to remove pressure from the safety lever while simultaneously pushing the blue safety lever with opposite hand up towards the stem until lever is locked in place.



# Installing Steering Damper

Before you begin installing the Steering Damper, make sure we have all the necessary tools and hardware. The hardware includes the following (all included in box);

- 2x M6x1.0, 18mm long bolts
- 2x M8x1.25, 35mm long bolts
- 2x M8 spring washers
- 2x M6 washers
- 2x M8x1.25 locking nuts
- 1x long threaded dowel
- 1x shorter threaded dowel
- 1x steering damper
- 1x steering damper clamp



For tools, you will need the following:

- 1x 5mm allen wrench
- 1x 6mm allen wrench
- 1x 13mm socket wrench (adjustable spanner works too, it is just more time consuming)
- Blue Thread Locker (optional)





1. Begin by moving the safety lever into its lowered position.



2. If you are using thread locker, apply now to the 2x M5 bolts. You will only need a little bit to get the job done.

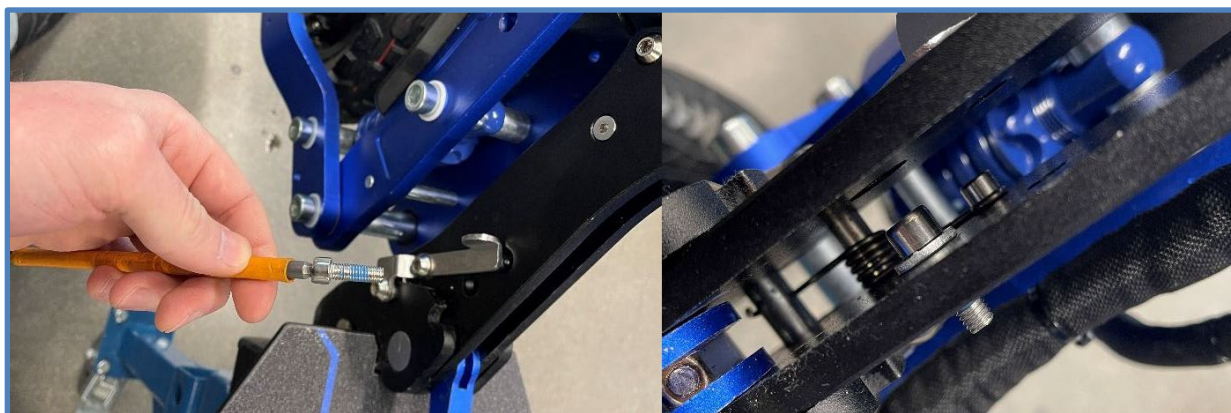

3. Use the 5mm allen to hold the M5 bolt and put it through the lefthand hold on the neck of the scooter. At the same time, use your fingers on your right hand to place the washer on the other side of the lefthand side of the neck.

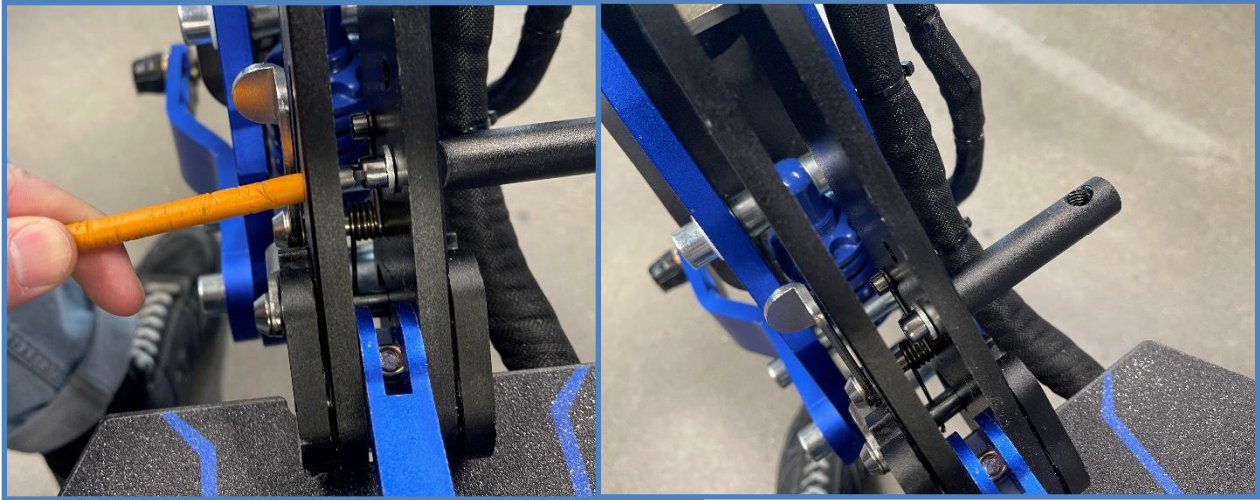

4. Use your fingers to thread the larger dowel onto the end of the bolt. You will want to leave it slightly loose. It may help to use the 5mm allen as a counter-torque for the bolt.

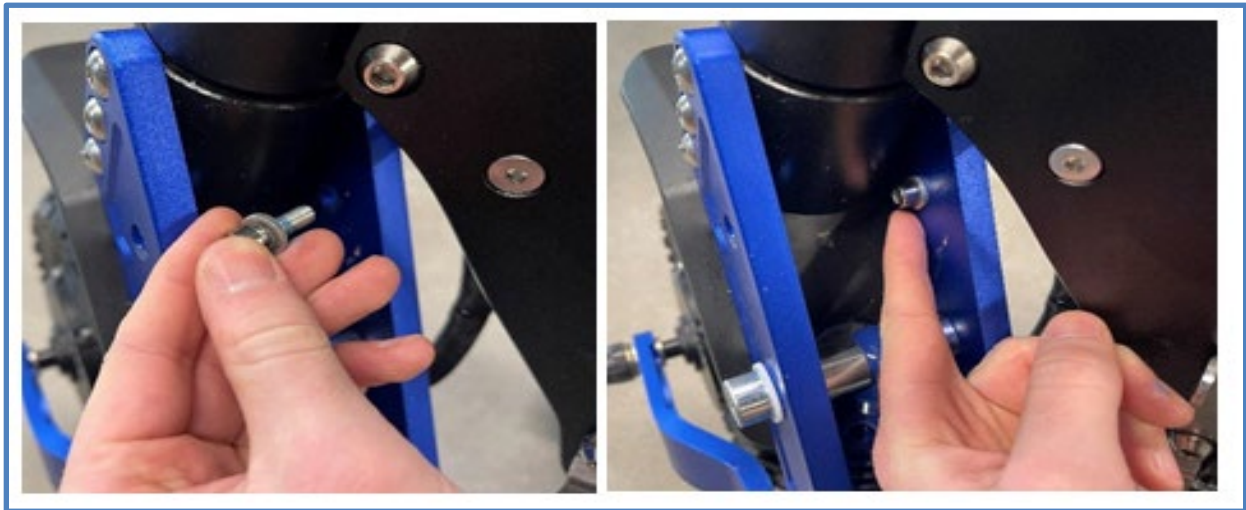

5. Now do the front dowel. The process is very similar, and should be a bit easier. Start by placing the washer onto the M5 bolt, and place it through the hole on the righthand side of the blue arm. Then hand tighten the dowel onto the other end of the M5 bolt. **Remember: do not tighten all the way yet.**



6. It is best to have both holes facing vertically as seen above.



7. Now slide the clamp onto the steering damper. Don't tighten the clamp down just yet. The damper is oriented in the below photo exactly how we want it on the scooter (lefthand side is the front, righthand side is the rear)

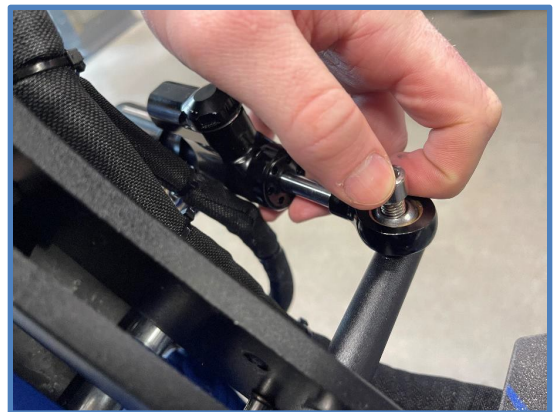

8. Place the eyelet above the rear (larger) dowel hole and start threading the M8 bolt through the eyelet in the damper and into the dowel. Once you can no longer tighten it with your fingers, use the 6mm allen to tighten down the rest of the way.



9. Repeat step 8 using the eyelet available on the clamp.



10. Place the M8 spring washer onto the underside of the M8 bolt, then start threading the M8 locking nut onto the bolt (following the spring washer).



11. Use the 13mm socket (or adjustable spanner) to tighten the bolt onto the underside of the nut. Repeat this step for both M8 bolts on either eyelet. Use the 6mm allen as a counter torque.



12. Now position everything so it is possible to turn the steering equal amounts in either direction. Start by adjusting the damper along the length of the rod so that there is an equal amount of silver rod on either side.

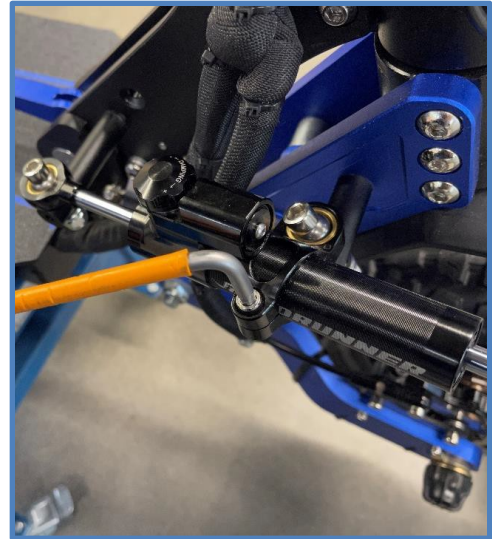

13. Tighten down the 5mm bolt on the clamp using a 5mm allen.



14. Finally, use the 5mm allen to tighten down the two M5 bolts. This is the last step. Please contact RoadRunner Scooters if you have any questions!

# How to Carry Your Scooter

When folded up, your scooter can be carried with one or two hands.

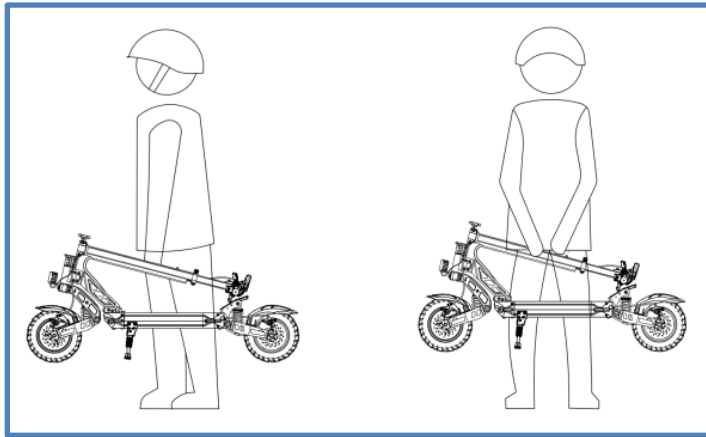

## Warranty Policy

The RoadRunner D4+ 4.0 Scooter comes with a one-year limited warranty. For full warranty information scan this QR code with your camera phone or visit our website at: <https://roadrunnerscooters.com/pages/warranty-policy-1>



Words are trademarks or registered trademarks of RoadRunner Scooters, LLC. Other companies mentioned, products or service names may be trademarks or registered trademarks of their respective owners.

This enterprise belongs to RoadRunner Scooters, LLC all rights reserved.

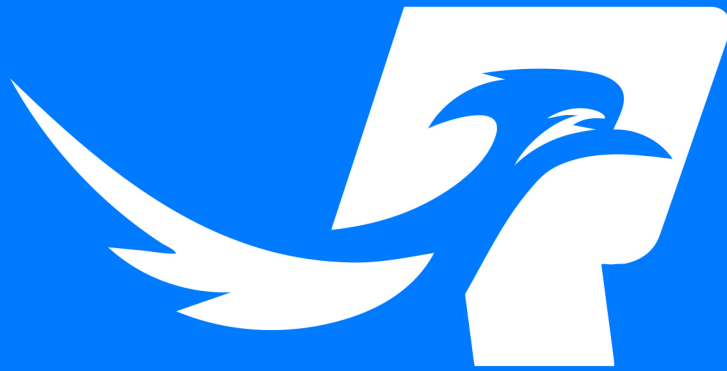

## Contact Us

Phone - (720) 664-4456

Email - [SUPPORT@ROADRUNNERSCOOTERS.COM](mailto:SUPPORT@ROADRUNNERSCOOTERS.COM)

Address - 2337 ARAPAHOE ST, SUITE 105 DENVER, CO 80205