

# NANROBOT D5+

PLEASE READ THIS INSTRUCTION CAREFULLY  
AND USE THE MACHINE CORRECTLY!

# USER MANUAL V2.0



**NANROBOT**®

OFFICIAL SITE: [WWW.NANROBOT.COM](http://WWW.NANROBOT.COM)

AFTER SERVICE EMAIL: [SUPPORT@NANROBOT.COM](mailto:SUPPORT@NANROBOT.COM)

BUSSINESS EMAIL: [STRIDEPower@NANROBOT.COM](mailto:STRIDEPower@NANROBOT.COM)

[NANROBOTSCOOTERS@GMAIL.COM](mailto:NANROBOTSCOOTERS@GMAIL.COM)

# NANROBOT



# CONTENT

<b>Warning</b> .....	2
<b>Safety Precautions</b> .....	3
<b>Electric Scooter Parameter</b> .....	4
<b>Electric scooter Components</b> .....	5
<b>Check Each Part After Unpacking</b> .....	6
<b>Unpacking Inspection</b> .....	7
<b>Pole Folding Operation</b> .....	9
<b>Pole Unfolding Operation</b> .....	10
<b>Rod High Telescopic Operation</b> .....	11
<b>Handle Bar Folding Operation</b> .....	12
<b>Charging</b> .....	13
<b>Power Turn on/off</b> .....	14
<b>Control Panel Instructions</b> .....	15
<b>Parameter Settings</b> .....	16
<b>Common Faults And Solutions</b> .....	17
<b>Maintenance</b> .....	18
<b>After Sales</b> .....	19
<b>Warranty Guarantee</b> .....	20

**INSPECTION BEFORE RIDING****WARNING!**

Inspection before riding should be carried out.

**CHECK THE SCOOTER BEFORE RIDING****CHECK THE SCOOTER BEFORE RIDING**

1. Make sure the control panel can be turned on.
2. Make sure the brake handle working properly.
3. Make sure the front of the scooter is stable.
4. Make sure the seat is stable.
5. Make sure the horn working properly.
6. Check the brake pads.
7. Make sure the rear blinker working properly.
8. Make sure the single and dual drive switch normally.
9. Make sure the Eco and turbo mode switch normally.
10. Make sure the alarm working properly.
11. Make sure the voltage value is within the normal voltage range (43V-58.8V).
12. Make sure the folding mechanism normal.



## SAFETY PRECAUTIONS

### SAFETY PRECAUTIONS

1. Be sure wear helmet, knee pads and elbow pads when riding.
2. The first ride uses low speed, then slowly to high speed after skilled use.
3. It is not allowed to ride on rainy days.
4. Do not allow to ride into the puddle.
5. Children under the age of 16 are prohibited from riding.
6. Check if the brakes are normal.
7. Please drive at low speed when going downhill.
8. Obey the traffic rules.
9. The handlebar adjusted to an appropriate position.
10. Check if the screws are loose and fasten.



**PARAMETER**

**ELECTRIC SCOOTER P****A****R****A****M****E****T****E****R**

**NANROBOT D5+ PARAMETER**

NET WEIGHT	70LBS
SIZE	48.8*48.8*23.6 INCH
CHARGING TIME	10-12H
WHEEL DIAMETER	10 INCH
RANGE	45-50 MILES
MAXIMUM SPEED	34-40 MPH
LOAD CAPACITY	MAX 330LBS
LITHIUM BATTERY	52V 26AH
MOTOR	2000W





SCOOTER COMPONENTS

ELECTRIC SCOOTER COMPONENTS





## CHECK EACH PART AFTER UNPACKING

### CHECK THE VARIOUS PARTS OF THE SCOOTER AFTER UNPACKING

### SCOOTER AFTER UNPACKING CHECK THE VARIOUS PARTS OF THE

1. Check if there is a tool kit.
2. Check if there is a charger.
3. Check if there is a voltage lock key.
4. Check if there are two alarm remote controller.
5. Check if the meter is locked.
6. Seat installation (if available).
7. Make sure the brake normal.

### PACKING LIST







**UNPACKING INSPECTION**

# UNPACKING INSPECTION

Inspection Of Each Component After Unboxing



Check whether the LCD control panel is locked and fasten as the picture show



Check whether the voltage lock is locked and fasten as the picture show



Check whether the brake handlebar is locked and fasten as the picture show



Check whether Light/Horn Button is locked and fasten as the picture show



**UNPACKING INSPECTION**

# UNPACKING INSPECTION

Inspection Of Each Component After Unboxing



Check whether the ECO Button is locked and fasten as the picture show



Adjust the brake callipers as the picture show



Mount the seat base



Place the seat in the seat tube



## FOIDING OPERATION

# POLE FOLDING OPERATION

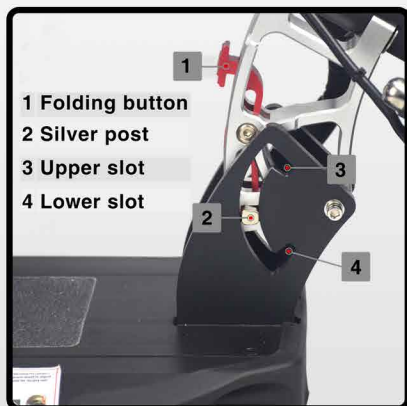

Cognitive folding unit



① Keep holding the brakes with both hands, push handlebars forward press the red folding button by foot so that the silver post completely leaves the upper slot



② When the silver post completely leaves the upper slot, lower the pole in the direction of the arrow



③ When the silver post is caught in the lower slot, the folding is completed.



## UNFOLDING OPERATION

### POLE UNFOLDING OPERATION



① Find the red folding button



② Keep pressing the red folding button so that the silver post completely leave the lower slot



③ Push back the pole in the direction of the arrow



④ When the silver post is caught in the upper slot, the unfolding is completed



## ROD HIGH TELESCOPIC OPERATION

# ROD HIGH TELESCOPIC OPERATION



① Push the fastening buckle in the direction of the arrow



② Loosen the fastening clip in the direction of the arrow



③ Adjust the pole up or down as you wish



④ Tighten the fastening buckle and turn it back in the direction of the arrow.



## HANDLE BAR FOLDING OPERATION

# HANDLE BAR FOLDING OPERATION



① Find the two folding sleeves on the handlebar



② Push the folding sleeve in the direction of the arrow



③ Fold the handle in the direction of the arrow



④ Complete the folding





## CHARGING

# CHARGING

1. First insert aviation head to the charging port
2. Insert in socket

**NOTE: The red light is charging ,and the green light means charging is finished**

## INTRODUCTION OF HANDLEBAR SECTION

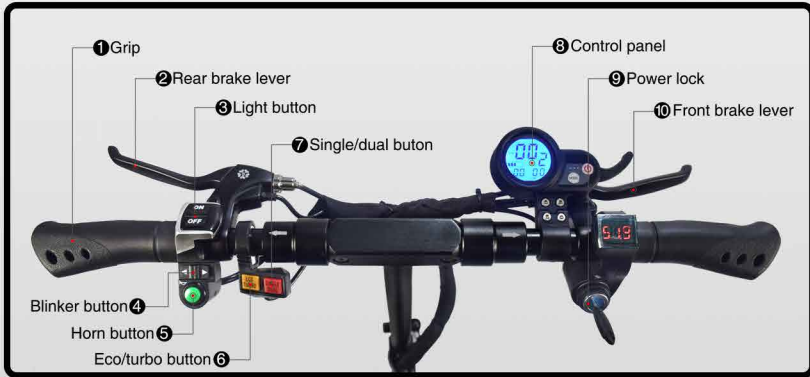

Lcd Control Panel



Light Button



Voltage Lock



Blinker Button  
Horn Button



Eco/Turbo: Switch  
Low/High Speed



Single/Dual:  
Switch Single  
/Double Drive

 **POWER TURN ON/OFF**

## POWER TURN ON/OFF

① Insert the key into the voltage lock and open the working mode. ② Press power button for 3 seconds until the power is turned on. Turn the voltage lock off directly, or turn it off by pressing the meter power 3 seconds.

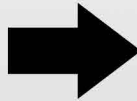

## ALARM REMOTE CONTROLLER



Turn on the Alarm mode, moving the scooter will trigger an alarm



Disable the Alarm



Make an alarm continuously to help you find your scooter



Reserved button



**Warning:** Do not rely on Alarm Mode to protect D5+ from all possible theft threats. While it may help deter some theft threats, no Alarm system can prevent all theft.





## CONTROL PANEL INSTRUCTIONS

# CONTROL PANEL INSTRUCTIONS



**Power:** power button (long press for 3 seconds)

**Gear:** current gear speed( gear:1, 2, 3 )

**Switch Gears:** Short press the power (  ) the current gear will flash then short press the (  ) key to change the gear position, 1 is slow speed, 2 is medium speed, and 3 is high speed.

**Speed:** current speed

**Speed Unit:** metric unit / imperial unit



**Battery Voltage:** current battery capacity

**Riding Time:** current duration of riding time

**MODE:** setting parameter button

**Accelerator:** E-gas

### NOTE

1. After the instrument is turned on, if there is no signal input for a long time (3 minutes), the meter will automatically turn off the power.
2. Short press the POWER (  ) button to change the display content of the instrument. TRIP, ODO, VOL, etc. appear respectively. When 00:00 is displayed, the time is displayed. When TRIP is displayed, it indicates a single mileage. When ODO is displayed, it indicates the accumulated mileage. When the VOL is displayed, the battery is displayed.
3. Long press the MODE (  ) key to clear the single mileage (under the TRIP interface).



**PARAMETER SETTINGS**

# PARAMETER SETTINGS

Press and hold both POWER( )and MODE( ) at the same time to access to the settings. Short press MODE to change parameter items and short press POWER to select the parameter item you want to change. Then press MODE to advance(1) or press POWER to decrease(0). Desired setting will be set after about 3 seconds.

**Note: Please keep the default values of the parameter settings, please do not change them at will. (P9 is an electronic brake can be adjusted, 0 is no electronic brake, 1 is weaker for electronic brakes, 2 is stronger for electronic brakes)**

## FOR EXAMPLE



### How to unale EBS ( Electric Braking System )

Press and hold both POWER( )and MODE( )at the same time to access to the settings,and short press MODE till it is P9 .Then short press POWER to select P9,then short press POWER or MODE TO change it to 0. so it's no EBS.

**Press MODE to move on to the next setting from P0 to P9**

P0	Wheel diameter in inches,do not change it at will.	Default=10
P1	Voltage cut off.When the voltage drops to 43.0V,undervoltage protection will be started and the power supply will be cut off automatically.	Default=430
P2	Magnetic poles in hub motor. do not change it at will.	Default=10
P3	Speed sensor function. do not change it at will.	Default=0
P4	Speedometer in kilometer or mile.	0=Km/h 1=M/h Default=0



## PARAMETER SETTINGS

P5	Non-kick start / Kick start	0=Non-kick start 1=Kick Start Default=0
P6	Turn on / off constant speed cruise	0=Non-cruising 1=Cruising Default=0
P7	Power start / Normal start	0=Power start 1=Normal start Default=0
P8	Power adjustment percent. 100mean full power.	From 0-100 Default=100
P9	Electronic brake strength value.	0 is no electronic brake. 1 is weaker for electronic brakes.2 is stronger for electronic brakes. Default=0.
P10	Function to be determined.	Reserved function

## COMMON FAULTS AND SOLUTIONS

Symptom: The light can be on, the speaker can sound and scooter cannot be turned on. Generally it is a control panel problem, you can replace a control panel.

Symptom: The scooter can't not be charged ,please check the charging port.If the charging port was burning out , replace the charging port on the scooter.If not, and the indicator light of the charger always shows green, Generally the charger is damaged. Replace the charger.

Fault phenomenon: the brake pads have abnormal sound generally, the brake pads are stuck and can be adjusted with tools.





## MAINTENANCE

1. It should be regularly maintained and checked the screws that need to be tightened. The emphasis on the folding mechanism, brake system, motor where the screws need to be checked is tightened.

- (1) Tighten the screws in the folding mechanism
- (2) Tighten the screws in front bars
- (3) Tighten the screws in front shock absorber
- (4) Tighten the screws in rear shock absorber
- (5) Tighten the screws in front motor
- (6) Tighten the screws in rear motor

2. Brake: if you find rust or excessive wear, replace it in time. If it cannot be used, you should check the brake disc and Legend Film, Replace them in time.

3. Motor: Check whether the motor wire is bare, Wrap all the exposed wires with electrical tape until the wires are safely covered.

### 4. Tires

- (1) Do not inflate above normal air pressure
- (2) The tires will slide and move easily on the wet situation. After it dry, you can lubricate the axle.
- (3) Do not lubricate the tires and rims.
- (4) After using the tire for a long time, please replace the tire, which will prolong the use of the scooter.





**AFTER SALE**

**AFTER SALE**

**ABOUT ASSEMBLY**

95% of scooter manufactured by NANROBOT are assembled, some of the parts may require assemble by our customers. For safe drive, please check and test everything before you go on a trip departure. After inspection and adjustment .If there is any issue, please contact your seller.If you don't have experience in assembly, the nanrobot scooter could help you do it.

**DAMAGE AND SCRATCHES**

To avoid damage, NANROBOT manufactures packed all electric scooter in foam and cardboard. If there is something broken,please take some photos of these parts and send the person who is in charge of your purchase, they will offer you the solution. If you have scratches, apply paint.

**ADJUSTMENT OF LCD CONTROL PANEL**

Although the lcd control panel was installed, it may also be damaged during shipping. Please send picture to us for new replacements. Summer season may lead to flat tire. Please be careful. It is necessary to check the tires before putting the air in the tire.

- (1) Please push the tire and check the condition of the air.
- (2) Because of high temperature, there is thermal expansion, tire will tend to flat regardless of quality.

**About Configurations**

Due to mass production and different batches, please understand that the item may not be the same as the pictures in the brochure, but we guarantee that the changed parts will be updated.

**MAN-MADE DAMAGE**

If it is man-made damage, you can buy replacement at [www.nanrobot.com](http://www.nanrobot.com), or you can buy the replacement at the distributor you buy, or you can send the scooter to the after sale address for repair, the cost of repair is borne by the buyer.If there are other after-sales problems, you can send an email to [support@nanrobot.com](mailto:support@nanrobot.com).



## WARRANTY GUARANTEE

### **WARRANTY GUARANTEE**

We have warranty and provide after-sale customer service for our products. If the product have any quality issue, please feel free to contact us, we will offer professional instructions and solutions timely.

For the entire scooter, vulnerable parts like tires, brake discs, horn, dash board, light etc. are within the warranty of 90 days. Battery and controllers are within the range of 180 days. The frame is within 365 days repair warranty. If the problem is caused by non-human factors, we will provide new replacements for free.

We are not responsible for wrong return and refund loss, the buyer should be responsible for more than 20% return charge, and double-way transportation charge.

The scooter which we sell are brand new products, all parts are the same as the original parts.

Customized orders may not be returned unless it has big issues that are cause by our company. Customers returning goods are responsible for freight charges. If the returned goods affect the second sale, our company charge a certain amount of fees.

### **EXCHANGES ( IF APPLICABLE )**

We only replace items if they are defective or damaged. If you need to exchange it for the same item, send us an email at [support@nanrobot.com](mailto:support@nanrobot.com).

**NANROBOT**

