

AC-Powered LED Light Bar Series

Line Voltage, TRIAC Dimmable & Linkable



CLEANLIFE® LED



FEATURES

- 120V, TRIAC Dimmable from 100% - 10%
- Driver On Board, No External Driver Needed
- Frosted Cover, Engineered to eliminate "dark spots"
- Long Lifetime, L70 >50,000 hours
- Linkable, No Voltage Drop (AC Powered)
- Pressure clips and double sided tape for easy installation
- Hard wire and plug-in configurations available
- UL Damp Listed, RoHS & FCC Compliant
- 5-Year Manufacturer's Limited Warranty



SPECIFICATIONS



5-Year Limited Warranty

Dimensions See Table

Operating Temp. -4°F~+105°F

Efficacy 400 Lumens/Foot

Beam Angle 120°

Application Indoor

Color Temperature



Installation

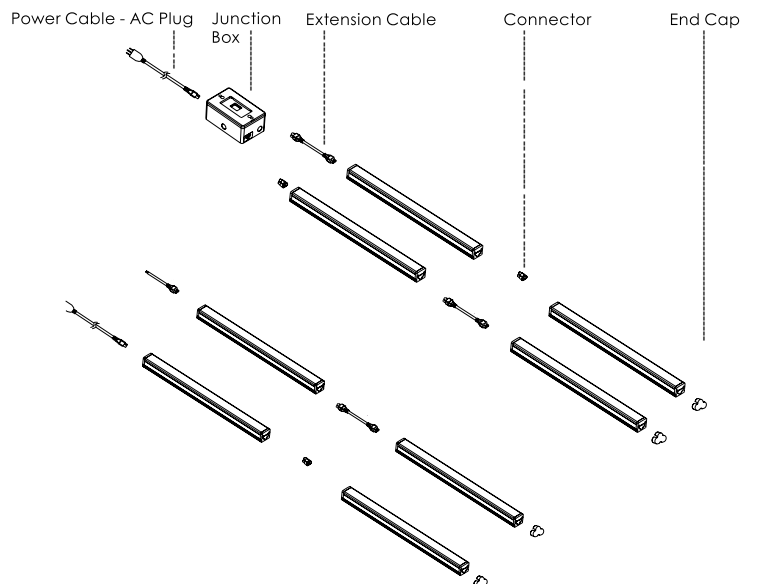

APPLICATION INFORMATION

Applications

- Indoor Signage
- General Cove Lighting
- Accent and Indirect Lighting
- Wall Washing
- Retail Display
- Kitchen, Under Cabinet, Toe Kick

Market Segments

- Residential
- Signage
- Hospitality
- Retail



Linkable



Easy to Install



Energy Saving



CLEANLIFE® LED

AC-Powered Light Bar Dimensions

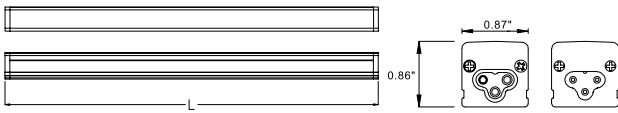

Project/Job	Notes
Date	
Comments	
Prepared by	

Ordering Information

Part Number	Length (IN)	Color Temperature	Average Rated Life (hrs.)	Input Voltage (V)	Rated Power (W)	Typical Lumens (lm) (±10%)	Nominal Lumens Per Watt (±3%)	CRI
CL-PNP-120F27-4W8DN	8	2700K	L70>50,000	120	4	280	71	80
CL-PNP-120F30-4W8DN	8	3000K	L70>50,000	120	4	280	71	80
CL-PNP-120F27-6W12DN	12	2700K	L70>50,000	120	6	460	77	80
CL-PNP-120F30-6W12DN	12	3000K	L70>50,000	120	6	460	77	80
CL-PNP-120F27-9W18DN	18	2700K	L70>50,000	120	9	550	61	80
CL-PNP-120F30-9W18DN	18	3000K	L70>50,000	120	9	550	61	80
CL-PNP-120F27-12W24DN	24	2700K	L70>50,000	120	12	850	71	80
CL-PNP-120F30-12W24DN	24	3000K	L70>50,000	120	12	850	71	80
CL-PNP-120F27-15W30DN	30	2700K	L70>50,000	120	15	950	63	80
CL-PNP-120F30-15W30DN	30	3000K	L70>50,000	120	15	950	63	80
CL-PNP-120F27-18W36DN	36	2700K	L70>50,000	120	18	1100	61	80
CL-PNP-120F30-18W36DN	36	3000K	L70>50,000	120	18	1100	61	80
CL-PNP-120F27-24W48DN	48	2700K	L70>50,000	120	24	1550	65	80
CL-PNP-120F30-24W48DN	48	3000K	L70>50,000	120	24	1550	65	80

Accessories

CABLES (7in Power Cable - Bare Wire included, all others sold separately)



Power Cables - Bare Wire
7in: CL-PNP-PC1-178 (Included)
24in: CL-PNP-PC1-610
70in: CL-PNP-PC1-1778
96in: CL-PNP-PC1-2438



Extension Cables
4in: CL-PNP-EC1-102
12in: CL-PNP-EC1-305
48in: CL-PNP-EC1-1219



Extension Cable - Bare Wire
70in: CL-PNP-EC2-1778

CONNECTORS



2 x Connectors (Included)
 CL-PNP-CN-01
2 x End Caps (Included)
 CL-PNP-CN-02

BRACKET KIT



2 x Clips (Included)
2 x Screws (Included)
 CL-PNP-BR-K-01



Power Cable - AC Plug
48in: CL-PNP-PC2-1219



Power Cable with Switch
65in: CL-PNP-PCS1-1651

Dimming

Junction Box works with LED Dimmers

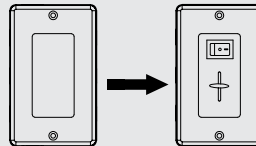

APPROVED DIMMING MODELS

- Lutron** S-600PR-WH
- Lutron** TGCL-153PH-WH
- Lutron** MACL-153MH-LA
- Leviton** WA-RXX-06674-12A

JUNCTION BOX



CL-PNP-JN-A
 • 5A Max
 • Dimensions: 2.76"L x 4.5"W x 1.56"H

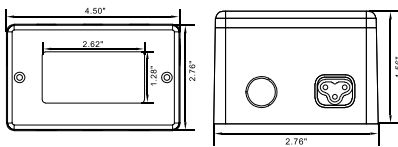

JUNCTION BOX WITH SWITCH (switch included)



CL-PNP-JN-B
 • 5A Max
 • Dimensions: 2.76"L x 4.5"W x 1.56"H

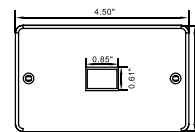

CL-PNP-JN-C
 • 5A Max
 • Dimensions: 2.08"L x 4.05"W x 1.2"H

