

# *Frigid Fluid*

COMPANY

PROUD MANUFACTURERS OF FUNERAL  
AND CEMETERY SUPPLIES  
SINCE 1892



Product featured on page 40



Product featured on page 8



Product featured on page 22

# FRIGID FLUID®

PROUD MANUFACTURERS OF FUNERAL AND CEMETERY SUPPLIES SINCE 1892.



11631 W. Grand Ave Northlake, IL 60164 USA

Phone: +1-708-836-1215 | Toll-Free: 1-800-621-4719 (US only) | Fax: +1-708-836-1247 | Email: [sales@frigidfluid.com](mailto:sales@frigidfluid.com)

FRIGID FLUID®

TIMELINE	4	POINTS, HOSES, & ASPIRATORS	25	IMERIAL CASKET LOWERING DEVICE	40
THE POWER OF SILITECH	6	ARTERIAL TUBES	26	MASTER CASKET LOWERING DEVICE	41
36 PLUS	8	DRAINS, ADAPTERS, & NEEDLES	27	INFANT/URN LOWERING DEVICE	42
SILITECH FLUIDS	9	FORCEPS & SCISSORS	28	STREAMLINER MOBILE STAND	43
ARTERIAL FLUIDS	10	SCISSORS & INJECTORS	29	LOWERING DEVICE ACCESSORIES	44
CAVITY FLUIDS	11	PROTECTIVE COVERS	30	LOWERING DEVICE STRAPS	46
JAUNDICE FLUIDS	12	PROTECTIVE MASKS	31	CEMETERY ACCESSORIES	47
CO-INJECTION FLUIDS	13	PLASTIC GARMENTS	32	CEMETERY EQUIPMENT & GRASS	48
SUPPLEMENTALS	14	GLOVES	33	CEMETERY TENTS	49
PREP ROOM SUPPLIES	18	BODY BAG & POUCHES	34	CEMETERY MARKERS	50
COSMETICS	20	STRETCHERS & COTS	35	CEMETERY VASES	51
EMBALMING MACHINE	22	FUNERAL ACCS. & BODY POSITIONING	36	DEVICE REPLACEMENT PARTS	52
EMBALMING MACH. INSTRUMENTS	23	BODY TRANSPORTATION	37	SERVICE & REPAIR	55
TROCARS, POINTS, HOSES	24	INTRO TO CEMETERY	38		

IT'S QUICK AND EASY. ORDER AT  
**WWW.FRIGIDFLUID.COM**

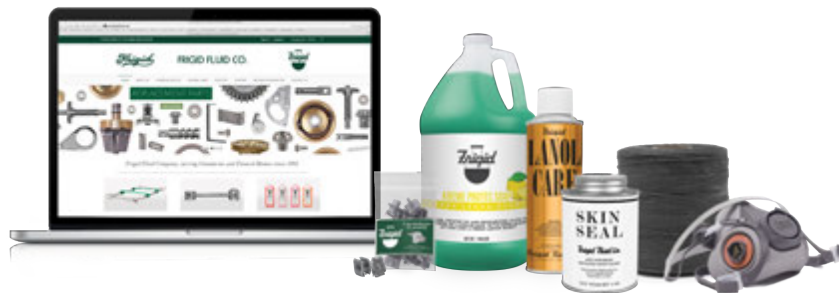

Visit Our Website ▶

Pay with credit card or on account and we will bill you.

A BRIEF HISTORY OF

*Frigid Fluid*  
COMPANY



Frigid is born when **Adelbert R. Krum** starts the business under the name of **Chicago Chemical & Manufacturing Co.** Operating out of a 14 x 14 barn, he made and marketed an embalming fluid to which he gave the trade name "Frigid."



**Incorporation** of Frigid Fluid in the State of Illinois.



President **Jennie M. Krum** is known as an innovator in the funeral home industry. She increases business and expands the product line.



Invention & Patent of the **"Master"** model lowering device.

Invention & Patent of the **"Imperial"** model lowering device.

1892

1901

1902

1914

1917

1945

1949

1955



**Frigid Fluid Company** officially replaces Chicago Chemical & Manufacturing Co. as the name of the firm to coincide with the **"Frigid"** trade name.

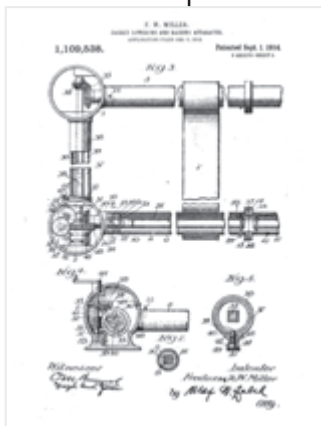

**US patent 1109538** awarded to Frigid Fluid for the invention of the casket lowering device



**President Franklin D. Roosevelt** is buried using the Frigid **"Standard"** Lowering Device.

# Age has its advantages...

**Especially for a business focused on personal relationships.**

Founded in 1892, Frigid Fluid Company is one of the oldest manufacturers and suppliers to the funeral service industry. Family owned and operated through five generations for over **130 years**, Frigid Fluid has the experience and ability to provide their customers with superior products and dependable service.



Invention & Patent of the mobile lowering device stand known as the **"Streamliner."**



5th Generation of the Family takes helm with **Brian Yeazel**, President



Frigid helps modernize the industry with the release of the **Frigid Embalming Machine**

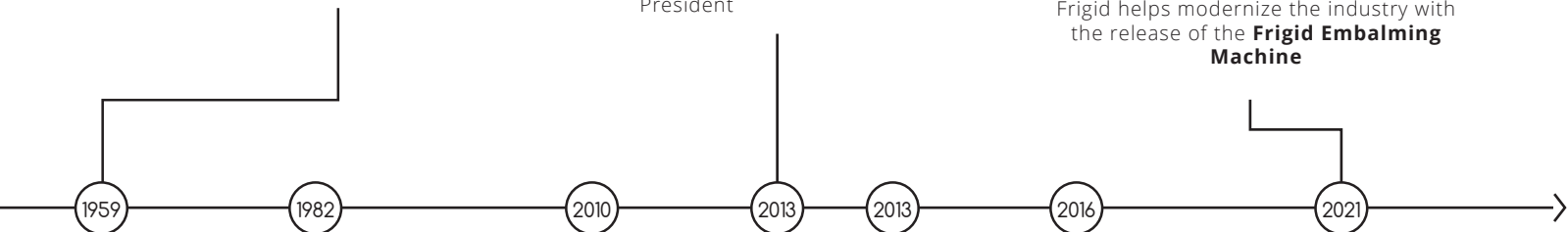

Development & Introduction of the **"Premium"** line of embalming fluids: Premium Cavity and Premium Jaundice.



Development & Introduction of the Frigid **"Silicone Technology"** line of embalming fluids: 36 Plus, Perfect Tone, Natural Tone and X-20.



**"Silitech"** trademark awarded to Frigid Fluid for its top-selling line of "Silicone Technology" embalming fluids.



Frigid attains **'CE' certification** on its world-class line of casket lowering devices

THE POWER OF

**SILITECH**<sup>®</sup>  
FRIGID SILICONE TECHNOLOGY

## SILITECH EMBALMING ADVANTAGES

Silicone lubricates the arterial system to help distribute formaldehyde deeply into the capillaries, thus promoting:

- Deeper Diffusion
- Wider Profusion
- Enhanced Saturation
- Superior Periphery Preservation

## THE BENEFITS OF SILICONE

**Silicone is extremely stable:**

- Able to withstand extremes of heat and cold.
- Acts as an insulator to protect the formaldehyde and other chemicals within the embalming solutions.
- Unaffected by aldehydes, alcohol, lanolin and other embalming chemicals.

**Silicone is very non-reactive:**

- Does not dehydrate
- Colored dye remains stable in the presence of silicone.



**DANGER:** Extremely flammable liquid or in contact with skin. Fatal if inhaled and serious eye damage. May cause cancer. Causes damage to organs before use. Do not handle until label is read and understood. Keep away from flames/hot surfaces. No smoking. Use explosion-proof electrical/ventilation non-sparking tools. Take precautionary discharge. Keep container tightly sealed. Do not eat, drink or smoke while handling. Do not breathe mist/vapor from mouth. Do not breathe mist/vapor in a well-ventilated area. Wear appropriate



## NO SHIPPING HAZMAT FEES

Frigid Fluid's arterial and cavity fluids are classified as a limited hazard during transport under current US shipping specifications. These fluids can be shipped by common carrier under the classification ORM-D. This reduces freight costs and does not require the imposition of a hazmat fee by the freight company.

## PHENOL-FREE FLUIDS\*

Frigid Fluid's embalming products are totally free of phenol. Phenol is a hazmat classified chemical that is highly toxic and known to cause lung irritation.

**\*ONLY Pharos Cavity contains phenol**

## LIMITED HAZMAT FEE PRODUCTS

Only these supplemental products incur a hazmat fee:

- STOP
- Safe Powder (25 lb. container)
- Feature Builder (only applies to 1 gallon size)
- Pharos Cavity

## SDS DOCUMENTS

Our Safety Data Sheets can be obtained from the support section of our website - [www.frigidfluid.com](http://www.frigidfluid.com).

liquid and vapor. Toxic if swallowed inhaled. Causes severe skin burns and eye damage. May cause an allergic skin reaction. May irritate the respiratory system. Obtain special instructions before use. All safety precautions have been taken. Keep away from heat/sparks/open flames. Keep container tightly closed. Use only in well-ventilated areas. Use only with proper lighting/equipment. Use only with appropriate protective measures against static electricity. Wash thoroughly after use. Do not breathe dust when using this product. Rinse thoroughly with water. Do not use on clothing. Use only outdoors or in well-ventilated areas. Use only with protective eye/face/gloves/clothing

# SILICONE BASED ARTERIAL FLUID

Frigid Fluid's "Silicone Technology" enhances the results you can attain with arterial fluids. The silicone advantage is delivered through a family of four arterial fluids.



**SILITECH**<sup>®</sup>  
FRIGID SILICONE TECHNOLOGY

## 36 PLUS<sup>®</sup> (33 INDEX)

1-36PL (24 case of 16 oz / 473 ml bottles)

### Our Best Selling Fluid.

36 PLUS<sup>®</sup> assures preservation and pleasing results with both normal and difficult cases.

It is particularly effective on frozen, decomposed and other challenging cases.

### The formulation combines:

- The lubricating, diffusing and penetrating advantages of Silicone.
- The addition of "Frigid STOP" to prevent the causes of tissue gas (Clostridium Prefringens).
- A water conditioner to neutralize calcium ions and soften hard water.
- A drainage enhancer.
- Use as a base solution chemical or an additive
- Mixes well with any arterial, from any manufacturer

### Resulting in a body that:

- Retains moisture and color for a very natural appearance.
- Is free of tissue burn and "pruning"

**Note:** 36 PLUS<sup>®</sup> is not recommended for a prep room attached to a septic system for which we recommend lanolin-based Tissue Guard 32.



## PERFECT TONE (18 index)

1-PERFTONE (24 case of 16 oz / 473 ml bottles)



### A lower index fluid that offers:

- Perfect for decedents with a cooler undertone to their skin and need enhanced hydration.
- Has all the distribution advantages of silicone.
- Provides all the softening effects of lanolin.
- Results in a pliable, smooth, life-like appearance.
- Works great as a companion arterial fluid alongside a higher index fluid because of these softening effects.
- Thorough, non-blotchy coloring of active dyes.
- A medium firm texture.
- No dehydration risk.



## NATURAL TONE (20 index)

1-NATTON (24 case of 16 oz / 473 ml bottles)



### Silicone Technology combined with:

- Mild but very effective buffers.
- The addition of humectants.
- A cosmetic effect that furnishes a uniform, life-like texture and color to the skin with a natural feel that is soft and smooth.
- Formulated for decedents with a naturally warm undertone.
- Mixes great with 36 Plus for normal cases.



## X-20 (20 index)

1-X20 (24 case of 16 oz / 473 ml bottles)



### A blend of six ingredients:

- Including the highest silicone content.
- For a thoroughly embalmed body of mild firmness.
- Displaying a natural, soft, feel to the skin.
- That has uniformity of color with a slightly pinkish tint.
- Especially effective on emaciated cases to help prevent dehydration.
- Works well with decedents with a naturally cool undertone.
- Pairs well with higher index fluids such as Frigid Standard or Frigid Rigid to provide extra moisturization.



## HUMECTANT (Supplemental fluid)

1-HUMECT (12 case of 16 oz / 473 ml bottles)



- Co-injection for cases showing signs of dehydration.
- An emulsion of several special oils and moisturizing agents that help to return sallow tissue to a life-like appearance with an excellent cosmetic skin texture and body pliability.
- Wrinkling is controlled and a proper moisture level is restored.
- The moisture loving ingredients of humectants work to prevent further dehydration by delaying the escape of water from surface tissues while restoring the moisture level in deeper tissues.
- In addition to its ability to rehydrate tissue, Humectant modifies the harsh action of formaldehyde and softens the color of the dyes used in arterial fluids.
- Can be used on both embalmed and unembalmed bodies. Making it a versatile supplemental fluid that can be used on bodies for natural burial.





**LANOL-TEX (22 index)**

- The Frigid arterial fluid with the highest level of lanolin.
- Plus two modifiers to furnish pliable tissue for a body of medium firmness.
- Ideal where soft, smooth skin texture is desired.
- Superb for dry, emaciated cases needing protection against dehydration.
- Pairs great with Frigid Rigid or other high index fluids, when moderate firmness is desired while maintaining proper moisturization.

**1-LANOLTEX**

24 case of 16 oz / 473 ml bottles

**TISSUE GUARD 32 (32 index)**

- Fantastic "Any Case" fluid. Results in a firm body that maintains a pliable feel to skin. Works even with trauma cases.
- Provides great tissue penetration, distribution and lasting moisturization.
- Effective on bodies that are beginning to exhibit early/moderate signs of decomposition.
- For use in place of "36 Plus" where the prep room is attached to a septic system.
- Incorporates a special blend of humectants and high quality dyes to give a warm, even cosmetic effect.
- Great for cases involving delayed burials or shipments.

**1-TISSG32**

24 case of 16 oz / 473 ml bottles

**FLO-TONE (25 index)**

- A unified, multi-balanced, general purpose arterial fluid for medium-firm results.
- Contains three disinfectants and three preservative agents.
- Modified to prevent dehydration, giving a soft appearance.
- Special buffers hold the pH close to the optimum for good formaldehyde action.
- A blend of dyes furnish a natural skin tone without blotching.
- Fresh odorizing scent

**1-FLOTONE**

24 case of 16 oz / 473 ml bottles



**EOTONE (27 index)**

- Mid-to-high range index for when slightly more firmness is desired.
- Contains buffers and humectants to modify the formaldehyde level.
- Results in a pleasant even, light pink skin tone coloration.
- Penetrates and adequately firms loose skin on obese decedents.
- Evenly distributed coloring on lips, jaws and fingertips. Pairs well with 36 Plus.
- Provides a satisfying amount of firming while still leaving skin pliable.

**1-EOTONE**

24 case of 16 oz / 473 ml bottles

**STANDARD (32 index)**

- Recommended for the most difficult cases.
- Great for use on stocky built decedents.
- Contains special salts that enhance the action of its preservative results.
- Suited for "hypo-injecting" areas of the body not receiving adequate distribution.
- Distributes well into areas of lymphedema
- Dyes don't blotch and firming is immediately detectable.
- Perfect to combine with 36 Plus on obese or autopsy cases.

**1-STANDARD**

24 case of 16 oz / 473 ml bottles

**FRIGID RIGID (35 index)**

- Perfect for trauma, delayed burial, and ship out cases where firmness is important.
- Includes a unique blend of buffers, humectants and plasticizers to lessen the harshness of formaldehyde.
- Ideal for aggressive applications, especially advanced cancer (counteracts nitrogenous waste) and decomposition cases.
- Ideal fluid if there's an extended period of time between death and final disposition.
- Can be added to an arterial solution to increase firmness.
- Frigid's highest index arterial fluid.

**1-RIGID**

24 case of 16 oz / 473 ml bottles



**PREMIUM CAVITY (7 index)**

- Low odor cavity fluid providing:
  - Excellent deep penetration.
  - Effective preservation.
  - Broad spectrum disinfection.
- Contains "Frigid STOP" to control tissue gas and vermin.
- Excellent disinfectant properties of glutaraldehyde.

**1-PREMCAV**

24 case of 16 oz / 473 ml bottles

**CAVITY 55 (8 index)**

- A low odor cavity fluid with especially good disinfection and deodorizing capability.
- Features four proven preservatives and disinfectants.
- Quickly penetrates to areas where putrefaction and odor production are taking place and stops them.

**1-CAV55**

24 case of 16 oz / 473 ml bottles

**5-PURPOSE CAVITY (8 index)**

- Preservation with disinfectants and deodorizers.
- Usable as a surface pack to quickly reach the areas of decomposition so it can act to neutralize the sources of odor and putrefaction, thereby effectively preserving the tissue.
- A much safer bleaching agent than the usual phenol-containing bleaches.
- Low formaldehyde level means the skin will not pucker when used hypodermically to preserve areas lacking distribution and firmness.

**1-5PUR**

24 case of 16 oz / 473 ml bottles



**DRY GUARD (21 index)**

- Quick action with excellent penetration and preservation resulting in tissue that is very firm and dry.
- As a surface pack, helps to firm and preserve areas of skin slip and spongy tissue.
- When used externally or just under the skin, it will help to bleach darkened areas and reduce swollen areas.

**1-DRYG**

24 case of 16 oz / 473 ml bottles

**CAVITY KING (25 index)**

- Excellent penetration and dispersion for maximum protection.
- Strong preservative power to protect against visceral putrefaction and odor.
- **Highly recommended when circulation is destroyed:**
  - Cancer, gangrenous, and ulcerated tissue.
  - Other disease damage.
  - Crushed or mutilated bodies.
  - Especially applicable for treating infant cases where arterial embalming is difficult to accomplish.

**1-CAVKING**

24 case of 16 oz / 473 ml bottles

**PHAROS (36 index)**

- Pharos cavity fluid is our highest index fluid (index 36).
- Provides rapid set-up and is extremely effective on posted cases.
- Formulated with additional organic germicides.
- Used by embalmers who prefer the exceptional tissue firmness provided by the high formaldehyde content.
- Contains phenol.

**1-PHAROS**

24 case of 16 oz / 473 ml bottles



### COLOR GUARD 1

- Primarily intended as a Jaundice Fluid
- Useful topical treatment to improve natural coloring of lips and to delay dehydration. Also works well on infant/child hands and feet.
- Intended for use with a low to moderate index arterial fluid and cool water.
- It chemically reacts with bilirubin to change its yellow coloration to a red or rosy tone.
- The yellow of jaundice can be significantly reduced, especially in visible body areas.
- Color Guard 1 does not contain preservative properties.

#### 1-COLOG I

24 case of 16 oz / 473 ml bottles

### PREMIUM JAUNDICE (8 index)

- Includes multiple agents to promote distribution throughout the body for effective flushing and bleaching of bilirubin, the pigment responsible for the yellowing tissue.
- Contains a low level of formaldehyde (8 index) so that large volumes of diluted fluid can effectively be used to flush the body.
- Counters the effect of formaldehyde on bilirubin, which many embalmers feel is the cause of "green" bodies that sometimes develop after embalming.
- Even when large volumes of diluted fluid are injected, water-logging is not a problem because of the moisture balancing chemicals.

#### 1-PREMJAUN

24 case of 16 oz / 473 ml bottles

### ROSE COLORTONE DYE

- Non-formaldehyde, concentrated dye.
- Compatible with all arterial and supplemental fluids.
- Produces a natural, long-lasting, life-like color and cosmetic effect.
- Compatible with any and all case types.
- Doesn't blotch or discolor skin tones.
- Especially effective in mucus membranes.
- Excellent for tracing your fluid throughout the embalming process.
- Most natural and apparently color results in fingernails/nail beds.

#### 1-ROSECOL

24 case of 16 oz / 473 ml bottles



### LEAK GUARD

- Specifically designed to prevent leakage of body fluids.
- Works to pull excessive moisture from the body and is an effective pore closer, a proven moisture reducer, a tissue hardener, and an effective firming agent for jaundice cases.
- To assist the preservation of the body, a powerful, non-formaldehyde disinfectant (glutaraldehyde) is included so that Leak Guard can be injected directly into tissue or used in conjunction with an arterial fluid.
- Especially applicable with badly bloated or water-logged bodies.

#### 1-LEAGK

24 case of 16 oz / 473 ml bottles

### TISSUE AID

- Formulated with natural colloids that are and especially effective moisture retainer.
- Highly recommended for emaciated and dry skin cases, when moisture loss from the body needs to be delayed.
- Fills out tissue sunken by dehydration, and embalming under very low humidity conditions.
- Tissue Aid restores the cells to the proper level of hydration resulting in recovery of a more natural appearance and form, skin that regains a soft, smooth texture, and a more natural, pliable, life-like feel to the body.

#### 1-TISSAID

24 case of 16 oz / 473 ml bottles

### FREE FLO (PRE-INJECTION)

- Improves distribution and drainage by freeing capillaries of congealing blood.
- When used with an arterial fluid, it improves the solutions ability to displace blood and allow the preservatives to do their work.
- Enhances distribution of arterial fluids, resulting in a uniformly embalmed body with even dye coloration.
- Being mildly alkaline, it buffers arterial fluid to an effective pH to reduce grey bodies.
- Special additives act to soften the potentially harsh effects of formaldehyde by retaining proper moisture.

#### 1-FREEFLO

12 case of 16 oz / 473 ml bottles



**SOLVOL (6 Index, PRE-INJECTION)**

- As a pre-injection it is excellent for a mild fluid flushing of the arterial and capillary system to allow better distribution and penetration of an arterial fluid.
- Useful as a bleaching agent, it penetrates readily into affected tissues to reduce and flush out objectionable discoloration.
- Special ingredients help prevent water-logging by promoting good drainage.
- Superior fluid for embalming infants: its low formaldehyde content, modifiers and mild formulation provide adequate preservation without harming delicate tissues.

**1-SOLVOL**  
24 case of 16 oz / 473 ml bottles

**PLASMA FLO (PRE-INJECTION)**

- For embalming bodies when congealed and clotted blood is anticipated. Clears and prepares the vascular system for optimum fluid distribution and penetration.
- Its special alkaline formula loosens and breaks up coagulated blood so that drainage can be established even in difficult cases such as burned or frozen bodies, or when extensive chemotherapy has taken place.
- As a co-injection fluid, Plasma Flo can be used with all aldehyde type arterials to enhance drainage, distribution, and penetration with a milder action by the arterial fluid.

**1-PLASFLO**  
12 case of 16 oz / 473 ml bottles

**WATER-CLOT GUARD**

- For outstanding control of hard water salts, which are frequently the cause of a blotchy appearance and fading color.
- Hard water salts work against the embalmer and the arterial fluids by:
  - Reacting with some of the dyes to reduce or eliminate their color.
  - Reacting with anionic surfactants to negate their distribution and penetration ability.
- Water/Clot Guard neutralizes calcium salts to prevent further clotting and to assist the break up of clots and congealed blood.

**1-WATCLOTG**  
24 case of 16 oz / 473 ml bottles



**STOP**

- STOP is the chemical of choice for controlling the sources of tissue gas.
- Two powerful disinfectants penetrate deeply and rapidly to the source of tissue gas.
- On contact, a small amount of STOP destroys anaerobic bacteria and kills all maggots or insects which may have infested the remains, eliminating vermin-caused embarrassment.
- A special additive provides lubrication so tissue does not dry out or become brittle.

**1-STOP**  
24 case of 16 oz / 473 ml bottles

**SPILL GUARD**

- Developed for spills of arterial and cavity fluids.
- Immediately neutralizes formaldehyde and glutaraldehyde so no harmful vapors can be produced.
- Spills can be flushed away or soaked up depending on local regulations.
- Contains no regulated chemicals and is not designed to neutralize phenols or chlorinated hydrocarbons.
- Highly recommended to have available in all prep rooms.

**1-SPILGG**  
1 gallon / 3.79 liter bottle

**ORIFICE GUARD**

- An effective surface disinfectant for pre-embalming treatment of the eyes, mouth, nose, and body
- Meets key requirements for use as a bactericidal in clean rooms or medical facilities, but also for general purposes.
- Can be applied using cloth or spray.
- Spray trigger available upon request (1-SPTRATRIG).

**1-ORIFG** 16 oz / 473 ml  
**1-ORIFGGAL** 1 gallon jug / 3.79 liter



## X-O ODOR NEUTRALIZER

- An all-natural odor neutralizer, X-O is safer than chemical alternatives.
- While some products mask unpleasant odors, X-O eliminates odors permanently.
- Spray into the air or directly onto a surface to obtain an odorless environment.

**2-XO8** 8 oz / 237 ml  
**2-XO16** 16 oz / 453 ml  
**2-XOG** 1 gallon / 3.79 liters

## VELVA CREAM WITH ANTISEPTIC

- Used externally to retain moisture in the skin, giving it a smooth, velvety texture, and to eliminate wrinkles.
- Velva Cream can also be employed with cotton when forming mouth features to prevent dehydration of the lips and on the surface of eye caps to retain moisture in the eyelids.

**1-CREAVELV**  
 16 oz / 453 ml

## LANOL CARE

- Lanolin-based spray that helps keep tissue moisturized and life-like.
- Provides an excellent base for the application of cosmetics.
- Ensures powder will never cake or crack on the skin, or look pasty.
- When applied to skin, results in a smooth, natural look.
- Will protect bodies from freezer burn if stored in a cooler.

**2-LANOCARE**  
 5.5 oz / 163 ml



## SEAL-O-TITE

- Seal-O-Tite is a liquid product for permanently sealing incisions against leakage.
- Forms a liquid-tight and highly flexible seal when dry.
- Brush over post-mortem seams, surgical incisions, and other wounds.
- Can be used as an adhesive during restorative work and filling large wounds.
- Thicker than Skin Seal.

**1-SEALOTITE**  
 1 pint / 568 ml jar

## SKIN SEAL

- Liquid sealant used to cover sutured or glued incisions.
- May be applied as a base for cosmetic application where tissue is compromised or weeping.
- Excellent for sealing cuts where hair is present.
- Clear drying.
- Thinner than Seal-O-Tite.

**1-SKINSEAL**  
 8 oz / 237 ml jar



## FRIGID STA-SEAL

- Seals incisions to prevent seepage.
- Sets instantly and shapes itself.
- Adheres flawlessly and dries quickly.

**2-STASEAL**  
 9.2 oz / 272 ml bottle

**2-STASEALG**  
 1 gallon container / 3.79 Liters



## THANO SEAL

For use on incisions, lacerations, abrasions, punctures and skin slips. Provides a complete seal to dry tissue that eliminates leaks. Easy peel and stick application.

### 2-THANOSEAL01

2" x 20' Roll

### 2-THANOSEAL02

4" x 20' Roll



## ARON ALPHA

- Effective way to seal lips, eyelids, small punctures, and incisions.
- A high-strength, instant adhesive that dries clear and colorless in less than 45 seconds.

### 2-ARONALPH

five 2 gram bottles



## PAULEX POWDER®

- A fine powder containing paraformaldehyde.
- Use it to pack orifices, eliminate odors, or as a hardening compound.
- Also for cancer cases, edema, gangrene, infection, burning, drowning, and stillbirth.
- It is great for cremations, disinterment, autopsies and body bag transport.

### 1-PAULPOWD1

1 lb / 454 g jar

### 1-PAULPOWD25

25 lb / 11.3 kg jar



## CONTACT EMBALMING SPRAY

- One of the strongest embalming sprays available.
- Use on bedsores, gangrene, putrefactive areas, cancer, floaters to embalm and deodorize on contact.
- Can be applied using cloth or spray.
- Spray trigger available upon request (1-SPTRATRIG).

### 1-CONTACT

16 oz / 453 ml



## VIS-O-GUARD GEL

- Developed for cases requiring deep penetration and odor control.
- A surface embalming material of high viscosity designed to cling to tissue.
- Deodorizes and preserves putrid tissue as well as areas of the body that lack arterial distribution.
- Use to preserve the contents of viscera bags.
- Vis-O-Guard Gel's pink color allows it to be utilized on the face.
- Used inside the flaps and cranium on autopsies, as well as on skin skip, bedsores, and abrasions.

### 1-VISOGUARD

2 lb / 0.907 kg jar



## FORMALIN CREAM

- A surface embalming cream that penetrates deep into tissue to preserve and disinfect.
- Control tissue hardness precisely by varying the quantity used and the period it is in contact with the body.
- Light pink color will not stain or bleach so it can be applied to the face with confidence.

### 1-CREAFORM

1 lb / 0.454 kg jar



### HEXAPHENE

- Great for embalming and dehydrating upper and lower limbs.
- External application should be covered by plastics, vinyl or plastic wrap.
- Once dressing area is properly covered, body is able to be dressed over affected area.
- Treats traumatic conditions, cancer, gangrene, etc.

**2-HEXAPHEN**  
2.5 lbs. / 3.78 L

### FEATURE BUILDER

- Congeals rapidly to make tissue building quicker and easier.
- Expands more fully to eliminate uneven application problems.
- Especially useful for rebuilding damaged facial features.

**1-FEATBGAL**  
1 gal / 3.78 L

**1-FEATB**  
16 oz / 473ml

### FEATURE BUILDER SOLVENT

- Used to thin Feature Builder and clean instruments.

**1-FEATBSOL**  
16 oz / 473 ml



### FRIGID HARDENING COMPOUND

- Three actions in one preparation: absorption, hardening, and disinfection.
- Indispensable in cases where circulation has been totally destroyed.
- Apply directly to affected parts to remove odors caused by sores, cancer, gangrene, or abscesses.
- Add cold water to use as a bleaching paste to eliminate surface discoloration.

**1-HARD25LBS**  
25 lb / 11.3 kg box

**1-HARD50LBS**  
50 lb / 22.7 kg box

### FRIGID AUTOPSY COMPOUND

- Absorbs excess water and firms tissue.
- Very quick acting.
- Preserving agents make it extremely effective in destroying pathogenic germs.
- Dustless, pleasant-smelling, and contains no wood products.

**1-AUTOP25LBS**  
25 lb / 11.3 box

**1-AUTOP50LBS**  
50 lb / 22.7box

### KREME PROTEC SOAP

- Cleans, protects and deodorizes with the softness of lanolin.
- Use it on hands before and after embalming to help cleanse.
- Applicable for bathing bodies and to shampoo hair, wash tables and instruments, etc.

**2-SOAPKREM-CH**  
Cherry scented, 1 gallon (3.78 L)

**2-SOAPKREM-LE**  
Lemon scented, 1 gallon (3.78 L)





**WAVICIDE-01**

- Fast acting, 30-day thorough working glutaraldehyde solution.
- Sporicidal, virucidal, bactericidal, tuberculocidal, pseudomonacidal and fungicidal.
- Effective against HIV (AIDS).
- Has a mild, fresh scent.
- Recommended for disinfecting embalming instruments and tools.
- It is 2.5% aqueous glutaraldehyde sterilant/disinfectant, pH 6.3 to 6.4.

**2-WAVICIDE**

1 gal / 3.78 L

**SURGICAL SCRUB FOAM**

- Foaming Alcohol-based surgical scrub with antiseptic and added moisturizers. Latex free.
- Can be mounted on wall with dispenser.
- **Scrub and Dispenser are sold separately**

**2-SURGSCRUB**

8 oz / 227 grams can

**2-SURGSCRUB-D**

white dispenser rack

**UNICIDE 256**

- A germicidal detergent that disinfects and deodorizes.
- Formulated for institutional use, this product can be used to disinfect floors, walls, metal surfaces, medical devices and other nonporous surfaces.
- Effective in hard water up to 400 PPM.
- Unicide 256 is effective against HIV (AIDS), and is staphocidal, pseudomonacidal, virucidal, fungicidal.
- Will neither leave a film nor dull floor finishes.

**2-MAXIGALL**

1 gal / 3.78 L



**DRY HAIR CLEANER**

- Developed to clean dirt, hair dye, cosmetics and tobacco stains from hair, mustaches, eyebrows, and fingers.
- Cleans body fluids from clothing and casket lining.
- Apply with cotton, cloth, or brush for maximum cleaning effects and control.

**1-HAIRCLEA**

16 oz. bottle

**FRIGID CALVARIUM CLAMPS**

Stainless steel screw-type calvarium clamps. Now featuring a Slotted/Phillips Combo Screw for added convenience.

**2-CALVCLAM**

20 per package

**NATURAL EXPRESSION MOUTH FORMERS**

Made of clear vinyl, Natural Expression Mouth Formers are ready for fast, easy installation. No pre-shaping or pre-forming is necessary.

**2-MOUTFORM-N**

12 per box



**DENTAL SIMULATORS**

Flesh colored plastic, formed to replace the natural curvature of dentures. Small molded spurs hold lips in place, helping to retain the normal curvature of the mouth.

**2-DENTSIMU**  
12 per box



**OCULIST EYE CAPS**

Oculist eye caps will bond to the eye on contact with moisture. Perforated surface guarantees secure closure of the eyelids.

**2-EYECAPS45S** small flesh, gross  
**2-EYECAPS45L** large flesh, gross  
**2-EYECAPS47S** small clear, gross  
**2-EYECAPS47L** large clear, gross



**PERFECTION EYE CAPS**

Eye caps are round with needle pointed perforations to hold lid in place. Available clear only.

**2-EYECAPSPC-S-G** small, gross  
**2-EYECAPSPC-M-G** medium, gross  
**2-EYECAPSPC-L-G** large, gross



**FRIGID TROCAR BUTTONS**

Frigid's own finely threaded trocar button with a sharp point. Works in tandem with the Frigid Trocar Applicator, to form a perfect seal.

**2-TROCBUTT-F**  
gross



**FRIGID TROCAR APPLICATOR**

Stainless steel applicator that perfectly interlocks with Frigid Trocar Buttons for a secure fit. Makes application process a breeze.

**4-GOV T**  
available each



**TROCAR BUTTONS**

Snip-tip trocar buttons are flesh colored and compatible with 2-prong trocar button applicators

**2-TROCBUTT-ST**  
gross



**2-PRONG TROCAR BUTTON APPLICATOR**

Allows for quick and easy application of any trocar button that requires a 2-prong applicator.

**2-TROCAPPL**  
available each



**AV CLOSURE**

Anal/vaginal plug.

**2-CLOSURAV**  
available each



**CRANIAL CAPS**

Our cranial caps absorb leaks and protect against stains.

**2-CAPSCRAN**  
12 per box



### MULTI-CLOSURE TROCAR BUTTONS

Use Multi-Closure buttons to close openings caused by IV. lines, hypodermic incisions, trocars, tracheotomies, and feeding tubes.

**2-TROCBUTT-M**  
50 per box



### PLASTIC SHEETS

36" x 84" (91 x 213 cm) white vinyl sheets. 5 mil.

**2-SHEEPLAS**  
available each



### BIOHAZARD BAGS

Our hazardous waste bags are available in two sizes: 24" x 33" (61 x 84 cm), 15 gallon (56.8 L) and 31"x43" (79 x 109 cm), 35 gallon (132.5 L). Each bag is imprinted with "Infectious Waste" in both English and Spanish.

**2-BAGHAZA**  
15 gal (58.8 L), 25/roll

**2-BAGHAZA-L**  
35 gal (132.5 L), 20/roll



### COTTON ROLLS

One pound rolls 100% absorbent cotton.

**2-COTTROLL**  
1 lb. (.454 kg) roll



### VISCERA BAGS

Safely store visceral organs in our 3-mil polyethylene viscera bag. Indispensable for autopsy cases. Each bag is 25" x 30" (64 x 76 cm) and comes with a tie.

**2-BAGSVISC**  
12 per box



### STRETCHER SHEETS

Disposable tissue/poly sheets for maximum absorbency and strength. 40" x 90" (102 x 229 cm)

**2-SHEESTRE-B**  
50 per case



### SANAPRON SHEETS

Paper on one side and plastic on the other, Sanapron sheets protect and absorb at the same time. Ideal for covering couches, embalming boards, or floors. 40" x 90" (102 x 229 cm).

**2-SANASHEE**  
12 per box



### WEBRIL<sup>®</sup> PREP TOWELS

Webril<sup>®</sup> Prep Towels from Frigid are 100% non-woven cotton fabric. One towel will absorb up to 10 times its own weight in liquid, and adheres to itself when folded, making an excellent "instant bandage." Towels come in 8" x 15".

**2-PREPTOWE**  
50 towels per roll, available by roll or in cases of 8



### COTTON SUTURE THREAD

**2-THRECOTT7**  
7 cord cotton, 1 lb., white.

**2-THRECOTT7B**  
7 cord braided cotton 1 lb., black.



### LINEN SUTURE THREAD

**2-THRELIN-RT7**  
7 cord linen, 1 lb. white, right twist

**2-THRELIN-WX**  
6 cord waxed linen, 1 lb.

**AIRBRUSH KIT**

The Airbrush Kit includes: Compressor, Airbrush Gun, 6' Smoke Color Hose, AC adapter, Compressor (Champagne or Black), eight 0.25 oz shades in glamour, 1 practice shade, Practice Paper, 1 bottle Citrus Cleaner, Training DVD, 1.2 oz. empty bottle for water, 1 Moist n' Dewy finish spray, 3 Eyebrow Stencils, Airbrush Gun Protector sleeve, Airbrush Gun tip and cup protector cover.

**2-AIRBRU-K**

Other Options Available Upon Inquiry

*\*When ordering, specify the cosmetic colors you prefer: Caucasian, Latin, or Black.*



**DERMA PRO PROFESSIONAL**

The Professional Cosmetic Kit is our most popular. The kit comes with a variety of colors that allow for use on any type of case.

**R-COSMKIT-PC**



**DERMA PRO ETHNIC STANDARD**

This kit provides a more complete selection of colors for the skin tone of your choice. Choose from Black, Hispanic, and Asian skin tones.

- R-COSMKIT-ESB**
- R-COSMKIT-ESH**
- R-COSMKIT-ESA**

- Black
- Hispanic
- Asian

**DERMA PRO STANDARD CAUCASIAN**

A versatile kit, the Standard Caucasian Kit provides a large number of colors to meet the needs of any type of case.

**R-COSMKIT-SC**

	Professional Cosmetic Kit	Economy Cosmetic Kit	Standard Caucasian Cosmetic Kit
Matte Finish water-base Covering Cremes	6	3	8
Camouflage Cremes	3	2	2
Translucent Powder	1	1	2
Blush/highlight Colors	3	2	2
Nail Polish Colors	2	2	3
Mascara Color	1	1	1
Lip Colors	3	3	4
Plastic Carrying Case	1	1	1
Eye Shadow Colors	X	2	2
Eyebrow Pencil	X	X	1
Lip Wax	X	X	1
Illusion Cremes	X	X	X



1 pint



**LYF-LYK COMPLEXION TINT**

Lyf-Lyk complexion tint is an ideal base for powder or rouge to eliminate the appearance of glossy skin. Applies evenly and dries quickly. Use on all exposed areas for the velvety appearance of living tissue.

<b>R-LYFLYK-LB</b>	brunette, powdered	1 pint / 473 ml bottle
<b>R-LYFLYK-LD</b>	dark, powdered	1 pint / 473 ml bottle
<b>R-LYFLYK-LF</b>	flesh, powdered	1 pint / 473 ml bottle
<b>R-LYFLYK-LL</b>	light, powdered	1 pint / 473 ml bottle
<b>R-LYFLYK-LS</b>	suntan, powdered	1 pint / 473 ml bottle

**LIP WAX**

Covering difficult areas of the lips has never been easier. Apply Lip Wax to treat cracked, dehydrated, and otherwise traumatized lips. Provides an excellent base for cosmetic application.

- R-LIPWAX-N**  
neutral, 3 oz / 89 ml can
- R-LIPWAX-LP**  
light pink, 3 oz / 89 ml can
- R-LIPWAX-P**  
pink, 3 oz / 89 ml can
- R-LIPWAX-R**  
ruby, 3 oz / 89 ml can
- R-LIPWAX-S**  
straw, 3 oz / 89 ml can



**PLASTO WAX PACKING WAX**

Plasto Wax is the only packing wax that returns to its original texture and firmness after heating. Plasto Wax Firm is a favorite among restoration professionals for rebuilding features damaged by disease and accident. Plasto Wax Soft can also be used to rebuild, but is more commonly used for covering discoloration and wounds.

- 2-PLASWAX1**  
firm, 8 oz / 237 ml can
- 2-PLASWAX2**  
soft, 8 oz / 237 ml can

**RESTOR SKIN**

Spray on to mask burns, bruises and other discolorations. Available in Neutral and Soft Beige.

- 2-RESTSKIN**  
Soft Beige, 5 oz/141 gram can
- 2-RESTSKIN-N**  
Neutral Flesh, 5 oz/141 gram can

**LANOL CARE**

- Lanolin-based spray that helps keep tissue moisturized and life-like.
- Provides an excellent base for the application of cosmetics.
- Ensures powder will never cake or crack on the skin, or look pasty.
- Results in skin with a smooth, natural look.
- Will protect bodies from freezer burn if stored in a cooler.

- 2-LANOCARE**  
5.5 oz / 163 ml

## EMBALM WITH PRECISION THE FRIGID EMBALMING MACHINE

### THE FRIGID EMBALMING MACHINE FEATURES:

- **Embalm with your fluid of choice.** The machine has the ability to utilize the harshest products on the market, even phenols and high index cavity fluids. Embalm worry-free!
- **Patent-pending Mix/Self-Clean port** ensures a consistent mixture in your formula and reduces the threat of separating fluids.
- **Custom-designed laboratory-strength Borosilicate Glass tank** will not discolor, cloud or crack over time.
- **Patent-pending Smart Lid** provides a quick and easy way to pour fluids into the tank while reducing embalmer exposure to embalming solution fumes.
- **Hydraulic flow sensor** detects blockages and flow changes immediately in the system and shows up on the digital display.
- **Dual Digital displays** indicate precise pressure and flow data which is controlled by the embalmer. Available in Imperial or Metric units.
- **Pressure range:** 0 – 105 psi (0 - 724 kPa)
- **Flow range:** 0 – 80 oz/min. (0 - 2.36 liters/minute)
- **Five distinct modes:** Off/Gravity Embalm, Mix, Clean, Inject and Pulse (24 pulses per minute).
- Clearly visible Imperial/metric graduated tank with max capacity of 3 gallons or 12 Liters, respectively.
- Includes high pressure hose.
- Available in white, black or custom colors.



### SPECIFICATIONS:

- **Dimensions:** 15.2" W x 19.3" H x 14.3" D (38,6 x 36,3 x 49 cm)
- **Weight:** 40 lbs (18 kg)
- Available in both 115 Volt & 230 Volt
- 2 year warranty



Embalm with your fluid of choice, including cavity fluids!



### THE FRIGID SMART LID

The Frigid Smart Lid has an easy-open hatch that limits exposure risk to both chemicals and fumes. The hatch filter also helps reduce contaminants from within your solution.

**3-SMARTLID**  
available each



### HIGH PRESSURE HOSE

High pressure hose, with stopcock and window. Allows you to see your solution right before it enters the body.

**3-FRIGIDHOSE**  
available each



Custom colors available!



**SLIP HUB ADAPTER**

**2-ADPR1051**

Stainless steel slip hub female threaded adapter

**2-ADPR1052**

Stainless steel slip hub male threaded adapter

**2-ADPR1055**

Stainless steel 12-32 male to 12-32 male threaded adapter



**QUICK CONNECT MALE TO MALE THREAD**

Male quick connect to 5/16-36 male thread for most hypo valve handles

**2-QCAM-516-36M**

Shown with **2-QCAM-516-36M** Quick Connect Male Adapter. Sold Separately



Shown with **2-ADPR9261** 12-32 Female x 5/16-36 Male Adapter. Sold separately

Quickly and easily connects to instruments such as the hypo trocar shafts or arterial tubes

**HYPHO VALVE**

Features a large comfortable hand grip. The large stainless steel actuating button features full metering flow control. The button provides smooth and proportional control of liquid flow. When button is raised the flow will smoothly be reduced and not snap shut. Made from high performance Delrin for durability and light weight. 5/16-36 female threads on each end. Adapters and Hypo Shafts sold separately

**2-HYPOVALVE**



**HYPHO TROCAR SHAFT**

Hypo Shafts feature stainless steel tubing and fitting with a replaceable hardened steel point. The shaft has 2 irrigation holes in addition to the point having two irrigation holes. Sold with point, safety cap and leather washer.

**R-TRO6309**

1/8" Dia. x 16.5" Trocar w/ 12-32 Male Threaded Hub w/ **R-TP6325** Point

**R-TRO6317**

3/16" Dia. x 16.5" Trocar w/ 12-32 Male Threaded Hub w/ **R-TP6333** Point

**R-TRO6317-LG**

3/16" Dia. x 16.5" Trocar w/ 5/16-36 Male Threaded Hub w/ **R-TP6333** Point

**R-TRO6325**

1/4" Dia. x 16.5" Trocar w/ 5/16-36 Male Threaded Hub w/ **R-TP6127** Point



**MALE TO FEMALE ADAPTER**

Stainless steel-valve handle to arterial tube adapter (5/16-36 male thread to 12-32 female thread)

**2-ADPR9261**



**QUICK CONNECT TO FEMALE THREAD**

Quick connect adapter to connect to all 12-32 male instruments.

**2-QCAM-12-32F**



**MALE TO MALE ADAPTER**

Stainless steel-valve handle to embalming machine pressure hose (5/16-36 male thread to 12-32 Male thread)

**2-ADPR9262**



**QUICK CONNECT ARTERIAL FEMALE**

Features all metal construction and 12-32 male thread for connection to most high pressure hoses, eliminating the need for the **2-ADPR1055**

*Note: Internal valve is not compatible with phenolic fluids.*

**2-QCAF-12-32M**



**MAGNETIC FILTER FOR TANK**

Available in white or black.

**4-EMB070**



**MIX/CLEAN PORT FILTER**

Available each.

**4-EMB275**



**TRADE EMBALMER**

The 15 inch (38.1 cm) Trade embalmer's trocar is collapsible for easy transport. Comes with a cleaning rod.

**R-TROC812**



without sight glass

**DYNAMIC**

- R-TROC829** with sight glass, 3/8" x 16" (9.53 mm x 41 cm)
- R-TROC830** with sight glass, 3/8" x 19" (9.53 mm x 48 cm)
- R-TROC834** with sight glass, 5/16" x 16" (7.94 mm x 41 cm)
- R-TROC835** with sight glass, 5/16" x 19" (7.94 mm x 48 cm)
- R-TROC840** w/o sight glass, 3/8" x 16" (9.53 mm x 41 cm)
- R-TROC841** w/o sight glass, 3/8" x 19" (9.53 mm x 48 cm)
- R-TROC843** w/o sight glass, 5/16" x 16" (7.94 mm x 41 cm)
- R-TROC844** w/o sight glass, 5/16" x 19" (7.94 mm x 48 cm)

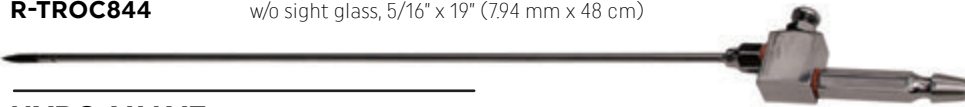

**HYPO-VALVE**

- R-TROCHY825-16** 3/16" x 16" (4.77 mm x 41 cm)
- R-TROCHY825-18** 3/16" x 18" (4.77 mm x 46 cm)
- R-TROCHY826-16** 1/8" x 16" (3.18 mm x 41 cm)
- R-TROCHY826-18** 1/8" x 18" (3.18 mm x 46 cm)



**STRAIGHT LINE**

All Straight Line trocars come with a cleaning rod.

- R-TROC816-14** 3/8" x 14" (9.53 mm x 36 cm)
- R-TROC816-16** 3/8" x 16" (9.53 mm x 41 cm)
- R-TROC816-18** 3/8" x 18" (9.53 mm x 46 cm)
- R-TROC816-20** 3/8" x 20" (9.53 mm x 51 cm)
- R-TROC816-22** 3/8" x 22" (9.53 mm x 56 cm)
- R-TROC817-14** 5/16" x 14" (7.94 mm x 36 cm)
- R-TROC817-16** 5/16" x 16" (7.94 mm x 41 cm)
- R-TROC817-18** 5/16" x 18" (7.94 mm x 46 cm)
- R-TROC817-20** 5/16" x 20" (7.94 mm x 51 cm)
- R-TROC817-22** 5/16" x 22" (7.94 mm x 56 cm)



**INFANT**

The 7" and 12" Infant Trocars come with a cleaning rod.

- R-TROCINF819-7** 3/16" x 7" (4.77 mm x 18 cm)
- R-TROCINF819-12** 3/16" x 12" (4.77 mm x 30 cm)
- R-TROCINF819-16** 3/16" x 16" (4.77 mm x 41 cm)
- R-TROCINF819-18** 3/16" x 18" (4.77 mm x 46 cm)
- R-TROCINF820-16** 1/8" x 16" (3.18 mm x 41 cm)
- R-TROCINF820-18** 1/8" x 18" (3.18 mm x 46 cm)



R-YCOMPLETE

**Y STANDARD**

- R-YTHREMOUN** Y with threaded hubs
- R-YSLIPHUB** Y with slip hubs

**Y COMPLETE** (PICTURED)

- R-YCOMPLETE** Y complete with stopcocks

**TROCAR CLEANING BRUSH**  
**R-BRUSTROC**



**ORDERING DIMENSIONS**

The trocar point dimension should match the O.D. of your trocar when ordering replacements.

Trocar dimensions are listed as Outside Dimension (O.D.) x Working Length. If you are not sure what size trocar or trocar point you need, please refer to the ruler provided on this page. The ruler is shown actual size. All trocars include 1 trocar point.





**DYNAMIC POINTS**

**R-POINDYNA3/8** 3/8" (9.53 mm)  
**R-POINDYNA5/16** 5/16" (7.94 mm)

**PIERCING POINTS**

**R-POINPIER3/8**  
 6 piercing points for 3/8" (9.53 mm) dynamic point  
**R-POINPIER5/16**  
 6 piercing points for 5/16" (7.94 mm) dynamic point

**REGULAR POINTS**

**R-POINTROC3/163** 3/16" (4.77 mm)  
**R-POINTROC3/8** 3/8" (9.53 mm)  
**R-POINTROC5/16** 5/16" (7.94 mm)  
**R-POINTROC1/8** round 1/8" (3.18 mm)  
**R-POINTROC3/164** round 3/16" (4.77 mm)



**CAVITY INJECTOR**

**R-INJECAVI**  
 cavity injector, 5" / (12.7 cm)  
 \*\*\*Sized to fit Frigid Fluid bottles.

**HYDRO ASPIRATOR**

The Hydro Aspirator features automatic vacuum to prevent contamination, and reversible flow for flushing trocar without disconnecting from faucet.

**ASPIRATOR EXTENSION**

**R-ASPIHYDR-EXT**  
 aspirator extension, 4"

**R-ASPIHYDR** hydro aspirator



**RUBBER INJECTING TUBING**

**2-TUBIRUBB5/16**  
 5/16" (7.94 mm), per foot  
**2-TUBIRUBB3/16**  
 3/16" (4.77 mm), per foot

**CLEAR PLASTIC ASPIRATING TUBING**

**2-TUBIPLAS5/16**  
 5/16" (7.94 mm), per foot  
**2-TUBIPLAS3/8**  
 3/8" (4.77 mm), per foot

**POST ASPIRATOR**

**R-ASPIPOS850**  
 Post aspirator



**NONCLOGGING POST ASPIRATOR**

**R-ASPIPOS850S**  
 Nonclogging post aspirator

**NASAL ASPIRATOR**

**R-TUBENASA**  
 nasal aspirator

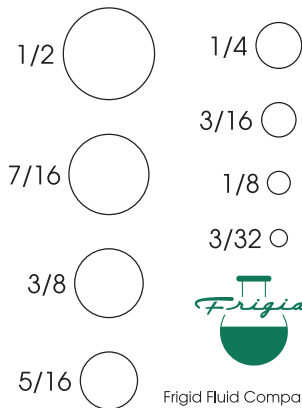

Frigid Fluid Company  
 11631 W. Grand Ave  
 Northlake, IL 60164  
 USA



**THREADED ARTERIAL TUBES**

<b>R-TUBEART06</b>	arterial tube with threaded hub, <b>3/16"</b> / 4.77 mm
<b>R-TUBEART06C</b>	curved arterial tube with threaded hub, <b>3/16"</b> / 4.77 mm
<b>R-TUBEART07</b>	arterial tube with threaded hub, <b>1/8"</b> / 3.18 mm
<b>R-TUBEART07C</b>	curved arterial tube with threaded hub, <b>1/8"</b> / 3.18 mm
<b>R-TUBEART08</b>	arterial tube with threaded hub, <b>3/32"</b> / 2.38 mm
<b>R-TUBEART08C</b>	curved arterial tube with threaded hub, <b>3/32"</b> / 2.38 mm

**STUB TYPE ARTERIAL TUBES**

<b>R-TUBEART04</b>	stub type with slip hub, <b>3/16"</b> / 4.77 mm
<b>R-TUBEART04T</b>	stub type with threaded hub, <b>3/16"</b> / 4.77 mm
<b>R-TUBEART05</b>	stub type with slip hub, <b>1/8"</b> / 3.18 mm
<b>R-TUBEART05T</b>	stub type with threaded hub, <b>1/8"</b> / 3.18 mm
<b>R-TUBEART09</b>	curved stub type with slip hub, <b>3/32"</b> / 2.38 mm
<b>R-TUBEART09T</b>	curved stub type with threaded hub, <b>3/32"</b> / 2.38 mm

**STUB TYPE CAROTID TUBES**

<b>R-TUBECAR05</b>	Curved stub type carotid tube with slip hub, <b>1/4"</b> / 6.35 mm
<b>R-TUBECAR05T</b>	Curved stub type carotid tube with threaded hub, <b>1/4"</b> / 6.35 mm
<b>R-TUBECAR06</b>	Curved stub type carotid tube with slip hub, <b>5/16"</b> / 7.94 mm
<b>R-TUBECAR06T</b>	Curved stub type carotid tube with threaded hub, <b>5/16"</b> / 7.94 mm

**CAROTID TUBES**

<b>R-TUBECAR01</b>	Carotid tube with slip hub, <b>5/16"</b> / 7.94 mm
<b>R-TUBECAR01T</b>	Carotid tube with threaded hub, <b>5/16"</b> / 7.94 mm
<b>R-TUBECAR02</b>	Carotid tube with slip hub, <b>1/4"</b> / 6.35 mm
<b>R-TUBECAR02T</b>	Carotid tube with threaded hub, <b>1/4"</b> / 6.35 mm

**HAIR PIN**

<b>R-INJEHAIR1/8</b>	Hair pin injector, <b>1/8"</b> / (3.18 mm)
<b>R-INJEHAIR3/16</b>	Hair pin injector, <b>3/16"</b> / (4.77 mm)
<b>R-INJEHAIR5/16</b>	Hair pin injector, <b>5/16"</b> / (7.94 mm)

**INFANT PROBE POINT**

<b>R-TUBEINF01</b>	Infant injector probe point with slip hub
<b>R-TUBEINF01T</b>	Infant injector probe point with threaded hub

**INFANT TUBE, RADIAL**

<b>R-TUBEINF03</b>	Infant tube, radial with slip hub
<b>R-TUBEINF03T</b>	Infant tube, radial with threaded hub

**INFANT OPEN END**

<b>R-TUBEINF02</b>	Infant injector, open end with slip hub.
<b>R-TUBEINF02T</b>	Infant injector, open end with threaded hub.





R-HUBSLIP



R-ADAPT871A



R-ADAPT871B



R-ADAPT904



R-ADAPLUER



R-ADAPSTOP



R-COCKSQUA

**ADAPTERS**

**R-HUBSLIP**

Adapter, arterial thread to slip hub.

**R-ADAPT871A**

Adapter, male valve threaded to female arterial threaded.

**R-ADAPT871B**

Adapter, double male arterial thread.

**R-ADAPT904**

Adapter, female arterial threaded to male luer.

**R-ADAPLUER**

Adapter, arterial thread to luer.

**R-ADAPSTOP**

stopcock adapter, double slip.

**R-COCKSQUA**

square body stopcock.

**SCALPEL HANDLES**

#4 scalpel handle for blades 20-25

**2-SCALHAND4**



2-SCALHAND4

**SCALPEL BLADES**

#22 scalpel blade

**2-SCALBLAD22**



2-SCALBLAD22

**DISPOSABLE SCALPELS**

disposable scalpel with #21 blades, 10/package

**2-SCALDISP**



2-SCALDISP

**SYRINGES**

**2-SYRIDISP20**

disposable 20cc

**2-SYRIGLAS20**

glass, luer-lock 20cc



GLASS SYRINGE



PLASTIC DISPOSABLE SYRINGE

Surgical needle sizes listed largest to smallest (Based on last number of product code).



**BACK-CURVED NEEDLES**

(sold by the dozen)

**2-NEEDBACK1**

1.42 mm x 80 mm (3.15 in)

**2-NEEDBACK2**

1.22 mm x 68 mm (2.68 in)

**2-NEEDBACK3**

1.10 mm x 60 mm (2.36 in)

**2-NEEDBACK4**

1.00 mm x 52 mm (2.05 in)

**2-NEEDBACK5**

1.00 mm x 46 mm (1.81 in)



**HYPODERMIC NEEDLES**

(available each)

**2-NEEDHYPO13-10**

13 gauge, 10" / (25.4 cm)

**2-NEEDHYPO14**

14 gauge, 3" / (7.62 cm)

**2-NEEDHYPO15-6**

15 gauge, 6" / (15.2 cm)

**2-NEEDHYPO15-8**

15 gauge, 8" / (20.3 cm)

**2-NEEDHYPO17**

17 gauge, 2" / (5.08 cm)

**2-NEEDHYPO17-3**

17 gauge, 3" / (7.62 cm)

**2-NEEDHYPO19**

19 gauge, 3" / (7.62 cm)

**2-NEEDHYPO20-6**

20 gauge, 6" / (15.2 cm)



**HALF-CURVED NEEDLES**

(Sold by the dozen)

**2-NEEDHALF0**

2.20 mm x 140 mm / 5.51"



**FULL-CURVED NEEDLES**

(sold by the dozen)

**2-NEEDFULL1**

1.2 mm x 80 mm / 3.14"

**2-NEEDFULL6**

1.10 mm x 55 mm / 2.17"

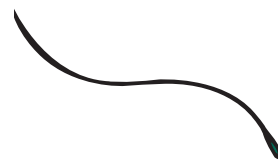

**DOUBLE-CURVED NEEDLES**

(sold by the dozen)

**2-NEEDDBLE1**

4.75" (120.65 mm)

**2-NEEDDBLE2**

4.25" (107.95 mm)

**2-NEEDDBLE3**

3.25" (82.55 mm)

**2-NEEDDBLE4**

2.25" (50.80 mm)



**ROCHESTER-PEAN**

**R-FORC120** 6 1/4" / (16 cm) straight  
**R-FORC120C** 6 1/4" / (16 cm) curved



**HEGAR NEEDLE**

**R-FORC61**  
 6" / (15 cm)



**ARTERY FIXATION**

**R-FORCARTE66-2**  
 2 hole artery fixation forcep,  
 5 1/2" straight / (14 cm)  
**R-FORCARTE66-3**  
 3 hole artery fixation forcep,  
 7 1/2" curved / (19 cm)



**DRESSING**

**R-FORCDRES62A** 10" / (25 cm)  
**R-FORCDRES62B** 6" / (15 cm)  
**R-FORCDRES8** 8" / (20 cm)



**CURVED VEIN**

**R-FORCVEIN7**  
 7" (17.8 cm) overall  
 4" shank (10 cm)



**ANGULAR VEIN**

**R-FORCVEIN12-7**  
 12" overall length (30.5 cm)  
 7" (17.8 cm) shank



**EYE DRESSING**

**R-FORCEYE-C** 4 1/2" curved / (11.4 cm)  
**R-FORCEYE-S** 4" straight / (10 cm)



**CRILE**

**R-FORCART506**  
 crile straight artery  
 5 1/2" / (14 cm)



**GATHERING**

**R-FORCGATH**  
 5 1/4" (13.3 cm)



**OPERATING DOUBLE SHARP**

**R-SCISDBSH5.5** 5 1/2" (14 cm)  
**R-SCISDBSH6.5** 6 1/2" (16.5 cm)



**CUTICLE**

**R-SCISCUTI**  
 4 1/8" curved (10.5 cm)



**MAYO CURVED**

**R-SCISMAYOC**  
 5 1/2" (14 cm)



**LISTER BANDAGE**

**R-SCISBAND**  
5 1/2" (14 cm)



**OPERATING SHARP/BLUNT**

**R-SCISBLSH5.5** 5 1/2" (14 cm)  
**R-SCISBLSH6.5** 6 1/2" (16.5 cm)



**MAYO STRAIGHT**

**R-SCISMAYOSTR**  
5 1/2" (14 cm)



**OPERATING DOUBLE BLUNT**

**R-SCISDBBL5.5** 5 1/2" (14 cm)  
**R-SCISDBBL6.5** 6 1/2" (16.5 cm)



**NEEDLE INJECTOR**

- All stainless steel construction
- Larger finger loops with soft curved edges
- Smooth radius end cap
- Adjustable force
- Spring Clip to retain needle
- Dependable trigger action

**R-DVRSSNCL**  
manual needle injector



**INJECTOR NEEDLES**

**2-NEEDINJE-B**  
needles for needle injector, brass, gross

**2-NEEDINJE-S**  
needles for needle injector, stainless steel, gross



**GROOVED PROBE POINT**

**R-GROODIR**  
grooved director probe point

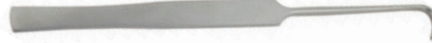

**ANEURISM NEEDLES**

**R-NEEDANEU**  
aneurism needle pin

**R-HOOKANEU-CH**  
cradle handle aneurism hook



**NEEDLE INJECTOR DRIVER**

The patented Injector Needle Driver™ is the first of its kind. Features a full comfortable hand grip, stainless steel nose, powerful driving action and a hands free spring clip to keep Injector Needles securely in place. Designed with women in mind, the Injector Needle Driver™ fits comfortably in smaller hands and is easy to squeeze. The end cap can be turned in or out for force adjustment.

**R-DRVSSN**



**NEOPRENE BIB APRON**

Reusable neoprene bib-style apron. Light weight and tear resistant with hemmed edges. Protects against chemicals and oils. Easily wiped clean. Available in black or green and in various sizes from 38 inches (97 cm) to 56 inches (142 cm) in length. Custom sizes also available.

**5-APRONEOP38**

black apron

**5-APRONEOPG38G**

green apron



**BARRIER GOWNS**

Provides full-length, fluid resistant coverage. Constructed with a single piece of impervious plastic, it has one thermal impulse seal for the ultimate in safe and worry-free protection. Meets most OSHA requirements.

**2-GOWNBARR-U**

blue, universal, 15 per box

*Also available in poly-coated yellow with thumb loops.*

**2-GOWNBARR-XLY**

yellow, L/XL 10 per bag



**FLUID-RESISTANT SMS GOWNS**

Classic Fluid-Resistant SMS gowns are breathable, flexible and strong enough for tough duties. Made from medium-weight fluid-resistant 4-Ply SMS material. Gowns feature strong seams to withstand fluids. Gowns are generously sized for full coverage and flexibility and are constructed with waist and neck ties to ensure secure fit.

**2-GOWNSMS-MD**

10 gowns/bag



**NON-SLIP SHOE COVERS**

Our shoe covers are manufactured from lightweight polypropylene and feature non-skid soles. Elasticity allows cover to conform to your shoe better. One size fits all.

**2-COVESHOE**

universal, 100 per box

**2-COVESHOE-L**

universal, 100 per box, size large



**BOUFFANT HAIR COVERS**

All caps comply with NFPA standards and are latex-free. Double-stitched elastic band keeps caps flat and comfortable on the forehead. Economy Cap. Lint Free. Made of Spunbond Polypropylene.

**2-COVEHAIR-21B**

blue, 100 per box



**SANAPRON APRONS**

The layer of paper added to these aprons make them absorbent while lending them increased durability. 25" x 40".

**2-SANAAPRO**

25 per box

**2-MASKN95A****2-MASKEYE EACH****2-MASKCONE****2-MASKSURG****2-MASKN95**

## PROTECTIVE MASKS

### N95 FLAT FOLD ADJUSTABLE RESPIRATOR MASKS

- NIOSH Approved N95 respirator mask filters airborne particles.
- Cellulose inner and outer facings.
- Flat fold style with adjustable nose and chin wire for a comfortable fit.
- One size fits most

#### 2-MASKN95A

35 masks/box

### FLUID-RESISTANT SURGICAL FACE MASKS WITH EYESHIELD

- Fluid-Resistant Surgical Masks with Eyeshield offer full protection against fluids at either the ASTM F1862 160 mmHg or 120 mmHg Fluid Resistance Levels while attached eyeshield offers protection over eyes or glasses.
- Additional layer on the NON27710 series provides higher fluid protection while cellulose inner facing found on both fluid resistant level options creates a soft, cool and non-irritating environment for comfort.
- An anti-fog strip of comfortable, soft foam prevents eyeglasses from fogging, thus ensuring optical clarity while ties create secure attachment.

#### 2-MASKEYE EACH

available each



## FLIP-UP FACE SHIELDS

Our face shields offer superior protection with maximum convenience. The clear shields easily snap on to the accompanying headgear. The headgear is adjustable to fit head sizes 6-1/2 to 8.

#### 2-FACEFLIP

available each

## SURGICAL CONE-STYLE FACE MASK

- The cone-shaped mask enables easy donning and is held away from the nose and mouth for comfort and protection.
- A malleable nosepiece allows a custom fit.
- Designed with comfortable, rounded edges.
- BFE > 99

#### 2-MASKCONE

50 masks/box

## STANDARD SURGICAL MASK

- MEDLITE surgical mask is designed to be highly breathable and lightweight, providing necessary protection while creating a cool and comfortable environment.
- Polypropylene outer facing provides a soft, fluid protection barrier while the cellulose inner facing assures comfort and breathability.
- A full-width nosepiece guarantees proper fit.
- BFE > 98%, PFE > 97%

#### 2-MASKSURG

50 masks/box

## N95 CONE-STYLE PARTICULATE RESPIRATOR MASKS

- N95 approved particulate respirator meets NIOSH and CDC guidelines for TB exposure.
- Micro filter medium protects against micron-size particles.
- Double band holds mask firmly in place for maximum protection.
- All respirators must be selected, fitted and maintained in accordance with OSHA and other applicable regulations.
- Available in large/medium and small.

#### 2-MASKN95

20 masks/box



## 3M FORMALDEHYDE RESPIRATOR

Our dual cartridge respirators protect from formaldehyde fumes without abandoning comfort. The Masks are lightweight with uniform weight distribution. Cartridges can be replaced. NIOSH approved.

#### 2-FORMRESP 2-FORMRESP-C

Respirator  
Replacement cartridge

Plastics sold individually

**STOCKINGS (PAIRS)**

**WHITE PLASTIC**

- 2-STOCPLAS-S
- 2-STOCPLAS-M
- 2-STOCPLAS-L
- 2-STOCPLAS-XL

**CLEAR PLASTIC**

- R-STOCPLAS(S)
- R-STOCPLAS(M)
- R-STOCPLAS(L)
- R-STOCPLAS(XL)

**PANTS**

**WHITE PLASTIC**

- 2-PANTPLAS-S
- 2-PANTPLAS-M
- 2-PANTPLAS-L
- 2-PANTPLAS-XL

**CLEAR PLASTIC**

- R-PANTPLAS(S)
- R-PANTPLAS(M)
- R-PANTPLAS(L)
- R-PANTPLAS(XL)

**CAPRI PANTS**

**WHITE PLASTIC**

- 2-CAPRPLAS-M
- 2-CAPRPLAS-L
- 2-CAPRPLAS-XL

**CLEAR PLASTIC**

- R-CAPRPLAS-M
- R-CAPRPLAS-L
- R-CAPRPLAS-XL

**SHIRT JACKETS (Not Pictured)**

**WHITE PLASTIC**

- R-JACKPLAS(M)
- R-JACKPLAS(L)
- R-JACKPLAS(XL)

**CLEAR PLASTIC**

- R-JACKPLAS-M
- R-JACKPLASW(L)
- R-JACKPLASW-XL

**COVERALLS**

**WHITE PLASTIC**

- 2-COVEPLAS-S
- 2-COVEPLAS-M
- 2-COVEPLAS-L
- 2-COVEPLAS-XL
- R-COVEPLASW-2X

**CLEAR PLASTIC**

- R-COVEPLAS(S)
- R-COVEPLAS(M)
- R-COVEPLAS(L)
- R-COVEPLAS(X)
- R-COVEPLAS-2X

**FRONT-ZIP UNIONALLS**

**WHITE PLASTIC**

- 2-UNIOPLAS-S
- 2-UNIOPLAS-M
- 2-UNIOPLAS-L
- 2-UNIOPLAS-XL
- 2-UNIOPLAS-XXL

**CLEAR PLASTIC**

- R-UNIOPLAS(S)
- R-UNIOPLAS(M)
- R-UNIOPLAS(L)
- R-UNIOPLAS(XL)
- R-UNIOPLAS(XXL)

**INFANT UNIONALLS**

**CLEAR PLASTIC**

- 2-UNIOPLAS-INF

**SLEEVES**

**2-SLEEPLAS**

white plastic sleeves, pair

**R-SLEEPLAS**

clear plastic sleeves, pair

**FULL-ZIP UNIONALLS**

Unique full-zip entry allows for easier dressing. The zipper starts in the middle of the torso (like the front-zip unionalls) and curves to extend fully down the left leg. Available in clear or white.

**WHITE PLASTIC**

- R-UNIOFULLW-L
- R-UNIOFULLW-XL
- R-UNIOFULLW-2X
- R-UNIOFULLW-3X
- R-UNIOFULLW-4X

**CLEAR PLASTIC**

- R-UNIOFULLC-L
- R-UNIOFULLC-XL
- R-UNIOFULLC-2X
- R-UNIOFULLC-3X
- R-UNIOFULLC-4X



Sleeves



Front-zip Unionalls



Coveralls



Pants



Stockings



Capri Pants





**NITRILE EXAMINATION GLOVES**

Nitrile Examination Gloves are the economical choice. The gloves are non-sterile, ambidextrous, and contain no natural rubber latex.

- 2-GLOVDERM-S 100 count box
- 2-GLOVDERM-M 100 count box
- 2-GLOVDERM-L 100 count box
- 2-GLOVDERM-XL 100 count box

**GLOVEWORKS HD LATEX INDUSTRIAL GLOVES**

Premium Latex, powder free, 8 mils thick, polymer coated, single use gloves with a beaded cuff.

- 2-GLOVIL-S 100 count box
- 2-GLOVIL-M 100 count box
- 2-GLOVIL-L 100 count box
- 2-GLOVIL-XL 100 count box

**MICROFLEX SAFE GRIP GLOVES**

One of the most popular gloves used by embalmers, designed for increased protection in hazardous environments. They offer good tactile sensitivity at the fingertips, long cuffs to protect wrist and forearms, are powder-free, and ambidextrous.

- 2-GLOVMFSG-S 50 count box
- 2-GLOVMFSG-M 50 count box
- 2-GLOVMFSG-L 50 count box
- 2-GLOVMFSG-XL 50 count box



**GLOVEPLUS HD BLUE LATEX EXAM GLOVES**

Premium latex, powder free, 13 mils thick, chlorinated, single use gloves with a beaded cuff.

- 2-GLOVGPL-M 50 count box
- 2-GLOVGPL-L 50 count box
- 2-GLOVGPL-XL 50 count box

**GLOVEPLUS HD HEAVY DUTY NITRILE EXAM GLOVES**

Premium latex free and powder free, 8 mils thick, polymer coated, single use, nitrile gloves with a beaded cuff.

- 2-GLOVGPN-M 50 count box
- 2-GLOVGPN-L 50 count box
- 2-GLOVGPN-XL 50 count box

**PALLBEARER GLOVES**

White cotton pallbearer gloves. Available with or without snaps.

- 2-GLOVPALL01 plain, 12 pair per box
- 2-GLOVPALL02 snaps, 12 pair per box



**HEAVY-DUTY BODY BAG**

Heavy-duty pouch with 6 nylon handles and 140" (3.6 m) zipper that allows the flap to fold over flat. The pouch measures 90" x 36" (229 x 91.4 cm) and is made of 20 mil black vinyl with corner rivets and guaranteed 1/4" (6.35 mm) seals.

**2-POUCBP402** available each



**DISPOSABLE BODY BAG**

Disposable body bags are constructed of white, 8 mil, high-grade, vinyl with heavy duty, rust-proof, curved zippers. Bags are individually packed, include 3 ID tags, and have a weight capacity of 450 lb / (204 kg).

**\*\*\*Our design conforms to OSHA's Universal Precautions regarding containment of body fluids and protection from blood-borne pathogens**

**2-POUCML** available each  
**2-POUCML-XL** available each



**ECONOMY BODY BAG**

Economy Body Bags are constructed from the finest American-made vinyl and are electronically sealed for secure containment of body fluids. They will not deteriorate or mildew under normal conditions. The bags are 38" x 96" (97 cm x 244 cm) and feature the exclusive "Zipper Lock Loop".

**2-POUCECON-W** white economy pouch, each



**#335 FIRST CALL POUCH**

This pouch has a full length zipper and complete bottom. It fits all One-Man Cots, standard ambulance cots and basket-type stretchers. Pouch is held securely with snap fastener tabs. You can also request a removable lining. Specify leatherette or velour fabric. Available in black, burgundy, or gray leatherette or burgundy, blue or gray velour.

**R-POUC335(L)** leatherette  
**R-POUC335(V)** velour

**MORTUARY COT COVERS**

Our mortuary cot covers are made with our Hi-Lustre drapery material. The covers are available in Burgundy, Green or Blue. 84" x 24" x 11" (213 cm x 63.5 cm x 28 cm) or custom size.

**5-COVECOT-R** plain, burgundy  
**5-COVECOT-G** plain, green  
**5-COVECOT-B** plain, blue



Paulex Powder is an excellent product to add to a body bag to aid in odor control and preservation.

**SHOP PAULEX POWDER ON PAGE 18**





### FERNO MODEL 23 ROLL-IN STYLE ONE-MAN MORTUARY COT

The Model 23 is a one-person cot that can also be used as a two-wheeled stretcher. The cot features a convenient undercarriage release lever and a leg lock lever for ease of use. Two quick-release restraint straps and one burgundy mattress included.

#### SPECIFICATIONS:

75 3/4" x 20" x 32" (max height) / (192 x 51 x 81 cm)  
 75 3/4" x 20" x 8.5" (min height) / (192 x 51 x 22 cm)  
 Load Height: 26" / (66 cm)  
 Weight: 48 lbs. / (27 kg)  
 Capacity: 400 lbs. / (181 kg)

**R-COT23** available each



### FERNO MODEL 24 MULTI-LEVEL ONE-MAN MORTUARY COT

The Model 24 features six levels that make one-person removals easy. One person can adjust the height with the body in place by using the special release levers. Two quick-release restraint straps and one burgundy mattress included.

#### SPECIFICATIONS:

77" x 20 1/2" x 32 1/4" (max height) (196 x 52 x 82 cm)  
 77" x 20 1/2" x 9 1/4" (min height) (196 x 52 x 23.5 cm)

#### R-COT24

Loading Height: 24" / (61 cm)  
 Weight: 54 lbs. / (24.5 kg)  
 Capacity: 400 lbs. / (181 kg)

#### R-COT24H

Loading Height: 31" / (79 cm)  
 Weight: 54 lbs. / (24.5 kg)  
 Capacity: 400 lbs. / (181 kg)

**R-COT24** available each  
**R-COT24H** accommodates high floor vehicles, available each



### FERNO MODEL 27-1 FIRST CALL MORTUARY COT

The Model 27-1 is the most maneuverable cot we offer. It has 4 swivel wheels and a tapered head end that allow you to navigate through tight corners. The loading end has a folding section that shortens the cot by 15" (38 cm). The multi-level undercarriage allows for height adjustments. Two quick-release straps and one burgundy mattress included.

#### SPECIFICATIONS:

78 3/4" x 22" x 33 1/2" (max height) (200 x 56 x 85 cm)  
 78 3/4" x 22" x 9" (min height) (200 x 56 x 23 cm)  
 Load Height: 26" / (66 cm)  
 Weight: 59 lbs. / (27 kg)  
 Capacity: 400 lbs. / (181 kg)

**R-COT27-1** available each  
**R-COT27-1(SR)** Cot with side rails



### FERNO MODEL 24-MAXX MULTI-LEVEL MORTUARY COT

Has an unique, independent-leg design, wider surface, and oversized wheels, the 24-MAXX allows you to transport bodies weighing up to 1,000 pounds while reducing the risk of back injuries. The cot allows for easy maneuverability in tight areas and down stairs, and has a powder-coated frame and stylish design.

#### DIMENSIONS:

76" x 26" x 40" (max height) (192 x 66 x 100 cm)  
 76" x 26" x 14" (min height) (192 x 66 x 34 cm)  
 Loading Height: 26" / (66 cm)  
 Weight: 74 lbs. / (34 kg)  
 Capacity: 1000 lbs. / (450 kg)

**R-COT24MAXX** available each



**FLX-A-POST FUNERAL FLAG**

Magnetic funeral flags that will cling to all metal and most vinyl tops. Available with many options. Custom designs are available, for extra charge. Specify standard flag or lead car flag.

**2-FLAGFLX** (shown)  
flag complete with purple funeral banner

**2-FLAGFLX-O** (shown)  
flag complete with orange funeral banner

**R-FLAGFLX**  
flag complete, specify banner

**2-FLAGFLX-S**  
flag complete with custom banner



**PLASTIC FLAG COVERS**

Available in two styles: clear plastic or Deluxe red, white, and blue.

**2-COVEFLAG**      clear, plain  
**2-COVEFLAG-D**    deluxe, plain



**BEXINERARY CONTAINER**

(Temporary Urn Container)

The Frigid Bexinerary Container is a simplistic, useful container with a large capacity. The container is 6" (15 cm) in diameter, 6 3/4" (17 cm) in height, with an overall volume of 3113 cm<sup>3</sup>. It features a sturdy steel construction with a gold enamel finish and an air-tight lid. Comes with a wood-grain cardboard shipping container.

**2-BEXICOMP**      available 24 per case



**DISPOSABLE POLYSTYRENE HEADREST**

Inexpensive disposable headrest. Perfect for AIDS, Hepatitis, and Herpes cases.

**2-ADJUBLOC-D**  
available individually or 24 case



**RUBBER HEAD BLOCK**

Durable black rubber headrest that can be used as an arm or leg rest as well as a dressing block.

**2-ADJUBLOC-B**      available each



**RUBBER WEDGE-EASE BODY SUPPORTS**

The unique shape of Wedge-Ease Body Supports allow for different body shapes with no sharp edges to promote maximum circulation. Designed to be used as a set of 6 support under the legs, buttocks, back and arms.

**2-BODYWEDG2**      2 pieces



**FRIGID MODEL 1491  
UTILITY TRUCK**

The Frigid 1491 Utility Truck is a rugged workhorse designed to give you years of heavy-duty service. Its welded steel frame and extra heavy-duty forks allow this truck to move even the heaviest loads. The 1491 is built with four 8" (20 cm) wheels allowing for easy maneuverability over bumps and cracks. Each post is topped with a rubber bumper to protect load from scratches. The following dimensions are standard, but can be changed to your specifications.

**DIMENSIONS:** 37" x 20" x 20" (94 x 49 x 49cm)  
**WEIGHT:** 45 lbs. / (20 kg)  
**CAPACITY:** 1000 lbs. / (454 kg)

**3-UTC1491S** available each



**FERNO MODEL 87**

The Ferno 87 Church Truck is a lightweight truck that can be set to 4 different lengths to meet all your needs. The rectangular aluminum tubing has an anodized finish that is easy to clean. Its 6" rubber tires roll over obstacles easily and silently. Available with foldout handles to help you carry over large obstacles such as curbs.

**R-TRUC87A** silver  
**R-TRUC87B** bronze  
**R-TRUC87O** onyx  
**R-TRUC87G** gold  
**R-TRUC87H** with fold-out handles  
**R-DRAPFERN(87)** drape, specify color



**FERNO MODEL 88**

The Ferno 88 Church Truck is for those who like a smaller truck. It looks and performs like the 87, but it is shorter in length and has only 3 positions. Available with foldout handles.

**R-TRUC88S** silver  
**R-TRUC88B** bronze  
**R-TRUC88BG** blue-gray  
**R-TRUC88G** gold  
**R-TRUC88H** with fold-out handles  
**R-DRAPFERN(88)** drape, specify color



**HYDRAULIC BODY AND  
CASKET LIFTER**

Extra heavy-duty casket and body lifter will easily handle up to 1000 lbs. With its nine 4" swivel casters, you can maneuver this body lifter through a doorway with ease.

**DIMENSIONS:** 30"x30"x36"/(76cm x 76cm x 91cm)

**WEIGHT:** 190 lbs. / (86.2 kg)  
**CAPACITY:** 1000 lbs. / (453.6 kg)  
**BODY STRAPS:** 4  
**CASKET STRAPS:** 2

**R-LIFTHYDR(S1)** available each



**ADJUSTABLE BODY STRAPS**

**R-STRALIFT(SJ4)** Set of four with hardware  
**R-STRALIFT(SJ)** Set of two



## LOWERING DEVICES AND CEMETERY EQUIPMENT



### THE ORIGINAL. THE BEST.

Frigid Fluid Co. revolutionized the death care industry when it introduced the automatic casket lowering device to market in 1914.

Since its appearance, Frigid has continued to improve upon the original model by adding new features and upgraded materials allowed by advancements in metallurgy and machining techniques.

Frigid devices continue to be manufactured and hand-assembled in Illinois to provide direct quality control and adherence to high standards.

Frigid remains the market leader of precision lowering devices constructed with the highest quality materials for durability, reliability and longevity of operation.

## STREAMLINED DESIGN, INHERENT QUALITY AND MASTER WORKMANSHIP, PRICELESS INGREDIENTS YOU FIND ONLY IN A FRIGID DEVICE.

### ALL FRIGID LOWERING DEVICES FEATURE:

- Sealed, self-lubricating bearings
- Modular design provides compact size for transport and storage
- High quality tempered steel and bronze precision gearing
- High quality ISO-9001 certified stainless steel tubing
- Sturdy, polished aluminum heads for fail-safe housing of all moving parts
- Custom, hand-made, governor to maintain a smooth, controlled lowering speed
- Adjustable braking system for a variable number of lowering speeds
- Stainless steel hand brake for simple lowering release
- Quiet, durable, low maintenance construction
- Resists corrosion and maintains appearance
- Engineered for reliability, strength, and longevity
- 12-month warranty on parts and labor



3-IMP5506S, Imperial 3-in-1 with telescoping stand and green drape



**IMPERIAL® LOWERING DEVICE**  
3-IMP5502SK

Pictured: 3-IMP5502SK, Imperial basic package

The Frigid Imperial casket lowering device has become a favorite among customers because of its quality of construction and its assurance of performance.

**SPECIFICATIONS**

**ASSEMBLED SIZE:** 58" L x 22" W x 75" H / (147.3 x 55.9 x 19.1 cm)  
**TELESCOPING TO:** 92" L x 34" W x 75" H / (233.7 x 86.4 x 19.1 cm)  
**MAX LOAD BEARING:** 800 lbs / (362 kg)  
 Total unit weight: 90 lbs / (40.8 kg)

LOWERING DEVICE ACCESSORIES



Maintenance Supplies



Device Straps



Lowering Device Protective Covers



Stainless Steel Hand Crank

**DEVICE PACKAGES**

**BASIC PACKAGE - 3-IMP5502SK**

Imperial device, stainless steel crank handle, set of straps.

**PLACER SET PACKAGE - 3-IMP5502SP**

Imperial device, stainless steel crank handle, set of straps, placer set.

**3-IN-1 PACKAGE - 3-IMP5504S/3-IMP5506S**

Regular or telescoping stand, Imperial device, stainless steel crank handle, placer set, and stand drape.

**FUNERAL DIRECTOR OPTION - 3-IMP5503SK**

The Funeral Director option features the same specifications as the Imperial device with the addition of long rails that are designed to break apart and fold in half making it easy to fit in a hearse.

**Folded dimensions of each half:** 42" x 10" x 8"  
(106.7 cm x 25.4 cm x 20.3 cm)

Available in all packages

BASIC PACKAGE



PLACER SET PACKAGE



3-IN-1 PACKAGE



FUNERAL DIRECTOR







Pictured: 3-MAS4903S, Master 3-in-1 Package with telescoping stand and green drape

**MASTER® LOWERING DEVICE**  
3-MAS4901SK

The Frigid Master casket lowering device is a high-grade lowering device specifically designed for everyday heavy-duty use. The load bearing components of the Master are twice the size of those found in the Imperial device, making it the safest and most durable device manufactured by Frigid.

**SPECIFICATIONS**

- ASSEMBLED SIZE:** 58" L x 22" W x 6.5" H / (147.3 x 55.9 x 16.5 cm)
- TELESCOPING TO:** 92" L x 34" W x 6.5" H / (233.7 x 86.4 x 16.5 cm)
- MAX LOAD BEARING:** 1000 lbs / (453 kg)
- TOTAL UNIT WEIGHT:** 125 lbs / (57 kg)

**OVERSIZED SPECIFICATIONS**

- TELESCOPING SIZE:** 98" L x 40" W x 6.5" H / (248.9 x 101.6 x 16.5 cm)
- TOTAL UNIT WEIGHT:** 130 lbs / (59 kg)

**DEVICE PACKAGES**

**BASIC PACKAGE - 3-MAS4901SK**

Master device, stainless steel crank handle, set of straps.

**PLACER SET PACKAGE - 3-MAS4901SP**

Master device, stainless steel crank handle, set of straps, placer set.

**3-IN-1 PACKAGE - 3-MAS4902S/3-MAS4903S**

Regular or telescoping stand, Master device, stainless steel crank handle, placer set, and stand drape.

**FUNERAL DIRECTOR OPTION - 3-MAS4900SK**

The Funeral Director option features the same specifications as the Master Device with the addition of long rails that are designed to break apart and fold in half making it easy to fit in a hearse.

**Folded dimensions of each half:** 42" x 10" x 8"  
(106.7 cm x 25.4 cm x 20.3 cm)

Available in all packages

**FRIGID FLUID OVERSIZED MASTER® LOWERING DEVICE**

The Master™ Over-sized device is 6" (15.24 cm) wider than a regular lowering device to accommodate wider caskets, available in all packages.

**BASIC PACKAGE**  
MAS-OVERSIZE

**PLACER SET PACKAGE**  
MAS-OVERSIZE-P

**3-IN-1 PACKAGE**  
REGULAR STAND: MAS-OVERSIZE-R  
TELESCOPING STAND: MAS-OVERSIZE-T





Pictured: 3-IMPINF/URN-3, includes device, stand, board and drape

## INFANT/URN LOWERING DEVICE

### 3-IMPINF/URN-3

The Infant/Urnlowering device offers the strength and beauty of our traditional casket lowering devices, yet in a unique smaller version. The Infant/Urnlowering device incorporates the same easy release hand brake mechanism as our casket lowering devices, allowing for a one-man operation.

#### STURDY ALUMINUM AND STAINLESS STEEL BODY

- Resists corrosion and maintains appearance.
- Provides strength and durability.

#### RUGGED MECHANISM

- Quality steel and bronze – not nylon or plastic.
- Precision tooled for smooth, quiet operation.
- Engineered for reliability and longevity.

#### MODULAR DESIGN

- Compact shipping and storage.
- Easy assembly and disassembly.
- Simplified cleaning and maintenance.

#### SPECIFICATIONS

**ASSEMBLED SIZE:** 40" L x 14" W x 7.5" H / (157.5 x 66.0 x 19.1 cm)

**TELESCOPING TO:** 40" L x 24" W x 7.5" H / (238.8 x 96.5 x 19.1 cm)

**MAX LOAD BEARING:** 800 lbs / (453 kg)

**DEVICE WEIGHT:** 62 lbs / (28 kg)

**BOARD DIMENSIONS:** 48" L x 32" W x 1" H / (121.9 x 81.3 x 2.54 cm)

**STAND DIMENSIONS:** 51" L x 34" W x 14" H / (129.5 x 86.4 x 35.6 cm)

**ASSEMBLED SETUP:** 51" L x 34" W x 21" H / (129.5 x 86.4 x 53.34 cm)

**FULL SETUP WEIGHT:** 109 lbs / (49.4 kg)

#### 3-IMPINF/URN-3

Infant/Urnlowering device, stand, board, and drape



Child casket set up with device, stand, and drape (casket by Cherokee Child Casket Company)



Full Infant/Urnlowering set up with device, stand, board and drape



DRAPE COLOR OPTIONS



Pictured: Streamliner and Master device with Placer Set Package

## STREAMLINER MOBILE SET-UP CART

Regular: 3-STRM614 / Oversized: 3-STRM614O

The Streamliner is designed to work best when paired with a Frigid casket lowering device with placer set, giving you a gravesite setup that is both safe and completely mobile.

### STREAMLINER FEATURES

- The Streamliner enables your setup to remain intact between burials.
- The tow bar is removable, allowing skirting to be attached.
- The Streamliner will relieve strain on the pallbearers' backs, while two wheel brakes and wheel locks ensure that each burial takes place without mishap.
- Consistent use of the Streamliner Mobile Stand & Casket Carrier will lengthen the life of your Frigid lowering device by protecting it from drops and other accidents.
- The Streamliner ships complete with tow bar and one pair of steel channels. The drape comes in three colors and is available at an extra charge.
- Oversize option available. Frame is 6 inches wider to accommodate the Master Oversize device.

### SPECIFICATIONS

**DIMENSIONS:** 112" x 53" x 23" / (284.5 x 134.6 x 58.4 cm)

**WEIGHT:** 420 lbs / (191 kg)

**MAX LOAD BEARING:** 1000 lbs / (453 kg)

**3-STRM614**

Regular Frigid Streamliner

**3-STRM614O**

Oversized Frigid Streamliner

**5-DRP616**

green single-faced drape for Streamliner

**5-COVESTRM**

canvas cover for Streamliner

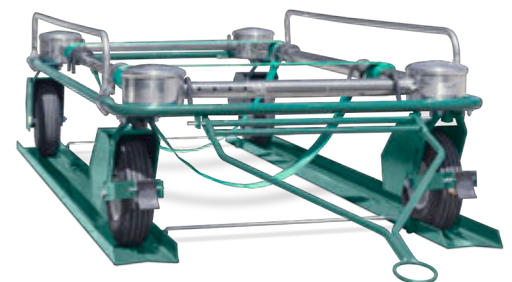

OVERSIZED OPTION AVAILABLE!



FRIGID STREAMLINER COVER  
5-COVESTRM



Easily attaches to a trailer hitch for transport around the cemetery, (keep under 15 mph / 24 kph)



### FRIGID REGULAR STAND

The original lowering device stand provides a sturdy base for the display of your casket lowering device during service. It stands 14" high and is made with stainless steel corner post tubing. All other tubing is polished aluminum. Weight: 50 lbs / (23 kg).

**3-STD1011S**

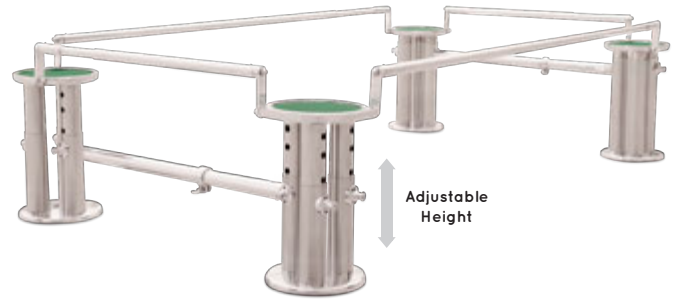

### FRIGID TELESCOPING STAND

Constructed of the same materials as the regular lowering device stand, the telescoping model is fully adjustable for hillside setup. One end of the telescoping stand adjusts from 10" to 18" (25.4 cm to 45.8 cm) while the other end adjusts from 14" to 26" (35.6 cm to 66 cm). Weight: 95 lbs / (43 kg).

**3-STD1007S**



DRAPE COLOR OPTIONS



DRAPE COLOR OPTIONS



### FOUR PIECE SINGLE-FACED

Designed for our non-telescoping device stand.

**5-DRP1062**

### ONE PIECE WRAP AROUND

One piece wrap around drapes feature a spring and Velcro tabs. It can be used on a regular stand to speed up setup time and increase efficiency.

**5-DRP1063** Single Faced  
**5-DRP1063D** Double Faced

### FULL DEVICE COVER

Save dollars in repairs and re-polishing by protecting your investment. The Frigid Full Device Cover is made of heavy-duty canvas and reinforced with extra heavy-duty canvas at the device corner heads. Featuring four handles for easy carrying, this is an effective way to keep your device in tip-top shape!

**5-COVEBOX-I** Imperial  
**5-COVEBOX-M** Master

\*\*\* Device drapes are available in burgundy, blue and green Hi-Lustre drapery material



**FRIGID DEVICE HEAD COVERS**

The perfect product to keep your Frigid lowering device looking like new! Comes in sturdy black plastic and green canvas, they fit snugly over the corner heads to protect against scratches and wear. Sold in sets of 4.

- 3-COVEHEAD-IMP** Imperial, Plastic
- 3-COVEHEAD-MAS** Master, Plastic
- 5-HTB400-C** Master, Canvas
- 5-HTB500-C** Imperial, Canvas



5'6" in length



Optional carrying case



**CASKET GUIDE RODS**

Six steel rods to hook to device side rails to safely guide the lowering process of the casket into the grave vault. Casket Guide Rods are 5'6" in length.

- 4-CASKROD** 6 per set

**CASKA-ROL PLACER BARS**

The Caska-Rol Placer combines top-quality construction with safety and convenience. Its sturdy rubber rollers have been spaced precisely so that all standard caskets will roll smoothly without drag. Set of 3 bars with an adjustable brake included.

- 2-CASKROL-P** Set of 3 Caska-Rol Placer Bars
- 5-BAGCSKROL** Optional Carrying Case

**DEVICE CRANK HANDLE**

Frigid lowering device Crank Handle features strong construction to prevent bending. Works with Imperial, Master and Standard model devices.

- 4-HTB100** Stainless Steel Crank Handle
- 4-HTB100W** Wooden Device Crank Handle



### LOWERING DEVICE STRAPS

Frigid lowering device straps are 3 7/8" (9.8 cm) wide and are available in both green and black poly heat-sealed, nylon webbing. Available in green or black. Sold in pairs.

**5-STR789**

15 feet (4.6 m) for a 6 foot (1.8 m) grave

**5-STR791**

20 feet (6.1 m) for an 8 foot (2.4 m) grave

**5-STR793**

25 feet (7.6 m) for a 10 foot (3.0 m) grave

**5-STR795**

30 feet (9.1 m) for a 12 foot (3.7 m) grave

*\*\*\*Our straps have a proven breaking strength of 2000 pounds / (907.2 kg) each.*

### LOWERING DEVICE REINFORCED STRAPS

Frigid reinforced straps are made from 3 7/8" (9.8 cm) wide, poly heat-sealed, nylon webbing. The center 5 feet section of the straps are reinforced with a double-ply material. This provides extra security and support for caskets. Available in both green and black colors. Sold in pairs.

**5-STR789R**

15 feet (4.6 m) for a 6 foot (1.8 m) grave

**5-STR791R**

20 feet (6.1 m) for an 8 foot (2.4 m) grave

**5-STR793R**

25 feet (7.6 m) for a 10 foot (3.0 m) grave

**5-STR795R**

30 feet (9.1 m) for a 12 foot (3.7 m) grave

### CONNECTING SHORT STRAPS

Sold in sets of four. Available in green or black colors

**5-STR SHORT**

**AVAILABLE IN A FULL DEVICE SET**  
*INCLUDES - 2 LONG STRAPS AND 4 SHORT SHORTS*



### SAFETY STRAP

Our safety straps are made of the same poly heat-sealed nylon webbing as our lowering device straps. Safety straps include zinc plated steel hooks on both ends. Overall length of hook and strap is 56" / (142.2 cm). Strap alone measures 48" / (121.9 cm). Available in green and black and also in custom lengths.

**5-STR760**

### SAFETY CHAINS

Each of the two steel machine chains are rated as a 545 lbs. load capacity. Overall length of hook and chain is 68" / (172.7 cm). Chain alone measures 54" / (137.2 cm).

**3-SAF766**

### POLISHED SAFETY BAR

1.5" / (3.8 cm) wide and 3/8" / (0.95 cm) thick polished stainless steel safety bar. The bars will accommodate up to a 38" / (96.5 cm) lowering device width. Safety bars provide a level, accident free presentation of the casket during the graveside service. Three safety bars are recommended to support a casket.

**3-SAFB767**



DRAPE COLOR OPTIONS



DRAPE COLOR OPTIONS



**FRIGID URN DISPLAY STAND**

The Frigid Urn Display Stand adds elegance to any display. Its large 25" x 25" (63.5 x 63.5 cm) surface allows for urns of any size and shape.

**Dimensions:** 25" x 25" x 28" / (63.5 x 63.5 x 72.1 cm)  
**Weight:** 6.2 lbs. / (2.8 kg)  
**Capacity:** 60 lbs. / (27.2 kg)

**3-URNDISP01** available each  
**5-DRP1061DRAPE** specify color

**FRIGID HI-LUSTRE CHAIR COVERS**

Our chair covers are made of traditional Hi-Lustre fabric. Machine-wash or dry-clean. Please specify fabric color (burgundy, green or blue), chair style, and size when ordering.

**5-COVECHAI-G**  
**5-COVECHAI-R**  
**5-COVECHAI-B**

Green  
 Red/Burgundy  
 Blue

**CHAIR COVER STORAGE BAGS**

Store chair covers together in a heavy duty canvas bag with draw-string top.

**5-BAGCOVE12**  
 bag for 12 chair covers



**CHAIR STORAGE BAGS**

Store folding chairs in increments of four, five, six, or eight. Makes for easy transport. Each bag is constructed of heavy-duty canvas with heavy duty nylon web handles and closures.

**5-BAGCHAIR4** bag for 4 chairs  
**5-BAGCHAIR5** bag for 5 chairs  
**5-BAGCHAIR6** bag for 6 chairs  
**5-BAGCHAIR8** bag for 8 chairs

**CASKET LOWERING HAND STRAPS**

**5-STR757** 1.5' x 20' / (3.8 cm x 6.1 meters) - cotton  
**5-STR758P** 2" x 20' / (5.1 cm x 6.1 meters) - black poly  
**5-STR758** 2" x 20' / (5.1 cm x 6.1 meters) - cotton  
**5-STR759P** 2" x 30' / (5.1 cm x 9.1 meters) - black poly  
**5-STR759** 2" x 30' / (5.1 cm x 9.1 meters) - cotton

**FRIGID TILE PROBE**

The safe and easy way to "probe" and locate underground objects. Handle and tip included with probe, and are available separately. Can also be ordered in custom lengths.

**3-TILE T** replacement tip  
**3-TILE 4** 4' / (1.2 meters) probe  
**3-TILE 6** 6' / (1.8 meters) probe



### PALLBEARER CASKET CARRIAGE

The Frigid Pallbearer is the best way of providing pallbearers with a dependable method for moving the casket from hearse to gravesite without mishap. Draperies are available for further service enhancement.

**DIMENSIONS:** 72" x 30" / (183 x 76 cm)

**LOAD CAPACITY:** 600 lbs / (272.2 kg)

**WEIGHT:** 240 lbs / (108.9 kg)

**3-PALL1400** Pallbearer  
**5-DRP1400D** Green Pallbearer Drape



### VAULT LID PLACER

The Frigid Vault Lid Placer is a reliable and simple way of moving and placing vault lids around the cemetery. Constructed of strong, welded steel, with a 1,000 lbs. hand operated gear box.

**DIMENSIONS:** 84" x 56" x 32" (213.4 x 142.2 x 81.2 cm)

**LOAD CAPACITY:** 1,000 lbs. / (453.6 kg)

**WEIGHT:** 225 lbs / (102.1 kg)

**3-VLPF58**



### HERCULES LIFT: CONCRETE & STEEL VAULT PLACER

The Hercules is used to raise and lower heavy vaults, assist in exhuming caskets, and position heavy monuments. It is constructed from 1.25" (3.2 cm) square steel tubing, features large 15" / 38.1 cm (rim diameter) wheels, and a ball hitch coupler for easy maneuvering when partnered with a truck.

**LIFTING CAPACITY:** 2300 lbs / (1043 kg)

**DIMENSIONS:** 89" x 55" x 40" / (226.0 cm x 139.7 cm x 101.6 cm)

**INSIDE DIMENSION CLEARANCE:** 90" x 40" x 60" / (229 x 102 x 152 cm)

**WEIGHT:** 480 lbs / (217.7 kg)

**3-HERC122HD**

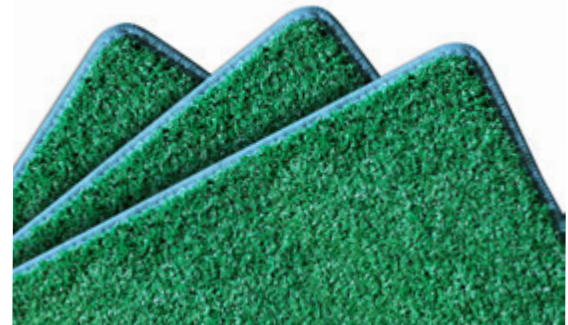

### GRAVESITE GRASS SETS

Frigid's artificial grass is made of a very strong, non-absorbent fibrous material that is easy to keep clean and will last for years of use. The grass features a high-quality duck canvas binding to help the grass blend naturally into the gravesite setup.

**MOUND COVER AND BORDER (NO LINER)** 5-GRASF6P2

12' x 14' (3.7 x 4.3 meters) mound cover (in 2 pieces), two 3' x 8' (0.9 x 2.4 meters) pieces, two 3' x 9' (0.9 x 2.7 meters) pieces.

**GRAVE BORDER** 5-GRASF6P3

Two 3' x 8' (0.9 x 2.4 meters) pieces, two 3' x 9' (0.9 m x 2.7 m) pieces.

**T-Style Liner-Border Combo** 5-GRASF6P6

Two 6' x 8' (1.8 x 2.4 meters) side pieces and two 3' x 9' (0.9 x 2.7 meters) T-end pieces with 3' x 3' (0.9 x 0.9 meters) drops.

**Mound Cover** 5-GRASF6P8

12' x 14' (3.7 x 4.3 meters) cover (in 2 pieces).

**T-Style Set** 5-GRASF6P9

12' x 14' (3.7 x 4.3 meters) mound cover (in 2 pieces), two 6' x 8' (1.8 x 2.4 meters) side pieces and two 3' x 9' (0.9 x 2.7 meters) T-end pieces with 3' x 3' (0.9 x 0.9 meters) drops.

**Custom Sizes** 5-GRASPOLYD

Custom sizes also available!



**CLASSIC 15 X 15**

The Classic 15' x 15' / (4.57 x 4.57 meters) quick assembly, folding tent. All metal components and superior fabric top. Reinforced with top grain cow hide for increased durability with 85% stronger yokes and flanges for extra support. Snug fit upper with dependable corner pieces. Guaranteed to be rust-free. Made in America.

**R-TENT1515** 15' x 15' Tent / (4.57 x 4.57 meters)

**OVAL FUNERAL TENT**

Oval Funeral Tents are known for their quality of construction and ease of assembly. Available in various colors and designs. Offer other modular options. Made in America.

**R-TENTOVAL**

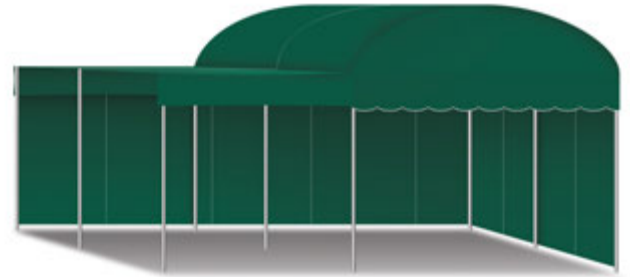
**ROLL AROUND**

The Roll Around is a 14' x 16' (4.27 x 4.88 meters) Canvas Funeral Chapel Tent on wheels. It is simple to install and all parts are assembly-ready, with convenient zinc plated components to combat corrosion. Comes with guaranteed no-flat tires that are also zinc plated for increased durability. The Roll Around is light weight and easy to use by hand. It also comes equipped with a universal hitch and a possible reversible tow package with upgrade. Available in a variety of canvas colors, comprised of top grain leather, reinforced canvas and galvanized steel. Made in America.

**R-TENTROLLA**

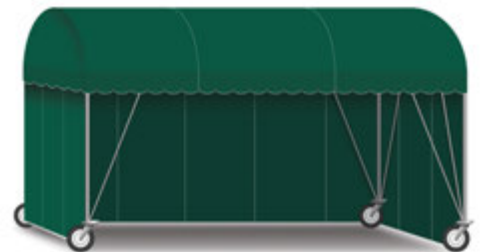



### STAINLESS LOT MARKERS

Embossed stainless steel marking discs with cast iron pins. Factory numbering is available for an extra charge.

- R-MARKW/OP35** 3.5" / (8.9 cm) D, no pin
- R-MARKW/OP45** 4.5" / (11.4 cm) D, no pin
- R-MARKWP35** 3.5" / (8.9 cm) D, with pin
- R-MARKWP45** 4.5" / (11.4 cm) D, with pin



### LAKESHORE CAST MARKERS

Lakeshore cast aluminum lot markers are available blank or imprinted with letters and/or numbers for an extra charge per character.

- R-MARKLOT3R** 3" round top, 8" integrally cast 3-spline stake. Max 3 characters.
- R-MARKLOT3X6R** 3" x 6" rectangular, 11" integrally cast 3-spline stake
- R-MARKLOT4R11** 4" round top, 11" integrally cast 3-spline stake
- R-MARKLOT4R8** 4" round top, 8" integrally cast galvanized spike
- R-MARKLOT4X20** 4" x 2" oval top, 8" integrally cast galvanized spike
- R-MARKLOT4X7R** 4" x 7" rectangular, 11" integrally cast 3-spline stake
- R-MARKLOT5S11** 5" square top, 11" integrally cast 3-spline stake
- R-MARKLOT5S8** 5" square top, 8" integrally cast galvanized spike
- R-MARKTEMP** 4" square plastic top, 8" galvanized spike



### NORMAN GRAVE MARKERS

Norman grave markers are constructed of hot-dipped galvanized steel and come with virtually unbreakable acrylic card covers.

- R-MARKCRTL** Crown tilted marker, tilted stake, 16 5/8" / (43.2 cm) H, card opening 2 3/8" x 4 5/8" / (6.0 x 11.7 cm), 25/box.
- R-MARKSURF** Surface marker, 5" x 7 1/4" (12.7 x 18.4 cm), card opening 2 3/8" x 4 5/8" / (6.0 x 11.7 cm), 25/box.

Markers come in grey, green or black.



### MCNEIL GRAVE MARKERS

- R-MARKER700** All aluminum, no glass, write-in info on aluminum insert with ballpoint pen, 36/box
- R-MARKER900** Aluminum, 8 1/2" x 4 5/8" / (21.6 x 11.7 cm) top, 15 3/4" (40.0 cm) stake, includes assortment of letters & numbers, 36/box.
- R-MARKERC166** Cast chrome, 4 1/2" x 8 1/2" / (11.4 x 21.6 cm) top, 15 3/4" (40.0 cm) stake, assortment of letters & numbers, 25/box.

All markers are available imprinted with your firm's name.

**SPARTAN VASES**

Half-exposed when open, the SPARTAN vases are available in three finishes and choices of a zinc casing or a 4 1/2" diameter polycasing. Extra-heavy die-cast zinc vase will not float when reversed in casing even if turf is flooded. Vase measures 7 3/4" high x 4" diameter.



**ZINC VASE & CASING  
BRONZE ENAMEL**

R-VASE7BP - polycasing  
R-VASE7BZ - zinc casing



**ZINC VASE & CASING  
GREY ENAMEL**

R-VASE7GP - polycasing  
R-VASE7GZ - zinc casing



**ZINC VASE & ZINC CASING  
BRONZE TEXTURED**

R-VASE7TT - zinc casing

**GRECIAN VASES**

Fully exposed when open, the GRECIAN series case vases are available in four handsome finishes and include a 5" diameter stainless steel casing with a locking ring at the top. Guard chains are optional. Vase stands 8 1/2" high when open.



**ZINC VASE & STAINLESS  
STEEL CASING - BROWN  
EPOXY**

R-VASE9ES - vase & casing



**ZINC VASE & STAINLESS  
STEEL CASING - BRONZE  
POWDER COAT**

R-VASE9BS - vase & casing



**ZINC VASE & STAINLESS  
STEEL CASING - GREY  
POWDER COAT**

R-VASE9GS - vase & casing



**ZINC VASE & STAINLESS  
STEEL CASING - BRONZE  
TEXTURED**

R-VASE9TS - vase & casing

**UTILITY VASES**

Simplicity means economy and durability with these ground level vases. Use with single or double wall polycasings to add longevity to the units.



**GALVANIZED VASE &  
CASING, 7" DEPTH**

R-VASE1GG7 - vase & casing



**GALVANIZED VASE & SINGLE  
WALL POLYCASING, 8" DEPTH  
- GREY**

R-VASE2GP8 - vase & casing



**GALVANIZED VASE & CASING,  
8" DEPTH**

R-VASE1GG8 - vase & casing



**GALVANIZED VASE & DOUBLE  
WALL POLYCASING, 8"  
DEPTH, - BROWN**

R-VASE3GP8 - vase & casing

**THRIFTY VASES**

Available as ground level or half-exposed when open, the THRIFTY series cast zinc vases provide maximum economy with durability. Handy finger holes also facilitate bouquet tie-downs for high wind seasons. Vase measures 7 3/4" high x 3 3/4" diameter. Casing will fit into a 4 1/4" marker coring.



**ZINC VASE & SINGLE WALL  
POLYCASING, - BRONZE  
ENAMEL**

R-VASE4BP - half-exposed  
R-VASE8BP - ground-level



**ZINC VASE & SINGLE WALL  
POLYCASING - BRONZE  
TEXTURED**

R-VASE4TP - half-exposed  
R-VASE8TP - ground-level



**ZINC VASE & SINGLE WALL  
POLYCASING, - BRONZE  
ENAMEL**

R-VASE4BP - half-exposed  
R-VASE8BP - ground-level

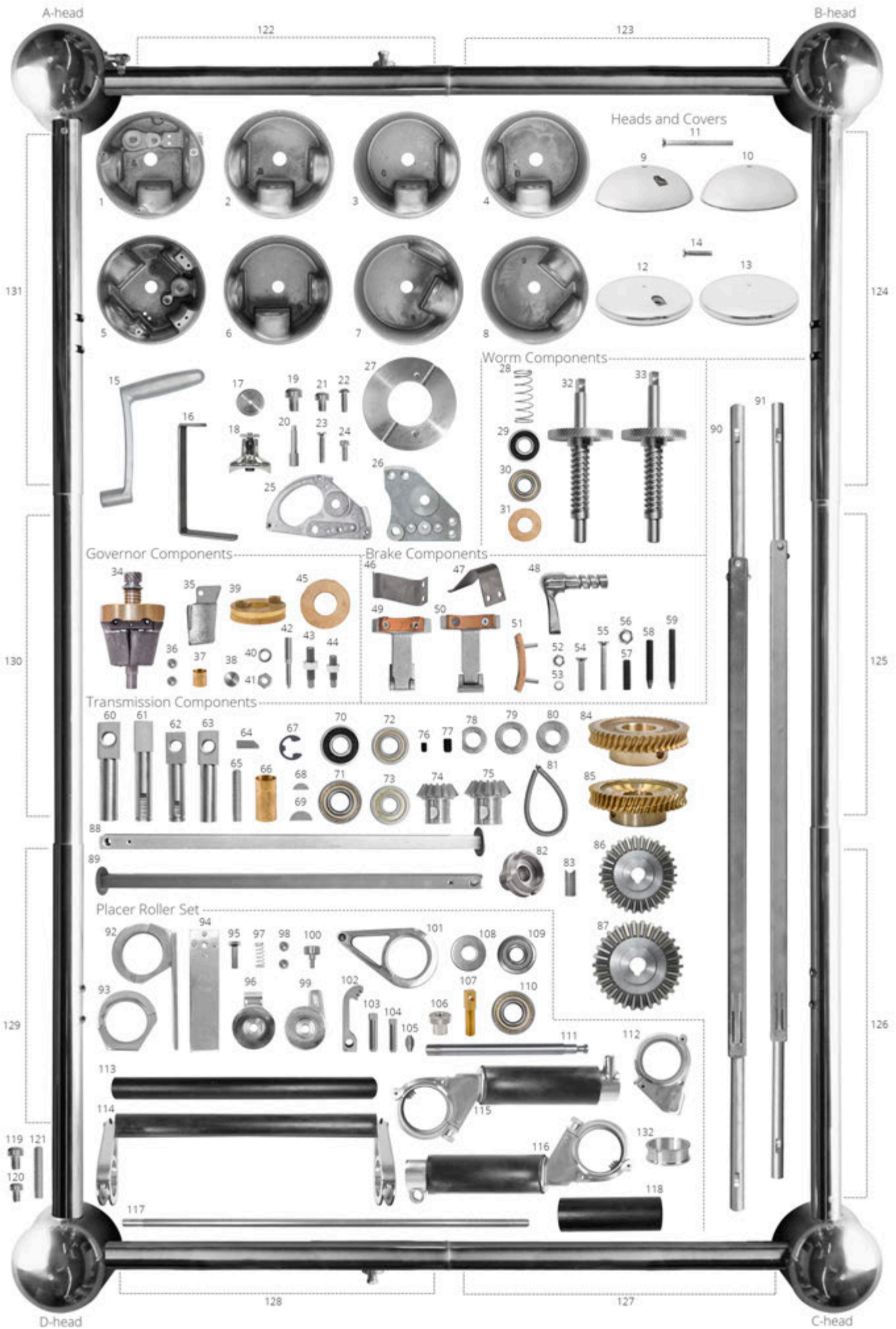

## LOWERING DEVICE REPLACEMENT PARTS

### REPLACEMENT PARTS FOR FRIGID IMPERIAL AND MASTER MODEL DEVICES



#### HEADS AND COVERS

1.	4-HTB551-A	Imperial A Head
2.	4-HTB552-B	Imperial B Head
3.	4-HTB553-C	Imperial C Head
4.	4-HTB554-D	Imperial D Head
5.	4-HTB491-A	Master A Head
6.	4-HTB492-B	Master B Head
7.	4-HTB493-C	Master C Head
8.	4-HTB494-D	Master D Head
9.	4-HTB555-A	Imperial A Head Cover
10.	4-HTB556-BCD	Imperial BCD Head Cover
11.	4-HTB559	Imperial Head Cap Retaining Screw
12.	4-HTB495-A	Master A Head Cover
13.	4-HTB496-BCD	Master BCD Head Cover
14.	4-HTB479	Master Head Cap Retaining Screw
15.	4-HTB100	Hand Crank For Lowering Device
16.	4-HTB202	Head Cap Retaining Bracket
17.	4-HTB201	Head Cap Retaining Plug
18.	4-HTB88	Tubing Lock Complete
19.	4-HTB76-L	Tubing Collar Screw For Long Link
20.	4-HTB88-2	Tubing Lock Plunger
21.	4-HTB76-2S	Tubing Collar Screw
22.	4-HTB203	Head Cap Retaining Plug Screw
23.	4-HTB60I	Screw for Imperial Spider Plate
24.	4-HTB60M	Screw for Master Spider Plate
25.	4-HTB59I	Imperial Spider Plate
26.	4-HTB59M	Master Spider Plate
27.	4-FLA1	T-Rail Adapters/Wilbert Way Flanges

#### WORM COMPONENTS

28.	4-WRM25	Spring for Sand Protector
29.	4-WRM300	Bearing for Bottom of Worm/Helical Gear
30.	4-WRM301	Bearing for Top of Worm/Helical Gear
31.	4-WRM24	Sand Protector Leather Washer
32.	4-WRM22/26M	Master Worm/Helical Gear Assembly
33.	4-WRM22/26I	Imperial Worm/Helical Gear Assembly

#### GOVERNOR COMPONENTS

34.	4-GOV92	Governor Assembly Complete
35.	4-GOV45	Governor Link with Weight
36.	4-GOV20	Steel Balls for Bottom and Top of Gov.
37.	4-GOV19	Governor Shaft Bushing
38.	4-GOV21	Governor Steel Truss Bearing
39.	4-GOV47	Governor Brake with Leather
40.	4-GOV228	Governor Brake Stud Washer
41.	4-GOV227	Governor Brake Stud Nut
42.	4-GOV50	Governor Brake Stud
43.	4-GOV91IMP	Governor Set Screw with Nut (Imperial)
44.	4-GOV91MAS	Governor Set Screw with Nut (Master)
45.	4-GOV48	Governor Brake Leather Disc

#### BRAKE COMPONENTS

46.	4-BRK178I	Imperial Hand Brake Spring
47.	4-BRK178M	Master Hand Brake Spring
48.	4-BRK57	Hand Brake Handle and Shaft
49.	4-BRK179M	Master Brake Stand Assembly
50.	4-BRK179I	Imperial Brake Stand Assembly
51.	4-BRK177	Brake Stand Leather with Screws
52.	4-GOV227	Gov. Brake Stud Nut/Brake Stand Base Nut
53.	4-BRK231	Brake Stand Base Screw Washer
54.	4-BRK232M	Master Brake Stand Base Screw
55.	4-BRK232I	Imperial Brake Stand Base Screw
56.	4-BRK171	Hex Nut for Brake Set Screws
57.	4-BRK170M	Brake Shaft Plunger Stud
58.	4-BRK169M	Brake Shaft Spiral Set Screw for Master
59.	4-BRK169I	Brake Shaft Spiral Set Screw for Imperial

#### TRANSMISSION COMPONENTS

60.	4-TRN162CTM	Master Tail End Short Link
61.	4-TRN162CHM	Master Head End Short Link
62.	4-TRN162CHI	Imperial Head End Short Link
63.	4-TRN162CTI	Imperial Tail End Short Link
64.	4-TRN242M	Straight Key for Master Bevel Gear
65.	4-TRN163	Short Link Screw for Connecting the Side of Rail to the Head

#### TRANSMISSION COMPONENTS (CONT.)

66.	4-TRN304MB	Brass Bushing for Master Short Link
67.	4-TRN244	E-Ring for Bevel Gear
68.	4-TRN241I	Woodruff Key for Imperial Bevel and Pinion Gear
69.	4-TRN241M	Woodruff Key for Master Pinion Gear
70.	4-TRN302-M-I	Bearing for Imperial Short Links and Master Bearing Housing
71.	4-TRN304M	Bearing for Master Short Links
72.	4-TRN303M	Bearing for Master Transmission Shafts
73.	4-TRN302-1-I	Bearing for Imperial Bearing Housing and Transmission Shafts
74.	4-TRN31I	Imperial Pinion Gear
75.	4-TRN38M	Master Pinion Gear
76.	4-TRN37	Imperial Transmission Shaft Collar Set Screw
77.	4-TRN37M	Master Transmission Shaft Collar Set Screw
78.	4-TRN36I	Imperial Transmission Shaft Collars for A & B Head
79.	4-TRN36M	Master Transmission Shaft Collars for A & B Head
80.	4-HTB98M	11/16" Short Link Collar for Master C & D Head
81.	4-TRN28	Ratchet Spring for Bronze Worm Gear
82.	4-TRN164	Bearing Housing
83.	4-TRN30	Ratchet Pin for Bronze Worm Gear
84.	4-TRN27M	Master Bronze Worm Gear
85.	4-TRN27I	Imperial Bronze Worm Gear
86.	4-TRN33I	Imperial Bevel Gear
87.	4-TRN33M	Master Bevel Gear
88.	4-HTB161-C-2.0	Side Rail Long Link for Imperial 2.0
89.	4-HTB161-C	Side Rail Long Link
90.	4-TRN78M	Master Transmission Shaft
91.	4-TRN78I	Imperial Transmission Shaft

#### PLACER SET COMPONENTS

92.	3-ESP11	End Stop for Casket Placer Set
93.	4-ESP01	End Stop Clamp
94.	4-ESP09	End Stop Finger
95.	4-ESP10	End Stop Finger Screw
96.	4-PLC15	Placer Support Bushing
97.	4-ESP07	End Stop Spring
98.	4-ESP08	End Stop Steel Balls
99.	4-PLC16	Placer Connecting Bushing
100.	4-PLC17N	Screw for Placer Support and Connecting Bushings
101.	4-ERP1	End Roller Clamp
102.	4-PLC04	Ratchet Pawl for Placer Clamp
103.	4-PLC05P	Pin for Ratchet Pawl
104.	4-PLC08P	Pin for Lock Screw
105.	4-PLC09	Lock Slug for Roller Shaft
106.	4-PLC06	Knurled Nut for Lock Screw
107.	4-PLC07	Lock Screw for Knurled Nut
108.	4-PLC12	Washer for Roller Shaft
109.	4-ERP6	Bearing for End Roller
110.	4-PLC14	Bearing for Placer Roller
111.	4-PLC11	Placer Roller Shaft
112.	4-PLC21	Placer Clamp
113.	4-ERP7	End Roller Rubber Roller (Bearings Not Included)
114.	3-ERP8	End Roller for Casket Placer Set (complete)
115.	4-PLC01C	Complete Placer Arm with Connecting Bushing
116.	4-PLC01S	Complete Placer Arm with Support Bushing
117.	4-PLC18S	Placer Guide Rod
118.	4-PLC13	Placer Arm Rubber Roller (Bearings Not Included)
132.	4-ERS	End Roller Clamp Shims

#### TUBING COMPONENTS

119.	4-HTB76-L	Tubing Collar Screw for Long Link
120.	4-HTB76-2S	Tubing Collar Screw
121.	4-TRN163	Short Link Screw for Connecting the Side Rail to the Head
122.	4-HTB87-AS	22.5" Outside Head End Tubing with Lock
123.	4-HTB94-BS	17" Inside Head End Tubing
124.	4-HTB74-BDS	29" Outside Tubing for BD Heads
125.	4-HTB77-CS	48" Inside Side Tubing
126.	4-HTB74-ACS	29" Outside Side Tubing for AC Heads
127.	4-HTB94-CS	17" Inside Tail End Tubing
128.	4-HTB87-DS	22.5" Outside Tail End Tubing with Lock
129.	4-HTB74-BDS	29" Outside Side Tubing for BD Heads
130.	4-HTB77-CS	48" Inside Side Tubing
131.	4-HTB74-ACS	29" Outside Side Tubing for AC Heads
132.	4-ERS	End Roller Clamp Shims



## STANDARD DEVICE MODEL REPLACEMENT PARTS

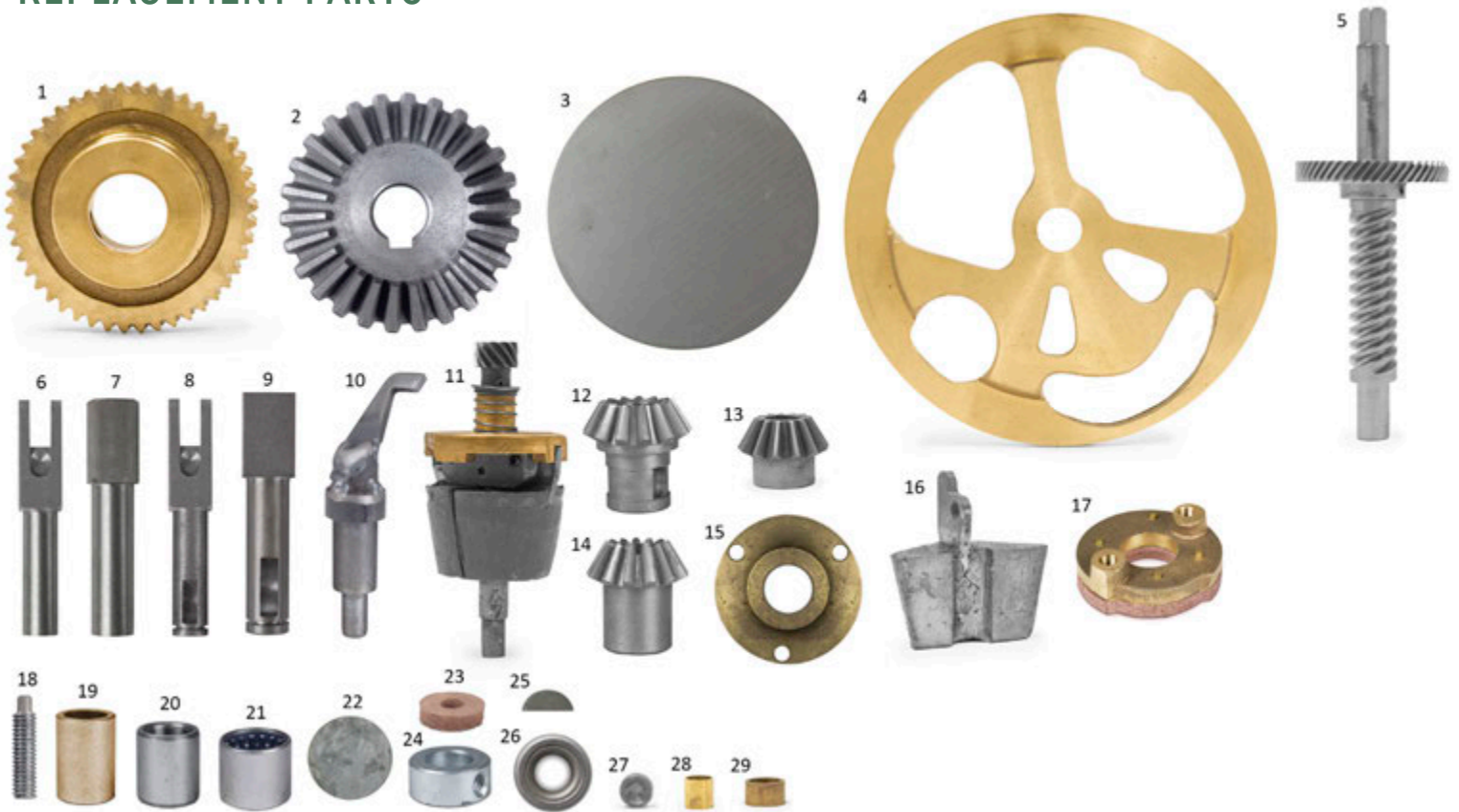

## STANDARD DEVICE MODEL REPLACEMENT PARTS

PRODUCT CODE	PRODUCT NAME	PRODUCT CODE	PRODUCT NAME
<b>1. 4-STAN27</b>	Bronze Worm Gear	<b>16. 4-STAN45</b>	Governor Link with Weight
<b>2. 4-STAN33</b>	Bevel Gear	<b>17. 4-STAN47</b>	Governor Brake
<b>3. 4-STAN11</b>	Bottom Disc for A Head	<b>18. 4-STAN91</b>	Governor Set Screw
<b>4. 4-STAN59</b>	Spider for Standard Device	<b>19. 4-STAN15</b>	Connect Rod Bushings A,B,C
<b>5. 4-STAN22/26</b>	Worm/Helical Gear Assembly	<b>20. 4-STAN15/PIN</b>	Bearing Pin for Short Link
<b>6. 4-STAN62-FT</b>	Short Link, Tail End for Funeral Director	<b>21. 4-STAN15/RACE</b>	Needle Bearing - Short Link
<b>7. 4-STAN162-CT</b>	Short Link, Tail End for Cemetery Model	<b>22. 4-STAN12</b>	Bottom Disc for B,C,D, Head
<b>8. 4-STAN62-FH</b>	Short link, Head End for Funeral Director	<b>23. 4-STAN55</b>	Stopshaft Washer
<b>9. 4-STAN162-CH</b>	Short Link, Head End, CM model	<b>24. 4-STAN98</b>	Short Link Collar
<b>10. 4-STAN54</b>	Stopshaft with Handle	<b>25. 4-STAN242</b>	Woodruff Key
<b>11. 4-STAN92</b>	Governor Complete	<b>26. 4-STAN18</b>	Bearing for Worm Shaft
<b>12. 4-STAN31N</b>	Pinion Gear for A Head	<b>27. 4-STAN21</b>	Truss Bearing - Gov Shaft
<b>13. 4-STAN35</b>	Idler Gear	<b>28. 4-STAN19</b>	Bushing for Gov Shaft
<b>14. 4-STAN38</b>	Pinion Gear for B Head	<b>29. 4-STAN17</b>	Bushing For Worm Shaft
<b>15. 4-STAN13BH</b>	Transmission Shaft Bushing		



## INTERESTED IN FRIGID CASKET LOWERING DEVICE REPAIR TRAINING?

### ON SITE TRAINING

- Frigid Team Member(s) visit your location to repair and service devices.
- Training for your staff on proper lowering device set up, operation, maintenance, and repair.
- Ensure devices operate up to Frigid Fluid standards.
- Hands on training while working on your own casket lowering devices.

### IN HOUSE TRAINING

- Training at Frigid Headquarters in Northlake, IL.
- Presentation of lowering device terminology, parts and preventative maintenance.
- Training on assembly of both Imperial and Master casket lowering device models.

**CALL +1-708-836-1215 FOR MORE INFORMATION!**



### LOWERING DEVICE PARTS KIT

A Frigid Casket Lowering Device Parts kit consists of all the most common parts that will wear over a device's lifespan, as well as all the parts and custom tools needed to replace the speed control function of the operating end.

- 4-PARTKIT-IMP** for Imperial Devices
- 4-PARTKIT-MAS** for Master Devices
- 4-PARTKIT-STAN** for Standard Devices

### FRIGID LOWERING DEVICE GREASE

Recommended grease for Frigid Casket Lowering Devices. Use to protect gearing from rust and corrosion and to keep device running smoothly and quietly.

**3-DEVGRE** 32 oz. jar / 0.91 kg

### FRIGID LOWERING DEVICE SPEED ADJUSTMENT TOOL

Frigid's speed adjustment tool is designed to easily adjust the governor brake studs of the casket lowering device. This is an essential tool for performing regular maintenance on the device. Made of solid stainless steel, the tool is built to last. Check Frigid Fluid's website for a video on how to use!

**4-GOV T**

Great to have on hand as a backup if you need to send your device in for repair or need a quick replacement. Easy to switch out with your old device using only two screws.



### MASTER® HEAD END COMPLETE

4-CHT400S-M

### IMPERIAL® HEAD END COMPLETE

4-CHT400S-I



**11631 W. GRAND AVE NORTHLAKE, IL 60164 USA**

Phone: 1-708-836-1215

Website: [www.frigidfluid.com](http://www.frigidfluid.com)

Toll-Free: 1-800-621-4719 (US only)

Fax: 1-708-836-1247

Email: [sales@frigidfluid.com](mailto:sales@frigidfluid.com)