



Rocker Step

PART NO. IB-FRS-015

FITS: 2019-Up Ford Ranger SuperCrew Cab



60-120 min



Cutting Not Required



Drilling Not Required

Torque & Tools

Fastener Size	Tightening Torque (ft-lbs)	Wrench Required		Allen Wrench Required	
<input type="checkbox"/> 6mm	<input type="checkbox"/> 7-8.5		<input type="checkbox"/> 10mm		<input type="checkbox"/> 4mm
<input checked="" type="checkbox"/> 8mm	<input checked="" type="checkbox"/> 18-20		<input checked="" type="checkbox"/> 13mm		<input type="checkbox"/> 5mm
<input checked="" type="checkbox"/> 10mm	<input checked="" type="checkbox"/> 35-40		<input checked="" type="checkbox"/> 16mm		<input type="checkbox"/> 6mm
<input type="checkbox"/> 12mm	<input type="checkbox"/> 60-70		<input type="checkbox"/> 18mm		<input type="checkbox"/> 8mm

BEFORE INSTALLATION

REMOVE CONTENTS FROM BOX. VERIFY ALL PARTS ARE PRESENT DEPEND ON THE PARTS LIST. READ INSTRUCTIONS CAREFULLY. BUMPER IS HEAVY, ASSISTANCE IS HIGHLY RECOMMENDED TO AVOID POSSIBLE INJURY OR DAMAGE TO THE VEHICLE.

Part List

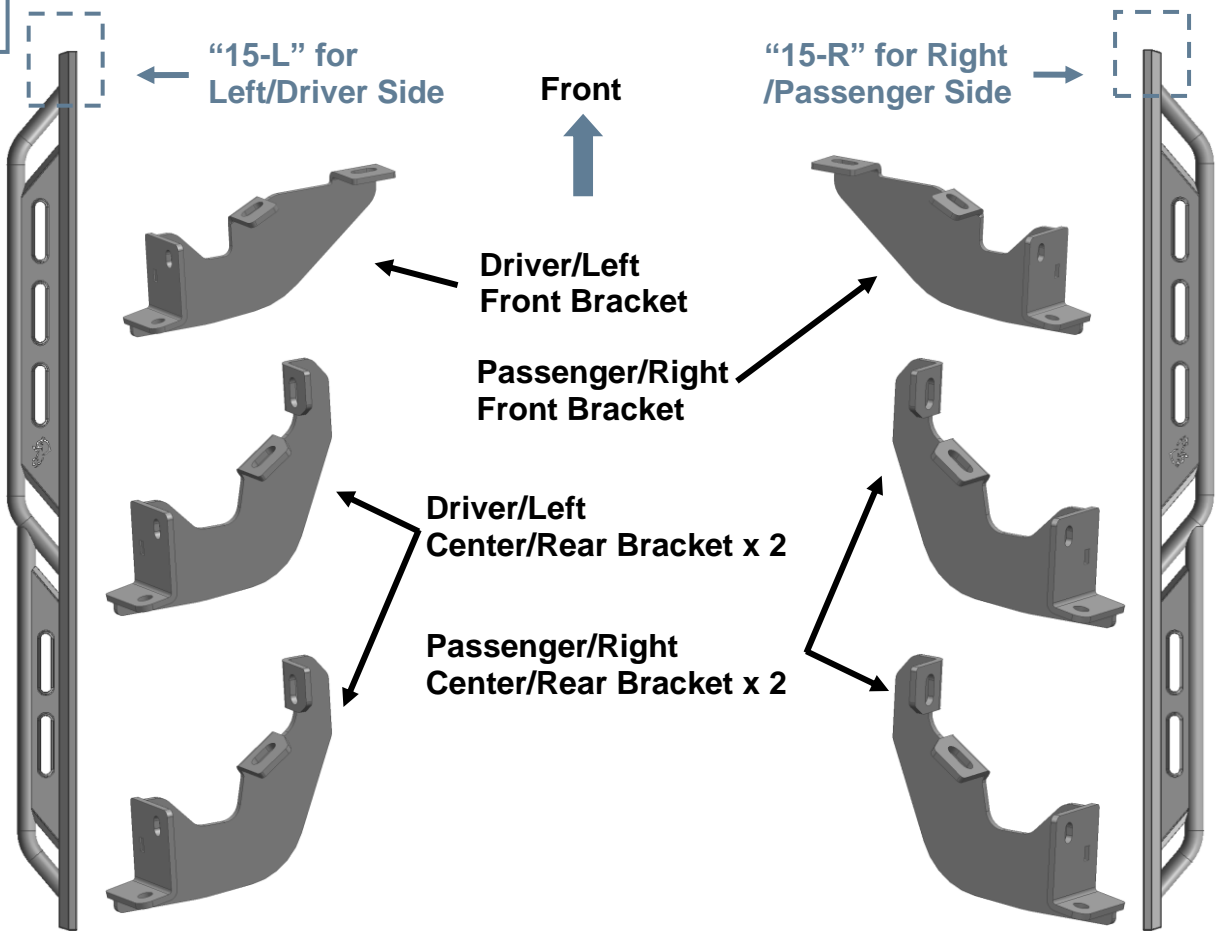



10mm x 25mm
Hex Bolt



10mm Flat
Washer



10mm Lock
Washer

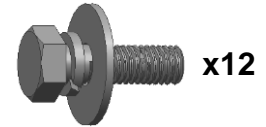

8mm x 25mm
Combo Bolt

PLEASE NOTE THAT THE FOLLOWING PICTURES ARE BASED ON THE PASSENGER SIDE INSTALLATION

STEP 1

Starting from underneath the Passenger/Right body panel, locate the front mounting location and the threaded holes in the body panel, **(Fig 1)**. Remove the plastic plugs covering the holes.

FIG 1

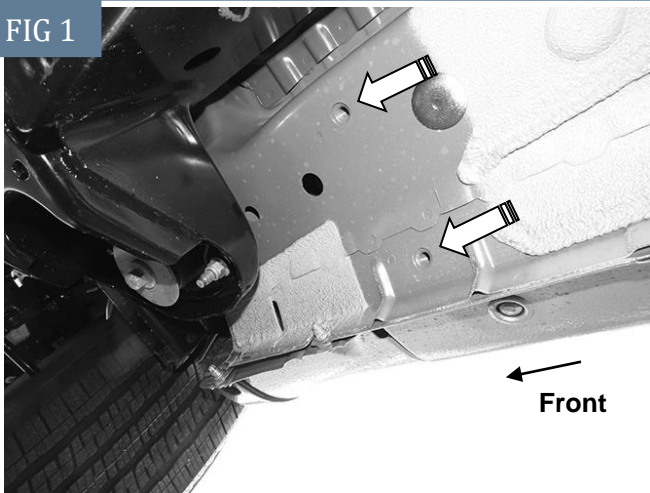

(Fig 1) Passenger/Right front mounting location

STEP 2

Select the Passenger/Right Front Mounting Bracket. Attach the Mounting Bracket to the front location with (2) 10mm Hex Bolts, (2) 10mm Lock Washers and (2) 10mm Flat Washers, **(Fig 2)**. Do not tighten hardware.

FIG 2

(2) 10mm Hex Bolts
(2) 10mm Lock Washers
(2) 10mm Flat Washers

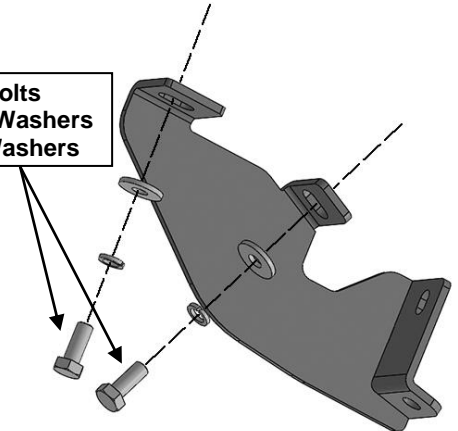

(Fig 2) Attach the Passenger/Right Front Mounting Bracket to the front location

STEP 3

Repeat **Steps 1-2** to attach (2) Passenger/Right Center/Rear Mounting Brackets to the center and rear locations, **(Figs 3-5)**. Do not tighten hardware.

FIG 3

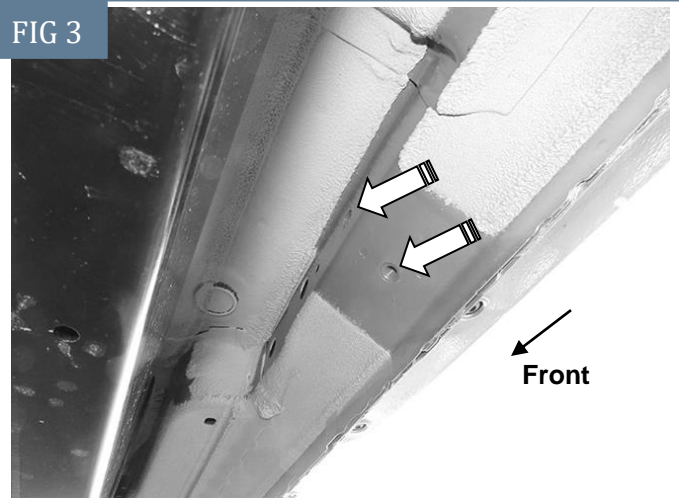

(Fig 3) Passenger/Right center mounting location

FIG 4

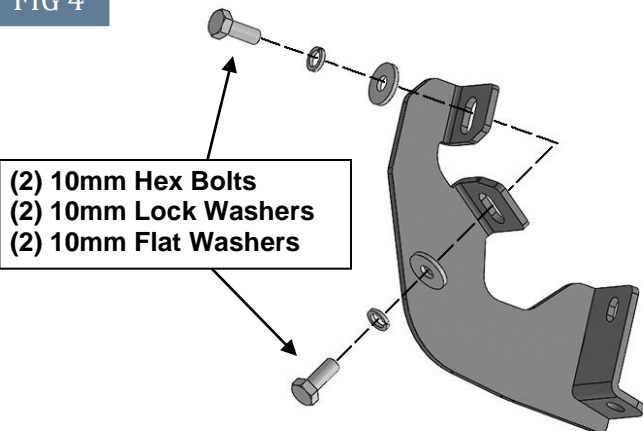

(2) 10mm Hex Bolts
(2) 10mm Lock Washers
(2) 10mm Flat Washers

(Fig 4) Attach (1) Passenger/Right Center/Rear Mounting Bracket to the center location

FIG 5

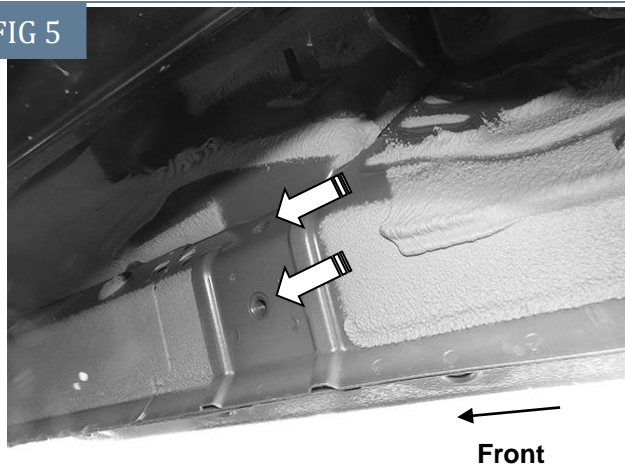

(Fig 5) Passenger/Right rear mounting location

STEP 4

Select the Passenger/Right Rocker Step.
NOTE: The Passenger/Right Rocker Step will have a "15-R" on the front. Carefully place Rocker Step on the brackets. **IMPORTANT:** Do not slide the Rocker Step front to back or damage to the finish may result. Attach Rocker Step to the (3) Mounting Brackets with (6) 8mm Combo Bolts, (Fig 6). Do not tighten hardware.

FIG 6

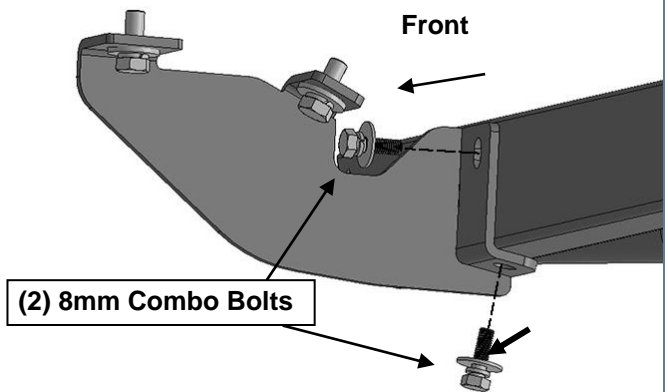

(Fig 6) Attach the Passenger/Right Rocker Step to the Mounting Brackets

STEP 5

Level and adjust the Rocker Step and fully tighten all hardware.

STEP 6

Repeat **Steps 1—5** to attach the Driver/Left Rocker Step.

STEP 7

Do periodic inspections to the installation to make sure that all hardware is secure and tight.

Attention

To protect your investment, do not use any type of polish or wax that may contain abrasives that could damage the finish.

Mild soap may be used also to clean the Running Boards.