

TOKU 

# AIR TOOLS

Ver.6.02

SGHART200

# AIR TOOLS

AUTOMOTIVE & GENERAL INDUSTRY

## INDEX

Impact Drivers 02

Drivers 02

Ratchets Wrenches 02

Impact Wrenches 3/8"~3/4" 03-04

Impact Wrenches 1"~1/2" 05-06

Angle Grinders and  
Straight Grinders 07-08

Die Grinders 09

Drills 10

Scaling Hammers 11

Needle Scalers 11

Hammers 12

Flux Chippers 12

Sanders 13

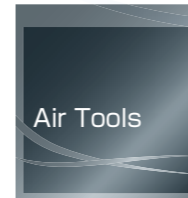

# Impact Drivers / Drivers Ratchet Wrenches



- 2 hammer(Pin-less)clutch
- 2 steps throttle for precise control
- 360 free rotating handle exhaust
- Well balanced Ergonomic design
- One handed easy reverse switch
- Ideal for wood work and assembly work
- 3/8 SQ.drive model available(MID-8P(R) 3/8SQ)

MID-8P 1/4"Hex

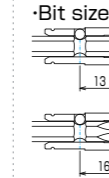
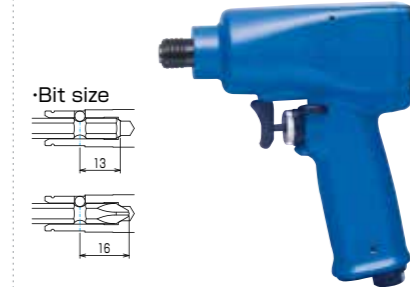

- Twin hammer clutch
- Tease throttle for precise control
- Handle Exhaust directs air away from an operator
- Well balanced Ergonomic design
- 4 Positions regulator
- Elastomer handle grip
- 3/8 SQ.drive model available (MID-12P 3/8SQ)
- Ideal for wood work and assembly work

MI-12D 1/4"Hex



- Ideal for motor vehicle and light assembly work

MID-60 1/4"Hex

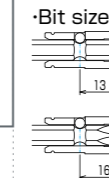
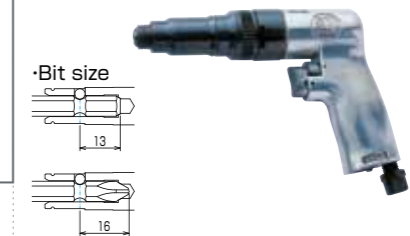

- Ideal for furniture,wood working, motor vehicle and other assembly operations

MV-6226 1/4"Hex



- Ideal for appliance,electronics and other light assembly industries

MV-6216 1/4"Hex



- Easy grip handle Quick run down capacity
- Ideal for usage on pumps, radiators, small engines exhaust systems etc.

MR-2310B 3/8"SQ  
MR-2410B 1/2"SQ



- Compact and powerful
- Rubber covered ratchet head
- Durable ratchet head (heat treated) prevents slipping
- Ideal for confined working conditions

MR-2207C 1/4"SQ  
MR-2209C 3/8"SQ

### Impact Drivers Specifications: Air pressure 6kg/cm<sup>2</sup>

MODEL	Drive (in)	Bolt Size (mm)	Net Weight (kg)	Overall Length (mm)	Center Height (mm)	Free Speed (rpm)	Air Cons		Air Inlet (PT)	Hose Size (in)
							Free (m <sup>3</sup> /min)	Load (m <sup>3</sup> /min)		
MID-8P	H 1/4	8	1.0	154	22.5	10500	0.55	0.4	1/4	1/4
MI-12D	H 1/4	12	1.2	154	25.3	9500	0.50	0.4	1/4	1/4
MID-60	1/4	6	0.8	181	55	10800	0.48	0.32	1/4	3/8

### Drivers and Ratchet Wrenches Specifications: Air pressure 6kg/cm<sup>2</sup>

MODEL	Drive (in)	Bolt Size (mm)	Torque Range (kg·m)	Net Weight (kg)	Overall Length (mm)	Free Speed (rpm)	Air Cons (m <sup>3</sup> /min)	Air Inlet (PT)	Hose Size (in)
MV-6216	H1/4	6	0.4-0.9	1.2	250	1800	0.42	1/4	1/4
MV-6226	H1/4	6	0.5-1.2	1.3	205	1800	0.6	1/4	1/4
MR-2207C	1/4	8	0.6-2.8	0.53	165	250	0.35	1/4	1/4
MR-2209C	3/8	8	0.6-2.8	0.53	165	250	0.35	1/4	1/4
MR-2310B	3/8	10	1.4-7.0	1.13	254	180	0.45	1/4	1/4
MR-2410B	1/2	10	1.4-7.0	1.13	254	180	0.45	1/4	1/4

# Impact Wrenches

## 3/8"~3/4"



### Two Hammer

- 2 hammer(Pin-less)clutch
- 2 steps throttle for precise control
- 360 free rotating handle exhaust
- Well balanced Ergonomic design
- One handed easy reverse switch
- Ideal for wood work and assembly work
- 3/8 SQ.drive model available(MID-8P(R) 3/8SQ)



MID-8P(R) 3/8"SQ



### Twin Hammer

- Compact and light Weight
- One handed easy reverse switch 1/2"SQ.drive model available
- Ideal for general repair and assembly work in the 3/8" range
- Tease throttle for precise control
- Handle Exhaust directs air away from the operator
- Well balanced Ergonomic design
- 4 positions regulator



MI-12P 3/8"SQ 1/2"SQ also available



### One Hammer

- Forward & reverse rotation is available with one hand
- Compact & light
- 360° air inlet swivel



MI-1310S 3/8"SQ



### Twin Hammer

- Extra compact body
- One handed smooth reverse control available
- Composite grip for easy handling
- Optimum for assembly and general repair work
- 1/2" SQ drive model available

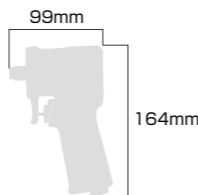

MI-14S 3/8"SQ 1/2"SQ also available



### One Hammer

- Front Exhaust
- 4 Positions regulator
- Ideal for general repair in the 3/8" range



MI-1311B 3/8"SQ



### Twin Hammer

- Elastomer handle grip
- Ideal for car repair and assembly work



MI-16M 3/8"SQ 1/2"SQ also available

## Composite Impact Wrench



Forward : 3 steps  
Set1: Hand tight torque  
Reverse : 2 steps  
Different power settings

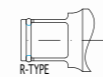

MI-17C 1/2"SQ

### [Features]

- Twin Hammer
- Only 1.8 kgs
- Oil Bath
- Most powerful 1/2" Impact Wrench in TOKU
- Long Anvil (+50.8) available (MI-17CL)



### Twin Hammer

- Ultimate power in reverse
- Ideal for car repair and tire shops
- Long Anvil (+50.8) available (MI-17M)
- Ergonomic handle
- Closed trigger
- Oil bath

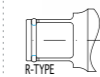

MI-17M 1/2"SQ



### Twin Hammer

- 360 free rotating exhaust
- One handed easy reverse switch
- Ideal for assembly and maintenance of trucks
- Anvil type: RH type available
- Long Anvil (+120) available (MI-20PL)

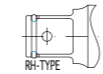

MI-20P 3/4"SQ



### Twin Hammer

- Extra compact body
- One handed smooth reverse control available
- Composite grip for easy handling
- Optimum for assembly and general repair work

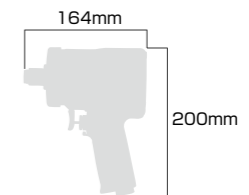
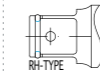

MI-20S 3/4"SQ

Impact Wrench Specifications: Air pressure 6kg/cm<sup>2</sup>

MODEL	Drive (in)	Bolt Size (mm)	Torque Range (kg-m)	Max Torque (kg-m)	Net Weight (kg)	Overall Length (mm)	Center Height (mm)	Free Speed (rpm)	Air Cons		Air Inlet (PT)	Hose Size (in)
									Free (m <sup>3</sup> /min)	Load (m <sup>3</sup> /min)		
MID-8P(R)	3/8	8	4-8	10	1.0	151	22.5	9500	0.57	0.44	1/4	1/4
MI-1310S	3/8	10	1-9	12	0.91	177	30	12500	0.4	0.3	1/4	3/8
MI-1311B	3/8	10	3-7	10	1.3	150	24	7000	0.45	0.35	1/4	1/4
MI-12P	3/8	12	5-11	12	1.2	150	25.3	9500	0.5	0.4	1/4	3/8
MI-14S	3/8	16	15-31	R34 L39	1.15	99	28.8	11700	0.62	0.36	1/4	3/8
MI-16M	3/8	13	15-36	46	1.5	170	27.5	7200	0.62	0.4	1/4	3/8
MI-16M	1/2	16	15-36	46	1.5	170	27.5	7200	0.62	0.4	1/4	3/8

Impact Wrench Specifications: Air pressure 6kg/cm<sup>2</sup>

MODEL	Drive (in)	Bolt Size (mm)	Torque Range (kg-m)	Max Torque (kg-m)	Net Weight (kg)	Overall Length (mm)	Center Height (mm)	Free Speed (rpm)	Air Cons		Air Inlet (PT)	Hose Size (in)
									Free (m <sup>3</sup> /min)	Load (m <sup>3</sup> /min)		
MI-17M	1/2	16	25-45	R55 L60	2.5	179	33	5500	0.6	0.5	1/4	3/8
MI-17C	1/2	16	26-56	R65 L70	1.8	181	34.5	R8500 L8800	0.99	0.99	1/4	3/8
MI-20P	3/4	20	40-80	100	3.9	309	42	5000	1.1	0.7	3/8	3/8
MI-20S	3/4	20	37-73	92	3.2	164	40.7	4500	0.9	0.6	3/8	3/8
MI-2500P	3/4	25	50-110	130	8.2	265	50	5300	1.2	0.7	3/8	1/2
MI-2500GS(ES)	3/4	25	50-110	130	8.2	341	50	5300	1.2	0.7	3/8	1/2
MI-2500GL	3/4	25	50-110	130	8.2	341	50	5300	1.2	0.7	3/8	1/2

# Impact Wrenches

## 1"~1-1/2"



MI-2500P 1"SQ

### One Hammer

- Anvil type: RH type available
- 3/4"SQ drive model available
- Ideal for assembly and maintenance of trucks
- Well balanced Ergonomic design
- 2 Steps throttle for precise control
- 4 positions regulator
- 360 free rotating exhaust



MI-2500GL 1"SQ  
MI-3800GL 1"SQ

### One Hammer

- Short anvil shank type MI3800GS available
- Ideal for maintenance of trucks and truck tires
- 2 Steps throttle for precise control
- Elastomer side handle grip
- 4 Positions regulator



Inside trigger



Inside trigger



MI-3800P 1"SQ

### One Hammer

- Anvil type: RH type available
- Ideal for maintenance of trucks and construction equipments
- Well balanced Ergonomic design
- 2 Steps throttle for precise control
- 4 positions regulator
- 360 free rotating exhaust
- Elastomer side handle grip



MI-38EXL 1"SQ

### Twin Hammer

- Extra light-weight
- Compact body
- Short anvil shank is available (MI-38EXS)
- 4 position regulator
- Ideal for changing truck tires, heavy equipment and plant maintenance
- Ergonomic handle design
- Durable clutch parts for long life
- 2 Steps throttle for precise control



MI-38GL 1"SQ  
MI-42GL 1"SQ

### Twin Hammer

- Anvil type: RH type available
- Short anvil shank type MI-38GS-MI-42GS available
- Ideal for changing truck tires and maintenance of heavy equipments
- Elastomer side handle grip
- 4 positions regulator
- Powerful and Light Weight
- Durable Clutch parts for long life
- 2 Steps throttle for precise control



Inside trigger

## Toku One hammer clutch Features

Simplified structure for high durability and easy maintenance  
Precised machined clutch provides excellent performance and less vibration.

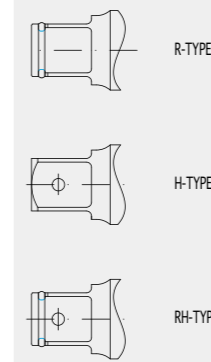
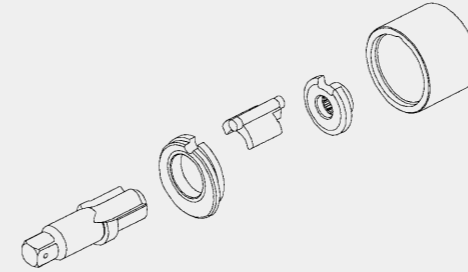

## Toku Twin hammer clutch Features

Toku twin hammer provides maximum performance, balanced impacts and power output  
Less wasted energy and simplified maintenance  
Cold forged hammer for high durability

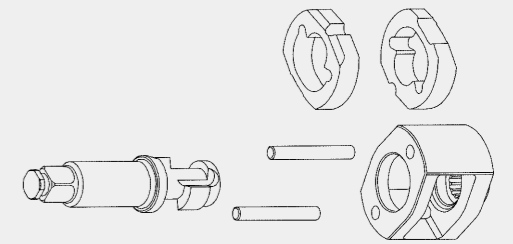

MI-5000GL 1"SQ

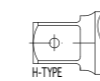

### One Hammer

- Anvil type: RH type available
- Ideal for maintenance of trucks and construction equipments



MI-5000P 1"SQ

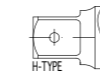

Inside trigger

### One Hammer

- Short anvil shank type MI-5000GS available
- Ideal for truck tires and heavy equipments



MI-5500 1-1/2"SQ



### Pin Hammer

- Pin clutch mechanism
- Powerful for extra heavy duty work



Inside trigger

Impact Wrench Specifications: Air pressure 6kg/cm<sup>2</sup>

MODEL	Drive (in)	Bolt Size (mm)	Torque Range (kg-m)	Max Torque (kg-m)	Net Weight (kg)	Overall Length (mm)	Center Height (mm)	Free Speed (rpm)	Air Cons		Air Inlet (PT)	Hose Size (in)
									Free (m <sup>3</sup> /min)	Load (m <sup>3</sup> /min)		
MI-2500P	1	25	50-110	130	8.2	265	50	5300	1.2	0.7	3/8	1/2
MI-2500GS(ES)	1	25	50-110	130	8.2	341	50	5300	1.2	0.7	3/8	1/2
MI-2500GL(EL)	1	25	50-110	130	9.0	460	50	5300	1.2	0.7	3/8	1/2
MI-3800P	1	38	50-150	200	9.5	276	55	4700	1.6	1.0	1/2	1/2
MI-3800GS(ES)	1	38	50-150	200	9.5	355	55	4700	1.6	1.0	1/2	1/2
MI-3800GL(EL)	1	38	50-150	200	10.2	504	55	4700	1.6	1.0	1/2	1/2
MI-38EXL	1	38	50-110	173	6.2	465	43	5300	1.3	0.8	3/8	1/2
MI-38GS(ES)	1	38	50-110	180	7.2	339	49	3700	1.2	0.7	1/2	1/2
MI-38GL(EL)	1	38	50-110	180	7.9	498	49	3700	1.2	0.7	1/2	1/2
MI-42GS(ES)	1	42	50-180	260	10.2	370	55	3900	1.9	1.0	1/2	1/2
MI-42GL(EL)	1	42	50-180	260	10.6	519	55	3900	1.9	1.0	1/2	1/2

### TYPE OF IMPACT WRENCH

## MI-3800GL

- G : Outside Trigger
- E : Inside Trigger
- P : Pistol Type Body
- S : Short Anvil Shank
- L : Long Anvil Shank

Impact Wrench Specifications: Air pressure 6kg/cm<sup>2</sup>

MODEL	Drive (in)	Bolt Size (mm)	Torque Range (kg-m)	Max Torque (kg-m)	Net Weight (kg)	Overall Length (mm)	Center Height (mm)	Free Speed (rpm)	Air Cons		Air Inlet (PT)	Hose Size (in)
									Free (m <sup>3</sup> /min)	Load (m <sup>3</sup> /min)		
MI-5000P	1	50	50-220	270	13.9	310	60	3700	1.9	1.0	1/2	1/2
MI-5000GS(ES)	1	50	50-220	270	14.3	460	60	3700	1.9	1.0	1/2	1/2
MI-5000GL(EL)	1	50	50-220	270	16.0	594	60	3700	1.9	1.0	1/2	1/2
MI-5500(ES)	1-1/2	55	150-428	560	18.1	520	60	2800	1.25	0.9	1/2	1/2

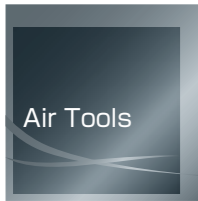

# Grinders

Angle Grinders with governor control



**TAG-40FLH**



**TAG-40FRH**

• Ideal for removing burs on the material and smoothing welds

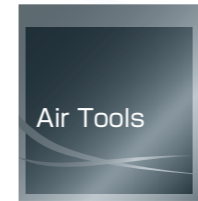

# Grinders

Angle Grinders/Straight Grinders with governor control

- Turn throttle type : 2"/4"/5"/7" model available
- Lever throttle type : 2"/4"/7"/9" model available
- Safety lock off throttle • 360 free rotating exhaust for 7"&9"



**TAG-700** Turn throttle type



**TAG-700QJL/900QJL** Lever throttle type

• Ideal for heavy duty work such as smoothing welds and cutting material



2 Spindle Types Available

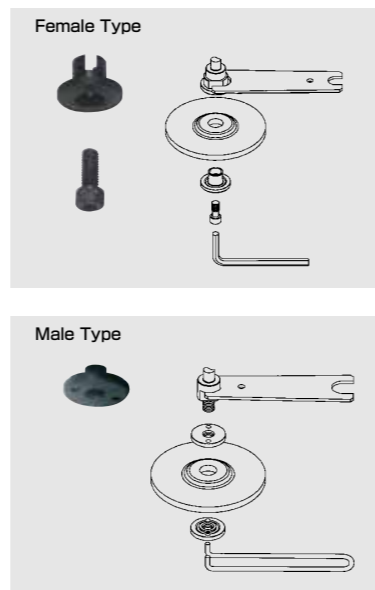

**TAG-40/50MR**



**TSG-6L** Lever throttle type Safety Lock-off throttle



**TSG-3F/5S/6S** Turn throttle type

• Ideal for various types of finishing tasks

Angle Grinders Specifications: Air pressure 6kg/cm<sup>2</sup>

MODEL	Wheel Size (mm)	Wheel Max Speed (m/min)	Free Speed (rpm)	Net Weight (kg)	Overall Length (mm)	Maximum Air Cons (m <sup>3</sup> /min)	Air Inlet (PT)	Hose Size (in)	Horse Power
TAG-40MR	100×6×16	4300	13000	1.4	195	1.00	1/4	3/8	0.9
TAG-40FR	100×6×16	4300	13000	1.4	195	1.00	1/4	3/8	0.9
TAG-40FRH	100×6×16	4300	13000	1.8	217.5	1.00	1/4	3/8	0.9
TAG-40FLH	100×6×16	4300	13000	1.6	213.5	1.00	1/4	3/8	0.9
TAG-50MR	125×6×22	4300	10300	1.4	195	1.00	1/4	3/8	0.9

Angle Grinders / Straight Grinders Specifications: Air pressure 6kg/cm<sup>2</sup>

MODEL	Wheel Size (mm)	Wheel Max Speed (m/min)	Free Speed (rpm)	Net Weight (kg)	Overall Length (mm)	Air Cons (m <sup>3</sup> /min)	Air Inlet (PT)	Hose Size (in)	Horse Power
TAG-700	180×8×22	4300	7500	3.1	274	0.8-1.0	3/8	1/2	1.3
TAG-700QJL	180×8×22	4800	8400	3.1	304	1.0-1.3	3/8	1/2	1.3
TAG-900QJL	230×8×22	4800	6500	3.4	304	0.7-1.0	3/8	1/2	1.3
TSG-3F	75×13×9.5	3000	12700	1.6	305	0.8	1/4	3/8	0.7
TSG-5S	125×19×12.7	3000	7600	3	400	1.1	3/8	1/2	1.4
TSG-6S	150×25×15.9	3000	6300	4.2	430	1.2	3/8	1/2	2.1
TSG-6L	150×25×15.9	3000	6000	4.2	430	1.2	3/8	1/2	2.1

# Grinders

## 6mm Grinders

- Turn throttle
- Front exhaust



**TG-25Z II**

- Turn throttle
- Front exhaust
- 1/4" Collet chuck (Option)



**TG-38Z**

- Rear exhaust
- 1/4" Collet chuck (Option)



**MG-7206B**

- Compact, light and handy
- 90° angle head allows flexibility in tight spots
- 1/4" Collet chuck (Option)



**MG-7236B 6mm Angle**

- Compact and light weight
- Front exhaust



**MG-1B**

- Compatible with 3" grindstone type using optional parts (refer to TSG-3F)



**TSG-3C 6mm Straight Grinders**

- Front exhaust
- 1/4" Collet chuck (Option)



**MG-20**

- Compact, light and handy
- Front exhaust
- 1/4" Collet chuck (Option)



**MG-7204B 6mm Mini**

6mm Grinders Specifications: Air pressure 6kg/cm<sup>2</sup>

MODEL	Collet Size (mm)	Net Weight (kg)	Overall Length (mm)	Free Speed (rpm)	Air Cons. Free (m <sup>3</sup> /min)	Air Inlet (PT)	Hose Size (in)
TG-25Z-II	6	0.56	150	18,000	0.5	1/4	3/8
MG-1B	6	0.6	157	20,000	0.4	1/4	3/8
TG-38Z	6	0.7	178	23,000	0.45	1/4	3/8
MG-7206B	6	0.6	146	22,000	0.5	1/4	3/8
MG-20	6	0.6	139	22,000	0.6	1/4	3/8
MG-7236B	6	0.4	123	18,000	0.38	1/4	3/8
MG-7204B	6	0.4	120	25,000	0.38	1/4	3/8

6mm Straight Grinders Specifications: Air pressure 6kg/cm<sup>2</sup>

MODEL	Collet Size (mm)	Net Weight (kg)	Overall Length (mm)	Free Speed (rpm)	Air Cons. Free (m <sup>3</sup> /min)	Air Inlet (PT)	Hose Size (in)	Horse Power
TSG-3C	6	1.6	340	12700	0.8	1/4	3/8	0.7

# Drills

- Industrial tool for professionals
- Tease throttle for precise control
- Planetary gear enables smooth operation and long life
- Handle exhaust



**MD-10L 3/8"**

- Triple planetary gear system provides smooth operation
- Grip reverse valve enables one handed directional changes
- 1/2 HP air motor provides max power
- Handle exhaust



**MD-3311B 3/8"**  
Reversible

- Reliable general purpose drill
- Handle exhaust



**MD-3310B 3/8"**

- Side support handle for good control
- Grip reverse valve enables one handed directional changes
- 1/2 HP air motor with a double reduction gear system produces reliable power
- Ideal for drilling, screw driving, reaming, cylinder honing



**MD-3413B 1/2"**  
Reversible

- Compact and light design
- Tease throttle for precise control
- Ideal for tapping work
- Rear exhaust



**MD-3312B 3/8"**  
Angle Reversible

Drills Specifications: Air pressure 6kg/cm<sup>2</sup>

MODEL	Chuck Size (in)	Spindle Size (in)	Net Weight (kg)	Overall Length (mm)	Free Speed (rpm)	Air Cons. Free (m <sup>3</sup> /min)	Air Inlet (PT)	Hose Size (in)
MD-10L	3/8	3/8x24UNF	0.9	160	2300	0.5	1/4	1/4
MD-3310B	3/8	3/8x24UNF	1.0	165	2400	0.47	1/4	1/4
MD-3311B	3/8	3/8x24UNF	1.1	200	2000	0.58	1/4	1/4
MD-3312B	3/8	3/8x24UNF	1.2	208	1200	0.36	1/4	1/4
MD-3413B	1/2	3/8x24UNF	1.6	220	500	0.47	1/4	1/4

# Scaling Hammers/ Needle Scalars



TS-2

- Compact and handy needle scalars
- Precision heat-treated needles for maximum performance



TNS-200



N-200



TNS-200PS

Scaling Hammers Specifications: Air pressure 6kg/cm<sup>2</sup>

MODEL	Piston Dia (mm)	Piston Stroke (mm)	Net Weight (kg)	Blow per Min (bpm)	Overall Length (mm)	Air Cons. Free (m <sup>3</sup> /min)	Air Inlet (PT)	Hose Size (in)
TS-2	30	30	2.2	8000	500	0.3	3/8	1/2

Needle Scalars Specifications: Air pressure 6kg/cm<sup>2</sup>

MODEL	Piston Dia (mm)	Blow per Min (bpm)	Needle Dia Length, Number (mm)×(mm)×Piece	Piston Stroke (mm)	Net Weight (kg)	Overall Length (mm)	Air Cons. Free (m <sup>3</sup> /min)	Air Inlet (PT)	Hose Size (in)
N-200	20	12000	3×125×12	12	1.12	225	0.25	1/4	1/4
TNS-200	20	4000	3×180×12	25	2.4	345	0.25	1/4	3/8
TNS-200PS	20	3500	3×180×12	25	1.6	305	0.25	1/4	3/8

- Hardened pistons and cylinders for longer life
- Simple structure for easy maintenance

# Hammers/ Flux Chippers

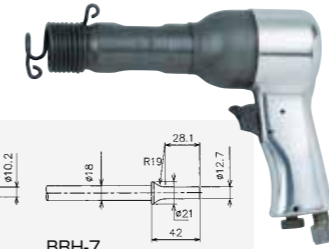

BRH-3/7

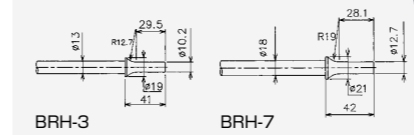

- Compact, light handy and durable
- Spool valve for precise speed control
- Built-in air regulator controls power output



MH-5111R/5115

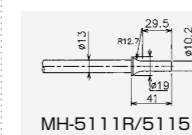

- Heavy duty air hammer for general use
- Simple structure and durable
- Ideal for muffler and pipe removal, body shop work



TFC-200



TFC-200F



TFC-257H

- Compact and lightweight body contributes to easy handling of tools.
- Ideal for light duty chipping job and surface finish work in jobs like removing slag, burrs, rust, and old paint.



TFC-400K-1300

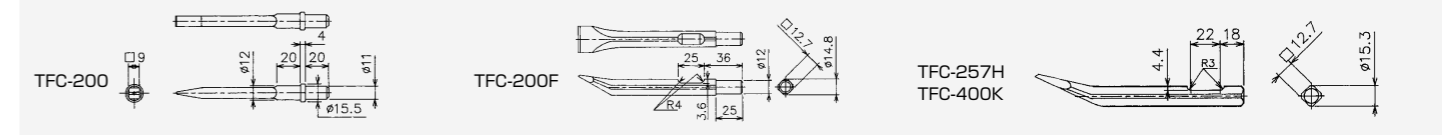

Hammers Specifications: Air pressure 6kg/cm<sup>2</sup>

MODEL	Piston Dia (mm)	Chisel Shank Bore Size (mm)	Blow per Min (bpm)	Piston Stroke (mm)	Net Weight (kg)	Overall Length (mm)	Air Cons. Free (m <sup>3</sup> /min)	Air Inlet (PT)	Hose Size (in)
BRH-3	14.3	10	1800	76	1.4	200	0.32	1/4	1/4
BRH-7	19	12	1500	90	2.1	220	0.35	1/4	1/4
MH-5111R	19	10	3500	66	1.6	200	0.2	1/4	1/4
MH-5115	19	10	2100	90	2	250	0.4	1/4	1/4

Flux Chippers Specifications: Air pressure 6kg/cm<sup>2</sup>

MODEL	Piston Dia (mm)	Blow per Min (bpm)	Piston Stroke (mm)	Net Weight (kg)	Overall Length (mm)	Air Cons. Free (m <sup>3</sup> /min)	Air Inlet (PT)	Hose Size (in)
TFC-257H	25.4	3200	34	1.97	240	0.42	3/8	1/2
TFC-200	20	12000	12	0.89	182	0.25	1/4	1/4
TFC-200F	20	12000	12	1.06	187	0.25	1/4	1/4
TFC-400K-1300	25.4	3000	34	5.6	1300	0.4	3/8	1/2

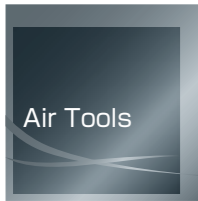

# Sanders

- 5mm orbit for high quality finishing
- Compact and light weight providing best power to weight ratio in this class



**MS-430  
N-5/N-6**

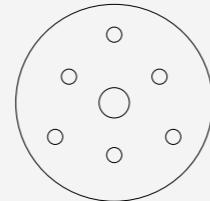

5"pad type



**MS-430  
G-5/G-6**

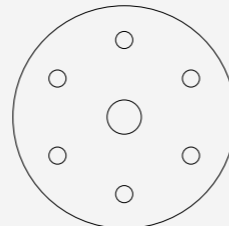

6"pad 6 holes type



- Easy handle, compact and lightweight
- Built-in power regulator
- Ideal for light sanding

**MS-4125B**

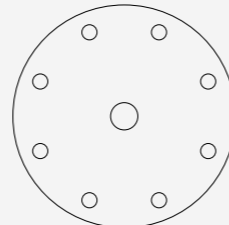

6"pad 8 holes type

Sanders Specifications: Air pressure 6kg/cm<sup>2</sup>

MODEL	Paper Size or Disk Size (mm)	Pad Type	Free Speed (rpm)	Orbit Size (mm)	Net Weight (kg)	Air Cons. Free (m <sup>3</sup> /min)	Air Inlet (PT)	Hose Size (in)
MS-430N-5	125	VELCRO	10000	5	0.9	0.38	1/4	3/8
MS-430N-6	150	VELCRO	10000	5	0.9	0.38	1/4	3/8
MS-430G-5	125	VELCRO	8500	5	0.93	0.38	1/4	3/8
MS-430G-6	150	VELCRO	8500	5	0.93	0.38	1/4	3/8
MS-4125B	75-115	-	14000	-	1	0.38	1/4	3/8

## OPERATING INSTRUCTIONS WHEN USING GENERAL AIR TOOLS

1. ALWAYS USE APPROVED EYE PROTECTION WHEN OPERATING TOOL.
2. NEVER WEAR LOOSE GLOVES OR CLOTHES WHEN OPERATING TOOL.
3. ALWAYS CHECK IF THE TOOL IS GOING TO BE USED WITH ACCESSORIES IN CORRECT SIZE AND IN GOOD CONDITION BEFORE ACTUAL OPERATION. (IMPACT SOCKETS, COUPLERS, DRILL BITS, BURS, CUTTER, DISCS, BRUSHES, NEEDLES, CHISELS, PISTONS AND OTHER ACCESSORIES FOR AIR TOOLS)
4. ALWAYS CHECK IF THE TOOL IS BEING LUBRICATED SUFFICIENTLY, BEFORE ACTUAL OPERATION. CHECK YOUR INSTRUCTION MANUAL ENCLOSED IN THE TOOL FOR CORRECT METHOD OF LUBRICATION. IN CASE IF THE OPERATION MANUAL WAS NOT ENCLOSED IN THE TOOL WHEN PURCHASED, STOP USING THE TOOL, CONTACT YOUR NEAREST DEALER AND ASK FOR THEIR INSTRUCTION.
5. ALWAYS USE THE CORRECT AIR PRESSURE AMOUNT INSTRUCTED IN THE OPERATION MANUAL ENCLOSED IN THE TOOL, IN CASE IF THE OPERATION MANUAL WAS NOT ENCLOSED IN THE TOOL WHEN PURCHASED, STOP USING THE TOOL, CONTACT YOUR NEAREST DEALER AND ASK FOR THEIR INSTRUCTION.
6. ALWAYS DIRECT EXHAUST AWAY FROM YOURSELF AND OTHERS IN THE AREA.
7. ALWAYS DISCONNECT THE TOOL WHEN NOT IN USE.
8. IN CASE IF YOU FIND ANY MALFUNCTION OF THE TOOL, STOP USING THE TOOL AND CONTACT YOUR NEAREST DEALER.

### Toku air tools torque calibration chart

MODEL	Torque	Working Torque Range	Max Torque	MODEL	Torque	Working Torque Range	Max Torque
MV-6216	(N·m)	3.9-8.8	-	MI-20S	(N·m)	360-720	900
	(kg·m)	0.4-0.9	-		(kg·m)	37-73	92
	(ft·lbs)	2.9-6.5	-		(ft·lbs)	266-531	664
MV-6226	(N·m)	4.9-11.7	-	MI-2500P	(N·m)	490-1078	1274
	(kg·m)	0.5-1.2	-		(kg·m)	50-110	130
	(ft·lbs)	3.6-8.7	-		(ft·lbs)	361.6-795.6	940
MR-2207C	(N·m)	5.8-27.4	-	MI-2500GS	(N·m)	490-1078	1274
	(kg·m)	0.6-2.8	-		(kg·m)	50-110	130
	(ft·lbs)	4.3-20.3	-		(ft·lbs)	361.6-795.6	940
MR-2209C	(N·m)	5.8-27.4	-	MI-2500GL	(N·m)	490-1078	1274
	(kg·m)	0.6-2.8	-		(kg·m)	50-110	130
	(ft·lbs)	4.3-20.3	-		(ft·lbs)	361.6-795.6	940
MR-2310B	(N·m)	13.7-68.6	-	MI-3800P	(N·m)	490-1470	1961
	(kg·m)	1.4-7.0	-		(kg·m)	50-150	200
	(ft·lbs)	10.1-50.6	-		(ft·lbs)	361.6-1084.9	1446
MR-2410B	(N·m)	13.7-68.6	-	MI-3800GS	(N·m)	490-1470	1961
	(kg·m)	1.4-7.0	-		(kg·m)	50-150	200
	(ft·lbs)	10.1-50.6	-		(ft·lbs)	361.6-1084.9	1446
MID-8P(R)	(N·m)	39-79	98	MI-3800GL	(N·m)	490-1470	1961
	(kg·m)	4-8	10		(kg·m)	50-150	200
	(ft·lbs)	29-58	72		(ft·lbs)	361.6-1084.9	1446
MI-12P	(N·m)	49-107	117	MI-38EXL	(N·m)	490-1080	1700
	(kg·m)	5-11	12		(kg·m)	50-110	173
	(ft·lbs)	36.2-79.6	87		(ft·lbs)	361-796	1254
MI-1311B	(N·m)	29-68	98	MI-38GS	(N·m)	490-1078	1765
	(kg·m)	3-7	10		(kg·m)	50-110	180
	(ft·lbs)	21.7-50.6	72		(ft·lbs)	361.6-795.6	1302
MI-1310S	(N·m)	9-88	117	MI-38GL	(N·m)	490-1078	1765
	(kg·m)	1-9	12		(kg·m)	50-110	180
	(ft·lbs)	7.2-65.1	87		(ft·lbs)	361.6-795.6	1302
MI-14S	(N·m)	150-300	R330 L380	MI-42GS	(N·m)	490-1765	2549
	(kg·m)	15-31	R34 L39		(kg·m)	50-180	260
	(ft·lbs)	111-221	R243 L280		(ft·lbs)	361.6-1301.9	1880
MI-16M(3/8) (1/2)	(N·m)	150-350	450	MI-5000P	(N·m)	490-2157	2647
	(kg·m)	15-36	46		(kg·m)	50-220	270
	(ft·lbs)	111-258	332		(ft·lbs)	361.6-1591.2	1953
MI-17C	(N·m)	255-549	R637 L686	MI-5000GS	(N·m)	490-2157	2647
	(kg·m)	26-56	R65 L70		(kg·m)	50-220	270
	(ft·lbs)	188.1-405.0	R470 L506		(ft·lbs)	361.6-1591.2	1953
MI-17M	(N·m)	245-441	R539 L588	MI-5000GL	(N·m)	490-2157	2647
	(kg·m)	25-45	R55 L60		(kg·m)	50-220	270
	(ft·lbs)	180.8-325.5	R398 L434		(ft·lbs)	361.6-1591.2	1953
MI-20P	(N·m)	392-784	980	MI-5500	(N·m)	1470-4197	5491
	(kg·m)	40-80	100		(kg·m)	150-428	560
	(ft·lbs)	289.3-578.6	723		(ft·lbs)	1084.9-3095.7	4050





Main Plant



Kamimine Plant



Kishima Plant



Hirokawa Plant



Kiyama Plant



Yamada Plant

## TOKU PNEUMATIC CO., LTD.

3-4, 4Chome, Katakasu, Hakata-ku, Fukuoka 812-0043 Japan

Phone : +81-92-431-0401

Fax : +81-92-431-1014

e-mail : [int-op@toku-net.co.jp](mailto:int-op@toku-net.co.jp)

URL : [www.toku-net.co.jp/en/](http://www.toku-net.co.jp/en/)



EMS 89393 / ISO 14001

DISTRIBUTOR