

Knobs

Specifications

Door Preparation:	Cross bore 2 1/8", edge bore 1", 1" x 2 1/4" latch mortise
Backset:	2 3/8" or 2 3/4"
Door Thickness:	1 3/8" to 1 3/4"
Cylinder:	KW1 standard, SC1 available, 5 pin
Chassis:	Cylindrical
Faceplate:	2 1/4" Round corner, drive-in available
Strikes:	2 1/4" Full rim standard for entry, 2 1/4" full lip standard for interior, others available
Bolt:	1/2" Throw
UL:	90 Minute fire rated available
Door Swing:	Entry & privacy functions for in-swinging doors only
ANSI Grading:	Meets Grade 2 standards

Finishes	Polished Brass (105)	Satin Nickel (119)	Polished Chrome (125)	Tuscan Bronze® (150)
Stafford	•	•		•
Ganyon	•	•	•	•
Lindingham		•		•
Webley	•	•		•
Barrett	•	•		

Dimensions

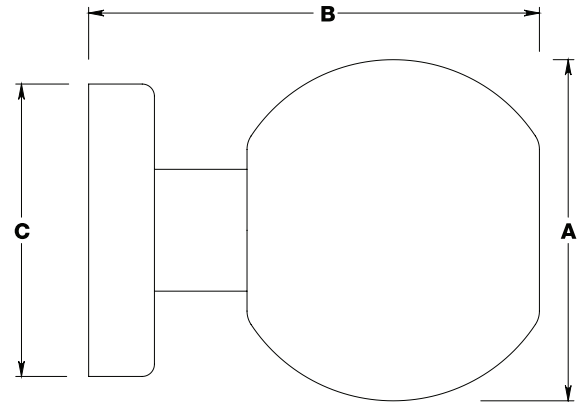

*Dimensions shown are for outside knob, passage function, 1 3/8" thick door

Style	A(in)	B(in)	C(in)
Stafford	2.37	2.82	2.95
Ganyon	2.37	2.81	2.95
Lindingham	2.23	2.73	2.95
Webley	2.34	2.57	2.95
Barrett	2.12	2.81	2.95

Functions

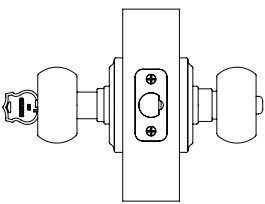

Keyed Entry

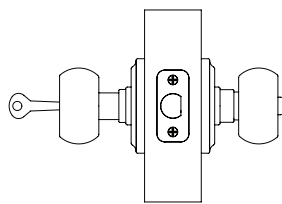

Privacy

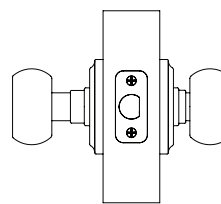

Passage

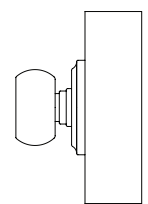

Dummy

Finishes



Polished Chrome
Ganyon



Satin Nickel
Barrett



Tuscan Bronze®
Stafford



Polished Brass
Webley