

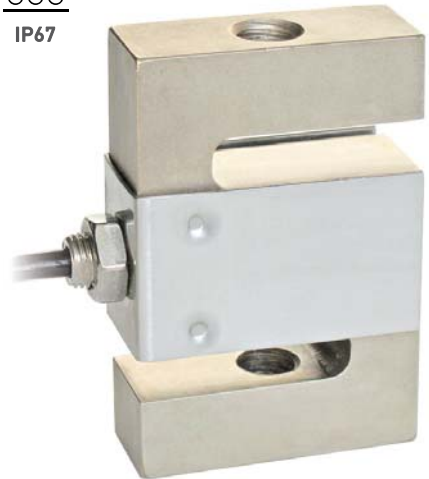

Capacity from 25 kg to 2500 kg



- SPECIAL STEEL
- COMBINED ERROR $\leq \pm 0.02\%$ (0.017% C4)
- PROTECTION CLASS IP67

| CAPACITY | kg | ACCURACY CLASS | | IECEx | Ex | EAC | EAC Ex | NTEP | EAC | NET WEIGHT (kg) | CODE |
|----------|----|----------------|----|-------|----|-----|--------|------|-----|-----------------|--------|
| | | C3 | C4 | | | | | | | | |
| 25 | | - | - | • | • | - | • | | | 0.4 | SL25 |
| 100 | | • | • | • | • | • | • | | | 0.6 | SL100 |
| 200 | | • | • | • | • | - | • | | | 0.6 | SL200 |
| 300 | | • | • | • | • | - | • | | | 0.6 | SL300 |
| 500 | | • | • | • | • | • | • | | | 0.7 | SL500 |
| 1000 | | • | • | • | • | • | • | | | 0.9 | SL1000 |
| 2500 | | • | • | • | • | • | • | | | 1.6 | SL2500 |

ON REQUEST

CERTIFICATIONS

- OIML R60 C3
- Complies with the Eurasian Custom Union standards

CERTIFICATIONS ON REQUEST

- ATEX II 1GD (zone 0-1-2-20-21-22)
- IECEx (zone 0-1-2-20-21-22)
- OIML R60 C4
- Complies with the Eurasian Custom Union standards for use in potentially explosive atmospheres
- NTEP - compliant to the metrological standards of United States and Canada

COMPLEMENTARY ACCESSORIES

| | DESCRIPTION | CODE |
|--|--|--|
| | Dimensions: M8x1.25 M10x1.5 M12x1.75 M20x1.5 | Load cell capacity: 25 kg 100 kg 200-1000 kg 2500 kg |
| | Special steel ball-and-socket joint with nut. | EM8DADO |
| | | EM10DADO |
| | | EM12DADO |
| | | EM20DADO |

DIMENSIONS (mm)

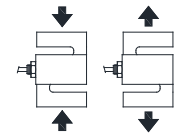
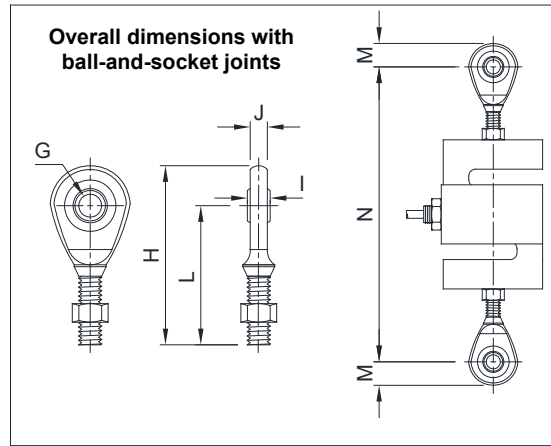
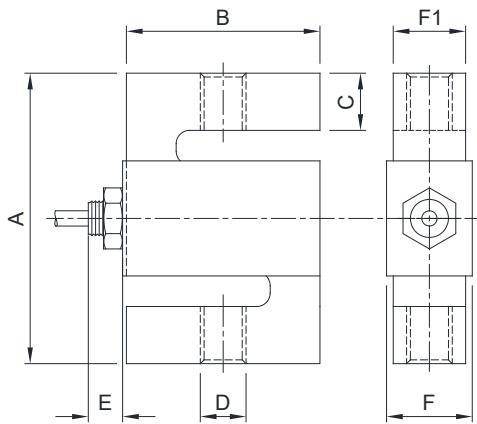

Example of application on the tension bar mechanical scale

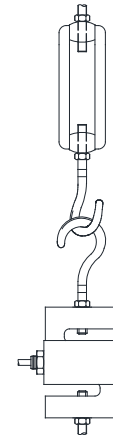

| | A | B | C | D | E | F | F1 | G | H | I | J | L | M | N (≈) |
|---------|-------|------|------|----------|----|------|------|-----|-------|----|------|------|------|-------|
| 25 kg | 76.2 | 50.8 | 15.7 | M8x1.25 | 10 | 14.5 | 12.7 | Ø8 | 54 | 8 | 6.5 | 42.5 | 11.5 | 129 |
| 100 kg | 76.2 | 50.8 | 15.3 | M10x1.5 | 9 | 22.4 | 19 | Ø10 | 62.5 | 9 | 7.5 | 48.5 | 14 | 142 |
| 200 kg | | | | | 8 | | | | | | | | | |
| 300 kg | 76.2 | 50.8 | 14.4 | M12x1.75 | 9 | 22.4 | 19 | Ø12 | 71 | 10 | 8.5 | 54.5 | 16.5 | 154 |
| 500 kg | | | | | 9 | | | | | | | | | |
| 1000 kg | 76.2 | 50.8 | 12.5 | M12x1.75 | 10 | 28.9 | 25.4 | Ø12 | 71 | 10 | 8.5 | 54.5 | 16.5 | 159 |
| 2500 kg | 101.6 | 76.2 | 20 | M20x1.5 | 6 | 28.9 | 25.4 | Ø20 | 104.5 | 16 | 13.5 | 77.5 | 27 | 217 |

TECHNICAL FEATURES

| Material | Special steel | | |
|--|-----------------|--|--|
| OIML R60 Accuracy class • Verification intervals | - | C3 • 3000 | C4 • 4000 |
| Nominal load (E max) | 25 kg | 100 - 200 - 300 kg 500 - 1000 - 2500 kg | 100 - 200 - 300 kg 500 - 1000 - 2500 kg |
| Minimum verification interval (V min) | - | E max / 10000 E max / 15000 | E max / 20000 |
| Combined error | ≤ ±0.02% | ≤ ±0.02% | ≤ ±0.017% |
| Protection class | IP67 | | |
| Rated output | 2 mV/V ±0.2% | Input resistance | 350 Ω ±3.5 |
| Temperature effect on zero | 0.0015% °C | Output resistance | 350 Ω ±3.5 |
| Temperature effect on span | 0.0017% °C | Zero balance | ±1% |
| Compensated temperature range | -10 °C / +40 °C | Insulation resistance | >5000 MΩ |
| Operating temperature range | -35 °C / +65 °C | Safe overload (% of full scale) | 150% |
| Creep at nominal load in 30 minutes | 0.03% | Ultimate overload (% of full scale) | 300% |
| Max supply voltage without damage | 18 V | Deflection at nominal load | 0.4 mm |

ELECTRICAL CONNECTIONS

| | |
|----------------|---|
| Cable length | 5 m (25 - 300 kg); 10 m (500 - 2500 kg) |
| Cable diameter | 5 mm |
| Cores | 4 x 0.24 mm ² |

