



## Sunbeam Service Sheet No. 9

**Subject: Sidecar Connections (Models S.7 & S.8)**

**Date: None shown**

### SIDECAR CONNECTIONS

Both models utilise the same front frame connection underneath the tank, the parts required to connect with the chassis member being:

3 - 1766	Ft Stay connector
2C - 5/8	Slotted Nut
3 - 1049	Washer
35 - 714	Split pin

### REAR FRAME CONNECTION

S.7 models up to Frame No. S7-2501 and S.8 models up to Frame No. S8-101 require the stud and bracket as illustrated (*Figure 1*). The model can be identified by the position of the tapped hole in the corner formed by the frame members.

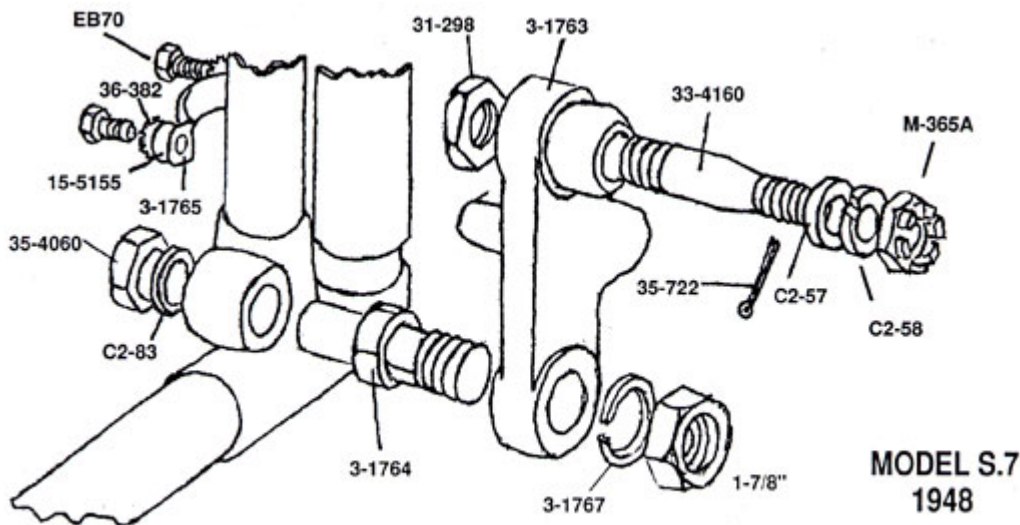

**Fig. 1**

### S.7 AND S.8 MODELS

All models after Frame Nos. S7-2502 and S8-102 utilise the single connector as shown in *Figure 2*. In this case the tapped hole is situated higher up the rear member.



# STEWART ENGINEERING

**THE SUNBEAM SPECIALISTS**

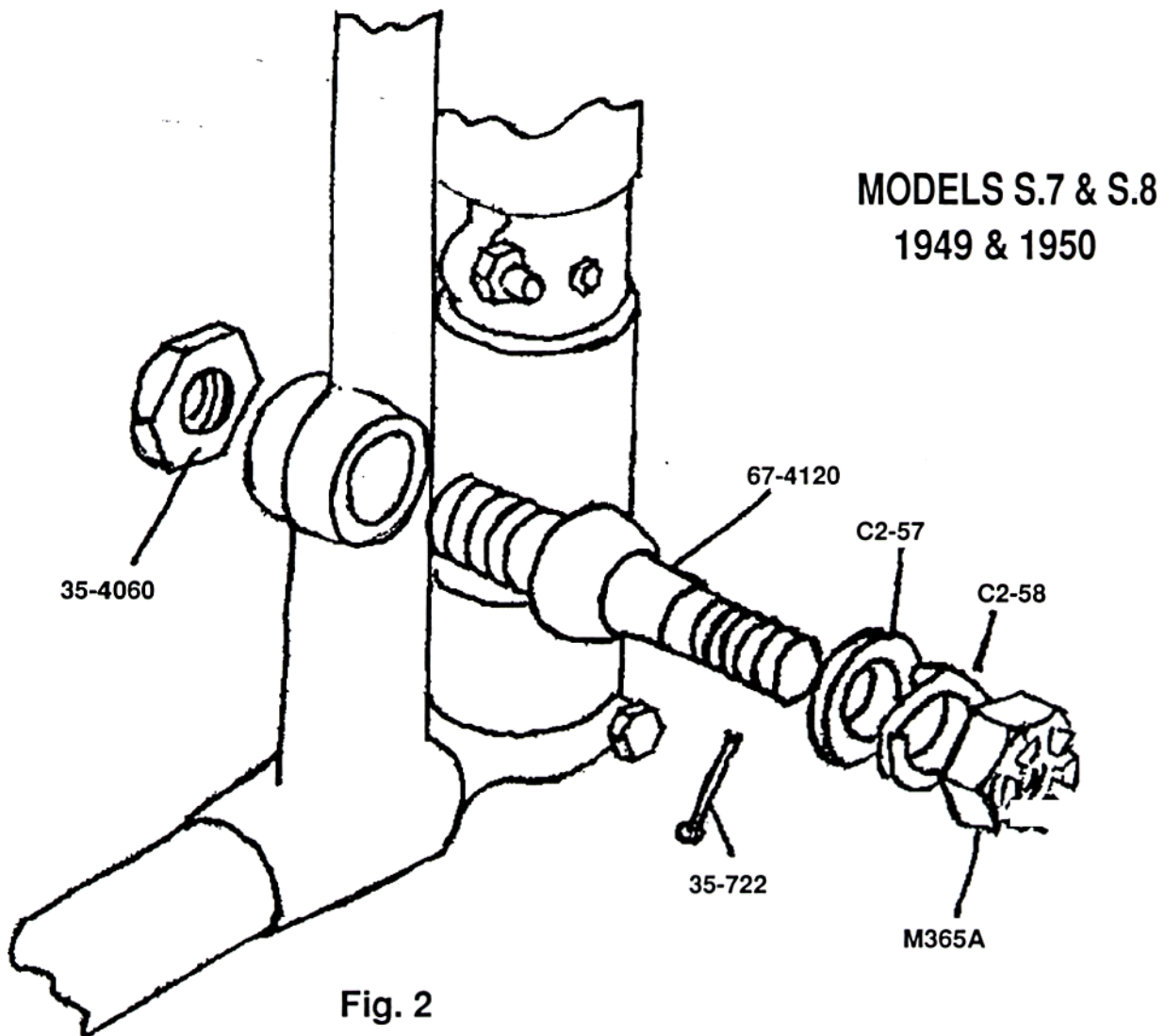

**MODELS S.7 & S.8  
1949 & 1950**

**Fig. 2**

#### **4th POINT CONNECTION**

This requires the removal of one domed nut holding the N/Side Crankcase buffer, in its place is fitted 3-1768 connector with bolt C2-109 and Nut EA-82.

**SERVICE DEPARTMENT  
B.S.A. CYCLES LIMITED**