

INNOVATION & TECHNOLOGY

SOAR
TRG

14+

ACHTUNG:
Nicht für Kinder unter 36 Monaten
geeignet. Enthält Kleinteile, die
verschluckt werden können.
(Erstickungsgefahr)



998

INSTRUCTION MANUAL



SOARSEIKI. Co.,Ltd

Info@soarseiki.com

INDEX

INTRODUCTION		01
SYMBOLS USED		04
BAGS A1	Front Diff Installation Rear Diff Installation	05
BAGS A2	Center Diff Installation	06
BAGS B1	FRONT TRANSMISSION	07-09
BAGS B2	FRONT TRANSMISSION FRONT SUSPENSION	10-12
BAGS C1	REAR TRANSMISSION REAR SUSPENSION	13-15
BAGS C2	REAR TRANSMISSION REAR SUSPENSION	16-17
BAGS D	CHASSIS BRACE AND WING SLAY	18
BAGS E	STEERING	19-20
BAGS F	CENTER DIFF & BRAKE	21-22
BAGS G	FRONT/CENTER/REAR ASSEMBLY	23-24
BAGS H	ENGINE&FUEL TANK	25-27
BAGS I	RADIO CASE	28-29
BAGS J	SHOCK ABSORBERS	30
BAGS K	FINAL ASSEMBLY	31-34

INSTRUCTION

Soar998 is a modern, high-competition extraordinary racing 1/8 nitro buggy that is the epitome of high-performance and fine distinctive design. Soar998 will present to you the highest performance, responsive handling, and extraordinary quality, engineering and fabulous design. The splendid craftsmanship and attention to detail are clearly evident everywhere from Soar998.

Soar998 was designed around a no compromise stage; Soar Seiki creates a low maintenance, extra-long life nitro buggy; namely, Soar998. The ultra-low center of gravity (CG) and optimized weight balance makes set-up, driving, and maintenance easy and quick.

Soar998 was created by multiple highest-quality materials and excellent design as aforesaid. On high-speed flat tracks or bumpy tracks, whether driving for fun or racing to win, the Soar998 deliver outstanding performance, speed, and excellent precision handling. We have made all our effort to make these instructions as easily as possible. If you have any difficulties, problems or questions, please do not hesitate to contact Soar Seiki supported team-group at info@soarseiki.com.

Please also come to visit our web site at <http://www.soar-rc.com/> and <http://www.soarseiki.com/> to find our latest news, option parts, and all other types of merchandise. We will do our best to take care all the need request from our honored customers who support us worldwide.

WARRANTY

Soar Seiki Model Racing Cars guarantee this model kit to be free from defects in both material and workmanship within 30 days of purchase. The total monetary value under warranty will in no case exceed the cost of the original kit purchased. This warranty does not cover any components damaged by use or modification or as a result of wear. Part or parts missing from this kit must be reported within 30 days of purchase. No part or parts will be sent under warranty without proof of purchase. Should you find a defective or missing part, please contact the local distributor. Service and customer support will be provided through local hobby store where you have purchased the kit, therefore make sure to purchase any Soar Seiki products at your local hobby store. This model racing car is considered to be a high-performance racing vehicle. As such vehicle will be used in an extreme range of conditions and situations, all which may cause premature wear or failure of any component. Soar Seiki has no control over usage of vehicles once they leave the dealer, therefore Soar Seiki can only offer warranty against all manufacturer's defects in materials, workmanship, and assembly at point of sale and before use. No warranties are expressed or implied that cover damage caused by what is considered normal use, or cover or imply how long any model cars' components or electronic components will last before requiring replacement. Due to the high performance level of this model car you will need to periodically maintain and replace consumable components. Any and all warranty coverage will not cover replacement of any part or component damaged by neglect,

QUALITY CERTIFICATE

SOAR SEIKI use only the highest quality materials and the best components for molded parts and the most sophisticated manufacturing processes of TQM (Total Quality Management). We guarantee that all parts of a newly-purchased kit are manufactured with the highest quality. Nevertheless, due to the many factors inherent in model race car

Failure to follow these instructions will be considered as abuse and/or neglect.

R/C & BUILDING TIPS

- Make sure all fasteners are properly tightened. Check them periodically.
- Make sure that chassis screws do not protrude from the chassis.
- For the best performance, it is very important that great care is taken to ensure the free movement of all parts.
- Clean all ball-bearings so they move very easily and freely.
- Tap or pre-thread the plastic parts when threading screws.
- Self-tapping screws cut threads into the parts when being tightened. Do not use excessive force when tightening the self-tapping screws because you may strip out the thread in the plastic. We recommend you stop tightening a screw when you feel some resistance.

IMPORTANT NOTES – GENERAL

- This product is not suitable for children under 16 years of age without the direct supervision of a responsible and knowledgeable adult.
- Carefully read all manufacturer-warnings and cautions for all parts used in the construction and use of your model/product.
- Assemble this kit only in places away from the reach of young children.
- First-time builders and users should seek advice from people who have building/combining experience in order to assemble the model/product correctly and to allow the model to reach its performance potential.
- Exercise care when using tools and sharp instruments.
- Be aware that when building, as some parts may have sharp edges.
- Keep small parts out of reach of small children. Children must not be allowed to put any parts in their mouth, or pull vinyl bag over their head.
- Read and follow instructions supplied with paints and/or cement, if used (not included in kit).
- After using your model, do NOT touch equipment on the model such as the motor and speed controller basing on they generate high temperatures. You may seriously burn yourself seriously touching them.

CUSTOMER SUPPORT

We have made all-out effort to make the instructions of Soar998 as easily to understand. Please do not hesitate to contact our Soar Seiki supported team-group at info@soarseiki.com. Please also come to visit our Website at <http://www.soar-rc.com/> and <http://www.soarseiki.com/> to find our latest news, option parts, and all other types of merchandise. We will do our best to take care all the need request from our honored customers who support us worldwide. You can also join Soar Seiki fans and enthusiasts in our online community at:

Soar Seiki Co., Ltd.

Address:

No.163-1, Zhongsha Rd., Dadu Dist.,
Taichung City 432,
Taiwan (R.O.C.)

Email: info@soarseiki.com

abuse, or improper or unreasonable use. This includes but not limited to damage from crashing, chemical and/or water damage, excessive moisture, improper using or no maintenance, or user modifications which compromise the integrity of components. Warranty will not cover components that are considered consumable on RC vehicles. Soar Seiki do not pay nor refund shipping on any component sent to Soar Seiki or its distributors for warranty. Soar Seiki reserve the right to make the final determination of the warranty status of any component or part.

Limitations of Liability

Soar Seiki make no other warranties expressed or implied. Soar Seiki shall not be liable for any loss, injury or damages, whether direct, indirect, special, incidental, or consequential, arising from the use, misuse, or abuse of this product and/or any product or accessory required to operate this product. In no case shall Soar Seiki's liability exceed the monetary value of this product. Take adequate safety precautions prior to operating this model. You are responsible for this model's assembly and safe operation. Disregard of the any of the above cautions may lead to accidents, personal injury, or property damage. SOAR SEIKI assume no responsibility for any injury, damage, or misuse of this product during assembly or operation, nor any addictions that may arise from the use of this product.

competition, we cannot guarantee all parts upon starting racing the car. Products which have been worn out, abused, neglected or improperly operated will not be covered under warranty.

We wish your enjoyment of this high-quality and high-performance RC car and wish your best success on the track!

- Ask your local hobby shop for any advice.

Please support your local hobby shop. We at Soar Seiki Model Racing Cars support all local hobby dealers. Therefore we ask you, if at all possible, to purchase Soar Seiki products at your hobby dealer and give them your support like we do. If you have difficulty finding Soar Seiki products, please check out our website <http://www.soar-rc.com/> and <http://www.soarseiki.com/> to get advice, or contact us via email at info@soarseiki.com, or contact the Soar Seiki distributor in your country.

- Follow the operating instructions for the radio equipment at all times.
- Do not put fingers or any objects inside rotating and moving parts, as this may cause damage or serious injury as your finger, hair, clothes, etc.
 - Be sure that your operating frequency is clear before turning on or running your model, and never share the same frequency with somebody else at the same time. Ensure that others are aware of the operating frequency you are using and when you are using it.
 - Use a transmitter designed for ground using with RC cars. Make sure that no one else is using the same frequency as yours in your operating area. Using the same frequency at the same time, whether it is driving, flying or sailing, can cause loss of control of the RC model, resulting in a serious accident.
 - Always turn on your transmitter before you turn on the receiver in the car. Always turn off the receiver before turning your transmitter off.
- Tap or pre-thread the plastic parts when threading screws.

INSTRUCTION

- Self-tapping screws cut threads into the parts when being tightened. Do not use excessive force when tightening the self-tapping screws because you may strip out the thread in the plastic. We recommend you stop tightening a screw when you feel some resistance.
- Ask your local hobby shop for any advice. Please support your local hobby shop. We at Soar Seiki Model Racing Cars support all local hobby dealers. Therefore we ask you, if at all possible, to purchase Soar Seiki products at your hobby dealer and give them your support like we do. If you have difficulty finding Soar Seiki products, please check out our website <http://www.soar-rc.com/> and <http://www.soarseiki.com/> to get advice, or contact us via email at info@soarseiki.com, or contact the Soar Seiki distributor in your country.
- Keep the wheels of the model off the ground when checking the operation of the radio equipment.
- Disconnect the battery pack before storing your model.
- When learning to operate your model, go to an area that has no obstacles if your model suffers a collision.
- Remove any sand, mud, dirt, grass or water before putting your model away.
- If the model behaves strange, immediately stop the model, check and resolve the problem.
- To prevent any serious personal injury and/or damage to property, be responsible when operating all remote controlled models.

IMPORTANT NOTES – NITRO ENGINES

- Always test the brakes and the throttle before starting your engine to avoid losing control of the model.
- Make sure the air filter is clean and oiled.
- Never run your engine without an air filter. Your engine can be seriously damaged if dirt and debris get inside to it.

IMPORTANT NOTES – ELECTRICAL

- Insulate any exposed electrical wiring (using heat shrink tubing or electrical tape) to prevent dangerous short circuits. Take maximum care in wiring, connecting and insulating cables. Make sure cables are always connected securely. Check connectors for if they become loose. And if so, reconnect them securely. Never use R/C models with damaged wires. A damaged wire is extremely dangerous, and can cause short-circuits resulting in fire. Please prepare wires repaired at your local hobby shop.
- Low battery power will result in loss of control. Loss of control can occur due to a weak battery in either the transmitter or the receiver. Weak running battery may also result in an out of control car if your car's receiver power is supplied by the running battery. Stop operation immediately if the car starts to slow down.
- When not using RC model, always disconnect and remove battery.
- Do not disassemble battery or cut battery cables. If the running battery short-circuits, approximately 300W of electricity can be discharged, leading to fire or burns. Never disassemble battery or cut battery cables.

IMPORTANT NOTES – NITRO FUEL

- Handle fuel only outdoors. Never handle nitro fuel indoors, or mix nitro fuel in a place where ventilation is bad.
- Only use nitro fuel for R/C models. Do not use gasoline or kerosene in R/C models as it may cause a fire or explosion, and destroy your engine.
- Nitro fuel is highly inflammable, explosive, and poisonous. Never use fuel indoors or in places with open fires and any kind of sources of heat.
- Always keep the fuel container cap tightly shut.
- Always read the warning label on the fuel container for safety information/reference.
- Nitro-powered model engines emit poisonous vapors and gasses. These vapors irritate eyes and can be highly dangerous to your health. We recommend wearing rubber or vinyl gloves to avoid direct contact with nitro fuel.
- Nitro fuel for RC model cars is made of the combination of the methyl alcohol, castor or synthetic oil, nitro methane etc. The flammability and volatility of these elements is very high, so be very careful during handling and storage of nitro fuel.

- The model car is not intended for use on public places and roads or areas where its operation conflict with or disrupt pedestrian or vehicular traffic.
- The model car is controlled by radio, it is subject to radio interference from many sources that are beyond your control. Since radio interference can cause momentary loss of control, always allow a safety margin in all directions around the model in order to prevent collisions.
- Do not use your model:
 - Near real cars, animals, or people that are unaware that an RC car is being driven.
 - In places where children and people gather
 - In residential districts and parks
 - In limited indoor spaces
 - In wet conditions
 - In the street
 - In areas where loud noises can disturb others, such as hospitals and residential areas.
 - At night or anytime your line of sight to the model may be obstructed or impaired in any way.

- For proper engine break-in, please refer to the manual that came with the engine.
- Do not run near open flames or smoke while running your model or while handling fuel.
- Some parts will be hot after operation. Do not touch the exhaust or the engine until they have cooled. These parts may reach 275°F during operation!

- Use a recommended charger for the receiver and transmitter batteries and follow the instructions correctly and carefully. Over-charging, incorrect charging, or using inferior chargers can cause the batteries to become dangerously hot. Recharge battery when it is necessary. Continual recharging may damage battery and, in the worst case, could build up heat leading to fire. If battery becomes extremely hot during recharging, please ask your local hobby shop to check and/or repair and/or replacement.
- Regularly check the charger for potential hazards such as damage to the cable, plug, casing or other defects. Ensure that any damage is rectified before using the charger again. Modifying the charger may cause short-circuit or overcharging leading to a serious accident. Therefore do not modify the charger.

- Keep nitro fuel away from open flame, sources of heat, direct sunlight, high temperatures, or near batteries.
- Store fuel in a cool, dry, dark, well-ventilated place, away from heating devices, open flames, direct sunlight, or batteries. Keep nitro fuel away from children.
- Do not leave the fuel in the carburetor or fuel tank when the model is not in use. It is danger that the fuel may leak out.
- Wipe up any spilled fuel with a cloth.
- Be care of spilled or leaking fuel. Fuel leaks can cause fires or explosions.
- Do not dispose of fuel or empty fuel containers in a fire. There is danger of explosion.

**In view of our policy of continuous product improvement,
the exact specifications/parts of the kit may change.**

In the unlikely event of any problems with your new kit,

please kindly contact the model shop where you purchased it, quoting the part number to search.

We do reserve all rights to change any specifications/parts without prior notice.

All rights reserved.

SYMBOLS USED

Part bags used



Assemble in the specified order



Assemble left and right sides the same way



Assemble front and rear the same way



Cut off remaining material



Assemble as many times as specified (here twice)



Apply instant glue



Additional Items Needed For Completion

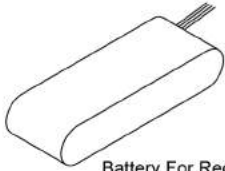

Battery For Receiver



Battery For Transmitter

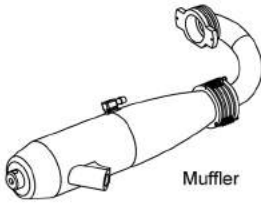

Muffler

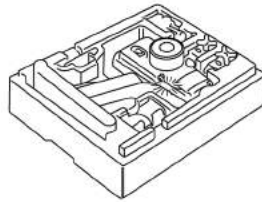

2 Channel Radio

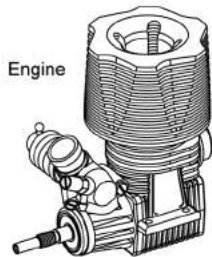

Engine

Tools needed To Assemble

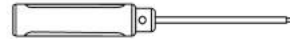

Hex Wrenches

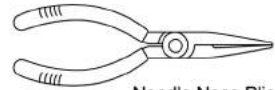

Needle Nose Pliers

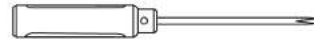

Phillips Type Screw Driver



Scissors



Box Wrench (5.5mm / 7mm / 10mm)



Hobby Knife

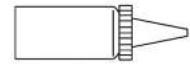

Instant Glue



Pliers



Screw (Sement)

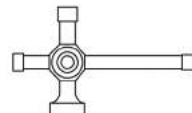

Utility Wrench



Glass or Vinyl Tape

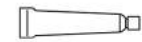

Rubber Glue

Additional Items Needed For Starting

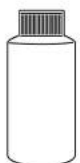

Air Filter Oil



Fuel Pump

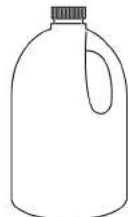

Fuel

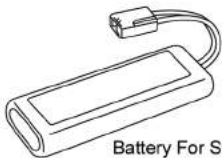

Battery For Starter Box

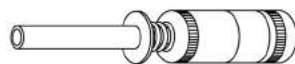

Glow Plug Ignitor

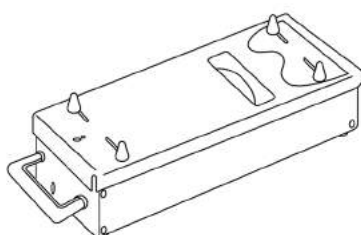

Starter Box

Items Needed To Control Car

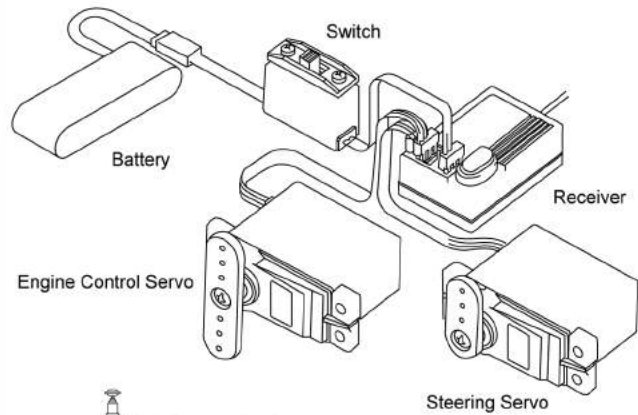

Transmitter

1 Front & Rear Differentials

BAGS A1



STEP A1-1

Front and rear diff

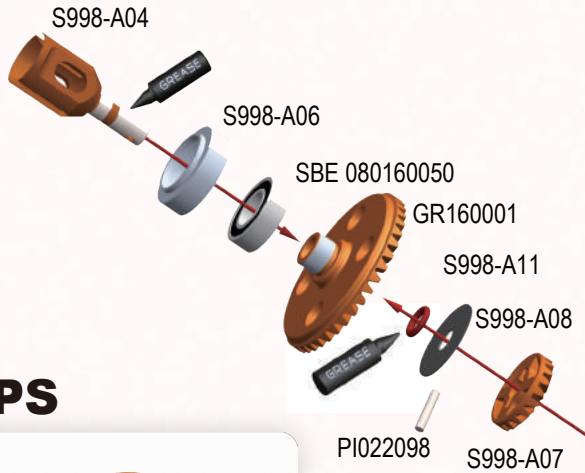

TIPS

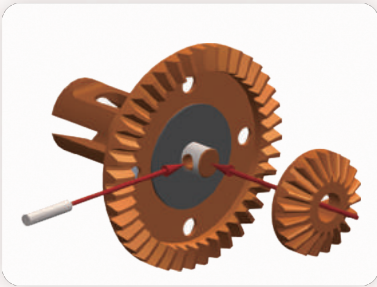

STEP A1-3

Front and rear diff

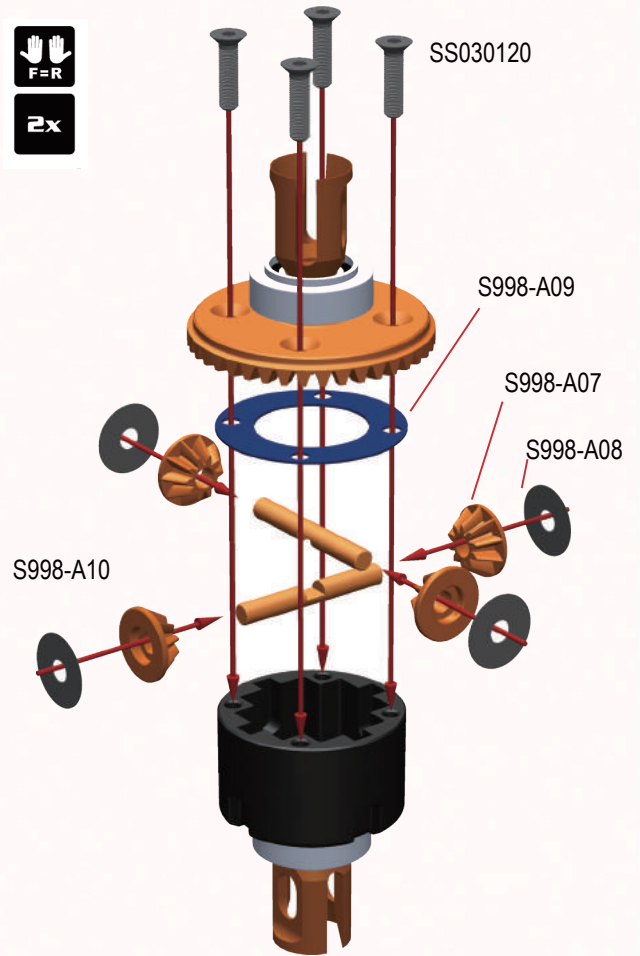

TIPS



Front diff 7000 cts
Rear diff 1000 cts



STEP A1-2

Front and rear diff

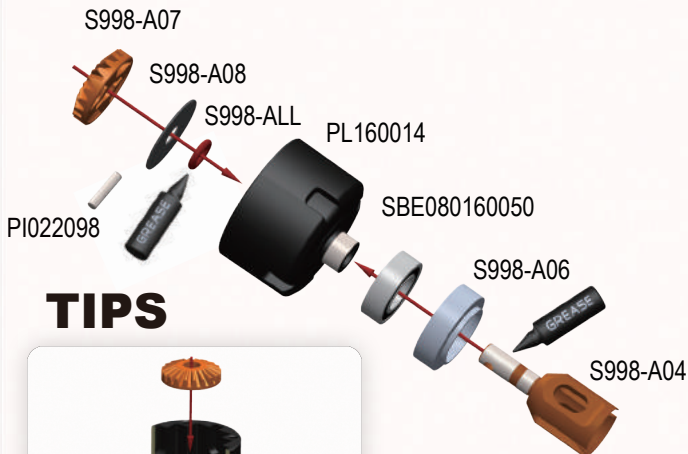

TIPS

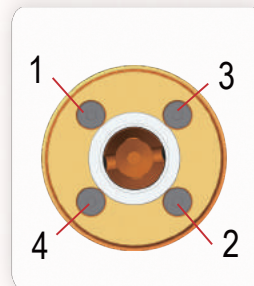
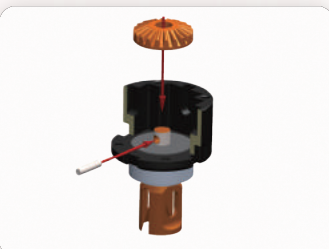

Finish Tightening in this order

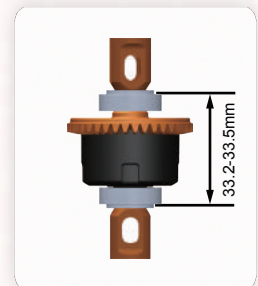

After assemble the differential should have a length of 33.2-33.5 mm measured from the end of ball bearings caps. If differential is longer, re-tighten the 4 screws holding the spur gear.

2 Center Differential

BAGS A2



STEP A2-1

Center diff

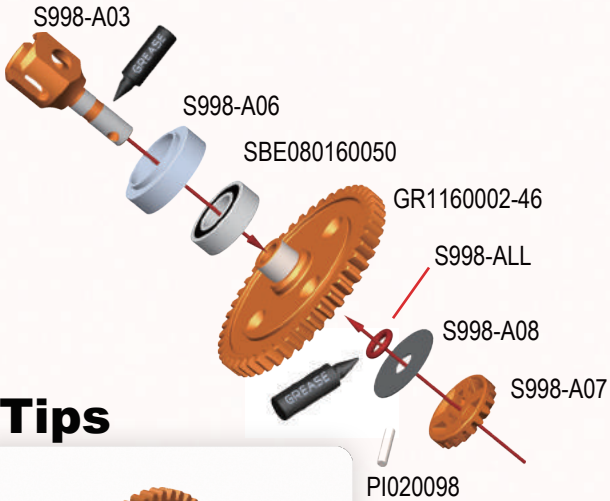

Tips

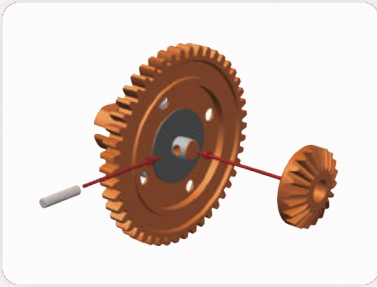

STEP A2-2

Center diff

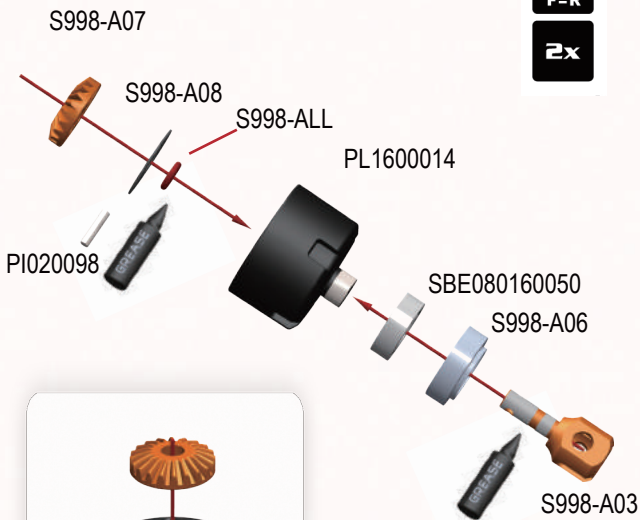

STEP A2-3

Center diff



OPTIONS	
GR160002-44	44T
GR160002-45	45T
GR160002-46	46T
GR160002-47	47T
GR160002-48	48T

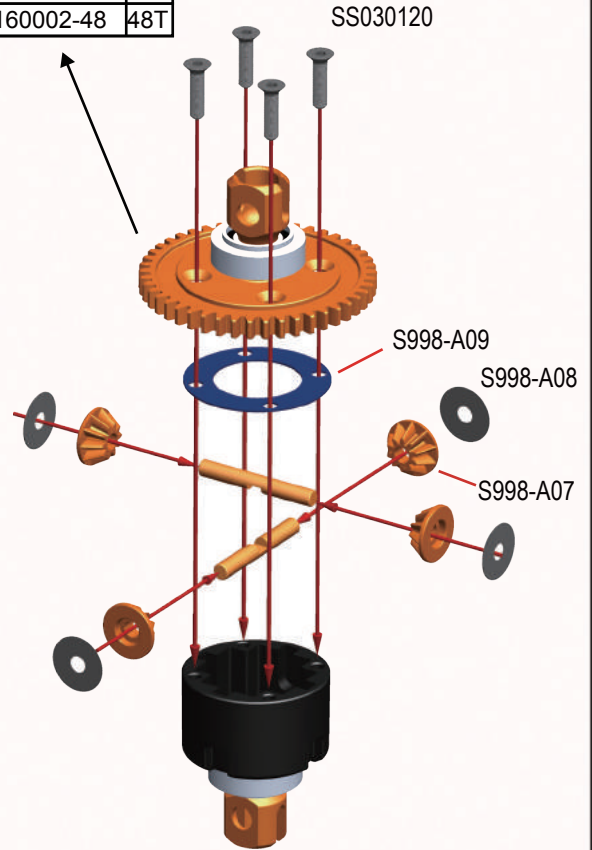

Tips



Center diff 5000 cts

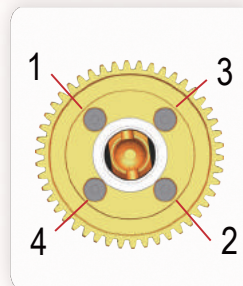

Finish Tightening in this order

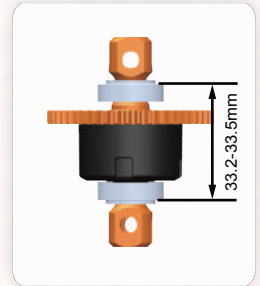

After assemble the differential should have a length of 33.2-33.5 mm measured from the end of ball bearings caps. If differential is longer, re-tighten the 4 screws holdinf the spur gear.

3 FRONT TRANSMISSION

BAGS B1

STEP B1-1

13T Pinion Gear

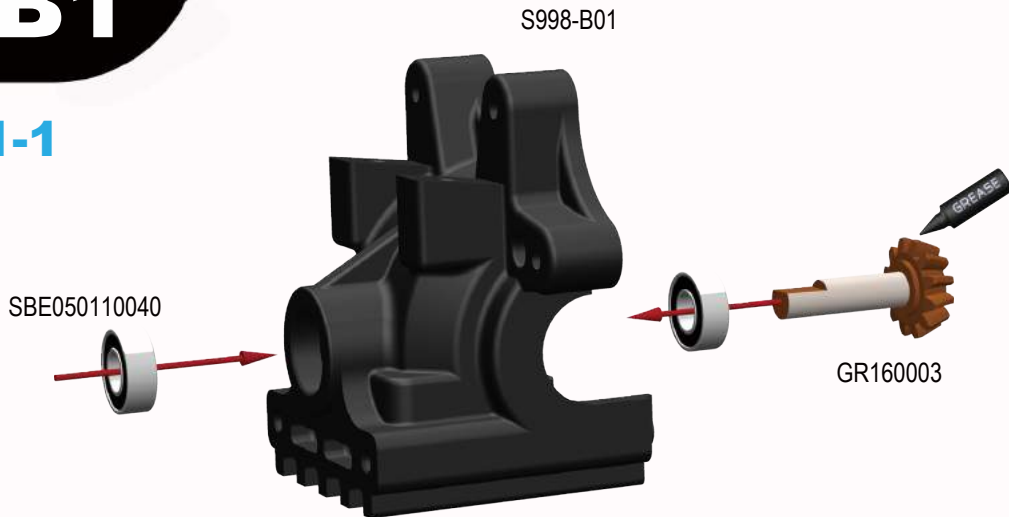

STEP B1-2

Front Center Universal

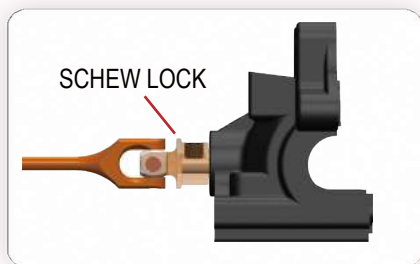

Push joint against gear to remove gap, Tighten set screw on to gear flat spot

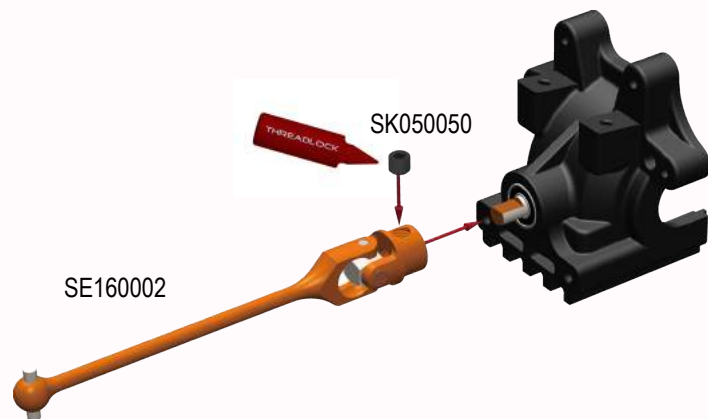

STEP B1-3

Front Gear Case

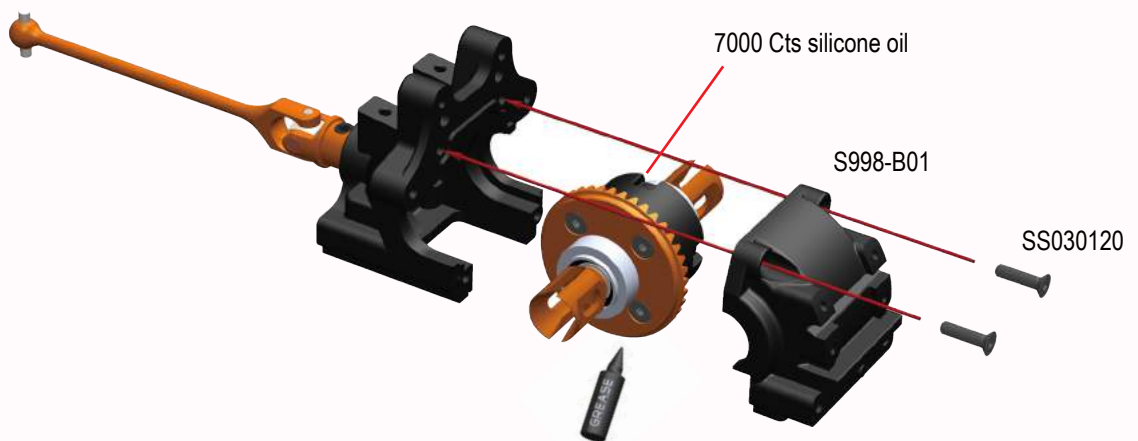

3 FRONT TRANSMISSION

BAGS B1

STEP B1-4

Front Shock Tower

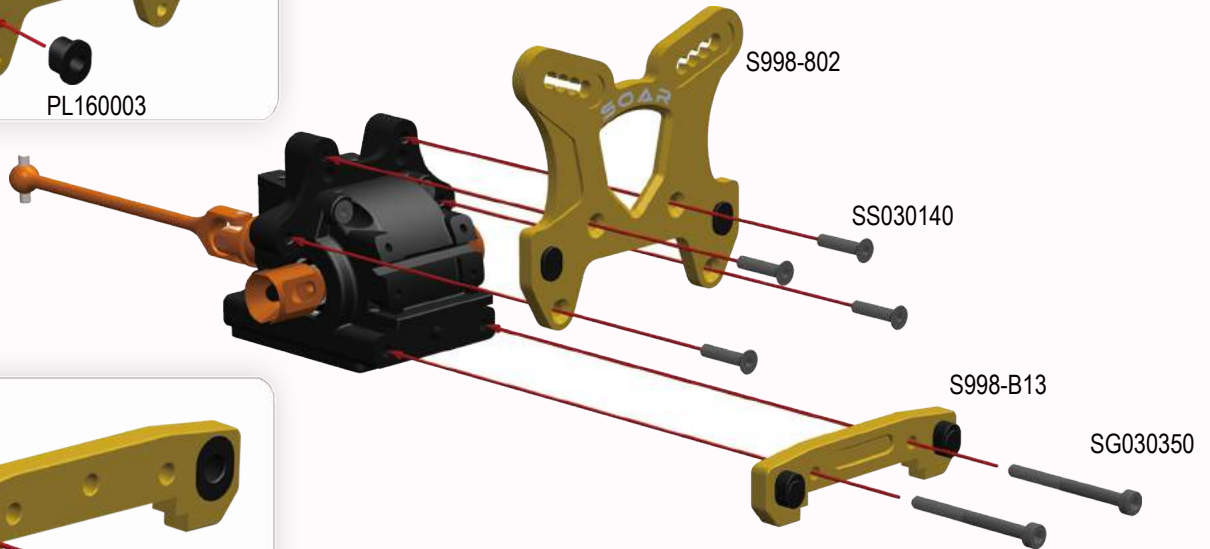

STEP B1-5

Front Shock Pivot Mount

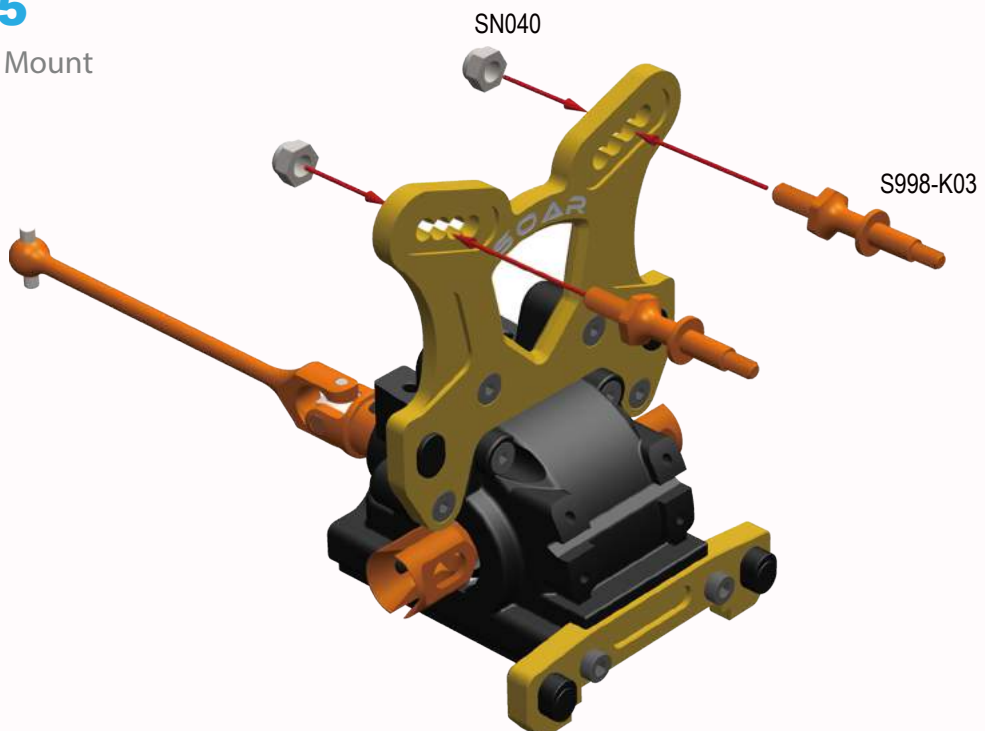

3 FRONT TRANSMISSION

BAGS B1

STEP B1-6

Front Lower Arm



STEP B1-7

Front Anti-Roll-Bar

OPTIONS	
SP160001-18	1.8mm
SP160001-19	1.9mm
SP160001-20	2.0mm
SP160001-21	2.1mm
SP160001-22	2.2mm
SP160001-23	2.3mm
SP160001-24	2.4mm
SP160001-25	2.5mm
SP160001-26	2.6mm

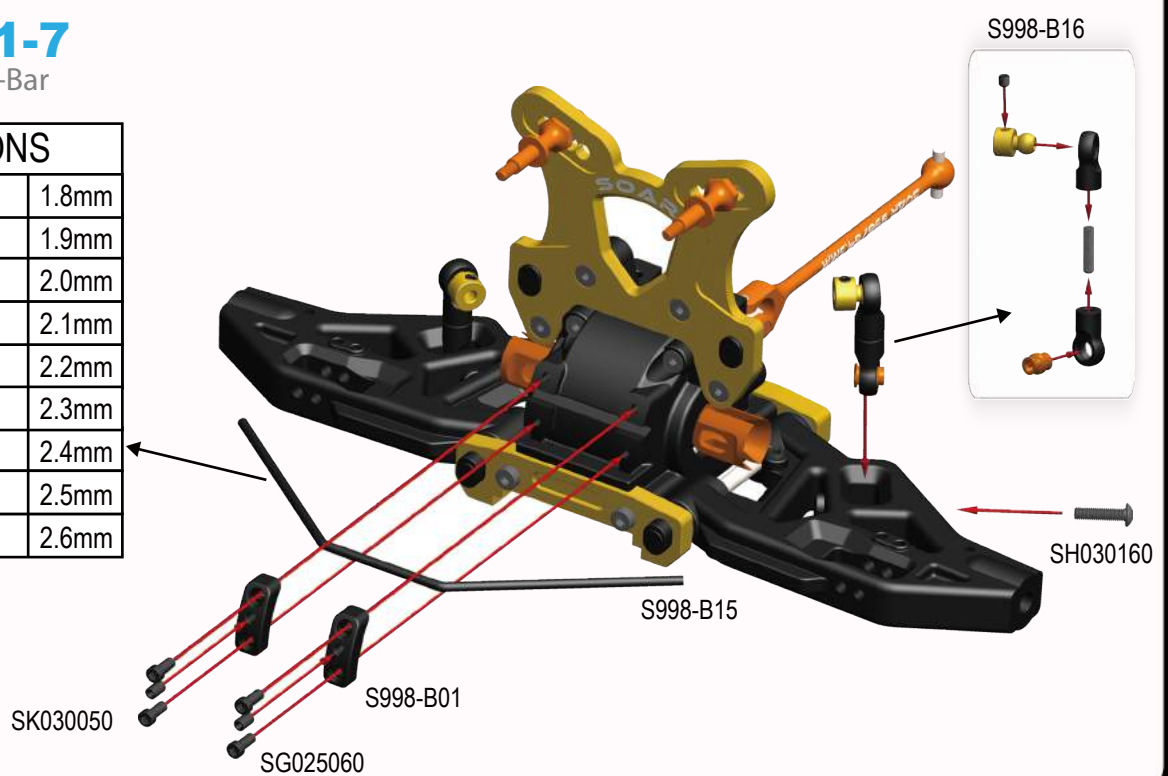

4 FRONT SUSPENSION

BAGS B2

STEP B2-1

Steering Block

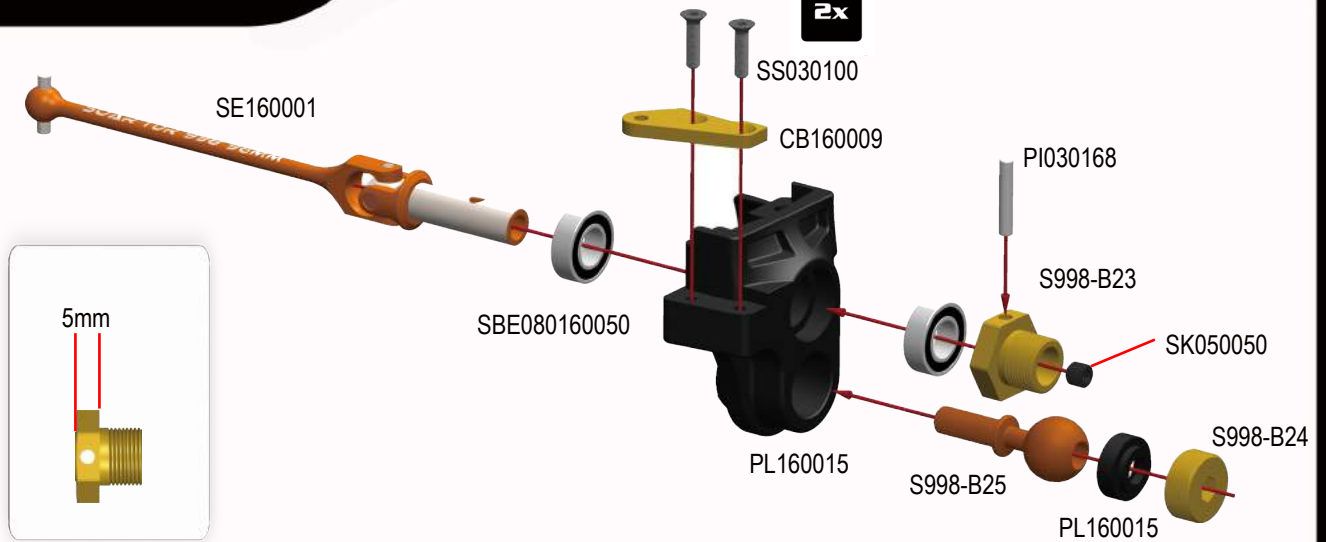

STEP B2-2

Front Support plate

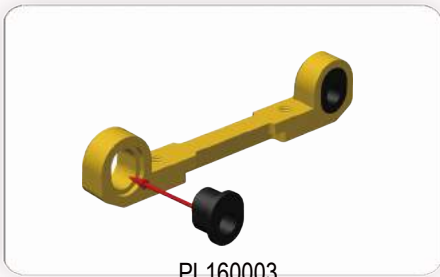

PL160003

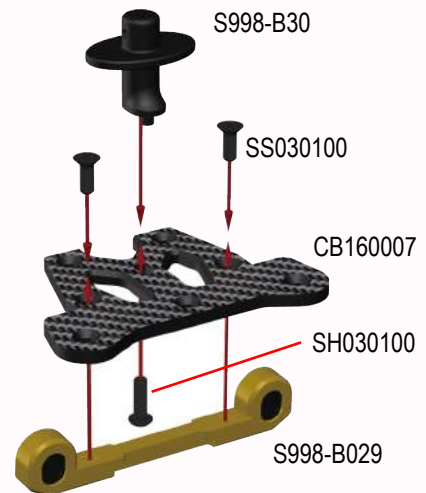

STEP B2-3

Front Upper Arm

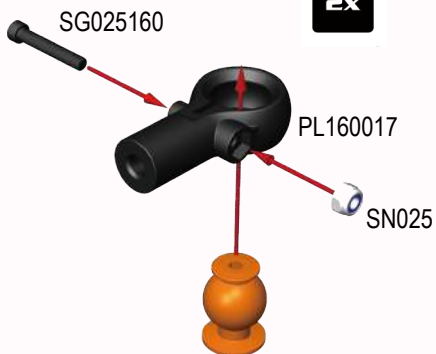

L



R

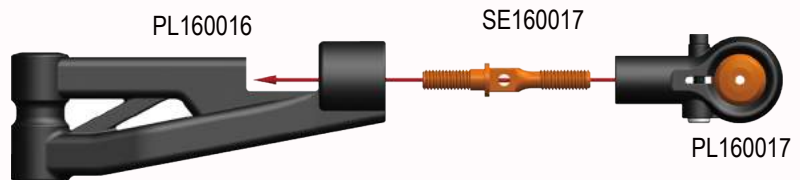

4 FRONT SUSPENSION

BAGS B2

STEP B2-5

Front Upper Arm

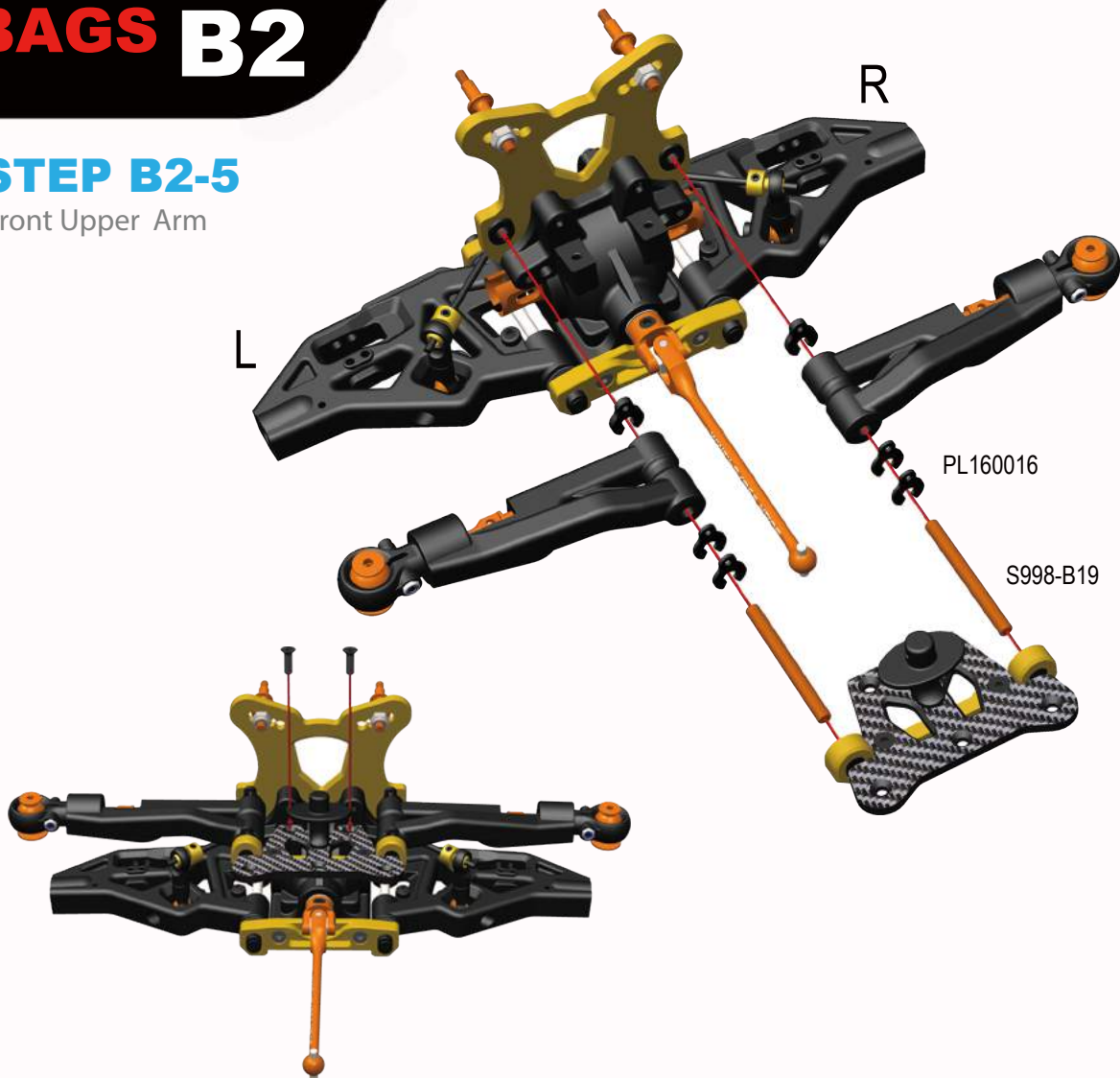

STEP B2-6

Steering Block

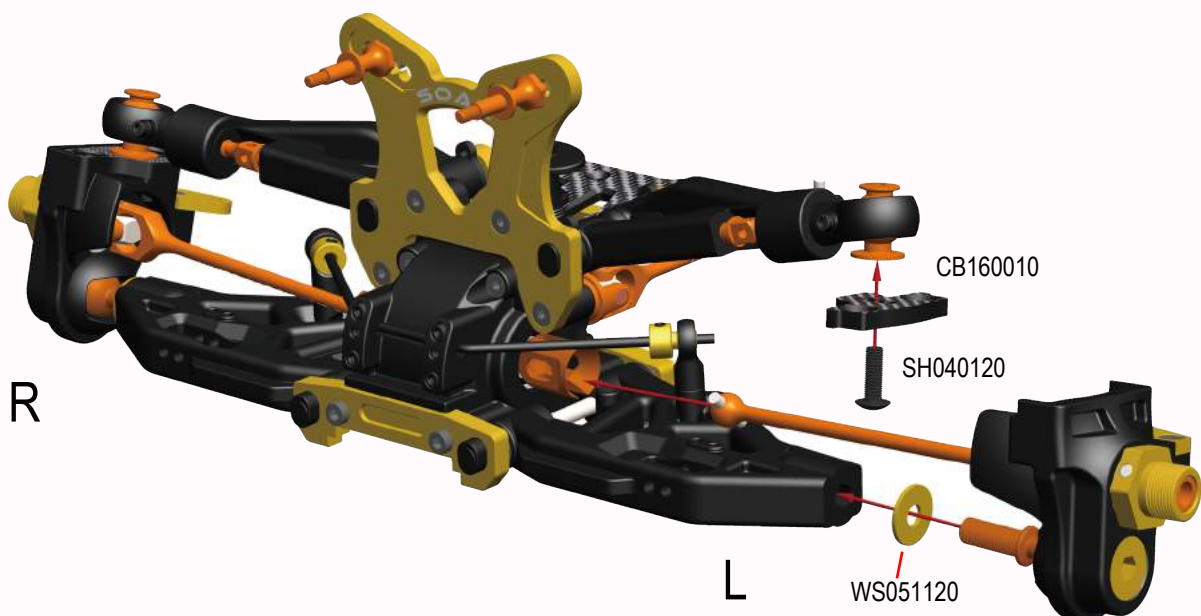

4 FRONT SUSPENSION

BAGS B2

STEP B2-7

Steering Upper Block

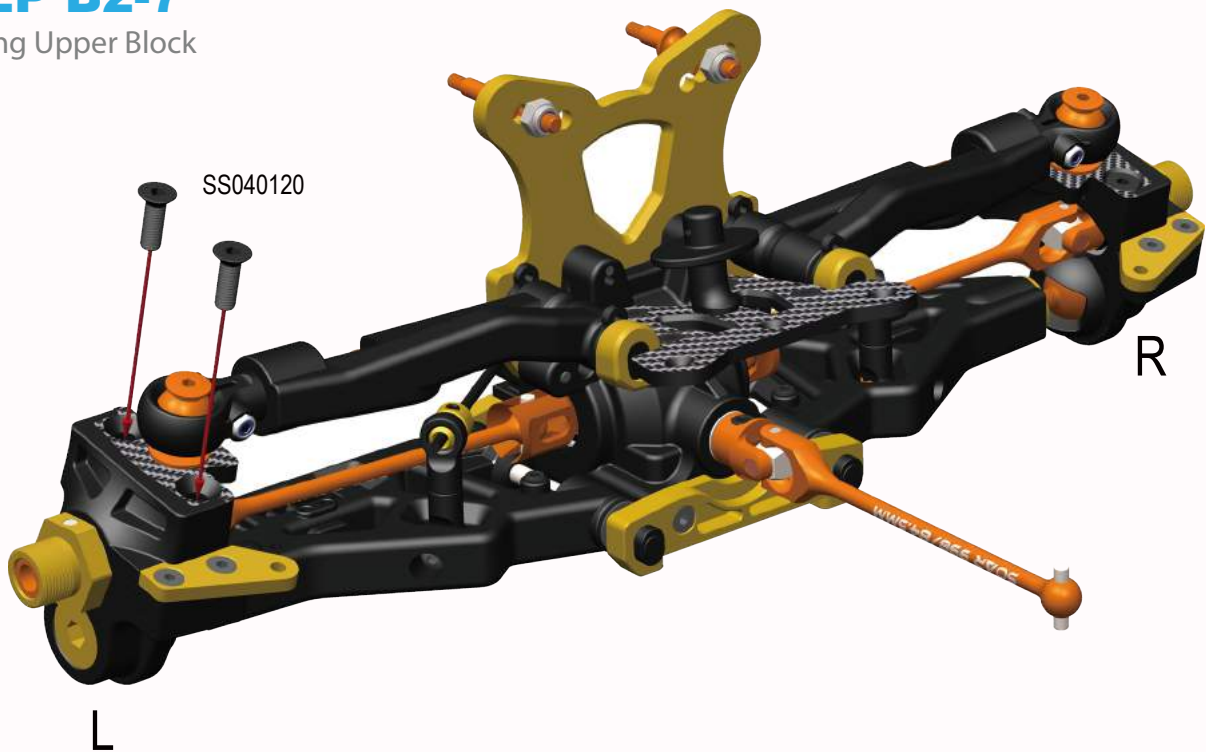

STEP B2-8

Front Suspension



5 REAR TRANSMISSION

BAGS C1

STEP C1-1

13T Pinion Gear

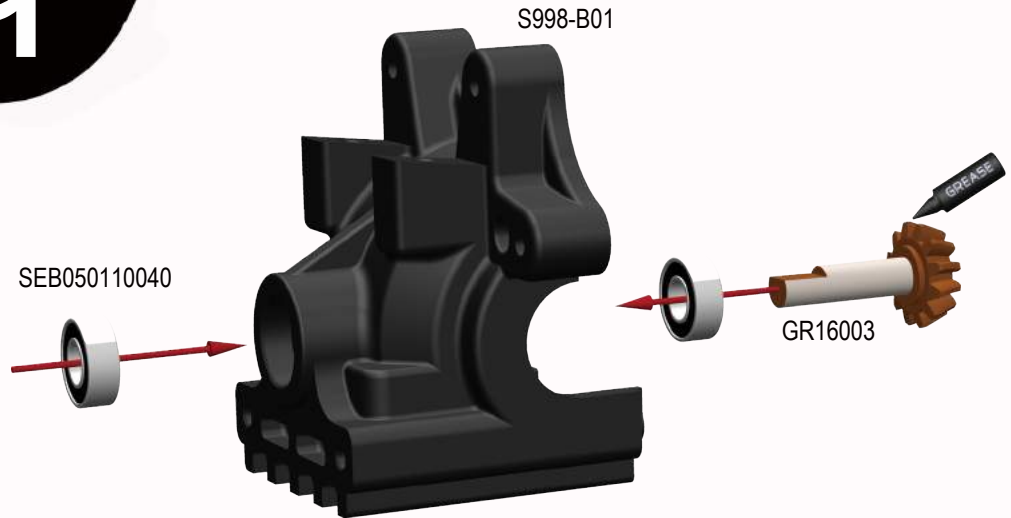

STEP C1-2

Rear Center Universal

TIP

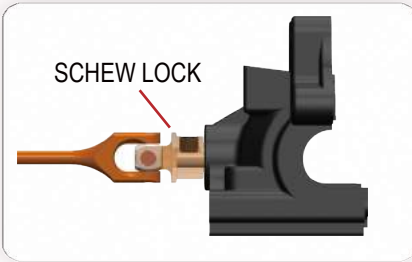

Push joint against gear to remove gap, Tighten set screw on to gear flat spot

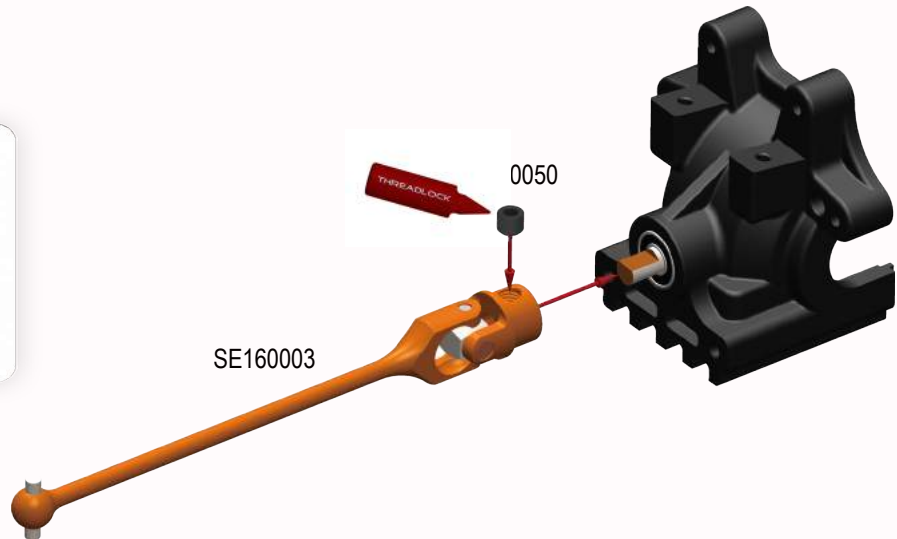

STEP C1-3

Rear Gear Case

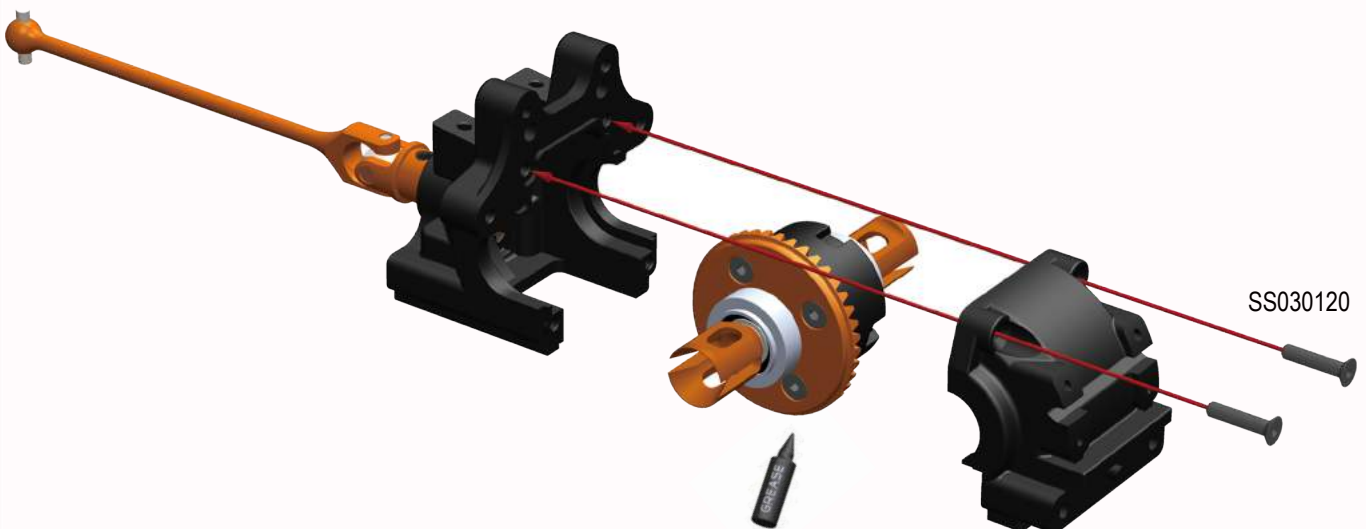

5 REAR TRANSMISSION

BAGS C1

STEP C1-4

Rear Arm Anti-Squat Plate

TIP

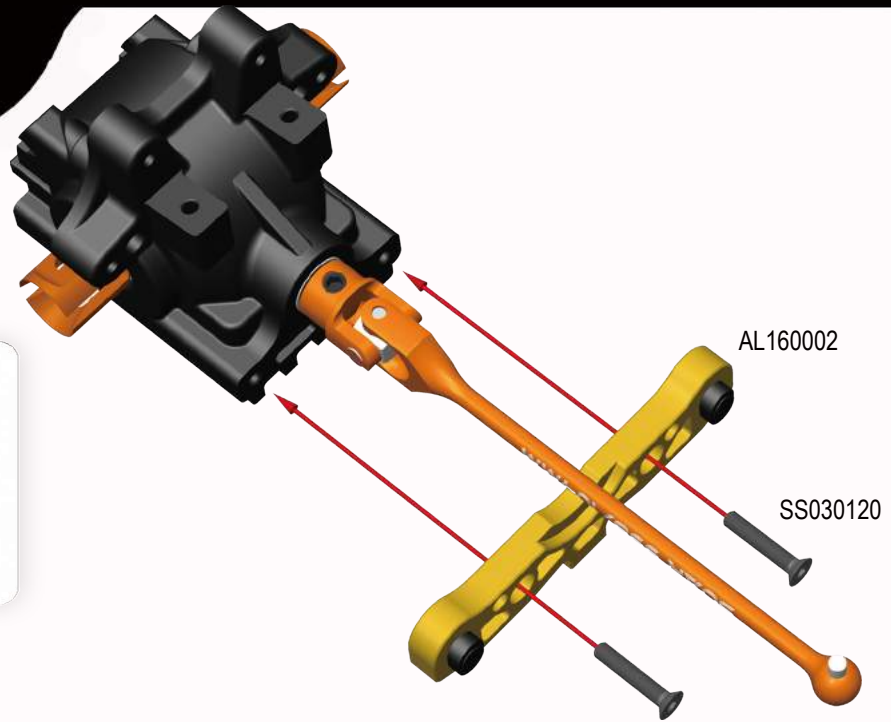
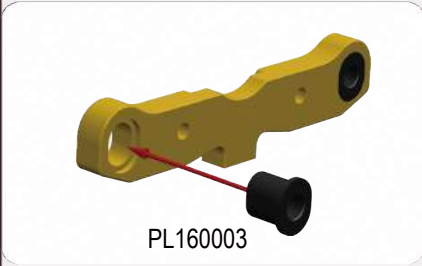

STEP C1-5

Rear Shock Tower

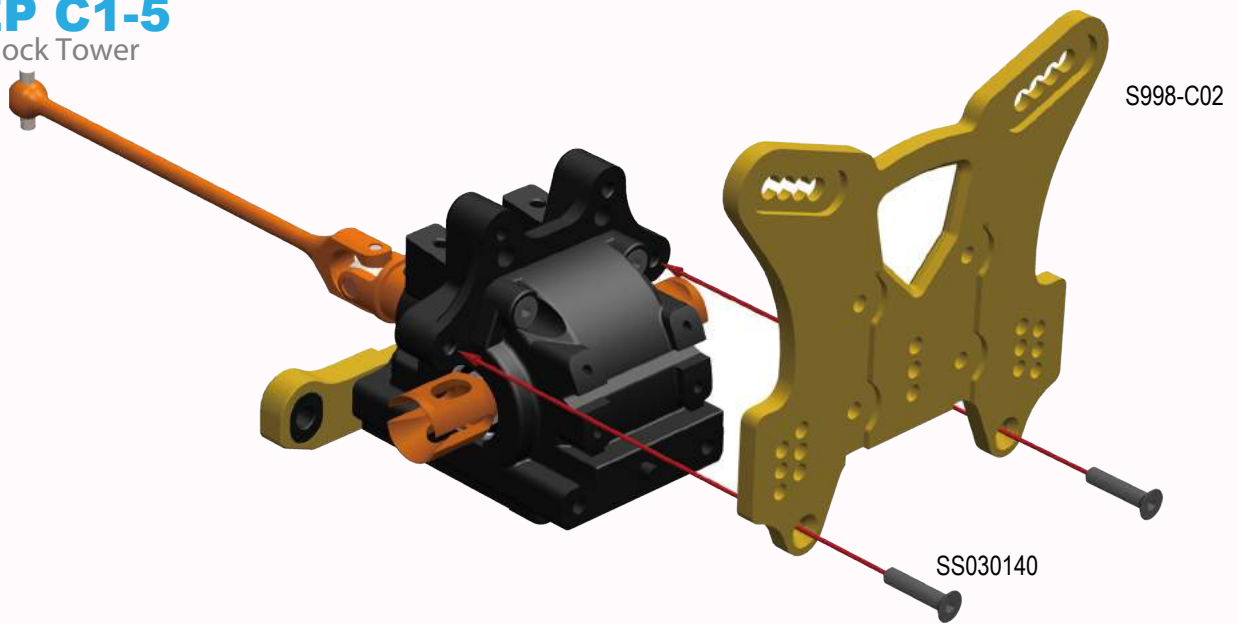

STEP C1-6

Rear Shock Pivot Mount

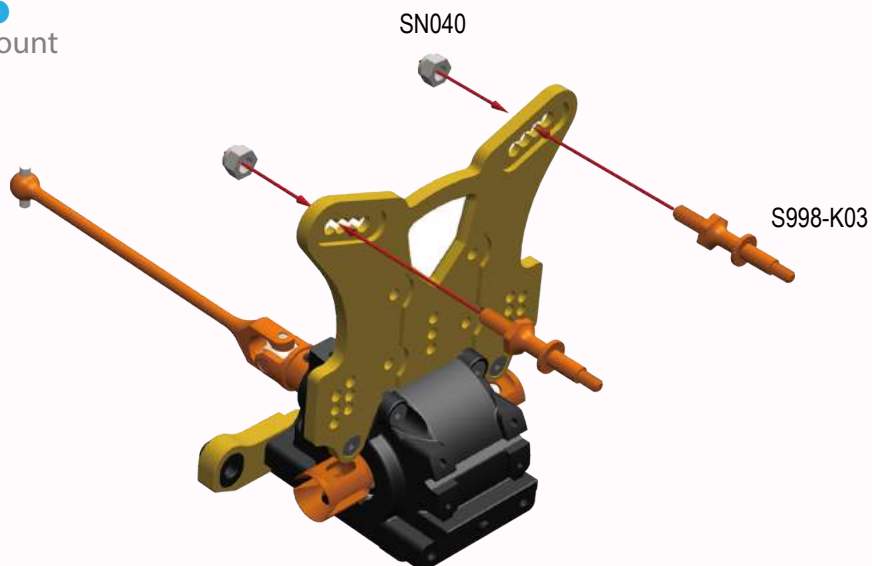

5 REAR TRANSMISSION

BAGS C1

STEP C1-5

Rear Lower Arm

TIP

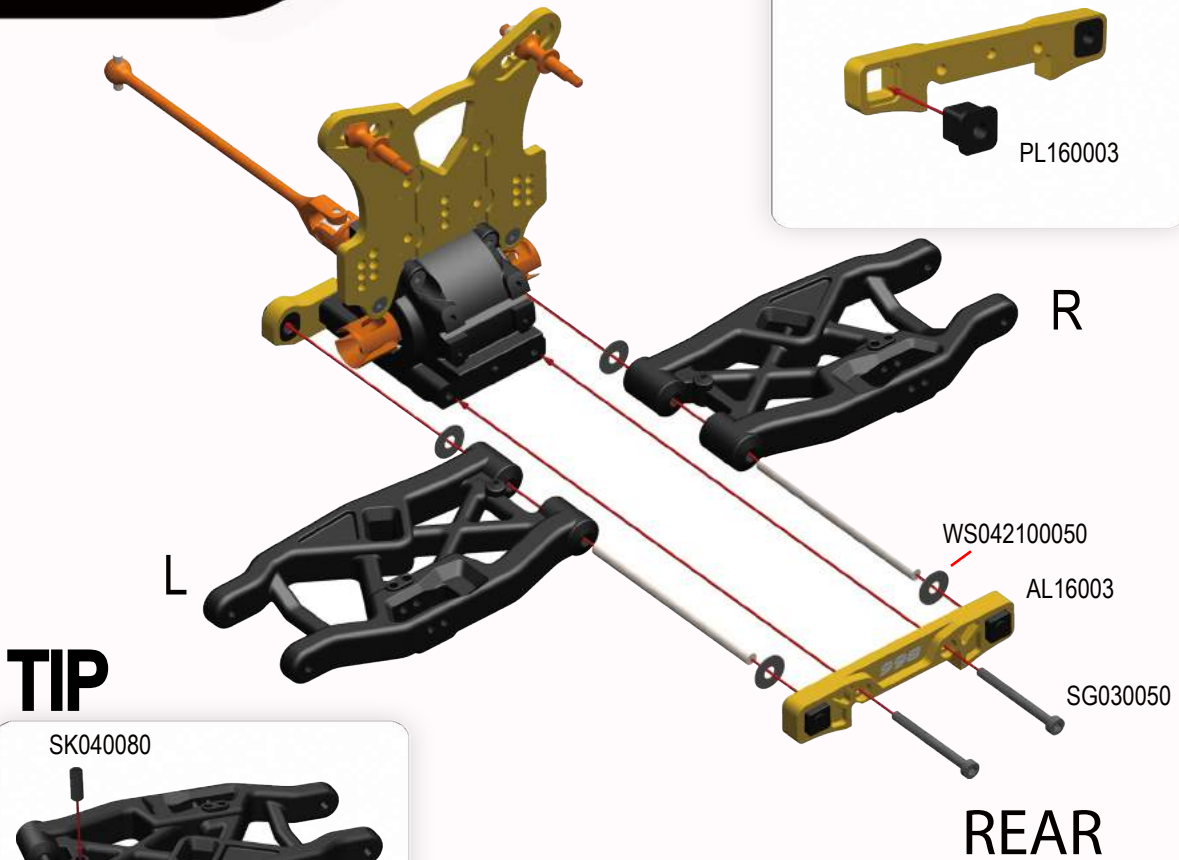

TIP



STEP C1-6

Rear Anti-Roll Bar

OPTIONS	
SP160002-24	2.4mm
SP160002-25	2.5mm
SP160002-26	2.6mm
SP160002-27	2.7mm
SP160002-28	2.8mm
SP160002-29	2.9mm
SP160002-30	3.0mm

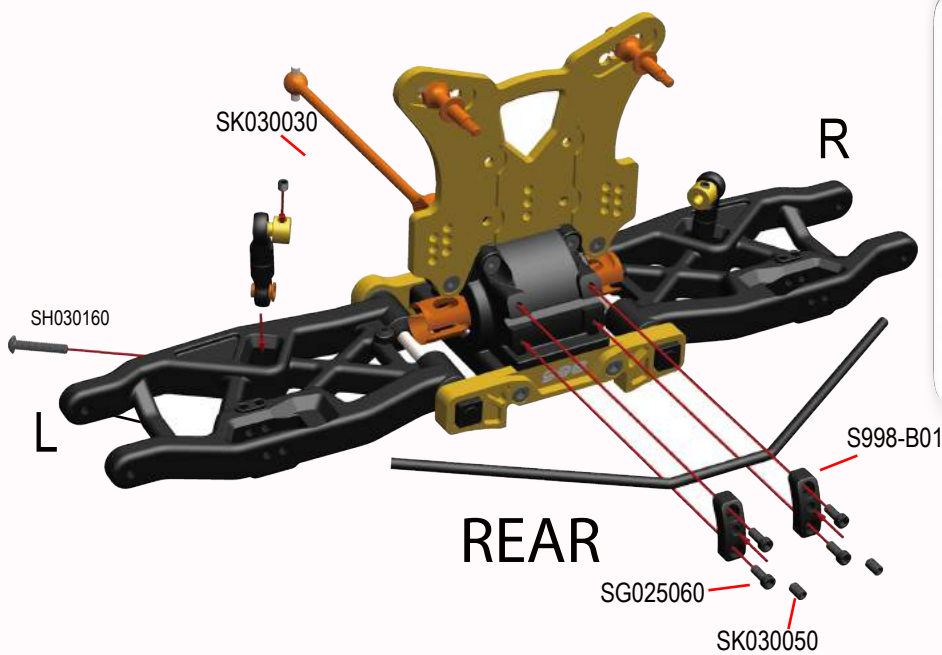

TIP



5 REAR TRANSMISSION

BAGS C2

STEP B2-1

Rear Uprights



2x

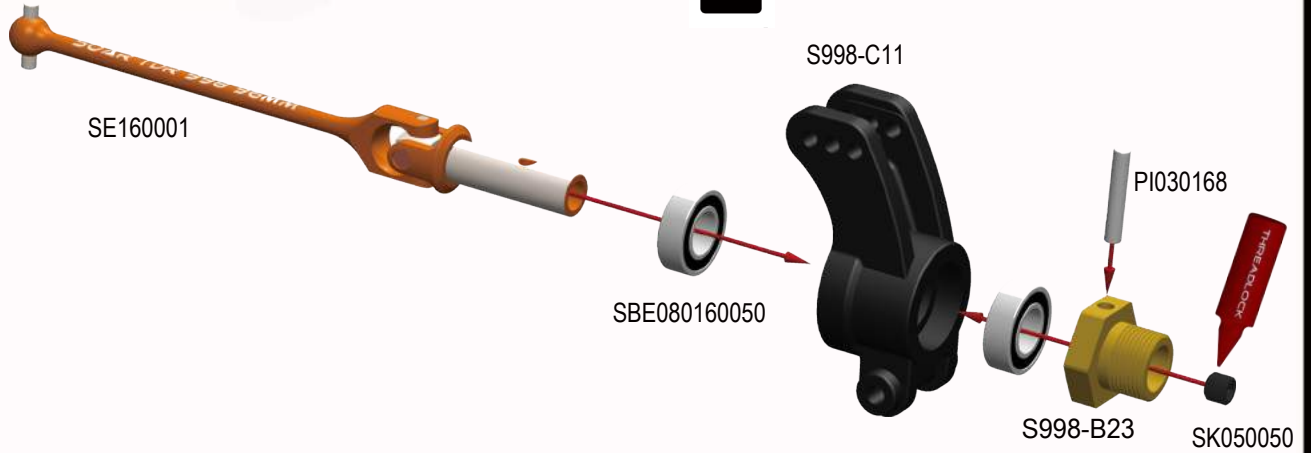

STEP B2-2

Rear Uprights



2x

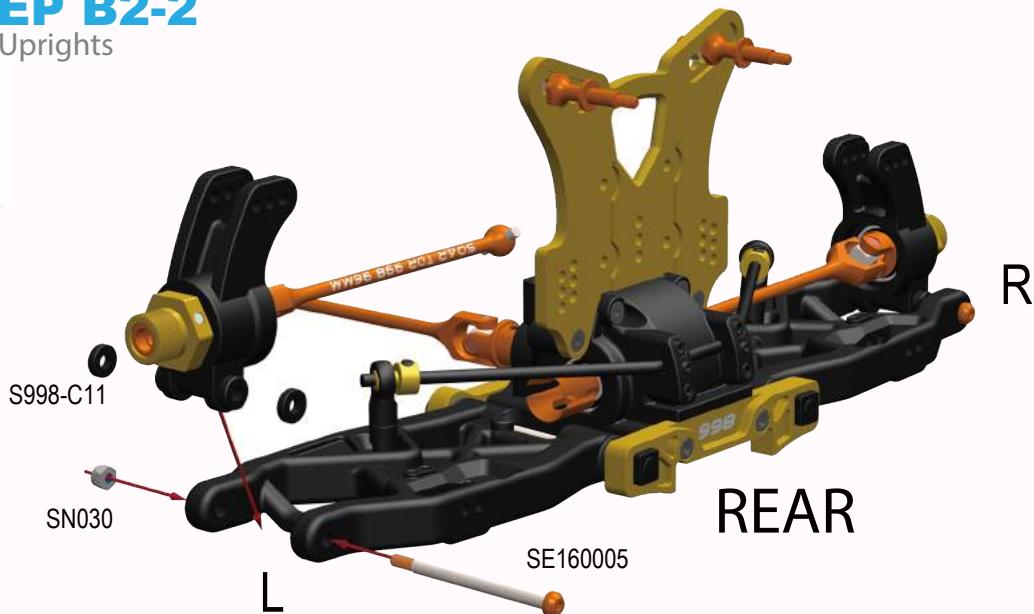

STEP B2-3

Rear Upper Arm



2x

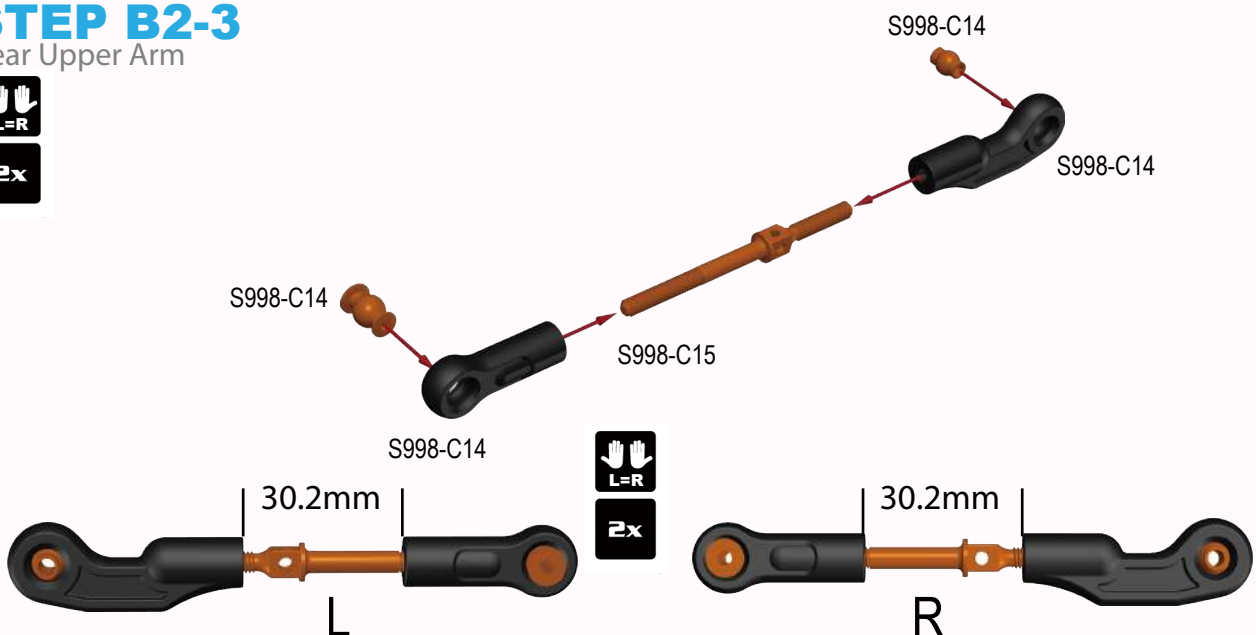

5 REAR TRANSMISSION

BAGS C2

STEP B2-1

Rear Upper Arm



2x

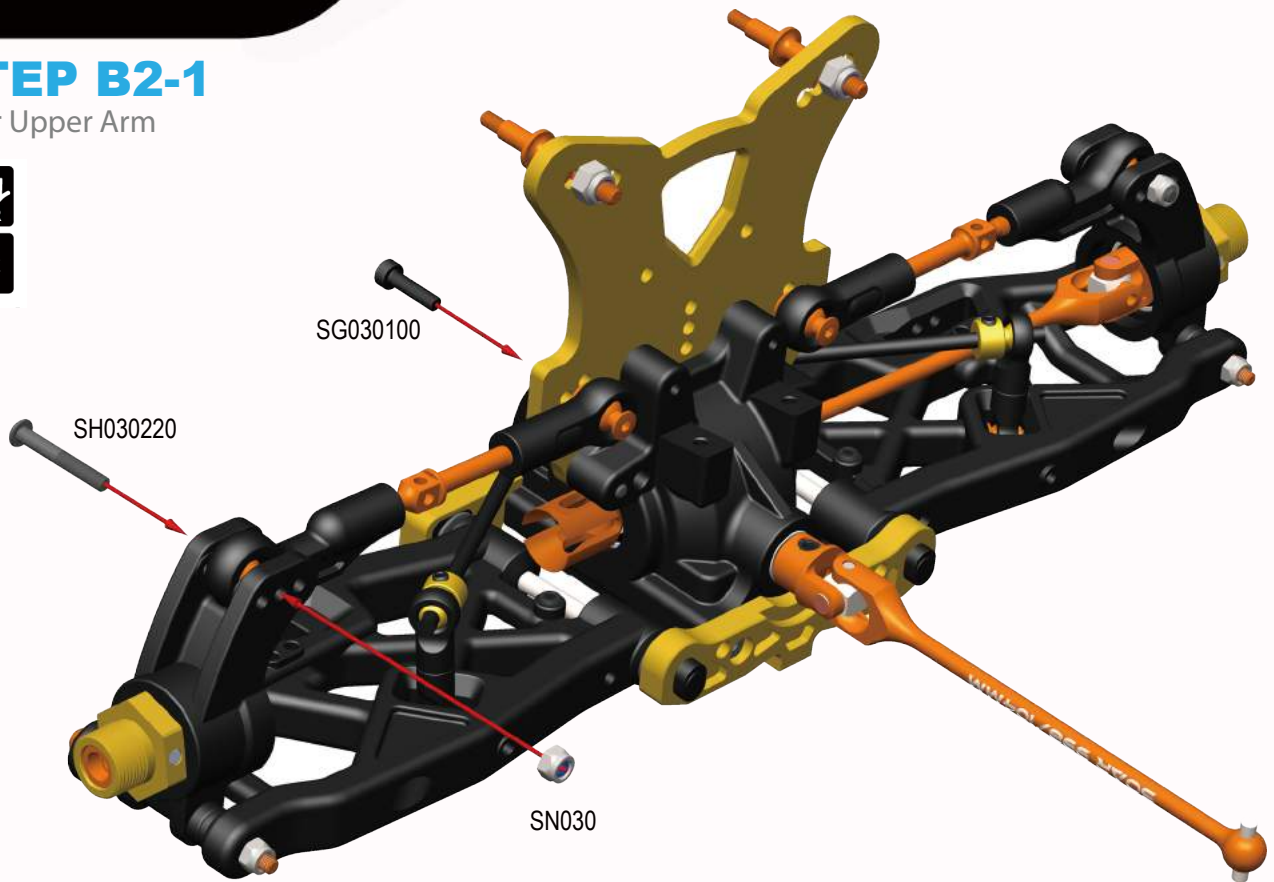

6 CHASSIS BRACE AND WING STAY

BAGS D

STEP D1-1

Wing Stay

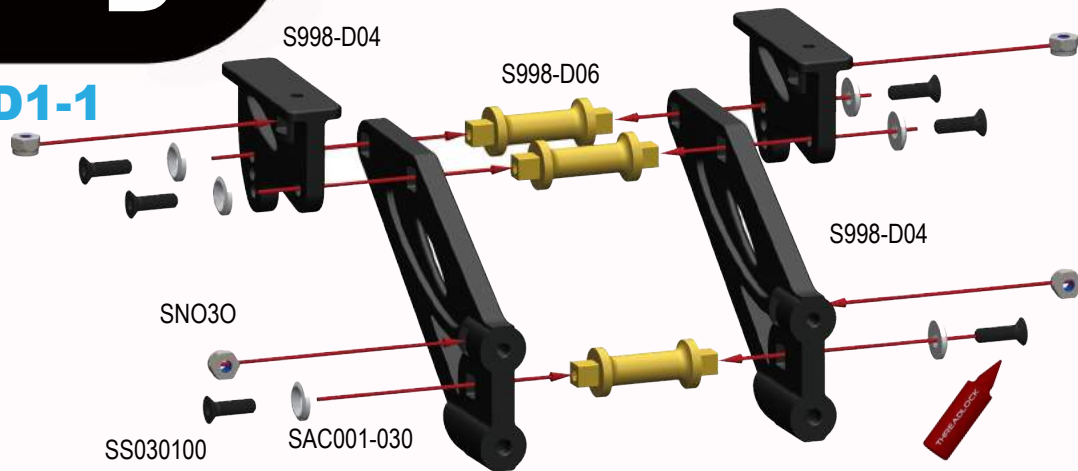

STEP D1-2

S998-D05

Wing Stay and Rear Body Mount

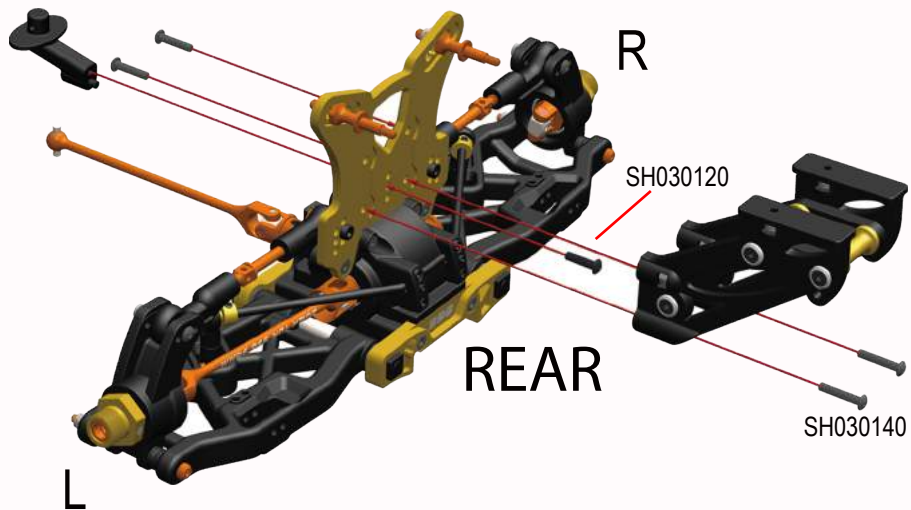

STEP D1-3

Rear Chassis Brace

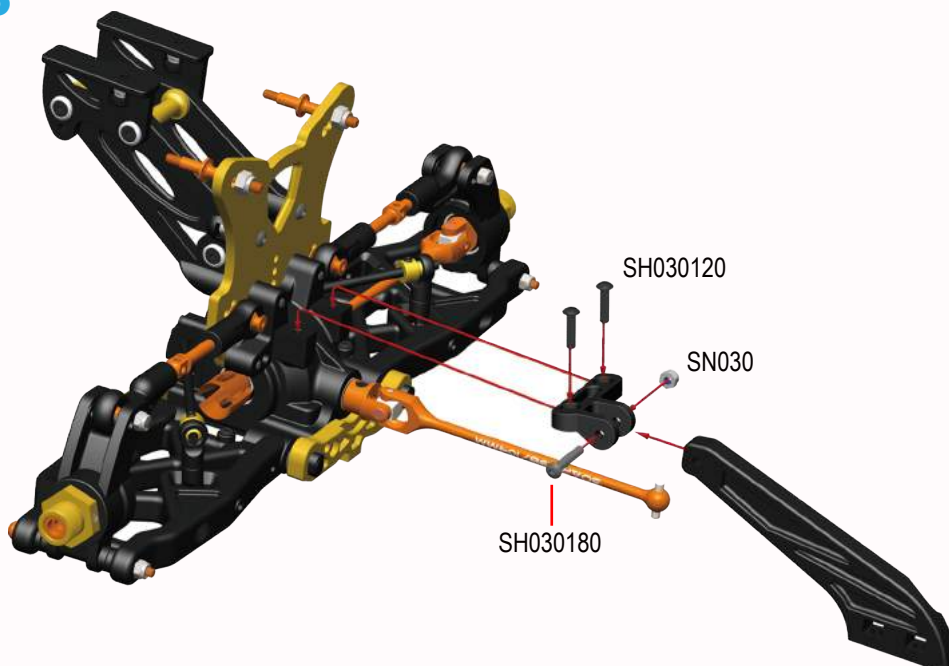

7 STEERING

BAGS E

STEP E1-4

Steering Tie-Rod End Set

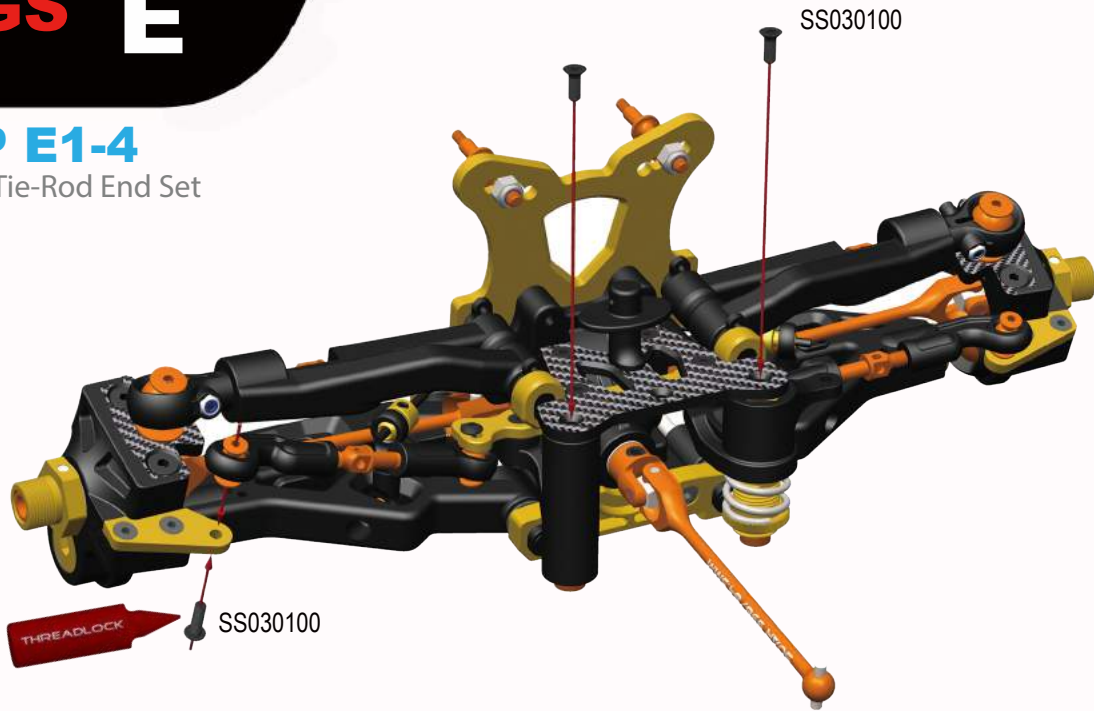

STEP E1-5

Front Chassis Brace

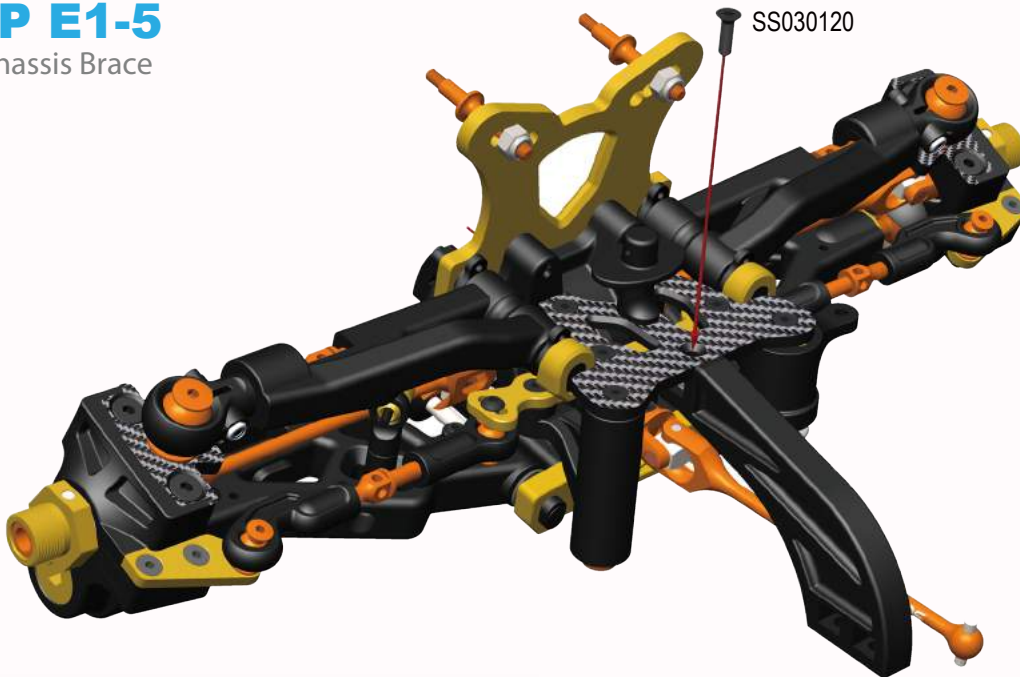

8 CENTER AND BRAKE

BAGS F

STEP F1-1

Center Diff Mount

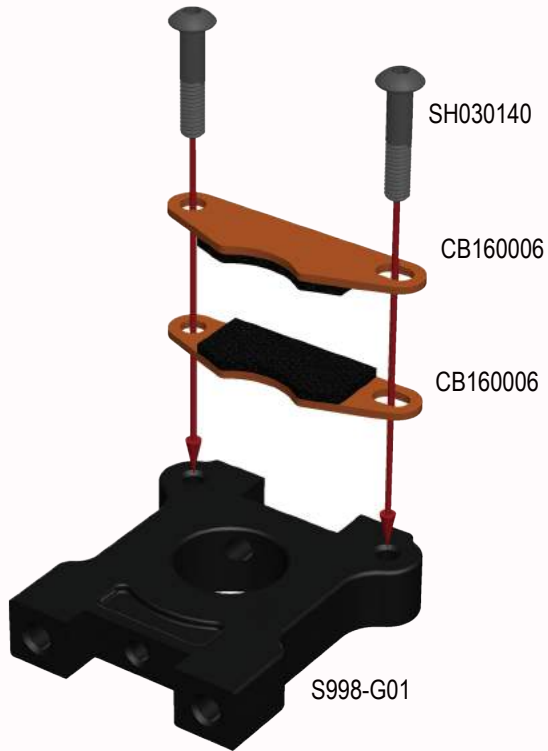

STEP F1-2

Center Diff Mount

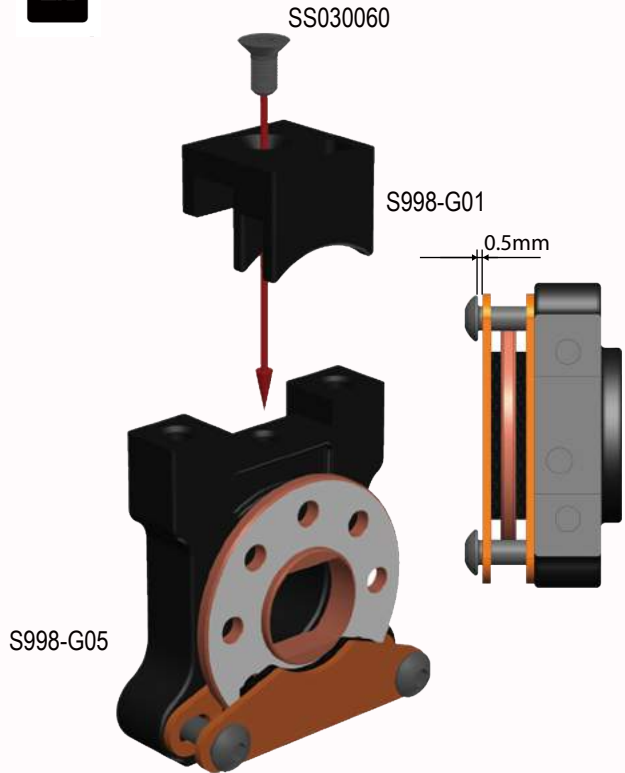

STEP F1-3

Center Diff Mount

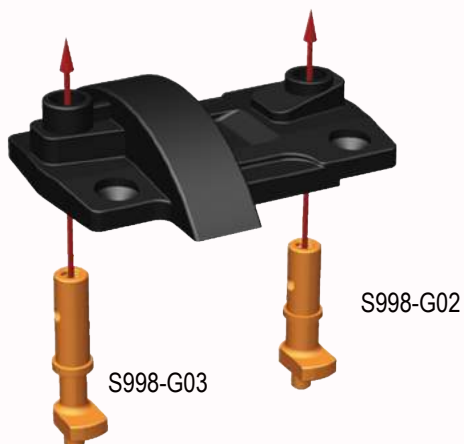

STEP F1-4

Center Diff Mount

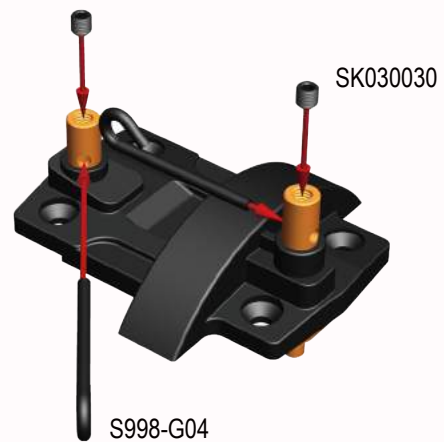

8 CENTER AND BRAKE

BAGS F

STEP F1-5

Center Diff Mount

SS030100

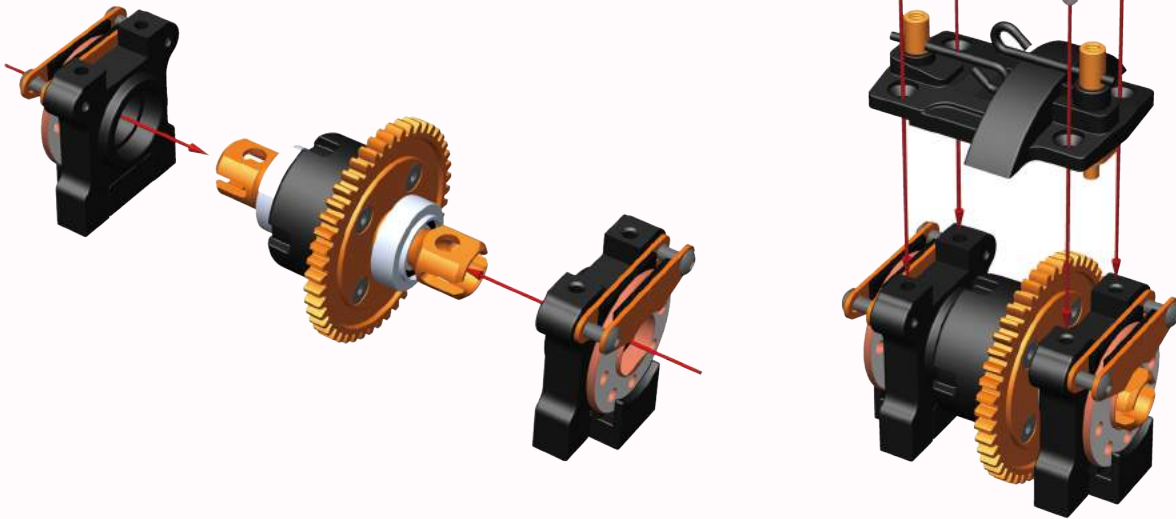

CENTER SET UP

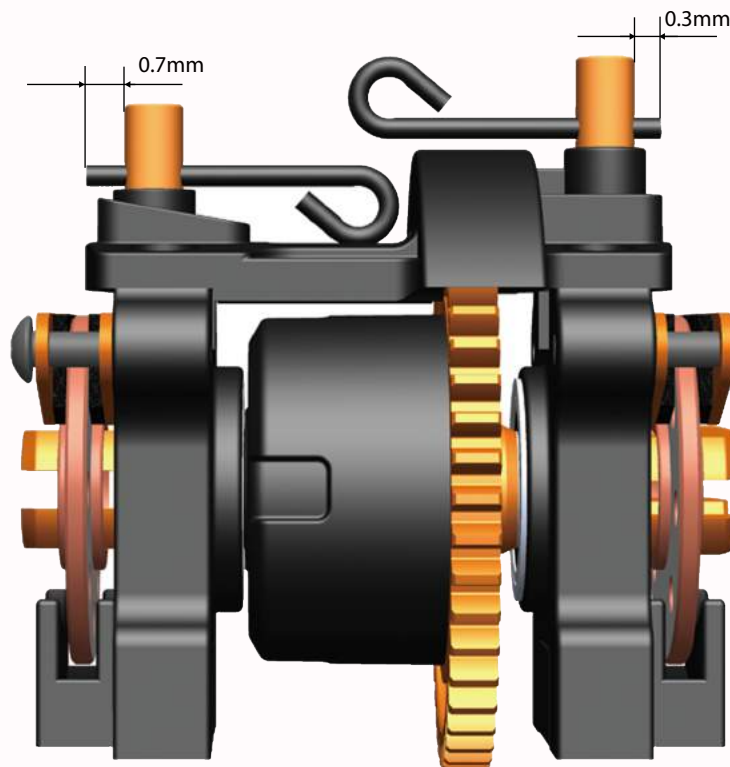

9 CHASSIS PRINCIPAL

BAGS G

STEP G-1

CHASSIS PRINCIPAL
INSTALLATION

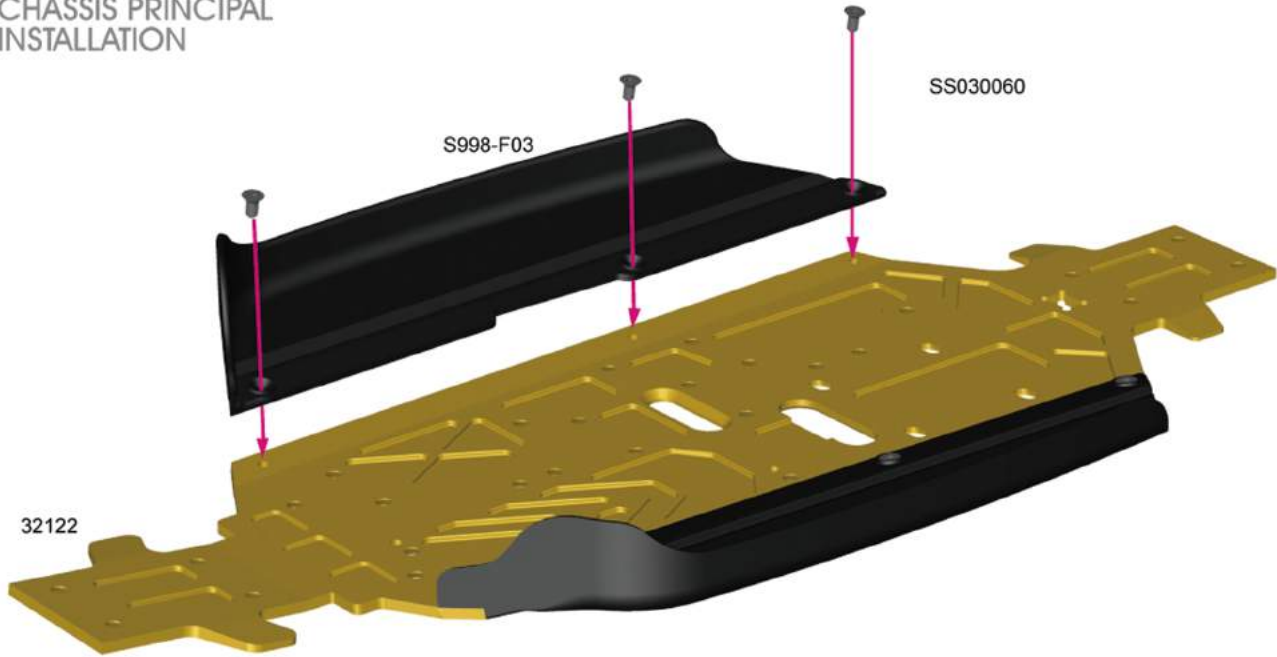

STEP G-2

CHASSIS PRINCIPAL
INSTALLATION

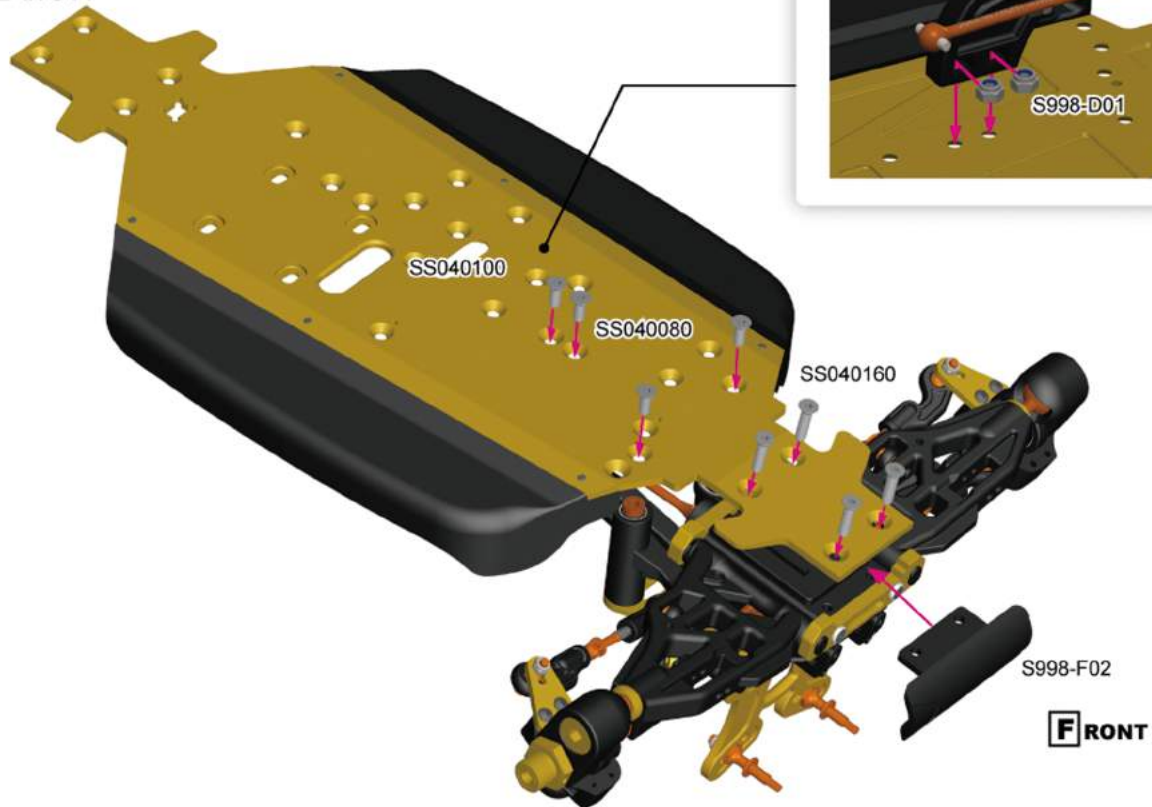

9 CHASSIS PRINCIPAL

BAGS G

STEP G-3

CHASSIS PRINCIPAL
INSTALLATION

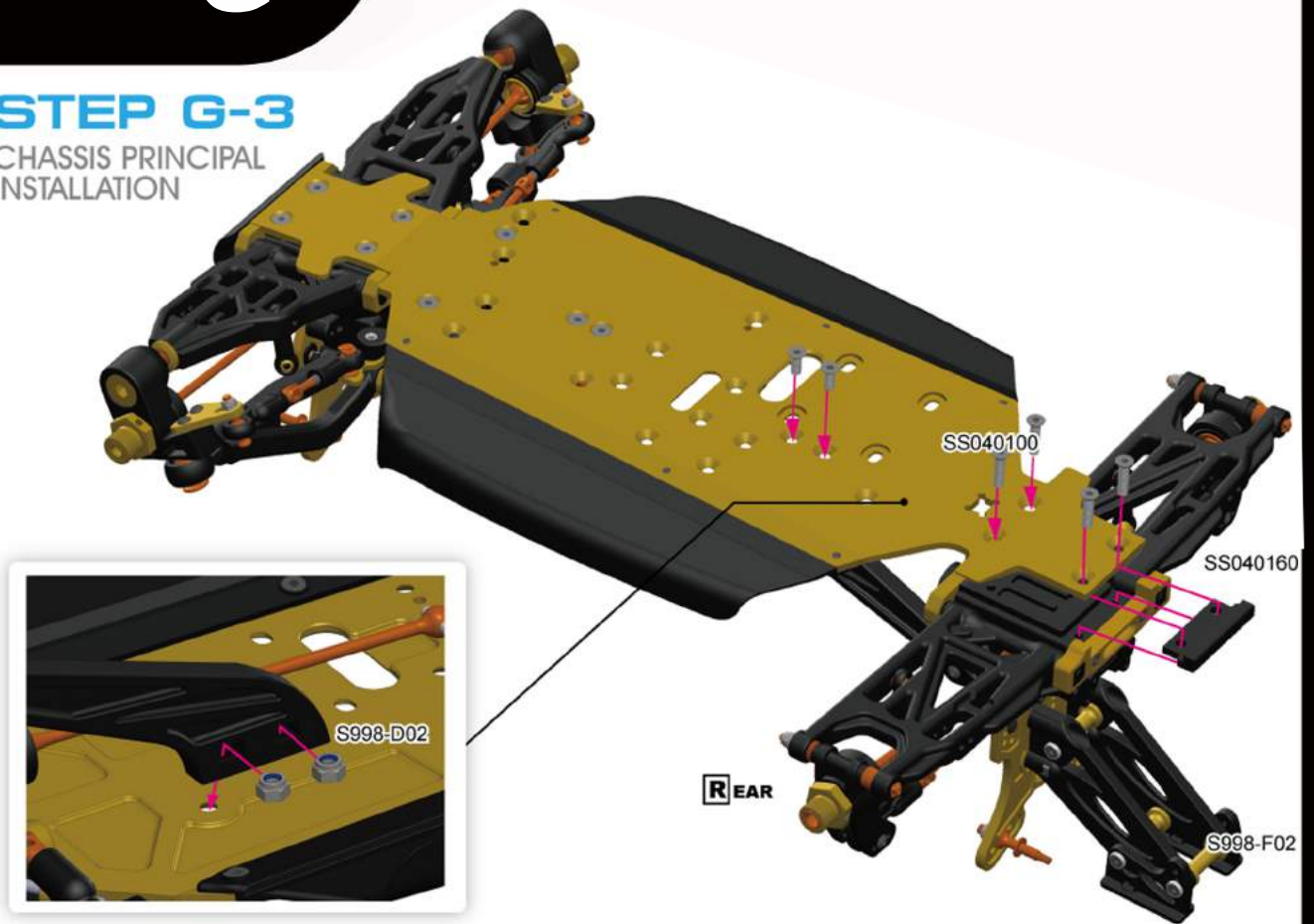

STEP G-4

CHASSIS PRINCIPAL
INSTALLATION

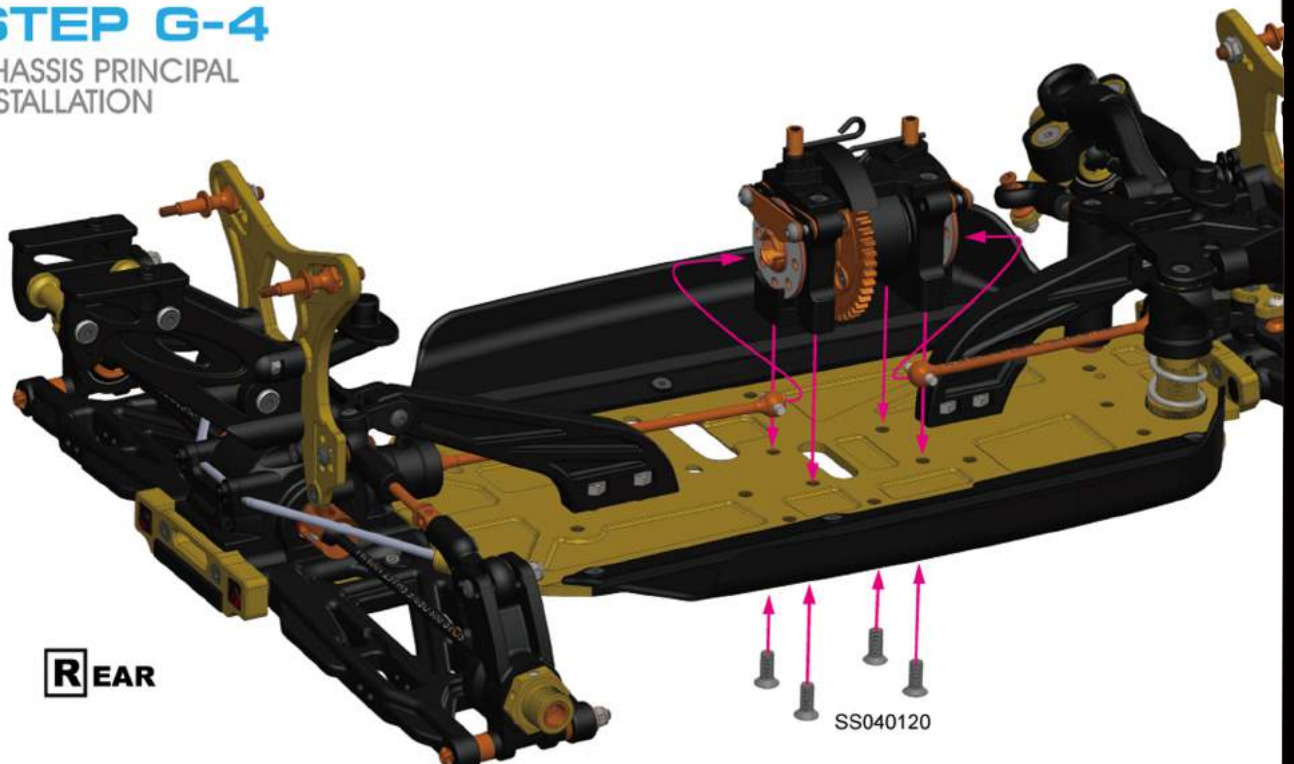

10 ENGINE AND FUEL TANK

BAGS H

STEP H-1 ENGINE INSTALLATION

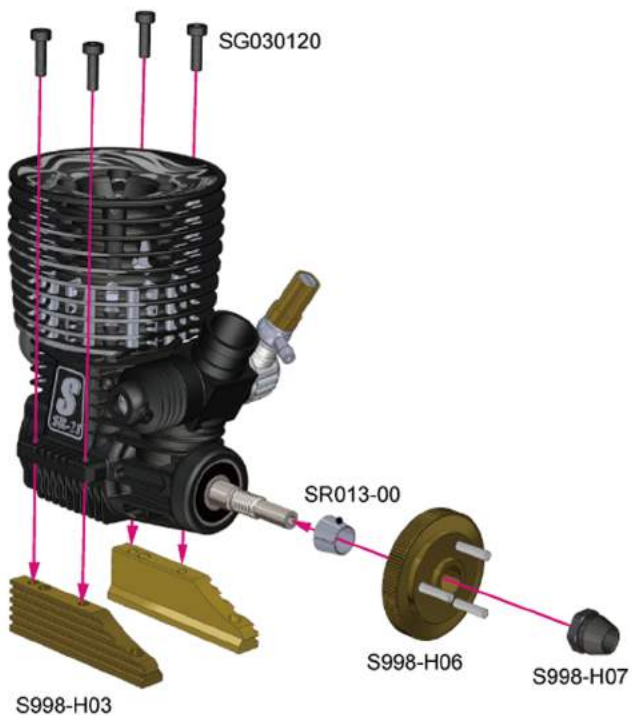

STEP H-2 ENGINE INSTALLATION

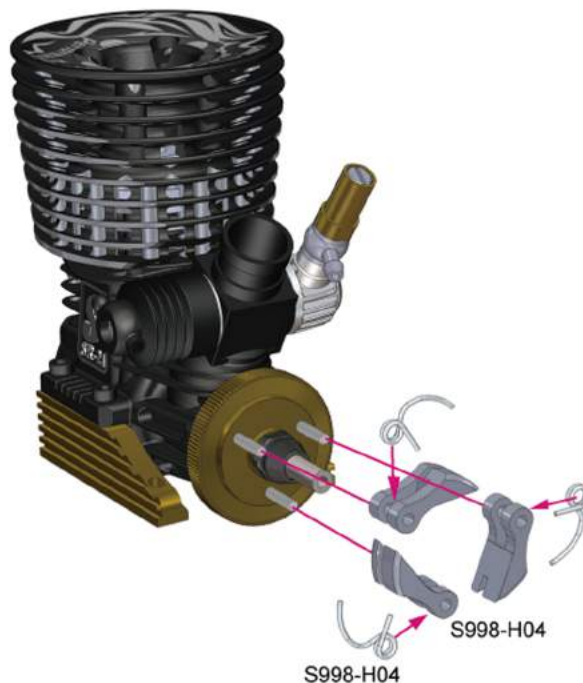

STEP H-3 ENGINE INSTALLATION

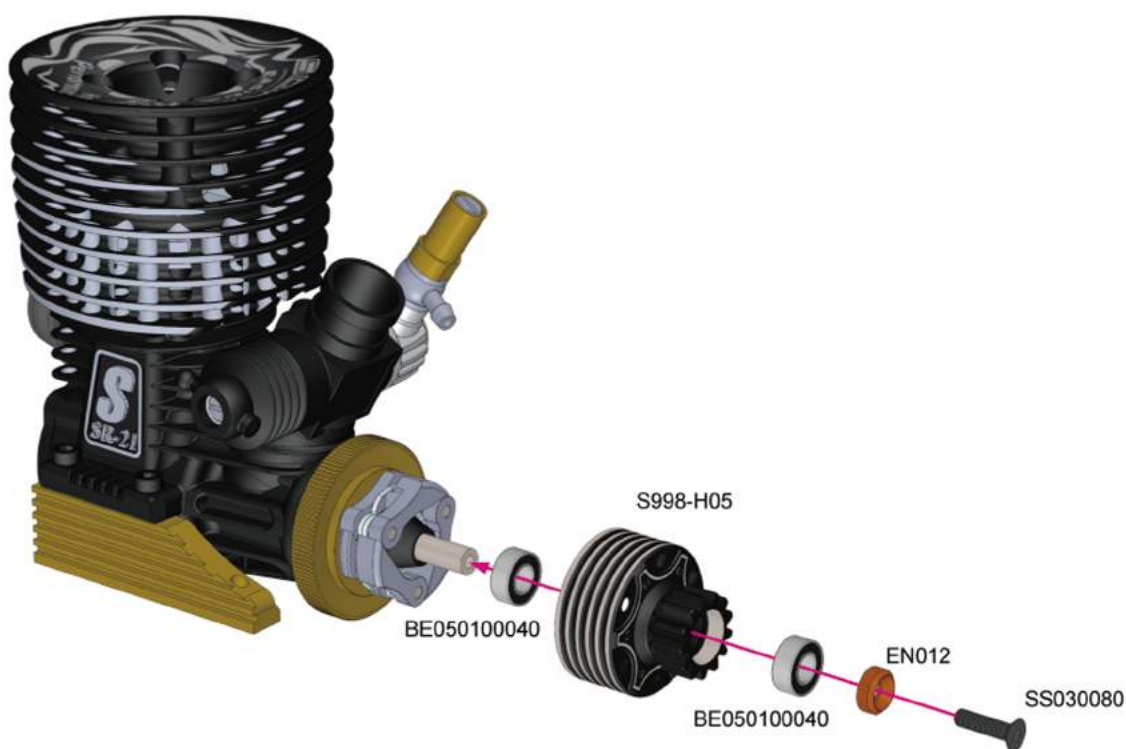

10 ENGINE AND FUEL TANK

BAGS H

STEP H-4 FUEL TANK INSTALLATION

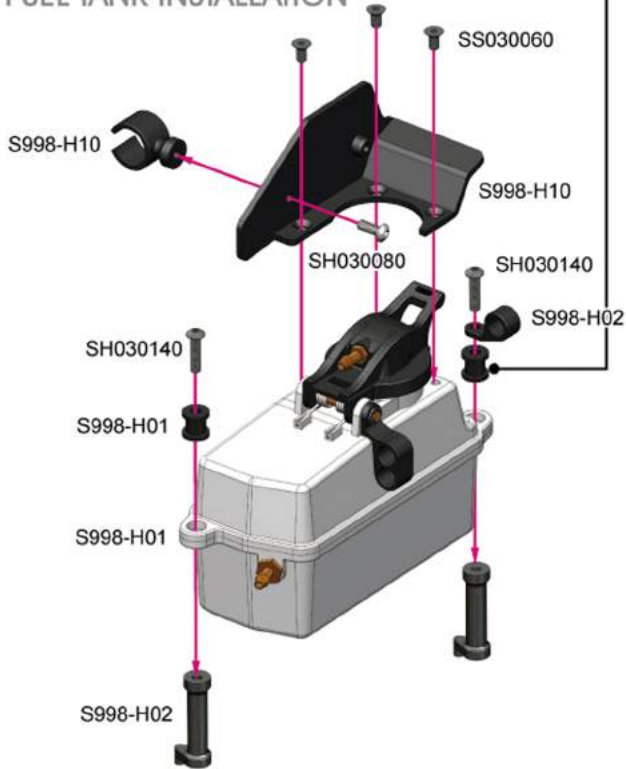

STEP H-5 FUEL TANK INSTALLATION

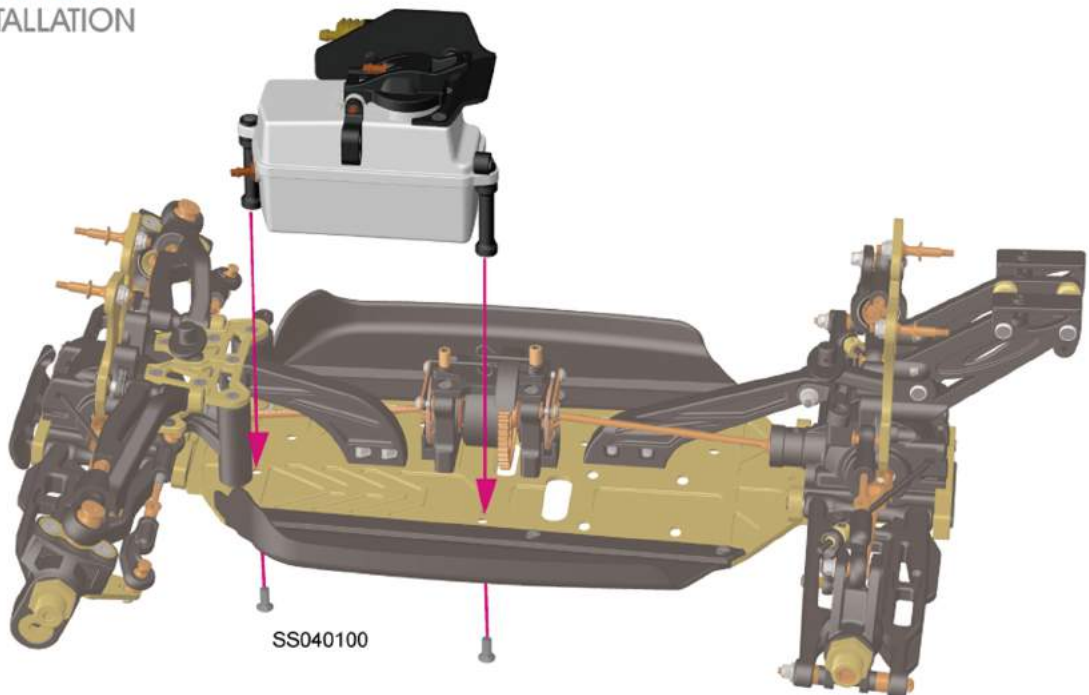

10 ENGINE AND FUEL TANK

BAGS H

STEP H-6 ENGINE INSTALLATION

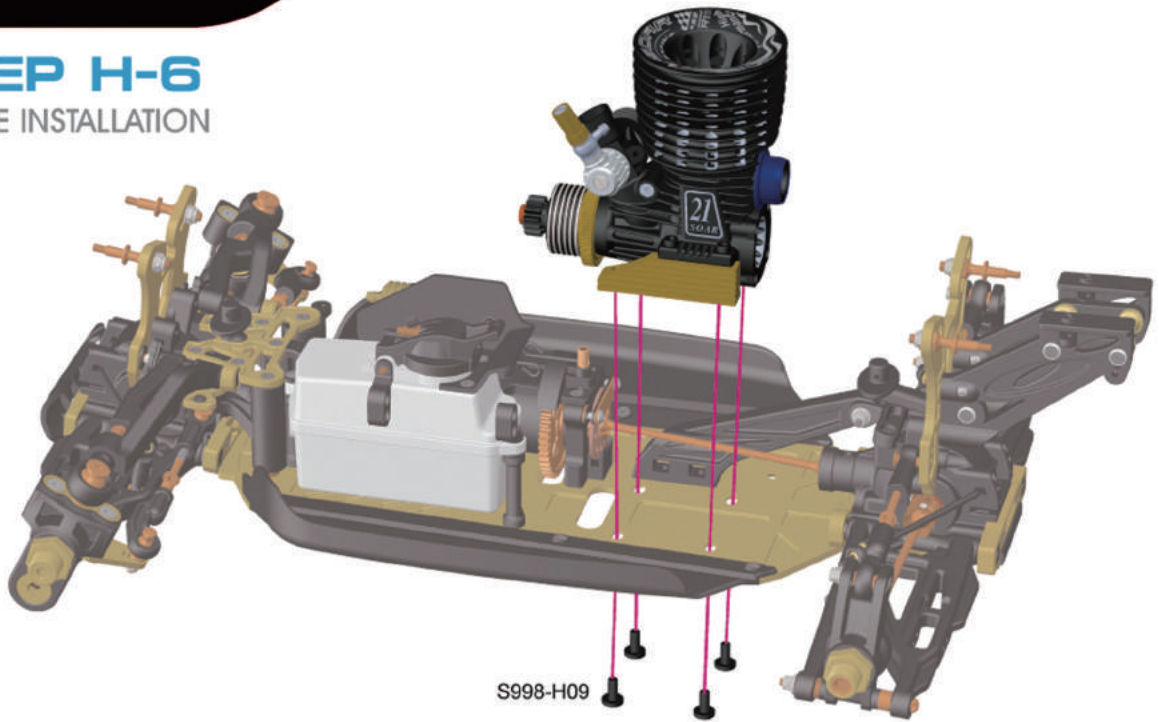

STEP H-7 Exhaust Installation

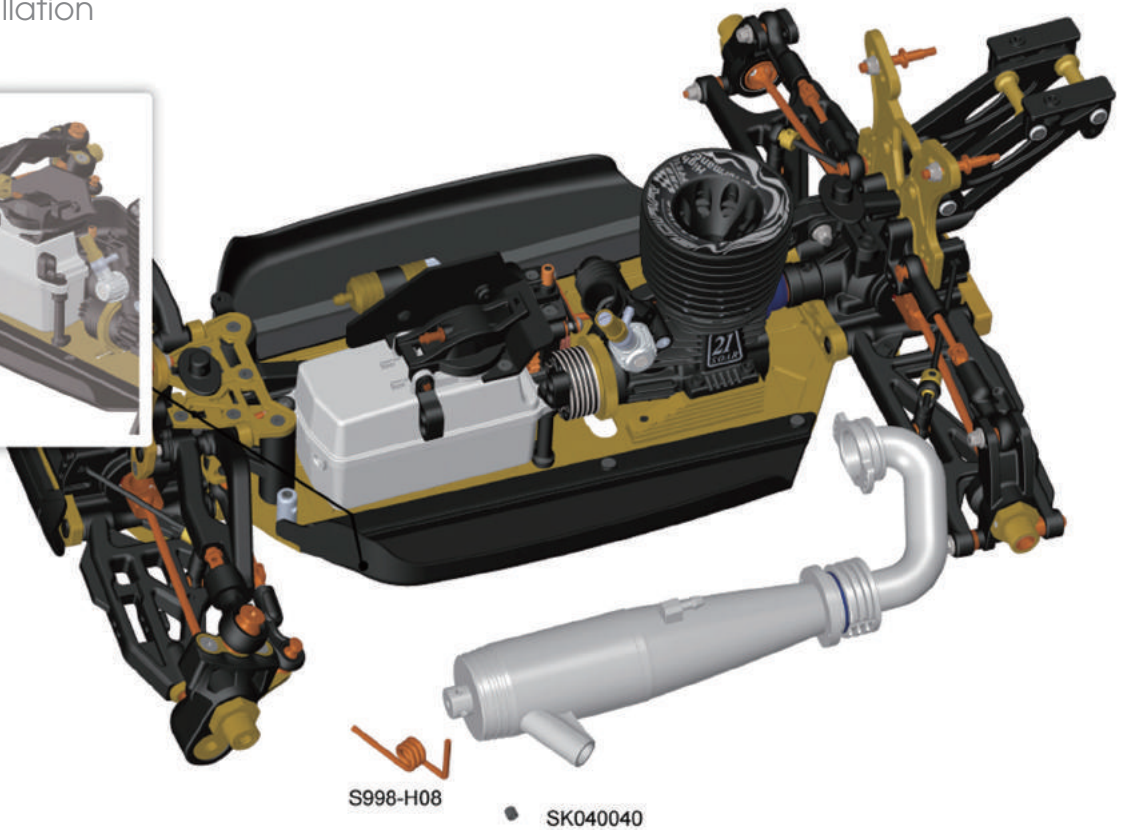

11 RADIO CASE

BAGS |

STEP I-1 RADIO CASE INSTALLATION

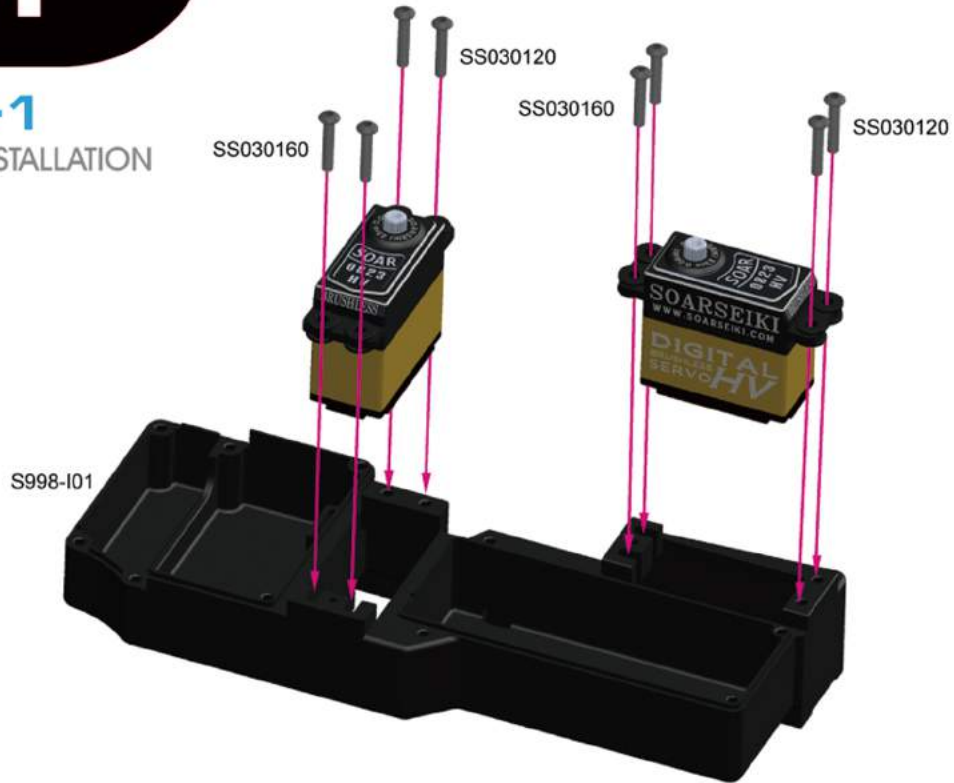

STEP I-2 RADIO CASE INSTALLATION

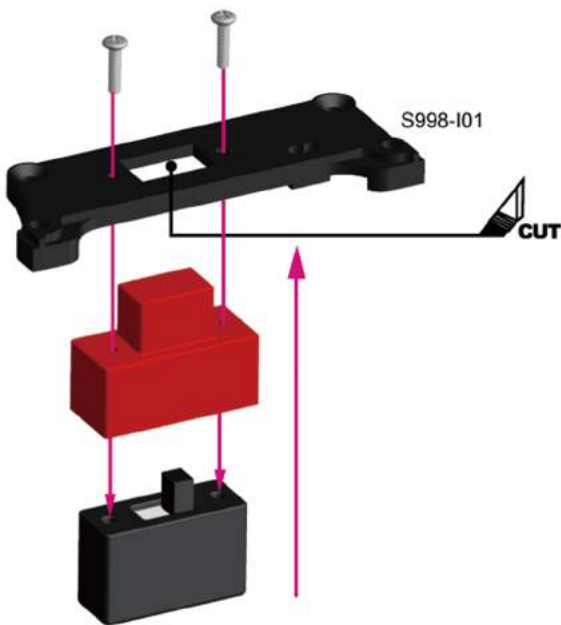

STEP I-3 RADIO CASE INSTALLATION

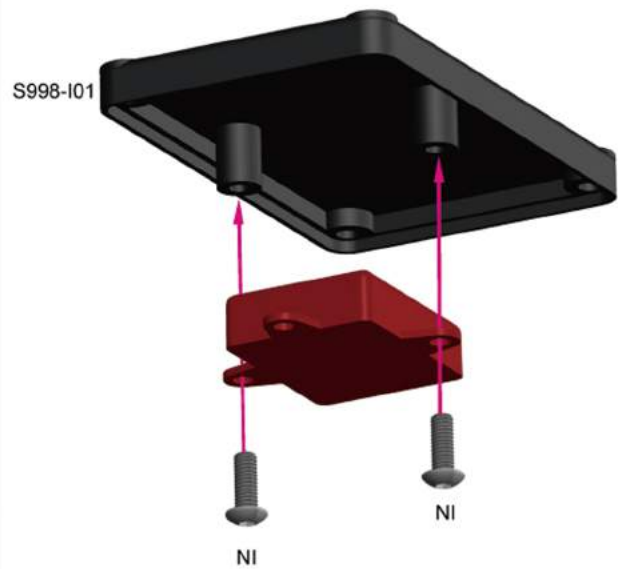

11 RADIO CASE

BAGS

STEP I-4

RADIO CASE INSTALLATION

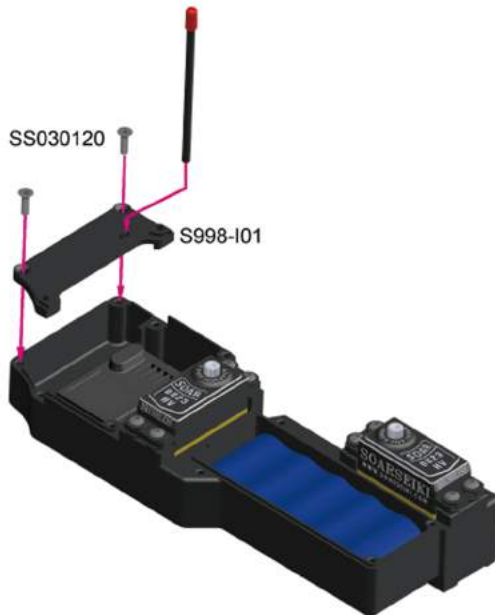

STEP I-5

RADIO CASE INSTALLATION

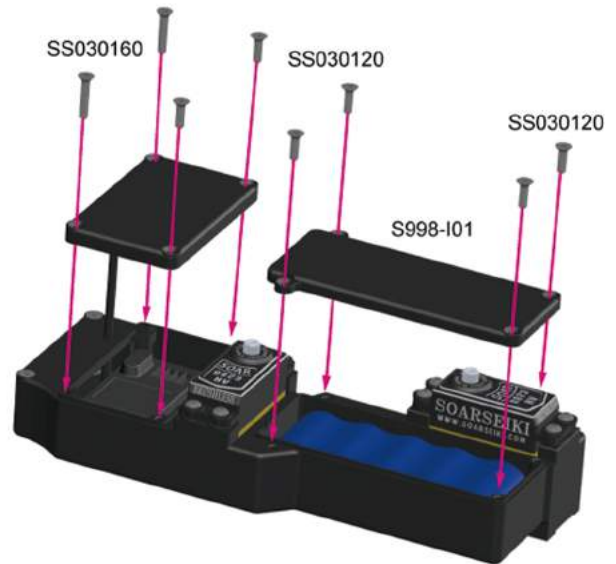

STEP I-6

RADIO CASE INSTALLATION

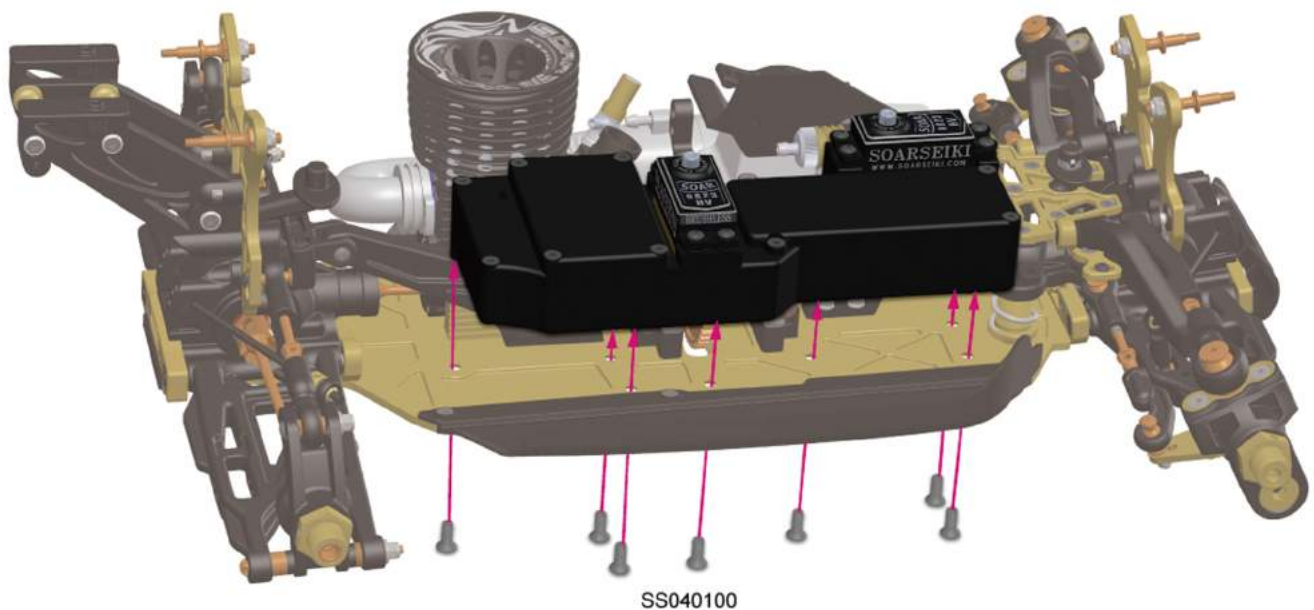

12 SHOCK ABSORBERS

BAGS

STEP J-1

SHOCK INSTALLATION
(FRONT & REAR)



STEP J-2

SHOCK INSTALLATION
(FRONT & REAR)



STEP J-3

SHOCK INSTALLATION
(FRONT & REAR)



STEP J-4

SHOCK INSTALLATION
(FRONT & REAR)



STEP J-5

SHOCK INSTALLATION
(FRONT & REAR)



STEP J-6

SHOCK INSTALLATION
(FRONT & REAR)

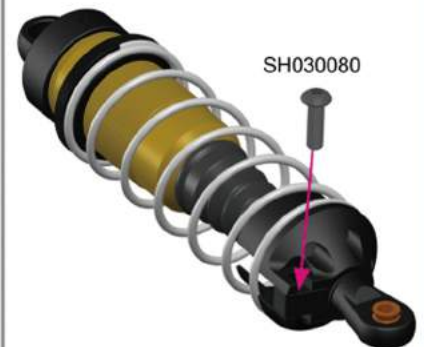

12 FINAL ASSEMBLY

BAGS K

STEP K-1

FRONT SHOCK INSTALLATION

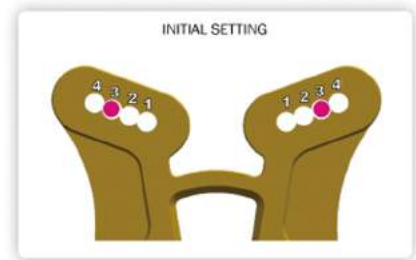
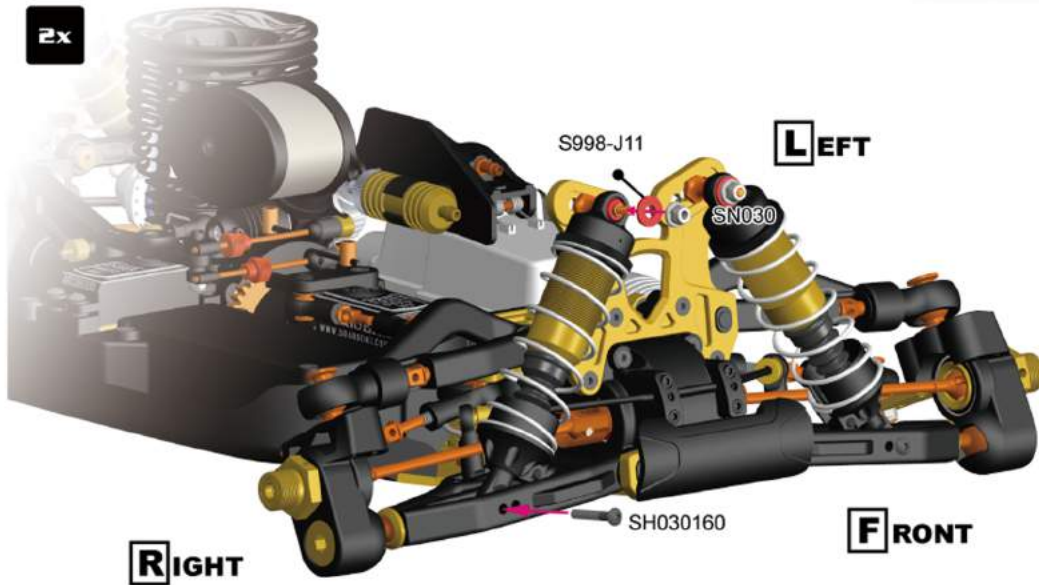

STEP K-2

REAR SHOCK INSTALLATION

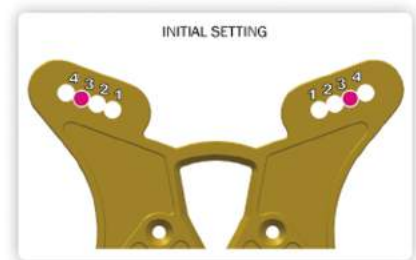
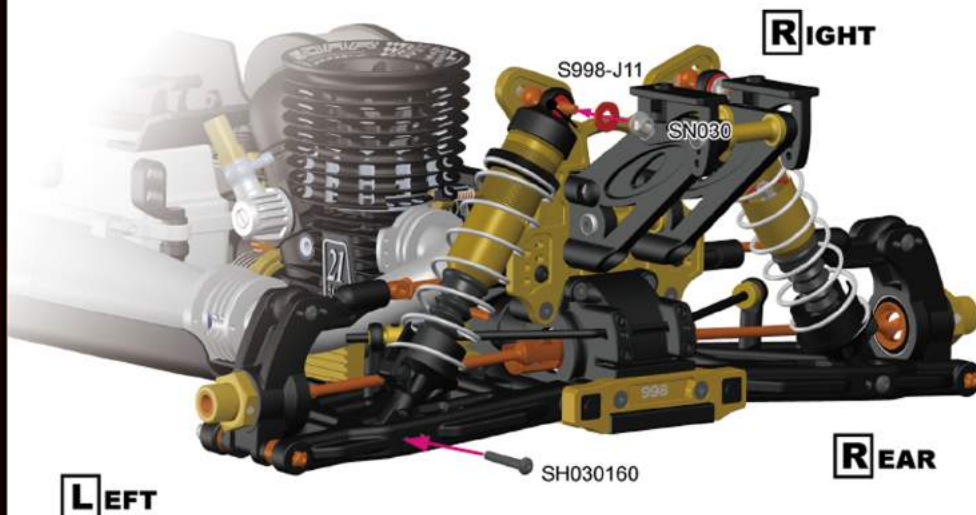

12 FINAL ASSEMBLY

BAGS K

STEP K-4

Steering Servo Link Installation

STEP K-3

Steering Servo Link Installation

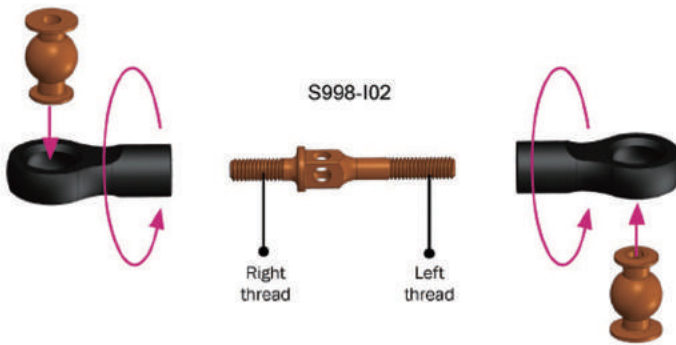

COMPLETE FIGURE

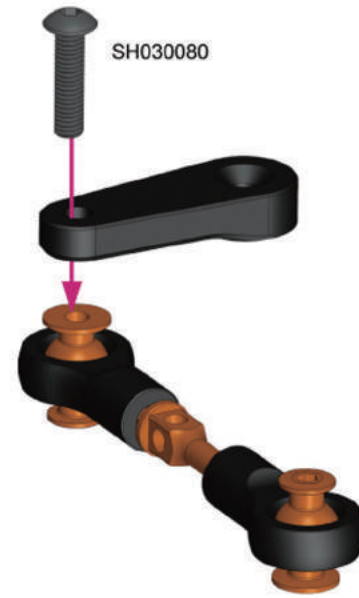

STEP K-5

Steering Servo Link Installation

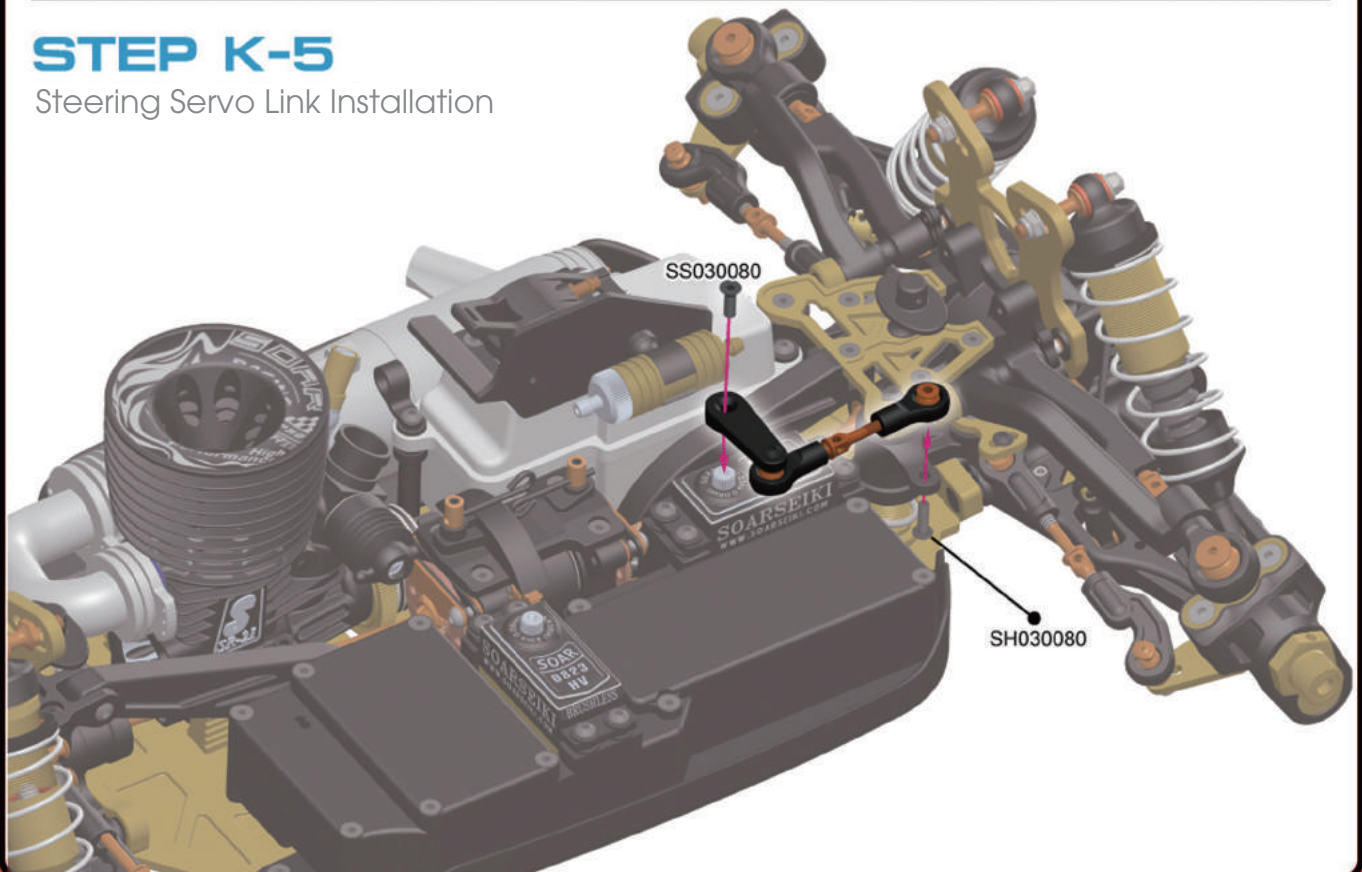

12 FINAL ASSEMBLY

BAGS K

STEP K-6

Throttle Linkage Installation

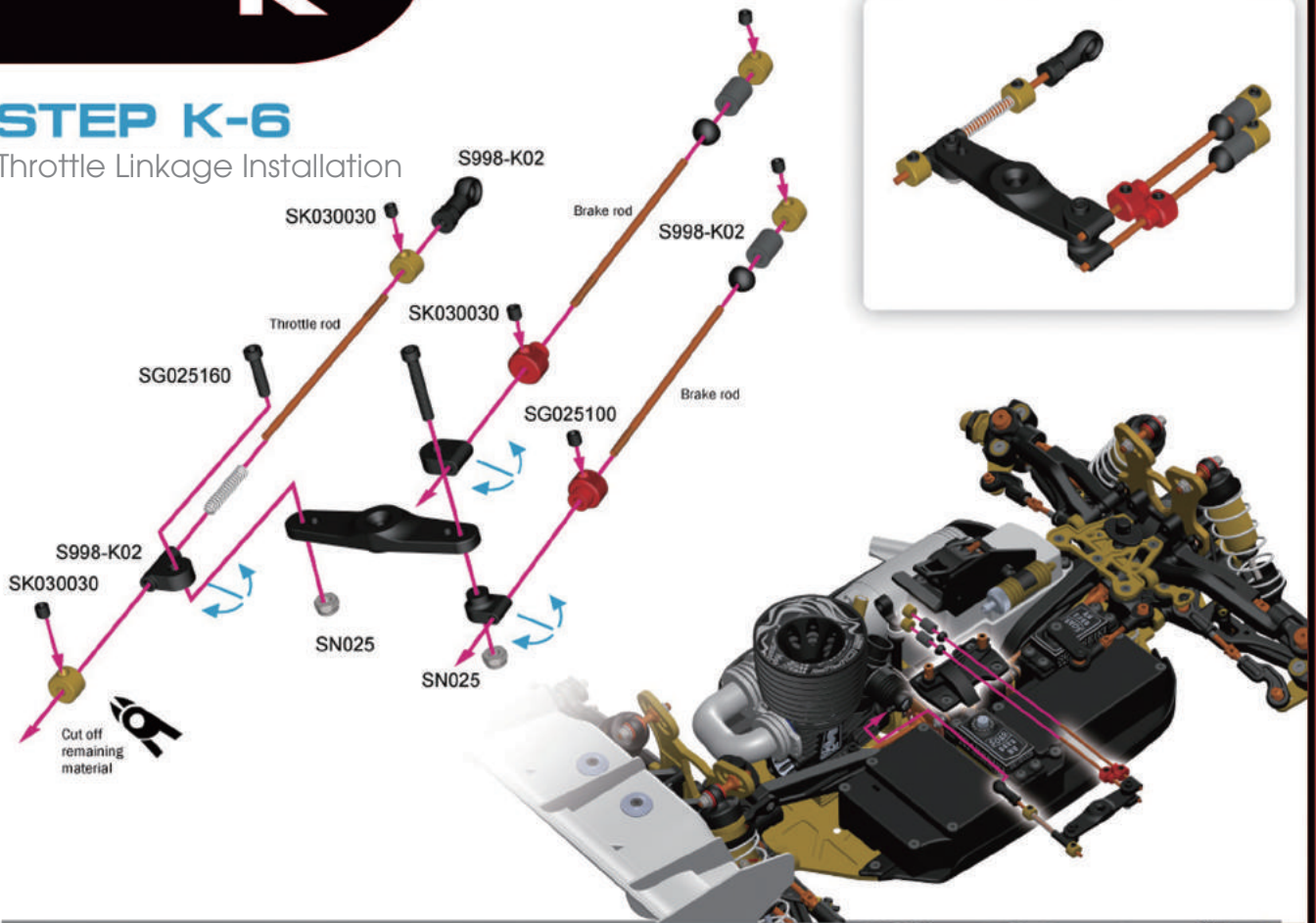

STEP K-7

Throttle Linkage Installation



12 FINAL ASSEMBLY

BAGS K

STEP K-8 SPOILER INSTALLATION

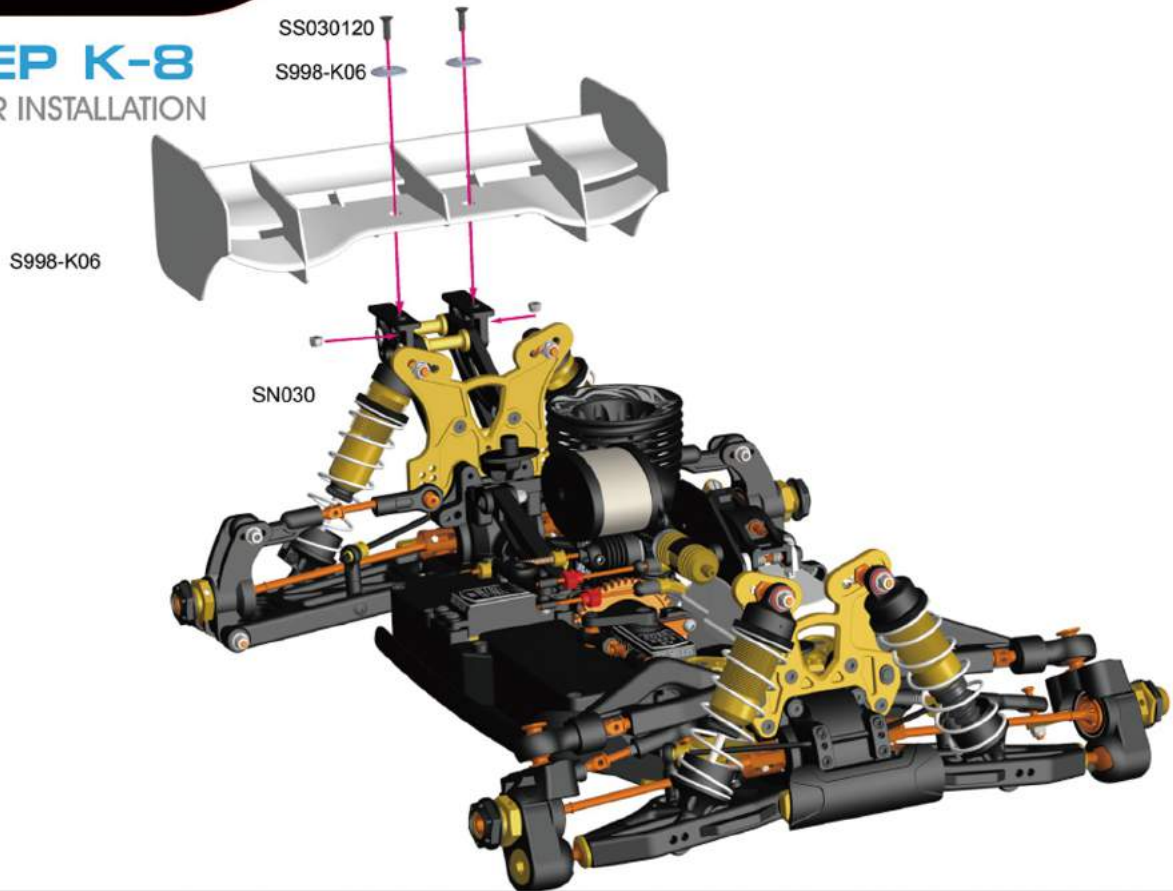

STEP K-9 AIR FILTER ASSEMBLY

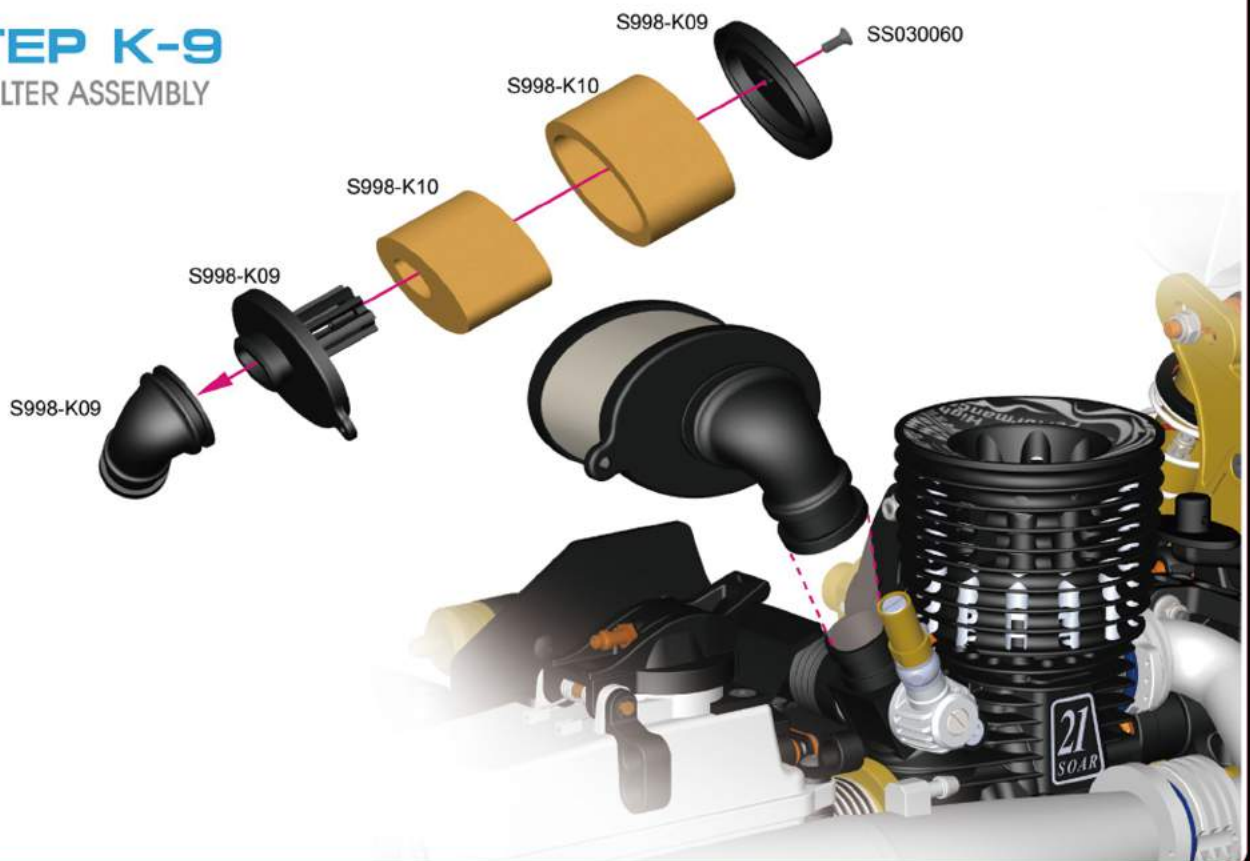

12 FINAL ASSEMBLY

BAGS K

STEP K-10

TIRE INSTALLATION

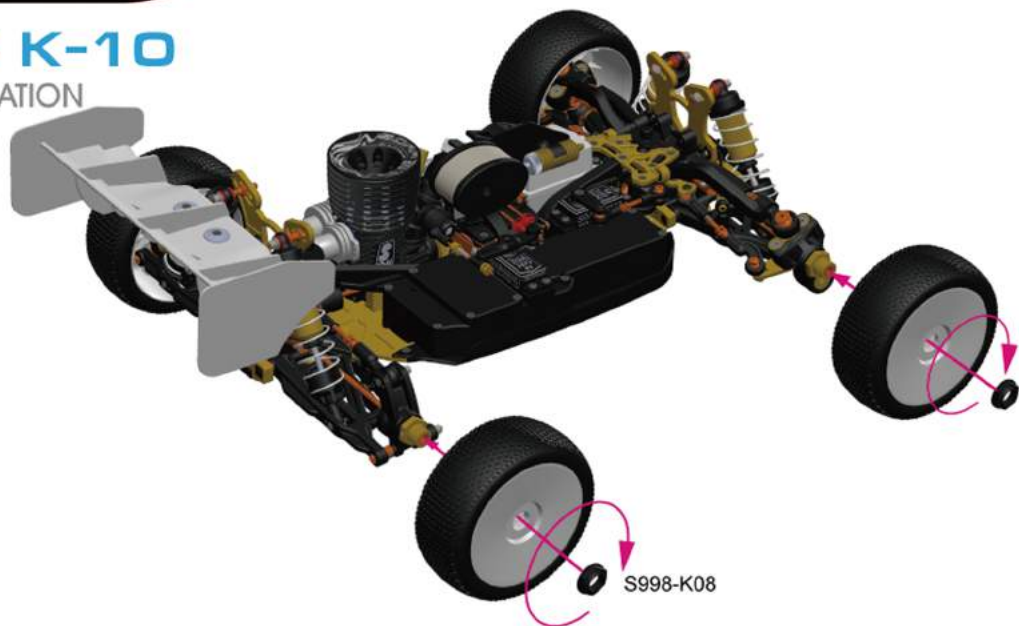

STEP K-11

COMPLETE ASSEMBLY





998

Quality is Power

WWW.SOARSEIKI.COM