

WC-RDS WIRE CHUCK INSTALLATION

1. Loosen the locking nut to remove the bolt and the original rubber chuck from the RDS shaft.
2. Slide the new wire chuck on the exposed shaft and use an Allen key to tighten down the set screw.

INCLUDED:

- WIRE CHUCK

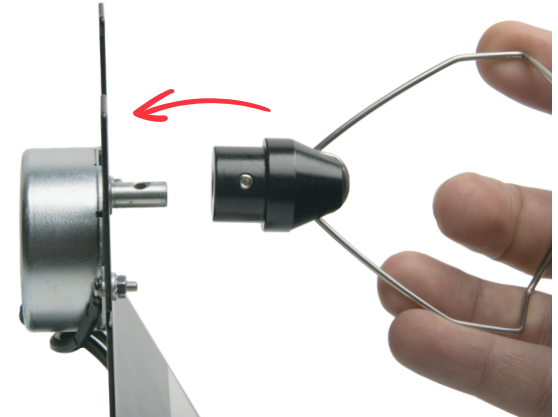

CRBPRODUCTS.COM