

# Table top Commercial Gas Griddle

## SPECIFICATION SHEET

## MODEL#: EMMG SERIES



### MODEL # EMMG-36

### Specifications

- Stainless steel for front, Left & Right panel
- Self-produced good quality U-shape burner with power of 30,000BTU/H each
- 20mm/1" thick griddle plate for EMMG-18/24/36/48
- 25mm/1" think griddle plate for EMMG-60M
- Branded gas valve
- Manual ignition
- Height Adjustable leg
- 3/4" rear gas connection

### Choose GAS TYPE When Placing Order

- LPG**  
Liquefied Propane Gas
- NG**  
Natural Gas

### Models in EMMG series

- EMMG-18 Gas Griddle**
- EMMG-24 Gas Griddle**
- EMMG-36 Gas Griddle**
- EMMG-48 Gas Griddle**
- EMMG-60M Gas Griddle**

### Accesories for Standard

- Adjustable bullet leg
- Convert kit from LPG and NG

## PRODUCT DIMENSION CHART

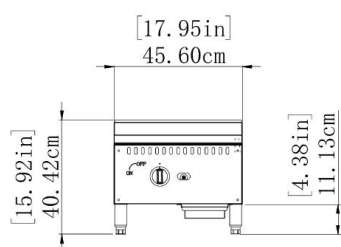

**EMMG-18**

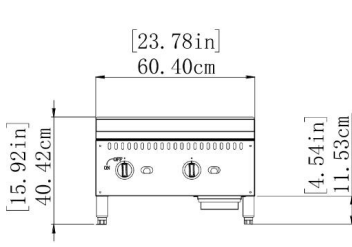

**EMMG-24**

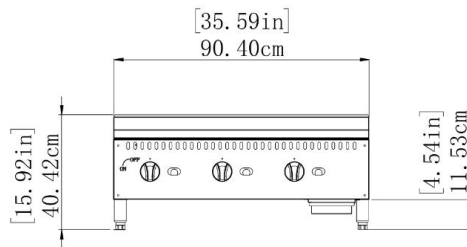

**EMMG-36**

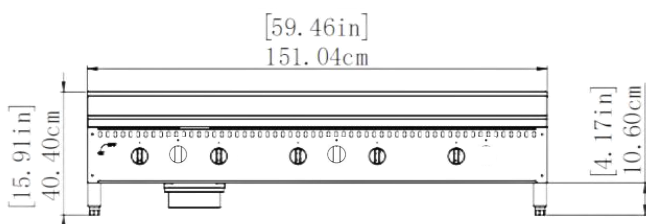

**EMMG-60M**

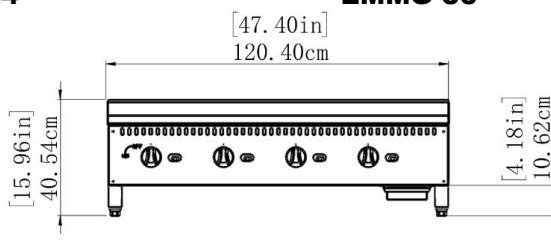

**EMMG-48**

## Key Parameters

Model	Product Dimension	Heat Power	Heating Burner	Gas Consumption	Gas inlet Connection	N.W	G.W	Packing dimension
EMMG-14	17.97x26.11x15.92 inch 456x663x405mm	30,000 BTU	1	LPG: 0.340m <sup>3</sup> /h NG: 0.789m <sup>3</sup> /h	3/4" NPT Male	31kg	44kg	565x785x490mm
EMMG-24	23.97x26.11x15.92 inch 604x663x405mm	60,000 BTU	2	LPG: 0.680m <sup>3</sup> /h NG: 1.578m <sup>3</sup> /h	3/4" NPT Male	43.5kg	59.5kg	720x785x490mm
EMMG-36	35.78x26.11x15.92 inch 904x663x405mm	90,000 BTU	3	LPG: 1.02m <sup>3</sup> /h NG: 2.367m <sup>3</sup> /h	3/4" NPT Male	65kg	86kg	1010x785x490mm
EMMG-48	47.4x26.11x15.92 inch 1204x663x405mm	120,000 BTU	4	LPG: 1.36m <sup>3</sup> /h NG: 3.156m <sup>3</sup> /h	3/4" NPT Male	90kg	116kg	1310x785x490mm
EMMG-60M	60x29.05x15.96inch 1510x738x405mm	150,000BTU	5	LPG: 1.699m <sup>3</sup> /h NG: 3.946m <sup>3</sup> /h	3/4" NPT Male	204.5kg	242.5kg	1625X900X510mm