

Table top Commercial Gas Charbroiler

SPECIFICATION SHEET

MODEL#: EMRC-M SERIES



MODEL # EMRC-24M

Specifications

- Stainless steel body
- Cast iron gas burner with power of 20000BTU each
- Cast iron Radiant cover
- Brass Gas Valve from Alpha Brand
- Manual ignition
- 3/4" rear gas connection and gas pressure regulator
- Height Adjustable leg

Choose GAS TYPE When Placing Order

- LPG**
Liquefied Propane Gas
- NG**
Natural Gas

Models in EMRC series

- EMRC-14M Gas Charbroiler**
- EMRC-24M Gas Charbroiler**
- EMRC-36M Gas Charbroiler**
- EMRC-48M Gas Charbroiler**

Standard Accessories

- Adjustable bullet leg
- Convert kit of LP gas and NG

PRODUCT DIMENSION CHART

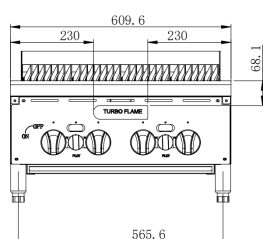

EMRC-24M

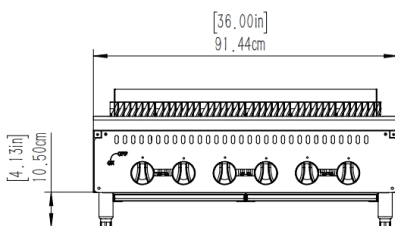

EMRC-36M

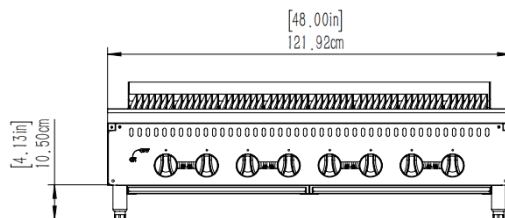

EMRC-48M

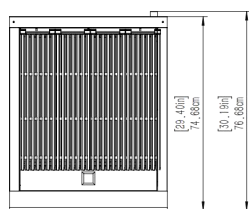

Top View

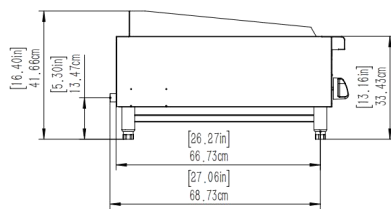

Side View

Key Parameters

Model	Product Dimension	Heat Power	Heating Burner	Gas Consumption	Gas inlet Connection	N.W	G.W	Packing dimension
EMRC-14M	14x30.24x16.30 inch 356x737.8x334.5mm	40,000 BTU/H	2	LPG: 0.453m ³ /h Town Gas: 1.052m ³ /h	3/4" NPT Male	53.5kg	66.5kg	456x890x500mm
EMRC-24M	24x29.05x16.38 inch 609.6x737.8x416mm	80,000 BTU/H	4	LPG: 0.906m ³ /h Town Gas: 2.104m ³ /h	3/4" NPT Male	89.5kg	105.5kg	740x890x500mm
EMRC-36M	36x29.05x16.38 inch 915x737.8x416mm	120,000 BTU/H	6	LPG: 1.36m ³ /h Town Gas: 3.156m ³ /h	3/4" NPT Male	124.5kg	150kg	1050x890x500mm
EMRC-48M	48x29.05x16.38 inch 1210x737.8x416mm	160,000 BTU/H	8	LPG: 1.813m ³ /h Town Gas: 4.209m ³ /h	3/4" NPT Male	159kg	194kg	1340x890x500mm