

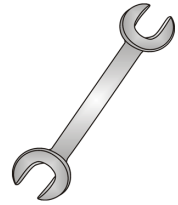

Tow-Trust Towbars

Important: Please read General Notes overleaf before fitting



Issue 4

TR7A NISSAN NV400 VAN FWD 2011> RENAULT MASTER VAN FWD 2010> VAUXHALL MOVANO VAN FWD 2010>

Item	Qty	Description	Item	Qty	Description
A	1	Crossmember	E	2	M16 x 60 Bolts & Nyloc Nuts
B	2	Handed Side Arms	F	10	M12 x 45 Bolts, 2 Nyloc Nuts & 8 S/P Washers
C	1	Coupling Spacer	G	12	12 x 40 Flat Washers
			H	2	12 x 25 Flat Washers

- Vehicles with rear step only:** First remove the two fixings each side connecting the Step to the brackets fixed to the chassis members. RETAIN FIXINGS.
- Vehicles with rear step only:** Remove the brackets from each chassis member, three fixings on the N/S chassis member, and two fixings on the O/S chassis member.
- Vehicles without rear step:** Remove Towing eye from left hand chassis member.
- Locate all Towbar mounting points and ensure threads and mating faces are all clean and free from any under seal.
- Using Item F and Item G loosely bolt Item A to the underside of the vehicle.
- Using Item F and Item G bolt Items B to each correct chassis.
- Using Item F with Item H bolt Items B to Item A.
- Using Item E bolt your desired ball bracket and wiring plate (not supplied in this kit) to Item A.
- Vehicles with rear step only:** Using the original step fixings bolt the step to Item A using Item G if necessary as spacers.
- Fully tighten all nuts and bolts ensuring Towbar is rigid and secure.

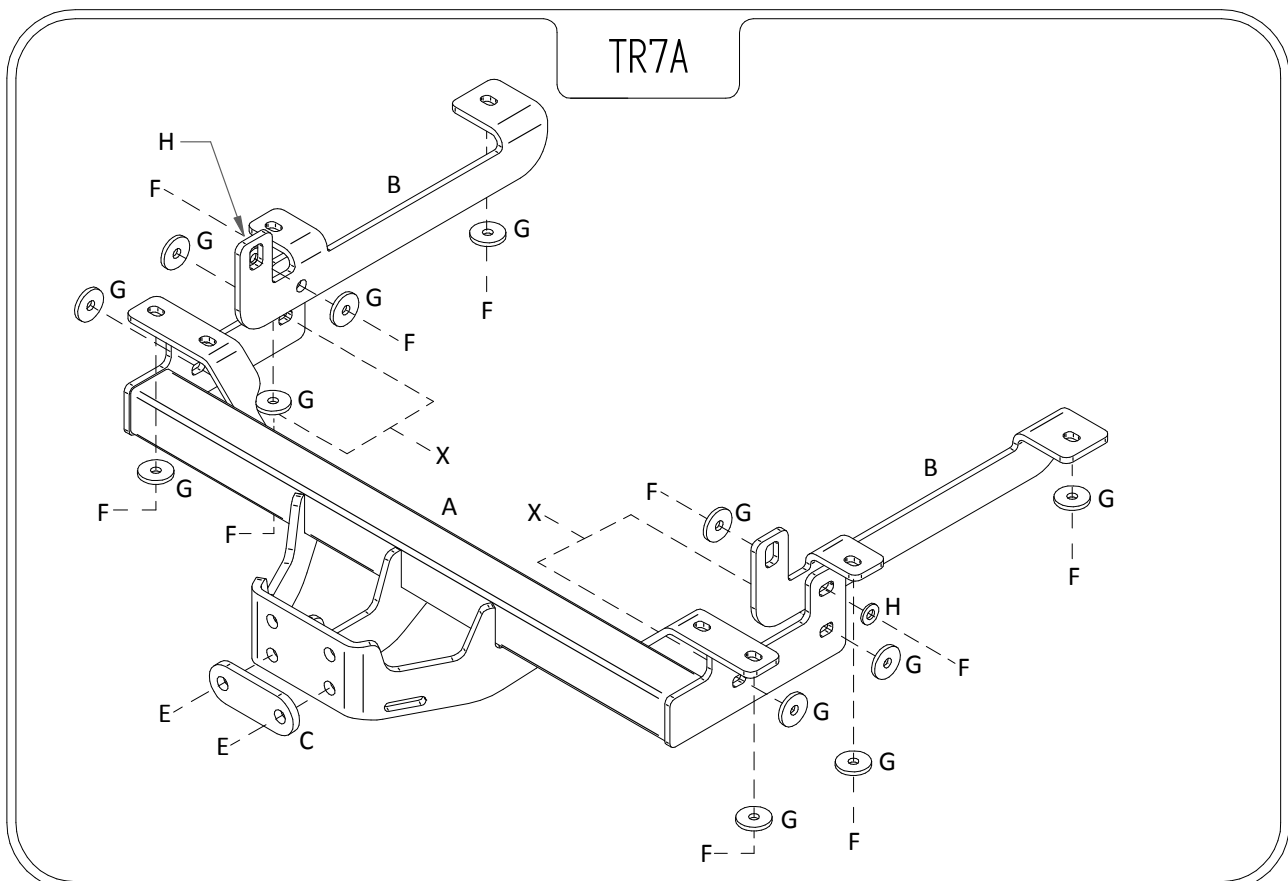

Note:

- Recommended Torque Setting for M12 Grade 10.9 -139 Nm. (For other Torque Settings see notes overleaf.)
- Nose load limits and vehicle manufacturers trailer / caravan weight limits must be observed.